

**6, heat pump, 9 kg**  
**WQG245A0TH**



- Iron Assist:
- AutoDry:
- **SensitiveDrying:**
- **Anti-Vibration**

Built-in / Free-standing: .....

: .....

: .....

/ : ..... White

: ..... 145.0 .

: ..... 842 x 598 x 613 mm

: ..... 54.5 .

: ..... 112 l

Fluorinated greenhouse gases: .....

Type of refrigerant: ..... R290

Hermetically sealed equipment: .....

The quantity expressed in CO2 equivalent: ..... 0.000

: ..... 800 W

( ): ..... 10 A

: ..... 220-240 V

: ..... 50 Hz

Drying process: ..... automatic

- (2010/30/EC): ..... 9.0 .

: ..... A++: very efficient

Power consumption in off-mode - NEW (2010/30/EC): ..... 0.10 W

Power consumption in left-on mode - NEW (2010/30/EC): ..... 0.75 W

Condenser: ..... B



- WTZ27400 :  
 WTZ27410 :  
 WTZPW20D Platform with pull-out  
 WMZ20600 :

## **6, heat pump, 9 kg WQG245A0TH**

---

- WQG245A0TH
- VarioPerfect: speedPerfect
- ecoPerfec
- aquaStop

### **engine power and consumption**

### **options**

### **comfort and safety**

- T F T -
- Yes
- 
- buzz
- M
  
- 2
- ( x x ): 84.2 x 59.8 x 61.3 .

**6, heat pump, 9 kg**  
**WQG245A0TH**

Measurements in mm

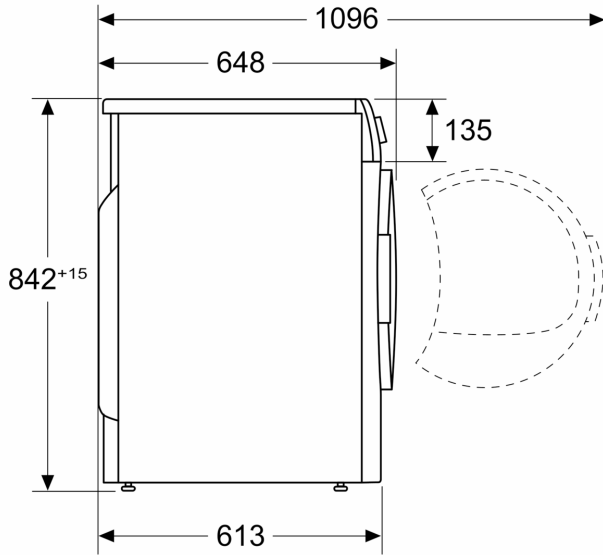

Measurements in mm

