

**6, heat pump, 9 kg
WQG24200TH**



- WMZ20600 :
- WTZ1110 Condenser drainage kit
- WTZ11400 :
- WTZ20410 Connection set
- WTZPW20D Platform with pull-out

- AutoDry:
- SensitiveDrying:
-

Built-in / Free-standing:

:

:

/ : White

: 145.0 .

: 842 x 598 x 613 mm

: 49.7 .

: 112 l

Fluorinated greenhouse gases:

Type of refrigerant: R290

Hermetically sealed equipment:

The quantity expressed in CO2 equivalent: 0.000

: 625 W

(): 10 A

: 220-240 V

: 50 Hz

Drying process: automatic

- (2010/30/EC): 9.0 .

: A++: very efficient

Energy consumption electric dryer, full load - NEW (2010/30/EC): 2.11 kWh

Standard cotton programme time at full load: 238

Energy consumption electric dryer, partial load - NEW (2010/30/EC): 1.22 kWh

Standard cotton programme time at partial load: 143

Weighted annual energy consumption, electric dryer - NEW (2010/30/EC): 259.0 kWh/annum

Power consumption in off-mode - NEW (2010/30/EC): 0.15 W

Power consumption in left-on mode - NEW (2010/30/EC): 0.50 W

Weighted programme time: 184

Condenser: B

Average condensation efficiency full load (%): 85 %

Average condensation efficiency partial load (%): 85 %

Weighted condensation efficiency for the standard cotton programme at full and partial load: 85 %



6, heat pump, 9 kg
WQG24200TH

Measurements in mm

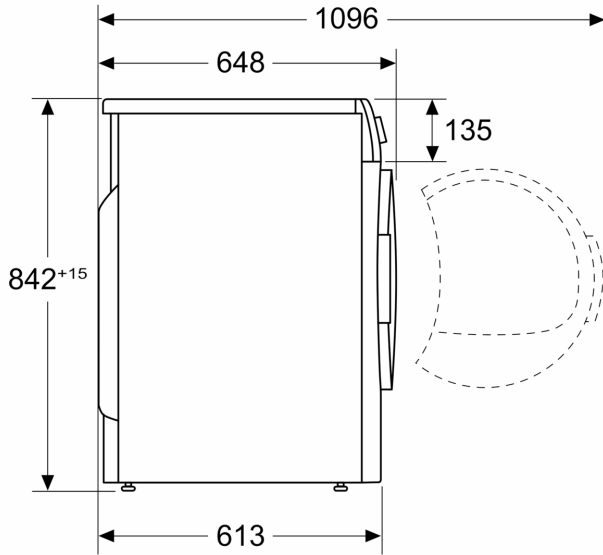

Measurements in mm

