

## iQ500, Frontloader Washing Machine, 9 kg, , Silver inox WM14T69XZA



**A+++**

- ✓ i-Dos: Automatically doses the precise amount of detergent and water.
- ✓ speedPack L – Speed up programmes, or wash in just 15 minutes.
- ✓ Clearly and intuitively, all available functions can be selected directly - large multiTouch LED display
- ✓ Efficient, durable and quiet - iQdrive.
- ✓ Get perfectly clean laundry in up to 65% less time with varioSpeed.

Maximum capacity in kg (EU 2017/1369): .....9.0 kg  
 Design: ..... Free-standing  
 Door opening: ..... Left  
 Color / Material body: ..... Silver inox  
 Length electrical supply cord: ..... 160.0 cm  
 Height of the appliance: ..... 848 mm  
 Dimensions of the product: ..... 848 x 598 x 590 mm  
 Wheels: ..... No  
 Net weight: ..... 71.0 kg  
 Drum volume: ..... 63 l  
 Connection rating: ..... 2300 W  
 Fuse protection: ..... 10 A  
 Voltage: ..... 220-240 V  
 Frequency: ..... 50 Hz



WMZ2200	Floor securing component
WMZ2381	Extension for cold water inlet /Aquastop

## iQ500, Frontloader Washing Machine, 9 kg, , Silver inox WM14T69XZA

- Housing in silver inox and stainless steel

### Engine power/Consumption

- Capacity: 9 kg
- Energy Efficiency Class: A+++
- Energy consumption :152 kWh per year, based on 220 standard washing cycles
- Energy consumption:standard 60 °C cotton programme 0.9 kWh full load and 0.6 kWh partial load and 40 °C cotton programme 0.44 kWh partial load
- Weighted power consumption off-mode / left-on mode: 0.1 W / 0.1 W
- Water consumption 11220 litres per year, based on 220 standard washing cycles
- B spin class
- Maximum spin speed: 1400rpm
- Remaining moisture:53 %
- Programme time:60 °C cotton programme 285 min at full load 285 min at partial load and 40 °C cotton programme 285 min partial load
- Duration of the left-on mode: 20 min
- Programme time:60 °C cotton programme 285 min at full load 285 min at partial load and 40 °C cotton programme 285 min partial load
- Noise level spinning:75dB (A) re 1 pW:

### Programmes

- Special programmes: quick wash/mixture, AllergyPlus / Hygiene, Super 15 min / Super 30 min, Duvet, Automatic Intensive, wool, delicates/silk

### Options

- i-Dos: automatic dosing of liquid detergent and softener
- varioSpeed: Up to 65% reduced washing cycle
- Touch control buttons: Less Ironing, soaking, i-DOS 2.0 1, i-DOS 2.0 2, Basic setting / Child lock, Memory, SpeedPerfect, Rinse plus +1+2+3, rinse hold, Start / Reload / Pause, Temperature Selection, Prewash, Spin speed reduction, Time Delay and 24 h Time Delay, i-Dos 1: Liquid detergent, i-Dos 2: Fabric Softener

### Comfort and Safety

- Reload Function: Stop the already running washing machine to add any forgotten items of laundry to the drum.
- XXL Drum volume: 63 l
- waveDrum: for highly effective and extremely gentle laundry care
- DrumClean with reminder function
- 32 cm porthole, silver-black grey with 171° opening door
- magnet with pull-open latch
- Reload function/ pause function
- Ferrite-BLDC
- AntiVibration
- Sound insulation by bottom cover
- Sound insulation by additional damping material
- Turbidity sensor
- Flow-through sensor

- waterPerfect: resource gentle watermanagement
- Precise load detection upon program start thanks to intelligent measuring technology.
- ActiveWater: water management system
- Automatic load detection for precise detection of loaded laundry to adjust automatically the amount of water that is needed in every wash.
- Multiple water protection
- Indication of water and energy consumption prior to start of programme
- Jog dial w mech. button
- metal Jog dial w mech. button
- Large touch-LED-display for programme status indication, temperature selection, max. spin speed, remaining time and 24 h end time delay, load recommendation and consumption indication
- Foam detection system
- Child Lock

### General Information

- Slide-Under
- Dimensions (H x W x D): 84.8 x 59.8 x 59 cm

metal Jog dial w mech. button

\*\* Values are rounded.

**iQ500, Frontloader Washing  
Machine, 9 kg, , Silver inox  
WM14T69XZA**

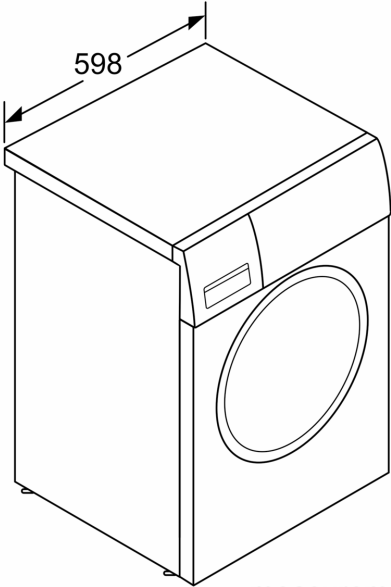

measurements in mm

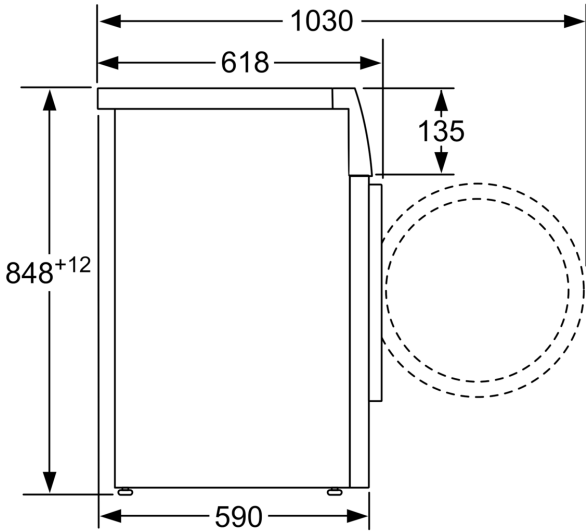

measurements in mm