

Series 4, Heat pump dryer, 8 kg WTH83028SG

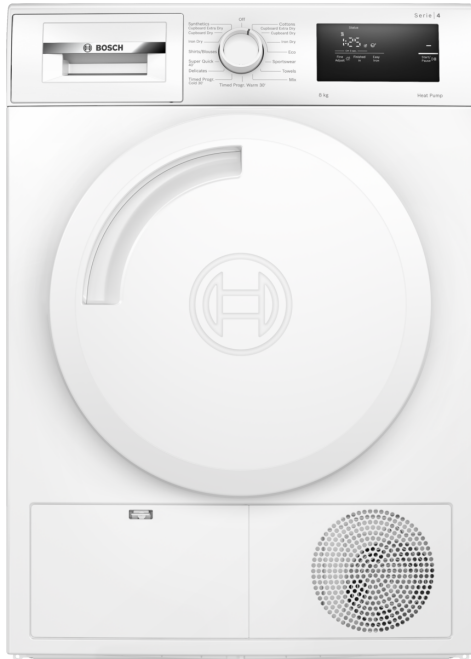

- **Auto Dry:** automatically dries to the exact degree of dryness you want.
- **Anti-Vibration Design:** Extremely stable vibration protection ensures high smoothness of operation.
- **LED Display with end-or start-time delay of up to 24 hours.**
- **Sensitive Drying System:** for gentle drying without wrinkles.
- **Anti-crease:** laundry is automatically loosened once program finished and does not crease.

Built-in / Free-standing: Free-standing
 Removable top: No
 Door hinge: Right
 Color / Material body: White
 Length electrical supply cord: 145.0 cm
 Dimensions: 842 x 598 x 613 mm
 Net weight: 46.8 kg
 Drum volume: 112 l
 Fluorinated greenhouse gases: No
 Type of refrigerant: R290
 Hermetically sealed equipment: Yes
 Connection rating: 600 W
 Fuse protection: 10 A
 Voltage: 220-240 V
 Frequency: 50 Hz
 Drying process: automatic
 Loading capacity: 8.0 kg
 Energy efficiency class: A+
 Condensation efficiency class - NEW (2010/30/EC): B



WMZ20600 Wool in basket - accessory
 WTZ1110 Condenser drainage kit
 WTZ11400 Stacking kit with pull-out shelf
 WTZ20410 Stacking kit
 WTZPW20D Platform with pull-out, dryer, cubic

Series 4, Heat pump dryer, 8 kg WTH83028SG

Engine power and consumption

- Capacity: 8 kg
- Dryer type: Condenser
- Energy Efficiency Class: A+ at a range of energy efficiency classes from A+++ to D
- The programme Cotton Ecoused at full and partial load is the standard drying programme to which the information in the label and the fiche relates, this programme is suitable for drying normal wet cotton laundry and is the most efficient programme in terms of energy consumption for cotton.
- Condensation efficiency class B on a scale from G (least efficient) to A (most efficient).<
- Noise level: 65 dB

Programmes

- Woollen Finish, Mix, Time program warm, Time program cold, Allergy Plus/Hygiene, Sports Wear, Down Wear, Super 40, Shirts 15

Additional Information

- Anti crease cycle 120 min at the end of the programme
- Touch Control Buttons: Start/pause, Low Heat, Less Ironing, Programme length, Fine-tuning of drying aim, 24 h Ready in

Convenience and safety

- Easy Clean Filter
- DUO-Tronic
- Fully electronic control dial for sensor drying programmes, timed and special programmes
- LED-Display for remaining time and 24 h end time delay, programme status indication, special functions
- Sensitive Drying Design: Stainless steel drum with textile care structure; soft design paddles
- AntiVibration™ Design: Stability and Quietness
- Wool drying basket
- Large and easily accessible lint filter
- Drum Light Interior
- Child Proof Lock
- End of cycle indicator
- Door Colour: White-black grey
- Pull-open latch
- Door hinge: right hand
- Metal door closing hook

Technical Information

- Dimensions (H x W x D): 84.2 cm x 59.8 cm x 61.3 cm
- Slide Under

**Series 4, Heat pump dryer, 8 kg
WTH83028SG**

Measurements in mm

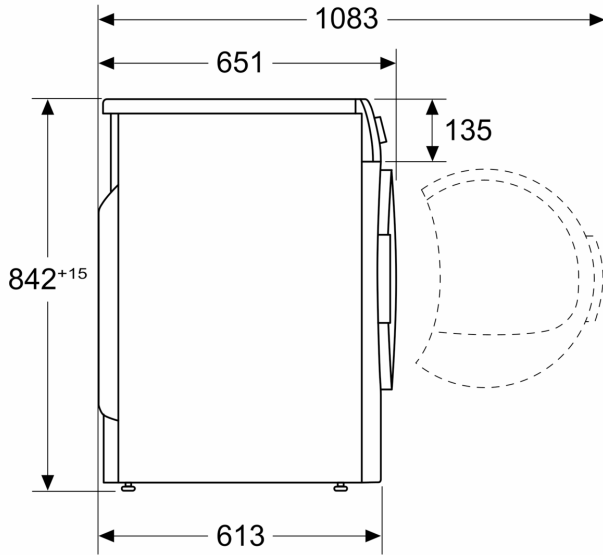

Measurements in mm

