

Series 6, Heat pump dryer, 9 kg WQG24200SG



- **Auto Dry:** automatically dries to the exact degree of dryness you want.
- **Sensitive Drying System:** for gentle drying without wrinkles.
- **Anti-crease:** laundry is automatically loosened once program finished and does not crease.
- **Easy Clean with A++:** dries very efficient. With easy cleaning of the condenser filter.

Built-in / Free-standing:	Free-standing
Removable top:	No
Door hinge:	Right
Color / Material body:	White
Length electrical supply cord:	145.0 cm
Dimensions:	842 x 598 x 613 mm
Net weight:	49.7 kg
Drum volume:	112 l
Fluorinated greenhouse gases:	No
Type of refrigerant:	R290
Hermetically sealed equipment:	Yes
The quantity expressed in CO2 equivalent:	0.000 t
Connection rating:	625 W
Fuse protection:	10 A
Voltage:	220-240 V
Frequency:	50 Hz
Drying process:	automatic
Loading capacity:	9.0 kg
Energy efficiency class:	A++
Energy consumption electric dryer, full load - NEW (2010/30/EC):	2.11 kWh
Standard cotton programme time at full load:	238 min
Energy consumption electric dryer, partial load - NEW (2010/30/EC):	1.22 kWh
Standard cotton programme time at partial load:	143 min
Weighted annual energy consumption, electric dryer - NEW (2010/30/EC):	259.0 kWh/annum
Power consumption in off-mode - NEW (2010/30/EC):	0.15 W
Power consumption in left-on mode - NEW (2010/30/EC):	0.50 W
Weighted programme time:	184 min
Condensation efficiency class - NEW (2010/30/EC):	B
Average condensation efficiency full load (%):	85 %
Average condensation efficiency partial load (%):	85 %
Weighted condensation efficiency for the standard cotton programme at full and partial load:	85 %

WMZ20600	Wool in basket - accessory
WTZ1110	Condenser drainage kit
WTZ11400	Stacking kit with pull-out shelf
WTZ20410	Stacking kit
WTZPW20D	Platform with pull-out, dryer, cubic



**Series 6, Heat pump dryer, 9 kg
WQG24200SG**

Measurements in mm

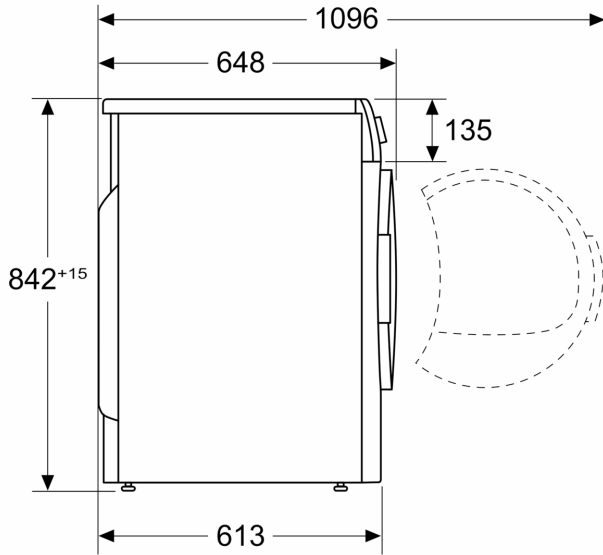

Measurements in mm

