

**Series 2, washing machine, front loader, 8 kg, 1200 rpm  
WAN24080TH**



WMZ2200 Floor securing component  
WMZ2381 Extension for cold water inlet /Aquastop

Built-in / Free-standing: .....Free-standing  
 Door hinge: .....Left  
 Color / Material body: .....White  
 Length electrical supply cord: .....160.0 cm  
 Height of the appliance: .....848 mm  
 Dimensions of the product: .....848 x 598 x 590 mm  
 Wheels: .....No  
 Net weight: .....70.7 kg  
 Drum volume: .....65 l  
 Door Frame: .....Silver-inox, black-grey  
 Noise level washing: .....55 dB(A) re 1 pW  
 Connection Rating: .....2300 W  
 Fuse protection: .....10 A  
 Voltage: .....220-240 V  
 Frequency: .....50 Hz  
 Energy Star Qualified: .....No  
 Cord Included: .....Yes  
 Plug type: .....Thai plug  
 Length of supply hose (in): .....59.05 "  
 Dimensions of the packed product: .....34.44 x 24.99 x 27.36  
 Net weight: .....156.000 lbs  
 Gross weight: .....158.000 lbs  
 Length of drain hose: .....150.00 cm  
 Length of supply hose: .....150.00 cm  
 Dimensions of the packed product (HxWxD): .....875 x 635 x 695 mm  
 Gross weight: .....71.5 kg  
 Connection Rating: .....2300 W  
 Fuse protection: .....10 A  
 Voltage: .....220-240 V  
 Frequency: .....50 Hz  
 Energy consumption: .....0.95 kWh  
 Water consumption: .....53.0 l  
 Water protection system: .....Multiple water protection  
 Maximum spin speed: .....1200 rpm  
 Spin speed options: .....Variable  
 Digital countdown indicator: .....Yes  
 Drying progress indicator: .....LED-display  
 Maximum capacity in kg (EU 2017/1369): .....8.0 kg



**Series 2, washing machine, front loader, 8 kg, 1200 rpm  
WAN24080TH**

---

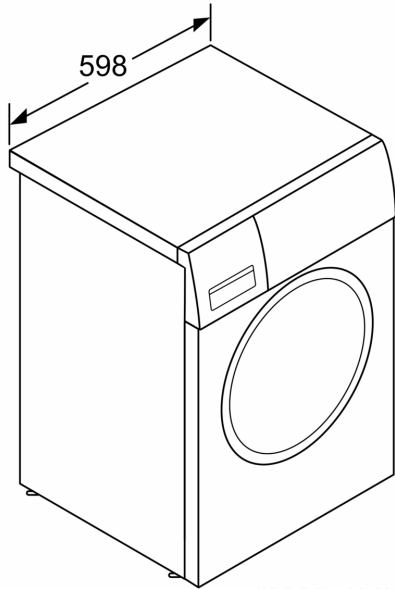

measurements in mm

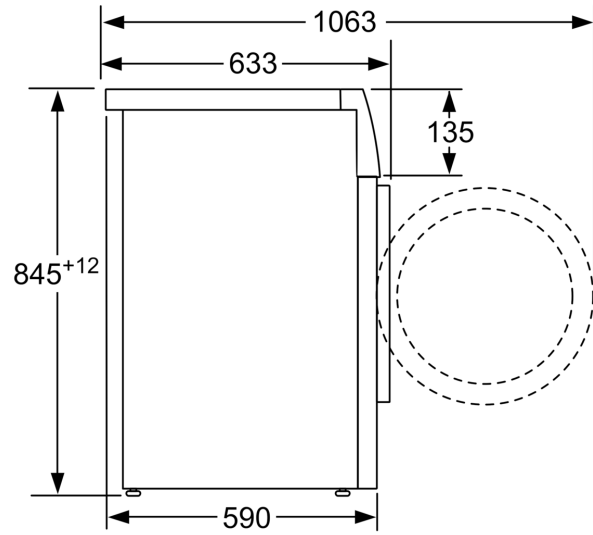

measurements in mm