

Series 8, Built-in oven with steam function, 60 x 60 cm, Black HSG7364B1



1 x enamel baking tray, 1 x grid, 1 x universal pan, 1 x steam container, size XL, punched, 1 x Steam container, unpunched, size M

HEZ635001 AirFry & Grill Set, HEZ636000 Glass pan, HEZ638D00 Full ext rails, level independent, steam, HEZ660060 Strip, HEZ664000 Baking and roasting grid (steam), HEZ66D52 2 steamcontainer(punched/unpunched)sizeM, HEZ915003 Glass roasting dish, 5,4 L, HEZG0AS00 Connecting cable 3m, HEZ32WA00 Wireless food thermometer, HEZ530000 Half tray, HEZ531010 Baking tray, non-stick ceramic coated, HEZ532010 Universal pan, non-stick ceramic coated, HEZ617000 Pizza pan, enamelled, HEZ629070 Air Fry & Grill tray, HEZ631070 Baking tray, enamelled, HEZ632070 Multipurpose pan, enamelled, HEZ633001 Lid for professional pan, enamelled, HEZ633070 Professional pan, enamelled, HEZ633073 Professional pan, enamelled

The built-in steam oven with Digital Control Ring and TFT-touchdisplay. Assist function for meals, PerfectBake Plus, PerfectRoast Plus: for automatically perfect dishes, moist steam baking and gentle steaming. Home Connect for control via the App.

- **Digital Control Ring:** the simple and innovative way to select oven settings.
- **TFT Touch Display Plus:** control with an innovative Digital Control Ring and enlarged TFT touchscreen
- **Steam Function Plus:** for gentle, healthy food preparation at up to 120°C.
- **Automatic Switch-off:** cooking process automatically stops as soon as the dish is done.
- **PerfectBake Plus:** regulates settings and tells you exactly when to remove dishes from the oven.

Gross weight: 95.000 lbs
 Built-in / Free-standing: Built-in
 Door opening: Drop down
 Min. required niche size for installation (HxWxD): 585-595 x 560-568 x 550 mm
 Dimensions: 595 x 594 x 548 mm
 Dimensions of the packed product (HxWxD): 675 x 660 x 690 mm
 Control Panel Material: Glass
 Door Material: Glass
 Net weight: 40.4 kg
 Length electrical supply cord: 120.0 cm
 Cooking method: Defrost, - Steam 100oC, - Fermentation, - Regeneration, 4D hot air, Air fry, Full width grill, Hotair gentle, Half width grill, Conventional heat, Conventional heat gentle, Pizza setting, low temperature cooking, Bottom heat, Hot air grilling, pre-heating, warming
 Time-setting Options: Start and Stop
 Fuse protection: 16 A
 Voltage: 220-240 V
 Frequency: 50; 60 Hz
 Plug type: Gardy plug w/ earthing
 Energy input: Electric
 Fuse protection: 16 A
 Voltage: 220-240 V
 Frequency: 50; 60 Hz
 Plug type: Gardy plug w/ earthing
 Dimensions of the packed product: 26.57 x 25.98 x 27.16
 Net weight: 89.000 lbs
 Included accessories: . 1 x enamel baking tray, 1 x grid, 1 x universal pan, 1 x steam container, punched, size XL, 1 x Steam container, unpunched, size M, 1 x Steam container, unpunched, size M



Series 8, Built-in oven with steam function, 60 x 60 cm, Black HSG7364B1

The built-in steam oven with Digital Control Ring and TFT-touchdisplay. Assist function for meals, PerfectBake Plus, PerfectRoast Plus: for automatically perfect dishes, moist steam baking and gentle steaming. Home Connect for control via the App.

Heating Functions

- Combi-steam oven with 21 heating methods: - 4D hot air, - Conventional heat, - Hot air grilling, - Full width grill, - Half width grill, - Pizza setting, - Bottom heat, - Low temperature cooking, - Preheating, - Keep warm, - Hotair gentle, Conventional heat gentle, - Steam 100oC, - Regeneration, - Fermentation, - Defrost, Hot air grilling, warming, 4D Hot air, Conventional heat
- Temperature range 30 °C - 250 °C
- Cavity volume: 71 l

Hook-in racks / rails

- Number of shelf levels: 5 PC
- Large capacity oven with shelf supports

Design

- Touch control
- Digital Control Ring
- Enamel cavity anthracite
- Extra large capacity oven

Cleaning:

- Ecolyse features: back panel

Comfort

- Oven Assistant with Voice Control
- LED display control (red)
- Electronic clock
- Digital temperature display with proposal
- Actual temperature display - Heating-up indicator
- Door hinge: Bottom, SoftClosing, Soft opening
- Soft opening
- Supporting systems: Dish categories
- Air Fry Function
- Rapid heating-up
- steam boost - add for 3min intensive steam with a touch of a button.
- There are different steam intensities selectable: steam level high, steam level middle, steam level low
- LED light switch for oven illumination
- Water tank empty indicator
- Location of the steam generator is outside of the cavity
- Integral cooling fan
- HomeConnect ready on WLAN

Standard Accessories

- 1 x enamel baking tray, 1 x Steam container, punched, size M, 1 x steam container, punched, size XL, 1 x Steam container, unpunched, size M, 1 x grid, 1 x universal pan

Safety Functions:

- Maximum window temperature 40° C low door temperature
- Child lock, Residual heat indicator, Automatic switch off, Start and Stop button, door contact switch

Technical Information

- Length of mains cable: 120 cm
- Nominal voltage: 220 - 240 V
- Electrical connection rating: 3600 W
- Energy efficiency rating (acc. EU Nr. 65/2014): A+(at a range of energy efficiency classes from A+++ to D)
- Energy consumption per cycle in conventional mode:0.87 kWh

Series 8, Built-in oven with steam function, 60 x 60 cm, Black HSG7364B1

Installing the
other
Air exchan

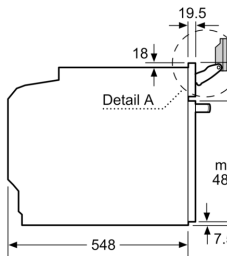
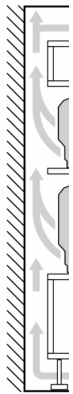

Note the pivoting range of the fast

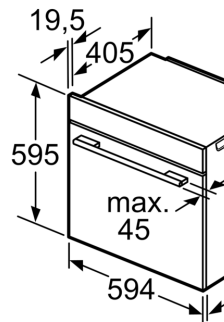

Space for applic
connection 320

If the appliance v
a hob, the follow
(including substr
must be taken in

Hob type

- Induction hob
- Full surface Induction hob
- Gas hob
- Electric hob

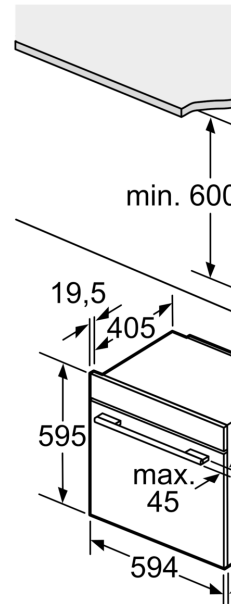

A: Air inlet :