

Series 8, Built-in compact oven with microwave function, 60 x 45 cm, Stainless steel
CMG633BS1B



1 x combination grid, 1 x universal pan

HEZ327000 Pizza stone, HEZ530000 Half tray, HEZ531010 Baking tray, non-stick ceramic coated, HEZ532010 Universal pan, non-stick ceramic coated, HEZ617000 Pizza pan, enamelled, HEZ625071 Grill tray, anthracite, HEZ631070 Baking tray, enamelled, HEZ632070 Multipurpose pan, enamelled, HEZ634080 Baking and roasting grid, microwave, HEZ636000 Glass pan, HEZ660050 Cover Strip, HEZ660060 Strip, HEZ664000 Baking and roasting grid, steam, HEZ915003 Glass roasting dish, 5,4 L

The compact oven with microwave function: enables you to achieve perfect baking and roasting results very quickly.

- **Microwave function:** for quick warming up or for fast cooking in combination with hot air.
- **4D hotair:** even heat distribution for perfect results.
- **TFT Touch Display:** easy-to-use thanks to the Control Ring with clear text and symbols.
- **LED-light:** perfect illumination of foods with minimum energy consumption.
- **Flap door with SoftOpen and SoftClose:** the oven door opens and closes especially gently and quietly.

Additional function: Microwave combination
Type of control:Electronic
Dimensions: 455x594x548 mm
Cavity dimensions: 237 x 480 x 392 mm
Length electrical supply cord: 150.0 cm
Net weight: 34.5 kg
Gross weight: 36.9 kg
Max. microwave power level: 900 W
Number of Power Levels: 5
Turntable: No
Cavity material: Enamelled steel
Door opening: Handle
Clock: Yes
Included accessories: 1 x combination grid, 1 x universal pan
Height of the appliance: 455 mm
Width of the appliance: 594 mm
Depth of the product: 548 mm
Max. microwave power level: 900 W
Connection rating: 3600 W
Fuse protection: 16 A
Voltage: 220-240 V
Frequency: 60; 50 Hz
Plug type: no plug
Alternative colors available: CMG633BB1B
Required cutout/niche size for installation (in): x
Dimensions of the packed product: 21.25 x 25.59 x 26.77
Net weight: 76.000 lbs
Gross weight: 81.000 lbs



4 242002 807409

Series 8, Built-in compact oven with microwave function, 60 x 45 cm, Stainless steel CMG633BS1B

- Required niche size for installation (HxWxD mm): 450 - 455 x 560 - 568 x 550
- "Please reference the built-in dimensions provided in the installation drawing"

The compact oven with microwave function: enables you to achieve perfect baking and roasting results very quickly.

Heating Functions

- Compact oven with microwave with 6 heating methods: - 4D hot air, - Hot Air-Eco, - Hot air grilling, - Full width grill, - Half width grill, - Preheating
- Additional heating methods with microwave: microwave, combi microwave constant
- 5 Microwave power settings (90 W, 180 W, 360 W, 600 W, 900 W) with Inverter (MW); Max. Power: 900 W;
- Intelligent inverter technology: maximum output power will be regulated to 600 W when used in longer operation
- Temperature range 30 °C - 275 °C
- Cavity volume: 45 l

Hook-in racks / rails

- Number of shelf levels: 3 PC

Design

- Intuitive Control Ring
- Enamel cavity anthracite

Cleaning:

Comfort

- LED display control (red)
- Electronic clock
- Digital temperature display with proposal
- Actual temperature display - Heating-up indicator
- Automatic programmes, 14
- Door hinge: Bottom, SoftClosing, Soft opening
- straight bar handle
- Supporting systems: Programs
- Rapid heating-up
- LED light switch for oven illumination
- Integral cooling fan

Standard Accessories

- 1 x universal pan, 1 x combination grid

Safety Functions:

- Maximum window temperature 40° C low door temperature
- Triple glazed CoolTouch door
- Child lock, Residual heat indicator, Automatic switch off, Start and Stop button, door contact switch

Technical Information

- Length of mains cable: 150 cm
- Nominal voltage: 220 - 240 V
- Electrical connection rating: 3600 W

Technical information:

- Dimensions of the product (HxWxD mm) : 455 x 594 x 548

**Series 8, Built-in compact oven with
microwave function, 60 x 45 cm,
Stainless steel
CMG633BS1B**

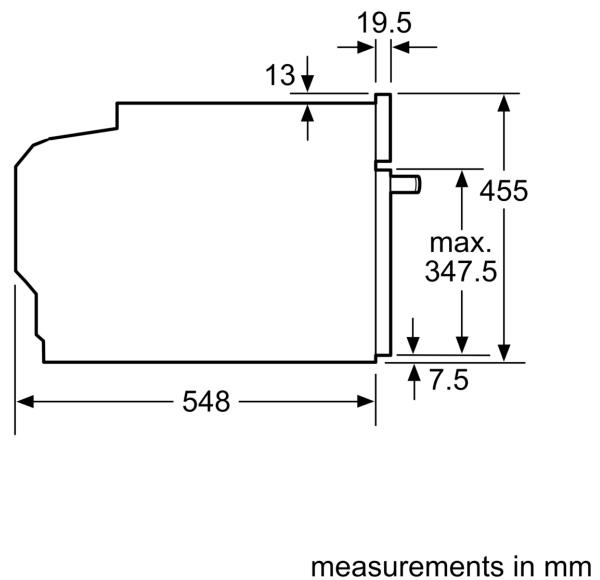
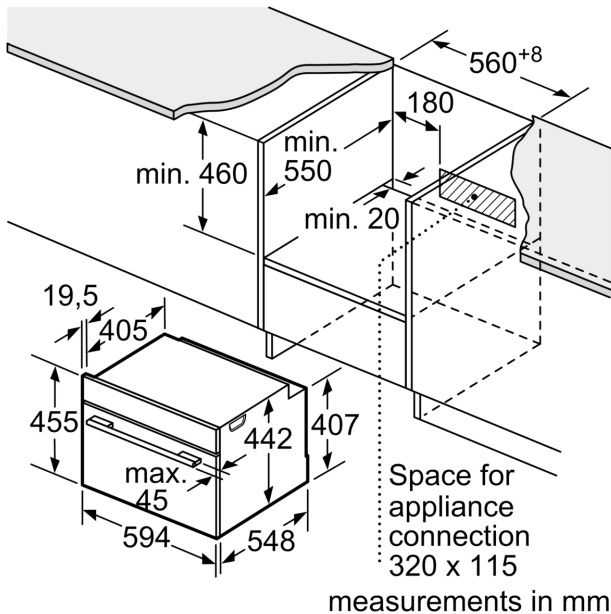

Installation with a hob.

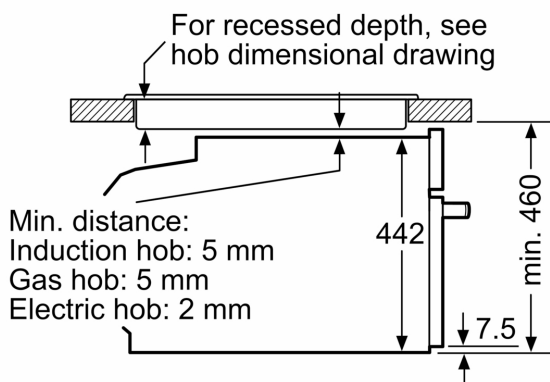

If the compact appliance will be installed underneath a hob, the following worktop thicknesses (including substructure if necessary) must be taken into account.

Hob type	min. worktop thickness	
	fitted	flush
Induction hob	42 mm	43 mm
Full surface Induction hob	52 mm	53 mm
Gas hob	32 mm	43 mm
Electric hob	32 mm	35 mm

