

Series 8, heat pump dryer, 9 kg WTX88EH9GB



A+++



- **Smart Dry:** automatically selects the best drying program based on the last washing cycle.
- **AutoDry:** gently dries laundry to precisely the degree of dryness you want.
- **Anti Vibration Design:** extremely stable and extraordinarily quiet thanks to special vibration protection.
- **Climate friendly dryer with the most environmental friendly agent (R290).**
- **Comfort Control Plus:** easy to operate thanks to the intuitive user interface, and many program options.

WMZ20600 Wool in basket - accessory
 WTZ27400 Stacking kit with pull-out shelf
 WTZ27410 Stacking kit
 WTZPW20D Platform with pull-out, dryer, cubic

Built-in / Free-standing: Free-standing
 Removable top: No
 Door hinge: Right reversible
 Color / Material body: White
 Length electrical supply cord: 179.5 cm
 Dimensions: 842 x 598 x 613 mm
 Net weight: 57.3 kg
 Drum volume: 112 l
 Fluorinated greenhouse gases: No
 Type of refrigerant: R290
 Hermetically sealed equipment: Yes
 Connection rating: 600 W
 Fuse protection: 10 A
 Voltage: 220-240 V
 Frequency: 50 Hz
 Drying process: automatic
 Loading capacity: 9.0 kg
 Energy efficiency class: A+++
 Energy consumption electric dryer, full load - NEW (2010/30/EC) 1.61 kWh
 Standard cotton programme time at full load: 215 min
 Energy consumption electric dryer, partial load - NEW (2010/30/EC): 0.90 kWh
 Standard cotton programme time at partial load: 132 min
 Weighted annual energy consumption, electric dryer - NEW (2010/30/EC): 193.0 kWh/annum
 Power consumption in off-mode - NEW (2010/30/EC): 0.10 W
 Power consumption in left-on mode - NEW (2010/30/EC): 0.10 W
 Duration of the left-on mode - NEW (2012/30/EC): 30 min
 Weighted programme time: 168 min
 Condensation efficiency class - NEW (2010/30/EC): B
 Average condensation efficiency full load (%): 88 %
 Average condensation efficiency partial load (%): 88 %
 Weighted condensation efficiency for the standard cotton programme at full and partial load: 88 %



Series 8, heat pump dryer, 9 kg WTX88EH9GB

engine power and consumption

Programmes

- standard programmes: cotton, easy care
- SmartDry
- Special programmes: allergy plus, Cotton, shirts/blouses, SmartDry, Down wear, Delicates, Towels, ColdRefresh_1piece, ColdRefresh_5pieces, ColdRefreshBusiness, Mixed Load, Super Quick 40 minutes program, Sportswear, Duvet, Synthetic, wool drying in basket, Wool Finish, Further programs, Timed Program Cold, Timed Program Warm

options

- Home Connect: Remote Monitoring and Control, Energy Management, Remote Diagnostics, SmartDry
- Anti crease cycle 120 min at the end of the programme
- Touch control buttons: base settings, end time delay, less ironing, Memory 1, Memory 2, options, Power button, Remote Start, Start / Reload / Pause, drying aim, 24 h end time delay

comfort and safety

- AutoClean
- AutoDry technology
- control dial with integrated On-/Off mode
- TFT-Clear text display for easy use
- Sensitive Drying System: Big Stainless steel drum with textile care structure, soft design paddles
- AntiVibration Design: more stability and quietness
- Wool drying basket
- Drum interior light: LED
- Child-proof lock
- Buzzer to indicate the end of cycle
- Glass door with frame chrome, white
- Metal door closing hook
- Door hinge: right-hand, door hinge: reversible
- Drain Set

Technical Information

- Slide-under height of 85cm
- Dimensions (H x W x D): 84.2 cm x 59.8 cm x 61.3 cm
- Dimensions (H x W): 84.2 cm x 59.8 cm
- Appliance depth: 61.3 cm
- Appliance depth incl. door: 65.1 cm
- Appliance depth with open door: 110.5 cm
- Heat pump technology with eco-friendly cooling agent R290

**Series 8, heat pump dryer, 9 kg
WTX88EH9GB**

Measurements in mm

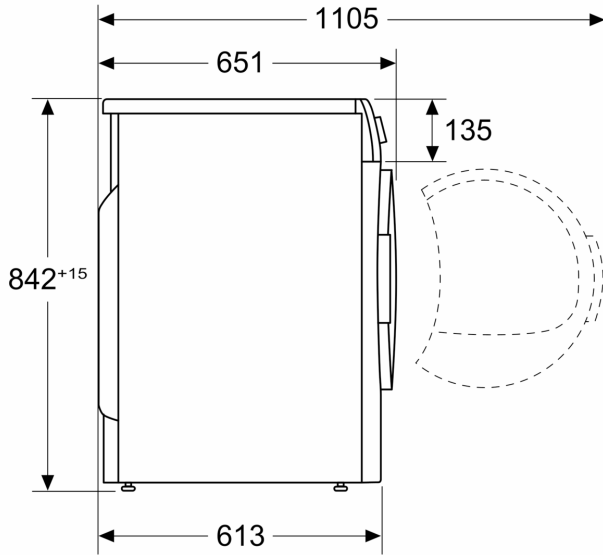

Measurements in mm

