

**iQ700, washing machine, front loader, 9 kg, , Silver inox WM14UQ9SIN**



WX975600	Floor securing component
WZ10131	Extension for cold water inlet /Aquastop
WZ20490	Platform with pull-out

- Effective odour removal even for non-washable clothes and textiles.
- ✓ sensoFresh Programme: Effective odour removal in no time, even for sensitive and non-washable fabrics.
  - ✓ Stain removal programme for removing the 4 most stubborn stains.
  - ✓ Anti-Vibration Side Panels reduce vibrations and ensure greater stability during the washing and spinning process.
  - ✓ waveDrum - Highly effective and extremely gentle laundry care

Built-in / Free-standing:	Freestanding
Door hinge:	left
Color / Material body:	Silver inox
Length electrical supply cord:	160.0 cm
Height of the appliance:	848 mm
Dimensions of the product:	848 x 598 x 590 mm
Wheels:	No
Net weight:	72.6 kg
Drum volume:	63 l
Door Frame:	Chrome, blackgray
Noise level washing:	47 dB(A) re 1 pW
Connection Rating:	2300 W
Fuse protection:	10 A
Voltage:	220-240 V
Frequency:	50 Hz
Energy Star Qualified:	No
Cord Included:	No
Plug type:	India plug (10 Ampere)
Length of supply hose (in):	59.05 "
Dimensions of the packed product:	33.85 x 24.80 x 26.77
Net weight:	160.000 lbs
Gross weight:	162.000 lbs
Length of drain hose:	150.00 cm
Length of supply hose:	150.00 cm
Dimensions of the packed product (HxWxD):	... 860 x 680 x 630 mm
Gross weight:	73.4 kg
Connection Rating:	2300 W
Fuse protection:	10 A
Voltage:	220-240 V
Frequency:	50 Hz
Water protection system:	Multiple water protection
Max. spin speed:	1400 rpm
Spin speed options:	Variable
Digital countdown indicator:	Yes
Energy Efficiency Class (Regulation (EU) 2017/1369):	C
Weighted energy consumption in kWh per 100 washing cycles of eco 40-60 programme (EU 2017/1369):	66 kWh
Maximum capacity in kg (EU 2017/1369):	9.0 kg
The water consumption of the eco programme in liters per cycle (EU 2017/1369):	44 l
Duration of eco 40-60 programme in hours and mins at rated capacity (EU 2017/1369):	3:37 h
Spin-drying efficiency class of eco 40-60 programme (EU 2017/1369):	B
Airborne acoustical noise emission class (EU 2017/1369):	A
Airborne acoustical noise emissions (EU 2017/1369):	71 dB(A) re 1 pW



## iQ700, washing machine, front loader, 9 kg, , Silver inox WM14UQ9SIN

### Technical Information

- Capacity: 9kg
- Maximum spin speed: 1400 rpm
- Dimensions (H x W x D): 84.8cm x 59.8cm x 59.0cm (63.2cm with door frame)
- 32cm porthole, 171° swing door

### Programmes

- Cottons, Cottons 60°C Label, Cottons Eco, Synthetics, Mix, Delicates/Silk, Wool, Rinse, Spin/Drain, Drum Clean, Shirts/Business, Outdoor/Waterproof, Super 15min/30min, sensoFresh

### Features

- sensoFresh Programme: Effective odour removal in short time, even for sensitive and non-washable fabrics
- sensoFresh: refreshing your clothes from odors without washing in just 45 min
- Intelligent, durable and quiet iQdrive motor for highly effective and efficient laundry care
- speedPerfect/ varioSpeed: Up to 65% reduced washing cycle
- The most efficient use of water with any load level - waterPerfect Plus.
- For highly effective and extremely gentle laundry care - waveDrum
- Anti-Vibration Side Panels reduce vibrations and ensure greater stability during the washing and spinning process.
- Time delay to select end of time of your wash (1-24 hours) and time remaining indicator
- Reload function to pause machine operation for adding in last minute laundry items
- Foam detection system to remove excessive foam

### Safety

- Voltmonitor - monitors, regulates and feedback voltage fluctuations to manage unstable electrical supply to protect the washing machine and ensure a smooth wash cycle
- Multiple water protection with magnetic valve to minimise risk of leakage
- Child-proof lock

### Display Screen & Alerts

- Large LED display screen to indicate: Programme status, Temperature and Spin Speed Selection, Remaining Time and 24 Hour End Time Delay, Load Recommendation and Energy Consumption
- TouchControl buttons: Start/Reload, Temperature, speedPerfect, Rinse Plus, Spin Speed Reduction
- Buzzer at the end of the wash programme

iQ700, washing machine, front loader, 9 kg, , Silver inox  
WM14UQ9SIN

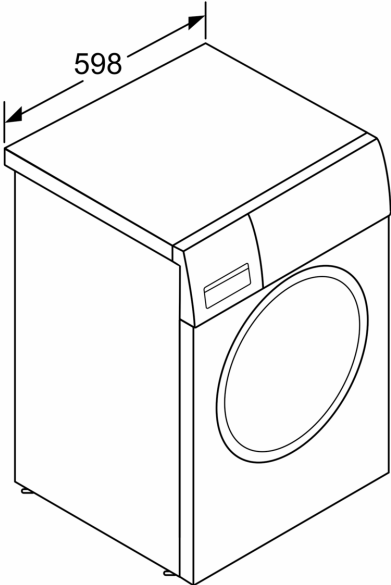

measurements in mm

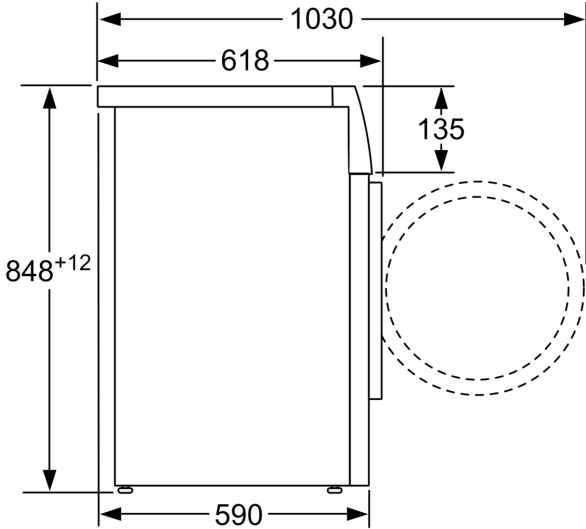

measurements in mm