

## iQ300, washing machine, front loader, 7 kg, 1200 rpm WM12K269IN



- ✓ waveDrum - Highly effective and extremely gentle laundry care
- ✓ Anti-Vibration Side Panels reduce vibrations and ensure greater stability during the washing and spinning process.
- ✓ Voltmonitor - monitors, regulates and feedback voltage fluctuations to manage unstable electrical supply to protect the washing machine and ensure a smooth wash cycle

Built-in / Free-standing: ..... Freestanding  
 Door hinge: ..... left  
 Color / Material body: ..... Silver  
 Length electrical supply cord: ..... 160.0 cm  
 Height of the appliance: ..... 848 mm  
 Dimensions of the product: ..... 848 x 598 x 590 mm  
 Wheels: ..... No  
 Net weight: ..... 72.4 kg  
 Drum volume: ..... 58 l  
 Door Frame: ..... Silver-black grey  
 Color Buttons: ..... silver  
 Color Dial: ..... silver  
 Noise level washing: ..... 55 dB(A) re 1pW  
 Fuse protection: ..... 10 A  
 Voltage: ..... 220-240 V  
 Frequency: ..... 50 Hz  
 Total annual energy consumption: ..... 210.0 kWh/annum  
 Energy Star Qualified: ..... No  
 Cord Included: ..... No  
 Plug type: ..... India plug (16 Ampere)  
 Length of supply hose (in): ..... 59.05 "  
 Dimensions of the packed product: ..... 37.99 x 25.78 x 27.95  
 Net weight: ..... 160.000 lbs  
 Gross weight: ..... 171.000 lbs  
 Length of drain hose: ..... 150.00 cm  
 Length of supply hose: ..... 150.00 cm  
 Dimensions of the packed product (HxWxD): ... 965 x 710 x 655 mm  
 Gross weight: ..... 77.5 kg  
 Fuse protection: ..... 10 A  
 Voltage: ..... 220-240 V  
 Frequency: ..... 50 Hz  
 Energy consumption: ..... 1.05 kWh  
 Water consumption: ..... 42.0 l  
 Total annual water consumption: ..... 8400 l  
 Total annual energy consumption: ..... 210.0 kWh/annum  
 Water protection system: ..... Multiple water protection  
 Max. spin speed: ..... 1200 rpm  
 Spin speed options: ..... Variable  
 Digital countdown indicator: ..... Yes  
 Drying progress indicator: ..... LED-display, LED  
 Maximum capacity in kg (EU 2017/1369): ..... 7.0 kg

WX975600 Floor securing component  
 WZ10130 Extension for cold water inlet /Aquastop



## iQ300, washing machine, front loader, 7 kg, 1200 rpm WM12K269IN

### Technical Information

- rated capacity: 7 kg
- Maximum Spin Speed: 1200 rpm
- Dimensions (H x W x D): 84.8cm x 59.8cm x 59.0cm (61.8cm with door frame)
- 32 cm porthole, 165° swing door

### Programmes

- Cottons, Synthetics, Mix, Delicates/Silk, Wool, Drum Clean, Rinse, Spin/Drain, Sportswear, Jeans, Duvet, Shirts, Kidswear, Freshen Up, SuperQuick 15min/30min

### Features

- WaveDrum's breakthrough wave-droplet design provides a thorough yet gentle clean for fine textiles
- Anti-Vibration Side Panels reduce vibrations and ensure greater stability during the washing and spinning process
- Less ironing reduces deep creases from forming in the laundry so less time is spent ironing
- Reload function to pause machine operation for adding a forgotten garment
- Foam detection system to remove excessive foam

### Safety

- Multiple water protection
- Voltmonitor monitors and regulates voltage fluctuations to protect the washing machine and ensure a smooth wash cycle

### Display Screen & Alerts

- LED display screen to indicate Remaining Time, Spin Speed reduction
- Buzzer at the end of the wash programme

**iQ300, washing machine, front loader, 7 kg, 1200 rpm  
WM12K269IN**

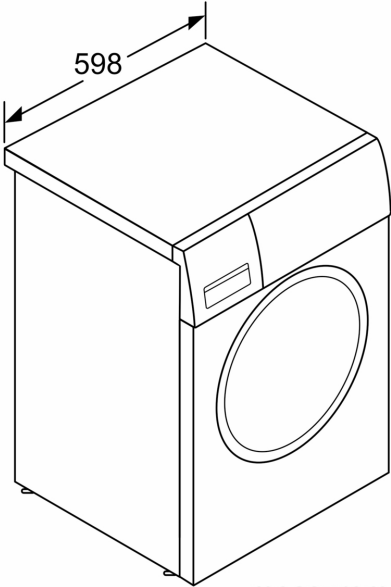

measurements in mm

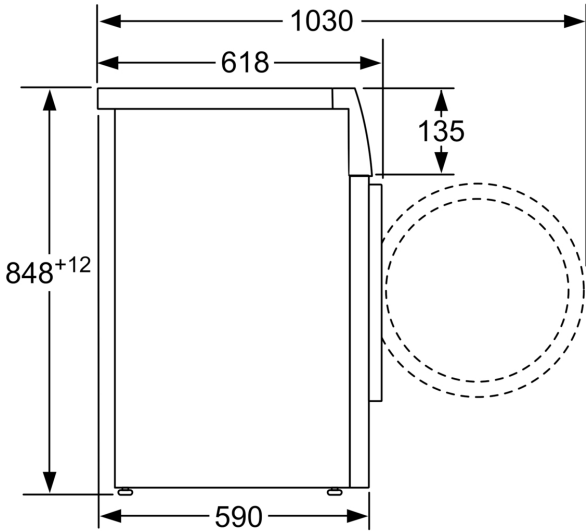

measurements in mm