

Floor fixation kit
WX975600

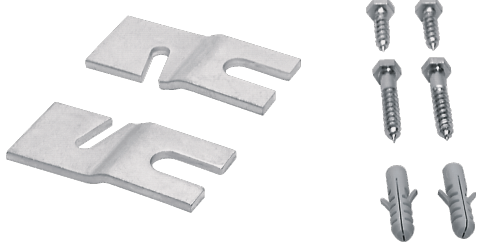

✓ Suitable for:
✓ WV / WM 3 ... / WM 4 ... WD 5 / WP 7

Features

Technical Data
Dimensions of the packed product (HxWxD): 60 x 50 x 100 mm
Pallet dimensions: 100.0 x 120.0 x 80.0
Quantity per packing unit: 42
Standard number of units per pallet: 756
Weight: 0.4 kg
Gross weight: 0.4 kg
EAN code:4242003047101

