

IQ500, Condenser tumble dryer, 9 kg WT46G491GB



B



Optional accessories

WZ11410	Stacking kit
WZ20400	Stacking kit with pull-out shelf

iSensonic condenser dryer with sensor-controlled autoDry technology for preventing laundry shrinkage.

- ✓ speedPack – Save time with our fast and highly efficient dryers.
- ✓ autoDry – Gentle and precise drying that protects your clothes.
- ✓ Outdoor programme – Dry your waterproof and outdoor clothing safely.
- ✓ easyClean filter for convenient fluff removal from the condenser filter.
- ✓ super40 – Fast and careful drying of small loads

Features

Technical Data

Built-in / Free-standing:	Freestanding
Removable top:	No
Door hinge:	Right
Length electrical supply cord:	179.5 cm
Dimensions:	842 x 598 x 613 mm
Weight:	42.3 kg
EAN code:	4242003803288
Connection Rating:	2600 W
Fuse protection:	13 A
Nominal power:	220-240 V
Frequency:	50 Hz
Capacity:	9.0 kg
Energy efficiency rating:	B
Energy consumption electric dryer, full load - NEW (2010/30/EC):	5.23 kWh
Standard cotton programme time at full load:	150 min
Energy consumption electric dryer, partial load - NEW (2010/30/EC):	2.77 kWh
Standard cotton programme time at partial load:	80 min
Weighted annual energy consumption, electric dryer - NEW (2010/30/EC):	616.0 kWh/annum
Weighted programme time:	110 min
Average condensation efficiency full load (%):	88 %
Average condensation efficiency partial load (%):	88 %
Weighted condensation efficiency (%):	88 %



IQ500, Condenser tumble dryer, 9 kg WT46G491GB

Features

Performance

Programmes/functions

- Fully electronic control dial for sensor and timed programmes
- Touch control buttons: low heat, buzzer, less ironing, programme length, start/pause, fine-tuning of drying aim, 24 h end time delay, less ironing, fine-tuning of drying aim, low heat, programme length, end time delay, buzzer, start/pause
- Special programmes: Woollens Finish, mixed fabrics, outdoor, timed programme warm, timed programme cold, hygiene, lingerie, rapid 40, shirts 15

Key features

- Sensitive drying: large softDry stainless steel drum system and revolution drying system
- AntiVibration design: for greater stability and quietness

Additional features

- Large LED display for remaining time and 24 hours time delay, programme progress indication and special functions
- Anti crease cycle 120 min at the end of the programme
- Drum interior light
- easyClean filter
- Child Lock
- End of cycle buzzer
- Door hinge: right-hand
- Container for condensed water

Technical Information

- Dimensions (H x W x D): 84.2 x 59.8 x Appliance depth: 65.1 cm
- Slide-under installation
- integrated glass door with frame Alu-Look, white

IQ500, Condenser tumble dryer, 9 kg WT46G491GB

Dimensioned drawings

Measurements in mm

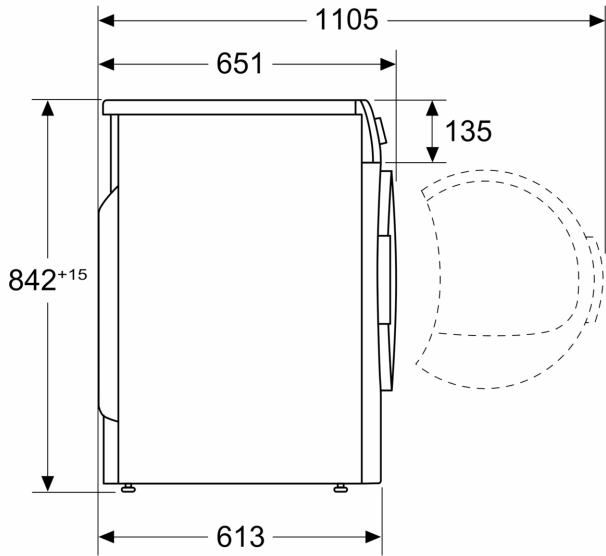

Measurements in mm

