

IQ300, Condenser tumble dryer, 8 kg, White
WT45N202GB



iSensoric condenser dryer with sensor-controlled autoDry technology and softDry drum for optimal textile care.

- ✓ autoDry – gentle and precise drying that protects your clothes.
- ✓ Outdoor programme – dry your waterproof and outdoor clothing safely.
- ✓ rapid40: carefully and quickly dries small loads.
- ✓ drumLight for an ideal illumination of the drum interior.
- ✓ softDry drum system for extremely gentle drying

Features

Technical Data

Built-in / Free-standing: Freestanding
Removable top: No
Door hinge: Right
Length electrical supply cord: 179.5 cm
Dimensions: 842x598x613 mm
Weight: 41.3 kg
EAN code: 4242003873762
Connection Rating: 2600 W
Fuse protection: 13 A
Nominal power: 220-240 V
Frequency: 50 Hz



Optional accessories

WZ11410 Stacking kit
WZ20400 Stacking kit with pull-out shelf
WZDP20D Platform with pull-out, dryer, cubic

¹ Scale of Energy Efficiency Classes from A to G

IQ300, Condenser tumble dryer, 8 kg, White WT45N202GB

Features

Performance

Programmes/functions

- Fully electronic control dial for sensor and timed programmes
- Touch control buttons: low heat, less ironing, programme length, fine-tuning of drying aim, 24 h end time delay, less ironing, fine-tuning of drying aim, low heat, programme length, end time delay, Start / Reload / Pause
- Special programmes: Woollens Finish, mixed fabrics, outdoor, timed programme warm, timed programme cold, hygiene, lingerie, rapid 40, shirts 15

Key features

- Sensitive drying: large softDry stainless steel drum system and revolution drying system
- AntiVibration design: for greater stability and quietness

Additional features

- LED Display for remaining time and 24 hours time delay, programme status indication, special functions
- Anti crease cycle 120 min at the end of the programme
- Drum interior light
- Child Lock
- End of cycle buzzer
- Door hinge: right-hand
- Container for condensed water

Technical Information

- Slide-under installation
- Glass door,, grey, white
- Dimensions (H x W x D): 84.2 x 59.8 x Appliance depth: 65.1 cm
- Fully electronic control dial for sensor drying, including timed and special programmes
- Metal door catch
- Energy Efficiency Class¹: B
- Energy²: 560 kWh
- Capacity: 1 - 8 kg
- Programme time³: 137 min
- Noise level: 65 dB (A) re 1 pW
- Condensation efficiency class⁴: B
- Condensation efficiency⁵: 88 %

¹ At a range of energy efficiency classes from A+++ to D

² Energy consumption kWh per year, based on 160 drying cycles of the standard cotton programme at full and partial load, and the consumption of the low power modes

³ Programme time of the standard cotton programme at full load

⁴ On a condensation efficiency class scale from A to G

⁵ Weighted condensation efficiency for the standard cotton programme at full and partial load

**IQ300, Condenser tumble dryer, 8
kg, White
WT45N202GB**

Dimensioned drawings

Measurements in mm

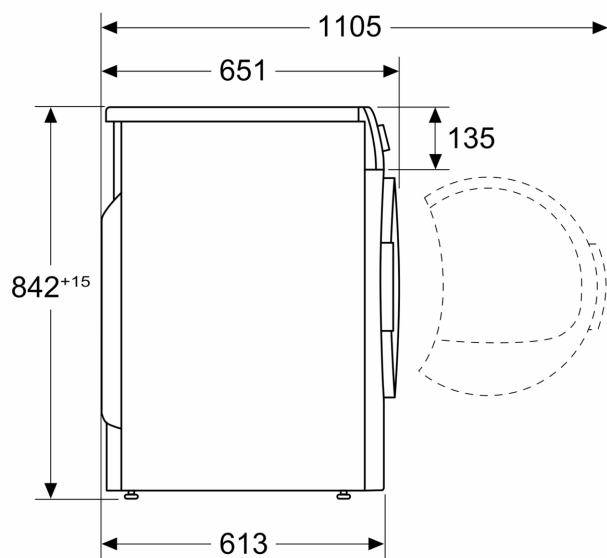

Measurements in mm

