

**Series 6, washing machine, front loader, 9 kg, 1400 rpm
WAU28PH9GB**



The i-DOS washer with Intelligent Dosing System and with Home Connect, is the smartest washer, that does everything automatically to get perfect results every time.

- **i-DOS:** automatically measures the precise amount of detergent and water.
- **Home Connect:** home appliances with smart connectivity for an easier everyday life.
- **Automatic programmes:** adjust the wash for the fabric type and degree of soiling.
- **EcoSilence Drive™:** quiet and energy-efficient drive, with a 10-year warranty.
- **SpeedPerfect:** perfectly clean in up to 65% less time*.

Technical Data

Energy Efficiency Class:	C
Weighted energy consumption in kWh per 100 washing cycles of eco 40-60 programme:	66 kWh
Maximum capacity in kg:	9.0 kg
The water consumption of the eco programme in liters per cycle:	44 l
Duration of eco 40-60 programme in hours and mins at rated capacity:	3:37 h
Spin-drying efficiency class of eco 40-60 programme:	B
Airborne acoustical noise emission class:	A
Airborne acoustical noise emissions :	72 dB(A) re 1 pW
Built-in / Free-standing:	Free-standing
Height of removable worktop:	-5 mm
Dimensions of the product:	845 x 598 x 590 mm
Net weight:	73.0 kg
Connection rating:	2300 W
Fuse protection:	10 A
Voltage:	220-240 V
Frequency:	50 Hz
Length electrical supply cord:	210.0 cm
Door hinge:	Left
Wheels:	No
EAN code:	4242005210671
Installation typology:	Free-standing

Optional accessories

WMZ2200	Floor securing component
WMZ2381	Extension for cold water inlet /Aquastop
WMZPW20W	Platform with pull-out, washer, cubic



4 242005 210671

Series 6, washing machine, front loader, 9 kg, 1400 rpm WAU28PH9GB

The i-DOS washer with Intelligent Dosing System and with Home Connect, is the smartest washer, that does everything automatically to get perfect results every time.

Performance

- Energy Efficiency Class¹: C
- Energy² / Water³: 66 kWh / 44 litres
- Load capacity: 1 - 9 kg
- Programme duration⁴: 3:37 h:min
- Spin drying efficiency class: B
- Spin speed^{**}: 400 - 1400 rpm
- Noise level: 72 dB (A) re 1 pW
- Noise efficiency class: A

Programmes/functions

- Touch control buttons: Reduced Ironing option, soaking, Ready in, i-DOS 1, i-DOS 2, Child lock, Memory, Remote Start, Aqua Plus, Rinse hold, start/pause with reload function, Temperature selection, SpeedPerfect, Prewash, Spin speed reduction/Rinse Hold
- Standard programmes: cottons, easy care, delicates, wool hand wash
- Special programmes: Automatic Gentle, Drum clean with reminder, Shirts, Drain / Spin, Remote Program, Mixed Load, Single Rinse, Super Quick 15/30
- Programmes via Home Connect app: Stain - Blood, Stain - Butter/Oil, Stain - Grass, Stain - Red wine
- Sensor electronics with safeguard monitoring system that adjusts load and distribution and programme settings to protect clothes

Key features

- i-DOS: automatic dosing of liquid detergent and softener
- Home Connect: Remote Monitoring and Control
- SpeedPerfect: perfectly clean in up to 65% less time. ***
- Reload function / pause function
- EcoSilence drive with 10 year warranty
- AntiVibration Design - for more stability and quietness
- EcoBar Plus function: five possible levels of energy and water consumption

Additional features

- Large LED-Display for programme status indication, temperature selection, spin speed, remaining time and 24 hours end time delay, load recommendation and consumption indication
- Control dial with integrated On / Off mode
- VarioDrum: gentle and efficient washing
- Drum interior light
- Drum clean with reminder function
- Sound insulation by additional noise reduction material
- AquaStop: Bosch home appliance with lifetime warranty against water damage*
- Foam detection system

- Overdosage indication
- Child lock
- Acoustic signals: Buzzer

Technical Information

- Slide-under installation
- Large silver-white door with 171° opening and 32cm porthole opening
- Drum volume: 63 litres
- Dimensions (H x W): 84.5 cm x 59.8 cm
- Appliance depth: 59.0 cm
- Appliance depth incl. door: 63.3 cm
- Appliance depth with open door: 106.3 cm

¹ Scale of Energy Efficiency Classes from A to G

² Energy consumption in kWh per 100 cycles (in programme Eco 40-60)

³ Weighted water consumption in litres per cycle (in programme Eco 40-60)

⁴ Duration of Eco 40-60 programme

^{**} Values are rounded.

* Please find warranty terms under: BSHM_BMRK_BL

*** Comparison between the program duration of Easy-care 40°C and the program duration of Easy-care 40°C + activated Speed option

**Series 6, washing machine, front
loader, 9 kg, 1400 rpm
WAU28PH9GB**

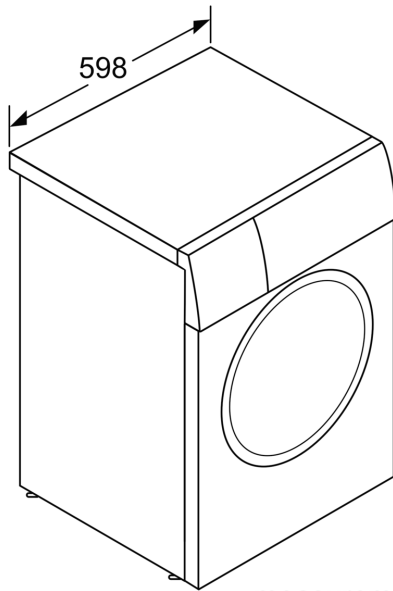

measurements in mm

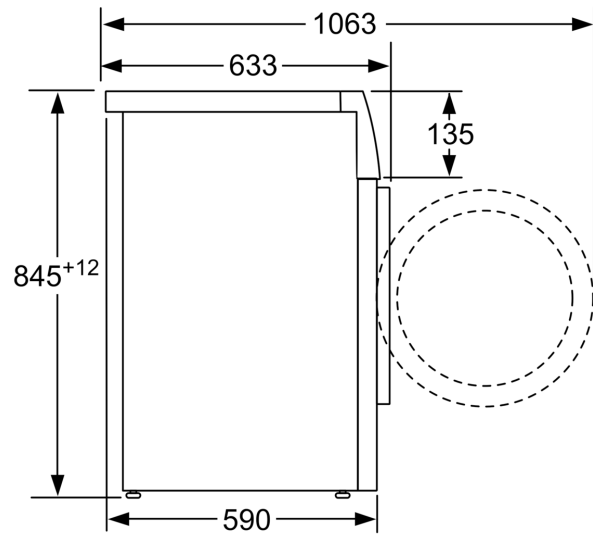

measurements in mm