

## Series 8, Built-in oven with added steam function, 60 x 60 cm, Black HRG7764B1B

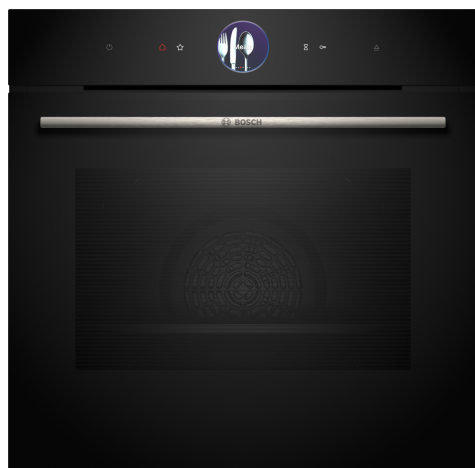

A<sup>+</sup>



### Included accessories

2 x combination grid, 1 x universal pan

### Optional accessories

HEZ327000 Pizza stone, HEZ32WA00 Wireless food thermometer, HEZ531010 Baking tray, non-stick ceramic coated, HEZ532010 Universal pan, non-stick ceramic coated, HEZ617000 Pizza pan, enamelled, HEZ629070 Air Fry & Grill tray, HEZ631070 Baking tray, enamelled, HEZ632070 Multipurpose pan, enamelled, HEZ633001 Lid for professional pan, enamelled, HEZ633070 Professional pan, enamelled, HEZ633073 Professional pan, enamelled, HEZ634000 Baking and roasting grid (standard), HEZ635001 AirFry & Grill Set, HEZ636000 Glass pan, HEZ638070 Full ext rails, level independent, pyro, HEZ660060 Strip, HEZ664000 Baking and roasting grid (steam), HEZ915003 Glass roasting dish, 5,4 L

**The built-in added steam oven with Digital Control Ring and TFT-touchdisplay. Assist function for meals: automatically prepares your dishes so they're crispy and juicy, PerfectRoast Plus, PerfectBake Plus, Home Connect for control via the App.**

- **Digital Control Ring:** simple and intuitive oven control.
- **TFT Touch Display Plus:** intuitive control with the Digital Control Ring and enlarged TFT touchscreen
- **Automatic Switch-off:** stops cooking as soon as the dish is done.
- **Pyrolytic self-cleaning:** automatic oven cleaning, with wipe-away ash.
- **Added Steam Function:** keep food crispy on the outside and juicy on the inside.

### Technical Data

Built-in / Free-standing: ..... Built-in  
Integrated Cleaning system: ..... Pyrolytic+Hydrolytic  
Min. required niche size for installation (HxWxD): 585-595 x 560-568 x 550 mm  
Dimensions: ..... 595 x 594 x 548 mm  
Dimensions of the packed product (HxWxD): ..... 675 x 660 x 690 mm  
Control Panel Material: ..... Glass  
Door Material: ..... Glass  
Net weight: ..... 40.6 kg  
Usable volume (of cavity) - cavity 1: ..... 71 l  
Cooking method: ..... reheating with steam, 4D Hotair, Defrost, Air fry, Full width grill, Hotair gentle, Half width grill, Conventional heat, Conventional heat gentle, Pizza setting, low temperature cooking, Bottom heat, Hot air grilling, pre-heating, warming  
Oven control: ..... electronic  
Number of interior lights: ..... 1  
Length electrical supply cord: ..... 120.0 cm  
EAN code: ..... 4242005327102  
Number of cavities (2010/30/EC): ..... 1  
Energy efficiency rating: ..... A<sup>+</sup>  
Energy consumption per cycle conventional (2010/30/EC): ..... 0.87 kWh/cycle  
Energy consumption per cycle forced air convection (2010/30/EC): ..... 0.69 kWh/cycle  
Energy efficiency index (2010/30/EC): ..... 81.2 %  
Connection rating: ..... 3600 W  
Fuse protection: ..... 16 A  
Voltage: ..... 220-240 V  
Frequency: ..... 50; 60 Hz  
Plug type: ..... no plug (electrical connection by electrician)  
Included accessories: ..... 2 x combination grid, 1 x universal pan



4 242005 327102

## **Series 8, Built-in oven with added steam function, 60 x 60 cm, Black HRG7764B1B**

**The built-in added steam oven with Digital Control Ring and TFT-touchdisplay. Assist function for meals: automatically prepares your dishes so they're crispy and juicy, PerfectRoast Plus, PerfectBake Plus, Home Connect for control via the App.**

### **Features**

- Oven with 20 heating methods: conventional top and bottom heat, full width variable grill, half width grill, bottom heat, low temperature cooking, defrost, plate warming, keep warm, Conventional heat gentle, reheating with steam, Dough proving, Hot air grilling, warming, 4D Hot air, Conventional heat
- Temperature range 30 °C - 275 °C
- Cavity volume: 71 litre capacity

### **Level independent telescopic rails**

- 5 shelf positions
- Available as an additional accessory, pyrolitic proof

### **Design**

- Touch controls
- Digital Control Ring
- Cavity inner surface: enamel anthracite

### **Cleaning**

- Pyrolytic self-cleaning function
- hydrolyse program
- Full glass inner door

### **Programmes/functions**

- Oven Assistant with Voice Control
- BE62
- Electronic clock timer
- Digital temperature display with proposal
- Actual temperature display Heating-up indicator meat probe
- Drop down door, SoftClose, SoftOpen
- BoschAssist
- Fast pre-heating function
- steam boost - add for 3min intensive steam with a touch of a button.
- There are different steam intensities selectable: steam level high, steam level middle, steam level low
- LED light, Light on/off when oven door opened/closed
- Water tank empty indicator
- Location of water tank: Outside cavity
- Integral cooling fan
- Home Connect ready

### **Accessories**

- 2 x combination grid, 1 x universal pan

### **Features**

- Maximum window temperature 30° C
- Low door temperature during pyrolitic cleaning
- Quadruple glazed door with heat reflective glass glazed CoolTouch door
- Electronic door lock
- Control panel lock Automatic safety switch off Residual heat indicator Start button Door contact switch

### **Technical information**

- 120 cm Cable length
- Nominal voltage: 220 - 240 V
- Total connected load electric: 3.6 KW
- Energy efficiency rating (acc. EU Nr. 65/2014): A+
- Energy consumption per cycle in conventional mode: 0.87 kWh

**Series 8, Built-in oven with added steam function, 60 x 60 cm, Black HRG7764B1B**

Installing the  
other  
Air exchan

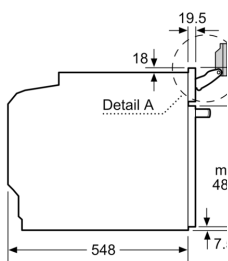

Note the pivoting range of the fast

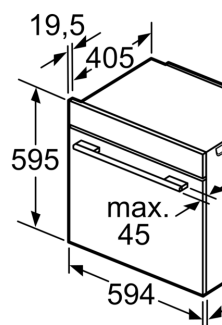

Space for appliance connection 320

If the appliance is used as a hob, the following dimensions (including substrate) must be taken in

**Hob type**

- Induction hob
- Full surface Induction hob
- Gas hob
- Electric hob

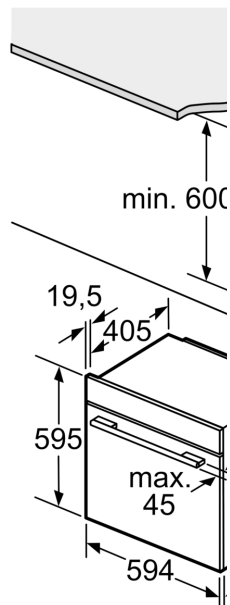

A: Air inlet