

## Series 4, Heat pump tumble dryer, 8 kg WTH84001GB



- **Auto Dry:** Automatically senses when your load is dried.
- **Easy Clean with A+:** efficient drying with easy maintenance.
- **Anti-Vibration Design:** extremely stable vibration protection ensures a smooth operation.
- **A dryer that respects the environment, thanks to the cooling agent.**
- **LED Display with touch button:** delay the start or end time of your drying cycle by up to 24 hours.

Built-in / Free-standing: .....	Freestanding
Removable top: .....	No
Door hinge: .....	Right
Length electrical supply cord: .....	179.5 cm
Dimensions: .....	842x598x613 mm
Net weight: .....	46.8 kg
Fluorinated greenhouse gases: .....	No
Hermetically sealed equipment: .....	Yes
EAN code: .....	4242005393800
Connection rating: .....	600 W
Fuse protection: .....	10 A
Voltage: .....	220-240 V
Frequency: .....	50 Hz
Loading capacity: .....	8.0 kg
Energy efficiency rating: .....	A+
Energy consumption electric dryer, full load - NEW (2010/30/EC):	2.18 kWh
Standard cotton programme time at full load: .....	226 min
Energy consumption electric dryer, partial load - NEW (2010/30/EC):	1.28 kWh
Standard cotton programme time at partial load: .....	137 min
Weighted annual energy consumption, electric dryer - NEW (2010/30/EC):	270.0 kWh/annum
Weighted programme time: .....	175 min
Average condensation efficiency full load (%): .....	81 %
Average condensation efficiency partial load (%): .....	81 %
Weighted condensation efficiency (%): .....	81 %

WMZ20600	Wool in basket - accessory
WTZ11400	Stacking kit with pull-out shelf
WTZ20410	Stacking kit
WTZPW20D	Platform with pull-out, dryer, cubic



## Series 4, Heat pump tumble dryer, 8 kg WTH84001GB

### Performance

- Energy Efficiency Class<sup>1</sup>: A+
- Energy<sup>2</sup>: 270 kWh
- Capacity: 1 - 8 kg
- Programme time<sup>3</sup>: 226 min
- Noise level: 65 dB (A) re 1 pW
- Condensation efficiency class<sup>4</sup>: B
- Condensation efficiency<sup>5</sup>: 81 %

### Programmes/functions

- Standard programmes: cotton, easy care
- Special programmes: Mixed Load, Towels, Time prog. 30 min. cold, Time prog. 30 min. warm, Sportswear, Down, Super Quick 40, Shirts/blouses

### Key features

- Anti crease cycle 120 min at the end of the programme
- Touch control buttons: start/pause, Reduced ironing, fine-tuning for drying level, 24 h, end Time Delay

### Additional features

- EasyClean filter
- Fully electronic control dial for sensor programmes and timed programmes
- Fully electronic control dial for sensor drying, including timed and special programmes
- LED Display for remaining time and 24 hours time delay, programme status indication, special functions
- Sensitive drying: large stainless steel drum with textile care and revolution drying system
- AntiVibration design: for greater stability and quietness
- No
- Container for condensed water
- Full container tank indicator
- Warning for fluff filter and condensed water container
- no
- Child lock
- Buzzer to indicate the end of cycle
- P-door Plastic, white
- pull-open latch
- Door hinge: right-hand
- Metal door catch

### Technical Information

- slide-under installation
- Dimensions (H x W): 84.2 cm x 59.8 cm
- Appliance depth: 61.3 cm
- Appliance depth incl. door: 65.1 cm
- Appliance depth with open door: 108.3 cm
- Heat pump technology with climate friendly cooling agent

<sup>3</sup> Programme time of the standard cotton programme at full load

<sup>4</sup> On a condensation efficiency class scale from A to G

<sup>5</sup> Weighted condensation efficiency for the standard cotton programme at full and partial load

<sup>1</sup> At a range of energy efficiency classes from A+++ to D

<sup>2</sup> Energy consumption kWh per year, based on 160 drying cycles of the standard cotton programme at full and partial load, and the consumption of the low power modes

**Series 4, Heat pump tumble dryer, 8 kg**  
**WTH84001GB**

Measurements in mm

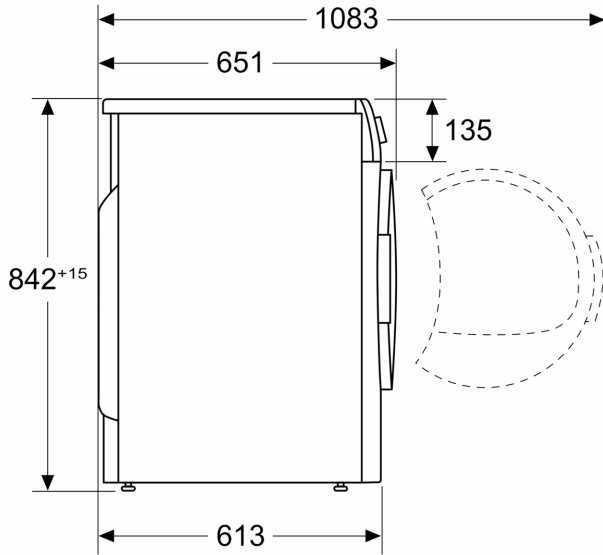

Measurements in mm

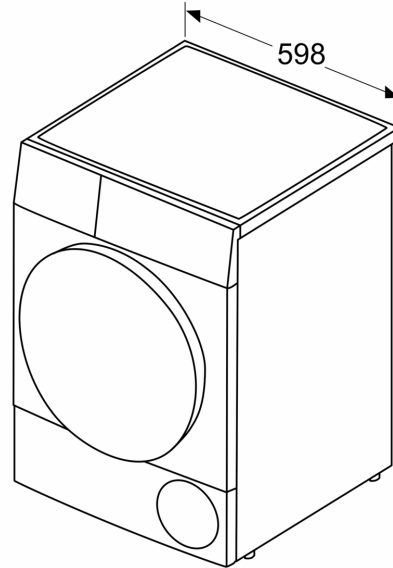

Measurements in mm

