

## Series 6, Heat pump tumble dryer, 9 kg, Cast iron grey WQG245R2GB



**The heat pump dryer with A+++ and Self-Cleaning condenser saves energy and its AutoDry sensor knows when your load is ready, protecting your garments.**

- **A+++ rated:** Discover our highly efficient dryer
- **Self-Cleaning Condenser:** Automatic fluff-cleaning condenser.
- **Super Quick 40:** Fast drying for smaller loads
- **Bed linen programme with reversing drum:** No more tangling.
- **Auto Dry:** Automatically senses when your load is dried.

### Technical Data

|   |                      |
|---|----------------------|
| Removable top:  | ..... No             |
| Built-in / Free-standing:   | ..... Freestanding   |
| Door hinge:   | ..... Right          |
| Length electrical supply cord:                                      | ..... 180 cm         |
| Dimensions:   | ..... 842x598x613 mm |
| Net weight:   | ..... 54.6 kg        |
| Fluorinated greenhouse gases:                                       | ..... R290           |
| Hermetically sealed equipment:                                      | ..... Yes            |
| EAN code:   | ..... 4242005555901  |
| Connection rating:  | ..... 600 W          |
| Fuse protection:  | ..... 10 A           |
| Voltage:  | ..... 220-240 V      |
| Frequency:  | ..... 50 Hz          |
| Loading capacity:   | ..... 9.0 kg         |
| Energy efficiency rating:   | ..... A+++           |
| Energy consumption electric dryer, full load - NEW (2010/30/EC):    | ..... 1.60 kWh       |
| Energy consumption electric dryer, partial load - NEW (2010/30/EC): | ..... 0.89 kWh       |
| Condensation efficiency class - NEW (2010/30/EC):                   | ..... A              |
| Average condensation efficiency full load (%):                      | ..... 88 %           |
| Average condensation efficiency partial load (%):                   | ..... 88 %           |

### Optional accessories

|          |                                      |
|----------|--------------------------------------|
| WMZ20600 | Wool in basket - accessory           |
| WTZ1110  | Condenser drainage kit               |
| WTZ2741C | Stacking kit                         |
| WTZPW40D | Platform with pull-out, dryer, cubic |



4 242005 555901

## Series 6, Heat pump tumble dryer, 9 kg, Cast iron grey WQG245R2GB

**The heat pump dryer with A+++ and SelfCleaning condenser saves energy and its AutoDry sensor knows when your load is ready, protecting your garments.**

### Performance

- Energy Efficiency Class<sup>1</sup>: A+++
- Energy<sup>2</sup>: 193 kWh
- Capacity: 1 - 9 kg
- Programme time<sup>3</sup>: 195 min
- Noise level: 61 dB (A) re 1 pW
- Condensation efficiency class<sup>4</sup>: B
- Condensation efficiency<sup>5</sup>: 88 %

### Programmes/functions

- Standard programmes: cotton, easy care
- Bed Linen Program: reduces tangling of big items thanks to reversible drum
- Special programmes: Cottons, Shirts/blouses, Cotton Eco, Down, Delicates, Towels, Mixed Load, Super Quick 40, Sportswear, Easy-Care, Woollens, Timed programme warm

### Key features

- Anti crease cycle 120 min at the end of the programme
- Half Load option: optimises drying for smaller loads
- Touch control buttons: Iron dry, Cupboard dry, Cupboard dry+, end Time Delay, Reduced ironing, Low heat, Buzzer, Start / Reload / Pause, 24 h end Time Delay

### Additional features

- SC1R
- Speed
- Fully electronic control dial for sensor programmes and timed programmes
- Large LED display for remaining time and 24 hours time delay, programme progress indication and special functions
- Load recommendation
- Usage meter: counts completed programmes
- Soft dial
- Sensitive drying: large stainless steel drum with textile care and revolution drying system
- AntiVibration design: for greater stability and quietness
- No
- Drum interior light
- Container for condensed water
- Child lock
- Buzzer to indicate the end of cycle
- NewValue door with cover glass, silver-black grey
- Door hinge: right-hand
- Metal door catch

### Technical Information

- slide-under installation
- Dimensions (H x W): 84.2 cm x 59.8 cm

- Appliance depth: 61.3 cm
- Appliance depth incl. door: 64.8 cm
- Appliance depth with open door: 109.6 cm
- Heat pump technology with climate friendly cooling agent

<sup>1</sup> At a range of energy efficiency classes from A+++ to D

<sup>2</sup> Energy consumption kWh per year, based on 160 drying cycles of the standard cotton programme at full and partial load, and the consumption of the low power modes

<sup>3</sup> Programme time of the standard cotton programme at full load

<sup>4</sup> On a condensation efficiency class scale from A to G

<sup>5</sup> Weighted condensation efficiency for the standard cotton programme at full and partial load

**Series 6, Heat pump tumble dryer, 9  
kg, Cast iron grey  
WQG245R2GB**

Measurements in mm

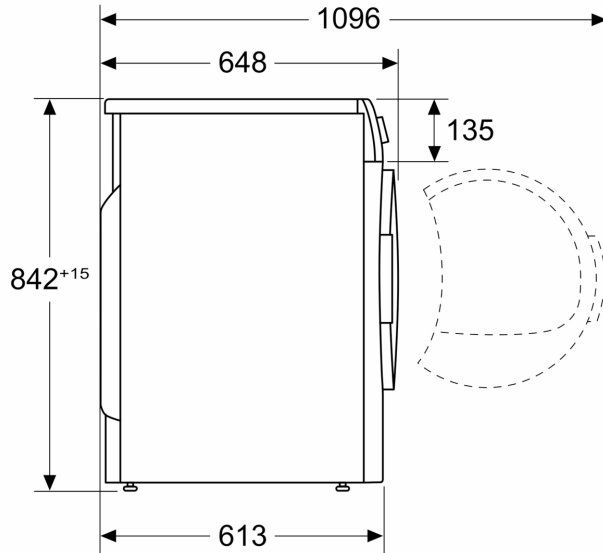

Measurements in mm

