

iQ500, Heat pump tumble dryer, 9 kg, Silver inox WQ46H2DXGB



The intelligent dryer for fast and gentle drying with resource saving A+++ -10%*, varioSpeed and intelligentDry powered by Home Connect.

- ✓ Energy label A+++ –10%. 10% more efficient than the limit value of energy efficiency class A+++.
- ✓ selfCleaning condenser: removes fluff to save you time and effort.
- ✓ Reversible drum – prevents large laundry items from tangling by alternating the drum rotation.
- ✓ varioSpeed: speed up the drying process by up to 40% at the click of a button.
- ✓ autoDry – gentle and precise drying that protects your clothes.

Features

Technical Data

Removable top: No
Built-in / Free-standing: Freestanding
Door opening:Right
Length electrical supply cord: 180 cm
Dimensions: 842x598x613 mm
Weight: 52.6 kg
Fluorinated greenhouse gases:R290
Hermetically sealed equipment:Yes
EAN code:4242003973141
Connection Rating: 800 W
Fuse protection:10 A
Nominal power:220-240 V
Frequency:50 Hz
Capacity:9.0 kg
Energy efficiency rating: A+++
Energy consumption electric dryer, full load - NEW (2010/30/EC):
1.44 kWh
Energy consumption electric dryer, partial load - NEW (2010/30/EC):
.....0.76 kWh
Average condensation efficiency full load (%): 90 %
Average condensation efficiency partial load (%): 91 %

Optional accessories

WZ20600	Wool in basket - accessory
WZ2750X	Stacking kit with pull-out shelf
WZ2751X	Stacking kit
WZDP40D	Platform with pull-out, dryer, cubic



iQ500, Heat pump tumble dryer, 9 kg, Silver inox WQ46H2DXGB

Features

Performance

- Energy Efficiency Class¹: A+++
- 10% more efficient than energy efficiency class A+++***
- Energy²: 171 kWh
- Capacity: 1 - 9 kg
- Programme time³: 265 min
- Noise level: 60 dB (A) re 1 pW
- Condensation efficiency class⁴: A
- Condensation efficiency⁵: 91 %

Programmes/functions

- Standard programmes: cotton, easy care
- Bed Linen Program: reduces tangling of big items thanks to reversible drum
- Programmes via app: Pillows, Woollens finish, Time program cold
- Special programmes: cotton, Cotton Eco, lingerie, towels, mixed fabrics, outdoor, rapid 40, easy-care, wool drying in basket, timed programme warm

Key features

- Home Connect: Remote Monitoring and Control, Energy Management, Remote Diagnostics, IntelligentDry, further programmes via download. Always keep your appliance up to date via firmware update.
- IntelligentDry: Perfect drying programme based on last washing cycle
- varioSpeed: Speed up drying in selected programs
- Half Load option: optimises drying for smaller loads
- Anti crease cycle 120 min at the end of the programme
- Touch control buttons: end time delay, less ironing, child lock 3 sec., Power button, remote start, low heat, Start / Reload / Pause, speedPerfect, drying level, 24 h end time delay

Additional features

- SC1R
- Elegantly designed inclined panel for intuitive control
- Large LED display for remaining time and 24 hours time delay, programme progress indication and special functions
- Load recommendation
- Fully electronic control dial for sensor and timed programmes
- Jog dial with integrated on/off control
- Sensitive drying: large softDry stainless steel drum system and revolution drying system
- AntiVibration design: for greater stability and quietness
- Wool drying basket
- Drum interior light
- Container for condensed water
- Child lock
- End of cycle buzzer
- Usage meter: counts completed programmes
- NewValue door with cover glass, black-chrome, black

- Metal door catch
- Slide-under installation
- Dimensions (H x W): 842 mm x 598 mm
- Appliance depth: 613 mm
- Appliance depth incl. door: 648 mm
- Appliance depth with open door: 1096 mm
- Heat pump technology with climate friendly cooling agent

¹ At a range of energy efficiency classes from A+++ to D

² Energy consumption kWh per year, based on 160 drying cycles of the standard cotton programme at full and partial load, and the consumption of the low power modes

³ Programme time of the standard cotton programme at full load

⁴ On a condensation efficiency class scale from A to G

⁵ Weighted condensation efficiency for the standard cotton programme at full and partial load

*** 10% more efficient (171 kWh/year) than the limit value (194kWh/year) of the energy efficiency class A+++ in category 9kg according to delegated EU-Regulation 392/2012

**iQ500, Heat pump tumble dryer, 9
kg, Silver inox
WQ46H2DXGB**

Dimensioned drawings

Measurements in mm

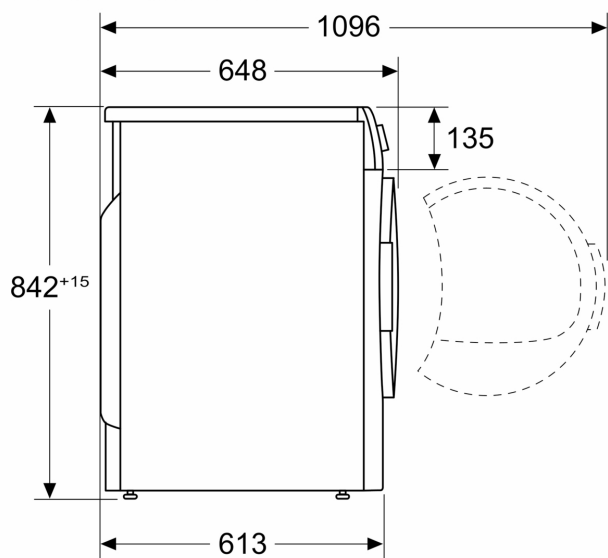

Measurements in mm

