

iQ700, Washing machine, front loader, 10 kg, 1600 rpm
WM16XGH4GB



Wifi-enabled washing machine with Home Connect: Remove the most stubborn 16 stains with the stainRemoval system and save time with the integrated speedPack.

- ✓ speedPack XL – Speed up programmes, set the duration or wash in just 15 minutes.
- ✓ Access and control your washing machine, no matter where you are - Home Connect App (Android and iOS)
- ✓ StainRemoval – Reliably removes 16 of the most stubborn types of stains.
- ✓ Highest level of easy handling combined with maximum functionality - TFT display multitouch
- ✓ Outdoor – Gentle cleaning for water-repellent fabrics, seams and membranes.

Features

Technical Data

Energy Efficiency Class:C
Weighted energy consumption in kWh per 100 washing cycles of eco 40-60 programme:67 kWh
Maximum capacity in kg: 10.0 kg
The water consumption of the eco programme in liters per cycle: 49 l
Duration of eco 40-60 programme in hours and mins at rated capacity: 3:55 h
Spin-drying efficiency class of eco 40-60 programme: A
Airborne acoustical noise emission class:A
Airborne acoustical noise emissions : 72 dB(A) re 1 pW
Design: Freestanding
Height of removable worktop: -2 mm
Dimensions of the product: 848 x 598 x 590 mm
Weight: 82.2 kg
Connection Rating: 2300 W
Fuse protection:10 A
Nominal power: 220-240 V
Frequency:50 Hz
Length of electrical supply cord: 210.0 cm
Door opening:Left
Wheels: No
Power consumption standby/network: Please check the user manual for how to switch off the WiFi module.: 1.5 W
Time auto-standby/network:5.0 min
EAN code:4242003886724
Installation type: Freestanding



Optional accessories

WX975600	Floor securing component
WZ10131	Extension for cold water inlet /Aquastop
WZWP20W	Platform with pull-out, washer, cubic

iQ700, Washing machine, front loader, 10 kg, 1600 rpm WM16XGH4GB

Features

Performance

- Energy Efficiency Class¹: C
- Energy² / Water³: 67 kWh / 49 litres
- Load capacity: 1 - 10 kg
- Programme duration⁴: 3:55 h:min
- Spin drying efficiency class: A
- Spin speed^{**}: 400 - 1600 rpm
- Noise level: 72 dB (A) re 1 pW
- Noise efficiency class: A

Programmes/functions

- TFT display: Clear text and high resolution for easy use with display of programme indication, temperature selection, spin speed, remaining time, 24 hour time delay and consumption indication
- Touch control buttons: basic settings, On/off, Ready in, stain selection, options, remote start, start/pause with reload function, temperature selection, varioSpeed, prewash, spin speed selection/Rinse Hold
- Standard programmes: cottons, easy care, delicates, wool hand wash
- Special programmes: hygiene, drain, drum clean with reminder, towels, shirts/blouses, Outdoor, easy care plus, PowerWash 59, Spin, mixed fabrics, single rinse, rapid 15 minute quick wash
- Options: extra rinse cycles, less ironing, Soaking, auto stain (16 options), night wash, speedPerfect, Rinse hold, prewash, waterPlus

Key features

- Home Connect: Remote Monitoring and Control, Energy Management
- powerSpeed system: better washing results in less time
- autoStain removal system (ASR) with 16 stain options
- Consumption indicator: Information about water and energy consumption prior to start of programme
- iQdrive with 10 year warranty
- antiVibration Design - for more stability and quietness
- Sound insulation by additional noise reduction material
- Reload function: Pause the already running washing machine to add any forgotten items of laundry to the drum.

Additional features

- Jog dial with integrated on/off control
- waveDrum: for highly effective and extremely gentle laundry care
- drum interior light
- drum clean with reminder function
- Consump indicator energy+water, autoLoad Plus, autoStain removal system (ASR)
- Foam detection system
- Out of balance load adjustment
- Electronic child safety package
- Acoustic signals: Multi-tone
- Detergent dispensing: easy clean
- aquaStop: Siemens home appliance with lifetime warranty against water damage*

Technical Information

- Slide-under installation
- Large chrome-black door with 180° opening
- Drum volume: 70 litres
- Dimensions (H x W): 84.8 cm x 59.8 cm
- Appliance depth: 59.0 cm
- Appliance depth incl. door: 63.2 cm
- Appliance depth with open door: 108.5 cm

¹ Scale of Energy Efficiency Classes from A to G

² Energy consumption in kWh per 100 cycles (in programme Eco 40-60)

³ Weighted water consumption in litres per cycle (in programme Eco 40-60)

⁴ Duration of Eco 40-60 programme

** Values are rounded.

* Please find warranty terms under the additional warranties section of our website.

**iQ700, Washing machine, front loader, 10 kg, 1600 rpm
WM16XGH4GB**

Dimensioned drawings

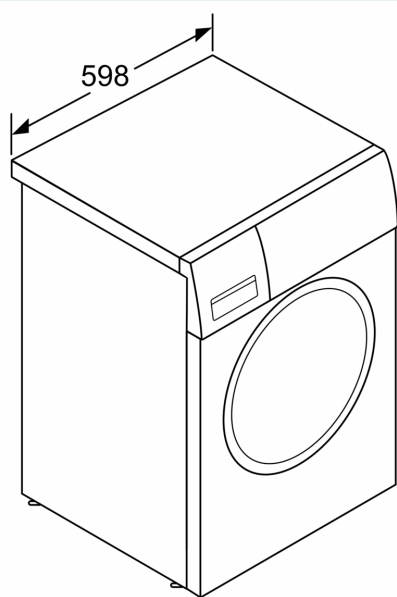

measurements in mm

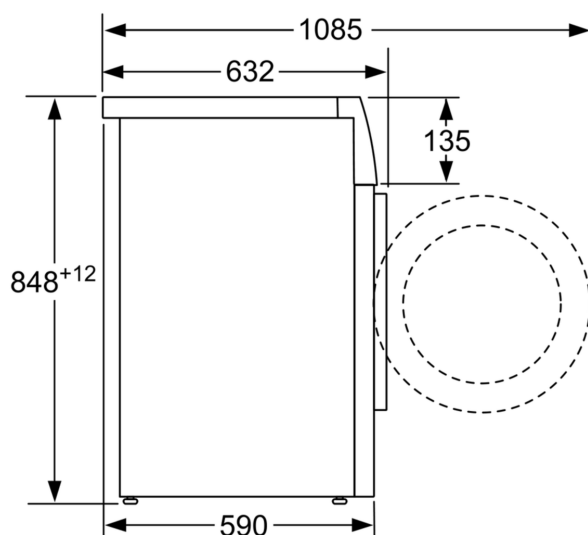

measurements in mm