

iQ500, Washing machine, front loader, 9 kg, 1400 rpm
WM14VMH4GB



Wifi-enabled washing machine with Home Connect: Save time with the integrated speedPack and remove the most stubborn 4 stains with stainRemoval system.

- ✓ speedPack XL: speed up your wash or use one of the fixed preset speed programmes.
- ✓ Home Connect app (Android and iOS): access and control your washing machine, wherever you are.
- ✓ Remote control: manage your wash with your mobile device.
- ✓ Push notifications: know what your machine needs with the Home Connect app.
- ✓ Voice control: your washing machine does exactly what you say.

Features

Technical Data

Energy Efficiency Class:A
Weighted energy consumption in kWh per 100 washing cycles of eco 40-60 programme:48 kWh
Maximum capacity in kg:9.0 kg
The water consumption of the eco programme in liters per cycle: 48 l
Duration of eco 40-60 programme in hours and mins at rated capacity:3:44 h
Spin-drying efficiency class of eco 40-60 programme: B
Airborne acoustical noise emission class:A
Airborne acoustical noise emissions : 69 dB(A) re 1 pW
Built-in / Free-standing: Freestanding
Dimensions of the product: 848 x 598 x 590 mm
Weight: 72.8 kg
Connection Rating: 2300 W
Fuse protection:10 A
Nominal power: 220-240 V
Frequency: 50 Hz
Length electrical supply cord: 210.0 cm
Door opening:Left
Wheels: No
EAN code:4242003899793
Installation type: Freestanding



Optional accessories

WX975600	Floor securing component
WZ10131	Extension for cold water inlet /Aquastop
WZWP20W	Platform with pull-out, washer, cubic

iQ500, Washing machine, front loader, 9 kg, 1400 rpm WM14VMH4GB

Features

Performance

- Energy Efficiency Class¹: A
- Energy² / Water³: 48 kWh / 48 litres
- Load capacity: 1 - 9 kg
- Programme duration⁴: 3:44 h:min
- Spin drying efficiency class: B
- Spin speed*: 400 - 1400 rpm
- Noise level: 69 dB (A) re 1 pW
- Noise efficiency class: A

Programmes/functions

- Standard programmes: cottons, easy care, delicates, wool hand wash
- Special programmes: hygiene, drum clean with reminder, shirts/blouses, Outdoor, drain / spin, PowerWash 59, mixed fabrics, single rinse, rapid 15 minute quick wash

Key features

- Home Connect: Remote Monitoring and Control, Remote diagnostics, Energy management
- autoStain removal system (ASR) - 4 stain removal options at the touch of a button
- Touch control buttons: less ironing, On/off, Ready in, stain selection, extra rinse, remote start, start/pause with reload function, temperature selection, varioSpeed, prewash, spin speed selection/Rinse Hold

Additional features

- Reload Function: Stop the washing machine to add any forgotten items of laundry to the drum.
- Large LCD display for programme status indication, temperature selection, max. spin speed, remaining time and 24 hours end time delay, stain selection and consumption indication
- powerSpeed system: better washing results in less time
- Drum volume: 65 litres
- drum interior light
- waveDrum: for highly effective and extremely gentle laundry care
- drum clean with reminder function
- Large chrome-black door with 171° opening
- Reload function: Pause the already running washing machine to add any forgotten items of laundry to the drum.
- iQdrive with 10 year warranty
- iQdrive with 10 year warranty
- waterPerfect Plus: for efficient use of water even with small loads thanks to intelligent sensor technology.
- Consump indicator energy+water, autoStain removal system (ASR)
- antiVibration Design - for more stability and quietness
- Sound insulation by additional noise reduction material
- Sound insulation by additional noise reduction material
- Aqua Protection
- Consumption indicator: Information about water and energy consumption prior to start of programme
- Jog dial with integrated on/off control

- Foam detection system
- Detergent over dosage display
- Out of balance load adjustment
- Electronic child safety package
- Acoustic signals: Buzzer
- Detergent dispensing: easy clean
- Divider for Liquid Detergent

Technical Information

- Slide-under installation
- Dimensions (H x W): 84.8 cm x 59.8 cm
- Appliance depth: 59.0 cm
- Appliance depth incl. door: 63.2 cm
- Appliance depth with open door: 106.3 cm

¹ Scale of Energy Efficiency Classes from A to G

² Energy consumption in kWh per 100 cycles (in programme Eco 40-60)

³ Weighted water consumption in litres per cycle (in programme Eco 40-60)

⁴ Duration of Eco 40-60 programme

** Values are rounded.

**iQ500, Washing machine, front loader, 9 kg, 1400 rpm
WM14VMH4GB**

Dimensioned drawings

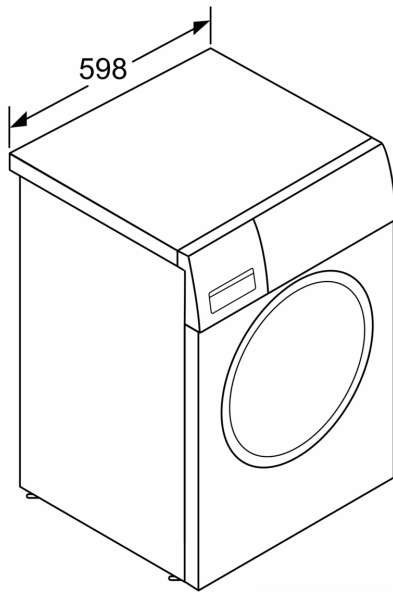

measurements in mm

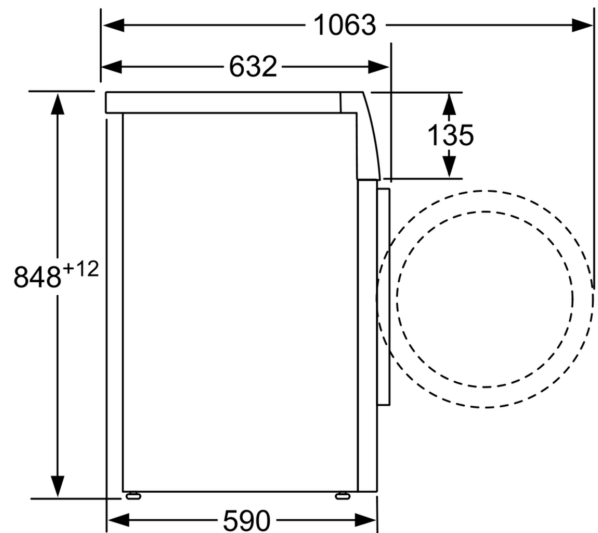

measurements in mm