

**iQ500, Washing machine, front loader, 9 kg, 1400 rpm
WM14UP89GB**



Optional accessories	
WX975600	Floor securing component
WZ10131	Extension for cold water inlet /Aquastop
WZWP20W	Platform with pull-out, washer, cubic

Wifi-enabled iSensonic Washing Machine with intelligent i-Dos automatic dosing system and multiTouch LED Display.

- ✓ i-Dos – Automatically doses the precise amount of detergent and water.
- ✓ speedPack L – Speed up your programmes, or wash in just 15 minutes.
- ✓ Home Connect app (Android and iOS): access and control your washing machine, wherever you are.
- ✓ Remote control: manage your wash with your mobile device.
- ✓ Push notifications: know what your machine needs with the Home Connect app.

Features

Technical Data	
Energy Efficiency Class:	A
Weighted energy consumption in kWh per 100 washing cycles of eco 40-60 programme:	46 kWh
Maximum capacity in kg:	9.0 kg
The water consumption of the eco programme in liters per cycle:	48 l
Duration of eco 40-60 programme in hours and mins at rated capacity:	3:48 h
Spin-drying efficiency class of eco 40-60 programme:	B
Airborne acoustical noise emission class:	A
Airborne acoustical noise emissions :	71 dB(A) re 1 pW
Built-in / Free-standing:	Freestanding
Dimensions of the product:	848 x 598 x 590 mm
Weight:	74.5 kg
Connection Rating:	2300 W
Fuse protection:	10 A
Nominal power:	220-240 V
Frequency:	50-60 Hz
Length electrical supply cord:	210.0 cm
Door opening:	Left
Wheels:	No
EAN code:	4242003908099
Installation type:	Freestanding



iQ500, Washing machine, front loader, 9 kg, 1400 rpm WM14UP89GB

Features

Performance

- Energy Efficiency Class¹: A
- Energy² / Water³: 46 kWh / 48 litres
- Load capacity: 1 - 9 kg
- Programme duration⁴: 3:48 h:min
- Spin drying efficiency class: B
- Spin speed^{**}: 400 - 1400 rpm
- Noise level: 71 dB (A) re 1 pW
- Noise efficiency class: A

Programmes/functions

- Touch control buttons: less ironing, soaking, Ready in, i-Dos 1, i-Dos 2, Child lock, Memory, remote start, Rinse plus +1+2+3, rinse hold, start/pause with reload function, temperature selection, varioSpeed, prewash, spin speed selection/Rinse Hold
- Standard programmes: cottons, easy care, delicates, wool hand wash
- Special programmes: automatic soft, drum clean with reminder, Outdoor, drain / spin, Remote Program, mixed fabrics, single rinse, rapid 15 minute quick wash, Hygiene
- Programmes via Home Connect app: Stain - Blood, Stain - Butter/Oil, Stain - Grass, Stain - Red wine

Key features

- Home Connect: Remote Monitoring and Control
- varioSpeed: Up to 65% reduced washing cycle ***
- Reload Function: Stop the washing machine to add any forgotten items of laundry to the drum.
- i-Dos: automatic dosing of liquid detergent and softener
- antiVibration Design - for more stability and quietness
- iQdrive with 10 year warranty

Additional features

- Large LED-Display for programme status indication, temperature selection, spin speed, remaining time and 24 hours end time delay, load recommendation and consumption indication
- Drum volume: 65 litres
- drum interior light
- waveDrum: for highly effective and extremely gentle laundry care
- drum clean with reminder function
- hydroSensor monitors and controls rinse cycles
- waterPerfect Plus: for efficient use of water even with small loads thanks to intelligent sensor technology.
- Consump indicator energy+water
- Detergent dispensing: i-DOS 2.0
- Aqua Protection
- Consumption indicator: Information about water and energy consumption prior to start of programme
- Jog dial with integrated on/off control
- Foam detection system
- Detergent over dosage display
- Out of balance load adjustment

- Electronic child safety package
- Acoustic signals: Buzzer

Technical Information

- Slide-under installation
- Large silver-black grey door with 171° opening
- Dimensions (H x W): 84.8 cm x 59.8 cm
- Appliance depth: 59.0 cm
- Appliance depth incl. door: 63.3 cm
- Appliance depth with open door: 106.3 cm

¹ Scale of Energy Efficiency Classes from A to G

² Energy consumption in kWh per 100 cycles (in programme Eco 40-60)

³ Weighted water consumption in litres per cycle (in programme Eco 40-60)

⁴ Duration of Eco 40-60 programme

** Values are rounded.

*** Comparison between the program duration of Easy-care 40°C and the program duration of Easy-care 40°C + activated varioSpeed option

**iQ500, Washing machine, front loader, 9 kg, 1400 rpm
WM14UP89GB**

Dimensioned drawings

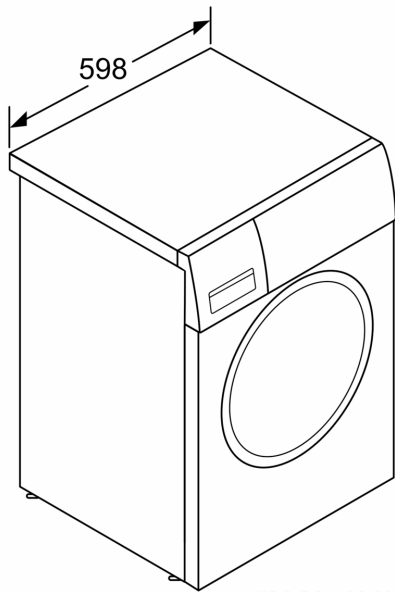

measurements in mm

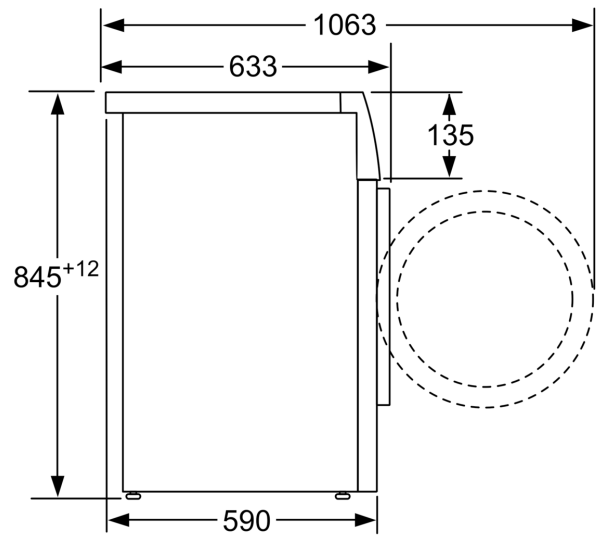

measurements in mm