

# Your dryer

**Congratulations** – you have chosen to buy a modern, high-quality Bosch domestic appliance. A distinctive feature of the condensation dryer with heat pump and automatic cleaning of the heat exchanger is its low energy consumption. Every dryer which leaves our factory is carefully checked to ensure that it functions correctly and is in perfect condition. Should you have any questions, our after-sales service will be pleased to help.

**Environmentally-responsible disposal** This appliance is labelled in accordance with European Directive 2012/19/EU concerning used electrical and electronic appliances (waste electrical and electronic equipment - WEEE). The guideline determines the framework for the return and recycling of used appliances as applicable throughout the EU.

For further information about our products, accessories, spare parts and services, please visit: [www.bosch-home.com](http://www.bosch-home.com)

Observe the safety instructions on Page 13.

You must read this instruction manual and the **Installation and maintenance instructions** before using the dryer. When installing the condensation drain, observe the separate **Instructions for condensation drain** (depending on the model)!

Contents	Page
Preparation	2
Control panel	2
Drying	3/4
Display panel and buttons	5
Notes on laundry	6
Overview of programmes	7
Important Information	8
Consumption rates	9
Normal noises	10
What to do if ... / After-sales service	11/12
Safety instructions	13

## Intended use

- For domestic use only.
- Only to be used for drying fabrics that have been washed with water.

**Keep children younger than 3 years old away from the dryer.** Do not let children make the cleaning and maintenance work on the dryer without supervision. Do not leave children unsupervised near the dryer. Keep pets away from the dryer. The dryer can be operated by children 8 years old and older, by persons with reduced physical, sensory or mental abilities and by persons with insufficient experience or knowledge if they are supervised or have been instructed in its use by a responsible adult. This appliance is intended for use up to a maximum height of 4000 metres above sea level.

## Programmes / Fabrics

Detailed overview of the programmes and fabrics → **Programme overview, Page 7**. Observe the care information on the care label. Dryness level, timer programming and options can be individually selected depending on the selected programme and the progress of the programme.

<b>Cottons</b>	Hard-wearing fabrics
<b>Easy Care</b>	Fabrics made from synthetic or blended fabrics
<b>Mixed Load</b>	A mixed load of fabrics made of cotton or synthetic fabrics
<b>Shoes in basket</b>	Shoes
<b>Wool in basket</b>	Hand or machine-washable fabrics made of wool or containing wool
<b>Timed program cold</b>	} All types of fabric except for wool and silk
<b>Timed program warm</b>	
<b>Shirts/Blouses</b>	Shirts and blouses made of cotton and blended fabrics
<b>Down Wear</b>	Fabrics with down filling
<b>Sportswear</b>	Functional clothing made of microfibre
<b>Super Quick 40'</b>	Synthetic fibres, light cotton or mixed fabrics
<b>Jeans</b>	Fabrics made from jeans/denim
<b>Blankets</b>	Large quilted fabrics containing synthetic fibres
<b>Towels</b>	Terry-towelling laundry e.g. towels and bathrobes

## Preparation

Never start the dryer if it is damaged. Inform your after-sales service.

Make sure your hands are dry. Hold the plug only.

Inspect the dryer

Connect the mains plug

Sort the laundry

Remove all items from pockets. Check for cigarette lighters. The drum must be empty prior to loading. See programme overview on page 7. See also separate instructions for "basket for woollens" (depending on the model).

The dryer is switched on and off by pressing the **On/Off** button in the centre of the programme selector. Select the programme by turning the outer ring on the programme selector (the selector can be turned in both directions). The selected programme is displayed.

Open the door/load the laundry/press the programme selector/set the programme

Close the door

Select the Start/Pause button

Remove the laundry and switch off the dryer

End of the programme ... Interrupt the programme

Drying

Further information can be found on Page 5

1  
2  
3

## Drying

**Empty the condensate container** If the condensation drain is installed, it is not necessary to empty the condensate container. → separate **Instructions for condensation drain**.

Empty the container **after each** drying cycle, and not during the cycle.

**Clean the fluff filters** Clean fluff filters reduce energy consumption.

**Remove the laundry and switch off the dryer**

**End of the programme ... Interrupt the programme**

**Empty the condensate container**

**Display panel and buttons**

**Information on laundry ...**

**Labeling of fabrics**

**Drying tips**

**Environmental protection / Energy-saving tips**

**Overview of Programmes**

**Sort the laundry according to type of textile and fabric.** Fabrics must be suitable for tumble drying. Dryness levels can be individually selected → **C/board dry extra**, **C/board dry** and **Iron dry** (depending on the model and programme). Degree of dryness can be finely adjusted (depending on the programme). Multi-layered fabrics require a longer drying time than single-layered items of clothing. Recommendation: Dry separately.

**Programmes**

**Max. Type of Fabric**

9608 / 90011100811

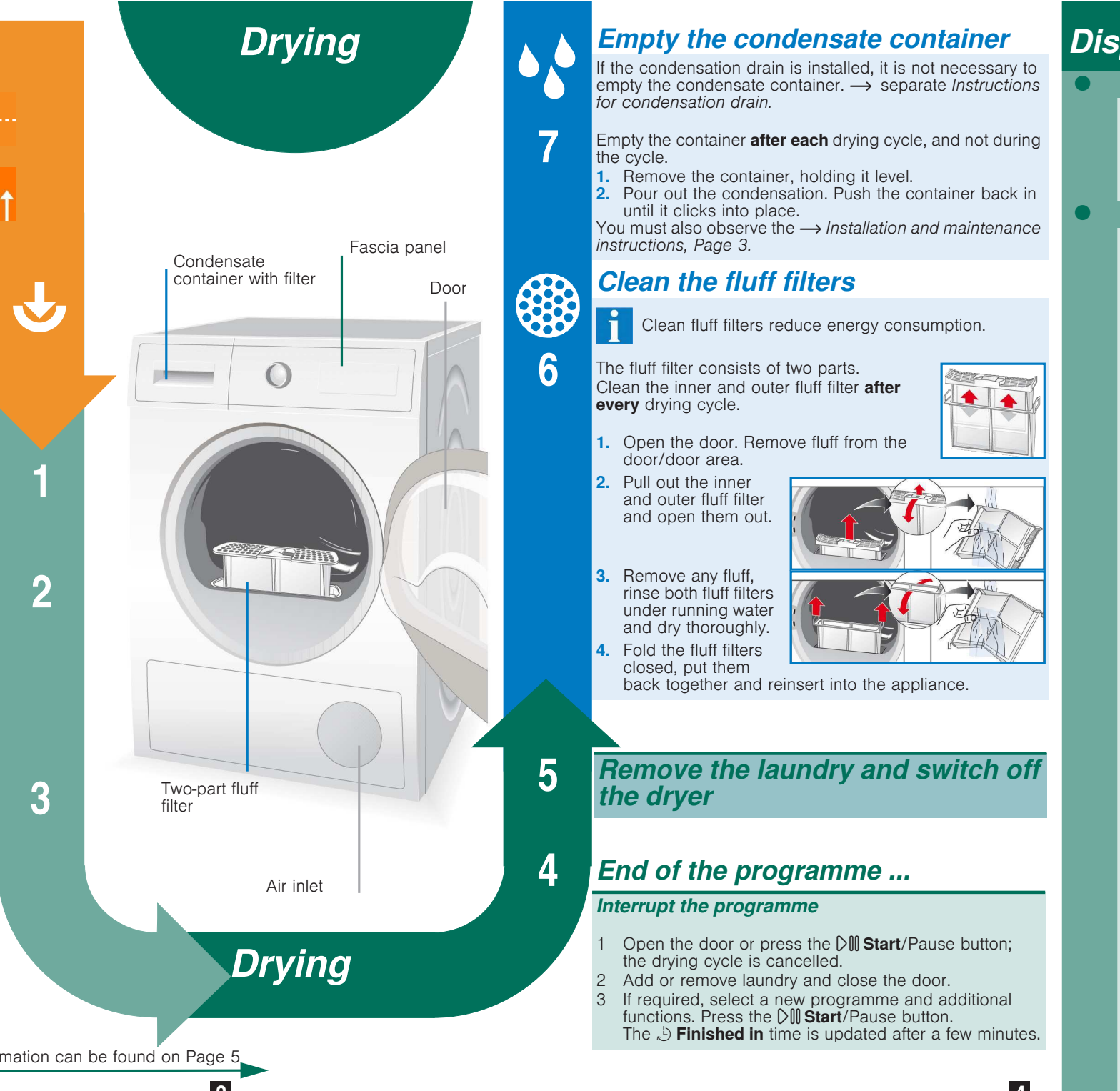

WYB8701AU  
81739 München/Deutschland

## Display panel and buttons

**Display panel**

**Please clean lint filter** Clean the fluff filters → Page 4.

**Please empty condensate container** Empty the condensate container → Page 4 and/or clean the filter in the condensate container → **Installation and maintenance instructions, Page 3**.

**Heat exchanger is being rinsed** Automatic cleaning of the heat exchanger. Do not empty the condensate container while this is displayed.

**Buttons**

**Drying target** Select the dryness level (e.g. Cupboard dry) or the drying time (20 mins up to 3 hrs: 30 mins, depending on the model and programme).

**Easy-Iron** After the programme finishes, the drum moves at regular intervals to prevent creases. Automatic reduced ironing function can be set in 30 mins intervals up to 120 mins. The standard setting for each programme is 60 mins.

**Finished in** When a programme is selected, the anticipated drying time for the maximum load is displayed. While drying, the moisture sensors detect the actual load and correct the programme length. This is shown in the display by jumps in the **Finished in** time. The **Finished in** time can be delayed in one-hour steps, up to a maximum of 24 hours. Press the **Finished in** button repeatedly until the required number of hours is displayed (h=hour).

**Options**

**Childlock:** Activate/Deactivate → start programme, press and hold the **Finished in** button above the display panel for 5 seconds.

**Spin speed;** **Adjust drying level;** **Low heat**

**Depending on the selected programme, it may not be possible to select individual options.**

**Spin speed:** The spin speed that was used for the spin in the washing machine → used exclusively to display the anticipated drying time ( **Finished in** time) more precisely.

**Adjust drying level:** The drying result (e.g. Cupboard dry) can be increased in three stages (+1 - max. +3); exception: Timer programme → default setting = 0. After one programme has been finely adjusted, the setting is retained for the others.

**Low heat:** Reduced temperature for delicate fabrics □, e.g. polyacrylic, polyamide or elastane, with a longer drying time.

For saving individual programme settings that are used frequently. Use the programme selector to select the required programme. Press and hold the **Memory 1/2** button for 3 sec. until the required programme has been saved. To select the saved programme, briefly press the **Memory 1/2** button. The programme that is called from **Memory 1** or **2** is displayed on the display panel.

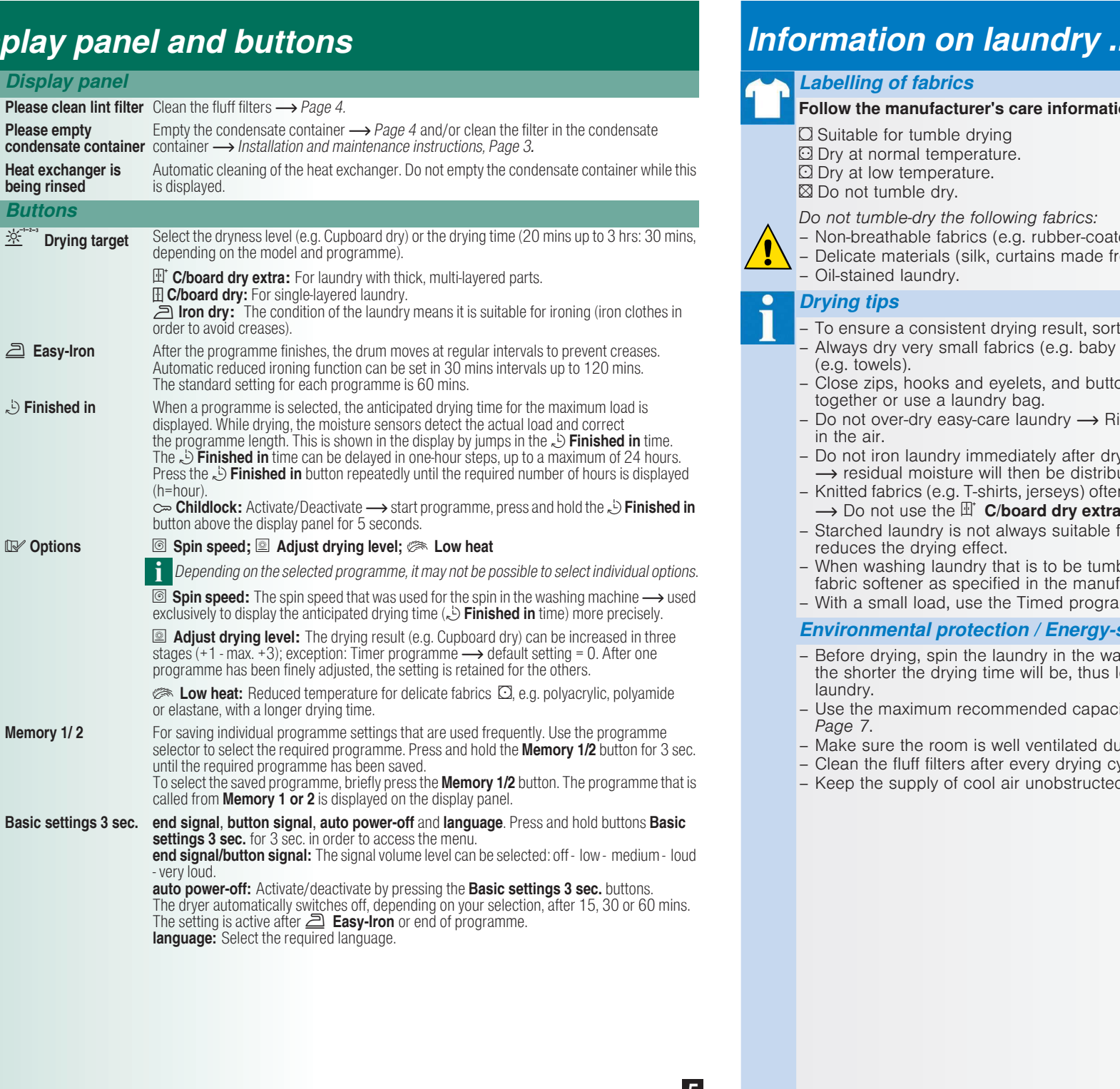

end signal, button signal, auto power-off and language. Press and hold buttons **Basic settings 3 sec.** for 3 sec. in order to access the menu. end signal/button signal: The signal volume level can be selected: off - low - medium - loud - very loud. auto power-off: Activate/deactivate by pressing the **Basic settings 3 sec.** buttons. The dryer automatically switches off, depending on your selection, after 15, 30 or 60 mins. The setting is active after **Easy-Iron** or end of programme. language: Select the required language.

## Information on laundry ...

**Labeling of fabrics**

**Follow the manufacturer's care information.**

Do not tumble-dry the following fabrics:

**Drying tips**

**Environmental protection / Energy-saving tips**

**Overview of Programmes**

**Sort the laundry according to type of textile and fabric.** Fabrics must be suitable for tumble drying. Dryness levels can be individually selected → **C/board dry extra**, **C/board dry** and **Iron dry** (depending on the model and programme). Degree of dryness can be finely adjusted (depending on the programme). Multi-layered fabrics require a longer drying time than single-layered items of clothing. Recommendation: Dry separately.

**Programmes**

**Max. Type of Fabric**

9608 / 90011100811

WYB8701AU  
81739 München/Deutschland

end signal, button signal, auto power-off and language. Press and hold buttons **Basic settings 3 sec.** for 3 sec. in order to access the menu. end signal/button signal: The signal volume level can be selected: off - low - medium - loud - very loud. auto power-off: Activate/deactivate by pressing the **Basic settings 3 sec.** buttons. The dryer automatically switches off, depending on your selection, after 15, 30 or 60 mins. The setting is active after **Easy-Iron** or end of programme. language: Select the required language.

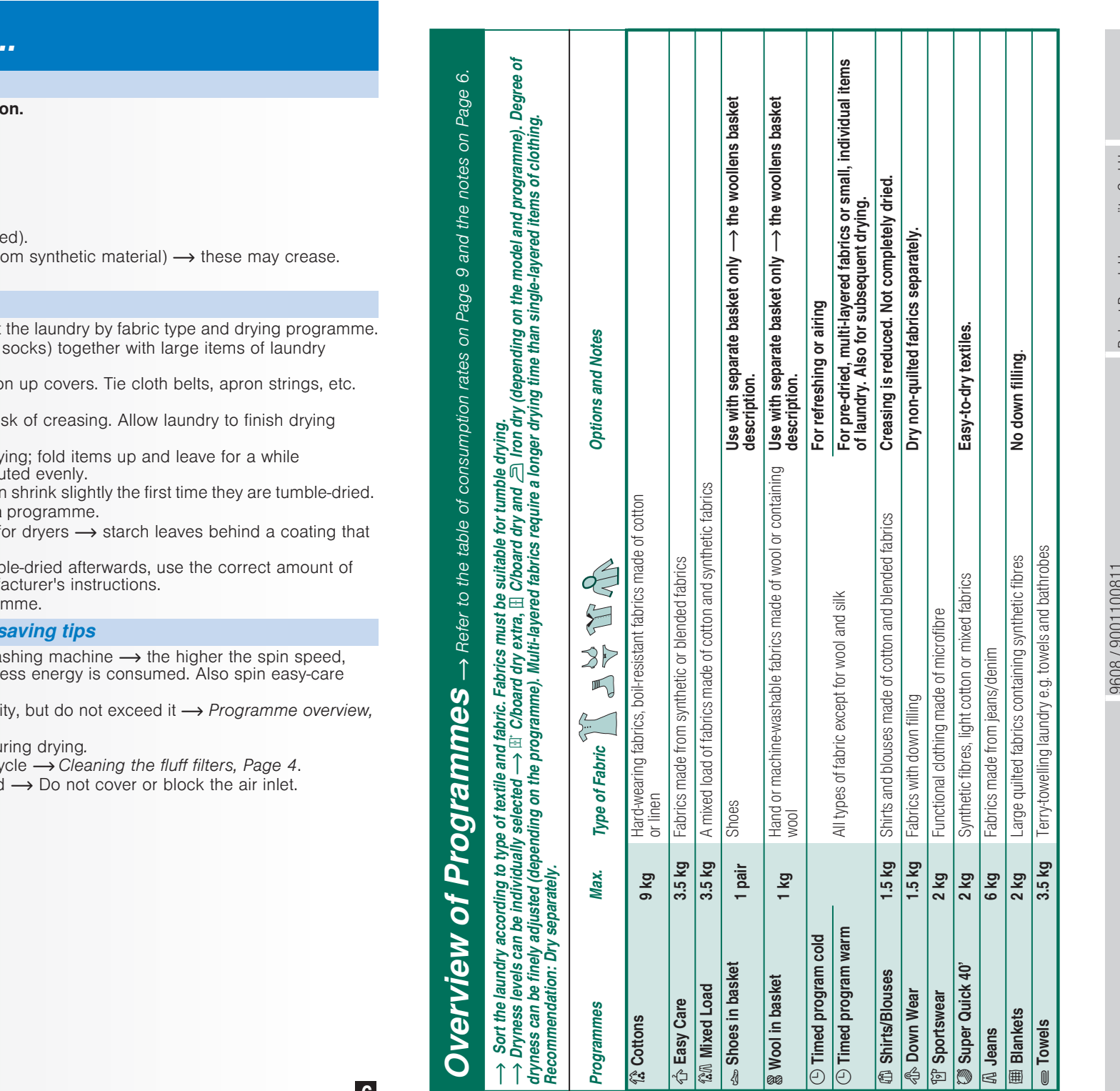

end signal, button signal, auto power-off and language. Press and hold buttons **Basic settings 3 sec.** for 3 sec. in order to access the menu. end signal/button signal: The signal volume level can be selected: off - low - medium - loud - very loud. auto power-off: Activate/deactivate by pressing the **Basic settings 3 sec.** buttons. The dryer automatically switches off, depending on your selection, after 15, 30 or 60 mins. The setting is active after **Easy-Iron** or end of programme. language: Select the required language.

## Important information...



Never operate the dryer without the fluff filters and without filter in condensate container!

### Fluff filters

During drying, fluff and hair from the laundry is trapped by the fluff filter. A blocked fluff filter may impair the heat exchange process.

The fluff filters must therefore be cleaned after every drying cycle.

Rinse regularly under running water → Page 4.

When cleaning the fluff filter, make sure that no foreign material (down, filling material) enters the air duct opening. If necessary, clean the drum beforehand with a vacuum cleaner. If foreign material should still enter the air duct → call the after-sales service.

### Filter in the condensate container

The filter in the condensate container cleans the condensation. This condensation is required for the automatic cleaning process. The filter should be cleaned regularly under running water. Empty the condensate container before cleaning the filter → *Installation and maintenance instructions*, Page 3.

### Fabrics

Do not dry any fabrics that have come into contact with solvents, oil, wax, grease or paint: e.g. hair styling products, nail varnish remover, stain remover, cleaning solvent, etc. Empty all pockets.

Do not dry non-breathable fabrics.

Avoid drying laundry items that produce a lot of fluff.

Woolens should be refreshed or dried using the woolens programme only.

## Consumption rates

Fabrics/programmes	Residual moisture in the fabrics after spinning		Drying time**	Energy consumption**
<b>👤 Cottons 9 kg</b>				
👤 C/board dry*	1400 rpm	50 %	133 min	1.72 kWh
	1000 rpm	60 %	157 min	2.13 kWh
	800 rpm	70 %	181 min	2.48 kWh
👤 Iron dry*	1400 rpm	50 %	98 min	1.22 kWh
	1000 rpm	60 %	123 min	1.62 kWh
	800 rpm	70 %	147 min	2.00 kWh
<b>👤 Easy Care 3.5 kg</b>				
👤 C/board dry*	800 rpm	40 %	46 min	0.52 kWh
	600 rpm	50 %	60 min	0.66 kWh

For testing in accordance with applicable standard EN61121 the dryer shall be used with external drain set.  
 \* Programme setting for testing in accordance with applicable standard EN61121.  
 \*\* The values may differ from those specified, depending on the type of fabric, composition of laundry to be dried, residual moisture in the fabric, the degree of dryness that has been set, the amount of laundry being loaded and the environmental conditions.

Fabrics/programmes	Drying time	Annual energy consumption
<b>👤 Cottons 9 kg / 4.5 kg*</b>		
👤 C/board dry***	157 min / per cycle	258 kWh / per year

\*\*\*Programme setting for testing and energy labelling in accordance with Directive 2010/30/EU.

## Normal noises

During drying, the compressor and the pump generate some noise which is entirely normal.

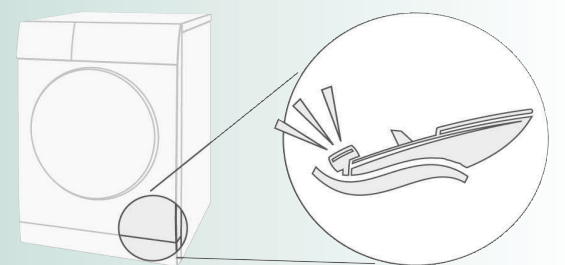

The compressor in the dryer may occasionally generate a humming noise. The volume and pitch of this may vary depending on the selected programmes and the progress of the drying.

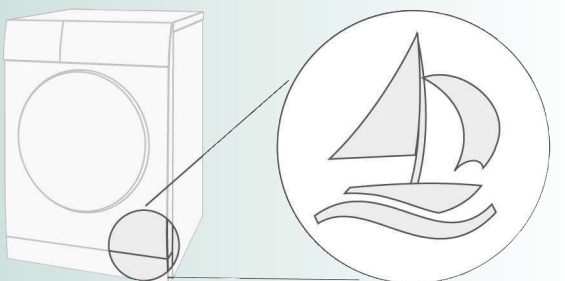

The compressor in the dryer is ventilated from time to time, which creates a whirring sound.

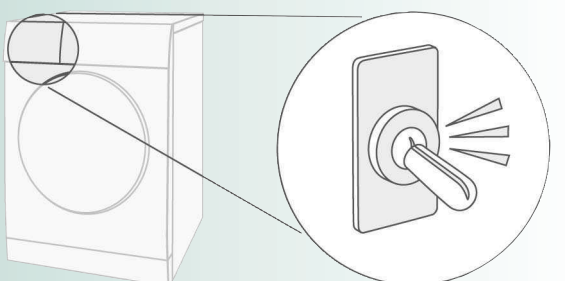

The automatic cleaning process causes a clicking noise.

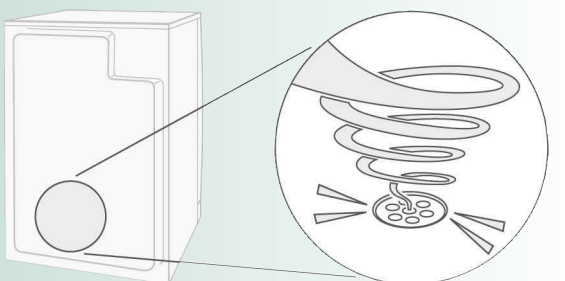

The process of pumping the condensation into the condensate container generates pumping noises.

## What to do if ...



If you cannot rectify a fault yourself (e.g. by switching the dryer off/on), please contact our after-sales service. We will always find an appropriate solution and will avoid unnecessary visits by engineers. Trust the expertise of the manufacturer and rest assured that the repair will be carried out by trained service technicians using original spare parts. The contact details of your local **after-sales service** can be found in the enclosed after-sales service directory:

– **GB** 0344 892 8979 (Calls charged at local or mobile rate.)  
 – **IE** 01450 2655 (0.03 € per minute at peak. Off peak 0.0088 € per minute.)  
 When contacting the after-sales service, please specify the product number (E-Nr.) and production number (FD) of your appliance(see inside of door).  
 Switch the dryer off using the programme selector and unplug the mains plug from the socket.

● **Please empty condensate container** is displayed. Emptying the condensate container → Page 4. Press any button. Press the **Start/Pause** button again.

● **Please empty condensate container** is displayed and the drying cycle is interrupted. Is the condensation drain installed? → Condensation drain hose blocked → check and clean the hose. Stopper in the condensate container? → separate *Instructions for condensation drain*.

● Is the filter in the condensate container dirty? → Clean the filter in the condensate container → *Installation and maintenance instructions*, Page 3.

● Residual water in the condensate container despite the dryer being connected to the condensation drain. Not a fault. If the condensation drain is installed, residual water remains in the condensate container due to the dryer's self-cleaning function.

● **Please clean lint filter** is displayed. Clean the fluff filters → Page 4. Press the **Start/Pause** button again.

● Dryer does not start. Has the **Start/Pause** button been pressed? Door closed? Ambient temperature greater than 5 °C? The optimum ambient temperature for drying is between 5 °C and 35 °C.

● Water is leaking out. Make sure the dryer is level. Push the condensate container back in until it locks fully into place.

## What to do if ...

● Laundry is not dried correctly or is still too damp. After the end of the programme, warm laundry feels damper than it actually is. Spread the laundry out and allow the heat to disperse.

Finely adjust the dryness level – this extends the drying time but does not increase the temperature. Your laundry will become drier.

Select a programme with a longer drying time or increase the drying level. This does not increase the temperature.

Select a time programme for extended drying of laundry that is still damp.

If you have exceeded the maximum load for the programme, the laundry may not be dried correctly.

Clean the moisture sensor in the drum. A fine layer of limescale may adversely affect the performance of the sensors and your washing will not dry properly.

Drying has been interrupted as a result of a power cut, because the condensate container is full or because the maximum drying time has been exceeded.

● Drying time too long. Clean the fluff filters under running water → Page 4.

Insufficient supply of air → Ensure that air can circulate.

Air inlet may be obstructed? Clear the inlet → *Installation and maintenance instructions*, Page 1.

Ambient temperature higher than 35 °C → Ventilate the room. The optimum ambient temperature for drying is between 5 °C and 35 °C. Outside of this range, the drying time may increase.

● The humidity in the room increases significantly. Make sure the room is sufficiently ventilated.

● **Heat exchanger is being rinsed** is displayed in the display panel. Not an error. Automatic cleaning of the heat exchanger. Do not empty the condensate container during the cleaning process.

● Power failure. Remove the laundry from the dryer immediately and spread out. This allows the heat to dissipate. Be careful as the door, the drum and the laundry may be hot.

● Other intermittent noises and vibrations. Normal noises → Page 10.

## Safety instructions



**EMERGENCY ONLY use the dryer...**

**The dryer must NEVER...**

**Hazards**

- Pull the appliance plug out of the socket immediately or disconnect the fuse.
- in rooms inside the house.
- to dry fabrics.
- be used for purposes other than those described above.
- be modified in terms of its technology or properties.
- The dryer must not be used by children or persons who have not been instructed in its use.
- Do not leave children unsupervised near the dryer.
- Keep pets away from the dryer.
- Remove all objects from pockets, and lighters in particular → **Risk of explosion**.
- Do not lean or sit on the door → **Risk of tipping**.
- Open the door carefully. Hot steam may escape. Fabrics and drum may be hot → **Risk of burns**.

**Installation**

- Secure loose leads or hoses, otherwise there is a **risk of tripping**.
- Below 0 °C there is a possibility of frost damage.

**Mains connection**

- Connect the dryer to an AC earthed socket according to specifications, otherwise it cannot be guaranteed that the appliance is completely safe.
- The cable cross-section must be sufficient.

- Only use earth-leakage circuit breakers with the following symbol:
- The appliance plug and socket must be compatible.
- Do not use multiple plugs/connectors and/or extension cables.
- Do not touch or hold the appliance plug with wet hands → **Risk of electric shock**.
- Never pull the appliance plug out of the socket by its cable.
- Do not damage the mains lead → **Risk of electric shock**.

**Operation**

- Only load the dryer as recommended in the programme descriptions (*Programmes/fabrics*, Page 1 and *Programme overview*, Page 7) . Check the contents before you switch the dryer on.
- Do not use the dryer if the laundry has been in contact with solvents, oil, wax, grease or paint (e.g. hair styling products, nail varnish remover, stain remover, cleaning solvent, etc.) → **Risk of fire/explosion**.
- The tumble dryer is not to be used if industrial chemicals have been used for cleaning.
- Dust (e.g. coal dust, flour) poses a danger: Do not use the dryer → **Risk of explosion**.
- Do not put laundry containing foam material/rubber in the dryer → elastic material may be destroyed and the dryer may be damaged due to possible deformation of the foam material.
- Do not turn off the dryer until the drying process ends, unless the laundry will be removed quickly and spread out, so that the heat can dissipate.
- Light things, such as long hair, may be sucked into the air inlet of the dryer → **Risk of injury**.
- Final part of a tumble dryer cycle occurs without heat (cool down cycle), to ensure that the items are left at a temperature that ensures that the items will not be damaged.
- Switch off the dryer once the programme has ended.
- The distilled water/water from condensation is not drinking water and may be contaminated with fluff.

**Defect**

- Do not use the dryer if it is defective or if you suspect that it is. Repairs must only be carried out by the after-sales service.
- Do not use the dryer if the mains cable is defective. To avoid danger, only have the defective mains cable replaced by the after-sales service.

**Spare parts**

- Only use genuine spare parts and accessories for safety reasons.

**Disposal**

- Dryer: Pull out the appliance plug, **then** cut off the mains cable from the appliance. Dispose of the appliance at a municipal waste disposal facility.
- Packaging: Keep all packaging out of reach of babies and children → **Risk of suffocation**.
- The dryer's heat exchanger contains fluorinated greenhouse gas (R407C) in a hermetically sealed unit → Dispose of this properly. Capacity: 0.290 kg. Total GWP: 0.514 tCO<sub>2</sub>.
- All materials are environmentally sound and can be reused. Dispose of in an environmentally-responsible manner.



Register your new Bosch now:  
[www.bosch-home.com/welcome](http://www.bosch-home.com/welcome)

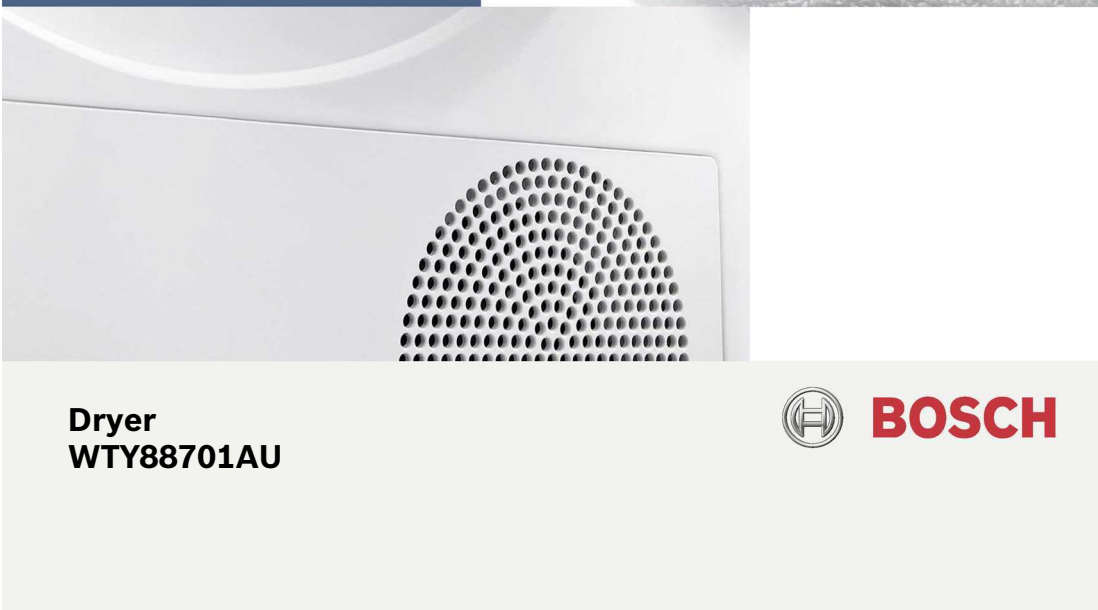

Dryer  
 WTY88701AU



en operating instructions

# Your dryer

**Congratulations** – you have chosen to buy a modern, high-quality Bosch domestic appliance.

A distinctive feature of the condensation dryer with heat pump and automatic cleaning of the heat exchanger is its low energy consumption.

Every dryer which leaves our factory is carefully checked to ensure that it functions correctly and is in perfect condition.

Should you have any questions, our after-sales service will be pleased to help.

## Environmentally-responsible disposal

This appliance is labelled in accordance with European Directive 2012/19/EU concerning used electrical and electronic appliances (waste electrical and electronic equipment - WEEE). The guideline determines the framework for the return and recycling of used appliances as applicable throughout the EU

For further information about our products, accessories, spare parts and services, please visit: [www.bosch-home.com](http://www.bosch-home.com)



Observe the safety instructions on Page 13.



You must read this instruction manual and the **Installation and maintenance instructions** before using the dryer. When installing the condensation drain, observe the separate **Instructions for condensation drain** (depending on the model)!

## Contents

	Page
■ Preparation	2
■ Control panel	2
■ Drying	3/4
■ Display panel and buttons	5
■ Notes on laundry	6
■ Overview of programmes	7
■ Important Information	8
■ Consumption rates	9
■ Normal noises	10
■ What to do if ... / After-sales service	11/12
■ Safety instructions	13

## Intended use

- For domestic use only.
- Only to be used for drying fabrics that have been washed with water.



Keep children younger than 3 years old away from the dryer.

Do not let children make the cleaning and maintenance work on the dryer without supervision. Do not leave children unsupervised near the dryer. Keep pets away from the dryer.

The dryer can be operated by children 8 years old and older, by persons with reduced physical, sensory or mental abilities and by persons with insufficient experience or knowledge if they are supervised or have been instructed in its use by a responsible adult.

This appliance is intended for use up to a maximum height of 4000 metres above sea level.

## Programmes / Fabrics

Detailed overview of the programmes and fabrics → *Programme overview, Page 7.*

Observe the care information on the care label. Dryness level, timer programming and options can be individually selected depending on the selected programme and the progress of the programme.

<b>Cottons</b>	Hard-wearing fabrics
<b>Easy Care</b>	Fabrics made from synthetic or blended fabrics
<b>Mixed Load</b>	A mixed load of fabrics made of cotton or synthetic fabrics
<b>Shoes in basket</b>	Shoes
<b>Wool in basket</b>	Hand or machine-washable fabrics made of wool or containing wool
<b>Timed program cold</b>	} All types of fabric except for wool and silk
<b>Timed program warm</b>	
<b>Shirts/Blouses</b>	Shirts and blouses made of cotton and blended fabrics
<b>Down Wear</b>	Fabrics with down filling
<b>Sportswear</b>	Functional clothing made of microfibre
<b>Super Quick 40'</b>	Synthetic fibres, light cotton or mixed fabrics
<b>Jeans</b>	Fabrics made from jeans/denim
<b>Blankets</b>	Large quilted fabrics containing synthetic fibres
<b>Towels</b>	Terry-towelling laundry e.g. towels and bathrobes

## Preparation

Installation → Installation and main



Never start  
Inform you

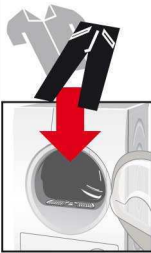

The dryer is switched on and off by pressing the **Ⓢ** button in the centre of the programme selector. Select the programme by turning the outer ring on the programme selector (the selector can be turned in both directions). The selected programme is displayed.

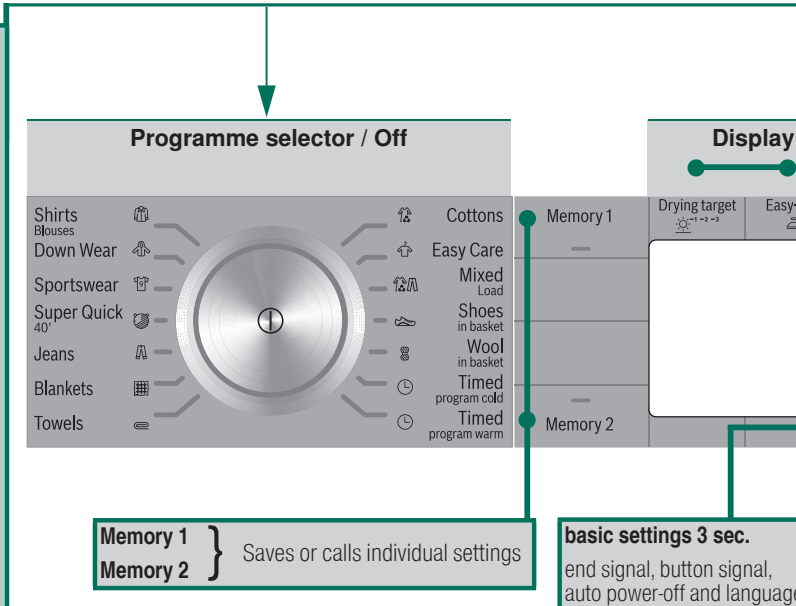

Do not touch the dryer if it is damaged. Contact your after-sales service.

Make sure your hands are dry. Hold the plug only.

**Inspect the dryer**

**Connect the mains plug**

**Sort the laundry**

Remove all items from pockets. Check for cigarette lighters. The drum must be empty prior to loading.

See programme overview on page 7. See also separate instructions for "basket for woollens" (depending on the model).

**Open the door/load the laundry/press the programme selector/set the programme**



**Close the door**

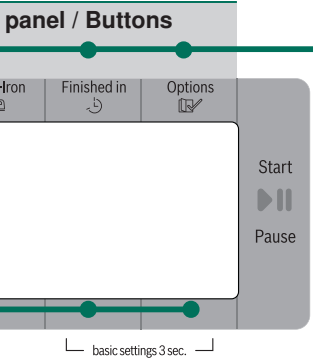

**Select the Start/Pause button**

**Change the functions in the display using the buttons**

☀️ Drying target C/board dry extra, C/board dry, Iron dry

👉 Easy-Iron Reduced ironing function can be set up to 120 minutes

🕒 Finished in Time delay/Childlock

⚙️ Options Spin speed, Adjust drying level, Low heat

Further information can be found on Page 5

# Drying

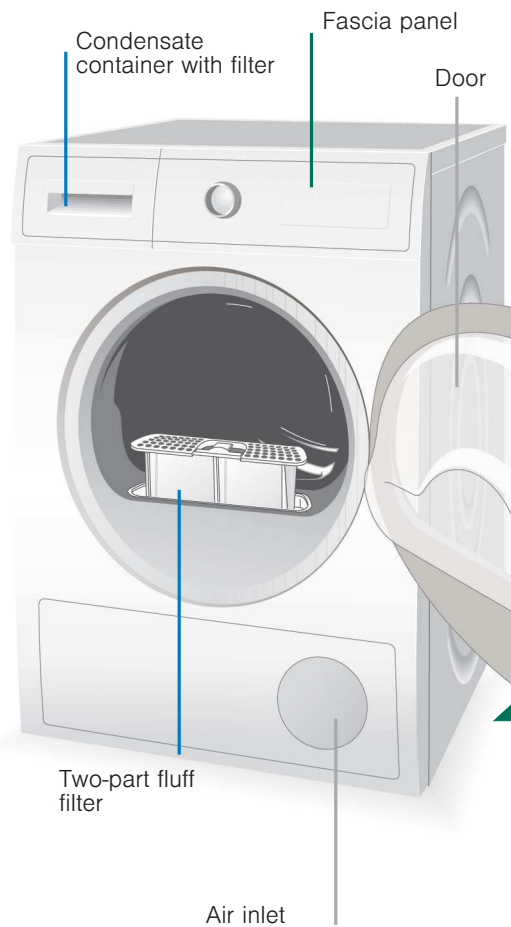

1

2

3

# Drying



7

## Empty the condensate container

If the condensation drain is installed, it is not necessary to empty the condensate container. → separate Instructions for condensation drain.

Empty the container **after each** drying cycle, and not during the cycle.

1. Remove the container, holding it level.
2. Pour out the condensation. Push the container back in until it clicks into place.

You must also observe the → Installation and maintenance instructions, Page 3.



6

## Clean the fluff filters

**i** Clean fluff filters reduce energy consumption.

The fluff filter consists of two parts. Clean the inner and outer fluff filter **after every** drying cycle.

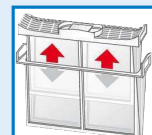

1. Open the door. Remove fluff from the door/door area.
2. Pull out the inner and outer fluff filter and open them out.

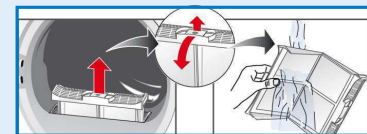

3. Remove any fluff, rinse both fluff filters under running water and dry thoroughly.
4. Fold the fluff filters closed, put them back together and reinsert into the appliance.

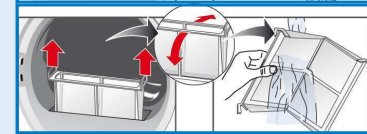

5

## Remove the laundry and switch off the dryer

4

## End of the programme ...

### Interrupt the programme

1. Open the door or press the Start/Pause button; the drying cycle is cancelled.
2. Add or remove laundry and close the door.
3. If required, select a new programme and additional functions. Press the Start/Pause button. The Finished in time is updated after a few minutes.

# Display panel and buttons

## Display panel

**Please clean lint filter** Clean the fluff filters → *Page 4*.

**Please empty condensate container** Empty the condensate container → *Page 4* and/or clean the filter in the condensate container → *Installation and maintenance instructions, Page 3*.

**Heat exchanger is being rinsed** Automatic cleaning of the heat exchanger. Do not empty the condensate container while this is displayed.

## Buttons



 **Drying target** Select the dryness level (e.g. Cupboard dry) or the drying time (20 mins up to 3 hrs: 30 mins, depending on the model and programme).

 **C/board dry extra:** For laundry with thick, multi-layered parts.

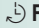
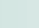

 **C/board dry:** For single-layered laundry.

 **Iron dry:** The condition of the laundry means it is suitable for ironing (iron clothes in order to avoid creases).

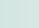
 **Easy-Iron** After the programme finishes, the drum moves at regular intervals to prevent creases. Automatic reduced ironing function can be set in 30 mins intervals up to 120 mins. The standard setting for each programme is 60 mins.

 **Finished in** When a programme is selected, the anticipated drying time for the maximum load is displayed. While drying, the moisture sensors detect the actual load and correct the programme length. This is shown in the display by jumps in the  **Finished in** time. The  **Finished in** time can be delayed in one-hour steps, up to a maximum of 24 hours. Press the  **Finished in** button repeatedly until the required number of hours is displayed (h=hour).

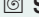
 **Childlock:** Activate/Deactivate → start programme, press and hold the  **Finished in** button above the display panel for 5 seconds.

 **Options**  **Spin speed;**  **Adjust drying level;**  **Low heat**

 Depending on the selected programme, it may not be possible to select individual options.

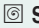
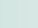
 **Spin speed:** The spin speed that was used for the spin in the washing machine → used exclusively to display the anticipated drying time ( **Finished in** time) more precisely.

 **Adjust drying level:** The drying result (e.g. Cupboard dry) can be increased in three stages (+1 - max. +3); exception: Timer programme → default setting = 0. After one programme has been finely adjusted, the setting is retained for the others.

 **Low heat:** Reduced temperature for delicate fabrics , e.g. polyacrylic, polyamide or elastane, with a longer drying time.

**Memory 1/2** For saving individual programme settings that are used frequently. Use the programme selector to select the required programme. Press and hold the **Memory 1/2** button for 3 sec. until the required programme has been saved.

To select the saved programme, briefly press the **Memory 1/2** button. The programme that is called from **Memory 1 or 2** is displayed on the display panel.

**Basic settings 3 sec.** **end signal, button signal, auto power-off** and **language.** Press and hold buttons **Basic settings 3 sec.** for 3 sec. in order to access the menu.

**end signal/button signal:** The signal volume level can be selected: off - low - medium - loud - very loud.

**auto power-off:** Activate/deactivate by pressing the **Basic settings 3 sec.** buttons. The dryer automatically switches off, depending on your selection, after 15, 30 or 60 mins. The setting is active after  **Easy-Iron** or end of programme.

**language:** Select the required language.

# Information on laundry ...



## Labelling of fabrics

**Follow the manufacturer's care information.**

- Suitable for tumble drying
- Dry at normal temperature.
- Dry at low temperature.
- Do not tumble dry.

*Do not tumble-dry the following fabrics:*

- Non-breathable fabrics (e.g. rubber-coated).
- Delicate materials (silk, curtains made from synthetic material) → these may crease.
- Oil-stained laundry.



## Drying tips

- To ensure a consistent drying result, sort the laundry by fabric type and drying programme.
- Always dry very small fabrics (e.g. baby socks) together with large items of laundry (e.g. towels).
- Close zips, hooks and eyelets, and button up covers. Tie cloth belts, apron strings, etc. together or use a laundry bag.
- Do not over-dry easy-care laundry → Risk of creasing. Allow laundry to finish drying in the air.
- Do not iron laundry immediately after drying; fold items up and leave for a while → residual moisture will then be distributed evenly.
- Knitted fabrics (e.g. T-shirts, jerseys) often shrink slightly the first time they are tumble-dried. → Do not use the  **C/board dry extra** programme.
- Starched laundry is not always suitable for dryers → starch leaves behind a coating that reduces the drying effect.
- When washing laundry that is to be tumble-dried afterwards, use the correct amount of fabric softener as specified in the manufacturer's instructions.
- With a small load, use the Timed programme.

## Environmental protection / Energy-saving tips

- Before drying, spin the laundry in the washing machine → the higher the spin speed, the shorter the drying time will be, thus less energy is consumed. Also spin easy-care laundry.
- Use the maximum recommended capacity, but do not exceed it → *Programme overview, Page 7*.
- Make sure the room is well ventilated during drying.
- Clean the fluff filters after every drying cycle → *Cleaning the fluff filters, Page 4*.
- Keep the supply of cool air unobstructed → Do not cover or block the air inlet.

# Overview of Programmes → Refer to the table of consumption rates on Page 9 and the notes on Page 6.

→ Sort the laundry according to type of textile and fabric. Fabrics must be suitable for tumble drying.  
 → Dryness levels can be individually selected → C/Board dry extra, C/Board dry and iron dry (depending on the model and programme). Degree of dryness can be finely adjusted (depending on the programme). Multi-layered fabrics require a longer drying time than single-layered items of clothing.  
 Recommendation: Dry separately.

Programmes	Max.	Type of Fabric	Options and Notes
Cottons	9 kg	Hard-wearing fabrics, boil-resistant fabrics made of cotton or linen	
Easy Care	3.5 kg	Fabrics made from synthetic or blended fabrics	
Mixed Load	3.5 kg	A mixed load of fabrics made of cotton and synthetic fabrics	
Shoes in basket	1 pair	Shoes	Use with separate basket only → the woollens basket description.
Wool in basket	1 kg	Hand or machine-washable fabrics made of wool or containing wool	Use with separate basket only → the woollens basket description.
Timed program cold			For refreshing or airing
Timed program warm		All types of fabric except for wool and silk	For pre-dried, multi-layered fabrics or small, individual items of laundry. Also for subsequent drying.
Shirts/Blouses	1.5 kg	Shirts and blouses made of cotton and blended fabrics	Creasing is reduced. Not completely dried.
Down Wear	1.5 kg	Fabrics with down filling	Dry non-quilted fabrics separately.
Sportswear	2 kg	Functional clothing made of microfibre	
Super Quick 40'	2 kg	Synthetic fibres, light cotton or mixed fabrics	Easy-to-dry textiles.
Jeans	6 kg	Fabrics made from jeans/denim	
Blankets	2 kg	Large quilted fabrics containing synthetic fibres	No down filling.
Towels	3.5 kg	Terry-towelling laundry e.g. towels and bathrobes	

9608 / 9001100811



Robert Bosch Hausgeräte GmbH  
 Carl-Wery-Str. 34  
 81739 München/Deutschland

WTY88701AU

## Important information...

Your dryer is designed to be particularly energy efficient. Its technical features include a refrigeration circuit, which uses energy efficiently in a similar way to a refrigerator. The dryer's heat exchanger is cleaned automatically during drying. The fluff filters and filter in the condensate container must be cleaned regularly.



Never operate the dryer without the fluff filters and without filter in condensate container!

### Fluff filters

During drying, fluff and hair from the laundry is trapped by the fluff filter. A blocked fluff filter may impair the heat exchange process.

The fluff filters must therefore be cleaned after every drying cycle.

Rinse regularly under running water → Page 4.

When cleaning the fluff filter, make sure that no foreign material (down, filling material) enters the air duct opening. If necessary, clean the drum beforehand with a vacuum cleaner. If foreign material should still enter the air duct → call the after-sales service.

### Filter in the condensate container

The filter in the condensate container cleans the condensation. This condensation is required for the automatic cleaning process. The filter should be cleaned regularly under running water. Empty the condensate container before cleaning the filter → *Installation and maintenance instructions, Page 3.*

### Fabrics

Do not dry any fabrics that have come into contact with solvents, oil, wax, grease or paint: e.g. hair styling products, nail varnish remover, stain remover, cleaning solvent, etc. Empty all pockets.

Do not dry non-breathable fabrics.

Avoid drying laundry items that produce a lot of fluff.

Woollens should be refreshed or dried using the woollens programme only.

## Consumption rates

Fabrics/programmes	Residual moisture in the fabrics after spinning		Drying time**	Energy consumption**
<b>👤 Cottons 9 kg</b>				
🗲 C/board dry*	1400 rpm	50 %	133 min	1.72 kWh
	1000 rpm	60 %	157 min	2.13 kWh
	800 rpm	70 %	181 min	2.48 kWh
👔 Iron dry*	1400 rpm	50 %	98 min	1.22 kWh
	1000 rpm	60 %	123 min	1.62 kWh
	800 rpm	70 %	147 min	2.00 kWh
<b>👤 Easy Care 3.5 kg</b>				
🗲 C/board dry*	800 rpm	40 %	46 min	0.52 kWh
	600 rpm	50 %	60 min	0.66 kWh

For testing in accordance with applicable standard EN61121 the dryer shall be used with external drain set.

\* Programme setting for testing in accordance with applicable standard EN61121.

\*\* The values may differ from those specified, depending on the type of fabric, composition of laundry to be dried, residual moisture in the fabric, the degree of dryness that has been set, the amount of laundry being loaded and the environmental conditions.

Fabrics/programmes	Drying time	Annual energy consumption
<b>👤 Cottons 9 kg / 4.5 kg*</b>		
🗲 C/board dry***	157 min / per cycle	258 kWh / per year

\*\*\* Programme setting for testing and energy labelling in accordance with Directive 2010/30/EU.

## Normal noises

During drying, the compressor and the pump generate some noise which is entirely normal.

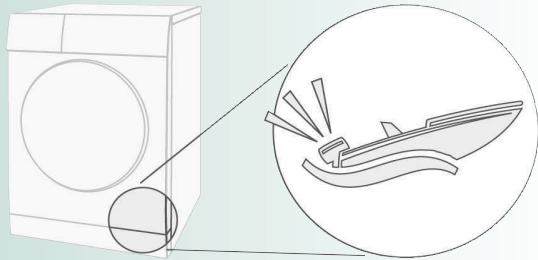

*The compressor in the dryer may occasionally generate a humming noise. The volume and pitch of this may vary depending on the selected programmes and the progress of the drying.*

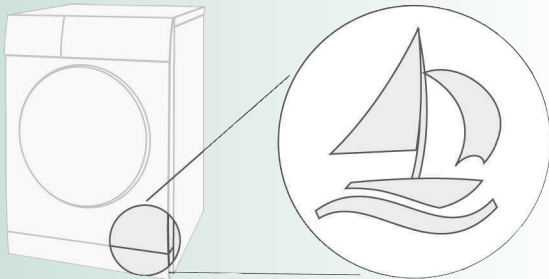

*The compressor in the dryer is ventilated from time to time, which creates a whirring sound.*

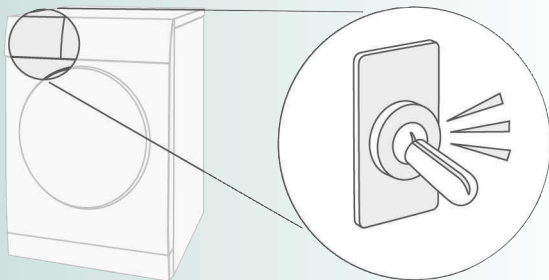

*The automatic cleaning process causes a clicking noise.*

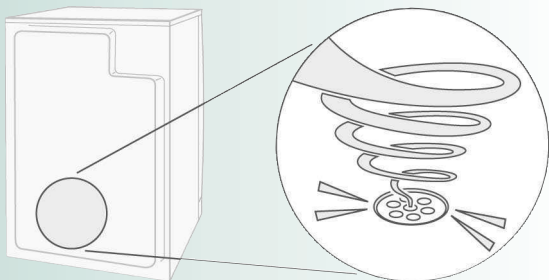

*The process of pumping the condensation into the condensate container generates pumping noises.*

## What to do if ...



If you cannot rectify a fault yourself (e.g. by switching the dryer off/on), please contact our after-sales service.

We will always find an appropriate solution and will avoid unnecessary visits by engineers. Trust the expertise of the manufacturer and rest assured that the repair will be carried out by trained service technicians using original spare parts.

The contact details of your local **after-sales service** can be found in the enclosed after-sales service directory:

– **GB** 0344 892 8979 (Calls charged at local or mobile rate.)

– **IE** 01450 2655 (0.03 € per minute at peak. Off peak 0.0088 € per minute.)

When contacting the after-sales service, please specify the product number (E-Nr.) and production number (FD) of your appliance (see inside of door).

Switch the dryer off using the programme selector and unplug the mains plug from the socket.

- Please empty condensate container** is displayed.      Emptying the condensate container → *Page 4*.  
 Press any button.  
 Press the **Start**/Pause button again.
- Please empty condensate container** is displayed and the drying cycle is interrupted.      Is the condensation drain installed? → Condensation drain hose blocked → check and clean the hose.  
 Stopper in the condensate container? → separate *Instructions for condensation drain*.  
  
 Is the filter in the condensate container dirty? → Clean the filter in the condensate container → *Installation and maintenance instructions, Page 3*.
- Residual water in the condensate container despite the dryer being connected to the condensation drain.      Not a fault. If the condensation drain is installed, residual water remains in the condensate container due to the dryer's self-cleaning function.
- Please clean lint filter** is displayed.      Clean the fluff filters → *Page 4*.  
 Press the **Start**/Pause button again.
- Dryer does not start.      Has the **Start**/Pause button been pressed?  
 Door closed?  
 Ambient temperature greater than 5 °C? The optimum ambient temperature for drying is between 5 °C and 35 °C.
- Water is leaking out.      Make sure the dryer is level.  
 Push the condensate container back in until it locks fully into place.

## What to do if ...

- Laundry is not dried correctly or is still too damp.
 

After the end of the programme, warm laundry feels damper than it actually is. Spread the laundry out and allow the heat to disperse.

Finely adjust the dryness level – this extends the drying time but does not increase the temperature. Your laundry will become drier.

Select a programme with a longer drying time or increase the drying level. This does not increase the temperature.

Select a time programme for extended drying of laundry that is still damp.

If you have exceeded the maximum load for the programme, the laundry may not be dried correctly.

Clean the moisture sensor in the drum. A fine layer of limescale may adversely affect the performance of the sensors and your washing will not dry properly.

Drying has been interrupted as a result of a power cut, because the condensate container is full or because the maximum drying time has been exceeded.

---

- Drying time too long.
 

Clean the fluff filters under running water → *Page 4*.

Insufficient supply of air → Ensure that air can circulate.

Air inlet may be obstructed? Clear the inlet → *Installation and maintenance instructions, Page 1*.

Ambient temperature higher than 35 °C → Ventilate the room. The optimum ambient temperature for drying is between 5 °C and 35 °C. Outside of this range, the drying time may increase.

---

- The humidity in the room increases significantly.
 

Make sure the room is sufficiently ventilated.

---

- **Heat exchanger is being rinsed** is displayed in the display panel.
 

Not an error. Automatic cleaning of the heat exchanger. Do not empty the condensate container during the cleaning process.

---

- Power failure.
 

Remove the laundry from the dryer immediately and spread out. This allows the heat to dissipate. Be careful as the door, the drum and the laundry may be hot.

---

- Other intermittent noises and vibrations.
 

Normal noises → *Page 10*.

## Safety instructions



- Emergency**
  - Pull the appliance plug out of the socket immediately or disconnect the fuse.
- ONLY use the dryer...**
  - in rooms inside the house.
  - to dry fabrics.
- The dryer must NEVER...**
  - be used for purposes other than those described above.
  - be modified in terms of its technology or properties.
- Hazards**
  - The dryer must not be used by children or persons who have not been instructed in its use.
  - Do not leave children unsupervised near the dryer.
  - Keep pets away from the dryer.
  - Remove all objects from pockets, and lighters in particular → **Risk of explosion.**
  - Do not lean or sit on the door → **Risk of tipping.**
  - Open the door carefully. Hot steam may escape. Fabrics and drum may be hot → **Risk of burns.**
- Installation**
  - Secure loose leads or hoses, otherwise there is a **risk of tripping.**
  - Below 0 °C there is a possibility of frost damage.
- Mains connection**
  - Connect the dryer to an AC earthed socket according to specifications, otherwise it cannot be guaranteed that the appliance is completely safe.
  - The cable cross-section must be sufficient.
  - Only use earth-leakage circuit breakers with the following symbol: 
  - The appliance plug and socket must be compatible.
  - Do not use multiple plugs/connectors and/or extension cables.
  - Do not touch or hold the appliance plug with wet hands → **Risk of electric shock.**
  - Never pull the appliance plug out of the socket by its cable.
  - Do not damage the mains lead → **Risk of electric shock.**
- Operation**
  - Only load the dryer as recommended in the programme descriptions (*Programmes/fabrics, Page 1* and *Programme overview, Page 7*). Check the contents before you switch the dryer on.
  - Do not use the dryer if the laundry has been in contact with solvents, oil, wax, grease or paint (e.g. hair styling products, nail varnish remover, stain remover, cleaning solvent, etc.) → **Risk of fire/explosion.**
  - The tumble dryer is not to be used if industrial chemicals have been used for cleaning.
  - Dust (e.g. coal dust, flour) poses a danger: Do not use the dryer → **Risk of explosion.**
  - Do not put laundry containing foam material/rubber in the dryer → elastic material may be destroyed and the dryer may be damaged due to possible deformation of the foam material.
  - Do not turn off the dryer until the drying process ends, unless the laundry will be removed quickly and spread out, so that the heat can dissipate.
  - Light things, such as long hair, may be sucked into the air inlet of the dryer → **Risk of injury.**
  - Final part of a tumble dryer cycle occurs without heat (cool down cycle), to ensure that the items are left at a temperature that ensures that the items will not be damaged.
  - Switch off the dryer once the programme has ended.
  - The distilled water/water from condensation is not drinking water and may be contaminated with fluff.
- Defect**
  - Do not use the dryer if it is defective or if you suspect that it is. Repairs must only be carried out by the after-sales service.
  - Do not use the dryer if the mains cable is defective. To avoid danger, only have the defective mains cable replaced by the after-sales service.
- Spare parts**
  - Only use genuine spare parts and accessories for safety reasons.
- Disposal**
  - Dryer: Pull out the appliance plug, **then** cut off the mains cable from the appliance. Dispose of the appliance at a municipal waste disposal facility.
  - Packaging: Keep all packaging out of reach of babies and children → **Risk of suffocation.**
  - The dryer's heat exchanger contains fluorinated greenhouse gas (R407C) in a hermetically sealed unit → Dispose of this properly. Capacity: 0.290 kg. Total GWP: 0.514 tCO<sub>2</sub>.
  - All materials are environmentally sound and can be reused. Dispose of in an environmentally-responsible manner.



Register your new Bosch now:  
[www.bosch-home.com/welcome](http://www.bosch-home.com/welcome)



**Dryer**  
**WTY88701AU**



**en** operating instructions