

Your new dryer

Congratulations - you have chosen to buy a modern, high-quality Bosch domestic appliance. The condensation dryer with heat pump and automatic cleaning of the heat exchanger is outstanding in terms of efficient energy consumption and low maintenance requirements → page 6. Every dryer which leaves our factory is carefully checked to ensure that it functions correctly and is in perfect condition. Should you have any questions, our after-sales service will be pleased to help.

Environmentally-responsible disposal This appliance is labelled in accordance with European Directive 2012/19/EU concerning used electrical and electronic appliances (waste electrical and electronic equipment - WEEE). The guideline determines the framework for the return and recycling of used appliances as applicable throughout the EU.

For further information about our products, accessories, spare parts and services, please visit: www.bosch-home.com

Observe the safety instructions on page 13. Read these instructions and the separate **Energy-saving mode** instructions before switching on the dryer.

Contents

■ Preparation	Page 2
■ Setting the programmes	Page 2
■ Drying	Page 3/4
■ Notes on laundry	Page 5
■ Button signals	Page 5
■ Fine adjustment of the drying result	Page 6
■ Important information	Page 6
■ Overview of programmes	Page 7
■ Installation	Page 8
■ Frost protection / Transport	Page 8
■ Signal	Page 8
■ Care and cleaning	Page 9
■ Technical data	Page 10
■ Optional accessories	Page 10
■ Normal noises	Page 11
■ What to do if ... / After-sales service	Page 12
■ Safety instructions	Page 13

Reduced temperature for delicate fabrics that require a longer drying time; e.g. polyacrylics, polyamide, elastane, acetate silk.

Intended use

- For domestic use only.
 - Only to be used for drying fabrics that have been washed with water.
- Keep children younger than 3 years old away from the dryer.**
Do not let children make the cleaning and maintenance work on the dryer without supervision. Do not leave children unsupervised near the dryer. Keep pets away from the dryer.
- The dryer can be operated by children 8 years old and older, by persons with reduced physical, sensory or mental abilities and by persons with insufficient experience or knowledge if they are supervised or have been instructed in its use by a responsible adult.
This appliance is intended for use up to a maximum height of 4000 metres above sea level.

Preparation

Never start the dryer if it is damaged. Inform your after-sales service.

Make sure your hands are dry. Hold the plug only.

Remove all items from pockets. Check for cigarette lighters. The drum must be empty prior to loading. See programme overview on page 7. See also separate instructions for "basket for woollens" (depending on the model)

Sorting and loading laundry

Drying

Inspecting the dryer

Connecting the mains plug

Sorting and loading laundry

Selecting and adjusting the programme

Emptying condensation

Empty the container after each drying cycle, not during drying.

Cleaning the fluff filter

Switching off the dryer

Removing the laundry

End of programme

Interrupt programme

Information on laundry ...

Labelling of fabrics

Drying tips

Environmental protection / Energy-saving tips

Button signals

Fine adjustment of the drying result

Adjustment of the levels of dryness

Fluff filters

Filter in the condensate container

Fabrics

Important Information

Never operate the dryer without the fluff filters and without filter in condensate container.

Programme overview

After drying, laundry is to be ...

PROGRAMMES

Programme overview

Sort the laundry according to type of textile and fabric. Fabrics must be suitable for tumble drying.

After drying, laundry is to be ...

PROGRAMMES

PROGRAMMES

Programme overview

After drying, laundry is to be ...

PROGRAMMES

PROGRAMMES

PROGRAMMES

Installation

- Scope of delivery: dryer, installation and operating instructions, woollens basket (depending on model).
- Check dryer for transport damage.
- The dryer is very heavy. Do not attempt to lift it on your own.
- Be careful to avoid sharp edges.
- Do not set up in a room that is susceptible to frost. Freezing water may cause damage.
- If in doubt, have the appliance connected by a specialist.
- Do not lift the dryer by protruding parts (e.g. the door) - risk of breakage.

1. Setting up the dryer

- The appliance plug must always be accessible.
- Ensure that the appliance is installed on a clean, level and firm surface.
- Do not obstruct the air inlet on the front of the dryer.
- Keep the area around the dryer clean.
- Make the dryer level using the threaded feet and a spirit level.
- Do not remove the threaded feet under any circumstances.

Do not set up the dryer behind a door or sliding door, as this may obstruct the dryer door or prevent it from opening. This will prevent a potentially fatal danger to children from locking themselves in.

2. Mains connection

- Connect to an AC earthed socket. If in doubt have the socket checked by a specialist.
- The mains voltage and the voltage shown on the rating plate (→ page 10) must be the same.
- The connected load and necessary fuse protection are specified on the rating plate.

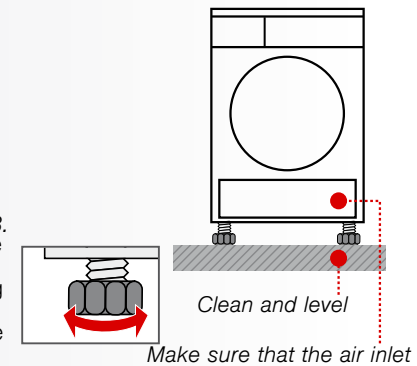

Frost protection / Transport

Frost protection - preparation

1. Empty the condensate container → page 4.
2. Select any programme using the programme selector.
3. Press the Start/Stop button → condensed water is pumped into the container
4. Wait 5 minutes and then empty the condensate container again.
5. Turn the programme selector to Off.

Transport

- Prepare the dryer → see Frost protection - preparation.
- Transport the dryer in a vertical upright position.
- Following transportation, do not use the dryer for two hours.

The dryer contains residual water; this can flow out if the dryer is tilted.

Signal

Switching on/off an acoustic signal at the end of the programme



Low heat light on → an acoustic signal at the end of the programme is switched on.
Low heat light off → an acoustic signal at the end of the programme is switched off.

Care and cleaning

Heat exchanger

The dryer's heat exchanger is cleaned automatically during drying. Do not pull out the condensate container during the cleaning process.

Dryer housing, control panel, air intake

Wipe with a soft, damp cloth.
Do not use harsh cleaning agents or solvents.
Remove detergent and cleaning agent residue immediately.

Filter in the condensate container

The filter is cleaned automatically when the condensate container is emptied. However, the filter should still be cleaned regularly under running water → This prevents stubborn deposits/dirt from building up.

1. Pull out the condensate container.

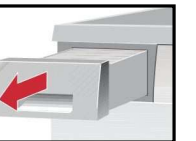

2. Pull the filter out of its snap-in lock.

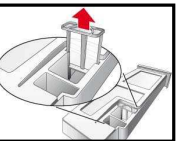

3. Clean the filter under running water or in the dishwasher.

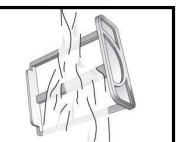

4. Refit the filter.

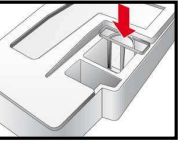

5. Insert the condensate container so that it locks into place.

Only operate the dryer with the filter inserted.

Moisture sensor

The dryer is equipped with stainless steel moisture sensors. Moisture sensors measure how damp the laundry is. A thin layer of limescale may build up on the moisture sensors after prolonged use.

1. Open the door.
2. Clean the moisture sensors using a damp sponge with a rough surface.

Do not use steel wool or abrasive materials.

Technical Data

- **Dimensions (DxWxH)** 60 x 60 x 85 cm (height adjustable)
- Weight** approx. 51 kg
- Max. capacity** 7 kg
- Condensate container** 4.0 l
- Connection voltage** 220-240 V
- Connected load** max. 800 W
- Fuse protection** 10 A
- Ambient temperature** 5 - 35°C
- Product number** Inside of door
- Production number** The rating plate can be found on the back of the dryer.
- **Power consumption when switched off** 0.10 W
- **Power consumption when ready for use (left-on mode)** 1.00 W
- **Drum interior light** (depending on model): The drum lights up after the door is opened and after the programme starts, and switches off automatically.

Consumption values table

Programme	Spin speed which is used for spinning the laundry	Duration**		Energy consumption**	
		7 kg	3.5 kg	7 kg	3.5 kg
Cottons Cupboard dry*	1400 rpm	151 min	93 min	1.33 kWh	0.80 kWh
	1000 rpm	178 min	110 min	1.65 kWh	0.97 kWh
	800 rpm	205 min	127 min	1.92 kWh	1.13 kWh
Iron dry*	1400 rpm	110 min	71 min	0.94 kWh	0.61 kWh
	1000 rpm	137 min	88 min	1.24 kWh	0.80 kWh
	800 rpm	166 min	111 min	1.55 kWh	1.04 kWh
Easy-Care Cupboard dry*	1400 rpm	64 min	35 min	0.54 kWh	0.35 kWh
	800 rpm	78 min	41 min	0.68 kWh	0.43 kWh

* Programme setting for testing in accordance with the applicable EN61121 standard.
** The values may differ from those specified, depending on the type of fabric, composition of laundry to be dried, residual moisture in the fabric, the degree of dryness that has been set, the amount of laundry being loaded and the environmental conditions.

Most efficient programme for cotton fabrics

The following "standard cottons programme" (identified with ☐) is suitable for drying normal, wet cotton laundry and is most efficient in terms of its combined energy consumption for drying wet cotton laundry.

Standard programme for cottons in accordance with current EU regulation 93/2012

Programme	Load	Energy consumption	Programme duration
☐ Cottons Cupboard dry	7 kg/3.5 kg	1.65 kWh/0.97 kWh	178 min/110 min

Programme setting for testing and energy labelling in accordance with Directive 2010/30/EU.

Optional accessories (order from the after-sales service using the order number, depending on the model)

- **Washer-dryer stack connection set** (WTZ 20410)
The dryer can be placed on top of a suitable washing machine with the same width and depth to save space. The dryer **must** be fastened to the washing machine using this connection set. WTZ 11400: with pull-out worktop.
- **Installation underneath the worktop** (WTZ 10290)
Instead of the appliance covering plate, you **must** have a metal cover fitted by a specialist.
- **Platform** (WMZ 20500)
For easier loading and unloading. The basket contained in the drawer can be used to carry the laundry.
- **Wollens basket** (WMZ 20600)
For drying individual wollen fabrics, sports shoes and soft toys (see separate instructions for "Wollens basket").

Normal noises

During drying, the compressor and the pump generate some noise which is entirely normal.

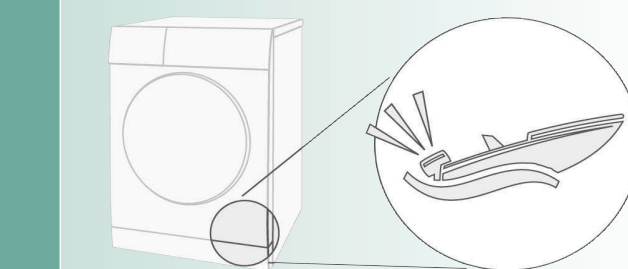

The compressor in the dryer may occasionally generate a humming noise. The volume and pitch of this may vary depending on the selected programmes and the progress of the drying.

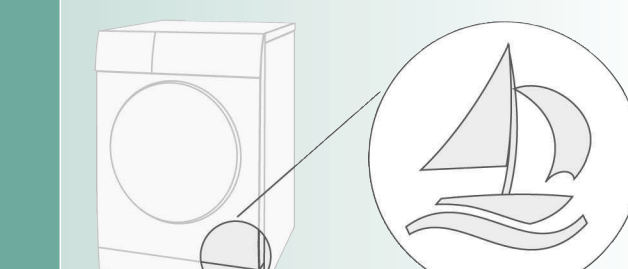

The compressor in the dryer is ventilated from time to time, which creates a whirring sound.

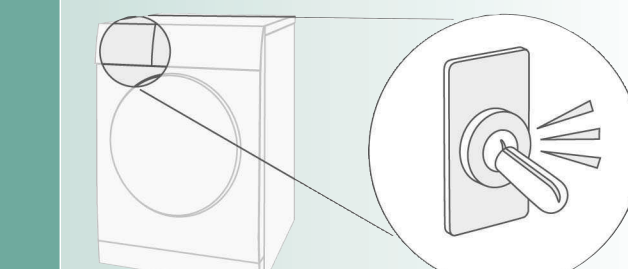

The automatic cleaning process causes a clicking noise.

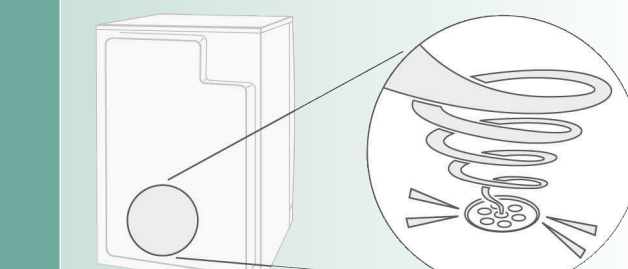

The process of pumping the condensation into the condensate container generates pumping noises.

What to do if...

- If you cannot rectify a fault yourself (e.g. switching off/on), please contact our after-sales service. We will always find an appropriate solution and will avoid unnecessary visits by engineers. Trust the expertise of the manufacturer and rest assured that the repair will be carried out by trained service technicians using original spare parts. The contact details of your local after-sales service can be found in the enclosed after-sales service directory, or by calling one of these numbers:
 - GB 0344 892 8979 (Calls charged at local or mobile rate.)
 - IE 01450 2655 (0.03 € per minute at peak. Off peak 0.0088 € per minute.)When contacting the after-sales service, please quote the appliance's product number (E no.) and production number (FD) (see under the loading door).

Turn the programme selector to **Off** and unplug the mains plug from the socket.

- The Start/Stop indicator lamp does not light up. Mains plugged in? Programme selected? Check the socket fuse.
- The display panel light and indicator lights (depending on model) go out. Energy-saving mode is activated → see the separate Energy-saving mode instructions.
- The Container indicator lamp and the Start/Stop button are flashing. Empty the condensate container → page 4. Clean the condensate container filter if necessary → page 9. Dryer transported? → Wait 2 hours and start again.
- The Clean indicator lamp and Start/Stop button are flashing. Rinse the fluff filter under running water → page 4.
- Dryer does not start. Start/Stop button selected? Door closed? Ambient temperature greater than 5°C? The optimum ambient temperature for drying is between 5 °C and 35 °C.
- Water is leaking out. Make sure the dryer is level.
- The door opens by itself. Push the door closed until you hear it click into place.
- Creasing. Laundry load exceeded? Remove articles of clothing immediately after the end of the programme, hang up and pull into shape. Unsuitable programme selected → page 7.
- Laundry is not dried correctly or is still too damp. After the end of the programme, warm laundry feels damper than it actually is. Spread the laundry out and allow the heat to disperse. Finely adjust the dryness level – this extends the drying time but does not increase the temperature. Your laundry will become drier. Select a programme with a longer drying time or increase the drying level. This does not increase the temperature. Select a time programme for extended drying of laundry that is still damp. If you have exceeded the maximum load for the programme, the laundry may not be dried correctly. Clean the moisture sensor in the drum. A fine layer of limescale may adversely affect the performance of the sensors and your washing will not dry properly. Drying has been interrupted as a result of a power cut, because the condensate container is full or because the maximum drying time has been exceeded.
- Drying time too long. Rinse the fluff filters under running water → page 4. Insufficient supply of air → ensure that air can circulate. Air inlet possibly blocked → Clear inlet → page 9. Ambient temperature higher than 35 °C → ventilate the room. The optimum ambient temperature for drying is between 5 °C and 35 °C. Outside of this range, the drying time may increase. Make sure the room is sufficiently ventilated.
- The humidity in the room increases significantly. Remove laundry from the dryer immediately and spread out. This allows the heat to dissipate. Be careful as the door, the drum and the laundry may be hot.
- Power failure.
- Other intermittent noises and vibrations. Not an error. Normal noises → page 11.
- Loud humming noise for several seconds. Has the condensate container been properly inserted? → Push the condensate container all the way in. Not an error. Normal noises → page 11.

Safety instructions

- **Emergency ONLY use the dryer...**
 - Pull the appliance plug out of the socket immediately or disconnect the fuse.
 - in rooms inside the house.
 - to dry fabrics.
- **The dryer must NEVER...**
 - be used for purposes other than those described above.
 - be modified in terms of its technology or properties.
- **Hazards**
 - The dryer must not be used by children or persons who have not been instructed in its use.
 - Do not leave children unsupervised near the dryer.
 - Keep pets away from the dryer.
 - Remove all objects from pockets, and lighters in particular → **Risk of explosion.**
 - Do not lean or sit on the door → **Risk of tipping.**
- **Installation**
 - Secure loose cables → **Risk of tripping.**
 - Do not operate a dryer if there is a risk of frost.
- **Mains connection**
 - Connect the dryer to an AC earthed socket according to specifications, otherwise it cannot be guaranteed that the appliance is completely safe.
 - The cable cross-section must be sufficient.
 - Only use earth-leakage circuit breakers with the following symbol:
 - The appliance plug and socket must be compatible.
 - Do not use multiple plugs/connectors and/or extension cables.
 - Do not touch or hold the appliance plug with wet hands → **Risk of electric shock.**
 - Never pull the appliance plug out of the socket by its cable.
 - Do not damage the mains lead → **Risk of electric shock.**
- **Operation**
 - Only load the drum with laundry.
 - Check the contents before you switch the dryer on.
 - Do not use the dryer if the laundry has been in contact with solvents, oil, wax, grease or paint (e.g. hair styling products, nail varnish remover, stain remover, cleaning solvent, etc.) → **Risk of fire/explosion.**
 - The tumble dryer is not to be used if industrial chemicals have been used for cleaning.
 - Dust (e.g. coal dust, flour) poses a danger: Do not use the dryer → **Risk of explosion**
 - Do not put laundry containing foamed material/rubber in the dryer → elastic material may be destroyed and the dryer be damaged due to possible deformation of the foamed material.
 - Do not turn off the dryer until the drying process ends, unless the laundry will be removed quickly and spread out, so that the heat can dissipate.
 - When cleaning the fluff filter, make sure that no foreign material (down or filling material) gets into the air duct opening. If necessary, clean the drum beforehand with a vacuum cleaner. If foreign material should still get into the air duct → call the after-sales service → **Risk of fire/explosion.**
 - Light things, such as long hair, may be sucked into the air inlet of the dryer → **Risk of injury.**
 - Final part of a tumble dryer cycle occurs without heat (cool down cycle), to ensure that the items are left at a temperature that ensures that the items will not be damaged.
 - Switch off the dryer once the programme has ended.
 - The water from condensation is not drinking water and may be contaminated with fluff.
- **Defect**
 - Do not use the dryer if it is defective or if you suspect that it is.
 - Repairs must only be carried out by the after-sales service.
 - Do not use the dryer if the mains cable is defective. To avoid danger, only have the defective mains cable replaced by the after-sales service.
- **Spare parts**
 - Only use genuine spare parts and accessories for safety reasons.
- **Disposal**
 - Pull out the appliance plug, then cut off the mains cable from the appliance.
 - Dispose of at a municipal waste disposal facility.
 - The dryer's heat exchanger contains fluorinated greenhouse (R134a) gas in a hermetically sealed unit → dispose of in a proper manner. Capacity: 0.220 kg. Total GWP: 0.315 tCO₂.
 - Packaging: Keep all packaging out of reach of babies and children → **Risk of suffocation.**
 - All materials are environmentally sound and can be reused.
 - Dispose of in an environmentally-responsible manner.



Register your new Bosch now:
www.bosch-home.com/welcome

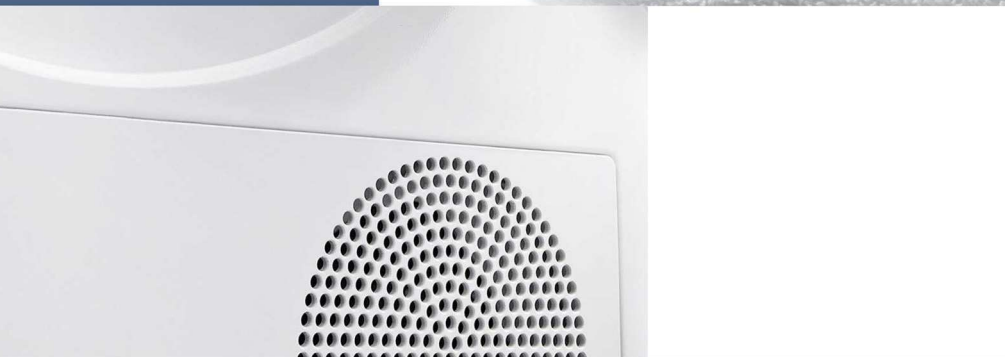

Dryer
WTW84161GB



en Operating and installation instructions

Your new dryer

Congratulations - you have chosen to buy a modern, high-quality Bosch domestic appliance.

The condensation dryer with heat pump and automatic cleaning of the heat exchanger is outstanding in terms of efficient energy consumption and low maintenance requirements → page 6.

Every dryer which leaves our factory is carefully checked to ensure that it functions correctly and is in perfect condition.

Should you have any questions, our after-sales service will be pleased to help.

Environmentally-responsible disposal

This appliance is labelled in accordance with European Directive 2012/19/EU concerning used electrical and electronic appliances (waste electrical and electronic equipment - WEEE). The guideline determines the framework for the return and recycling of used appliances as applicable throughout the EU.

For further information about our products, accessories, spare parts and services, please visit: www.bosch-home.com



Observe the safety instructions on page 13.



Read these instructions and the separate **Energy-saving mode** instructions before switching on the dryer.

Contents

Page

Preparation	2
Setting the programmes	2
Drying	3/4
Notes on laundry	5
Button signals	5
Fine adjustment of the drying result	6
Important Information	6
Overview of programmes	7
Installation	8
Frost protection / Transport	8
Signal	8
Care and cleaning	9
Technical data	10
Optional accessories	10
Normal noises	11
What to do if ... / After-sales service	12
Safety instructions	13

Reduced temperature for delicate fabrics that require a longer drying time; e.g. polyacrylics, polyamide, elastane, acetate silk.

Intended use

- For domestic use only.
- Only to be used for drying fabrics that have been washed with water.



Keep children younger than 3 years old away from the dryer.

Do not let children make the cleaning and maintenance work on the dryer without supervision. Do not leave children unsupervised near the dryer. Keep pets away from the dryer.

The dryer can be operated by children 8 years old and older, by persons with reduced physical, sensory or mental abilities and by persons with insufficient experience or knowledge if they are supervised or have been instructed in its use by a responsible adult.

This appliance is intended for use up to a maximum height of 4000 metres above sea level.

Preparation

Installation → page 8



Never start the dryer if it is damaged. Inform your after-sales service.



Make sure your hands are dry. Hold the plug only.



Sorting and loading

Remove all items from pockets. Check for cigarette lighters. The drum must be empty prior to loading.

See programme overview on page 7. See also separate instructions for "basket for v (depending on the model)

Selecting and adjusting the programme

Select the d

... and adapt to indiv

Additional functions	Display status/ service	Programme selector
<p>Low Heat </p>	<ul style="list-style-type: none"> ○ Drying ○ Iron Dry ○ Cupboard Dry ○ Anti-Crease/End ○ Container ○ Clean 	
	<p>Container</p> <p>Empty the condensate container. Clean the filter in the condensate container if necessary → page 9.</p>	
	<p>Clean</p> <p>Rinse the fluff filters under running water → page 4.</p>	
<p>Low heat </p>	<p>Fine adjustment of the drying result</p> <p>The drying result (e.g. Cupboard Dry) can be adjusted over three levels (1 - max. 3) for the Cottons, Easy-Care and SuperQuick 40' programmes → presetting = 0. After one of these programmes has been finely adjusted, the setting is retained for the others. Further information → page 6.</p>	



All buttons are sensitive. They need to be touched.

Press the (



Only use the dryer if the plug is inserted.

Inspecting the dryer

Connecting the mains plug

Loading laundry

woollens"

the programme

dry programme ...

individual requirements

positive and only
lightly.

Start/Stop button

with the fluff filter

0, 1, 2, 3

condensate container with filter

Control panel

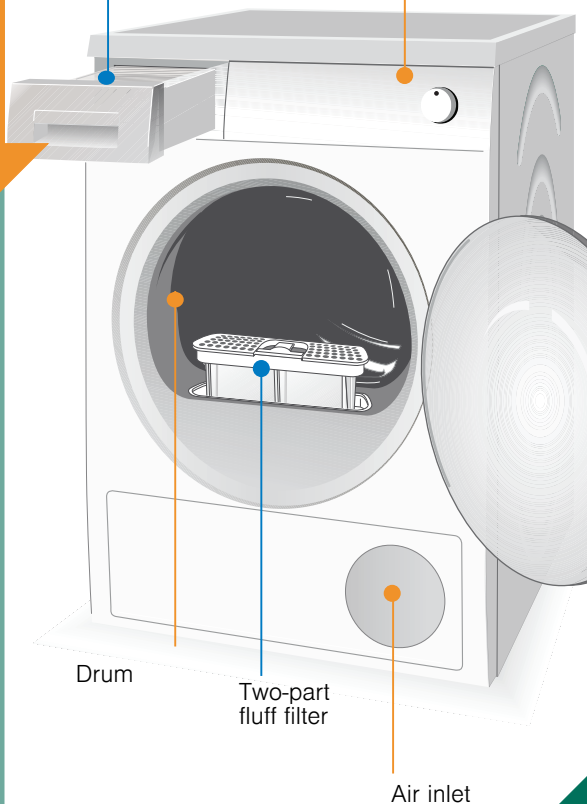

Drying



1
2

3

Drying



Do not pull out/empty the condensate container when drying is in progress.



Emptying condensation

Empty the container **after each** drying cycle, not during drying.

1. Remove the condensate container and hold it level.
2. Pour out the condensation.
3. Always push container in fully until it clicks into place.

If the **Container** indicator lamp flashes despite the container having been emptied → *Filter in condensate container, page 9.*

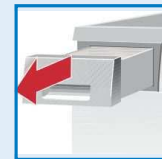

Cleaning the fluff filter

i Clean fluff filters reduce energy consumption.

The fluff filter consists of two parts. Clean the inner and outer filter **after every** drying cycle:

1. Open the door. Remove fluff from the door/door area.
2. Pull out both parts of the fluff filter.
3. Remove fluff from the edge of the shaft. Fluff should not fall into the open shaft.
4. Open the filter and remove all the fluff.
5. Rinse both parts under running water and dry thoroughly.
6. Close the inner and outer filter, put them back together and reinsert them into the appliance.

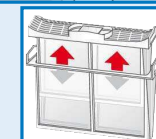
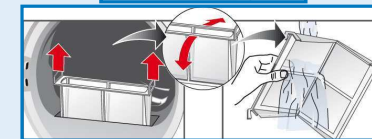
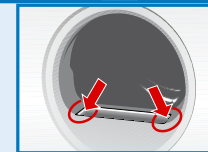
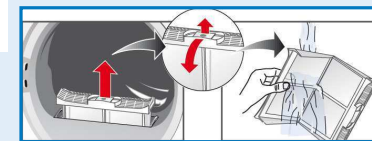

Switching off the dryer

Turn the programme selector to **Off**. Do not leave laundry in the dryer.

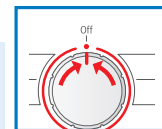

Removing the laundry

Your dryer is equipped with an automatic reduced ironing function. The drum is moved at specific time intervals for 60 minutes once the programme has ended. The laundry stays loose and fluffy (or 120 minutes if the additional **Less ironing** function is selected (*depending on model*)).

End of programme as soon as the **Anti-Crease/End** indicator lamp lights up.

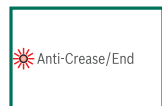

Interrupt programme Adding or removing laundry.

i The drying operation can be interrupted briefly to add or remove laundry. However, it must then be continued until it has finished.

1. Open the door. The drying process is interrupted.
2. Add or remove laundry then close the door.
3. If required, select a new programme and additional functions.
4. Press the **Start/Stop** button.

Information on laundry ...



Labelling of fabrics

Follow the manufacturer's care information.

- Dry at normal temperature.
- Dry at low temperature → in addition, select **Low Heat** Ⓛ^+ .
- Do not machine dry.



Always observe the safety instructions on page 13.

Do not tumble-dry the following fabrics, for example:

- Non-breathable fabrics (e.g. rubber-coated).
- Delicate materials (silk, curtains made from synthetic material) → these may crease.
- Oil-stained laundry.



Drying tips

- To ensure an even result, sort the laundry by fabric type and drying programme.
- Always dry very small fabrics (e.g. baby socks) together with large items of laundry (e.g. towels).
- Close zips, hooks and eyelets, and button up covers. Tie fabric belts, apron strings, etc. together
- Do not over-dry easy-care laundry → Risk of creasing. Allow laundry to finish drying in the air.
- Do not dry woollens in the dryer. They may, however, be refreshed → page 7 **Wool finish** programme (depending on model).
- Do not iron laundry immediately after drying; fold items up and leave for a while → residual moisture will then be distributed evenly.
- The drying result depends on the type of water used during washing. → *Fine adjustment of the drying result* → page 6.
- Knitted fabrics (e.g. T-shirts, jerseys) often shrink slightly the first time they are tumble-dried. → Do not use the **Extra Dry** programme.
- The drying of starched laundry should be limited. → Starch leaves behind a coating that impairs drying.
- When washing laundry that is to be tumble-dried afterwards, use the correct amount of fabric softener as specified in the manufacturer's instructions.
- For pre-dried, multi-layered fabrics or small, individual items of laundry, use the Timed programme. Also suitable for subsequent drying.

Environmental protection / Energy-saving tips

- Before drying, spin the laundry thoroughly in the washing machine → the higher the spin speed, the shorter the drying time will be, thus less energy is consumed. Also spin easy-care laundry.
- Use the maximum recommended capacity, but do not exceed it → Programme overview → page 7.
- Make sure the room is well ventilated during drying.
- Do not cover or seal the air inlet.

Button signals



Setting the volume for button signals

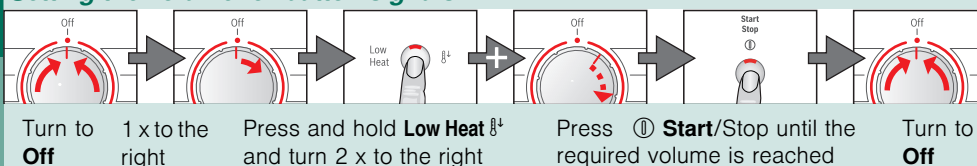

Selectable values: off, quiet, medium, loud, very loud.

Fine adjustment of the drying result



Adjustment of the levels of dryness

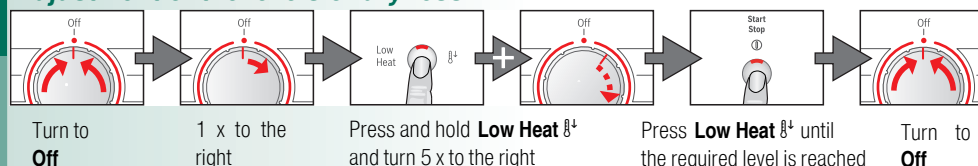

Drying, Iron Dry, Cupboard Dry, Anti-Crease/End are displayed in sequence. Short signal when changing from level 3 to 0, otherwise long signal.

0	1	2	3

Important Information

Your dryer is designed to be particularly energy efficient. Its technical features include a refrigeration circuit, which uses energy efficiently in a similar way to a refrigerator. The dryer's heat exchanger is cleaned automatically during drying. The fluff filters and filter in the condensate container must be cleaned regularly.



Never operate the dryer without the fluff filters and without filter in condensate container.

Fluff filters

During drying, fluff and hair from the laundry is trapped by the fluff filter. Blocked fluff filters may impair the heat exchange process. The fluff filters must therefore be cleaned after every drying cycle. Rinse regularly under running water → page 4.

Filter in the condensate container

The filter in the condensate container cleans the condensation. This condensation is required for the automatic cleaning process. The filter should be cleaned regularly under running water. Empty the condensate container before cleaning the filter → page 4/9.

Fabrics

Do not dry any fabrics that have come into contact with solvents, oil, wax, grease or paint: e.g. hair styling products, nail varnish remover, stain remover, cleaning solvent. etc. Empty all pockets.

Do not dry non-breathable fabrics.

Avoid drying items that produce a lot of fluff.

Woollens should be refreshed only, using the woollens programme.

Programme overview

see also page 5.

Sort the laundry according to type of textile and fabric. Fabrics must be suitable for tumble drying.

After drying, laundry is to be ...	Ironed	lightly ironed	not ironed	mangled
PROGRAMMES				
TEXTILE TYPE AND INFORMATION				
*👤 Cottons	max. 7 kg			
*👤 Easy-Care	max. 3.5 kg			
Iron Dry	☞ ☞ ☞ ☞			
Cupboard Dry	☞			
Extra Dry	☞			
🌀 SuperQuick 40'	max. 1 kg			
Wool finish	max. 3 kg			
🕒 Timed Programme warm 30 min	max. 3 kg			

*Dryness levels can be selected individually → Extra Dry, Cupboard Dry and Iron Dry (depending on the model).

Degree of dryness can be finely adjusted; multi-layered textiles require a longer drying time than single-layered items of clothing. Recommendation: Dry separately.

9604 / 9000964585



Robert Bosch Hausgeräte GmbH
Carl-Wery-Str. 34
81739 München/Deutschland

WTW84161GB

Installation

- ! Scope of delivery: dryer, installation and operating instructions, woollens basket (depending on model).
- ! Check dryer for transport damage.
- ! The dryer is very heavy. Do not attempt to lift it on your own.
- ! Be careful to avoid sharp edges.
- ! Do not set up in a room that is susceptible to frost. Freezing water may cause damage.
- ! If in doubt, have the appliance connected by a specialist.
- ! Do not lift the dryer by protruding parts (e.g. the door) - risk of breakage.

- 1. Setting up the dryer**
- ! The appliance plug must always be accessible.
 - ! Ensure that the appliance is installed on a clean, level and firm surface.
 - ! Do not obstruct the air inlet on the front of the dryer.
 - ! Keep the area around the dryer clean.
 - ! Make the dryer level using the threaded feet and a spirit level.
 - ! Do not remove the threaded feet under any circumstances.

! Take all accessory parts out of the drum. The drum must be empty.

- ! Do not set up the dryer behind a door or sliding door, as this may obstruct the dryer door or prevent it from opening. This will prevent a potentially fatal danger to children from locking themselves in.

- 2. Mains connection** see Safety instructions → page 13.
- ! Connect to an AC earthed socket. If in doubt have the socket checked by a specialist.
 - ! The mains voltage and the voltage shown on the rating plate (→ page 10) must be the same.
 - ! The connected load and necessary fuse protection are specified on the rating plate.

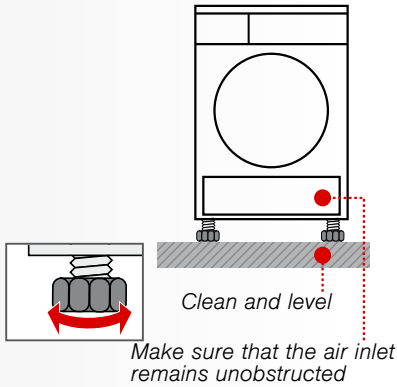

Frost protection / Transport

- ! Do not operate the dryer if there is a danger of frost.
- Frost protection - preparation**
1. Empty the condensate container → page 4.
 2. Select any programme using the programme selector.
 3. Press the **Start/Stop** button → condensed water is pumped into the container
 4. Wait 5 minutes and then empty the condensate container again.
 5. Turn the programme selector to **Off**.

- Transport**
- ! Prepare the dryer → see Frost protection - preparation.
 - ! Transport the dryer in a vertical upright position.
 - ! Following transportation, do not use the dryer for two hours.

i The dryer contains residual water; this can flow out if the dryer is tilted.

Signal

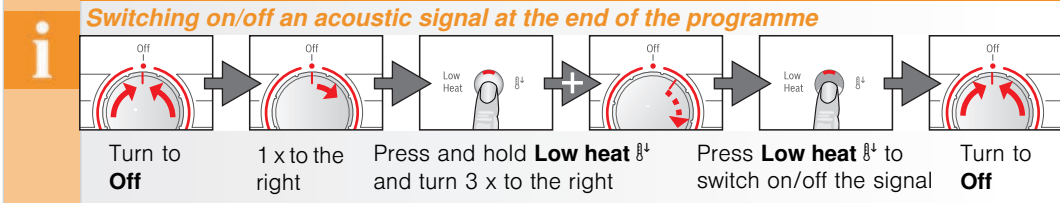

i **Low heat** light on → an acoustic signal at the end of the programme is switched on.
 i **Low heat** light off → an acoustic signal at the end of the programme is switched off.

Care and cleaning

! Appliance must be switched off.

i **Heat exchanger**
 The dryer's heat exchanger is cleaned automatically during drying. Do not pull out the condensate container during the cleaning process.

! **Dryer housing, control panel, air intake**
 Wipe with a soft, damp cloth. Do not use harsh cleaning agents or solvents. Remove detergent and cleaning agent residue immediately.

! **Filter in the condensate container**
 The filter is cleaned automatically when the condensate container is emptied. However, the filter should still be cleaned regularly under running water → This prevents stubborn deposits/dirt from building up.

1. Pull out the condensate container.
2. Pull the filter out of its snap-in lock.
3. Clean the filter under running water or in the dishwasher.
4. Refit the filter.
5. Insert the condensate container so that it locks into place.

! Only operate the dryer with the filter inserted.

! **Moisture sensor**
 The dryer is equipped with stainless steel moisture sensors. Moisture sensors measure how damp the laundry is. A thin layer of limescale may build up on the moisture sensors after prolonged use.

1. Open the door.
2. Clean the moisture sensors using a damp sponge with a rough surface.

! Do not use steel wool or abrasive materials.

Technical Data

● Dimensions (DxWxH)	60 x 60 x 85 cm (height adjustable)
Weight	approx. 51 kg
Max. capacity	7 kg
Condensate container	4.0 l
Connection voltage	220-240 V
Connected load	max. 800 W
Fuse protection	10 A
Ambient temperature	5 - 35°C
Product number	Inside of door
Production number	



The rating plate can be found on the back of the dryer.

Power consumption when switched off 0.10 W

Power consumption when ready for use (left-on mode) 1.00 W

● **Drum interior light** (depending on model): The drum lights up after the door is opened and after the programme starts, and switches off automatically.

Consumption values table

Programme	Spin speed which is used for spinning the laundry	Duration**		Energy consumption**	
 Cottons		7 kg	3.5 kg	7 kg	3.5 kg
Cupboard dry*	1400 rpm	151 min	93 min	1.33 kWh	0.80 kWh
	1000 rpm	178 min	110 min	1.65 kWh	0.97 kWh
	800 rpm	205 min	127 min	1.92 kWh	1.13 kWh
Iron dry*	1400 rpm	110 min	71 min	0.94 kWh	0.61 kWh
	1000 rpm	137 min	88 min	1.24 kWh	0.80 kWh
	800 rpm	166 min	111 min	1.55 kWh	1.04 kWh
 Easy-Care		3.5 kg		3.5 kg	
Cupboard dry*	800 rpm	64 min		0.54 kWh	
	600 rpm	78 min		0.68 kWh	

* Programme setting for testing in accordance with the applicable EN61121 standard.

** The values may differ from those specified, depending on the type of fabric, composition of laundry to be dried, residual moisture in the fabric, the degree of dryness that has been set, the amount of laundry being loaded and the environmental conditions.

Most efficient programme for cotton fabrics

The following "standard cottons programme" (identified with ) is suitable for drying normal, wet cotton laundry and is most efficient in terms of its combined energy consumption for drying wet cotton laundry.

Standard programme for cottons in accordance with current EU regulation 932/2012

Programme	Load	Energy consumption	Programme duration
 Cottons Cupboard dry	7 kg/3.5 kg	1.65 kWh/0.97 kWh	178 min/110 min

Programme setting for testing and energy labelling in accordance with Directive 2010/30/EU.

Optional accessories (order from the after-sales service using the order number, depending on the model)

WTZ 20410 Washer-dryer stack connection set
The dryer can be placed on top of a suitable washing machine with the same width and depth to save space. The dryer **must be** fastened to the washing machine using this connection set. WTZ 11400: with pull-out worktop.

WTZ 10290 Installation underneath the worktop
Instead of the appliance covering plate, you **must** have a metal cover fitted by a specialist.

WMZ 20500 Platform
For easier loading and unloading. The basket contained in the drawer can be used to carry the laundry.

WMZ 20600 Wollens basket
For drying **individual** wollen fabrics, sports shoes and soft toys (see separate instructions for "Woollens basket").

Normal noises

During drying, the compressor and the pump generate some noise which is entirely normal.

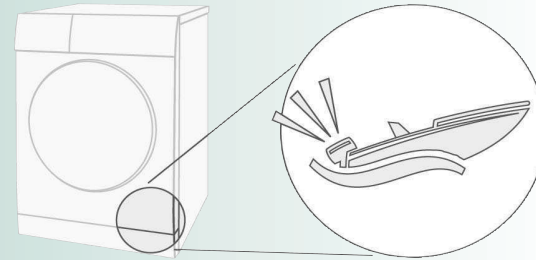

The compressor in the dryer may occasionally generate a humming noise. The volume and pitch of this may vary depending on the selected programmes and the progress of the drying.

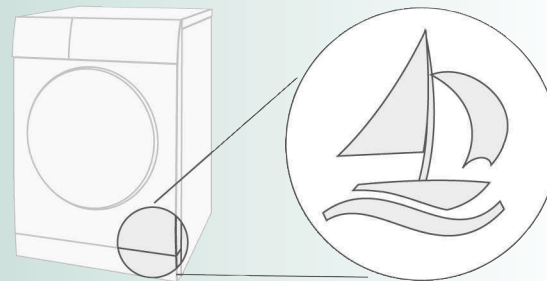

The compressor in the dryer is ventilated from time to time, which creates a whirring sound.

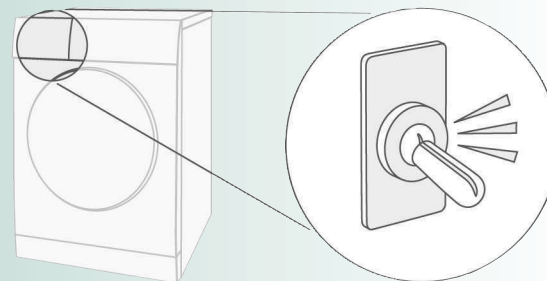



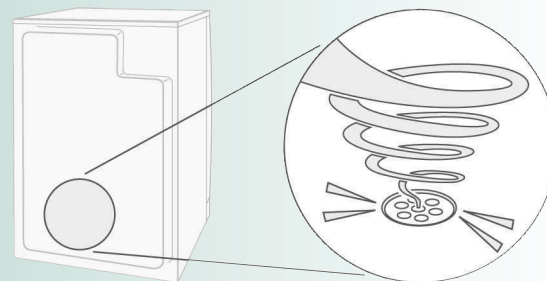



The automatic cleaning process causes a clicking noise.





The process of pumping the condensation into the condensate container generates pumping noises.

What to do if...

	If you cannot rectify a fault yourself (e.g. switching off/on), please contact our after-sales service. We will always find an appropriate solution and will avoid unnecessary visits by engineers. Trust the expertise of the manufacturer and rest assured that the repair will be carried out by trained service technicians using original spare parts. The contact details of your local after-sales service can be found in the enclosed after-sales service directory, or by calling one of these numbers: – GB 0344 892 8979 (Calls charged at local or mobile rate.) – IE 01450 2655 (0.03 € per minute at peak. Off peak 0.0088 € per minute.) When contacting the after-sales service, please quote the appliance's product number (E no.) and production number (FD) (see under the loading door). Turn the programme selector to Off and unplug the mains plug from the socket.	
●	The  Start/Stop indicator lamp does not light up.	Mains plug plugged in? Programme selected? Check the socket fuse.
●	The display panel light and indicator lights (<i>depending on model</i>) go out and the  Start/Stop indicator light flashes.	Energy-saving mode is activated → see the separate <i>Energy-saving mode</i> instructions.
●	The Container indicator lamp and the  Start/Stop button are flashing.	Empty the condensate container → <i>page 4</i> . Clean the condensate container filter if necessary → <i>page 9</i> . Dryer transported? → Wait 2 hours and start again.
●	The Clean indicator lamp and  Start/Stop button are flashing.	Rinse the fluff filter under running water → <i>page 4</i> .
●	Dryer does not start.	 Start/Stop button selected? Door closed? Ambient temperature greater than 5 °C? The optimum ambient temperature for drying is between 5 °C and 35 °C.
●	Water is leaking out.	Make sure the dryer is level.
●	The door opens by itself.	Push the door closed until you hear it click into place.
●	Creasing.	Laundry load exceeded? Remove articles of clothing immediately after the end of the programme, hang up and pull into shape. Unsuitable programme selected → <i>page 7</i> .
●	Laundry is not dried correctly or is still too damp.	After the end of the programme, warm laundry feels damper than it actually is. Spread the laundry out and allow the heat to disperse. Finely adjust the dryness level – this extends the drying time but does not increase the temperature. Your laundry will become drier. Select a programme with a longer drying time or increase the drying level. This does not increase the temperature. Select a time programme for extended drying of laundry that is still damp. If you have exceeded the maximum load for the programme, the laundry may not be dried correctly. Clean the moisture sensor in the drum. A fine layer of limescale may adversely affect the performance of the sensors and your washing will not dry properly. Drying has been interrupted as a result of a power cut, because the condensate container is full or because the maximum drying time has been exceeded.
●	Drying time too long.	Rinse the fluff filters under running water → <i>page 4</i> . Insufficient supply of air → ensure that air can circulate. Air inlet possibly blocked → Clear inlet → <i>page 8</i> . Ambient temperature higher than 35 °C → ventilate the room. The optimum ambient temperature for drying is between 5 °C and 35 °C. Outside of this range, the drying time may increase.
●	The humidity in the room increases significantly.	Make sure the room is sufficiently ventilated.
●	Power failure.	Remove laundry from the dryer immediately and spread out. This allows the heat to dissipate. Be careful as the door, the drum and the laundry may be hot.
●	Other intermittent noises and vibrations.	Not an error. Normal noises → <i>page 11</i> .
●	Loud humming noise for several seconds.	Has the condensate container been properly inserted? → Push the condensate container all the way in. Not an error. Normal noises → <i>page 11</i> .

Safety instructions

	Emergency ONLY use the dryer...	– Pull the appliance plug out of the socket immediately or disconnect the fuse. – in rooms inside the house. – to dry fabrics.
	The dryer must NEVER...	– be used for purposes other than those described above. – be modified in terms of its technology or properties.
	Hazards	– The dryer must not be used by children or persons who have not been instructed in its use. – Do not leave children unsupervised near the dryer. – Keep pets away from the dryer. – Remove all objects from pockets, and lighters in particular → Risk of explosion . – Do not lean or sit on the door → Risk of tipping .
	Installation	– Secure loose cables → Risk of tripping . – Do not operate a dryer if there is a risk of frost.
	Mains connection	– Connect the dryer to an AC earthed socket according to specifications, otherwise it cannot be guaranteed that the appliance is completely safe. – The cable cross-section must be sufficient. – Only use earth-leakage circuit breakers with the following symbol:  – The appliance plug and socket must be compatible. – Do not use multiple plugs/connectors and/or extension cables. – Do not touch or hold the appliance plug with wet hands → Risk of electric shock . – Never pull the appliance plug out of the socket by its cable. – Do not damage the mains lead → Risk of electric shock .
	Operation	– Only load the drum with laundry. Check the contents before you switch the dryer on. – Do not use the dryer if the laundry has been in contact with solvents, oil, wax, grease or paint (e.g. hair styling products, nail varnish remover, stain remover, cleaning solvent, etc.) → Risk of fire/explosion . – The tumble dryer is not to be used if industrial chemicals have been used for cleaning. – Dust (e.g. coal dust, flour) poses a danger: Do not use the dryer → Risk of explosion – Do not put laundry containing foamed material/rubber in the dryer → elastic material may be destroyed and the dryer be damaged due to possible deformation of the foamed material. – Do not turn off the dryer until the drying process ends, unless the laundry will be removed quickly and spread out, so that the heat can dissipate. – When cleaning the fluff filter, make sure that no foreign material (down or filling material) gets into the air duct opening. If necessary, clean the drum beforehand with a vacuum cleaner. If foreign material should still get into the air duct → call the after-sales service → Risk of fire/explosion . – Light things, such as long hair, may be sucked into the air inlet of the dryer → Risk of injury . – Final part of a tumble dryer cycle occurs without heat (cool down cycle), to ensure that the items are left at a temperature that ensures that the items will not be damaged. – Switch off the dryer once the programme has ended. – The water from condensation is not drinking water and may be contaminated with fluff.
	Defect	– Do not use the dryer if it is defective or if you suspect that it is. Repairs must only be carried out by the after-sales service. – Do not use the dryer if the mains cable is defective. To avoid danger, only have the defective mains cable replaced by the after-sales service.
	Spare parts	– Only use genuine spare parts and accessories for safety reasons.
	Disposal	– Pull out the appliance plug, then cut off the mains cable from the appliance. Dispose of at a municipal waste disposal facility. – The dryer's heat exchanger contains fluorinated greenhouse (R134a) gas in a hermetically sealed unit → dispose of in a proper manner. Capacity: 0.220 kg. Total GWP: 0.315 tCO ₂ . – Packaging: Keep all packaging out of reach of babies and children → Risk of suffocation . – All materials are environmentally sound and can be reused. Dispose of in an environmentally-responsible manner.



Register your new Bosch now:
www.bosch-home.com/welcome



Dryer
WTW84161GB



en Operating and installation instructions