

SIEMENS

Operating and
installation instructions

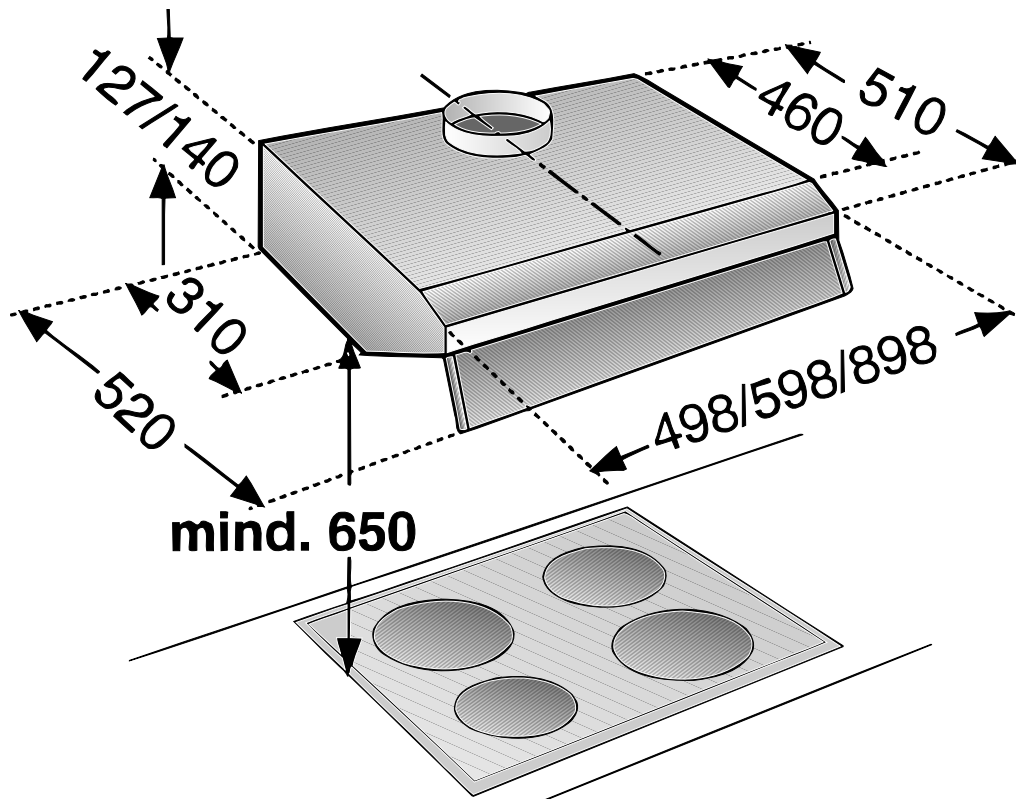



⚠ Important safety information

Read these instructions carefully. Only then will you be able to operate your appliance safely and correctly. Retain the instruction manual and installation instructions for future use or for subsequent owners.

The appliance can only be used safely if it is correctly installed according to the safety instructions. The installer is responsible for ensuring that the appliance works perfectly at its installation location.

This appliance is intended for domestic use and the household environment only. The appliance is not intended for use outside. Do not leave the appliance unattended during operation. The manufacturer is not liable for damage which is caused by improper use or incorrect operation.

This appliance may be used by children over the age of 8 years old and by persons with reduced physical, sensory or mental capacity or by persons with a lack of experience or knowledge if they are supervised or are instructed by a person responsible for their safety how to use the appliance safely and have understood the associated hazards.

Children must not play with the appliance. Children must not clean the appliance or carry out general maintenance unless they are at least 8 years old and are being supervised.

Keep children below the age of 8 years old at a safe distance from the appliance and power cable.

Check the appliance for damage after unpacking it. Do not connect the appliance if it has been damaged in transport.

This appliance is not intended for operation with an external clock timer or a remote control.

Danger of suffocation!

Packaging material is dangerous to children. Never allow children to play with packaging material.

Danger of death!

Risk of poisoning from flue gases that are drawn back in.

Always ensure adequate fresh air in the room if the appliance is being operated in exhaust air mode at the same time as room air-dependent heat-producing appliance is being operated.

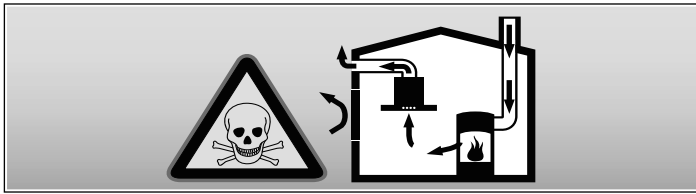

Room air-dependent heat-producing appliances (e.g. gas, oil, wood or coal-operated heaters, continuous flow heaters or water heaters) obtain combustion air from the room in which they are installed and discharge the exhaust gases into the open air through an exhaust gas system (e.g. a chimney).

In combination with an activated vapour extractor hood, room air is extracted from the kitchen and neighbouring rooms - a partial vacuum is produced if not enough fresh air is supplied. Toxic gases from the chimney or the extraction shaft are sucked back into the living space.

- Adequate incoming air must therefore always be ensured.
- An incoming/exhaust air wall box alone will not ensure compliance with the limit.

Safe operation is possible only when the partial vacuum in the place where the heat-producing appliance is installed does not exceed 4 Pa (0.04 mbar). This can be achieved when the air needed for combustion is able to enter through openings that cannot be sealed, for example in doors, windows, incoming/exhaust air wall boxes or by other technical means.

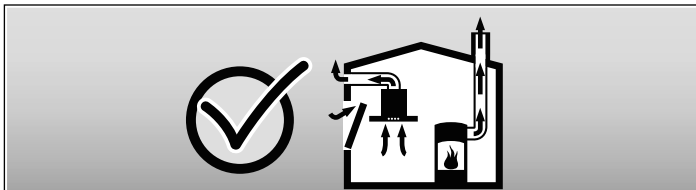

In any case, consult your responsible Master Chimney Sweep. He is able to assess the house's entire ventilation setup and will suggest the suitable ventilation measures to you.

Unrestricted operation is possible if the vapour extractor hood is operated exclusively in the circulating-air mode.

Risk of fire!

- Grease deposits in the grease filter may catch fire.

Clean the grease filter at least every 2 months.

Never operate the appliance without the grease filter.

- Grease deposits in the grease filter may catch fire. Never work with naked flames close to the appliance (e.g. flambéing). Do not install the appliance near a heat-producing appliance for solid fuel (e.g. wood or coal) unless a closed, non-removable cover is available. There must be no flying sparks.
- Hot oil and fat can ignite very quickly. Never leave hot fat or oil unattended. Never use water to put out burning oil or fat. Switch off the hotplate. Extinguish flames carefully using a lid, fire blanket or something similar.
- When gas burners are in operation without any cookware placed on them, they can build up a lot of heat. A ventilation appliance installed above the cooker may become damaged or catch fire. Only operate the gas burners with cookware on them.
- Operating several gas burners at the same time gives rise to a great deal of heat. A ventilation appliance installed above the cooker may become damaged or catch fire. Never operate two gas burners simultaneously on the highest flame for longer than 15 minutes. One large burner of more than 5 kW (wok) is equivalent to the power of two gas burners.

Risk of burns!

The accessible parts become very hot when in operation. Never touch hot parts. Keep children at a safe distance.

Risk of injury!

- Components inside the appliance may have sharp edges. Wear protective gloves.
- Items placed on the appliance may fall down. Do not place any objects on the appliance.

Risk of electric shock!

- A defective appliance may cause electric shock. Never switch on a defective appliance. Unplug the appliance from the mains or switch off the circuit breaker in the fuse box. Contact the after-sales service.
- Incorrect repairs are dangerous. Repairs may only be carried out and damaged power cables replaced by one of our trained after-sales technicians. If the appliance is defective, unplug the appliance from the mains or switch off the circuit breaker in the fuse box. Contact the after-sales service.
- Penetrating moisture may cause an electric shock. Do not use any high-pressure cleaners or steam cleaners.

Causes of damage

Caution!

Risk of damage due to corrosion. Always switch on the appliance while cooking to avoid condensation. Condensate can produce corrosion damage.

Always replace faulty bulbs to prevent the remaining bulbs from overloading.

Risk of damage due to ingress of humidity into the electronic circuitry. Never clean operator controls with a wet cloth.

Surface damage due to incorrect cleaning. Clean stainless steel surfaces in the direction of the grain only. Do not use any stainless steel cleaners for operator controls.

Surface damage due to strong or abrasive cleaning agents. Never use strong and abrasive cleaning agents.

Risk of damage from returning condensate. Install the exhaust duct in such a way that it falls away from the appliance slightly (1° slope).

Operating instructions:

Description of appliance

Heat shield

(hinged to increase the suction area)

Switch/light/ fan

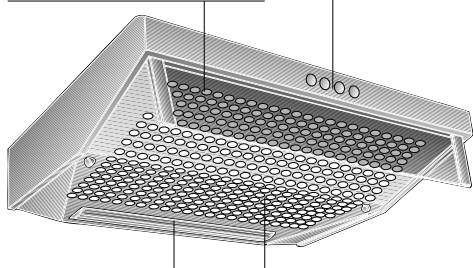

Light

Filter grille

Operating modes

Exhaust-air mode:

- The extractor-hood fan extracts the kitchen vapours and conveys them through the grease filter into the atmosphere.
- The grease filter absorbs the solid particles in the kitchen vapours.
- The kitchen is kept almost free of grease and odours.

⚠ If the extractor hood is operated in exhaust-air mode at the same time as a flue-type heater (e.g. gas, oil or solid-fuel heater, instantaneous water heater, boiler), ensure that there is an adequate air supply which the heater requires for combustion.

Safe operation is possible provided that the partial vacuum in the room in which the heater is installed does not exceed 4 Pa (0.04 mbar).

This can be achieved if the combustion air is able to flow through non-lockable openings, e.g. in doors, windows and in conjunction with an air supply/air-intake wall box or by other technical procedures such as reciprocal interlocking.

If the air intake is inadequate, there is a risk of poisoning from combustion gases which are drawn back into the room.

An air-intake/exhaust-air wall box by itself is no guarantee that the limiting value will not be exceeded.

Note: When assessing the overall requirement, the combined ventilation system for the entire household must be taken into consideration. This rule does not apply to the use of cooking appliances, such as hobs and ovens.

Unrestricted operation is possible if the extractor hood is used in recirculating mode – with activated carbon filter.

Operating modes

Circulating-air mode:

- An activated carbon filter must be fitted for this operating mode (see Filters and maintenance). The activated carbon filter can be purchased as an optional accessory FROM YOUR DEALER. The corresponding accessory numbers can be found at the end of these operating instructions.
 - The extractor-hood fan extracts the kitchen vapours which are purified in the grease filter and activated carbon filter and then conveyed back into the kitchen.
 - The grease filter absorbs the grease particles in the kitchen vapours.
 - The activated carbon filter binds the odorous substances.
- ⚠** If no activated carbon filter is installed, it is not possible to bind the odorous substances in the cooking vapours.
- ⚠** If the extractor hood is switched from exhaust-air mode to circulating-air mode, the exhaust-air opening must be sealed to prevent a hazardous situation (see optional accessories in the Instructions for use).

Before using for the first time

Important notes:

- The Instructions for Use apply to several versions of this appliance. Accordingly, you may find descriptions of individual features that do not apply to your specific appliance.
- This extractor hood complies with all relevant safety regulations.
Repairs should be carried out by qualified technicians only.
Improper repairs may put the user at considerable risk.
- Before using your appliance for the first time, please read these Instructions for Use carefully. They contain important information concerning your personal safety as well as on use and care of the appliance.
- Please retain the operating and installation instructions for a subsequent owner.

Before using for the first time

- ⚠** Do not use the appliance if damaged.
- ⚠** The appliance is not intended for use by young children or infirmed persons without supervision. Young children should be supervised to ensure they do not play with the appliance.
- ⚠** If the connecting cable for this appliance is damaged, the cable must be replaced by the manufacturer or his customer service or a similarly qualified person in order to prevent serious injury to the user.
- ⚠** The appliance may be connected to the mains by a qualified technician only.
- ⚠** Dispose of packaging materials properly (see Installation instructions).
- ⚠** This extractor hood is designed for domestic use only.
- ⚠** Light bulbs must always be fitted when the extractor hood is in use.
- ⚠** Defective bulbs should be replaced immediately to prevent the remaining bulbs from overloading.
- ⚠** Never operate the extractor hood without a grease filter.
- ⚠** Overheated fat or oil can easily catch fire.
If you are cooking with fat or oil, e.g. chips, etc., never leave the cooker unattended.
- ⚠** Do not flambé food directly under the extractor hood.
! Risk of grease filter catching fire due to flames.
- ⚠** The hotplates must always be covered with a utensil.
- ⚠** Restrictions apply to the use of the extractor hood over a solid-fuel burner (coal, wood, etc.). (See Installation instructions).

Gas hobs / Gas cookers

- ⚠** Do not use all the gas hotplates simultaneously for a prolonged period (max. 15 minutes) at maximum thermal load, otherwise there is a risk of burns if the housing surfaces are touched or a risk of damage to the extractor hood. If the extractor hood is situated over a gas hob, operate the hood at maximum setting if three or more gas hotplates are operated simultaneously.

Operating the extractor hood

 Cooking vapours are best eliminated by:

- Switching on the extractor hood** when you start cooking.
- Only switching off the extractor hood** a few minutes after you have finished cooking.

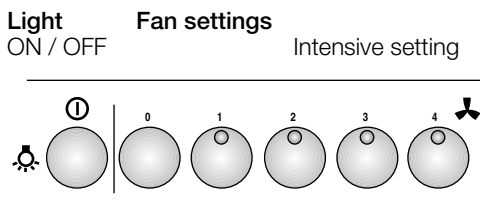
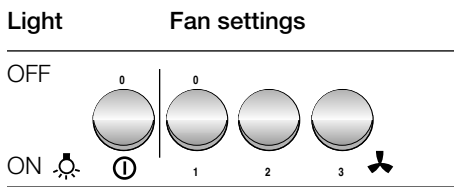
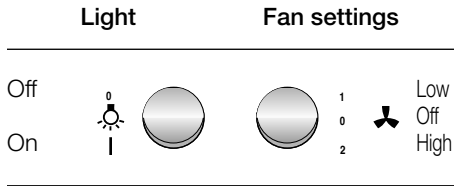

Filters and maintenance

Different grease filters can be used to absorb the grease particles in the kitchen vapours.

Fleece grease filter:

The filter mat consists of highly flammable material.

Warning:

A build up of greasy residue increases flammability, and the function of the extractor hood may be impaired.

Important:

Replace the fleece grease filter in good time, otherwise there is a risk of fire from the heat which accumulates during deep-fat frying or roasting.

Replacing the fleece grease filter:

- During normal operation (daily 1 to 2 hours) the fleece grease filter must be replaced every 8 to 10 weeks.
Replace printed fleece grease filters at the latest when the coloured print dissolves.
- Use only original filters.**
These comply with the safety regulations and ensure optimum function.

Disposal of the old fleece grease filter:

- Fleece grease filters do not contain any harmful substances. They can be disposed of as bio-degradable waste.

Removing and installing the metal filter:

1. Press in the interlocks on the left and right sides of the filter grille.

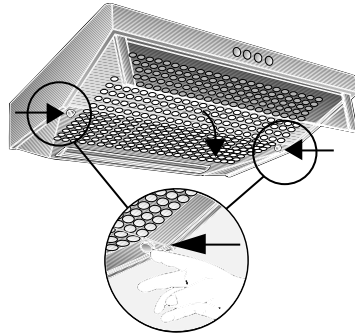

2. Remove the filter grille.

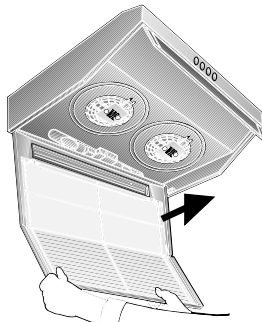

3. Remove the wire grille and the saturated filter mats.

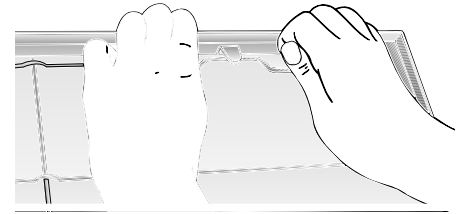

4. Clean the filter grille and insert a new filter mat.
5. Clamp the filter mat with the wire grille.
6. Re-insert the filter grille.

 The interlocks must lock into position on the left and right sides.

Metal grease filter:

The filter mats consist of non-flammable material.

Warning:

A build up of greasy residue increases flammability, and the function of the extractor hood may be impaired.

Important:

Replace the metal grease filter in good time, otherwise there is a risk of fire from the heat which accumulates during deep-fat frying or roasting.

Cleaning the metal grease filter:

- During normal operation (daily 1 to 2 hours) the metal grease filter must be replaced every 8 to 10 weeks.
- The metal grease filter can be cleaned in the dishwasher.
Slight discoloration may occur.
- Important:**
Do not clean heavily saturated metal grease filters with other dishes.
- If cleaning by hand, soak the grease filters in a hot soapy solution.
Then brush off any residual grease, rinse thoroughly and leave to dry.
- Use only original filters.**
These ensure optimum function.

Filters and maintenance

Removing and installing the metal filter
(See details for removing/inserting the fleece filter):

1. Clean the filter grille and the filter mats.
2. Re-insert the cleaned filter mats and clamp them with the wire grille. Ensure that there is no gap in the middle.

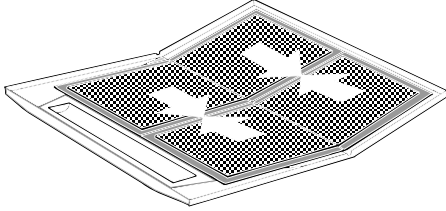

Activated carbon filter:

For binding the odorous substances in circulating-air mode.

(See details for removing/inserting the fleece filter.)

1. Insert the screws through the wing nuts and sleeves and screw the screws into the left and right sides of the intermediate base (required only during the initial installation). Screws, wing nuts and sleeves are enclosed with the activated carbon filter –.
2. Using a screwdriver or similar tool, press the two lugs on the housing inwards (required only during the initial installation).

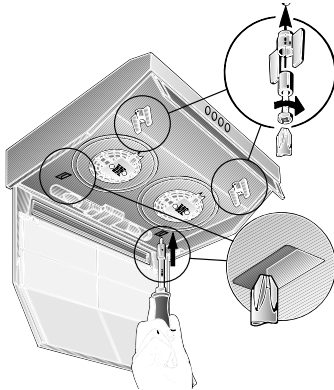

3. Insert the activated carbon filter at the rear, fold up and lock into position on the left and right with the wing nuts.

⚠ The lugs on the left and right sides of the activated carbon filter are folded in for the 50 cm wide extractor hood. They must be folded up for the 60 cm and 90 cm wide extractor hoods.

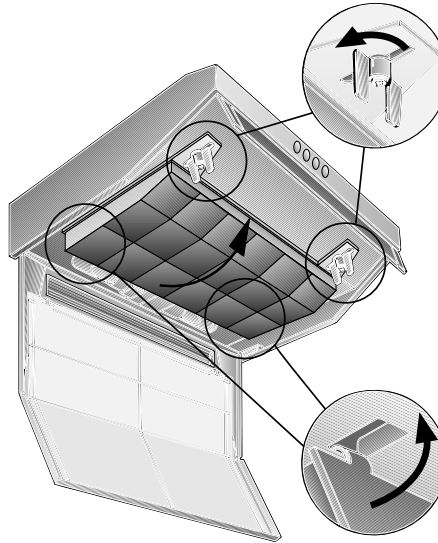

Replacing the activated carbon filter:

- During normal operation (daily 1 to 2 hours) the activated carbon filter must be replaced approximately 1 x year.
- The activated carbon filter can be purchased FROM YOUR DEALER (see Optional accessories).
- Use only original filters.** These ensure optimum function.

Disposal of the old activated carbon filter:

- Activated carbon filters do not contain any harmful substances. They can be disposed of as residual waste.

Cleaning and care

Isolate the extractor hood by pulling out the mains plug or switching off the fuse.

- When cleaning the grease filters, remove grease deposits from accessible parts of the housing. This prevents the risk of fire and ensures that the extractor hood continues operating at maximum efficiency.
- Clean the extractor hood with a hot soap solution or a mild window cleaner.
- Do not scrape off dried-on dirt but wipe off with a damp cloth.
- Do not use scouring agents or abrasive sponges.
- Note:** Do not use alcohol (spirit) on plastic surfaces, as dull marks may appear.

Caution: Ensure that the kitchen is adequately ventilated. Avoid naked flames!

⚠ Clean the operating buttons with a mild soapy solution and a soft, damp cloth only. Do not use stainless-steel cleaner to clean the operating buttons.

Stainless steel surfaces:

- Use a mild non-abrasive stainless steel cleaner.
- Clean the surface in the same direction as it has been ground and polished.

⚠ Do not use any of the following to clean stainless steel surfaces: abrasive sponges, cleaning agents containing sand, soda, acid or chloride!

Aluminium and plastic surfaces:

- Use a soft, non-linting window cloth or micro-fibre cloth.
- Do not use dry cloths.
- Use a mild window cleaning agent.
- Do not use aggressive, acidic or caustic cleaners.
- Do not use abrasive agents.

Replacing the light bulbs

1. Switch off the extractor hood and isolate the extractor hood by pulling out the mains plug or switching off the fuse.
2. Remove the grease filter (see Filters and maintenance).
3. Replace the bulb (standard filament bulb, max 40 W, E14 bulb holder).

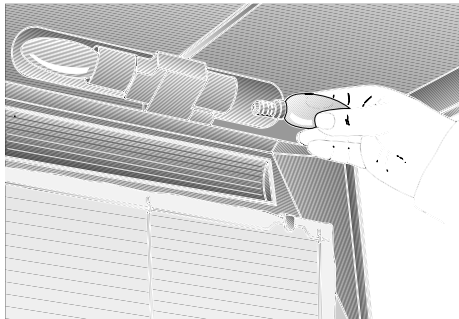

4. Re-insert the grease filters.
5. Reconnect the power by inserting the mains plug or by switching on the fuse.

Malfunctions

Please contact customer service regarding any queries or malfunctions.
(See customer-service directory).

When calling, please quote:

E-No.	FD
-------	----

Enter the numbers in the above box. The numbers can be found on the rating plate – remove the grease filter inside the extractor hood to reveal the rating plate.

Installation Instructions:

Important information

⚠ Old appliances are not worthless rubbish. Valuable raw materials can be reclaimed by recycling old appliances. Before disposing of your old appliance, render it unusable.

⚠ You received your new appliance in a protective shipping carton. All packaging materials are environmentally friendly and recyclable. Please contribute to a better environment by disposing of packaging materials in an environmentally-friendly manner.

Please ask your dealer or inquire at your local authority about current means of disposal.

⚠ The extractor hood can be used in exhaust air or circulating air mode.

⚠ Always mount the extractor hood over the centre of the hob.

⚠ Minimum distance between electric hob and bottom edge of extractor hood: **650 mm**, Fig. 1.

⚠ The extractor hood must not be installed over a solid fuel cooker – a potential fire hazard (e.g. flying sparks) – unless the cooker features a **closed, non-removable cover** and all national regulations are observed.

⚠ The smaller the gap between the extractor hood and hotplates, the greater the likelihood that droplets will form on the underside of the extractor hood.

Additional information concerning gas cookers:

⚠ When installing gas hotplates, comply with the relevant national statutory regulations (e.g. in Germany: Technische Regeln Gasinstallation TRG1).

⚠ Always comply with the currently valid regulations and installation instructions supplied by the gas appliance manufacturer.

⚠ Only one side of the extractor hood may be installed next to a high-sided unit or high wall. Gap at least 50 mm.

⚠ Minimum distance on gas hotplates between the upper edge of the trivet and lower edge of the extractor hood: **650 mm**, Fig. 1.

Prior to installation

Exhaust-air mode

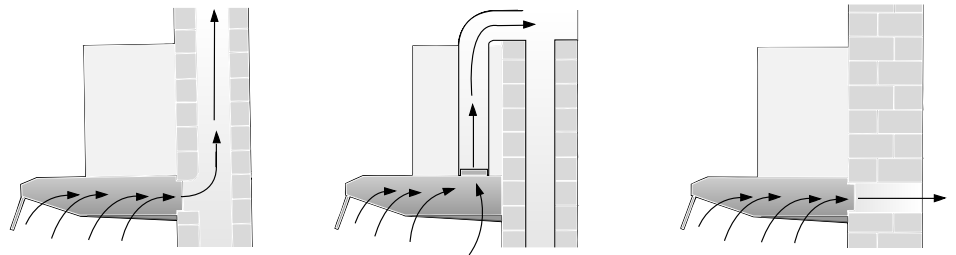

The exhaust air is discharged upwards through a ventilation shaft or directly through the outside wall into the open.

✂ Exhaust air must not be discharged via a smoke or exhaust gas flue which is already in use or via a shaft which is used for ventilating rooms in which fireplaces are located.

Discharge exhaust air in accordance with official and statutory regulations (e.g. national building regulations).

Discharge of air into smoke or exhaust air flues which are not in use requires the consent of a heating engineer.

✂ **If the extractor hood is operated in exhaust-air mode at the same time as a flue-type heater (e.g. gas, oil or solid-fuel heater, instantaneous water heater, boiler), ensure that there is an adequate air supply** which the heater requires for combustion.

Safe operation is possible provided that the partial vacuum in the room in which the heater is installed does not exceed 4 Pa (0.04 mbar).

This can be achieved if the combustion air is able to flow through non-lockable openings, e.g. in doors, windows and in conjunction with an air supply/air-intake wall box or by other technical procedures such as reciprocal interlocking.

This can be achieved if the combustion air is able to flow through non-lockable openings, e.g. in doors, windows and in conjunction with an air supply/air-intake wall box or by other technical procedures such as reciprocal interlocking.

If the air intake is inadequate, there is a risk of poisoning from combustion gases which are drawn back into the room.

An air-intake/exhaust-air wall box by itself is no guarantee that the limiting value will not be exceeded.

Note: When assessing the overall requirement, the combined ventilation system for the entire household must be taken into consideration. This rule does not apply to the use of cooking appliances, such as hobs and gas cookers.

The extractor hood can be used without restriction in circulating air mode – with an activated carbon filter.

An extractor hood which is operated in **exhaust-air mode** should be fitted with a one-way flap if there is no one-way flap in the exhaust-air pipe or wall box. If a one-way flap is not supplied with the appliance, you can purchase one from your dealer (see optional accessories in the Instructions for use).

⚠ **Do NOT cut out the inner part of the exhaust-air connection.**

Fitting the one-way flap:

- Insert the two lugs on the one-way flap into the holes in the exhaust-air connection.

Before installation

If the exhaust air is conveyed through the exterior wall, a telescopic wall box should be used.

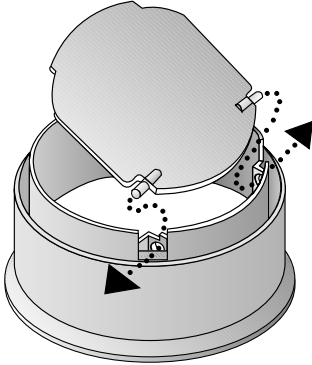

Optimum performance of the extractor hood:

- Short, smooth exhaust-air pipe.
- Minimum number of pipe bends.
- Largest possible pipe diameter (120 mm dia. recommended) and large pipe bends.

If long, rough exhaust-air pipes, many pipe bends or smaller pipe diameters are used, the air extraction rate will no longer be at an optimum level and there will be an increase in noise.

- Round pipes:**
Short discharge pipe:
 Inner diameter at least 100 mm,
extended discharge pipe:
 Inner diameter at least 120 mm.
- Flat ducts** must have an **inner cross-section equivalent** to round pipes with an inner diameter of 100/120 mm.
There should be no sharp bends.
 100 mm dia approx. 78 cm²
 125 mm dia approx. 113 cm²
- If pipe diameters differ:**
 Insert sealing strip.
- Ensure an adequate air supply for **exhaust-air mode.**

Exhaust air upwards:

Pipe diameter: 100 or 120 mm

- Break off cover on the top of the extractor hood; strike the retaining points with a tool.

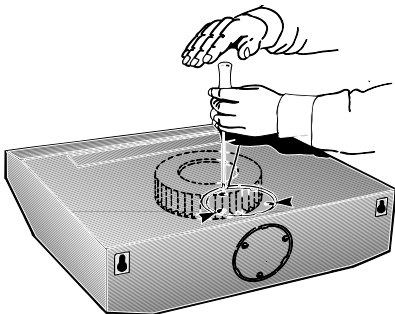

⚠ To prevent damage to the fan, hold the tool vertically.

- Remove the broken off metal part (possibly a noisy and disruptive procedure).
- If the pipe diameter is 120 mm, cut out the inner part of the exhaust-air connection.

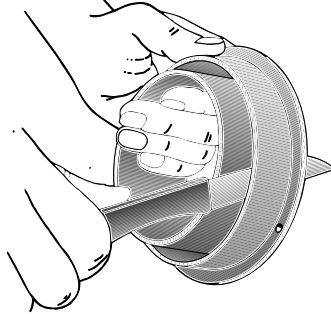

- Insert the exhaust-air connection and turn as far as possible.

Exhaust air towards the rear:

Pipe diameter: 100 mm

- Break off cover on the rear panel of the extractor hood; strike the retaining points with a tool.

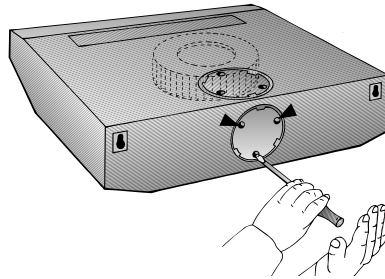

⚠ To prevent damage to the fan, hold the tool vertically.

- Remove the broken off metal part (possibly a noisy and disruptive procedure).
- If the extractor hood has 2 motors, the opening on the plastic part must be made at the rear; cut through the 3 ribs and remove the cut-off part.

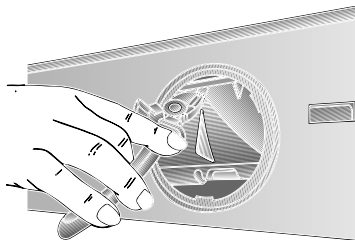

- Cut off the outer part of the exhaust-air connection.

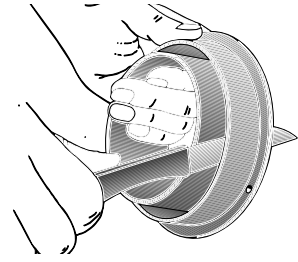

- Insert the inner part and turn as far as possible.

Circulating-air mode

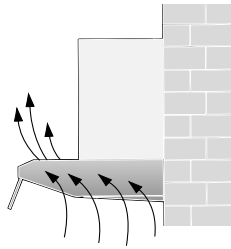

- With activated carbon filter if exhaust-air mode is not possible.
- The air purified by an additional activated carbon filter is conveyed back into the room.
- For insertion of the activated carbon filter see Instructions for use.
- If the extractor hood is switched from exhaust-air mode to circulating-air mode, the exhaust-air opening must be sealed to prevent a hazardous situation (see optional accessories in the Instructions for use).

Electrical connection

WARNING: THIS APPLIANCE MUST BE EARTHED

IMPORTANT: Fitting a Different Plug:

The wires in the power cord are colour-coded as follows:

Green and Yellow	– Earth
Blue	– Neutral
Brown	– Live

If you fit your own plug, the colours of these wires may not correspond with the identifying marks on the plug terminals.

Proceed as follows:

1. Connect the green and yellow (Earth) wire to the terminal in the plug marked 'E' or with the symbol (\equiv), or coloured green or green and yellow.
2. Connect the blue (Neutral) wire to the terminal in the plug marked 'N' or coloured black.
3. Connect the brown (Live) wire to the terminal marked 'L', or coloured red.

The extractor hood may be connected to a correctly installed earthed socket only. Attach the earthed socket near the extractor hood in an accessible position.

- The earthed socket should be connected via its own power circuit.

⚠ If appliances do not feature the OFF delay function, the indicator may start flashing when the extractor hood has been switched off for several hours via a separate switch, even though the grease filters are not yet saturated.

(See instructions for use, section on filter and maintenance).

Electrical specifications:

These can be found on the rating plate inside the appliance following removal of the filter frames.

⚠ Before carrying out repairs, always isolate the appliance.

Length of the connection cable: 1.30 m.

If permanent connection is required:

The extractor hood may only be connected by an electrician registered with the local electricity board.

A disconnecting device must be provided on the installation side. Switches with a contact opening of more than 3 mm and all-pole disconnection are regarded as disconnecting devices. These include LS switches and contactors.

This extractor hood complies with EU regulations on interference suppression.

Fitting the extractor hood

To the wall

50 cm wide extractor hood:
With 3 screws.

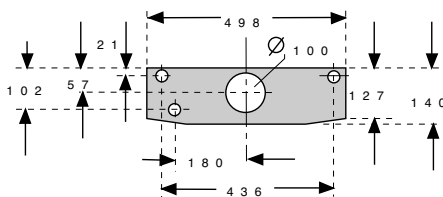

60 cm wide extractor hood:
With 3 screws.

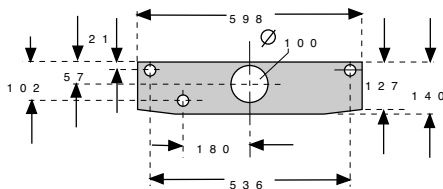

90 cm wide extractor hood:
With 5 screws.

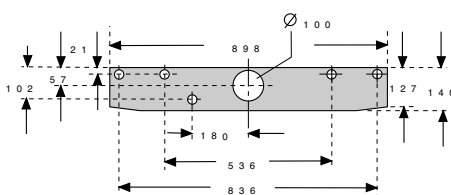

1. Mark mounting boreholes. Dimensions can be found in or use template.
2. Drill 8 mm dia. holes and insert wall plugs flush with the wall.
3. Screw in the upper screws (on left and right) until there is a gap of approx. 7 mm between the screw head and the wall.

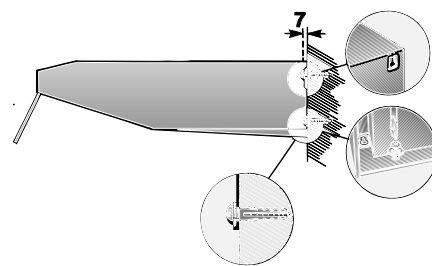

4. Remove the filter grille (see Instructions for use)
5. Attach the extractor hood.
6. Tighten the lower screw (with washer) inside the extractor hood.

To a wall-hanging cupboard

50 cm wide extractor hood:
With 4 screws.

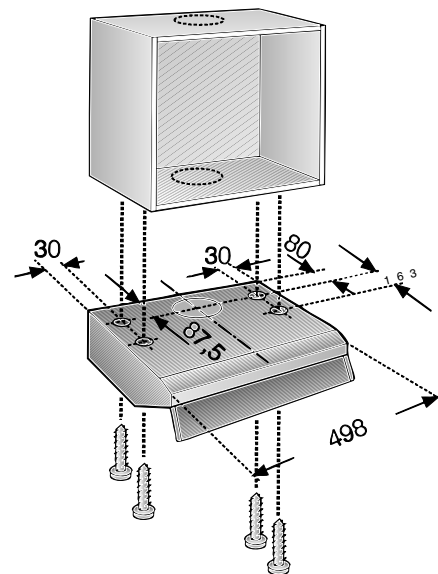

60 cm wide extractor hood:
With 4 screws.

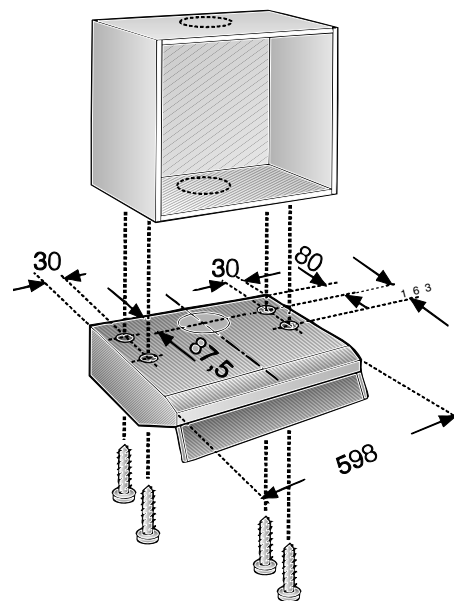

Fitting the extractor hood

90 cm wide extractor hood:
With 6 screws.

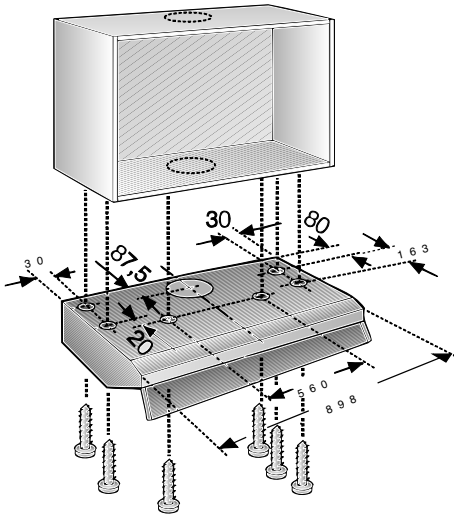

1. Dimensions for the mounting boreholes can be found in, or place a template on the base of the wall-hanging cupboard.
2. Mark the mounting holes and make pilot holes with a bradawl. In exhaust-air mode (upwards) mark the exhaust-air opening and saw out.
 - Consider the location of the connection cable; if required, saw out the cupboard.
3. Remove the filter grille (see Instructions for use).
4. Screw the extractor hood to the base of the cupboard.

Final assembly

Exhaust-air mode:

- Stick the enclosed covering foil over the air outlet grille on the top of the extractor hood. Ensure that the surface is clean.

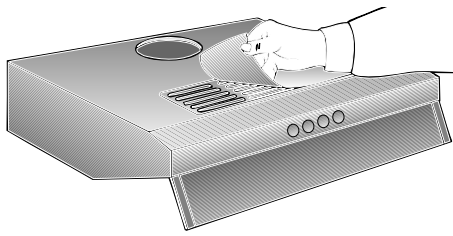

- Connect the pipes.

2-motor extractor hood

Selecting the operating mode:

- Exhaust-air mode: Position 1
- Circulating-air mode: Position 2
- Select the operating mode on the left or right with a screwdriver.

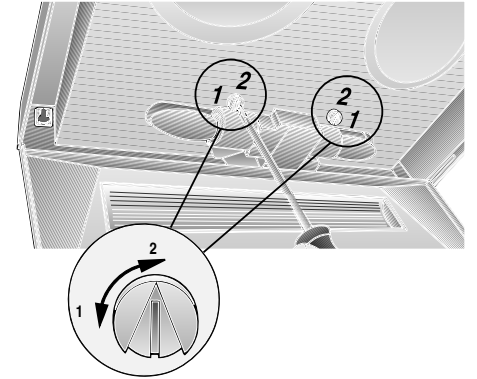

- Connect to the power supply.
- Insert the filter grille (see Instructions for use).

Weight in kg:

Width	Exhaust air	Circulating air
50 cm	7,0	8,0
60 cm 1 motor	8,0	9,0
60 cm 2 motors	10,0	11,0
90 cm	13,0	14,0

Design changes with respect to technical development shall remain withheld.

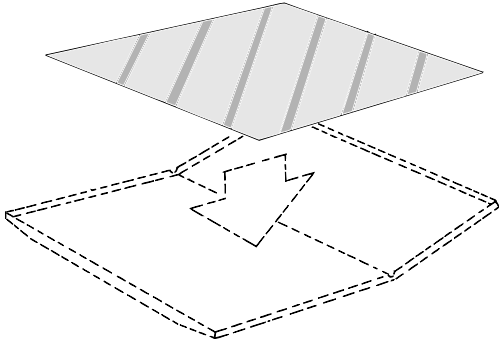
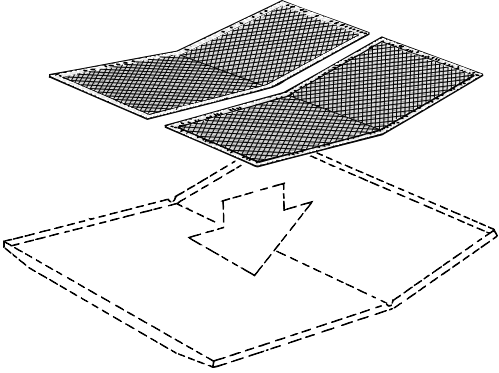
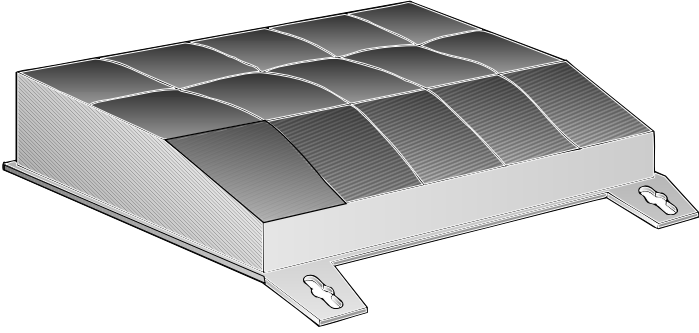
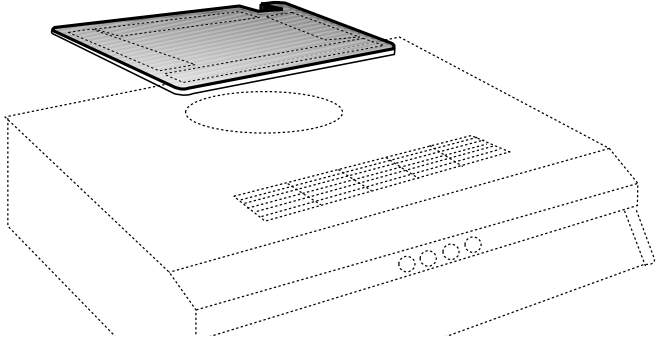
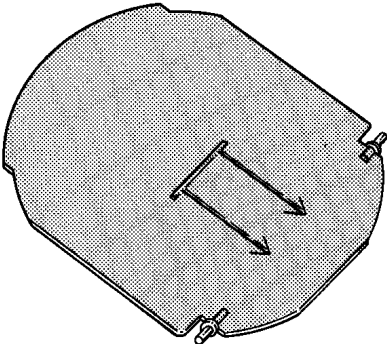
	<p>LZ 23000</p>
	<p>60 cm: LZ 16010</p> <p>90 cm: LZ 22010</p>
	<p>LZ 11000</p>
	<p>266657</p>
	<p>084848</p>

Siemens-Electrogeräte GmbH
Carl-Wery-Straße 34
81739 München
Germany



9000920931 930830