

Your washing machine

Congratulations – You have opted for a modern, high-quality domestic appliance manufactured by Siemens. The washing machine is distinguished by its economical energy consumption.

Each appliance which leaves our factory is inspected thoroughly to ensure that it functions properly and is in perfect condition.

Environmental disposal

Dispose of packaging in an environmentally friendly manner.

This appliance has been identified in accordance with the European Directive 2002/96/EG on Waste Electrical and Electronic Equipment (WEEE).

The Directive specifies the framework for an EU-wide valid return and recycling of waste appliances.



Contents

	Page
■ Intended use	1
■ Setting programmes	2
■ After washing	4
■ Individual settings	5
■ Important information	6
■ Overview of programmes	7
■ Care	8
■ Information on the display panel	8
■ Maintenance	9
■ What to do if ...	10
■ Safety instructions	11
■ Consumption values	11

Intended use

- for use in the household only,
- for the washing of machine-washable textiles in a detergent solution,
- to be operated with cold drinking water and commercially available detergents and care products which are suitable for use in washing machines.

- ⚠ Do not leave children unattended near the washing machine!
- Keep pets away from the washing machine!

Programmes

For detailed overview of programmes see *Page 7*.

Temperature and spin speed can be selected individually.

Cottons/Coloureds	} hard-wearing textiles
Stains Extra	
Stains	
Easy-Care	easy-care textiles
Silk	delicate washable textiles
Wool/🐑	hand/machine-washable textiles
Empty	the rinsing water if ⌀ occurs
Spin	washing washed by hand
Low Spin	washing washed by hand at reduced spin speed
Rinse	with subsequent spin cycle; for hand-washed items, starching or "freshen up" items, see <i>Page 6</i>
Shirts/Office wear	Non-iron shirts made of cotton, linen, synthetics fibres or blended fabrics
Outdoor	Membrane-coated textiles
Rapid	short programme
Mixed Fabrics	different types of washing
Easy-Care Dark	dark textiles

Preparation

⚠ Correct installation according to separate installation instructions.

Checking the machine

- Never switch on a damaged machine!
- Inform your customer service!

Turn on the tap

Insert mains plug

- ⚠ With dry hands only! Take hold of the plug only!

Before washing for the first time, wash once without any washing. See page 6

Sorting and inserting the washing

Follow manufacturer's care information! According to the information on the care labels. According to type; colour; soiling and temperature.

Follow important instructions! See page 6!

Insert large and small items of washing! Do not jam items of washing between the washing machine door and rubber seal.

Add detergent and care product

Meter accordingly: Washing amount, soiling, water hardness (ask your water supply company) and manufacturer's instructions. Pour liquid detergent into the appropriate dispenser and place in the drum.

- I Prewash: Detergent, starch
- ☞ Care product: Fabric softener
- II Main wash: Detergent, water softener, bleach, stain remover

ⓘ Dilute viscous fabric softener and fabric conditioner with water. Prevents blockage of the overflow.

Set and adjust programme

For additional functions and option buttons see *individual settings, page 5*.

ⓘ All buttons are sensitive, they only need to be touched gently!

Select Start

Programme selector for switching the machine on and off and for selecting the programme. Can be rotated in either direction.

Wash

1

2

Wash

Removing washing

Open washing machine door and remove washing. If ⌀ (without final spin) active: Set programme selector to **Empty** or select spin speed. Select **Start**. Remove any foreign objects – risk of rusting.

Turn off the tap

Not required for Aqua-Stop models.

Switch off

Set programme selector to **Off**.

End of programme when ...

... **Start** flashes and **-0-** is indicated on the display panel.

Change programme ...

If you have mistakenly selected a wrong programme:

- Reselect programme.
- Select **Start**.

... or terminate

Programmes with high temperature, first:

- Cool washing: Select **Rinse**. Washing machine door remains locked.
- Select **Off**.
- Select **Spin** or **Empty**.
- Select **Start**.

Individual settings

Option buttons

You can change the spin speed and temperature beforehand and while the selected programme is running. Effects dependent on the programme progress.

Temp. °C

You can change the indicated washing temperature. The maximum washing temperature which can be selected depends on the set programme.

Finish in

The respective programme duration is displayed by selecting the programme. The programme start can be delayed before the programme begins. The **Finish in** –time can be set in hour-steps up to maximum 24h (depending on model). Keep pressing the **Finish in** button until the required number of hours is indicated (h=hour). Select **Start**.

Spin rpm

You can change the indicated spin speed. The maximum spin speed which can be selected depends on the set programme.

Additional functions* see also *programme overview* (* depending on model)

Intensive Wash	Extension of the washing time for a more intensive washing of highly soiled washing or 6 kg of cottons and coloureds.
Prewash	For heavily soiled, hard-wearing washing, e.g. made of cotton or linen. Prewash at 30 °C.
Less Ironing	Special spin sequence with subsequent fluffing. Gentle final spin – residual moisture in the washing increased slightly.
Extra Rinse	Additional rinse cycle and extended washing time. For areas with very soft water or for further improvement of the rinsing result.

Start

For starting or interrupting the programme.

Signal

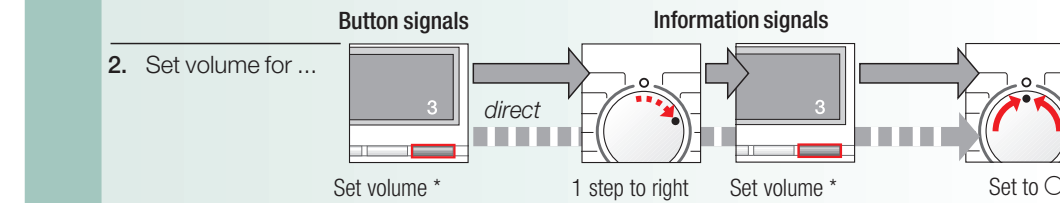
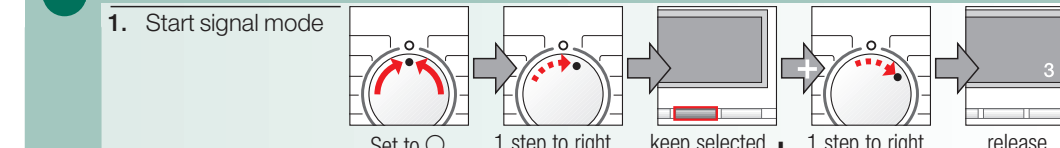

* If required, select repeatedly

Important information

Protecting the washing and the machine

- Empty pockets.
- Remove metal parts (paper clips, etc.).
- Wash delicates in the net/bag (tights, curtains, underwired bras).
- Close zips, button up covers.
- Brush sand out of pockets and collars.
- Remove curtain fittings or include in the net/bag.

Before washing for the first time

Do not put any washing in the washing machine! Turn on the tap, fill the appliance with approx. 1 litre of water and then pour ½ measuring cup of detergent into dispenser II. Set programme selector to **Easy-Care 60 °C** and select **Start**. At the end of the programme set the programme selector to **Off**.

Washing with different degrees of soiling

Light	Wash new items separately. Do not prewash.
	If required, pretreat stains. Select Intensive Wash additional function.
Heavy	Load less washing. Prewash.

Soaking

Load washing of the same colour
Pour soaking agent/detergent into dispenser II according to the manufacturer's instructions. Set programme selector to **Cottons/Coloureds 30 °C** and select **Start**. After approx. 10 minutes select **Start**. After the required soaking time reselect **Start** if the programme is to be continued or change the programme.

Starching

Washing should not be treated with fabric softener
Dissolve an amount of starch for approx. 15 litres of water according to the manufacturer's instructions. Set programme selector to **Rinse**, set spin speed and select **Start**. As soon as water runs in: Pour the starch solution into dispenser I.

Dyeing/Bleaching

Do not dye/bleach washing in the washing machine.

Freshen up

Use programme **Rinse**
For items, that have been tucked away or stored for a period of time, to remove creases caused by folding and storage and to eliminate odours. Use fabric conditioner for "fresh" smell.

Protection of the environment/conservation tips

- Utilise the maximum amount of washing for the particular programme.
- Wash normally soiled washing without prewash.
- Instead of **Cottons/Coloureds 90 °C** select **Stains 60 °C** programme. Comparable cleaning result with significantly lower energy consumption.
- Meter detergent according to the manufacturer's instructions and water hardness.
- If the washing is then dried in the tumble dryer, select spin speed according to the instructions of the dryer manufacturer.

Your washing machine

Congratulations – You have opted for a modern, high-quality domestic appliance manufactured by Siemens. The washing machine is distinguished by its economical energy consumption. Each appliance which leaves our factory is inspected thoroughly to ensure that it functions properly and is in perfect condition.



Environmental disposal

Dispose of packaging in an environmentally friendly manner.

This appliance has been identified in accordance with the European Directive 2002/96/EG on Waste Electrical and Electronic Equipment (WEEE).

The Directive specifies the framework for an EU-wide valid return and recycling of waste appliances.

Contents

Page

Intended use	1
Setting programmes	2
After washing	4
Individual settings	5
Important information	6
Overview of programmes	7
Care	8
Information on the display panel	8
Maintenance	9
What to do if ...	10
Safety instructions	11
Consumption values	11

Intended use

- for use in the household only,
- for the washing of machine-washable textiles in a detergent solution,
- to be operated with cold drinking water and commercially available detergents and care products which are suitable for use in washing machines.

- Do not leave children unattended near the washing machine!
- Keep pets away from the washing machine!

Programmes

For detailed overview of programmes see Page 7.

Temperature and spin speed can be selected individually.

Cottons/Coloureds	} hard-wearing textiles
Stains Extra	
Stains	
Easy-Care	easy-care textiles
Silk	delicate washable textiles
Wool/	hand/machine-washable textiles
Empty	the rinsing water if occurs
Spin	washing washed by hand
Low Spin	washing washed by hand at reduced spin speed
Rinse	with subsequent spin cycle; for hand-washed items, starching or "freshen up" items, see Page 6
Shirts/Office wear	Non-iron shirts made of cotton, linen, synthetics fibres or blended fabrics
Outdoor	Membrane-coated textiles
Rapid	short programme
Mixed Fabrics	different types of washing
Easy-Care Dark	dark textiles

Preparation



Correct installation according to separate installation instructions.



Checking the machine

- Never switch on a damaged machine!
- Inform your customer service!



Turn on the tap



Insert mains plug



With dry hands only!
Take hold of the plug only!



Programme selector

Off

Shirts/Office wear

Outdoor

Rapid

Mixed Fabrics

Empty

Low Spin

Spin

Rinse

Cottons/Coloureds

Stains Extra

Stains

Silk

Wool

Easy-Care

Easy-Care Dark

Display panel/Option buttons

Temp.°C

Spin rpm

Finish in

Additional functions

Intensive Wash

Pre-wash

* depending on model

90	Temp.°C	Select
1 – 24h*	Finish in	Program
1400*	Spin rpm	Select or ()
Status displays		Program
<div><div></div><div></div><div></div><div>-0-</div></div>		Washing

Before washing for the first time,
wash once without any washing. See page 6

Sorting and inserting the washing

Follow manufacturer's care information!
According to the information on the care labels.
According to type; colour; soiling and temperature.

Follow important instructions! See page 6!

Insert large and small items of washing! Do not jam items of washing between the washing machine door and rubber seal.

Add detergent and care product

Meter accordingly:
Washing amount, soiling, water hardness (ask your water supply company) and manufacturer's instructions. Pour liquid detergent into the appropriate dispenser and place in the drum.

Prewash: Detergent, starch

Care product: Fabric softener

Main wash: Detergent, water softener, bleach, stain remover

Dilute viscous fabric softener and fabric conditioner with water.
Prevents blockage of the overflow.

Set and adjust programme

For additional functions and option buttons see individual settings, page 5.

i All buttons are sensitive, they only need to be touched gently!

Select Start

Programme selector for switching the machine on and off and for selecting the programme. Can be rotated in either direction.

the temperature (* = cold)

programme ends in ...

the spin speed
(without final spin)

programme progress displays:

ing, Rinse, Spin, End

Wash

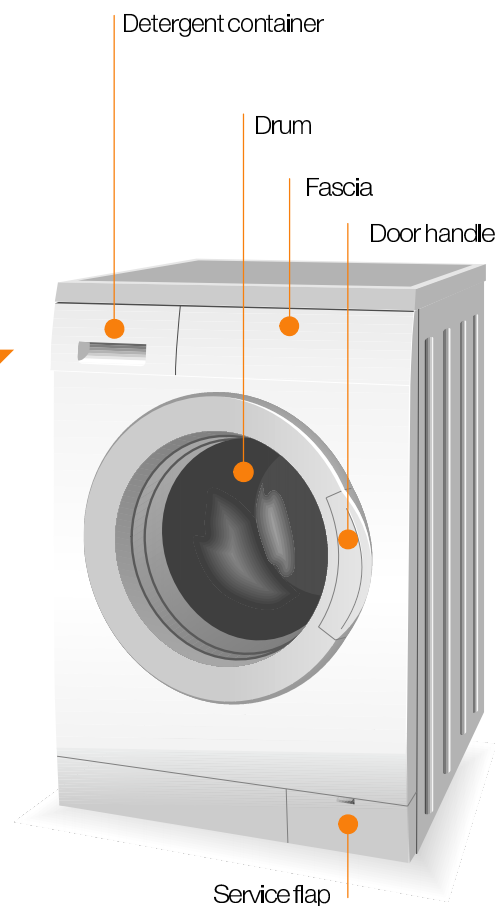

Wash

Removing washing

Open washing machine door and remove washing.
If ⌀ (without final spin) active: Set programme selector to **Empty** or select spin speed.
Select **Start**.
Remove any foreign objects – risk of rusting.

Turn off the tap

Not required for Aqua-Stop models.

Switch off

Set programme selector to **Off**.

End of programme when ...

... **Start** flashes and -0- is indicated on the display panel.

Change programme ...

If you have mistakenly selected a wrong programme:
– Reselect programme.
– Select **Start**.

... or terminate

Programmes with high temperature, first:
– Cool washing: Select **Rinse**.
Washing machine door remains locked.
– Select **Off**.
– Select **Spin** or **Empty**.
– Select **Start**.

Individual settings

Option buttons

You can change the spin speed and temperature beforehand and while the selected programme is running. Effects dependent on the programme progress.

Temp. °C

You can change the indicated washing temperature. The maximum washing temperature which can be selected depends on the set programme.

Finish in

The respective programme duration is displayed by selecting the programme. The programme start can be delayed before the programme begins. The **Finish in** –time can be set in hour-steps up to maximum 24h (depending on model). Keep pressing the **Finish in** button until the required number of hours is indicated (h=hour). Select **Start**.

Spin rpm

You can change the indicated spin speed. The maximum spin speed which can be selected depends on the set programme.

Additional functions* see also programme overview (* depending on model)

Intensive Wash	Extension of the washing time for a more intensive washing of highly soiled washing or 6 kg of cottons and coloureds.
Prewash	For heavily soiled, hard-wearing washing, e.g. made of cotton or linen. Prewash at 30 °C.
Less Ironing	Special spin sequence with subsequent fluffing. Gentle final spin – residual moisture in the washing increased slightly.
Extra Rinse	Additional rinse cycle and extended washing time. For areas with very soft water or for further improvement of the rinsing result.

Start

For starting or interrupting the programme.

Signal

1. Start signal mode

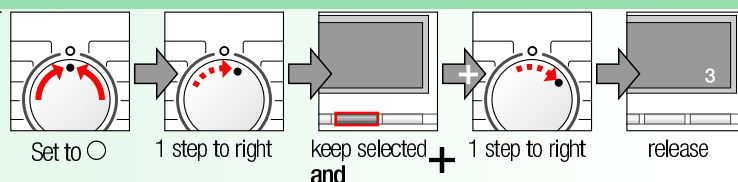

2. Set volume for ...

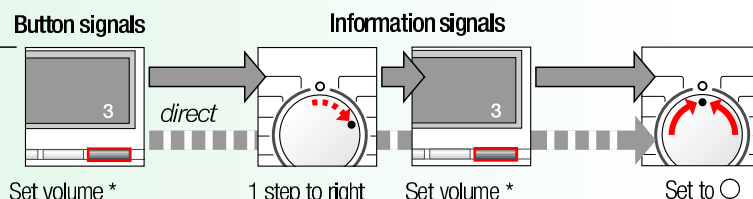

* If required, select repeatedly



Important information



Protecting the washing and the machine

- Empty pockets.
- Remove metal parts (paper clips, etc.).
- Wash delicates in the net/bag (tights, curtains, underwired bras).
- Close zips, button up covers.
- Brush sand out of pockets and collars.
- Remove curtain fittings or include in the net/bag.



Before washing for the first time



Do not put any washing in the washing machine! Turn on the tap, fill the appliance with approx. 1 litre of water and then pour ½ measuring cup of detergent into dispenser II.

Set programme selector to **Easy-Care 60 °C** and select **Start**.

At the end of the programme set the programme selector to 0 **Off**.



Washing with different degrees of soiling

Light		Wash new items separately. Do not prewash.
Heavy		If required, pretreat stains. Select Intensive Wash additional function. Load less washing. Prewash.



Soaking Load washing of the same colour

Pour soaking agent/detergent into dispenser II according to the manufacturer's instructions. Set programme selector to **Cottons/Coloureds 30 °C** and select **Start**. After approx. 10 minutes select **Start**. After the required soaking time reselect **Start** if the programme is to be continued or change the programme.



Starching Washing should not be treated with fabric softener

Dissolve an amount of starch for approx. 15 litres of water according to the manufacturer's instructions.

Set programme selector to **Rinse**, set spin speed and select **Start**. As soon as water runs in: Pour the starch solution into dispenser I.



Dyeing/Bleaching

Do not dye/bleach washing in the washing machine.



Freshen up Use programme Rinse

For items, that have been tucked away or stored for a period of time, to remove creases caused by folding and storage and to eliminate odours. Use fabric conditioner for "fresh" smell.



Protection of the environment/conservation tips

- Utilise the maximum amount of washing for the particular programme.
- Wash normally soiled washing without prewash.
- Instead of **Cottons/Coloureds 90 °C** select **Stains 60 °C** programme. Comparable cleaning result with significantly lower energy consumption.
- Meter detergent according to the manufacturer's instructions and water hardness.
- If the washing is then dried in the tumble dryer, select spin speed according to the instructions of the dryer manufacturer.



Cottons/Coloureds	**-90 °C			
Stains Extra	**-60 °C	6 kg*	Hard-wearing textiles, heat-resistant textiles made of cotton or linen	Intensive Wash, Prewash, Less Ironing, Extra Rinse
Stains				
Easy-Care	**-60 °C		Easy-care textiles made of cotton, linen, synthetic fibres or blended fabrics	Intensive Wash, Prewash, Less Ironing, Extra Rinse
Mixed Fabrics	**-40 °C	3 kg	Textiles made of cotton and easy-care textiles	Intensive Wash, Prewash, Less Ironing, Extra Rinse Different types of washing can be washed together
Easy-Care Dark	**-40 °C		Dark textiles made of cotton and dark easy-care textiles	Intensive Wash, Prewash, Less Ironing, Extra Rinse; reduced rinse and final spin cycle
Silk	**-30 °C		For delicate, washable textiles, e.g. made of silk, satin, synthetic fibres or blended fabrics (e.g. curtains)	Intensive Wash, Prewash, Less Ironing, Extra Rinse; no spin cycle between the rinse cycles
Wool	**-40 °C		Hand or machine-washable wool or rich-wool textiles	also suitable for hand-washable silk; reduced rinse and final spin cycle
Shirts/Office wear	**-60 °C	2 kg	Non-iron shirts made of cotton, linen, synthetics fibres or blended fabrics	Intensive Wash, Prewash, Extra Rinse; reduced spin cycle
Outdoor	**-40 °C		Membrane-coated textiles	Intensive Wash, Less Ironing, Extra Rinse; reduced final spin at intervals
Rapid	**-40 °C		Easy-care textiles made of cotton, linen, synthetic fibres or blended fabrics	Short programme approx. 15 minutes suitable for refreshing
Additional programmes				
Rinse, Spin, Empty, Low Spin				

i The programmes are time-controlled for lightly soiled textiles. If textiles are heavily soiled, reduce the load or select additional functions, e.g. **Intensive Wash**.
Programmes without prewash – pour detergent into dispenser **II**, programmes with prewash – divide detergent between dispensers **I** and **II**.

* Select the **Intensive Wash** additional function if washing 6 kg of cottons and coloureds.

For further information and a selection of our products go to our web site:
<http://www.siemens-haushaerate.de> or contact our customer service centres

Siemens Electrogeräte GmbH
Carl-Wey-Str. 34
81739 München / Germany

WM12E468GB...
0307
9000 250 558

Care



- Risk of electric shock!
Pull out the mains plug!
- Risk of explosion! No solvents!



Machine housing, control panel

- Wipe with a soft, damp cloth.
- Do not use abrasive detergents.
- Immediately remove washing and cleaning agent residue.
- Do not clean the appliance with a water jet.



Clean the detergent drawer ...

... if it contains detergent or fabric softener residue.

1. Pull out, depress insert, completely remove.
2. Open the cover.
3. Clean with water and dry.
4. Close and lock the cover (place cylinder on guide pin).
5. Insert detergent drawer.

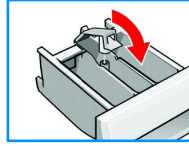
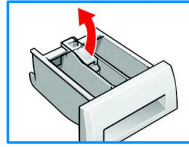
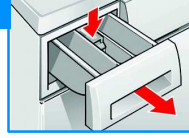

Leave detergent drawer open so that residual water can evaporate.



Drum

Leave washing machine door open so that the drum can dry out.
Rust stains – use chlorine-free cleaning agent, not steel wool.



Descaling No washing in the machine!

Descal according to the instructions of the descaling agent-manufacturer, not required for correct detergent dosage.

Information on the display panel depending on model

F:16	Close the washing machine door properly; washing may be caught.
F:17	Turn on the tap, supply hose kinked/jammed; clean filter (page 9), water pressure too low.
F:18	Clean detergent-solution pump (page 9), outlet pipe/drainage hose blocked.
F:21	Motor fault! Call customer service!
F:23	Water in the base pan, appliance leaking. Call customer service!



- Risk of scalding!
Allow detergent solution to cool down!
- Turn off the tap!

Detergent-solution pump

Set programme selector to **Off**, pull out the mains plug.

1. Open and remove service flap.
2. For models with drainage hose:
Take drainage hose out of the holder and pull out of the housing. Remove sealing cap, allow detergent solution to flow out.
Press on sealing cap and insert drainage hose into the holder.
- 2* For models without drainage hose:
Carefully unscrew pump cover until the detergent solution begins to run out.
When the service flap is half full, screw back the pump cover and empty the service flap.
Repeat steps until all the detergent solution has run out.
3. Carefully unscrew the pump cover (residual water).
4. Clean the interior, pump cover thread and pump housing (fan impeller in the detergent-solution pump must rotate).
5. Reinsert and screw on pump cover.
6. Insert and close service flap.

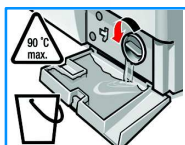
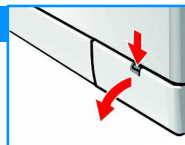

To prevent unused detergent from flowing into the outlet during the next wash:
Pour 1 litre of water into dispenser II and select the **Empty** programme.

Filters in the water supply



Risk of electric shock! Do not immerse Aqua-Stop safety device in water (contains electric valve).

Release water pressure in the supply hose:

1. Turn off the tap!
2. Select any programme (except **Spin/Empty**).
3. Press **Start**. Leave programme for approx. 40 seconds.
4. Set programme selector to **Off**.
5. Remove hose from tap.
6. Clean filter with small brush.
7. Depending on the model, remove hose from the rear of the appliance and clean the filter.
8. Connect the hose and check for leaks.

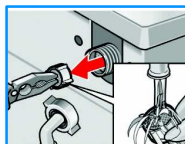

- Water is running out.
 - Correctly attach/replace drainage hose.
 - Tighten screw-fitting on the supply hose.
- Water not flowing in.
Detergent not washed in.
 - **Start** not selected?
 - Tap not open?
 - Filter blocked? Clean filter (page 9).
 - Supply hose kinked or jammed?
- Washing machine door cannot be opened.
 - Safety function active, wait for approx. 2 minutes.
 - **Ø** (without final spin) selected?
- Programme does not start.
 - **Start** selected?
 - Door closed?
- Detergent solution is not drained.
 - Clean detergent-solution pump (page 9).
 - Clean outlet pipe and/or drainage hose.
- Washing not spun correctly.
 - Distribute small and large items of washing in the drum.
- Spin cycle actuated several times.
 - Not a fault – unbalanced load detection system adjusts imbalance.
- Water not visible in the drum.
 - Not a fault – water below the visible area.
- Residual water in the dispenser for care product.
 - Not a fault – effect of the care product not impaired.
- Odour formation in the washing machine.
 - Run **Cottons 90 °C** programme without washing. Use standard detergent.
- Foam is coming out of the detergent drawer.
 - Too much detergent used?
 - Mix 1 tablespoon of fabric conditioner with ½ litre of water and pour into dispenser II in the detergent drawer.
 - Reduce detergent dosage for the next wash cycle.
- Vibrations during spin cycle.
 - Appliance feet fixed? Secure appliance feet (Installation instructions).
 - Transportation safety devices removed? Remove transportation safety devices (Installation instructions).
- Spin result not satisfactory.
 - **Less Ironing*** selected (page 5)?

(* depending on model)
- Display panel/indicator lights do not function while the appliance is running.
 - Power failure?
 - Fuse tripped? Switch on/replace fuse.
 - If the fault occurs repeatedly, call customer service.
- Programme progress longer than usual.
 - Not a fault – unbalanced load detection system adjusts imbalance by repeatedly distributing the washing.
 - Not a fault – Foam detection system active – a rinse cycle is started.
- Detergent residue on the washing.
 - Occasionally phosphate-free detergents contain water-insoluble residue.
 - Select **Rinse** or brush the laundry after washing.
- If a fault cannot be rectified or a repair is required:
 - Set programme selector to **Off** and pull out the mains plug.
 - Turn off the tap and call customer service (Installation instructions).



Safety instructions

- Read and follow the operating and installation instructions and all other information enclosed with the washing machine.
- Retain documents for subsequent use.

Risk of electric shock

- Never pull out the mains plug by tugging the power cord!
- Never insert/pull out the mains plug with damp hands.

Risk of injury

- Washing machine door may become very hot.
- Caution when draining hot detergent solution.
- Do not climb on the washing machine.
- Do not lean on the open washing machine door.
- Do not touch the drum in case it is still spinning.
- Keep detergents and care products out of the reach of children.
- Keep packaging, plastic film and packaging parts out of the reach of children.

Risk of poisoning

Risk of suffocation

Danger to life

On redundant appliances:

- Pull out the mains plug.
- Sever the power cord and discard together with the plug.
- Destroy the lock on the washing machine door. This will prevent children from locking themselves in and suffocating.

Risk of explosion

- Caused by detergents containing solvents, e.g. stain remover/items of washing pretreated with solvent naphtha may result in an explosion after being loaded into the washing machine. Beforehand thoroughly rinse items of washing by hand.

SIEMENS

Operating instructions

en

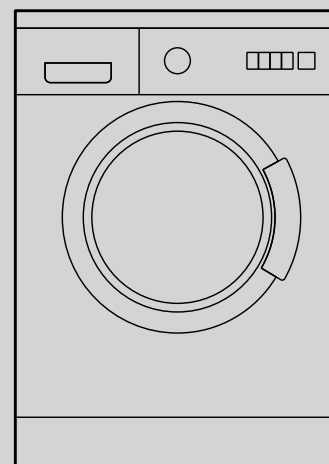

Washing machine

Consumption values

Programme	Additional function	Load	Current **	Water **	Programme duration **
Cottons 40 °C *	Intensive Wash	6 kg	0.60 kWh	53 l	2:13 h
Cottons 60 °C	–	6 kg	1.20 kWh	55 l	1:30 h
Stains 60 °C*	Intensive Wash	6 kg	1.02 kWh	45 l	2:15 h
Cottons 90 °C	Intensive Wash	6 kg	1.90 kWh	60 l	2:13 h
Easy-Care 40 °C *	Intensive Wash	3 kg	0.55 kWh	50 l	1:24 h
Easy-Care 40 °C (also suitable as Short programme)	–	3 kg	0.54 kWh	40 l	0:55 h
Mixed Fabrics	–	3 kg	0.59 kWh	35 l	0:50 h
Silk 30 °C	–	2 kg	0.22 kWh	32 l	0:32 h
Wool 30 °C *		2 kg	0.14 kWh	30 l	0:40 h

* Programme setting with **Intensive Wash** option and maximum spin speed for testing according to or in accordance with EN 60 456 and IEC 60 456.

** The values deviate from the indicated values depending on water pressure, water hardness, water inlet temperature, room temperature, type and amount of washing and degree of soiling, utilised detergent, fluctuations in the mains voltage and selected additional functions.



Read these instructions before switching on the washing machine!
Also follow the separate Installation instructions.
Follow the safety instructions on page 11!