





Programmes	°C	max.	Type of washing	Additional functions; information
Cottons	✱ -90 °C			
Intensive	✱ -60 °C	7* kg	Hard-wearing textiles, heat-resistant textiles made of cotton or linen	(stains),  (prewash),  (easy iron),  (hydro rinse)
Cottons Eco				
Easy-Care	✱ -60 °C		Easy-care textiles made of cotton, linen, synthetic fibres or blended fabrics	(stains),  (prewash),  (easy iron),  (hydro rinse)
Mix	✱ -40 °C	3 kg	Textiles made of cotton and easy-care textiles	(stains),  (prewash),  (easy iron),  (hydro rinse); Different types of washing can be washed together
Dark Wash	✱ -40 °C		Dark textiles made of cotton and dark easy-care textiles	(stains),  (prewash),  (easy iron),  (hydro rinse); reduced rinse and final spin cycle
Delicate/Silk	✱ -30 °C		For delicate, washable textiles, e.g. made of silk, satin, synthetic fibres or blended fabrics (e.g. curtains)	(stains),  (prewash),  (easy iron),  (hydro rinse); no spin cycle between the rinse cycles
Wool	✱ -40 °C		Hand or machine-washable wool or rich-wool textiles	also suitable for hand-washable silk; reduced rinse and final spin cycle
Shirts/Business	✱ -60 °C	2 kg	Non-iron shirts made of cotton, linen, synthetics fibres or blended fabrics	(stains),  (prewash),  (easy iron),  (hydro rinse); reduced spin cycle
Outdoor	✱ -40 °C		Textiles for outdoor wear	(stains),  (easy iron),  (hydro rinse); reduced final spin in intervals
Super 15'	✱ -40 °C		Easy-care textiles made of cotton, linen, synthetic fibres or blended fabrics	Short programme approx. 15 minutes; suitable for refreshing
Additional programmes				Rinse,  Spin,  Empty,  Low spin
The programmes are time-controlled for lightly soiled textiles. If textiles are heavily soiled, reduce the load or select additional functions, e.g.  (stains). Programmes without prewash – pour detergent into dispenser II, programmes with prewash – divide detergent between dispensers I and II. * Select the  (stains) additional function if washing 7 kg of cottons and coloureds.				
For further information and a selection of our products go to our web site: <a href="http://www.siemens-international.com">http://www.siemens-international.com</a>				Siemens Electrogeräte GmbH Carl-Wery Str. 34 81739 München / Deutschland WM12E481SN WM14E481SN 0207 9000 244 738

## Care



- Risk of electric shock!  
Pull out the mains plug!
- Risk of explosion! No solvents!

### Machine housing, control panel

- Wipe with a soft, damp cloth.
- Do not use abrasive detergents.
- Immediately remove washing and cleaning agent residue.
- Do not clean the appliance with a water jet.

### Clean the detergent drawer ...

... if it contains detergent or fabric softener residue.

1. Pull out, depress insert, completely remove.
2. Open the cover.
3. Clean with water and dry.
4. Close and lock the cover (place cylinder on guide pin).
5. Insert detergent drawer.

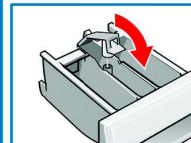
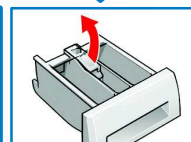
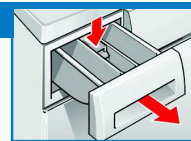

Leave detergent drawer open so that residual water can evaporate.

### Drum

Leave washing machine door open so that the drum can dry out.  
Rust stains – use chlorine-free cleaning agent, not steel wool.

### Descaling *No washing in the machine!*

Descale according to the instructions of the descaling agent-manufacturer, not required for correct detergent dosage.

## Information on the display panel *depending on model*

F:16	Close the washing machine door properly; washing may be caught.
F:17	Turn on the tap, supply hose kinked/jammed; clean filter ( <i>page 9</i> ), water pressure too low.
F:18	Clean detergent-solution pump ( <i>page 9</i> ), outlet pipe/drainage hose blocked.
F:21	Motor fault. Call customer service!
F:23	Water in the base pan, appliance leaking. Call customer service!

## Maintenance



- Risk of scalding!  
Allow detergent solution to cool down!
- Turn off the tap!

### Detergent-solution pump

Set programme selector to **Off**, pull out the mains plug.

1. Open and remove service flap.
- For models with drainage hose:  
2. Take drainage hose out of the holder and pull out of the housing.  
Remove sealing cap, allow detergent solution to flow out.  
Press on sealing cap and insert drainage hose into the holder.
- For models without drainage hose:  
2\* Carefully unscrew pump cover until the detergent solution begins to run out.  
When the service flap is half full, screw back the pump cover and empty the service flap.  
Repeat steps until all the detergent solution has run out.
3. Carefully unscrew the pump cover (residual water).
4. Clean the interior, pump cover thread and pump housing (fan impeller in the detergent-solution pump must rotate).
5. Reinsert and screw on pump cover.
6. Insert and close service flap.

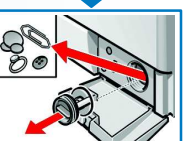
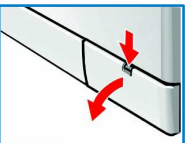

To prevent unused detergent from flowing into the outlet during the next wash: Pour 1 litre of water into dispenser II and select the **Empty** programme.

### Filters in the water supply

Release water pressure in the supply hose:

1. Turn off the tap!
2. Select any programme (except **Spin**/ **Empty**).
3. Press (**start/pause**) . Leave programme for approx. 40 seconds.
4. Set programme selector to **Off**.
5. Remove hose from tap.
6. Clean filter with small brush.
7. Depending on the model, remove hose from the rear of the appliance and clean the filter.

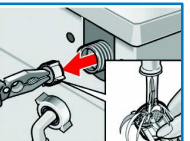

8. Connect the hose and check for leaks.

## What to do if ...

- Water is running out.
  - Correctly attach/replace drainage hose.
  - Tighten screw-fitting on the supply hose.
- Water not flowing in.  
Detergent not washed in.
  - (start/pause) not selected?
  - Tap not open?
  - Filter blocked? Clean filter (*page 9*).
  - Supply hose kinked or jammed?
- Washing machine door cannot be opened.
  - Safety function active. Wait approx. 2 minutes.
  - (without final spin) selected?
- Programme does not start.
  - (start/pause) selected?
  - Door closed?
- Detergent solution is not drained.
  - Clean detergent-solution pump (*page 9*).
  - Clean outlet pipe and/or drainage hose.
- Washing not spun correctly.
  - Distribute small and large items of washing in the drum.
- Spin cycle actuated several times.
  - Not a fault – unbalanced load detection system adjusts imbalance.
- Water not visible in the drum.
  - Not a fault – water below the visible area.
- Residual water in the dispenser for care product.
  - Not a fault – effect of the care product not impaired.
- Odour formation in the washing machine.
  - Run **Cottons 90 °C** programme without washing. Use standard detergent.
- Foam is coming out of the detergent drawer.
  - Too much detergent used?  
Mix 1 tablespoon of fabric conditioner with ½ litre of water and pour into dispenser II in the detergent drawer.
  - Reduce detergent dosage for the next wash cycle.
- Vibrations during spin cycle.
  - Appliance feet fixed?  
Secure appliance feet (*Installation instructions*).
  - Transportation safety devices removed?  
Remove transportation safety devices (*Installation instructions*).
- Spin result not satisfactory.
  - (easy iron) selected (*page 5*)?
- Display panel/indicator lights do not function while the appliance is running.
  - Power failure?
  - Fuse tripped? Switch on/replace fuse.
  - If the fault occurs repeatedly, call customer service.
- Programme progress longer than usual.
  - Not a fault – unbalanced load detection system adjusts imbalance by repeatedly distributing the washing.
  - Not a fault – Foam detection system active - a rinse cycle is started.
- Detergent residue on the washing.
  - Occasionally phosphate-free detergents contain water-insoluble residue.
  - Select **Rinse** or brush the laundry after washing.
- If a fault cannot be rectified or a repair is required:
  - Set programme selector to **Off** and pull out the mains plug.
  - Turn off the tap and call customer service (*Installation instructions*).

## Safety instructions

- Read and follow the operating and installation instructions and all other information enclosed with the washing machine.
- Retain documents for subsequent use.

### **Risk of electric shock**

- Never pull out the mains plug by tugging the power cord!
- Never insert/pull out the mains plug with damp hands.
- Washing machine door may become very hot.
- Caution when draining hot detergent solution.
- Do not climb on the washing machine.
- Do not lean on the open washing machine door.
- Do not touch the drum in case it is still spinning.

### **Risk of injury**

### **Risk of poisoning**

### **Risk of suffocation**

### **Danger to life**

On redundant appliances:

- Pull out the mains plug.
- Sever the power cord and discard together with the plug.
- Destroy the lock on the washing machine door. This will prevent children from locking themselves in and suffocating.
- Caused by detergents containing solvents, e.g. stain remover/items of washing pretreated with solvent naphtha may result in an explosion after being loaded into the washing machine. Beforehand thoroughly rinse items of washing by hand.

### **Risk of explosion**

## Consumption values

Programme	Additional function	Load	Current **	Water **	Programme duration **
Cottons 40 °C *	(stains)	7 kg	0.65 kWh	65 l	2:30 h
Cottons 60 °C	–	7 kg	1.20 kWh	70 l	1:35 h
Cottons Eco 60 °C *	(stains)	7 kg	1.19 kWh	49 l	2:36 h
Cottons 90 °C	(stains)	7 kg	2.00 kWh	75 l	2:33 h
Easy-Care 40 °C *	(stains)	3 kg	0.55 kWh	50 l	1:24 h
Easy-Care 40 °C (also suitable as <b>Short programme</b> )	–	3 kg	0.55 kWh	40 l	0:55 h
Mix	–	3 kg	0.60 kWh	37 l	0:50 h
Delicate/Silk 30 °C	–	2 kg	0.25 kWh	34 l	0:32 h
Wool  30 °C *	–	2 kg	0.15 kWh	30 l	0:40 h

\* Programme setting with (stains) option and maximum spin speed for testing according to or in accordance with EN 60 456 and IEC 60 456.

\*\* The values deviate from the indicated values depending on water pressure, water hardness, water inlet temperature, room temperature, type and amount of washing and degree of soiling, utilised detergent, fluctuations in the mains voltage and selected additional functions.

# SIEMENS

## Operating instructions

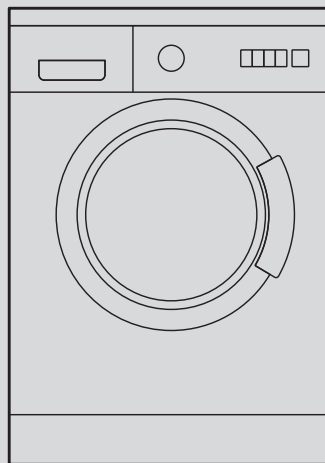

Washing machine



Read these instructions before switching on the washing machine!  
Also follow the separate installation instructions.  
Follow the safety instructions on page 11!

# Your washing machine

**Congratulations** – You have opted for a modern, high-quality domestic appliance manufactured by Siemens. The washing machine is distinguished by its economical energy consumption. Each appliance which leaves our factory is inspected thoroughly to ensure that it functions properly and is in perfect condition.



## Environmental disposal

Dispose of packaging in an environmentally friendly manner.

This appliance has been identified in accordance with the European Directive 2002/96/EG on Waste Electrical and Electronic Equipment (WEEE).

The Directive specifies the framework for an EU-wide valid return and recycling of waste appliances.

## Contents

Page

Intended use	1
Setting programmes	2
After washing	4
Individual settings	5
Important information	6
Overview of programmes	7
Care	8
Information on the display panel	8
Maintenance	9
What to do if ...	10
Safety instructions	11
Consumption values	11

## Intended use

- for use in the household only,
  - for the washing of machine-washable textiles in a detergent solution,
  - to be operated with cold drinking water and commercially available detergents and care products which are suitable for use in frontloading-washing machines.
- !**
- Do not leave children unattended near the washing machine!
  - The appliance is not intended for use by young children or infirm persons without supervision.
  - Keep pets away from the washing machine!

## Preparation



Correct installation according to separate installation instructions.



### Checking the machine

- Never switch on a damaged machine!
- Inform your customer service!



### Turn on the tap



### Insert mains plug



With dry hands only!  
Take hold of the plug only!



## Programmes

For detailed overview of programmes see Page 7.

Temperature and spin speed can be selected individually.

	Cottons	} hard-wearing textiles
	Intensive	
	Cottons Eco	
	Easy-Care	} easy-care textiles
	Delicate/Silk	} delicate washable textiles
	Wool	} hand/machine-washable textiles
	Empty	} the rinsing water if  occurs
	Spin	} washing washed by hand
	Low spin	} washing washed by hand at reduced spin speed
	Rinse	} with subsequent spin cycle
	Shirts/Business	} non-iron shirts
	Outdoor	} textiles for outdoor wear
	Super 15'	} short programme
	Mix	} different types of washing
	Dark Wash	} dark textiles

### Programme selector



### Display panel/Option buttons

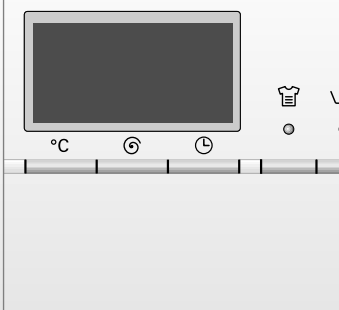

	– 90	°C	Selected
	– 1600*		Selected (W)
	1 – 24h*		Program
Status displays			Program
		–0–	Washing

*Before washing for the first time,  
wash once without any washing. See page 6*

## Sorting and inserting the washing

Follow manufacturer's care information!

According to the information on the care labels.  
According to type; colour; soiling and temperature.

*Follow important instructions! See page 6!*

Insert large and small items of washing! Do not jam items of washing between the washing machine door and rubber seal.

## Add detergent and care product

Meter accordingly:

Washing amount, soiling, water hardness (ask your water supply company) and manufacturer's instructions. Pour liquid detergent into the appropriate dispenser and place in the drum.

Prewash: Detergent, starch

Care product: Fabric softener

Main wash: Detergent, water softener, bleach, stain remover

Dilute viscous fabric softener and fabric conditioner with water.  
Prevents blockage of the overflow.

## Set and adjust programme

For additional functions and option buttons see individual settings, page 5.

**i** All buttons are sensitive, they only need to be touched gently!

Select  (start/pause)

Programme selector for switching the machine on and off and for selecting the programme. Can be rotated in either direction.

Select the temperature (\* = cold)

Select the spin speed (\* depending on model) or without final spin)

Programme ends in ... (\* depending on model)

Programme progress displays:

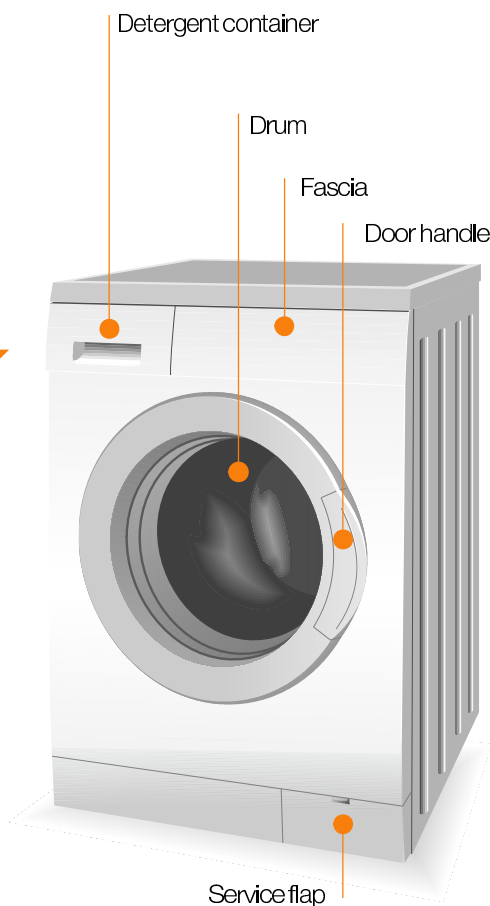

Washing, Rinse, Spin, End

# Wash

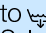

# Wash

## Removing washing

Open washing machine door and remove washing.  
If  (without final spin) active: Set programme selector to  **Empty** or select spin speed.  
Select  (**start/pause**).  
Remove any foreign objects – risk of rusting.

## Turn off the tap

Not required for Aqua-Stop models.

## Switch off

Set programme selector to **Off**.

## End of programme when ...

...  (start/pause) flashes and **-0-** is indicated on the display panel.

## Change programme ...

If you have mistakenly selected a wrong programme:

- Reselect programme.
- Select  (**start/pause**).

## ... or terminate

Programmes with high temperature, first:

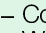
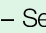
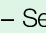
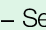
- Cool washing: Select  **Rinse**.  
Washing machine door remains locked.
- Select **Off**.
- Select  **Spin** or  **Empty**.
- Select  (**start/pause**).



# Individual settings

## Option buttons

You can change the spin speed and temperature beforehand and while the selected programme is running. Effects dependent on the programme progress.

### °C (Temperature)

You can change the indicated washing temperature. The maximum washing temperature which can be selected depends on the set programme.

### ⌚ (rpm)

You can change the indicated spin speed. The maximum spin speed which can be selected depends on the set programme.

### ⌚ (Ready in time)

The respective programme duration is displayed by selecting the programme. The programme start can be delayed before the programme begins. The **Ready in**-time can be set in hour-steps up to maximum 24h (depending on model). Keep pressing the ⌚-button until the required number of hours is indicated (h=hour). Select <D> (start/pause).

## Additional functions

see also programme overview

☞ (stains)	Extension of the washing time for a more intensive washing of highly soiled washing or 7 kg of cottons and coloureds.
⏮ (prewash)	For heavily soiled, hard-wearing washing, e.g. made of cotton or linen. Prewash at 30 °C.
⌚ (easy iron)	Special spin sequence with subsequent fluffing. Gentle final spin – residual moisture in the washing increased slightly.
👑 (hydro rinse)	Increased water level and additional rinse cycle, extended washing time. For areas with very soft water or for further improvement of the rinsing result.

### <D> (start/pause)

For starting or interrupting the programme.

## Signal

### 1. Start signal mode

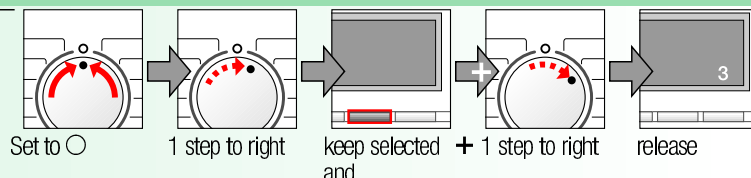

### 2. Set volume for ...

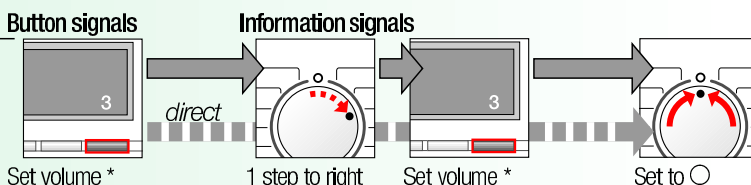

\* If required, select repeatedly

\* If required, select repeatedly



# Important information



## Protecting the washing and the machine

- Empty pockets.
- Remove metal parts (paper clips, etc.).
- Wash delicates in the net/bag (tights, curtains, underwired bras).
- Close zips, button up covers.
- Brush sand out of pockets and collars.
- Remove curtain fittings or include in the net/bag.



## Before washing for the first time

Do not put any washing in the washing machine! Turn on the tap, fill the appliance with approx. 1 litre of water and then pour ½ measuring cup of detergent into dispenser II. Set programme selector to ☞ **Easy-Care 60 °C** and select <D> (start/pause). At the end of the programme set the programme selector to **Off**.



## Washing with different degrees of soiling

Light	Wash new items separately.
	Do not prewash.
	If required, pretreat stains. Select ☞ (stains) additional function.
Heavy	Load less washing.
	Prewash.



## Filling weight

Do not exceed maximum load:

- Cottons and coloureds 7 kg
- Easy-Care 3 kg
- Delicates, silk and woollens 2 kg



## Soaking

Load washing of the same colour

Pour soaking agent/detergent into dispenser II according to the manufacturer's instructions. Set programme selector to ☞☞ **Cottons 30 °C** and select <D> (start/pause). After approx. 10 minutes select <D> (start/pause). After the required soaking time reselect <D> (start/pause) if the programme is to be continued or change the programme.



## Starching

Washing should not be treated with fabric softener

Dissolve an amount of starch for approx. 15 litres of water according to the manufacturer's instructions. Set programme selector to 🍷 **Rinse**, set spin speed and select <D> (start/pause). As soon as water runs in: Pour the starch solution into dispenser I.



## Dyeing/Bleaching

Do not dye/bleach washing in the washing machine.



## Protection of the environment/conservation tips

- Utilise the maximum amount of washing for the particular programme.
- Wash normally soiled washing without prewash.
- Instead of ☞☞ **Cottons 90 °C** select **Cottons Eco 60 °C** programme. Comparable cleaning result with significantly lower energy consumption.
- Meter detergent according to the manufacturer's instructions and water hardness.
- If the washing is then dried in the tumble dryer, select spin speed according to the instructions of the dryer manufacturer.



	Cottons	*-90 °C			
	Intensive	*-60 °C			☞ (stains), ☞ (prevash), ☞ (easy iron), ☞ (hydro rinse)
	Cottons Eco		7* kg		
	Easy-Care	*-60 °C			☞ (stains), ☞ (prevash), ☞ (easy iron), ☞ (hydro rinse)
	Mix	*-40 °C	3 kg		☞ (stains), ☞ (prevash), ☞ (easy iron), ☞ (hydro rinse); Different types of washing can be washed together
	Dark Wash	*-40 °C			☞ (stains), ☞ (prevash), ☞ (easy iron), ☞ (hydro rinse); reduced rinse and final spin cycle
	Delicate/Silk	*-30 °C			☞ (stains), ☞ (prevash), ☞ (easy iron), ☞ (hydro rinse); no spin cycle between the rinse cycles
	Wool	*-40 °C			also suitable for hand-washable silk; reduced rinse and final spin cycle
	Shirts/Business	*-60 °C	2 kg		☞ (stains), ☞ (prevash), ☞ (hydro rinse); reduced spin cycle
	Outdoor	*-40 °C			☞ (stains), ☞ (easy iron), ☞ (hydro rinse); reduced final spin in intervals
	Super 15'	*-40 °C			Short programme approx. 15 minutes; suitable for refreshing
Additional programmes					☞ Rinse, ☞ Spin, ☞ Empty, ☞ Low spin

The programmes are time-controlled for lightly soiled textiles. If textiles are heavily soiled, reduce the load or select additional functions, e.g. ☞ (stains). Programmes without prevash – pour detergent into dispenser **II**, programmes with prevash – divide detergent between dispensers **I** and **II**.

\* Select the ☞ (stains) additional function if washing 7 kg of cottons and coloureds.

For further information and a selection of our products go to our web site: <http://www.siemens-international.com>

WM12E481SN  
WM14E481SN  
0207  
9000 244 738

Siemens Electrogeräte GmbH  
Carl-Wery Str. 34  
81739 München / Deutschland

## Care



- Risk of electric shock! Pull out the mains plug!
- Risk of explosion! No solvents!



### Machine housing, control panel

- Wipe with a soft, damp cloth.
- Do not use abrasive detergents.
- Immediately remove washing and cleaning agent residue.
- Do not clean the appliance with a water jet.



### Clean the detergent drawer ...

... if it contains detergent or fabric softener residue.

1. Pull out, depress insert, completely remove.
2. Open the cover.
3. Clean with water and dry.
4. Close and lock the cover (place cylinder on guide pin).
5. Insert detergent drawer.

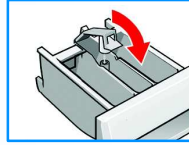
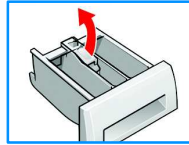
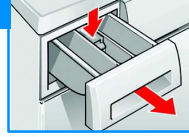

Leave detergent drawer open so that residual water can evaporate.



### Drum

Leave washing machine door open so that the drum can dry out.  
Rust stains – use chlorine-free cleaning agent, not steel wool.



### Descaling No washing in the machine!

Descal according to the instructions of the descaling agent-manufacturer, not required for correct detergent dosage.

## Information on the display panel depending on model

F:16	Close the washing machine door properly; washing may be caught.
F:17	Turn on the tap, supply hose kinked/jammed; clean filter (page 9), water pressure too low.
F:18	Clean detergent-solution pump (page 9), outlet pipe/drainage hose blocked.
F:21	Motor fault. Call customer service!
F:23	Water in the base pan, appliance leaking. Call customer service!



- Risk of scalding!  
Allow detergent solution to cool down!
- Turn off the tap!

## Detergent-solution pump

Set programme selector to **Off**, pull out the mains plug.

1. Open and remove service flap.
2. For models with drainage hose:  
Take drainage hose out of the holder and pull out of the housing.  
Remove sealing cap, allow detergent solution to flow out.  
Press on sealing cap and insert drainage hose into the holder.
- 2\* For models without drainage hose:  
Carefully unscrew pump cover until the detergent solution begins to run out.  
When the service flap is half full, screw back the pump cover and empty the service flap.  
Repeat steps until all the detergent solution has run out.
3. Carefully unscrew the pump cover (residual water).
4. Clean the interior, pump cover thread and pump housing (fan impeller in the detergent-solution pump must rotate).
5. Reinsert and screw on pump cover.
6. Insert and close service flap.

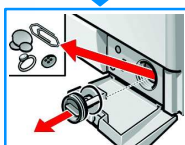
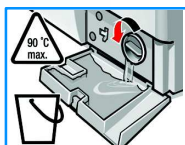
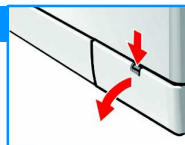

To prevent unused detergent from flowing into the outlet during the next wash:  
Pour 1 litre of water into dispenser II and select the **Empty** programme.

## Filters in the water supply

Release water pressure in the supply hose:

1. Turn off the tap!
2. Select any programme (except **Spin**/ **Empty**).
3. Press **(start/pause)**. Leave programme for approx. 40 seconds.
4. Set programme selector to **Off**.
5. Remove hose from tap.
6. Clean filter with small brush.
7. Depending on the model, remove hose from the rear of the appliance and clean the filter.
8. Connect the hose and check for leaks.

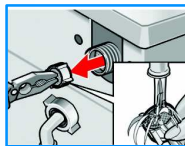

- Water is running out.
  - Correctly attach/replace drainage hose.
  - Tighten screw-fitting on the supply hose.
- Water not flowing in.  
Detergent not washed in.
  - **(start/pause)** not selected?
  - Tap not open?
  - Filter blocked? Clean filter (page 9).
  - Supply hose kinked or jammed?
- Washing machine door cannot be opened.
  - Safety function active. Wait approx. 2 minutes.
  - **(without final spin)** selected?
- Programme does not start.
  - **(start/pause)** selected?
  - Door closed?
- Detergent solution is not drained.
  - Clean detergent-solution pump (page 9).
  - Clean outlet pipe and/or drainage hose.
- Washing not spun correctly.
  - Distribute small and large items of washing in the drum.
- Spin cycle actuated several times.
  - Not a fault – unbalanced load detection system adjusts imbalance.
- Water not visible in the drum.
  - Not a fault – water below the visible area.
- Residual water in the dispenser for care product.
  - Not a fault – effect of the care product not impaired.
- Odour formation in the washing machine.
  - Run **Cottons 90 °C** programme without washing. Use standard detergent.
- Foam is coming out of the detergent drawer.
  - Too much detergent used?
  - Mix 1 tablespoon of fabric conditioner with ½ litre of water and pour into dispenser II in the detergent drawer.
  - Reduce detergent dosage for the next wash cycle.
- Vibrations during spin cycle.
  - Appliance feet fixed? Secure appliance feet (*Installation instructions*).
  - Transportation safety devices removed? Remove transportation safety devices (*Installation instructions*).
- Spin result not satisfactory.
  - **(easy iron)** selected (page 5)?
- Display panel/indicator lights do not function while the appliance is running.
  - Power failure?
  - Fuse tripped? Switch on/replace fuse.
  - If the fault occurs repeatedly, call customer service.
- Programme progress longer than usual.
  - Not a fault – unbalanced load detection system adjusts imbalance by repeatedly distributing the washing.
  - Not a fault – Foam detection system active - a rinse cycle is started.
- Detergent residue on the washing.
  - Occasionally phosphate-free detergents contain water-insoluble residue.
  - Select **Rinse** or brush the laundry after washing.
- If a fault cannot be rectified or a repair is required:
  - Set programme selector to **Off** and pull out the mains plug.
  - Turn off the tap and call customer service (*Installation instructions*).



## Safety instructions

- Read and follow the operating and installation instructions and all other information enclosed with the washing machine.
- Retain documents for subsequent use.

### Risk of electric shock

- Never pull out the mains plug by tugging the power cord!
- Never insert/pull out the mains plug with damp hands.

### Risk of injury

- Washing machine door may become very hot.
- Caution when draining hot detergent solution.
- Do not climb on the washing machine.
- Do not lean on the open washing machine door.
- Do not touch the drum in case it is still spinning.

### Risk of poisoning

### Risk of suffocation

- Keep detergents and care products out of the reach of children.
- Keep packaging, plastic film and packaging parts out of the reach of children.

### Danger to life

On redundant appliances:

- Pull out the mains plug.
- Sever the power cord and discard together with the plug.
- Destroy the lock on the washing machine door. This will prevent children from locking themselves in and suffocating.

### Risk of explosion

- Caused by detergents containing solvents, e.g. stain remover/items of washing pretreated with solvent naphtha may result in an explosion after being loaded into the washing machine. Beforehand thoroughly rinse items of washing by hand.

# SIEMENS

## Operating instructions

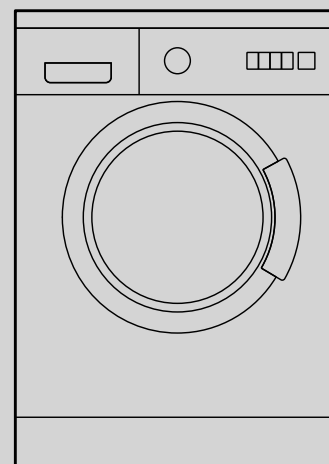

Washing machine

en

## Consumption values

Programme	Additional function	Load	Current **	Water **	Programme duration **
Cottons 40 °C *	(stains)	7 kg	0.65 kWh	65 l	2:30 h
Cottons 60 °C	–	7 kg	1.20 kWh	70 l	1:35 h
Cottons Eco 60 °C *	(stains)	7 kg	1.19 kWh	49 l	2:36 h
Cottons 90 °C	(stains)	7 kg	2.00 kWh	75 l	2:33 h
Easy-Care 40 °C *	(stains)	3 kg	0.55 kWh	50 l	1:24 h
Easy-Care 40 °C (also suitable as <b>Short programme</b> )	–	3 kg	0.55 kWh	40 l	0:55 h
Mix	–	3 kg	0.60 kWh	37 l	0:50 h
Delicate/Silk 30 °C	–	2 kg	0.25 kWh	34 l	0:32 h
Wool 30 °C *	–	2 kg	0.15 kWh	30 l	0:40 h

\* Programme setting with (stains) option and maximum spin speed for testing according to or in accordance with EN 60 456 and IEC 60 456.

\*\* The values deviate from the indicated values depending on water pressure, water hardness, water inlet temperature, room temperature, type and amount of washing and degree of soiling, utilised detergent, fluctuations in the mains voltage and selected additional functions.



Read these instructions before switching on the washing machine!  
Also follow the separate installation instructions.  
Follow the safety instructions on page 11!