

Your washing machine

Congratulations – You have opted for a modern, high-quality domestic appliance manufactured by Siemens. The washing machine is distinguished by its economical energy consumption.

Each appliance which leaves our factory is inspected thoroughly to ensure that it functions properly and is in perfect condition.

Environmental disposal

Dispose of packaging in an environmentally friendly manner.

This appliance has been identified in accordance with the European Directive 2002/96/EG on Waste Electrical and Electronic Equipment (WEEE).

The Directive specifies the framework for an EU-wide valid return and recycling of waste appliances.

Contents

	Page
■ Intended use	1
■ Setting programmes	2
■ After washing	4
■ Individual settings	5
■ Important information	6
■ Overview of programmes	7
■ Care	8
■ Information to indicator lights	8
■ Maintenance	9
■ What to do if ...	10
■ Safety instructions	11
■ Consumption values	11

Intended use

- for use in the household only,
- for the washing of machine-washable textiles in a detergent solution,
- to be operated with cold drinking water and commercially available detergents and care products which are suitable for use in washing machines.

- ⚠ Do not leave children unattended near the washing machine!
- Keep pets away from the washing machine!

Programmes

For detailed overview of programmes see *Page 7*. Temperature and spin speed can be selected individually.

👤 Cotton	hard-wearing textiles
👤 Cotton Intensive	hard-wearing textiles
👤 Mix	different types of washing
👤 Easy-Care	easy-care textiles
👤 Delicates	delicate washable textiles
👤 Wool	hand/machine-washable textiles
👤 Empty	the rinsing water if Rinse Hold occurs
👤 Spin	washing washed by hand

Preparation

⚠ Correct installation according to separate installation instructions.

Checking the machine

- Never switch on a damaged machine!
- Inform your customer service!

Turn on the tap

Insert mains plug

- ⚠ With dry hands only! Take hold of the plug only!

Sorting and inserting the washing

Follow manufacturer's care information! According to the information on the care labels. According to type; colour; soiling and temperature.

Follow important instructions! See page 6! Insert large and small items of washing! Do not jam items of washing between the washing machine door and rubber seal.

Add detergent and care product

Meter accordingly: Washing amount, soiling, water hardness (ask your water supply company) and manufacturer's instructions. Pour liquid detergent into the appropriate dispenser and place in the drum.

- I Prewash: Detergent, starch
- ☞ Care product: Fabric softener
- II Main wash: Detergent, water softener, bleach, stain remover

ⓘ Dilute viscous fabric softener and fabric conditioner with water. Prevents blockage of the overflow.

Set and adjust programme

For additional functions and option buttons see *individual settings, page 5*.

ⓘ All buttons are sensitive, they only need to be touched gently!

Programme selector for switching the machine on and off and for selecting the programme. Can be rotated in either direction.

Select Start/Pause

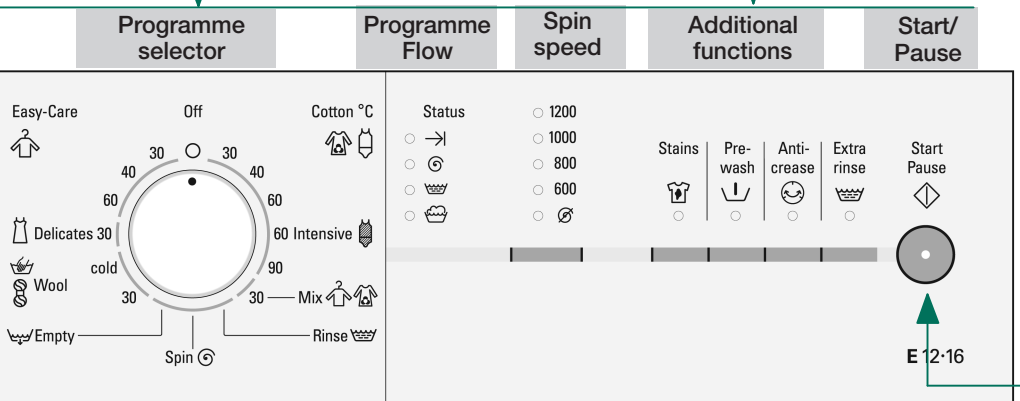

Symbols:

- End
- 👤 Spin
- 👤 Rinse
- 👤 Wash
- 👤 Spin off

Wash

1

2



Wash

3

Removing washing

Open washing machine door and remove washing. If ☞ (without final spin) active: Set programme selector to 🚰 Empty or select spin speed. Select **Start/Pause** ☞. Remove any foreign objects – risk of rusting.

Turn off the tap

Not required for Aqua-Stop models.

Switch off

Set programme selector to **Off**.

End of programme when ...

... **Start/pause** ☞ flashes and indicator light → **End** flashes.

Change programme ...

If you have mistakenly selected a wrong programme:

- Reselect programme.
- Select **Start/pause** ☞.

... or terminate

Programmes with high temperature, first:

- Cool washing: Select 🚰 Rinse.
- Washing machine door remains locked.
- Select **Off**.
- Select 🚰 Spin or 🚰 Empty.
- Select **Start/pause** ☞.

Individual settings

👤 Spin	You can already change the indicated spin speed. The maximum spin speed which can be selected depends on the set programme.
👤 Additional functions	see also programme overview
👤 Stains	Extension of the washing time for a more intensive washing of highly soiled washing or 7 kg of cottons and coloureds.
👤 Prewash	For heavily soiled, hard-wearing washing, e.g. made of cotton or linen. Prewash at 30 °C.
👤 Anticrease	Special spin sequence with subsequent fluffing. Gentle final spin – residual moisture in the washing increased slightly.
👤 Extra rinse	additional rinse cycle. For areas with very soft water or for further improvement of the rinsing result.
👤 Start/Pause ☞	For starting or interrupting the programme.
👤 Signal	

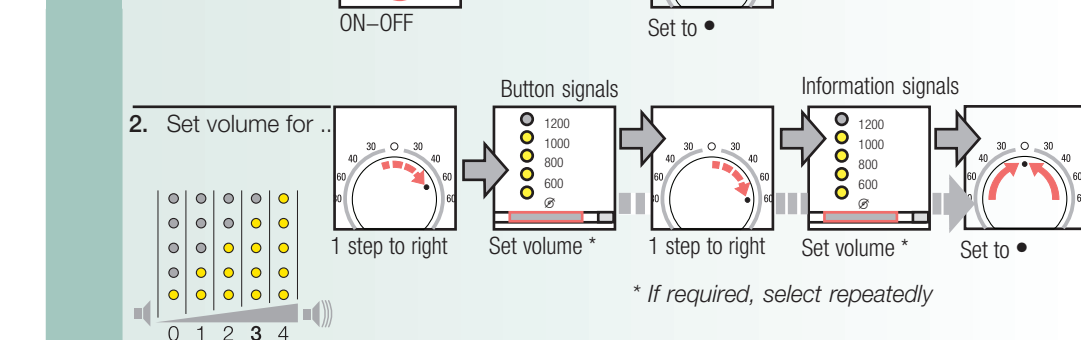

Important information

Protecting the washing and the machine

- Empty pockets.
- Remove metal parts (paper clips, etc.).
- Wash delicates in the net/bag (tights, curtains, underwired bras).
- Close zips, button up covers.
- Brush sand out of pockets and collars.
- Remove curtain fittings or include in the net/bag.

Before washing for the first time

Do not put any washing in the washing machine! Turn on the tap, fill the appliance with approx. 1 litre of water and then pour ½ measuring cup of detergent into dispenser II. Set programme selector to ☞ **Easy-Care 60 °C** and select **Start/pause** ☞. At the end of the programme set the programme selector to **Off**.

Washing with different degrees of soiling

Light	Wash new items separately. Do not prewash.
Heavy	If required, pretreat stains. Select 🚰 Stains additional function. Load less washing. Prewash.

Filling weight

Do not exceed maximum load:

- Cottons and coloureds 7 kg
- Easy-Care 3 kg
- Delicates, silk and woollens 2 kg

Soaking

Load washing of the same colour. Pour soaking agent/detergent into dispenser II according to the manufacturer's instructions. Set programme selector to ☞ **Cotton 30 °C** and select **Start/pause** ☞. After approx. 10 minutes select **Start/pause** ☞. After the required soaking time reselect **Start/pause** ☞ if the programme is to be continued or change the programme.

Starching

Washing should not be treated with fabric softener. Dissolve an amount of starch for approx. 15 litres of water according to the manufacturer's instructions.

Dyeing/Bleaching

Do not dye/bleach washing in the washing machine.

Protection of the environment/conservation tips

- Utilise the maximum amount of washing for the particular programme.
- Wash normally soiled washing without prewash.
- Instead of ☞ **Cotton 90 °C** select ☞ **Cotton Intensive 60 °C** programme. Comparable cleaning result with significantly lower energy consumption.
- Meter detergent according to the manufacturer's instructions and water hardness.
- If the washing is then dried in the tumble dryer, select spin speed according to the instructions of the dryer manufacturer.

Programmes	°C	max.	Type of washing	Additional functions; information		
				☞Stains, ⬇Prewash, ☉Anticrease, ☞Extra rinse	☞Stains, ⬇Prewash, ☉Anticrease, ☞Extra rinse (also suitable as Short programme)	☞Stains, ⬇Prewash, ☉Anticrease, ☞Extra rinse (also suitable as Short programme)
☞Cotton	30, 40, 60, 90 °C	7 kg*	Hard-wearing textiles, heat-resistant textiles made of cotton or linen			
☞Cotton Intensive	60 °C					
☞Easy-Care	30, 40, 60 °C	3 kg	Easy-care textiles made of cotton, linen, synthetic fibres or blended fabrics			
☞Mix	30 °C		Textiles made of cotton and easy-care textiles			
☞Delicates	30 °C	2 kg	For delicate, washable textiles, e.g. made of silk, satin, synthetic fibres or blended fabrics (e.g. curtains)			
Wool ☞	cold, 40 °C		Hand or machine-washable wool or rich-wool textiles			
Additional programmes				☞Rinse, ☉Spin, ☞Empty		
* The programmes are time-controlled for lightly soiled textiles. If textiles are heavily soiled, reduce the load or select additional functions, e.g. ☞Stains. Programmes without prewash – pour detergent into dispenser II, programmes with prewash – divide detergent between dispensers I and II. * Select the ☞Stains additional function if washing 7 kg of cottons and coloureds.						

For further information and a selection of our products go to our web site:
<http://www.siemens-international.com>

Care



- Risk of electric shock! Pull out the mains plug!
- Risk of explosion! No solvents!

Machine housing, control panel

- Wipe with a soft, damp cloth.
- Do not use abrasive detergents.
- Immediately remove washing and cleaning agent residue.
- Do not clean the appliance with a water jet.

Clean the detergent drawer ...

... if it contains detergent or fabric softener residue.

1. Pull out, depress insert, completely remove.
2. Open the cover.
3. Clean with water and dry.
4. Close and lock the cover (place cylinder on guide pin).
5. Insert detergent drawer.

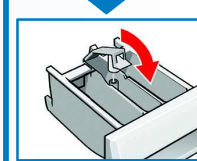
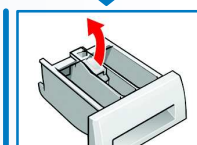
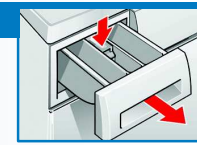

Leave detergent drawer open so that residual water can evaporate.

Drum

Leave washing machine door open so that the drum can dry out.
Rust stains – use chlorine-free cleaning agent, not steel wool.

Descaling

No washing in the machine!

Descale according to the instructions of the descaling agent-manufacturer, not required for correct detergent dosage.

Information to indicator lights

depending on model

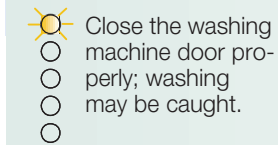

Close the washing machine door properly; washing may be caught.

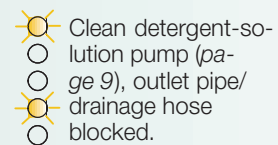

Clean detergent-solution pump (page 9), outlet pipe/drainage hose blocked.

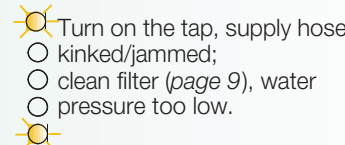

Turn on the tap, supply hose kinked/jammed; clean filter (page 9), water pressure too low.

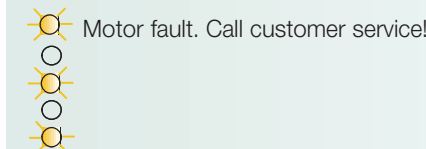

Motor fault. Call customer service!

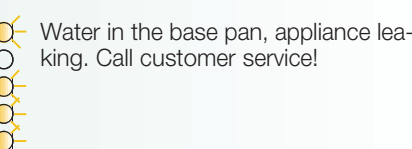

Water in the base pan, appliance leaking. Call customer service!

Maintenance



- Risk of scalding! Allow detergent solution to cool down!
- Turn off the tap!

Detergent-solution pump

Set programme selector to **Off**, pull out the mains plug.

1. Open and remove service flap.

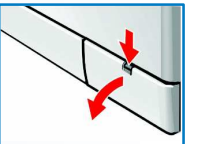

2. For models with drainage hose: Take drainage hose out of the holder and pull out of the housing. Remove sealing cap, allow detergent solution to flow out. Press on sealing cap and insert drainage hose into the holder.



- 2* For models without drainage hose: Carefully unscrew pump cover until the detergent solution begins to run out. When the service flap is half full, screw back the pump cover and empty the service flap. Repeat steps until all the detergent solution has run out.

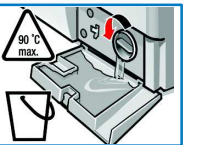

3. Carefully unscrew the pump cover (residual water).

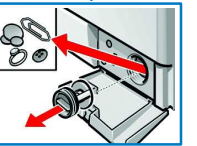

4. Clean the interior, pump cover thread and pump housing (fan impeller in the detergent-solution pump must rotate).

5. Reinsert and screw on pump cover.

6. Insert and close service flap.

To prevent unused detergent from flowing into the outlet during the next wash: Pour 1 litre of water into dispenser II and select the ☞Empty programme.

Filters in the water supply

Risk of electric shock! Do not immerse Aqua-Stop safety device in water (contains electric valve).

Release water pressure in the supply hose:

1. Turn off the tap!
2. Select any programme (except ☉Spin/☞Empty).
3. Press **Start/pause** ⬇. Leave programme for approx. 40 seconds.
4. Set programme selector to **Off**.
5. Remove hose from tap.
6. Clean filter with small brush.
7. Depending on the model, remove hose from the rear of the appliance and clean the filter.



8. Connect the hose and check for leaks.

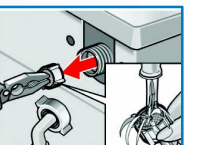

What to do if ...

- Water is running out. – Correctly attach/replace drainage hose. – Tighten screw-fitting on the supply hose.
- Water not flowing in. Detergent not washed in. – **Start/pause** ⬇ not selected? – Tap not open? – Filter blocked? Clean filter (page 9). – Supply hose kinked or jammed? – Safety function active. Wait 2 minutes – Rinse Hold selected? – **Start/pause** ⬇ selected? – Door closed?
- Washing machine door cannot be opened. – Clean detergent-solution pump (page 9). – Clean outlet pipe and/or drainage hose.
- Programme does not start. – Distribute small and large items of washing in the drum.
- Detergent solution is not drained. – Not a fault – unbalanced load detection system adjusts imbalance.
- Washing not spun correctly. – Not a fault – water below the visible area.
- Spin cycle actuated several times. – Not a fault – effect of the care product not impaired.
- Residual water in the dispenser for care product. – Run ☞Cotton 90 °C programme without washing. Use standard detergent.
- Odour formation in the washing machine. – Too much detergent used? Mix 1 tablespoon of fabric conditioner with ½ litre of water and pour into dispenser II in the detergent drawer. – Reduce detergent dosage for the next wash cycle.
- Foam is coming out of the detergent drawer. – Appliance feet fixed? Secure appliance feet (Installation instructions). – Transportation safety devices removed? Remove transportation safety devices (Installation instructions).
- Vibrations during spin cycle. – ☉Anticrease selected (page 5)?
- Spin result not satisfactory. – Power failure? – Fuse tripped? Switch on/replace fuse. – If the fault occurs repeatedly, call customer service.
- Display panel/indicator lights do not function while the appliance is running. – Not a fault – unbalanced load detection system adjusts imbalance by repeatedly distributing the washing. – Foam detection system active – a rinse cycle is started.
- Programme progress longer than usual. – Occasionally phosphate-free detergents contain water-insoluble residue. – Select ☞Rinse or brush the laundry after washing.
- Detergent residue on the washing. – If a fault cannot be rectified or a repair is required: – Set programme selector to **Off** and pull out the mains plug. – Turn off the tap and call customer service (Installation instructions).

Safety instructions

- Read and follow the operating and installation instructions and all other information enclosed with the washing machine.
- Retain documents for subsequent use.
- Risk of electric shock** – Never pull out the mains plug by tugging the power cord! – Never insert/pull out the mains plug with damp hands.
- Risk of injury** – Washing machine door may become very hot. – Caution when draining hot detergent solution. – Do not climb on the washing machine. – Do not lean on the open washing machine door. – Do not touch the drum if it is still rotating. – Keep detergents and care products out of the reach of children.
- Risk of poisoning** – Keep packaging, plastic film and packaging parts out of the reach of children.
- Risk of suffocation** On redundant appliances: – Pull out the mains plug. – Sever the power cord and discard together with the plug. – Destroy the lock on the washing machine door. This will prevent children from locking themselves in and suffocating. – Caused by detergents containing solvents, e.g. stain remover/items of washing pretreated with solvent naphtha may result in an explosion after being loaded into the washing machine. Beforehand thoroughly rinse items of washing by hand.
- Danger to life**
- Risk of explosion**

Consumption values

Programme	Additional function	Load	Current **	Water **	Programme duration **
☞Cotton 40 °C*	☞Stains	7 kg	0.65 kWh	65 l	2:30 h
☞Cotton 60 °C	–	7 kg	1.20 kWh	70 l	1:35 h
☞Cotton-Intensive 60 °C*	☞Stains	7 kg	1.19 kWh	49 l	2:36 h
☞Cotton 90 °C*	☞Stains	7 kg	2.00 kWh	75 l	2:33 h
☞Easy-Care 40 °C*	☞Stains	3 kg	0.55 kWh	50 l	1:24 h
☞Easy-Care 40 °C (also suitable as Short programme)	–	3 kg	0.55 kWh	40 l	0:55 h
☞Mix	–	3 kg	0.60 kWh	37 l	0:50 h
☞Delicates 30 °C	–	2 kg	0.25 kWh	34 l	0:32 h
Wool ☞ 30 °C	–	2 kg	0.15 kWh	30 l	0:40 h

* Programme setting with ☞Stains (yoğun yıkama) option and maximum spin speed for testing according to or in accordance with EN 60 456 and IEC 60 456.

** The values deviate from the indicated values depending on water pressure, water hardness, water inlet temperature, room temperature, type and amount of washing and degree of soiling, utilised detergent, fluctuations in the mains voltage and selected additional functions.

SIEMENS

Operating instructions

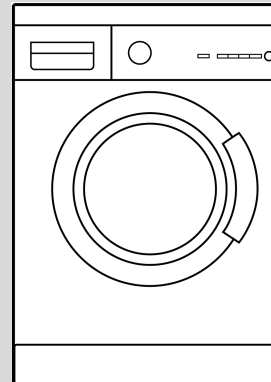

Washing machine



Read these instructions before switching on the washing machine! Also follow the separate installation instructions. Follow the safety instructions on page 11!

Your washing machine

Congratulations – You have opted for a modern, high-quality domestic appliance manufactured by Siemens. The washing machine is distinguished by its economical energy consumption. Each appliance which leaves our factory is inspected thoroughly to ensure that it functions properly and is in perfect condition.



Environmental disposal

Dispose of packaging in an environmentally friendly manner.

This appliance has been identified in accordance with the European Directive 2002/96/EG on Waste Electrical and Electronic Equipment (WEEE).

The Directive specifies the framework for an EU-wide valid return and recycling of waste appliances.

Contents

Page

Intended use	1
Setting programmes	2
After washing	4
Individual settings	5
Important information	6
Overview of programmes	7
Care	8
Information to indicator lights	8
Maintenance	9
What to do if ...	10
Safety instructions	11
Consumption values	11

Intended use

- for use in the household only,
- for the washing of machine-washable textiles in a detergent solution,
- to be operated with cold drinking water and commercially available detergents and care products which are suitable for use in washing machines.



- Do not leave children unattended near the washing machine!
- Keep pets away from the washing machine!

Preparation



Correct installation according to separate installation instructions.



Checking the machine

- Never switch on a damaged machine!
- Inform your customer service!



Turn on the tap



Insert mains plug



With dry hands only!
Take hold of the plug only!



Programmes

For detailed overview of programmes see Page 7.
Temperature and spin speed can be selected individually.

Cotton	hard-wearing textiles
Cotton Intensive	hard-wearing textiles
Mix	different types of washing
Easy-Care	easy-care textiles
Delicates	delicate washable textiles
Wool	hand/machine-washable textiles
Empty	the rinsing water if Rinse Hold occurs
Spin	washing washed by hand

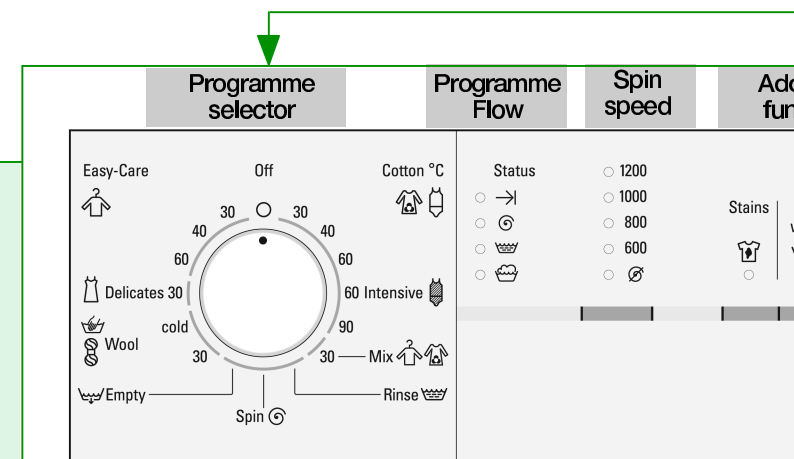

Symbols:

- End
- Spin
- Rinse
- Wash
- Spin off

*Before washing for the first time,
wash once without any washing. See page 6*

Sorting and inserting the washing

Follow manufacturer's care information!
According to the information on the care labels.
According to type; colour; soiling and temperature.

Follow important instructions! See page 6!

Insert large and small items of washing! Do not jam items of washing between the washing machine door and rubber seal.

Add detergent and care product

Meter accordingly:
Washing amount, soiling, water hardness (ask your water supply company) and manufacturer's instructions. Pour liquid detergent into the appropriate dispenser and place in the drum.

Prewash: Detergent, starch

Care product: Fabric softener

Main wash: Detergent, water softener, bleach, stain remover

Dilute viscous fabric softener and fabric conditioner with water.
Prevents blockage of the overflow.

Set and adjust programme

For additional functions and option buttons see individual settings, page 5.

i All buttons are sensitive, they only need to be touched gently!

Programme selector for switching the machine on and off and for selecting the programme. Can be rotated in either direction.

Select Start/Pause 

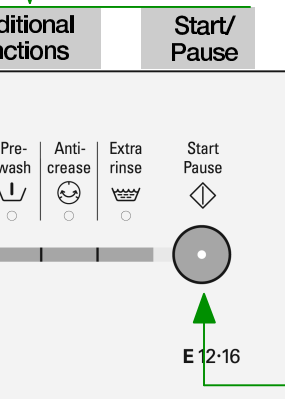

Wash

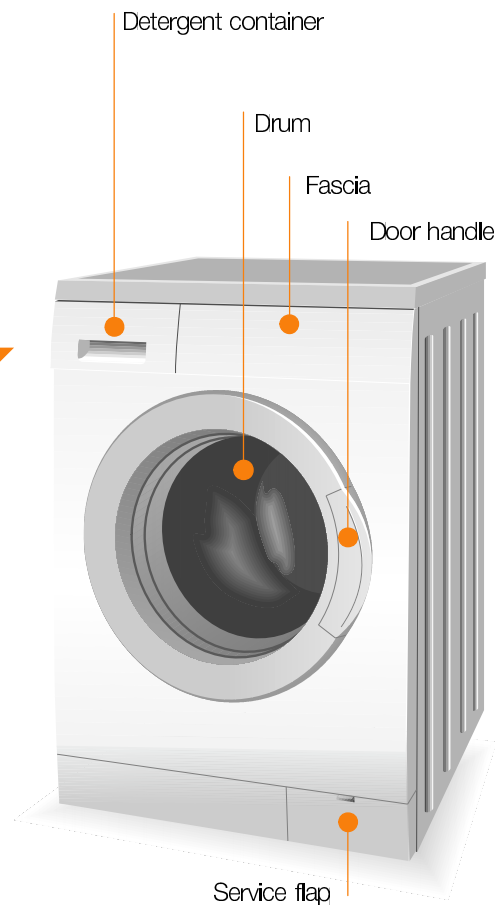

Wash

Removing washing

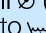
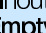
Open washing machine door and remove washing.
If  (without final spin) active: Set programme selector to  **Empty** or select spin speed. Select **Start/Pause** .
Remove any foreign objects – risk of rusting.

Turn off the tap

Not required for Aqua-Stop models.

Switch off

Set programme selector to **Off**.

End of programme when ...

... **Start/pause**  flashes and indicator light → **End** flashes.

Change programme ...

If you have mistakenly selected a wrong programme:

- Reselect programme.
- Select **Start/pause** .

... or terminate

Programmes with high temperature, first:

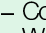
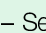
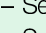
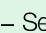
- Cool washing: Select  **Rinse**.
Washing machine door remains locked.
- Select **Off**.
- Select  **Spin** or  **Empty**.
- Select **Start/pause** .

Individual settings

Spin

You can already change the indicated spin speed. The maximum spin speed which can be selected depends on the set programme.

Additional functions *see also programme overview*

☒ Stains	Extension of the washing time for a more intensive washing of highly soiled washing or 7 kg of cottons and coloureds.
⏮ Prewash	For heavily soiled, hard-wearing washing, e.g. made of cotton or linen. Prewash at 30 °C.
☼ Anticrease	Special spin sequence with subsequent fluffing. Gentle final spin – residual moisture in the washing increased slightly.
🚿 Extra rinse	additional rinse cycle. For areas with very soft water or for further improvement of the rinsing result.

Start/Pause ◀▶

For starting or interrupting the programme.

Signal

1. Start signal mode

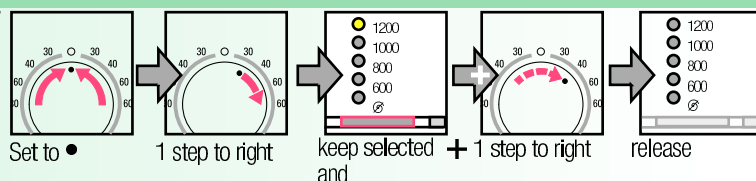

Optional:

blindmode*
ON-OFF

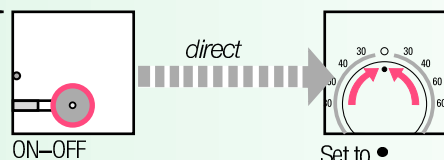

*Long signal – function on.
Short signal – function off.

2. Set volume for ..

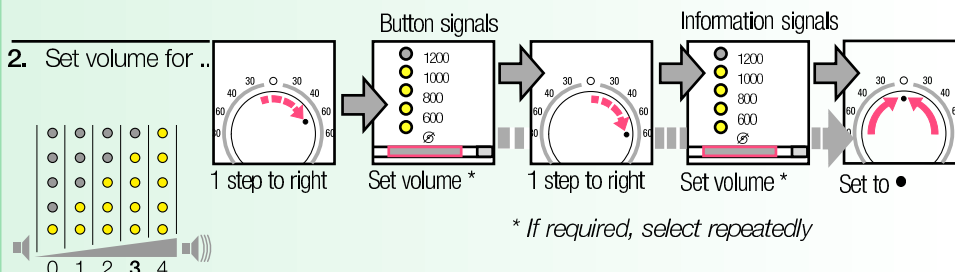

Important information



Protecting the washing and the machine

- Empty pockets.
- Remove metal parts (paper clips, etc.).
- Wash delicates in the net/bag (tights, curtains, underwired bras).
- Close zips, button up covers.
- Brush sand out of pockets and collars.
- Remove curtain fittings or include in the net/bag.



Before washing for the first time

Do not put any washing in the washing machine! Turn on the tap, fill the appliance with approx. 1 litre of water and then pour ½ measuring cup of detergent into dispenser II. Set programme selector to ☒ **Easy-Care 60 °C** and select **Start/pause** ◀▶. At the end of the programme set the programme selector to **Off**.



Washing with different degrees of soiling

Light	Wash new items separately.
	Do not prewash.
	If required, pretreat stains. Select ☒ Stains additional function.
Heavy	Load less washing.
	Prewash.



Filling weight

Do not exceed maximum load:

- Cottons and coloureds 7 kg
- Easy-Care 3 kg
- Delicates, silk and woollens 2 kg



Soaking *Load washing of the same colour*

Pour soaking agent/detergent into dispenser II according to the manufacturer's instructions. Set programme selector to ☒ **Cotton 30 °C** and select **Start/pause** ◀▶. After approx. 10 minutes select **Start/pause** ◀▶. After the required soaking time reselect **Start/pause** ◀▶ if the programme is to be continued or change the programme.



Starching *Washing should not be treated with fabric softener*

Dissolve an amount of starch for approx. 15 litres of water according to the manufacturer's instructions.



Dyeing/Bleaching

Do not dye/bleach washing in the washing machine.



Protection of the environment/conservation tips

- Utilise the maximum amount of washing for the particular programme.
- Wash normally soiled washing without prewash.
- Instead of ☒ **Cotton 90 °C** select ☒ **Cotton Intensive 60 °C** programme. Comparable cleaning result with significantly lower energy consumption.
- Meter detergent according to the manufacturer's instructions and water hardness.
- If the washing is then dried in the tumble dryer, select spin speed according to the instructions of the dryer manufacturer.

	30, 40, 60, 90 °C	7 kg*	Hard-wearing textiles, heat-resistant textiles made of cotton or linen	Stains, Prewash, Anticrease, Extra rinse
	60 °C			
	30, 40, 60 °C	3 kg	Easy-care textiles made of cotton, linen, synthetic fibres or blended fabrics	Stains, Prewash, Anticrease, Extra rinse (also suitable as Short programme)
	30 °C		Textiles made of cotton and easy-care textiles	Stains, Prewash, Anticrease, Extra rinse Different types of washing can be washed together
	30 °C	2 kg	For delicate, washable textiles, e.g. made of silk, satin, synthetic fibres or blended fabrics (e.g. curtains)	Stains, Prewash, Anticrease, Extra rinse; no spin cycle between the rinse cycles
	cold, 40 °C		Hand or machine-washable wool or rich-wool textiles	also suitable for hand-washable silk; reduced rinse and final spin cycle
Additional programmes Rinse, Spin, Empty				

i The programmes are time-controlled for lightly soiled textiles. If textiles are heavily soiled, reduce the load or select additional functions, e.g. Stains. Programmes without prewash – pour detergent into dispenser **II**, programmes with prewash – divide detergent between dispensers **I** and **II**.

* Select the Stains additional function if washing 7 kg of cottons and coloureds.

For further information and a selection of our products go to our web site:
<http://www.siemens-international.com>

SIEMENS ELECTROGERÄTE GMBH

WM12E160IN
1006en
9000 171 099

Care



- Risk of electric shock!
Pull out the mains plug!
- Risk of explosion! No solvents!



Machine housing, control panel

- Wipe with a soft, damp cloth.
- Do not use abrasive detergents.
- Immediately remove washing and cleaning agent residue.
- Do not clean the appliance with a water jet.



Clean the detergent drawer ...

... if it contains detergent or fabric softener residue.

1. Pull out, depress insert, completely remove.
2. Open the cover.
3. Clean with water and dry.
4. Close and lock the cover (place cylinder on guide pin).
5. Insert detergent drawer.

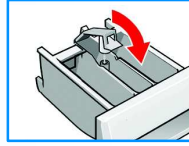
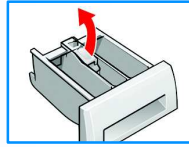
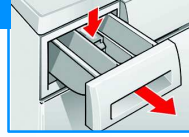

Leave detergent drawer open so that residual water can evaporate.



Drum

Leave washing machine door open so that the drum can dry out.
Rust stains – use chlorine-free cleaning agent, not steel wool.



Descaling No washing in the machine!

Descal according to the instructions of the descaling agent-manufacturer, not required for correct detergent dosage.

Information to indicator lights depending on model

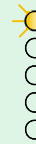

Close the washing machine door properly; washing may be caught.

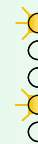

Clean detergent-solution pump (page 9), outlet pipe/drainage hose blocked.

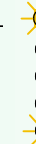

Turn on the tap, supply hose
○ kinked/jammed;
○ clean filter (page 9), water
○ pressure too low.



Motor fault. Call customer service!



Water in the base pan, appliance leaking. Call customer service!



- Risk of scalding!
Allow detergent solution to cool down!
- Turn off the tap!

Detergent-solution pump

Set programme selector to **Off**, pull out the mains plug.

1. Open and remove service flap.
2. For models with drainage hose:
Take drainage hose out of the holder and pull out of the housing. Remove sealing cap, allow detergent solution to flow out.
Press on sealing cap and insert drainage hose into the holder.
- 2* For models without drainage hose:
Carefully unscrew pump cover until the detergent solution begins to run out.
When the service flap is half full, screw back the pump cover and empty the service flap.
Repeat steps until all the detergent solution has run out.
3. Carefully unscrew the pump cover (residual water).
4. Clean the interior, pump cover thread and pump housing (fan impeller in the detergent-solution pump must rotate).
5. Reinsert and screw on pump cover.
6. Insert and close service flap.

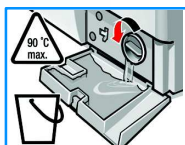
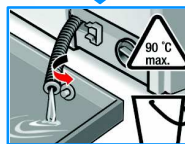
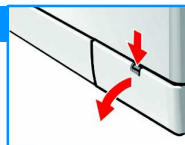

To prevent unused detergent from flowing into the outlet during the next wash:
Pour 1 litre of water into dispenser II and select the **Empty** programme.

Filters in the water supply



Risk of electric shock! Do not immerse Aqua-Stop safety device in water (contains electric valve).

Release water pressure in the supply hose:

1. Turn off the tap!
2. Select any programme (except **Spin/Empty**).
3. Press **Start/pause**. Leave programme for approx. 40 seconds.
4. Set programme selector to **Off**.
5. Remove hose from tap.
6. Clean filter with small brush.
7. Depending on the model, remove hose from the rear of the appliance and clean the filter.
8. Connect the hose and check for leaks.

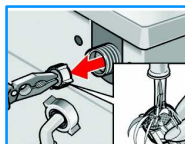

- Water is running out.
 - Correctly attach/replace drainage hose.
 - Tighten screw-fitting on the supply hose.
- Water not flowing in.
Detergent not washed in.
 - **Start/pause** not selected?
 - Tap not open?
 - Filter blocked? Clean filter (page 9).
 - Supply hose kinked or jammed?
- Washing machine door cannot be opened.
 - Safety function active. Wait 2 minutes
 - Rinse Hold selected?
- Programme does not start.
 - **Start/pause** selected?
 - Door closed?
- Detergent solution is not drained.
 - Clean detergent-solution pump (page 9).
 - Clean outlet pipe and/or drainage hose.
- Washing not spun correctly.
 - Distribute small and large items of washing in the drum.
- Spin cycle actuated several times.
 - Not a fault – unbalanced load detection system adjusts imbalance.
- Water not visible in the drum.
 - Not a fault – water below the visible area.
- Residual water in the dispenser for care product.
 - Not a fault – effect of the care product not impaired.
- Odour formation in the washing machine.
 - Run **Cotton 90 °C** programme without washing. Use standard detergent.
- Foam is coming out of the detergent drawer.
 - Too much detergent used?
Mix 1 tablespoon of fabric conditioner with ½ litre of water and pour into dispenser II in the detergent drawer.
 - Reduce detergent dosage for the next wash cycle.
- Vibrations during spin cycle.
 - Appliance feet fixed?
Secure appliance feet (Installation instructions).
 - Transportation safety devices removed?
Remove transportation safety devices (Installation instructions).
- Spin result not satisfactory.
 - **Anticrease** selected (page 5)?
- Display panel/indicator lights do not function while the appliance is running.
 - Power failure?
 - Fuse tripped? Switch on/replace fuse.
 - If the fault occurs repeatedly, call customer service.
- Programme progress longer than usual.
 - Not a fault – unbalanced load detection system adjusts imbalance by repeatedly distributing the washing.
 - Foam detection system active – a rinse cycle is started.
- Detergent residue on the washing.
 - Occasionally phosphate-free detergents contain water-insoluble residue.
 - Select **Rinse** or brush the laundry after washing.
- If a fault cannot be rectified or a repair is required:
 - Set programme selector to **Off** and pull out the mains plug.
 - Turn off the tap and call customer service (Installation instructions).



Safety instructions

- Read and follow the operating and installation instructions and all other information enclosed with the washing machine.
- Retain documents for subsequent use.

Risk of electric shock

- Never pull out the mains plug by tugging the power cord!
- Never insert/pull out the mains plug with damp hands.

Risk of injury

- Washing machine door may become very hot.
- Caution when draining hot detergent solution.
- Do not climb on the washing machine.
- Do not lean on the open washing machine door.
- Do not touch the drum if it is still rotating.

Risk of poisoning

Risk of suffocation

- Keep detergents and care products out of the reach of children.
- Keep packaging, plastic film and packaging parts out of the reach of children.

Danger to life

On redundant appliances:

- Pull out the mains plug.
- Sever the power cord and discard together with the plug.
- Destroy the lock on the washing machine door. This will prevent children from locking themselves in and suffocating.

Risk of explosion

- Caused by detergents containing solvents, e.g. stain remover/items of washing pretreated with solvent naphtha may result in an explosion after being loaded into the washing machine. Beforehand thoroughly rinse items of washing by hand.

SIEMENS

Operating instructions

en

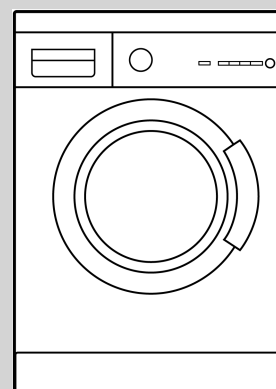

Washing machine

Consumption values

Programme	Additional function	Load	Current **	Water **	Programme duration **
Cotton 40 °C*	Stains	7 kg	0.65 kWh	65 l	2:30 h
Cotton 60 °C	–	7 kg	1.20 kWh	70 l	1:35 h
Cotton-Intensive 60 °C*	Stains	7 kg	1.19 kWh	49 l	2:36 h
Cotton 90 °C*	Stains	7 kg	2.00 kWh	75 l	2:33 h
Easy-Care 40 °C*	Stains	3 kg	0.55 kWh	50 l	1:24 h
Easy-Care 40 °C (also suitable as Short programme)	–	3 kg	0.55 kWh	40 l	0:55 h
Mix	–	3 kg	0.60 kWh	37 l	0:50 h
Delicates 30 °C	–	2 kg	0.25 kWh	34 l	0:32 h
Wool 30 °C	–	2 kg	0.15 kWh	30 l	0:40 h

* Programme setting with **Stains** (yoğun yıkama) option and maximum spin speed for testing according to or in accordance with EN 60 456 and IEC 60 456.

** The values deviate from the indicated values depending on water pressure, water hardness, water inlet temperature, room temperature, type and amount of washing and degree of soiling, utilised detergent, fluctuations in the mains voltage and selected additional functions.



Read these instructions before switching on the washing machine!
Also follow the separate installation instructions.
Follow the safety instructions on page 11!