

Brief and handy:  
everything your dishwasher  
needs...  
**Before using for the first  
time, read the installation  
and operating instructions!**

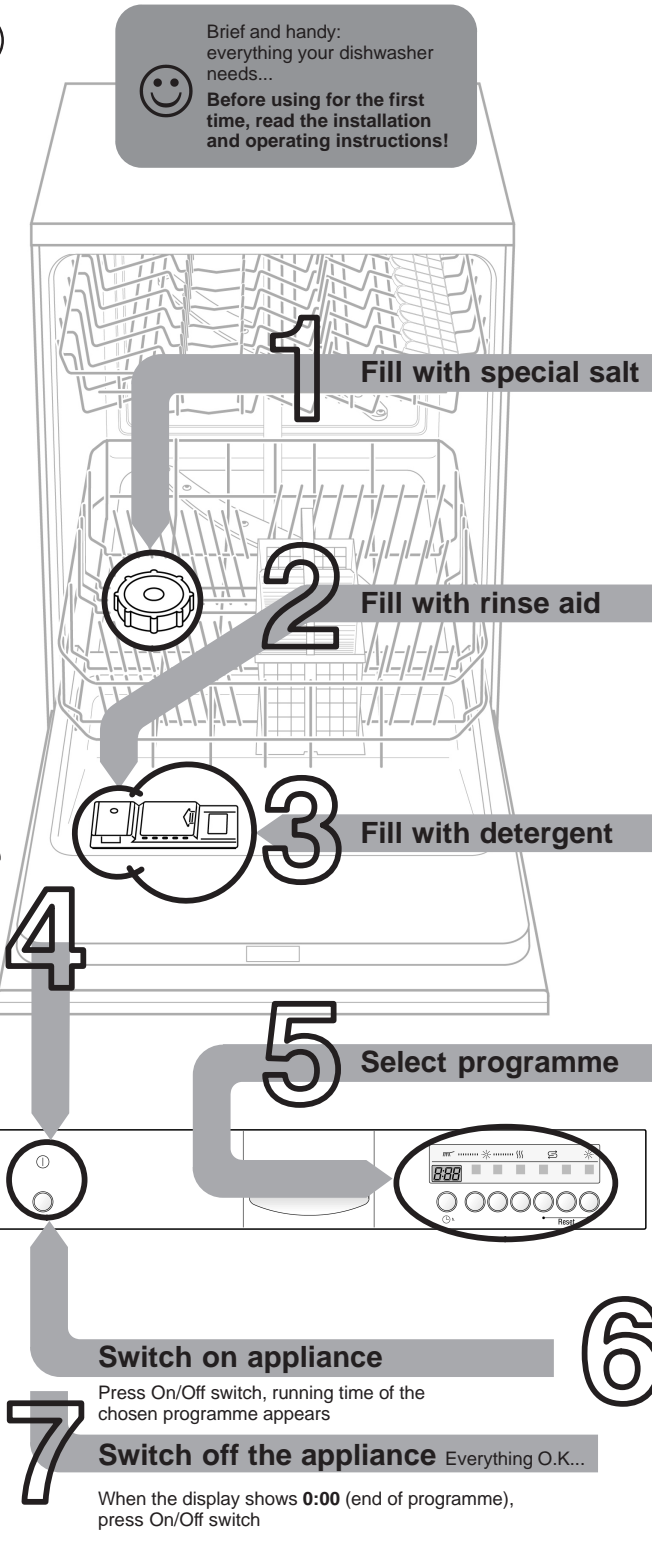

### Adjusting the water softening system \*

Request the water hardness  
value in your area from your  
water supply company and  
**enter it here ...**

\* **only before first use**  
of the appliance or if  
the **water hardness**  
changes

Read off the correct setting for your water hardness

Wasser- Härte- wert °dH	Härte- stufe	mmol/l	Einstellwert an der Maschine
0 - 6	I	0 - 1,1	H:00
7 - 8	I	1,2-1,4	H:01
9 - 10	II	1,5-1,8	H:02
11-12	II	1,9-2,1	H:03
13-16	III	2,2-2,9	H:04
17-21	III	3,0-3,7	H:05
22-30	IV	3,8-5,4	H:06
31-50	IV	5,5-8,9	H:07

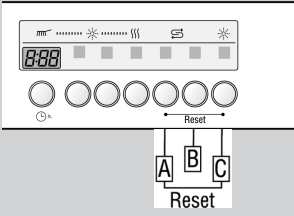

Dissolves limescale (not required for set value 0!)

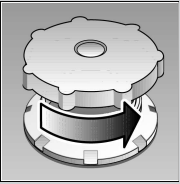

Unscrew  
the lid.

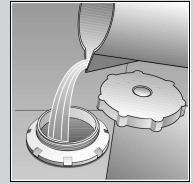

**Only before using  
the dishwasher  
for the first time  
pour approx. 1 l /  
2 pt water into the  
salt opening.**

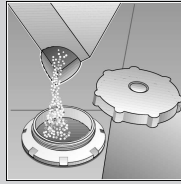

Pour in max.  
1.5 kg / 3 lb 5 oz  
**salt** (never deter-  
gent!)

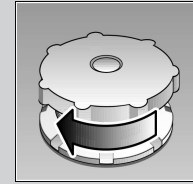

Screw on the  
lid. Switch on  
dishwasher  
immediately.

Everything is sparkling clean ...

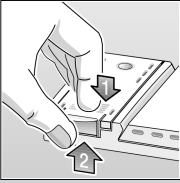

Press mark 1,  
lift up lid 2.



Refill whenever level indicator is light!

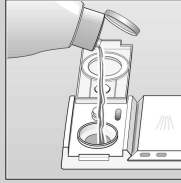

Pour in  
**rinse aid**.

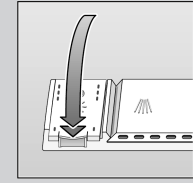

Close the  
lid. **CLICK!**

Very dirty dishes, a lot of detergent ...

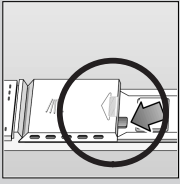

If required, open  
the lid (press the  
pin).



**Warning,**  
combination  
products are not  
suitable for all  
programmes,  
follow manufac-  
turer's instructions.

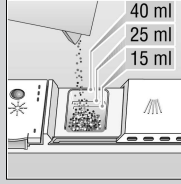

Pour in  
**detergent**.

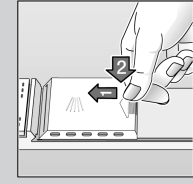

Push the lid  
shut, press.  
**PLOP!**

Quick, economical or intensive

#### Programme Overview

This overview shows the maximum number of programmes  
available. You'll find the corresponding programmes of your  
device on your control panel.

The programme data are laboratory read-  
outs according to  
European Standard EN 50242.  
In practice, deviations are possible.

	Intensive 70°	Auto 55°/65°	Eco 50°	Gentle 40°	Quick 45°	Prerinse
Duration: hs/mins	2:18	1:25-2:20	2:20	1:15	0:30	0:19
Energy Consumption: kWh	1,65	1,10-1,60	1,05	0,90	0,80	0,05
Water Consumption: litres	16	10-17	14	14	10	4
With Aquasensor	13	-	-	11	-	-

#### Additional programmes \*\*

**Soak**  
...crockery in the lower  
basket, programme  
starts automatically,  
remember to add an  
extra 5g of cleaning  
agent when the door  
unlocks.

**Time reduction/  
time saving**  
...shortens the  
cleaning time, reduces  
the drying.

**Upper basket cleaning**  
...Only the crockery in the  
upper basket is cleaned

**Lower basket cleaning**  
...Only the crockery in the  
lower basket is cleaned

**Time selection**  
...switches on as soon as  
you press the time  
selection button:  
Alters the programme  
start in hourly steps

\*\* on some models

Maintenance and care

Strainers ...

Check, if required, clean

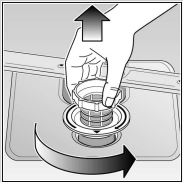

Rotate filter cylinder, remove filter system ...

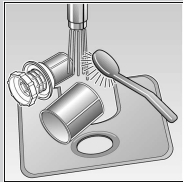

rinse under flowing water ...

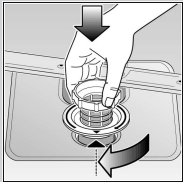

Insert ...

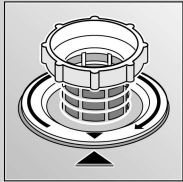

Screw in filter system NOTE MARK!

Cleaning the waste-water pump \*

- \* With some models
- Ladle out water and remove filters
- Unscrew cover (Torx T20)
- Check area of fan impeller for foreign objects
- Screw in cover and insert filters

Spray arms ...

Remove blockages/deposits

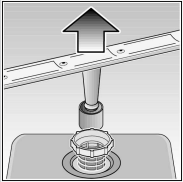

Pull lower arm upwards ...

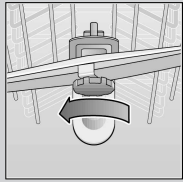

Unscrew upper arm ...

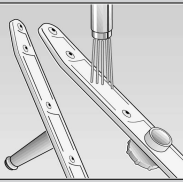

Clean spray nozzles under flowing water (perhaps with toothpick) ...

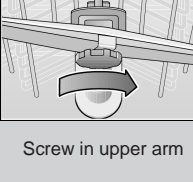
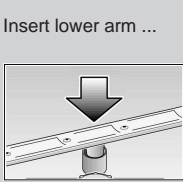

Screw in upper arm

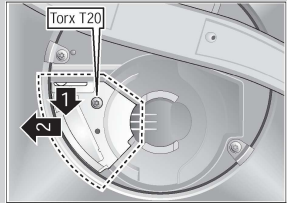

Eliminating minor faults yourself ...

... Self-help pays!

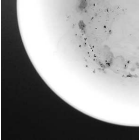
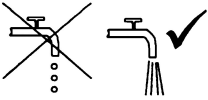
Fault	Possible Cause	Remedy	Fault	Possible Cause	Remedy
Residual water in the device	Waste-water pump blocked Programme not yet ended	<ul style="list-style-type: none"><li>▶ Clean waste-water pump (see above).</li><li>▶ Close and switch on appliance or terminate programme (see Terminating the programme).</li></ul>	Dishes not clean Sand or grainy residues on dishes	Utensils are situated too close to each other or on top of each other Too little cleaning product  Unsuitable programme selected Spray nozzles blocked Filters dirty, not installed securely Spray arms blocked	<ul style="list-style-type: none"><li>▶ Spread out the utensils, avoid contact between the utensils.</li><li>▶ Follow manufacturer's specifications (detergent).</li><li>▶ Select more intensive programme.</li><li>▶ Clean spray arms (see above).</li><li>▶ Clean the strainers (see above).</li><li>▶ Arrange the utensils so that the spray arms can rotate freely.</li></ul>
Device does not work/stops	Supply fitting not open Supply hose kinked Supply fitting jammed or calcified 	<ul style="list-style-type: none"><li>▶ Open supply fitting.</li><li>▶ Lay supply hose without kinks.</li><li>▶ 1. Unscrew water connection.</li><li>▶ 2. Clean filter in the water connection.</li><li>▶ 3. Flow rate must be min. 9 l/min when the water inlet is open.</li><li>▶ If the flow rate is less, replace the supply fitting.</li></ul>	Stains and streaks	Rinse aid dosage too high / too low	<ul style="list-style-type: none"><li>▶ Streaks: Reduce dosage.</li><li>▶ Water or limescale stains: Increase dosage.</li></ul>
Plastic parts / parts of dishes discoloured	Too little cleaning product Discoloration caused by food colourings (tomato sauce)	<ul style="list-style-type: none"><li>▶ Follow manufacturer's specifications (detergent).</li><li>▶ Discoloration is quite safe; fades after subsequent rinse cycles.</li></ul>	Milky residues on dishes (can be removed)	Water softening system incorrectly set; no special salt	<ul style="list-style-type: none"><li>▶ Set water softening system correctly.</li><li>▶ Refill with special salt.</li></ul>
Cutlery rusty	Cutlery not rust-proof Hard knife blades are more susceptible Extraneous rust	<ul style="list-style-type: none"><li>▶ Use dishwasher-proof cutlery.</li><li>▶ Never wash rusting parts in the appliance.</li></ul>	Milky film, glasses cloudy / dull (cannot be removed)	Glasses not dishwasher-proof.	<ul style="list-style-type: none"><li>▶ Use dishwasher-proof glasses.</li><li>▶ Use glass-friendly cleaning products.</li></ul>

Further advice can be found in the instruction manual

Stopping the programme ...

Press and hold the two reset buttons simultaneously for approximately 3 seconds while the programme is running (RESET)

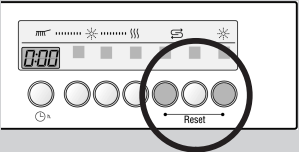

"0:00" appears  
The programme will stop after 1 minute



Switch off the appliance.

Loading the dishwasher correctly ...

Arrange dishwasher-proof utensils (having removed any ash, wax, grease, ink, sticky labels; remove, large remnants of jam, dairy products and food) according to the operating instructions and check that the spray arms can rotate freely.