

## Your new dryer

**Congratulations** – You have opted for a modern, high-quality domestic appliance of the Siemens brand. The condenser dryer is distinguished by its economical energy consumption.

Each dryer which leaves our factory is inspected thoroughly to ensure that it functions properly and is in perfect condition.

If you have any questions, please do not hesitate to contact our customer service.

### Environmental disposal

Dispose of packaging in an environmentally friendly manner.

This appliance has been identified in accordance with the European directive 2002/96/EG on Waste Electrical and Electronic Equipment – WEEE.

The directive specifies the framework for an EU-wide valid return and recycling of old appliances.

## Contents

	Page
■ Preparation	2
■ Setting programmes	2
■ After drying	4
■ About the washing ...	5
■ Servicing and cleaning	6
■ Overview of programmes	7
■ Installation	8
■ Technical specifications	9
■ Optional accessories	9
■ What to do if ...	10
■ Safety instructions	11

## Intended Use

- only in the household;
- only for drying textiles which have been washed with water.

- Do not leave children unattended near the dryer!
- Keep pets away from the dryer!

## Preparation

For installation see page 8

Never use a damaged dryer!  
Notify customer service!

Check the dryer

Insert the mains plug

With dry hands only!  
Take hold of the plug with dry hands only!

Sort and put in the washing

Take all objects out of the pockets.  
Look out for cigarette lighters!  
The drum must be empty before it is loaded!

See overview of programmes on page 7.  
See also separate instructions for "Woollens basket" (depending on model).

Selecting + setting programme

Select drying programme ...

... and adjust individually

Select Start button

All buttons are sensitive,  
a gentle tap is adequate!

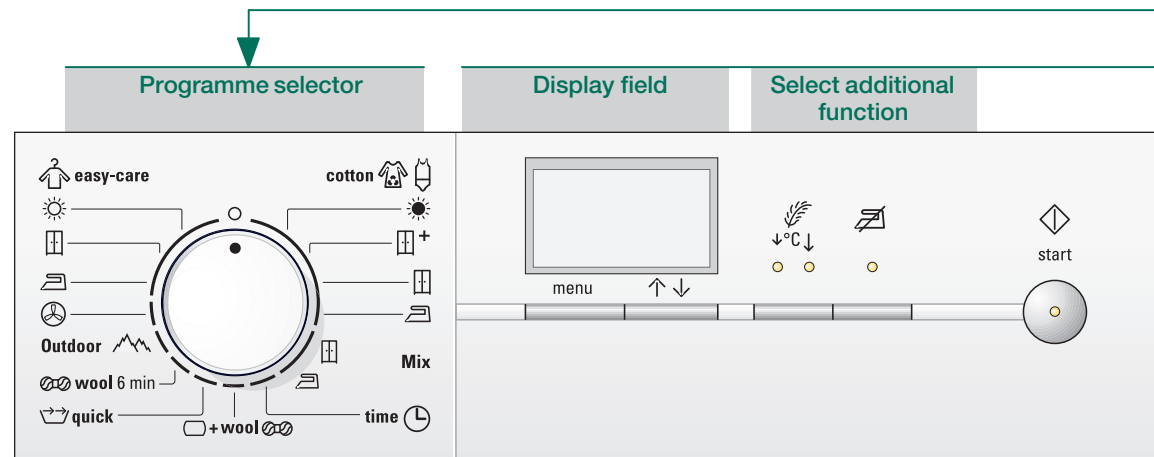

to select the settings

■ menu

to change all settings on the display panel

■ ↑↓ Change

1\*–24 hours End of programme after ... ("depending on the selected programme, e.g. duration 1:54h → 2h. Can always be selected to the next full hour.)

Finish in

0, 1, 2, 3 Buzzer volume has four settings (0 = buzzer switched off)

Buzzer

On–Off Prevents unauthorised use (hold down menu button for 5 seconds)

Lock (depending on model)

0, 1, 2, 3 Fine adjustment of the degree of drying for cotton, easy-care, Mix and quick programme

Degree of dryness

600–1800 Spin speed at which the washing was spun

Spin speed

## Drying



## Drying

### Draining the condensation

- Pull out the container and keep in a horizontal position.
- Pour out the condensation.
- Insert the container until it locks into position.

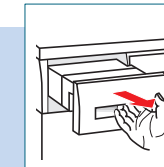

### Cleaning the fluff filter

- Open door, pull out filter and open.
  - Remove fluff (run hand over filter).
  - Close filter, re-insert and close door.
- Rinse extremely soiled or blocked filters with warm water and dry thoroughly.

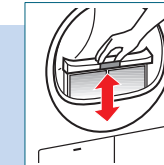

### Switching off the dryer

Set programme selector to ○ (Off).  
Do not leave damp washing in the dryer!

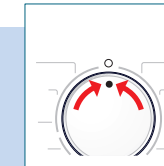

### Removing washing

The automatic anti-crease function causes the drum to move at specific intervals, the washing remains loose and fluffy for an hour (two hours if the Less Ironing function is also selected – depending on model).

### Programme end

as soon as → is lit on the display panel

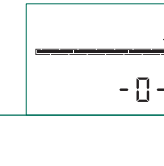

### Topping up or removing washing

- Open door, the drying process is terminated.
- Top up or remove washing and close door.
- If required, reselect programme and additional functions.
- Select start button.

Drum and door may be hot.

## About the washing ...

### Identifying textiles

Follow care information of the manufacturer!

- Dry at normal temperature.
- Dry at low temperature → also select ↓ °C ↓ (Low Heat).
- Do not dry by machine.

Do not dry the following textiles in the dryer:

- Airtight textiles (e.g. rubberised).
- Delicate fabrics (silk, synthetic curtains) → anti-creasing!
- Dripping wet washing → high energy consumption!
- Oil-contaminated washing.

### Drying tips

- For uniform drying result, sort the washing according to fabric type and drying programme.
- Close zips, hooks and eyelets, button up quilt covers, tie fabric belts, apron strings, etc.
- Do not overdry the washing → risk of creasing! Leave the washing to air.
- Do not iron the washing immediately after drying, fold up the washing for a while → residual moisture will then be distributed evenly.
- Knitted textiles (e.g. T-shirts, knitted underwear) often shrink when dried for the first time → Do not use the Extra Dry programme.
- The drying of starched washing should be limited → Starch leaves a coating which impairs drying.
- Use the time programme for a small load.

### Protection of the environment/Conservation of energy

- Before drying, thoroughly spin the washing in the washing machine → Higher spin speeds reduce the drying time and lower the energy consumption; also spin easy-care washing.
- Use the maximum recommended load, but do not exceed → Page 7, "Overview of programmes".
- Ensure that the room is well ventilated during the drying process.
- Clean the fluff filter after each drying process → Page 4.
- Keep the air cooler clean → Page 6 "Servicing and cleaning".
- Ensure that the cooling air flow is not obstructed → Do not block or seal the cooling grille.

## Servicing and cleaning

Appliance must be switched off!

### Dryer housing, control panel, cooling grille

- Rub with a soft, damp cloth.
- Do not use any caustic cleaning agents/solvents.
- Immediately remove washing and cleaning agent residue.
- During drying, water may occasionally collect between the window and the seal. This does not adversely affect the function of your dryer in any way!

Clean protective filter 3–4 times a year or if (Clean filter) flashes when the fluff filter has been cleaned.

### Air cooler/protective filter

To clean, remove the protective filter only! Clean the air cooler behind the protective filter once a year!

- Leave the dryer to cool down.
- Residual water may escape, place an absorbent cloth under the maintenance flap.

- Unlock the maintenance flap.
- Completely open maintenance flap.

- Screw both locking levers towards each other.
- Pull out the protective filter/air cooler.

Do not damage the protective filter or air cooler!  
Clean with warm water only; do not use hard/sharp-edged objects!

- Thoroughly clean the protective filter/air cooler, allow all the water to drip out.
- Clean the seals.
- Re-insert the protective filter/air cooler, handle below!
- Unscrew both locking levers.

- Close the maintenance flap until it locks into position.



After drying:

- iron the washing
- lightly iron the washing
- do not iron the washing
- mangle the washing

	T-Shirt	Shirts	Trousers	Skirts/dresses	Sportswear	Work clothes	Anorak	Towel/ing bathrobe	Underwear	Socks	Bed linen	Table linen	Terry towels	Tea towels/ Hand towels
<b>cotton</b> (Iron Dry)														
<b>max. 6 kg</b> (Cupboard Dry)														
<b>max. 3 kg</b> (Cupboard Dry Plus)														
<b>max. 1.5 kg</b> (Extra Dry)														
<b>easy-care</b> (Iron Dry)														
<b>max. 3 kg</b> (Iron Dry)														
<b>max. 3 kg</b> (Cupboard Dry)														
<b>max. 3 kg</b> (Very Dry)														
<b>Mix</b> (Cupboard Dry)/(Iron Dry)														
<b>max. 3 kg</b> (De-Crease)														
<b>max. 1.5 kg</b> (Outdoor)														
<b>max. 3 kg</b> (Wool 6 min)														
<b>max. 3 kg</b> (Quick)														
<b>max. 1.5 kg</b> (Wool +)														
<b>max. 3 kg</b> (Time)														

Further information and a selection of our products can be found on our Internet page:  
<http://www.siemens-international.com>

WT46S510BY  
WT46S510SK  
0507 en  
90000 56586

SiemensElectrogeräte GmbH  
Carl-Wey Str. 34  
81739 München / Deutschland

Installation

- Included in delivery: Dryer, operating and installation instructions, woollens basket (depending on model).
- Mains plug not inserted!
- Check dryer for damage which may have been caused in transit!
- Dryer is heavy. Do not lift it by yourself!
- Beware of sharp edges!
- Do not install in a room where there is a risk of frost! Freezing water may result in damage!
- If in doubt, have a technician connect the appliance!
- Do not lift the dryer by projecting components (e.g. door) – risk of breakage!

**1. Installing the dryer**

Take all accessories out of the drum. Drum must be empty!

- Mains plug must be accessible at all times!
- Place the dryer on a clean, level and firm surface!
- Do not obstruct cooling grille at the front of the dryer.
- Keep the area around the dryer clean.
- Align the dryer with the height-adjustable feet.
- Use a spirit level.
- Never remove the height-adjustable feet!

Clean and level  
Do not obstruct cooling grille

**2. Mains connection**

see Safety instructions, page 11.

- Connect correctly to an a.c. earthed socket. If in doubt, have the socket checked by an electrician!
- Mains voltage must correspond with the voltage specifications on the appliance rating plate (see page 9)!
- Wattage and required fuse are indicated on the appliance rating plate.

**3. Switching over the connected load**

10/16 ampere

Set to ○ (Off)   1 x clockwise   Hold selected and 3 x clockwise   Set ampere   Set to ○ (Off)

Feedback signals (depending on model)

10 A	Lo			off
16 A	hi			flashes

Display field

If required, select repeatedly.

Frost protection/ transportation

- Do not operate the dryer if there is a risk of frost!
- Preparation**
  - Empty condensation container, see page 4.
  - Set programme selector to any programme.
  - Select **start** button –> condensation is pumped into the container.
  - Wait 5 min., empty condensation container again.
  - Set programme selector to ○ (Off).

Technical specifications

- Dimensions (D x W x H)** 60 x 60 x 85 cm (height-adjustable)
  - Weight (net)** approx. 45 kg
  - Max. capacity** 6 kg
  - Condensation container** 4.2 l
  - Supply voltage**
  - Connected load**
  - Fuse**
  - Product number (E-Nr.)**
  - Production number (FD)**
- See appliance rating plate
- The appliance rating plate is situated on the rear of the dryer.

Consumption values			Specifications are approximate values determined under normal conditions. Fluctuations up to 10% are possible.			
	Spin speed r.p.m. (residual humidity)		Drying time in min. with 8 min. cooling time		Energy consumption in kWh	
			10 A	16 A	10 A	16 A
<b>cotton 6 kg</b> (Cupboard Dry*)	1400	(approx. 50%)	100	80	3.0	3.0
	1000	(approx. 60%)	118	96	3.6	3.6
	800	(approx. 70%)	140	110	4.2	4.2
(Iron Dry*)	1400	(approx. 50%)	76	56	2.2	2.2
	1000	(approx. 60%)	94	72	2.8	2.8
	800	(approx. 70%)	116	86	3.4	3.4
<b>easy-care 3 kg</b> (Cupboard Dry*)	800	(approx. 40%)	42	36	1.2	1.2
	600	(approx. 50%)	53	45	1.5	1.5

\* Test programmes according to DIN EN 61 121 and IEC 61 121

- Drum light (Bulb E14, 15 W)** (depending on model)
- The drum is lit when the door is opened and closed or when the programme starts; it goes out automatically.

Optional accessories

- Order no.
- |          |   |
|----------|---|
| WZ 20160 | <b>Connection fittings for condensation outlet</b><br>The condensation is conveyed directly via a hose.   |
| WZ 20310 | <b>Connection set for washing-drying column</b><br>To save space, the dryer can be placed on a suitable washing machine which has the <b>same depth and width</b> . |
| WZ 20300 | Same as WZ 20310 but with removable worktop.  |
| WZ 20290 | <b>Cover for appliance underneath worktop</b><br>The dryer can be built under the worktop in a line of kitchen units.   |

What to do if ...

- Repairs may be carried out by customer service or authorised technicians only! Before you call customer service, please check whether you can correct the fault yourself. A technician will charge you for advice, even during the warranty period. Please give customer service the product number (E-Nr.) and the production number (FD) of the appliance (see inside of door).
- start** indicator light does not come on.

Is the mains plug inserted?  
Programme selected?  
Check fuse in the house.
- (Empty water) symbol and **start** indicator light flash.

Empty condensation container.  
If featured, check hose for condensation outlet (kink).
- (Clean filter) symbol and **start** indicator light flash.

Clean air cooler, page 6 “Servicing and cleaning”.  
Clean fluff filter, page 4.
- Dryer does not start.

**start** button selected?  
Door closed?  
Programme set?  
Ambient temperature higher than 5 °C?
- Water is running out.

Align dryer horizontally.  
Clean air cooler seal.
- Door is opening by itself.

Press door until it “clicks” into position.
- Degree of dryness was not reached or drying time too long.

Clean fluff filter/air cooler, page 4/6.  
Empty condensation container.  
Check water outlet (if featured).  
Ambient temperature above 30 °C –> adequate ventilation.  
Cooling grille may be blocked –> unblock.  
Unsuitable programme set? Page 7.  
Dryer installation too restricted? Provide air circulation.  
Power failure –> restart dryer.
- Washing damp.

Use next higher drying programme or also the time programme, page 7.  
Warm washing feels damper than it actually is!
- Humidity in the room is increasing significantly.

Ventilate room adequately.  
Cooling grille blocked? –> Unblock.  
Ensure that the air cooler has been inserted.
- One or more indicator lights for programme status are flashing.

Clean filter and air cooler, page 4/6.  
Check installation conditions, page 8.  
Switch off, leave to cool down, switch on again, restart programme.
- Does the interior light (depending on model) work?

Pull out the mains plug. Open cover inside the appliance above the door (with a Torx 20 screwdriver) and change the bulb.  
Close cap.
- If you cannot correct a fault yourself or if a repair is required:

- Set programme selector to ○ (Off).
  - Pull out the mains plug.

Safety instructions

- Emergency Use dryer ONLY ... NEVER ...**
- Hazards**
  - Immediately pull out mains plug or interrupt fuse.
  - in the house.
  - for drying textiles.
  - use dryer for other purposes than those described above.
  - modify the technology or properties of the dryer.
  - Children and uninstructed persons must not use the dryer.
  - Do not leave children unattended near the dryer.
  - Keep pets away from the dryer.
  - Take all objects out of the pockets. Look out for cigarette lighters –> risk of explosion!
  - Do not lean or sit on the door –> risk of dryer tipping over!
  - Open the door carefully. Hot steam may escape.
- Installation**
  - Frost damage possible below 0 °C.
  - Attach loose cables or hoses, otherwise risk of tripping.
- Mains connection**
  - Connect the dryer correctly to an a.c. earthed socket, otherwise safety cannot be ensured.
  - Cable cross-section must be adequate.
  - Use residual-current-operated circuit-breaker with this symbol only:
  - Mains plug and socket must match.
  - Do not use multiple plug/couplings and/or extension leads.
  - Do not take hold of the mains plug with damp hands.
  - Never pull the mains plug out of the socket by tugging the cable.
  - Do not damage the power cord.
- Operation**
  - Load the drum with *washing only*. Check the contents before switching on the dryer.
  - Do not use the dryer if the washing has come into contact with solvent, oil, wax, grease or ink (e.g. setting lotion, nail varnish remover, stain remover, solvent naphtha, etc.) –> risk of fire/explosion!
  - Dust hazard (e.g. coal dust, flour): do not use the dryer –> risk of explosion!
  - Do not use the dryer if the washing contains foam/rubber –> elastic material may be destroyed and the dryer may be damaged by possible deformation of the foam.
  - Switch off the dryer when the programme ends.
  - Do not drink the condensation!
- Defect**
  - Do not use the dryer if it is defective or considered to be defective; repairs by customer service only.
  - Do not use the dryer if the power cord is defective. To prevent hazards, have a defective power cord replaced by customer service only.
  - Before changing the interior light bulb, always pull the mains plug out of the socket.
- Spare parts Disposal**
  - For reasons of safety use original spare parts and accessories only.
  - Dryer: pull out the mains plug, **then** sever the power cord on the appliance. Dispose of at a public waste disposal centre.
  - Packaging: do not allow children to play with packaging parts –> risk of suffocation!
  - All materials are environmentally friendly and recyclable. Dispose of in an environmentally friendly manner.
- 11
- 
- Operating and installation instructions
- 
- Read these instructions before switching on the dryer! Follow instructions on page 11!
- en

# Your new dryer

**Congratulations** – You have opted for a modern, high-quality domestic appliance of the Siemens brand. The condenser dryer is distinguished by its economical energy consumption.

Each dryer which leaves our factory is inspected thoroughly to ensure that it functions properly and is in perfect condition.

If you have any questions, please do not hesitate to contact our customer service.

## Environmental disposal

Dispose of packaging in an environmentally friendly manner.

This appliance has been identified in accordance with the European directive 2002/96/EG on Waste Electrical and Electronic Equipment – WEEE.

The directive specifies the framework for an EU-wide valid return and recycling of old appliances.



# Intended Use

- only in the household;
- only for drying textiles which have been washed with water.



- Do not leave children unattended near the dryer!
- Keep pets away from the dryer!

# Preparation

For installation see page 8



Never use a damaged dryer!  
Notify customer service!



With dry hands only!  
Take hold of the plug with dry hands only!



Sort and put in the

Take all objects out of the pockets.  
Look out for cigarette lighters!  
The drum must be empty before it is loaded!

See overview of programmes on page 7.  
See also separate instructions for "Woollens bas" (depending on model).

# Contents

Page

- Preparation ..... 2
- Setting programmes .... 2
- After drying ..... 4
- About the washing ... .. 5
- Servicing and cleaning .. 6
- Overview of programmes 7
- Installation ..... 8
- Technical specifications . 9
- Optional accessories .... 9
- What to do if ... .. 10
- Safety instructions ..... 11

Selecting + setting p

Select drying p

... and adj

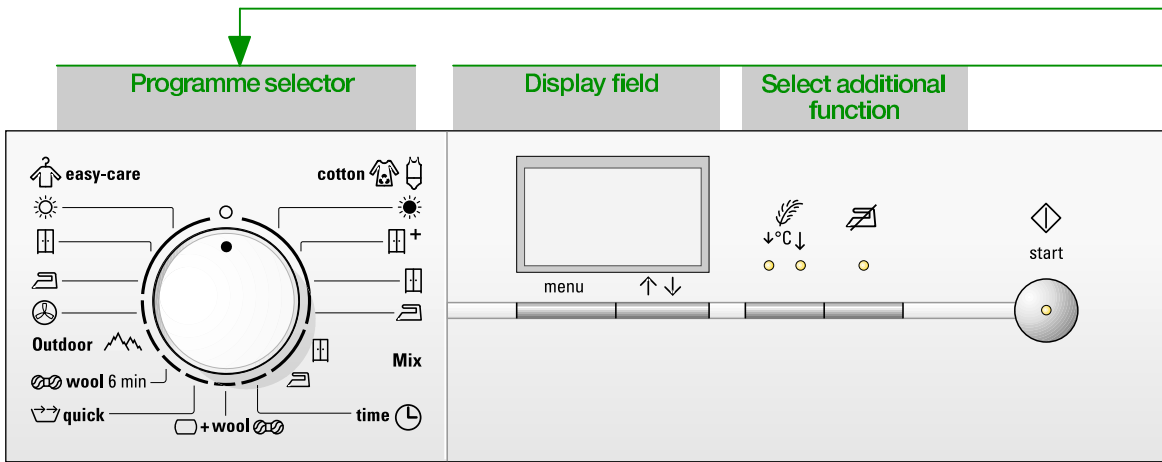

All buttons are sensitive to a gentle tap is adequate

Select

to select the settings		to change all settings on the display panel	
1*–24 hours	End of programme after ...(*depending on the selected programme, e.g. duration 1:54h -> 2h. Can always be selected to the next full hour.)	menu	Reduced temperature in two stages for delicate fabrics, e.g. polyacryl, polyamide, elastane, acetate, to reduce drying time.
0, 1, 2, 3	Buzzer volume has four settings (0 = buzzer switched off)	↑↓ Change	Less Ironing
On–Off	Prevents unauthorised use (hold down menu button for 5 seconds)	Finish in	Reduces creasing and extends anti-crease programme ends.
0, 1, 2, 3	Fine adjustment of the degree of drying for cotton, easy-care, Mix and quick programme	Buzzer	Status displays
600–1800	Spin speed at which the washing was spun	Lock (depending on model)	Displays for programme sequence: drying, iron dry, cupboard dry, finished/less ironing
		Degree of dryness	Service displays
		Spin speed	Clean filter
			Empty water

Check the dryer

Insert the mains plug

the washing

ket"

programme

programme ...

ust individually

ive,  
ate!

ct Start button

ate textiles ☐,  
for longer

hase when

roning,

# Drying

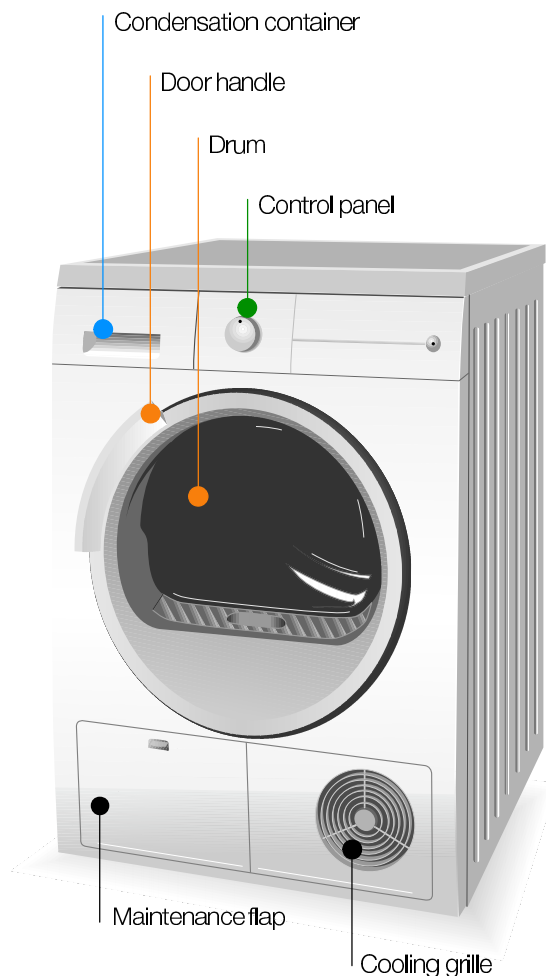

## Drying



### Draining the condensation

1. Pull out the container and keep in a horizontal position.
2. Pour out the condensation.
3. Insert the container until it locks into position.

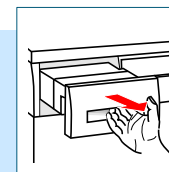

### Cleaning the fluff filter

1. Open door, pull out filter and open.
  2. Remove fluff (run hand over filter).
  3. Close filter, re-insert and close door.
- Rinse extremely soiled or blocked filters with warm water and dry thoroughly.

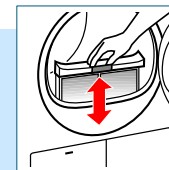

### Switching off the dryer

Set programme selector to 0 (Off).  
Do not leave damp washing in the dryer!

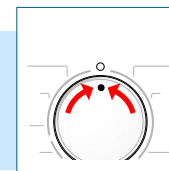

### Removing washing

The automatic anti-crease function causes the drum to move at specific intervals, the washing remains loose and fluffy for an hour (two hours if the  $\text{A}$  (Less Ironing) function is also selected – depending on model).

**Programme end** as soon as  $\rightarrow$  is lit on the display panel



### Topping up or removing washing

1. Open door, the drying process is terminated.
2. Top up or remove washing and close door.
3. If required, reselect programme and additional functions.
4. Select  $\diamond$  **start** button.



Drum and door may be hot.







# About the washing ...



## Identifying textiles

### Follow care information of the manufacturer!

-  Dry at normal temperature.
-  Dry at low temperature → also select  (Low Heat).
-  Do not dry by machine.



Do not dry the following textiles in the dryer:

- Airtight textiles (e.g. rubberised).
- Delicate fabrics (silk, synthetic curtains) → anti-creasing!
- Dripping wet washing → high energy consumption!
- Oil-contaminated washing.

## Drying tips

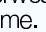
- For uniform drying result, sort the washing according to fabric type and drying programme.
- Close zips, hooks and eyelets, button up quilt covers, tie fabric belts, apron strings, etc.
- Do not overdry the washing → risk of creasing! Leave the washing to air.
- Do not iron the washing immediately after drying, fold up the washing for a while → residual moisture will then be distributed evenly.
- Knitted textiles (e.g. T shirts, knitted underwear) often shrink when dried for the first time → Do not use the  (Extra Dry) programme.
- The drying of starched washing should be limited → Starch leaves a coating which impairs drying.
- Use the time programme for a small load.

## Protection of the environment/Conservation of energy

- Before drying, thoroughly spin the washing in the washing machine → Higher spin speeds reduce the drying time and lower the energy consumption; also spin easy-care washing.
- Use the maximum recommended load, but do not exceed → Page 7, "Overview of programmes".
- Ensure that the room is well ventilated during the drying process.
- Clean the fluff filter after each drying process → Page 4.
- Keep the air cooler clean → Page 6 "Servicing and cleaning".
- Ensure that the cooling air flow is not obstructed → Do not block or seal the cooling grille.

# Servicing and cleaning



Appliance must be switched off!



## Dryer housing, control panel, cooling grille

- Rub with a soft, damp cloth.
- Do not use any caustic cleaning agents/solvents.
- Immediately remove washing and cleaning agent residue.
- During drying, water may occasionally collect between the window and the seal. This does not adversely affect the function of your dryer in any way!

Clean protective filter 3–4 times a year or if  (Clean filter) flashes when the fluff filter has been cleaned.



## Air cooler/protective filter

To clean, remove the protective filter only! Clean the air cooler behind the protective filter once a year!

- Leave the dryer to cool down.
- Residual water may escape, place an absorbent cloth under the maintenance flap.

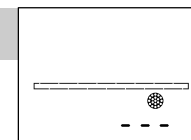

1. Unlock the maintenance flap.
2. Completely open maintenance flap.

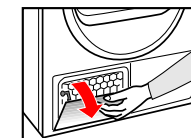

3. Screw both locking levers towards each other.
4. Pull out the protective filter/air cooler.

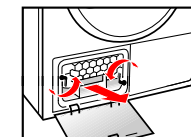

Do not damage the protective filter or air cooler!  
Clean with warm water only; do not use hard/sharp-edged objects!

5. Thoroughly clean the protective filter/air cooler, allow all the water to drip out.
6. Clean the seals.
7. Re-insert the protective filter/air cooler, handle below!
8. Unscrew both locking levers.

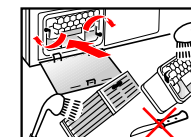

9. Close the maintenance flap until it locks into position.

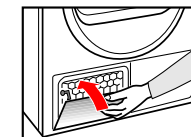

## After drying:

- iron the washing
- lightly iron the washing
- do not iron the washing
- mangle the washing

	T-Shirt	Shirts	Trousers	Skirts/dresses	Sportswear	Work clothes	Anorak	Towelling bathrobe	Underwear	Socks	Bed linen	Table linen	Terry towels	Tea towels/hand towels
<b>cotton</b> max. 6 kg	✓	✓	✓	✓	✓	✓	✓	✓	✓	✓	✓	✓	✓	✓
(Iron Dry)	✓	✓	✓	✓	✓	✓	✓	✓	✓	✓	✓	✓	✓	✓
(Cupboard Dry)	✓	✓	✓	✓	✓	✓	✓	✓	✓	✓	✓	✓	✓	✓
(Cupboard Dry Plus)	✓	✓	✓	✓	✓	✓	✓	✓	✓	✓	✓	✓	✓	✓
(Extra Dry)	✓	✓	✓	✓	✓	✓	✓	✓	✓	✓	✓	✓	✓	✓
<b>easy-care</b> max. 3 kg	✓	✓	✓	✓	✓	✓	✓	✓	✓	✓	✓	✓	✓	✓
(Iron Dry)	✓	✓	✓	✓	✓	✓	✓	✓	✓	✓	✓	✓	✓	✓
(Cupboard Dry)	✓	✓	✓	✓	✓	✓	✓	✓	✓	✓	✓	✓	✓	✓
(Very Dry)	✓	✓	✓	✓	✓	✓	✓	✓	✓	✓	✓	✓	✓	✓
<b>Mix</b> max. 3 kg	✓	✓	✓	✓	✓	✓	✓	✓	✓	✓	✓	✓	✓	✓
(Cupboard Dry)/(Iron Dry)	✓	✓	✓	✓	✓	✓	✓	✓	✓	✓	✓	✓	✓	✓

For mixed items made of cotton and easy-care textiles (mix).

For cotton or linen fabrics and easy-care textiles which are still damp. Creases in textiles are reduced. Textiles are not completely dried. Hang up textiles!

For textiles with membrane coating, water-repellent textiles, working clothes, fleece textiles (dry jackets/trousers with removable lining separately).

For machine-washable woollen textiles. Textiles are fluffier, but not dried. Remove and hang up textiles when the programme ends.

For washing which is to be dried quickly, e.g. made of synthetic fabrics, cotton or blended fabrics.

Use with separate basket only. See description of "Woollens basket".

For predried, multi-ply, delicate textiles made of acrylic fibres or for individual small items.

Also for subsequent drying.

<b>time</b> max. 3 kg	✓	✓	✓	✓	✓	✓	✓	✓	✓	✓	✓	✓	✓	✓
<b>wool</b> 6 min	✓	✓	✓	✓	✓	✓	✓	✓	✓	✓	✓	✓	✓	✓
<b>quick</b> max. 3 kg	✓	✓	✓	✓	✓	✓	✓	✓	✓	✓	✓	✓	✓	✓
<b>+ wool</b> max. 1.5 kg	✓	✓	✓	✓	✓	✓	✓	✓	✓	✓	✓	✓	✓	✓
<b>+ wool</b> max. 1.5 kg	✓	✓	✓	✓	✓	✓	✓	✓	✓	✓	✓	✓	✓	✓

Further information and a selection of our products can be found on our Internet page: <http://www.siemens-international.com>

WT46S10BY  
WT46S10SK  
0507 en  
90000 56586  
SiemensElectrogeräte-GmbH  
Carl-Wery Str. 34  
81739 München/Deutschland

## Frost protection/ transportation



### Preparation

1. Empty condensation container, see page 4.
2. Set programme selector to any programme.
3. Select **start** button → condensation is pumped into the container.
4. Wait 5 min., empty condensation container again.
5. Set programme selector to ○ (Off).

## Installation



- Included in delivery: Dryer, operating and installation instructions, woollens basket (depending on model).
- Mains plug not inserted!
- Check dryer for damage which may have been caused in transit!
- Dryer is heavy. Do not lift it by yourself!
- Beware of sharp edges!
- Do not install in a room where there is a risk of frost! Freezing water may result in damage!
- If in doubt, have a technician connect the appliance!
- Do not lift the dryer by projecting components (e.g. door) – risk of breakage!

### 1.

#### Installing the dryer



Take all accessories out of the drum. Drum must be empty!

- Mains plug must be accessible at all times!
- Place the dryer on a clean, level and firm surface!
- Do not obstruct cooling grille at the front of the dryer.
- Keep the area around the dryer clean.
- Align the dryer with the height-adjustable feet. Use a spirit level.
- Never remove the height-adjustable feet!

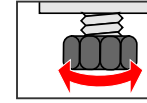

Clean and level  
Do not obstruct cooling grille

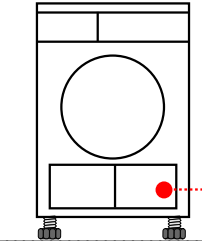

### 2.

#### Mains connection see Safety instructions, page 11.

- Connect correctly to an a.c. earthed socket. If in doubt, have the socket checked by an electrician!
- Mains voltage must correspond with the voltage specifications on the appliance rating plate (see page 9)!
- Wattage and required fuse are indicated on the appliance rating plate.

### 3.

#### Switching over the connected load



Check your socket fuse!

10/16 ampere

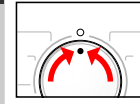

Set to ○ (Off)

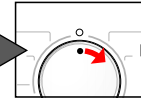

1 x clockwise

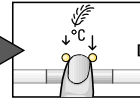

Hold selected and 3 x clockwise

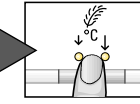

Set ampere

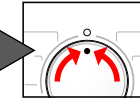

Set to ○ (Off)

Feedback signals (depending on model)

10 A

16 A

Display field

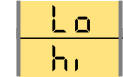

off

flashes

If required, select repeatedly.



Do not operate the dryer if there is a risk of frost!

# Technical specifications

●	- <b>Dimensions (D x W x H)</b>	60 x 60 x 85 cm (height-adjustable)
	- <b>Weight (net)</b>	approx. 45 kg
	- <b>Max. capacity</b>	6 kg
	- <b>Condensation container</b>	4.2 l
	- <b>Supply voltage</b>	} See appliance rating plate
	- <b>Connected load</b>	
	- <b>Fuse</b>	
	- <b>Product number (E-Nr.)</b>	
	- <b>Production number (FD)</b>	

The appliance rating plate is situated on the rear of the dryer.

● **Consumption values** Specifications are approximate values determined under normal conditions. Fluctuations up to 10% are possible.

Spin speed r.p.m. (residual humidity)			Drying time in min. with 8 min. cooling time		Energy consumption in kWh	
			10 A	16 A	10 A	16 A
👤 <b>cotton 6 kg</b>						
👤 (Cupboard Dry*)	1400	(approx. 50%)	100	80	3.0	3.0
	1000	(approx. 60%)	118	96	3.6	3.6
	800	(approx. 70%)	140	110	4.2	4.2
👤 (Iron Dry*)	1400	(approx. 50%)	76	56	2.2	2.2
	1000	(approx. 60%)	94	72	2.8	2.8
	800	(approx. 70%)	116	86	3.4	3.4
👤 <b>easy-care 3 kg</b>						
👤 (Cupboard Dry*)	800	(approx. 40%)	42	36	1.2	1.2
	600	(approx. 50%)	53	45	1.5	1.5

\* Test programmes according to DIN EN 61 121 and IEC 61 121

● **Drum light** (depending on model)  
**(Bulb E14, 15 W)**

The drum is lit when the door is opened and closed or when the programme starts; it goes out automatically.

# Optional accessories

Order no.

## WZ 20160 Connection fittings for condensation outlet

The condensation is conveyed directly via a hose.

## WZ 20310 Connection set for washing-drying column

To save space, the dryer can be placed on a suitable washing machine which has the **same depth and width**.

WZ 20300 Same as WZ 20310 but with removable worktop.

## WZ 20290 Cover for appliance underneath worktop

The dryer can be built under the worktop in a line of kitchen units.

# What to do if ...



Repairs may be carried out by customer service or authorised technicians only!

Before you call customer service, please check whether you can correct the fault yourself. A technician will charge you for advice, even during the warranty period. Please give customer service the product number (E-Nr.) and the production number (FD) of the appliance (see inside of door).

●	◇ <b>start</b> indicator light does not come on.	Is the mains plug inserted? Programme selected? Check fuse in the house.
●	☒ (Empty water) symbol and ◇ <b>start</b> indicator light flash.	Empty condensation container. If featured, check hose for condensation outlet (kink).
●	☒ (Clean filter) symbol and ◇ <b>start</b> indicator light flash.	Clean air cooler, <i>page 6 "Servicing and cleaning"</i> . Clean fluff filter, <i>page 4</i> .
●	Dryer does not start.	◇ <b>start</b> button selected? Door closed? Programme set? Ambient temperature higher than 5 °C?
●	Water is running out.	Align dryer horizontally. Clean air cooler seal.
●	Door is opening by itself.	Press door until it "clicks" into position.
●	Degree of dryness was not reached or drying time too long.	Clean fluff filter/air cooler, <i>page 4/6</i> . Empty condensation container. Check water outlet (if featured). Ambient temperature above 30 °C → adequate ventilation. Cooling grille may be blocked → unblock. Unsuitable programme set? <i>Page 7</i> . Dryer installation too restricted? Provide air circulation. Power failure → restart dryer.
●	Washing damp.	Use next higher drying programme or also the time programme, <i>page 7</i> . Warm washing feels damper than it actually is!
●	Humidity in the room is increasing significantly.	Ventilate room adequately. Cooling grille blocked? → Unblock. Ensure that the air cooler has been inserted.
●	One or more indicator lights for programme status are flashing.	Clean filter and air cooler, <i>page 4/6</i> . Check installation conditions, <i>page 8</i> . Switch off, leave to cool down, switch on again, restart programme.
●	Does the interior light (depending on model) work?	Pull out the mains plug. Open cover inside the appliance above the door (with a Torx 20 screwdriver) and change the bulb. Close cap.
●	If you cannot correct a fault yourself or if a repair is required:	
	- Set programme selector to ○ (Off).	
	- Pull out the mains plug.	

# Safety instructions



## Emergency Use dryer ONLY ... NEVER ...

- Immediately pull out mains plug or interrupt fuse.
- in the house.
- for drying textiles.

## Hazards

- use dryer for other purposes than those described above.
- modify the technology or properties of the dryer.
- Children and uninstructed persons must not use the dryer.
- Do not leave children unattended near the dryer.
- Keep pets away from the dryer.
- Take all objects out of the pockets. Look out for cigarette lighters  
-> risk of explosion!
- Do not lean or sit on the door -> risk of dryer tipping over!
- Open the door carefully. Hot steam may escape.

## Installation

- Frost damage possible below 0 °C.
- Attach loose cables or hoses, otherwise risk of tripping.

## Mains connection

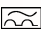
- Connect the dryer correctly to an a.c. earthed socket, otherwise safety cannot be ensured.
- Cable cross-section must be adequate.
- Use residual-current-operated circuit-breaker with this symbol only: 
- Mains plug and socket must match.
- Do not use multiple plug/couplings and/or extension leads.
- Do not take hold of the mains plug with damp hands.
- Never pull the mains plug out of the socket by tugging the cable.
- Do not damage the power cord.

## Operation

- Load the drum with *washing only*. Check the contents before switching on the dryer.
- Do not use the dryer if the washing has come into contact with solvent, oil, wax, grease or ink (e.g. setting lotion, nail varnish remover, stain remover, solvent naphtha, etc.) -> risk of fire/explosion!
- Dust hazard (e.g. coal dust, flour): do not use the dryer -> risk of explosion!
- Do not use the dryer if the washing contains foam/rubber -> elastic material may be destroyed and the dryer may be damaged by possible deformation of the foam.
- Switch off the dryer when the programme ends.
- Do not drink the condensation!

## Defect

- Do not use the dryer if it is defective or considered to be defective; repairs by customer service only.
- Do not use the dryer if the power cord is defective. To prevent hazards, have a defective power cord replaced by customer service only.
- Before changing the interior light bulb, always pull the mains plug out of the socket.

## Spare parts

## Disposal

- For reasons of safety use original spare parts and accessories only.
- Dryer: pull out the mains plug, **then** sever the power cord on the appliance. Dispose of at a public waste disposal centre.
- Packaging: do not allow children to play with packaging parts  
-> risk of suffocation!
- All materials are environmentally friendly and recyclable. Dispose of in an environmentally friendly manner.

# SIEMENS

## Operating and installation instructions

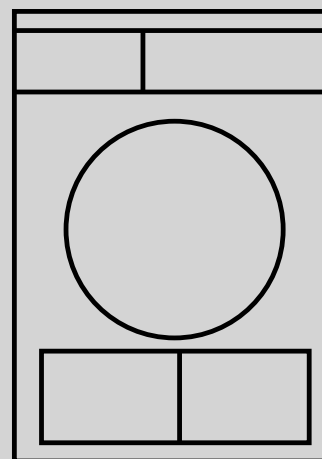

*Dryer*



Read these instructions before switching on the dryer!  
Follow instructions on page 11!

en