

Instruction Manual and Installation Instructions

en

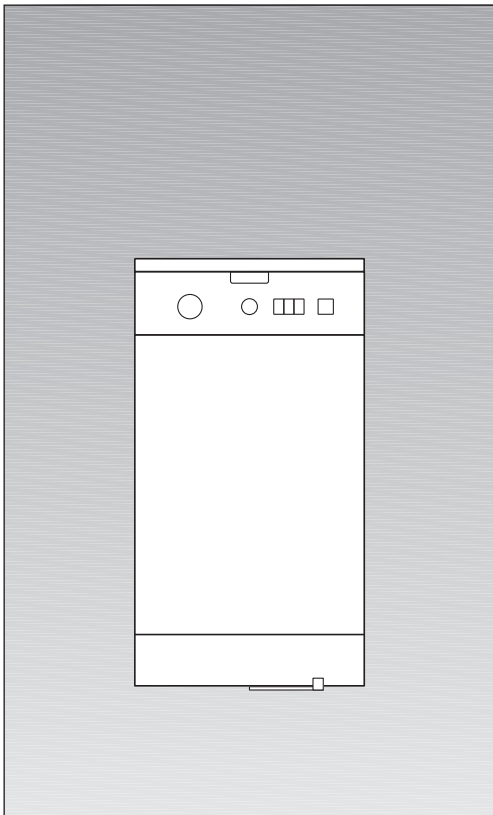

Washing machine

Table of Contents

Operating Instructions

Safety Instructions	3
Appliance lid and drum lid	5
Before Using Your Washing Machine For the First Time	7
Preparing, Sorting and Loading the Laundry	8
Laundry Detergents and Additives	11
Selecting Programmes	13
Washing	16
When the Programme has Ended	18
Special Applications	19
Cleaning and Care	20
Troubleshooting Minor Faults	24
Customer service	27
Consumption Rates	28

Installation Instructions

Installing, connecting and transporting the appliance	29
Transportation protection devices	33
Appliance, moving	37
Water connection	39

Appendix

Index	45
Programme Chart	47

Please read this instruction manual and all other information accompanying the washing machine before operating the appliance.

Please retain all documents for future reference or for a subsequent appliance owner.

Safety Instructions

General

Your washing machine is intended:

- For domestic use only.
- For washing machine-washable fabrics in washing lye.
- For operation using cold tap water and conventional laundry detergents and additives that are suitable for use in washing machines.

Safety Instructions

Never leave children unattended in the proximity of the washing machine.

Keep domestic pets away from the washing machine. Do not touch the loading door when washing at high temperatures.

Do not insert / remove the mains plug with wet or damp hands.

Handle the plug body only when removing the plug from the socket.

Take care when draining hot washing lye.

Do not climb onto the washing machine.

⚠ Danger of suffocation!

Keep children away from shipping carton and packaging components. Danger of suffocation from folding cartons and plastic film.

⚠ Danger of fatal injury!

On out-of service appliances, unplug mains plug. Cut off power cord and discard with mains plug. To prevent playing children from becoming trapped and endangered.

Control panel

Select a programme

Switches on / off the washing machine.

Can be turned in both directions.

The programme selector cannot be turned when the programme is in progress. The programme sequence is controlled electronically.

Control lights illuminate

“On” when programme is selected.

“Active” when “◊” is pressed.

“End” when programme is finished.

Flashing control lights = operating fault.

Release

Press to open the appliance cover.

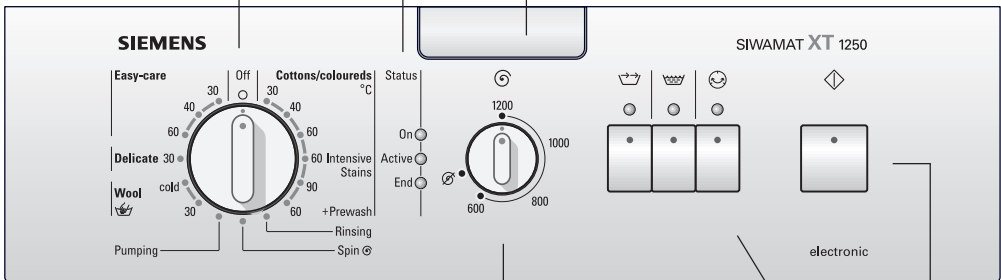

Set the spin speed (if desired)

Variable; must click into place at “Ø”.

Press buttons for additional functions

(where required to supplement the programme)

“☐” (cup icon): Shortened programme duration.

“☐” (bowl icon): Additional rinsing cycle.

“☺” (smiley face icon): Reduces creasing.

It is also possible to combine the additional functions at any time.

The control light above the option button lights up when the respective additional function is active.

To cancel the additional function: Press the button again.

Press the “◊” button

The washing process begins (programme must have been selected).

Appliance lid and drum lid

Opening the lid

- ☐ Press the "Lid" button.
The lid springs open.
- ☐ Open the lid.

Opening the drum lid

Caution

Do not rotate the drum with the perforated outer surface.

- ☐ Grip the recesses in the drum and rotate the drum in the direction of the arrow until the drum lid is situated at the top.
- ☐ Press on the rear half of the lid until the hook is released in the slot.

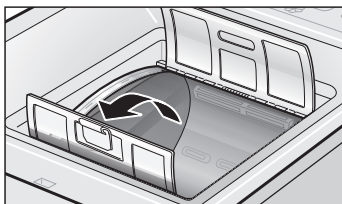
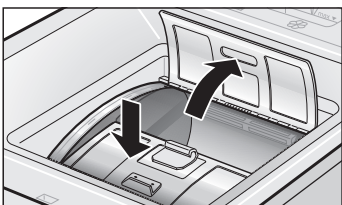
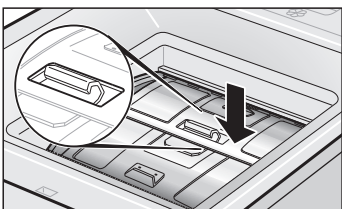
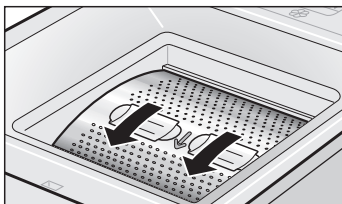

- ☐ In this position grip the front half of the lid and open the rear half of the lid.
- ☐ Open the front half of the lid.

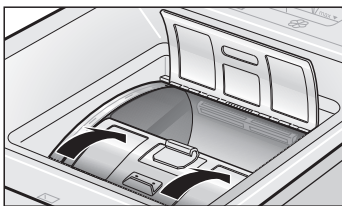

Closing the drum lid

- ❑ Close the front half of the lid.

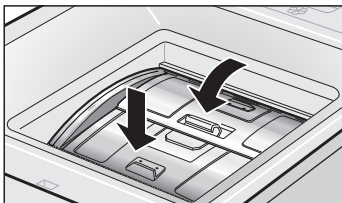

- ❑ In this position grip the front half of the lid, close the rear half of the lid, ensuring that the hook of the front half of the lid engages with the slot in the rear half of the lid.

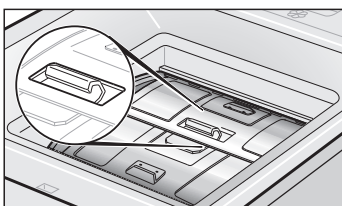

- ❑ Release the two halves of the lid.
- ❑ The two halves of the drum lid are correctly closed if they do not open when the front half of the lid is pressed down.

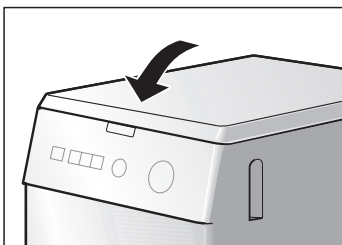

Closing the appliance lid

- ❑ Close the lid and press until it locks into position.

Caution!

Do not allow hot objects or substances containing solvents, e.g. nail polish remover, to come into contact with the top.

Before Using Your Washing Machine For the First Time

The washing machine must be properly installed and connected; see installation instructions.

Your appliance was tested before leaving the factory. To remove any water left over from testing procedures, the first washing cycle should be carried out without laundry in the machine.

- ☐ Do not load any laundry.
- ☐ Turn on the water tap.
- ☐ Pour approx. 1 litre / 1 $\frac{3}{4}$ pt of water into chamber II of the detergent dispenser.
- ☐ Half fill the measuring beaker with detergent and pour into chamber II. Do not use any special detergents for delicates or woollens (excessive foam).
- ☐ Set the programme selector to "90 °C Cottons + Linens".
The "Ready" control light comes on.
- ☐ Press the "⬠" button.
The "Active" control light comes on.

When the "End" control light comes on:

- ☐ Set the programme selector to "Off".

Preparing, Sorting and Loading the Laundry

Preparing the laundry

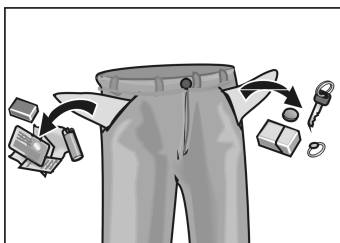

Caution

Loose debris (e.g. coins, paper clips, needles, nails) can damage items of clothing as well as parts of the washing machine (e.g. drum).

- ☐ Empty all pockets on items of clothing.
- ☐ Brush out any sand from pockets and cuffs.
- ☐ Close zip-fasteners and button up bed covers.
- ☐ Remove curtain runners or tie them up in a net / bag.
- ☐ The following items must be washed inside a net / pillow case:
 - Extremely delicate items, e.g. fine tights, net curtains.
 - Small items, e.g. small socks or handkerchiefs.
 - Underwired bras (the wire may come loose during washing and cause damage).
- ☐ When washing trousers, knitwear and woven fabrics, e.g. shirts, T-shirts or sweatshirts, always turn these items inside out.

Sorting the laundry

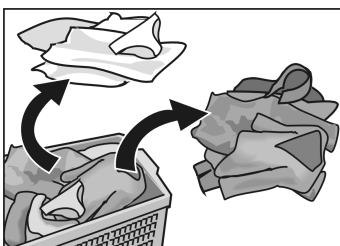

Caution

Items of clothing can become discoloured. Never wash new multi-coloured items together with other items.

White items may become grey. Always wash white and coloured items separately.

- ☒ **i** Observe the treatment symbols on the textile labels ((refer also to separate “Programme Chart see Page 47”).

 = do not wash

Degrees of dirt

Slight dirt

No recognizable dirt or staining. Laundry may have some body odour.

Normal dirt

Visible dirt and/or some light staining recognizable.

Intensive dirt

Dirt and/or staining recognizable e.g. working clothes such as overalls or baker's and butcher's coats.

Typical stains

- Skin fat, cooking oils / fat, sauces, mineral oil, wax (containing fat / oil).
- Tea, coffee, red wine, fruit, vegetables (bleachable).
- Blood, egg, milk, starch (containing protein / carbohydrate).
- Soot, soil, sand (pigments), red sand on tennis clothes.

Removing stains

Wherever possible, remove / pretreat stains whilst they are still fresh.

First, dab soapy water onto the stain. Do not rub.

Subsequently wash the items of clothing using the appropriate programme.

Several washing cycles may sometimes be required in order to remove stubborn / dried in stains.

Loading the laundry

⚠ Risk of explosion!

Items of clothing that have been pretreated with solvent-based cleaning agents, e.g. stain remover and dry cleaning spirit, represent an explosion hazard once loaded into the washing machine. Before loading the laundry, rinse thoroughly by hand.

Warning

Loose debris in the washing machine drum can damage the laundry. Before loading the laundry, check that there is no debris in the drum.

- ☐ Open the cover and drum lid.
- ☐ Unfold the sorted items of clothing and place them loosely into the drum. Mix large and small items. Laundry items which vary in size are more evenly distributed during the spin cycle.
- ☐ Do not exceed recommended loads:
Overloading will cause poor wash results and encourage creasing.

The washing machine automatically reduces the water and energy requirement for smaller amounts of laundry.

- ☐ Close the drum lid.
Do not jam items of laundry between the drum and drum lid.

Laundry Detergents and Additives

Dispensing the correct amount of detergent

⚠ Risk of poisoning!

Keep detergents and additives out of the reach of children.

Dispense the detergent according to:

- ☐ the water hardness. This information can be obtained from your local water authority.
- ☐ the amount of laundry.
- ☐ the amount of soil.
- ☐ the specifications of the detergent manufacturer. Dispensing the correct amount of detergent relieves the strain on the environment and ensures optimum washing results.

Pour liquid detergent into the appropriate dispensing chamber.

Too little detergent:

The laundry is not cleaned properly and will, after a while, become grey and stiff.

Greyish brown spots (fat globules) may appear on the laundry. The heaters may calcify.

Too much detergent:

Environmentally incompatible, excessive foam reduces wash agitation causing poor washing and rinsing results.

Adding detergent/cleaning product

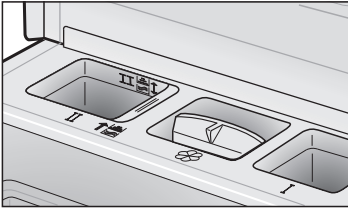

Chamber I:

Detergent for prewash or starch.

Chamber II:

Detergent for main wash, softener, bleach, stain remover or soaking agent.

☼ Chamber:

Additives, e.g. fabric softener or former (fill at least to lower edge of insert **1**).

If you select a programme without prewash, you can dispense the detergent directly onto the drum.

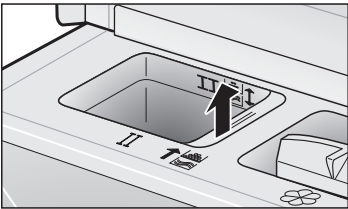

The insert in dispenser II can be moved for the different types of detergents. If you are using washing powder:

☐ Pull the insert up to the

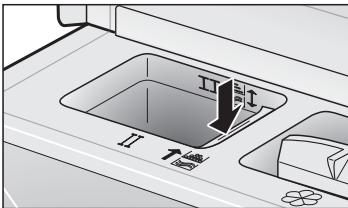

If you are using liquid detergent (only in programmes without prewash):

☐ Press the insert down to the



Selecting Programmes

Basic programmes

Select the desired programme (refer also to “Programme Chart, see Page 47”).

90 °C Cottons + Linens

An energy-intensive programme for heat-resistant fabrics made from cotton or linen.

For the protection of the drainage pipe, the hot washing solution is mixed with approx. 7 litres / 1 ½ gal. of cold water before being drained.

60 °C Intensive Stains

An energy-saving programme for stained or very dirty fabrics.

The extended washing time means that a cleaning result comparable to that of the 90 °C programme is achieved using considerably less energy.

60 °C Cottons + Linens with Prewash

For very dirty, hard-wearing fabrics.

30, 40, 60 °C Cottons + Linens

For hard-wearing fabrics

30, 40, 60 °C Easy-care

For easy-care fabrics made from cotton, synthetics or blended fibres.

30 °C Delicates

For sensitive, easy-care fabrics made from cotton, silk, synthetics or blended fibres, and net curtains. No spinning between rinsing cycles.

30 °C, Woollens cold

For hand or machine-washable fabrics made from wool or wool blend.



Extra cycle programme selector

Rinse
Separate rinsing cycle with subsequent spin cycle for easy-care fabrics.

Spin
Separate spin cycle. Washing solution or rinsing water is drained prior to the spin cycle.

Drain
Draining of the rinsing water after a wash programme with the “ Rinse hold” setting for the gentle treatment of delicate laundry.

Spin speed selector

Basic setting
The spin speed selector is pointing up.
Laundry is spun at maximum spin speed in the “Cottons+Linens  programme.
In the “Easy-care 

Maximum spin speeds

Revolutions per minute XT 750	Revolutions per minute XT 1050	Revolutions per minute XT 1250	Type of laundry / Extra cycle
750	1000	1200	Cottons/coloureds
750	800	800	Easy-care
600	600	600	Delicate
750	800	800	Wool
750	800	800	Rinsing
750	800	800	Spin 

Unbalanced load detection system

The automatic unbalanced load detection system spins the washing several times to ensure even distribution. In the woollens programme the washing is spun only twice to prevent matting. If the washing is very unevenly distributed, the machine will not spin.

Additional option

No Final Spin

For delicate textiles and net curtains.

All programmes can be run without final spin.

The laundry is left in the final rinsing water.

The **Spin** indicator light is lit.

Before the washing can be removed, the **Empty** or **Spin** programme must be run by setting the speed selector to the required speed.



Reduced washing duration – only 2 rinsing cycles.
Suitable for slightly dirty laundry.

Recommended load amount: Up to a maximum of 3 kg.



Rinse Plus

An additional rinsing cycle is performed; The washing duration will be prolonged accordingly.

Recommended application:

In areas with very soft water.



Special spin cycle with post-spin loosening cycle.
The laundry is left lying loosely in the drum, thus reducing creasing.

Observe the maximum load for each type of fabric;
Remove the laundry immediately after the spin cycle.

Washing



- ❑ Turn on the water tap.

Start the programme

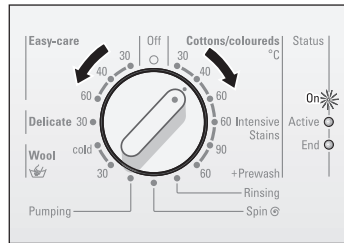

- ❑ Turn the programme selector to the desired programme (refer also to separate “Programme Chart”).
The “On” control light comes on.

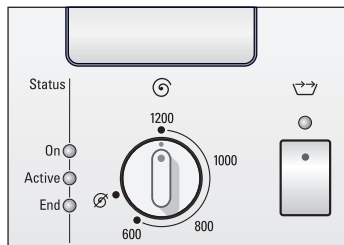

- ❑ Select the desired spin speed or “0”.

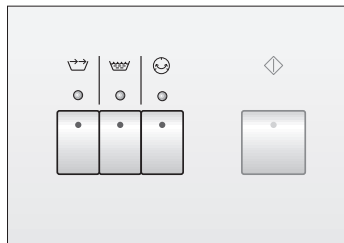

- ❑ Where required, press the option button(s) for additional function(s).

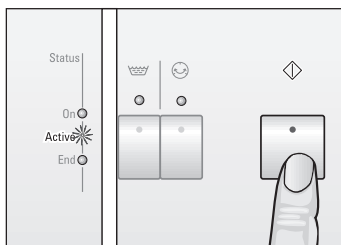

- ☐ Press the “◈” button.
The “Active” control light comes on, and the programme starts.

The “Active” control light remains lit for the entire duration of the programme.

Changing a programme

If you have accidentally selected the wrong programme:

- ☐ Turn the programme selector to “Off”.
- ☐ Turn the programme selector to the desired programme.
The “On” control light comes on.
- ☐ Press the “◈” button.
The “Active” control light comes on, and the new programme starts.

Cancelling active programme

If you wish to prematurely end a programme:

- ☐ Turn the programme selector to “Off”.
- ☐ Turn the programme selector to “Pumping” or “Spin Ⓞ”.
The “On” control light comes on.

For “Spin Ⓞ”, select the desired spin speed (but not “⊘”).

- ☐ Press the “◈” button.
The “Active” control light comes on.

When the Programme has Ended

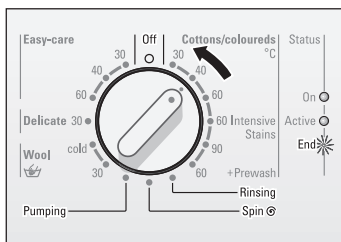

The “End” control light comes on.

- ☐ Turn the programme selector to “Off”,
and, where required:
- ☐ Select a programme option (“Pumping”, “Spin” or “Rinsing”).
- ☐ Press the “End” button.
- ☐ At the end of the programme option, turn the programme selector to “Off”.

Unloading the laundry



- ☐ Turn off the water tap.
(If appliance features Aqua-Stop, turn off tap only if house is empty for a prolonged period)
- ☐ Open the appliance lid and drum lid.

If the loading door cannot be opened:
Wait for 2 minutes (the safety function is active)
or

there is still water in the washing machine if the “Ø” option was selected.
In this latter case, select the “Pumping” or “Spin” programme.

- ☐ Unload the laundry.

At the end of the washing programme there is a small quantity of water in the chamber ☼.

Caution

Remove any debris (e.g. coins, paper clips) from the drum and rubber seal – **risk of rust formation!**

- ☐ Leave the lid open so that the inside of the washing machine can dry out.

Special Applications

Pre-soak

Attention

Do not bleach/dye washing in the washing machine.

- ☐ Load laundry of the same colour.
- ☐ Add the presoak agent to chamber II according to the manufacturer's specifications.
- ☐ Turn the programme selector to "30 °C Cottons + Linens".
The "Ready" control light comes on.
- ☐ Press the "⬠" button.
The "Active" control light comes on, and the programme starts.
- ☐ After approx. 15 minutes, turn the programme selector to "Off". The laundry is left to lie in the water.
- ☐ Select a programme after the desired soaking period.

Do not add any additional detergent. The presoak solution continues to be used in the wash programme.

Starching

The laundry must not be treated with fabric softener.

- ☐ Load the laundry.
- ☐ Dispense the correct amount of starch for approx. 15 litres / 3.3 gal. of water. Powdered starch must first be dissolved in water according to the manufacturer's specifications.
- ☐ Pour the starch solution into the open drum.
- ☐ Carefully close the drum lid and appliance lid.
- ☐ Turn the programme selector to "Rinse".
- ☐ Set the spin speed ("Ø" is also possible).
- ☐ Press the "⬠" button.

If the "Ø" option is selected, the "Drain" programme must subsequently be selected.

Cleaning and Care

⚠ Risk of electric shock!

Always disconnect the appliance from the mains before cleaning.

Never clean the washing machine with a jet of water.

⚠ Risk of explosion!

Never use solvents to clean the appliance.

Cleaning the appliance housing and control panel

As required:

- ☐ Use hot soapy water or a mild, non-abrasive cleaning agent.
- ☐ Rub dry with a soft towel.

Cleaning the drum

In the event that rust spots have formed due to left-over debris (e.g. coins, paper clips, needles, nails):

- ☐ Use a chlorine-free cleaning agent. Follow the manufacturer's instructions. Never use steel wool.

Descaling the washing machine

Caution

Descaling agents contain acids which can attack parts of the washing machine and discolour the laundry.

Provided that you use the correct amount of detergent, it is not necessary to descale the washing machine.

If, however, descaling the appliance becomes necessary, please follow the instructions provided by the descaling agent manufacturer.

Cleaning the fabric softener insert

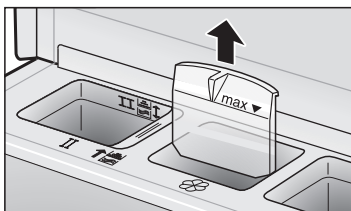

- ☐ Pull out the insert.



- ☐ Clean the insert under running water.

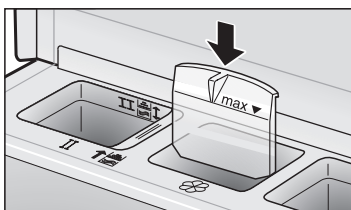

- ☐ Push in the insert.

Cleaning the drain pump

Draining the washing solution

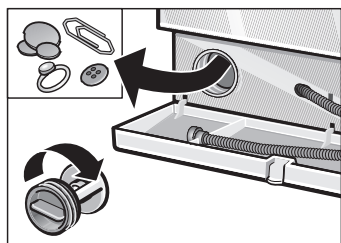
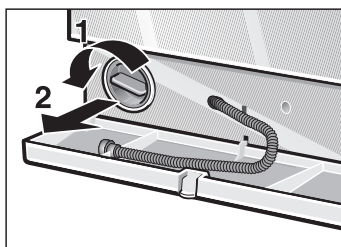
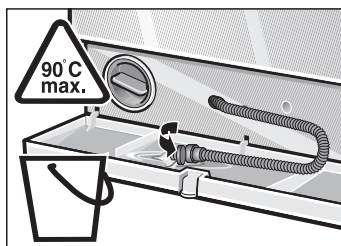
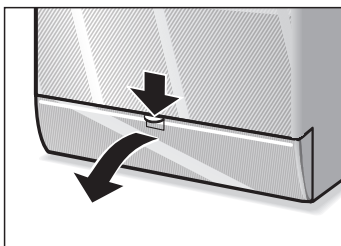

This is necessary if the washing solution cannot be completely drained. The pump is blocked by either loose debris or fluff which accumulates if fluff-giving fabrics are washed at high temperatures.

(Up to 20 litres / 4.4 gal. Have a suitable container ready.)

⚠ Risk of scalding!

Allow the hot washing solution to cool.

- ☐ Turn the programme selector to "Off".
- ☐ Open the flap.

- ☐ Take the drainage hose out of the holder.
- ☐ Remove the sealing cap and drain the water into a receptacle.
- ☐ Press on the sealing cap and insert the drainage hose into the holder.
- ☐ Carefully unscrew the pump cover.
- ☐ Remove any foreign objects/fluff from the inner compartment and clean. The pump impeller wheel must be able to rotate.
Remove any residue and fluff from the pump cover thread and pump housing.
- ☐ Insert the pump cover and screw on tight.
- ☐ Insert and close the flap.

To prevent unused detergent from being pumped out during the next wash cycle:

- ☐ Pour 1 litre of water into dispenser II
- ☐ Select the "Drain" programme.

Cleaning water inlet strainers

This is necessary if very little or no water flows into the washing machine.

First release the water pressure in the supply hose:

- ☐ Turn off the water tap.
- ☐ Turn the programme selector to any programme (except "Spin" and "Drain").
- ☐ Press the "⬢" button, and allow the programme to run for approx. 40 seconds.

Cleaning the strainer at the water tap

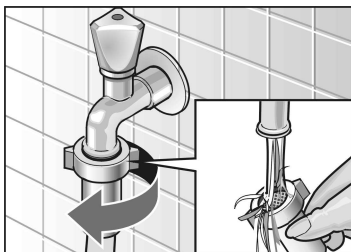

- ☐ Disconnect the hose from the water tap.
- ☐ Rinse the strainer under flowing water.
- ☐ Reconnect the hose.

Cleaning the strainer on the washing machine

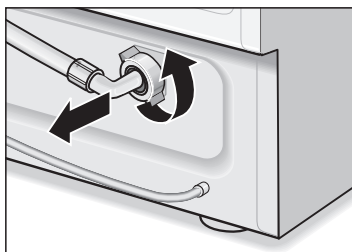

- ☐ Disconnect the hose from the back of the washing machine.

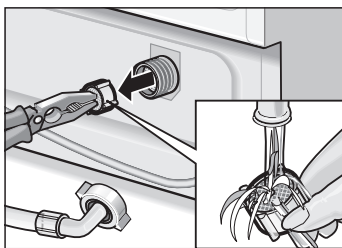

- ☐ Pull out the strainer and rinse under running water.
- ☐ Insert the strainer and reconnect the hose.
- ☐ Turn on the water tap and check whether water is still discharged. If water is still discharged, check that the strainer is attached properly.
- ☐ Turn off the water tap.

Troubleshooting Minor Faults

⚠ Risk of electric shock!

Repairs must only be carried out by our Customer Service or an authorized technician.

If repairs are needed, and assuming that you cannot eliminate the fault yourself with the aid the following table:

- ❑ Turn the programme selector to “Off”.
- ❑ Disconnect the washing machine from the mains.
- ❑ Turn off the water tap.
- ❑ Call Customer Service (refer to Page 27).

Fault	Cause	Action
Lid cannot be opened.	"Ø" selected.	Select "Pumping" or "Spin ⌚" or set programme selector to "Off".
	Safety function active.	Wait 2 minutes.
Detergent is not dispensed from dispenser I.	Programme without prewash selected.	Select "Cottons/colourdes 60 °C + Prewash".
Detergent residue in the detergent dispensers.	Damp or lumpy detergent.	Dry detergent dispensers before filling with detergent.
		Use the dispensing aid for liquid detergent.
		Insert for liquid detergent pressed down. Reposition the insert for washing powder.
Programme does not start. "On" indicator light flashes.	Appliance lid not closed.	Close the lid ("clicks" shut).

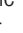
Fault	Cause	Action
Indicator lights do not illuminate.	Fuse tripped.	Switch on/replace fuse. If the fault occurs repeatedly, call customer service.
	Power failure.	Selected programme continues when power restored. If the washing is to be removed, proceed as described under "Cleaning the pump"; see Page 22.
	Plug loose or not plugged in.	
Programme does not start. "On", "Active" and "End" indicator lights flash.	Drum lid not closed.	Close the drum lid.
Programme does not start.	"◊" button not pressed.	Press the "◊" button.
Water does not flow in or detergent is not dispensed. "Active" indicator lights flashes.	Tap not turned on.	Turn on the tap.
	Inlet hose bent or pinched.	
	Filters in water inlet blocked.	Clean the filters; see Page 23.
Water is not completely drained. "End" indicator light flashes.	Foreign objects blocking the pump.	Clean the pump; see Page 22.
	High-fluff garments were washed. Drainage hose bent. Drainage pipe or drainage hose blocked.	Clean the drainage pipe and/or drainage hose, see Page 22.
Water runs out from under the appliance.	Screw-fitting of inlet hose leaking.	Tighten the screw-fitting.
	Drainage hose leaking.	Replace the drainage hose.
Water and fabric softener in  dispenser.	Not a fault.	Effect of the fabric softener is not impaired.
Foam comes out.	Too much detergent.	Switch off the appliance. Mix 1 tablespoon of fabric softener with ½ litre of water and add to dispenser II. Switch on the appliance again.
		Reduce detergent dosing for the next wash cycle.

Fault	Cause	Action
Pump noise	Not a fault. Noises generated when the pump starts up or draws air are normal.	
"Lid" button cannot be pressed.	Programme not ended or "Ø" selected.	When the water has been drained and the programme has ended, the appliance lid can be opened after approx. 2 minutes.
Vibrations during wash and spin cycles	Transit bolts not removed	Remove the transit bolts; see installation instructions.
	Appliance feet not secured.	Secure the appliance feet.
	Appliance standing on rollers.	Swivel the lever from left to right.
Repeated spinning	Not a fault. Unbalanced load detection system attempts to remove an imbalance by repeatedly spinning the washing.	
Programme runs for longer than usual.	Not a fault. Unbalanced load detection system attempts to remove an imbalance by repeatedly distributing the washing.	Wash large and small items of washing together to reduce the imbalance.
	Foam detection function has implemented an additional rinse cycle to dissolve the foam.	Adjust detergent dosing for the next wash cycle.
Washing result not satisfactory.	Soiling is greater than assumed.	Select suitable programme.
	Insufficient detergent dispensed.	Dispense detergent according to the manufacturer's specifications.
Detergent residue on washing.	Some phosphate-free detergents contain water-insoluble residue which may appear as light stains on the washing.	Select "Rinsing" immediately or Brush the washing after the drying cycle.
Grey residue on washing.	Soiling caused by ointments, greases or oils.	Select maximum detergent dosing and maximum permitted temperature for the next wash cycle.

Customer service

Each washing machine which leaves our factory is checked carefully to ensure that it functions properly and is in perfect condition. If you have any questions – especially with respect to installing and connecting your washing machine – please do not hesitate to contact our customer service department.

Before you call customer service, please check whether you can eliminate the fault yourself (see from page 24).

A technician who is called out to give advice will charge you, even if the appliance is still under guarantee.

You can find your nearest customer service in the enclosed address list. Please provide customer service with the product number (E-Nr.) and the production number (FD) of the appliance.

This information can be found on the rating plate in the thick-bordered box on the appliance plate behind the base panel.

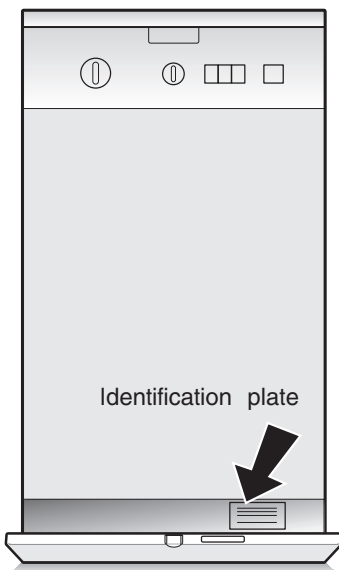

E-Nr. _____	FD _____
-------------	----------

Product number

Production number

Please note the two numbers in the space provided above.

To prevent unnecessary call-outs, please assist customer service by quoting the product and production numbers.

Further information and a selection of our products can be found on our Internet page:
<http://www.siemens-international.com>

Consumption Rates

Normal programme (without additional functions)	Load	Electricity *	Water *	Duration *
40 °C Cottons + Linens	4.5 kg	0.5 kWh	49 l	115 min.
60 °C Cottons + Linens	4.5 kg	0.85 kWh	49 l	115 min.
60 °C Cottons + Linens Intensive/Stains	4.5 kg	0.85 kWh	49 l	135 min.
90 °C Cottons + Linens (the hot washing solution is mixed with approx. 7 litres of cold water before being drained)	4.5 kg	1.7 kWh	56 l	120 min.
40 °C Easy-care	2.0 kg	0.4 kWh	48 l	75 min.
30 °C Delicates	2.0 kg	0.3 kWh	55 l	45 min.
30 °C Woollens	2.0 kg	0.2 kWh	35 l	55 min.

* The rates may deviate from the stated values depending on water pressure and hardness, room temperature, type and amount of laundry, detergents used, fluctuations in the mains voltage and selected additional functions.

Installing, connecting and transporting the appliance

Safety instructions

Risk of injury!

The washing machine is very heavy. Take care when lifting it.

Caution

Frozen hoses may tear/burst. Do not install the washing machine in an area where there is a risk of frost or outdoors.

The washing machine may be damaged. Do not lift the washing machine by its projecting parts.

In addition to the safety information listed here, the local water and electricity supplier may have special requirements.

If in doubt, have the appliance connected by a specialist.

Installation surface

Stability is important to prevent the washing machine from “wandering” during the spin cycle.

The installation surface must be solid and level. Soft floor coverings, e.g. carpets or floor coverings with a foam backing are not suitable.

If the washing machine is to be installed on a **wooden floor**:

- ☐ If possible, install the washing machine in a corner.
- ☐ Screw a water-resistant wooden board (at least 30 mm thick) to the floor.
- ☐ Secure the washing machine feet with fixing brackets*.

If the washing machine is to be installed on a **base**:

- ☐ Secure the washing machine feet with fixing brackets*.

* Holding brackets (set) can be obtained from a specialist store or the Customer Service (order no. WX 9756).

Packaging and old appliances



Unpack the appliance and dispose of the packaging in an environmentally-responsible manner.

This appliance is labelled in accordance with European Directive 2002/96/EC concerning used electrical and electronic appliances (waste electrical and electronic equipment - WEEE).

The guideline determines the framework for the return and recycling of used appliances as applicable throughout the EU.

Aligning the appliance

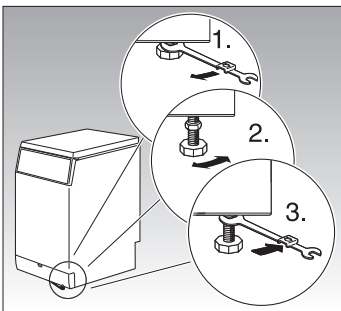
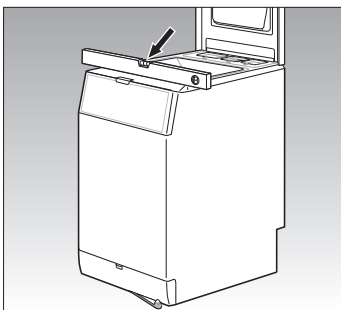
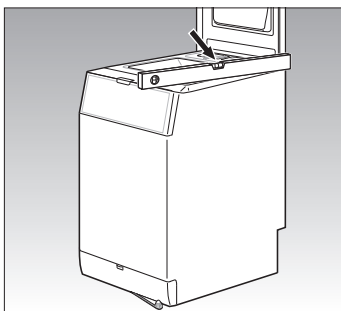

All four appliance feet must be firmly on the ground.
The washing machine must not wobble.

- ☐ Level the washing machine with the assistance of the four adjustable feet and a spirit level.

Correcting the height of the appliance feet:

- ☐ Loosen the lock nuts with the socket wrench.
- ☐ Modify the height by rotating the appliance feet.
- ☐ Tighten the lock nuts against the housing.

Standard accessories

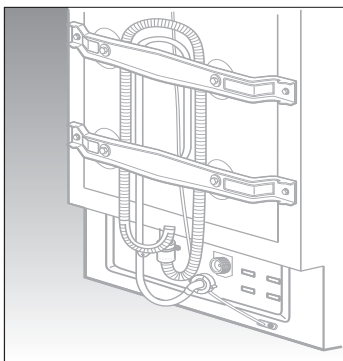

- Water-inlet hose.
- Water drainage hose.
- Elbow for attaching the drain hose, e.g. into a wash basin
- Power cord.
- Spanner.
- Covers for holes left by removing the transport bolts.

Depending on the connection situation, the following part is also required:

- 1 hose clip Ø 24–40 mm (DIY store) is also required for connection to a siphon.

Useful tools

The following tools are helpful:

- Ring wrench (SW 13)
- Spirit level

Transportation protection devices

Removing the transportation protection devices

Caution

It is very important that you remove the transit bolts at the back of the machine before using it for the first time. Keep the transit bolts in case you need to transport the machine at a later date (e.g. moving house). Do not transport the machine unless the transit bolts have been fitted in place.

- ❑ Unscrew the 4 outer bolts in the braces with a 10 mm spanner.

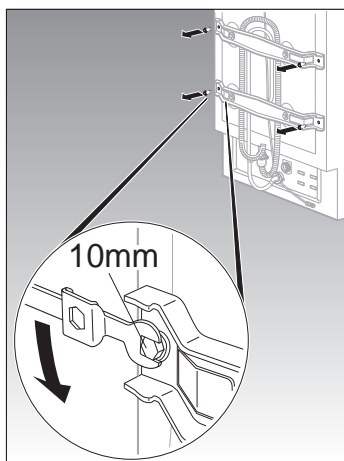

- ❑ Unscrew the 4 inner bolts in the braces with a 13 mm spanner, until the bolts are freely movable.
- ❑ Removing the transportation protection devices.

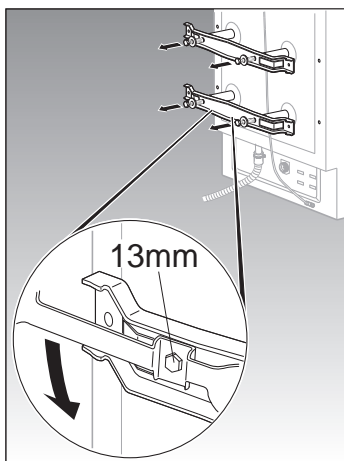

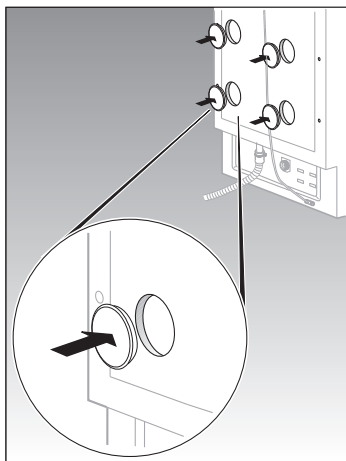

- ❑ Close off the 4 large holes in the rear panel by inserting the caps supplied with the machine.

Dimensions

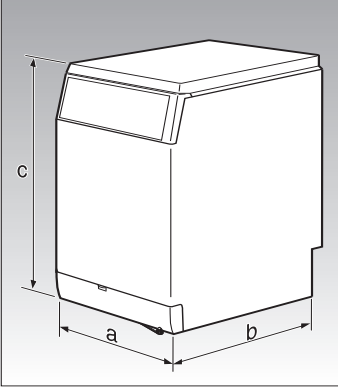

a = 450 mm

b = 580 mm

c = 850 mm

Weight approx. 64 kg

Hose and-cable lengths

Connection on left side

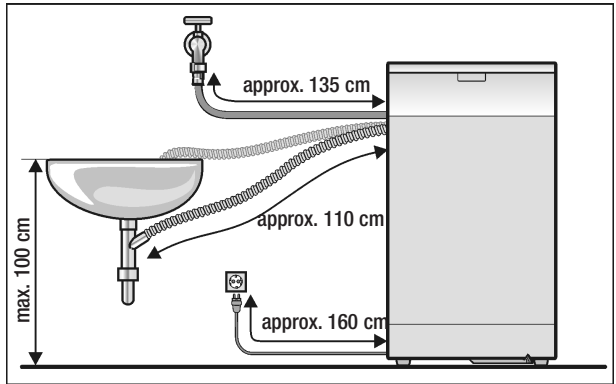

Connection on right side

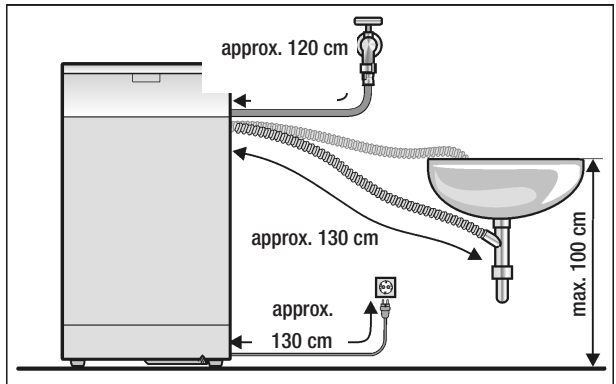

Other hoses

Available from specialist dealers:

- Extended supply hose (approx. 2.20 m).

Appliance, moving

The appliance can be moved on rollers to another installation location.

Caution

The appliance is designed to be moved within the installation room only and not over greater distances.

Basic setting

The lever is situated on the front of the appliance at the bottom right-hand side.

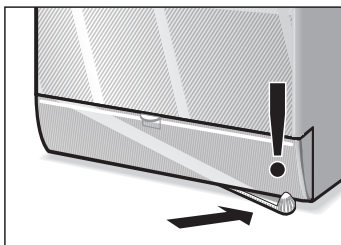

Caution

Before using the appliance, ensure that it is standing firmly on its feet (lever on right).

When moving the appliance, don't forget the water connections (supply and drainage) and the electrical connection (mains cable)!

The mains cable can be wound up and the mains plug placed in the park position on the rear of the appliance.

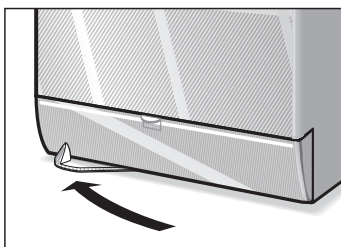

Swivel the lever on the front of the appliance at the bottom from right to left. The appliance is standing on its rollers.

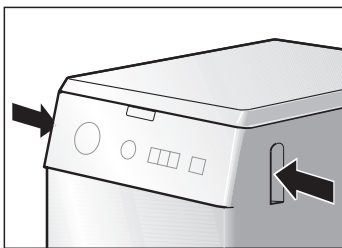

- ❑ Take hold of the recessed grips on the left and right sides of the appliance and move the appliance to the required location.

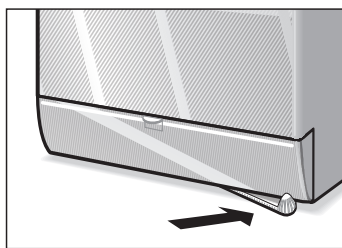

- ❑ Move the lever back (swivel lever to right). The appliance is standing firmly on its feet again.
- ❑ Check that the appliance is vertical and has all 4 feet firmly on the floor. Otherwise, the appliance may generate a great deal of noise and move during the spin cycle

Water connection

Connecting the water

Water inlet hose

Caution

Operate the washing machine with cold drinking water only. Do not connect to the mixer tap of an unpressurised hot-water apparatus.

If in doubt, have the appliance connected by a specialist.

The water inlet hose must not be

- kinked or crushed,
- modified or severed (strength is no longer guaranteed).

Plastic threads must only be tightened by hand. Do not remove the strainers from the water supply hose.

Check the mains water pressure:

- The water pressure should be between 1 and 10 bars (when the tap is turned on, at least 8 litres of water is discharged per minute).
- If the water pressure is higher, install a pressure reducing valve.

Connect the water supply hose.

- ❑ to the rear panel of the washing machine and ...

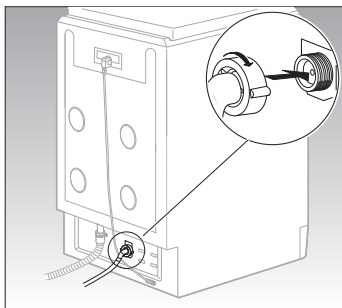

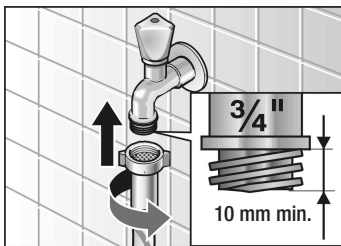

- ☐ to the tap.
- ☐ After connecting the water inlet hose:
Turn on the water tap completely, and check connection points for water-tightness.

Water drainage hose

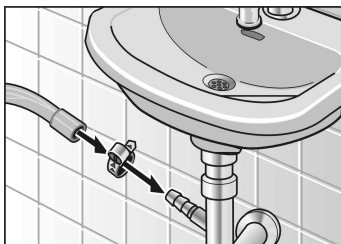

Warning

Do not bend or pull the water drainage hose.

Height difference between the placement area and drainage point: maximum 100 cm.

Drainage into a siphon:

- ☐ Secure connection point with 24–40 mm Ø hose clip (specialist outlet).

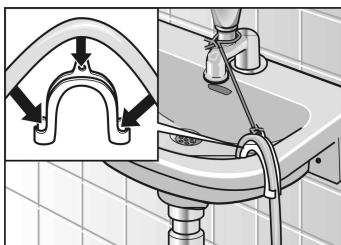

Drainage into a wash basin:

Warning

The plug must not block the drain of the wash basin.

- ☐ Secure the drainage hose to prevent it from slipping out of the sink.
- ☐ When the water is being pumped out of the washing machine, check that the water drains away quickly enough.

Connecting the power

Caution

Connect the washing machine only to an alternating current via a correctly installed earthed socket.

The mains voltage must correspond to the voltage specification on the washing machine (nameplate). Connection specifications as well as the required fuses are stipulated on the appliance nameplate.

Ensure that:

- The mains plug and socket are compatible.
- The cable cross-section is adequate.
- The earthing system has been installed correctly.

The mains cable may be changed (if required) by an electrician only.

Replacement mains cable available from customer service.

Do not use multiple plugs/sockets or extension cables.

In the event that an earth-leakage circuit breaker is to be used, only use types marked with the following symbol: .

Only this symbol can guarantee compliance with all current regulations.

Do not insert/pull out the mains plug with wet hands.

Do not pull out the mains plug by tugging the cable.

Installing transportation protection devices

Before transporting the washing machine(e.g. when moving):

- Turn off the tap.
- Drain any residual washing solution (refer to page 22).
- Release the water pressure in the supply hose (refer to Page23).
- Disconnect the washing machine from the mains, power plug in stand-by position.
- Dismantle the supply and drainage hose
- Fix on the rear off washing machine
- Installing transportation protection devices.

To insert transportation protection devices:

- ☐ Remove the lower covers.
- ☐ Unscrew hose clamp.
- ☐ Prepare the transport bolts:
Loosen the screw in the sleeve until the end of the sleeve is level with the end of the sleeve.
- ☐ Attach and close the cover plate.

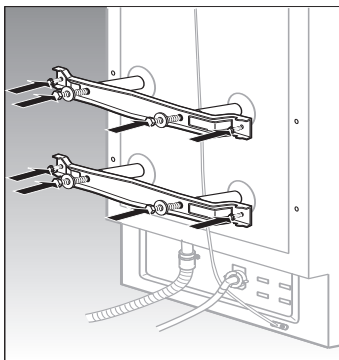

Index

A

- Aligning the appliance, 32
- Appliance, moving, 37

C

- Connecting the power, 41
- Connecting the water
 - Water drainage hose, 40
 - Water inlet hose, 39
- Cover, 4
- Customer service, 28

D

- Dimensions, 35

H

- Holding bracket, 31
- Hose and–cable lengths, 36

I

- Installation surface, 31
- Installing transportation protection devices, 42
- Internet, 28

P

- Packaging and old appliances 32
- Park position, 37
- Product number, 28
- Production number, 28

S

- Safety instructions, 30
- Spin speed selector, 14
- Stability, 31, 37

































T

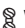

- Transportation protection devices, 34

W

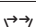
- Water connection, 39
- without final spin, 15

WXT1250EU
WXT1050EU
1205 en
9000 051 277

Programmes ¹⁾²⁾ Type of laundry	Amount of laundry	Degree of soiling/Advice	Required button, additional function
 Cottons + Linens      Hard-wearing textiles, heat-resistant textiles e.g. cotton or linen			
30, 40 ³⁾, 60 °C	4.5 kg	light to normal	none
		negligible to light	
		Additional rinsing cycle	
		Reduced ironing	
30, 40, 60³⁾ °C 		stained	none
30, 40, 60 °C + 		normal to heavy	none
90 °C		normal to heavy	none
 Synthetics    Easy-care textiles e.g. cotton, linen, synthetic materials or blended fabrics (Also suitable as a short programme)			
30, 40 ³⁾, 60 °C	up to 2 kg	light to normal	none
		negligible to light	
		Additional rinsing cycle	
		Reduced ironing	
Delicates     Delicate, washable textiles, e.g. silk, satin, synthetic or blended fabrics without wool component (e.g. curtains)			
30°C	up to 2 kg	light to normal	none
		negligible to light	
		Additional rinsing cycle	
		Reduced ironing	
 Wool      hand and machine washable wool or wool rich textiles, e.g. cashmere, mohair or angora. Also suited for hand washable silk.			
15, 30³⁾ °C	up to 2 kg	light to normal	none
		negligible to light	
		Additional rinsing cycle	
		Reduced ironing	
Programme options	Rinse, Spin, Drain		

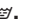
- 1) You can change the programme with the following settings: additional functions/Buttons: , , .
- 2) Pour detergent into dispenser **II** (on left) for programme without prewash;
distribute detergent between dispensers **I** and **II** for programmes with prewash.
- 3) Programme setting for test in accordance or in conformity with EN 60456 and IEC 60456.

