

Washing Machine

Table of Contents

Operating Instructions

Safety Instructions	4
Control panel	5
Before using your washing machine for the first time	6
Preparing, sorting and loading the washing	7
Preparing the washing	7
Sorting the washing	7
Degrees of dirt	8
Loading the washing	9
Detergents and cleaning products	10
Dosing detergent	10
Adding detergent/cleaning product	10
Programmes and functions	11
Programme selector	11
Spin speed selector	13
Additional option – buttons	14
Wash	15
Changing the programme	16
Cancelling the programme	16
After washing	17
Remove the washing	17
Special applications	18
Soaking	18
Starching	18
Cleaning and Care	19
Clean housing, fascia and supply lines	19
Cleaning the drum	19
Descaling the washing machine	19
Cleaning the detergent dispenser	20
Cleaning the drain pump	21
Cleaning water inlet strainers	22
Help with minor problems	23
Fault displays	23

Installation Instructions

Consumption values	27
Customer service	28
Installing, connecting and transporting the appliance	29
Safety instructions	29
Standard accessories	30
Dimensions	30
Installation surface	31
Removing the transportation protection devices	32
Hose and cable lengths	34
Connecting the water	35
Aligning the washing machine	36
Connecting the power	37
Transport, e.g. when moving	38

Appendix

Aqua Stop warranty	39
Index	40
Programme overview	43
Quick-reference instructions	44

These operating and installation instructions describe various models. Differences are indicated in the appropriate places.

Please read this instruction manual and all other information accompanying the washing machine before operating the appliance.

Please retain all documents for future reference or for a subsequent appliance owner.

Safety Instructions

General

Your washing machine is intended:

- For domestic use only.
- For washing machine-washable fabrics in washing lye.
- For operation using cold tap water and conventional laundry detergents and additives that are suitable for use in washing machines.

Safety Instructions

Never leave children unattended in the proximity of the washing machine.

Keep domestic pets away from the washing machine.

Do not insert / remove the mains plug with wet or damp hands.

Handle the plug body only when removing the plug from the socket.

Take care when draining hot washing lye.

Do not touch the loading door when washing at high temperatures.

Do not climb onto the washing machine.

Do not lean on the open washing machine door.

⚠ Danger of suffocation!

Keep children away from shipping carton and packaging components. Danger of suffocation from folding cartons and plastic film.

⚠ Danger of fatal injury!

On out-of service appliances, unplug mains plug.

Cut off power cord and discard with mains plug.

To prevent playing children from becoming trapped and endangered, ensure that the door locking mechanism is disabled.

Control panel

Programme selector

For switching the machine on and off and for selecting the programme.

Can be rotated in either direction.

The programme selector does not rotate while the programme is running – the programme sequence is electronically controlled.

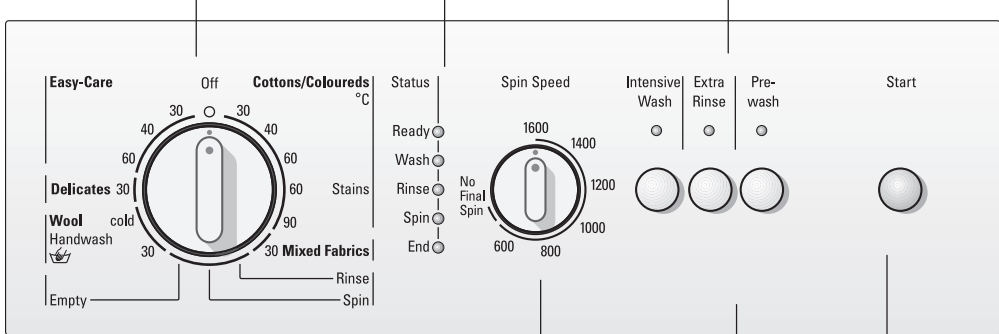

Indicator lights for the programme status

Ready illuminate, if the programme is selected.

Wash, Rinse, Spin illuminate when the **Start** button is pressed and the particular programme section is running.

End is lit when the programme has ended.

Indicator lights flash: Operation error.

Spin speed selector (if required)

For stepless setting of the spin speed; must click in place at **No Final Spin**.

Buttons for additional options

(in addition to the programme if required)

Intensive Wash: More intensive wash.

Extra Rinse: Additional rinsing cycle.

Prewash: actuate Prewash

Additional options can be combined before the programme is started.

The indicator lights of the buttons come on, if the additional options are active.

Switch off additional option: press button again. Indicator light goes out.

Start button

For starting the wash cycle (programme must have been selected).

Before using your washing machine for the first time

Attention

The washing machine must have been installed and connected properly refer to Page 29.

- ☐ **i** The washing machine was tested before leaving the factory. To remove any water left over from testing procedures, the first washing cycle should be carried out **without** laundry in the machine.
- ☐ Turn the tap on.
- ☐ Pull out the detergent drawer all the way.
- ☐ Pour approx. 1 litre / 1 $\frac{3}{4}$ pt of water into chamber **II** of the detergent dispenser.
- ☐ $\frac{1}{2}$ Half fill the measuring beaker with detergent and pour into chamber **II**.
- ☐ **i** Do not use any special detergents for delicates or woollens (excessive foam).
- ☐ Close the detergent drawer.
- ☐ Close the washing machine door.
- ☐ Set the programme selector to **Cottons 90 °C**.
- ☐ Press the **Start** button.
The programme starts.

The programme has ended when the **End** indicator light is lit:

- ☐ Turn the programme selector to **Off**.

Preparing, sorting and loading the washing

Preparing the washing

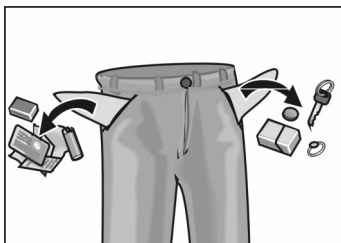

Attention

Loose debris (e.g. coins, paper clips, needles, nails) can damage items of clothing as well as parts of the washing machine (e.g. drum).

- ☐ Empty all pockets on items of clothing.
- ☐ Brush sand out of pockets and cuffs/turn-ups.
- ☐ Close zips, fasten pillow cases/cushion covers.
- ☐ Remove curtain runners or tie up in a net/bag.
- ☐ Wash in a net/cushion cover:
 - delicates, e.g. tights, curtains,
 - small laundry items, e.g. socks or handkerchiefs,
 - underwired bras (underwire may become detached during washing and cause damage).
- ☐ Trousers, knitwear and knitted textiles, e.g. jersey garments, T-shirts or sweatshirts should be turned inside out.

Sorting the washing

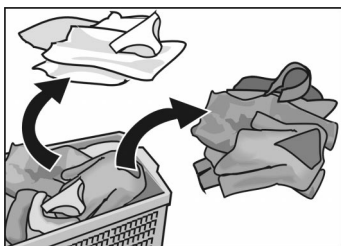

Attention

Washing may become discoloured. Do not wash new coloured washing with other washing.

White items may become grey. Wash white and coloured items separately.

- i** Observe the treatment symbols on the textile labels (see also programme overview).

Degrees of dirt

lightly soiled

No visible soiling or stains. Washing has probably absorbed body odour.

normally soiled

Visible soiling and/or a few light stains.

very soiled

Visible soiling and/or stains, e.g work clothes, e.g. mechanic's overalls, baker's and butcher's clothing.

Typical stains

- Skin grease, cooking oil/fat, sauces, mineral oil, wax (containing fat/oil).
- Tea, coffee, red wine, fruit, vegetables (which can be bleached).
- Blood, egg, milk, starch (containing protein, carbohydrate).
- Soot, earth, sand (pigments), tennis clothing soiled with red clay.

Removing stains

Remove/pretreat stains as soon as possible after they have occurred.

First dab with a soapy solution. Do not rub.

Then select the appropriate programme and wash the item.

Stubborn/dried in stains can sometimes only be removed by washing several times.

Loading the washing

⚠ Risk of explosion!

Items of clothing that have been pretreated with solvent-based cleaning agents, e.g. stain remover and dry cleaning spirit, represent an explosion hazard once loaded into the washing machine. Before loading the laundry, rinse thoroughly by hand.

Attention

Foreign objects in the drum may damage the laundry. Before loading the laundry, check that there is no debris in the drum.

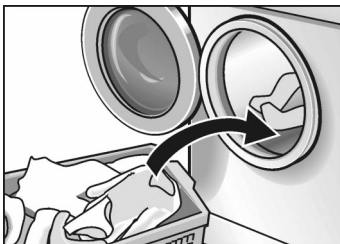

- ☐ Open the washing machine door.
- ☐ Unfold the sorted items of clothing and place them loosely into the drum. Mix large and small items. Laundry items which vary in size are more evenly distributed during the spin cycle.
- ☐ **i** Do not exceed recommended loads (see programme overview). Overloading will cause poor wash results and encourage creasing.
- ☐ Close the washing machine door. Take care not to trap any items of clothing between the loading door and rubber seal.

Detergents and cleaning products

Dosing detergent

⚠ Risk of poisoning!

Keep detergents and additives out of the reach of children.

Dose detergent according to

- the water hardness. You can find out the water hardness from your water utility company.
- the amount of laundry.
- the degree of soiling.
- the specifications of the detergent manufacturer.

Pour liquid detergent into the corresponding dispenser.

Too little detergent:

The laundry is not washed clean and eventually becomes grey and hard. Greyish-brown dots (grease spots) may stain the laundry. The heating elements are calcifying.

Too much detergent:

Environmentally incompatible, excessive foam reduces wash agitation causing poor washing and rinsing results.

Dispenser I

Detergent for prewash or starch.

Dispenser II

Detergent for main wash, water softener, pre-soaking agent, bleach and stain removal product.

Dispenser ☼

Cleaning product, e.g. fabric softener or fabric conditioner (do not fill above the lower edge of the insert 1).

i Concentrated or viscous fabric softener or fabric conditioner must be diluted with a little water before it is poured into the dispenser (prevents the overflow from becoming blocked).

Adding detergent/cleaning product

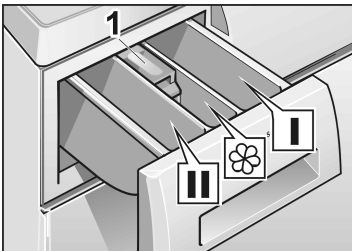

Programmes and functions

Programme selector

Basic programmes

Select the desired programme - see also programme overview.

i Programmes wash lightly soiled textiles in the shortest possible time. For heavily soiled textiles reduce the load or press the **Intensive Wash** button!

Cottons/Coloureds 30, 40, 60 °C

For hard-wearing textiles, e.g. made of cotton or linen.

Cottons/Coloureds 60 °C Stains

For stained, heavily soiled textiles, e.g. cotton or linen. Energy and water saving programme. The longer washing time in this 60 °C-programme means that the cleaning effects are comparable with those of a 90 °C-programme, although the power and water consumption is considerably lower.

Cottons 90 °C

Energy-intensive programme for heat-resistant textiles, e.g. made of cotton or linen.

To protect the waste-water pipes, the hot water is mixed with approx. 7 litres of cold water and cooled before being drained.

Easy-Care 30, 40, 60 °C

For easy-care textiles, e.g. made of cotton, linen, synthetic or blended fabrics.

i Also suitable as **short programme**.

Mixed Fabrics 30 °C

Time-optimised programme for lightly soiled cotton textiles and easy-care textiles. Different types of washing can be washed together. Even suitable for washing new textiles before they are worn for the first time.

-  Wash white and coloured items separately. Do not wash new coloured washing with other washing.

Short washing time.

Delicates 30 °C

For delicate, washable textiles, e.g. silk, satin, synthetic materials or blended fabrics (e.g. curtains).

Delicates cycle at 30 °C for hand and machine washable silk.

-  We do not recommend washing these textiles with other rougher textiles.

Wool Handwash cold, 30 °C

For hand and machine washable wool or wool-rich textiles, e.g. cashmere, mohair or angora. Also suited for hand washable silk.

Programme options

Rinse

Rinse cycle with subsequent spin cycle for rinsing hand-washed items or for starching.

Press the **Extra Rinse** button for an additional rinse cycle.

Spin

Spin cycle after a programme with setting **No Final Spin** or for spinning hand-washed washing with selection of the required speed. Washing water or rinsing water is drained before the spin cycle.

Empty

Water is drained after a programme with the **No Final Spin** setting on display panel for gentle treatment of delicate laundry.

Spin speed selector

Basic setting

The spin speed selector is pointing up.
In the **Cottons/Coloureds** programme the fabrics will be spun at the maximum possible spin speed.

In the **Easy-Care, Mixed Fabrics, Delicates** and **Wool** programmes, a lower spin speed will automatically be used, irrespective of the position of the button – gentle treatment of delicate fabrics.

i Between the rinse cycles the washing is given an intermediate spin only (not for **Delicate**).
This improves the rinsing results.

Maximum spin speeds

Revolutions per minute depending on model		Type of laundry / Programme options
1600	1400	Cottons/Coloureds
800	800	Easy-Care
800	800	Mixed Fabrics
600	600	Delicate
800	800	Wool
1200	1200	Rinse
1200	1200	Spin

Additional option

No Final Spin

For delicate textiles and net curtains.
All programmes can be run without final spin.
The laundry is left in the final rinsing water.
The **Spin** indicator light is lit.
Before the washing can be removed, the **Empty** or **Spin** programme must be run by setting the speed selector to the required speed.

Additional option – buttons

Intensive Wash

The washing time is extended so that highly soiled washing or 6 kg of cottons/coloureds are washed more intensively.
Press the button in addition to the programme for the following combinations of load and degree of soiling:

Amount of laundry	Programme and button Intensive Wash	Degree of soiling
6 kg	Cottons/Coloureds 30, 40, 60 °C	lightly to normally soiled
	Cottons/Coloureds 60 °C Stains	normally soiled with stains
	Cottons 90 °C	normally soiled
up to 5 kg	Cottons/Coloureds 30, 40, 60 °C	normally to heavily soiled
	Cottons/Coloureds 60 °C Stains	normally to heavily soiled with stains
up to 3 kg	Easy-Care 30, 40, 60 °C	normally to heavily soiled
	Mixed Fabrics 30 °C	
up to 2 kg	Delicates 30 °C	
	Wool cold 30 °C	

See the programme table for further information.

Extra Rinse

Additional rinsing of laundry.
Programme duration is extended accordingly.
Recommended application:
in areas with very soft water.

Prewash

For very dirty, hard-wearing laundry, e.g. cotton or linen.
The washing temperature of the prewash is 30 °C.
Prewash cannot be selected for woollens programme.

i If the prewash is cancelled, the detergent solution is pumped out and the programme continues with the main wash cycle.

Wash

Example of **Easy-Care 40 °C** programme:

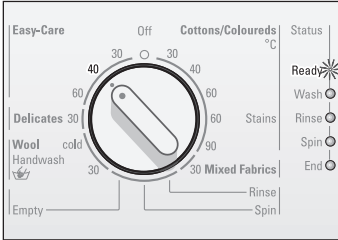

- ❑ Turn the programme selector to the desired programme (see also the programme overview).
The **Ready** indicator light comes on.

Example:

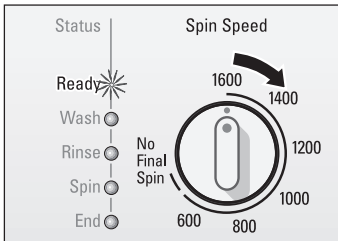

- ❑ If required, select spin speed or **No Final Spin**.

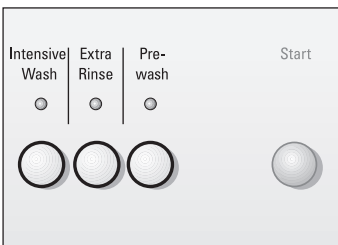

- ❑ If required, press the button(s) for additional option(s).
The indicator light of the selected button is on.



- ❑ Press the **Start** button.
The programme starts.

Changing the programme

If you have accidentally selected the wrong programme:

- ☐ Turn the programme selector to the desired programme.
If prewash is selected subsequently, set the programme selector to **Off** and reselect the programme.
- ☐ If required, change other settings.
- ☐ Press the **Start** button.
The programme starts.
- ☐ **i** The newly selected programme starts at the programme section at which the previous programme was cancelled, however with the new settings.

Cancelling the programme

If you would like to terminate a programme and remove the washing:

- ☐ Turn the programme selector to **Empty**, **Spin** or **Rinse**.
If required, select spin speed (not **No Final Spin**).
- ☐ **i** If a programme is interrupted at a high temperature, **Rinse** should be selected to cool down the washing.
- ☐ Press the **Start** button.
- ☐ Wait until programme ends.
- ☐ Turn the programme selector to **Off**.
- ☐ Open the washing machine door.
- ☐ Remove the washing.
- ☐ **i** If a programme was interrupted at a high temperature, the washing machine door may remain locked until the appliance has cooled down.

After washing

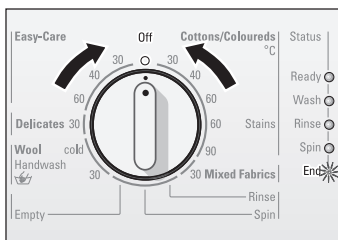

The **End** indicator light comes on.

- ☐ Turn the programme selector to **Off**.

or

- ☒ **i** The programme has ended and the **Spin** indicator light is lit.
 - ☐ Select an additional programme (**Empty** or **Spin**).
 - ☐ Press the **Start** button.
 - ☐ At the end of the programme option, turn the programme selector to **Off**.

Remove the washing

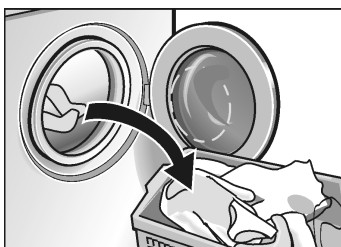

- ☐ Open the washing machine door.

If the loading door cannot be opened:
Wait 2 minutes (safety function is active)

or

there is still water in the washing machine if the **No Final Spin** option was selected.

Select the **Empty** or **Spin** programme and press the **Start** button.

- ☐ Unload the laundry.

Attention

Remove any foreign objects (e.g. coins, paper clips) from the drum and rubber seal – **risk of rust!**

- ☐ Leave the washing machine door and detergent drawer open to allow the interior of the washing machine to dry.

Special applications

Soaking

Attention

Do not bleach/dye washing in the washing machine.

- ☐ Load laundry of the same colour.
- ☐ Pour soaking agent into dispenser **II** according to the manufacturer's instructions.
- ☐ Set the programme selector to **Cottons/Coloureds 30 °C**.
- ☐ Press the **Start** button.
The programme starts.
- ☐ After approx. 10 minutes, turn the programme selector to **Off**. The laundry is left to lie in the water.
- ☐ Select a programme according to the required soaking time, the detergent solution is pumped out.
- ☐ **i** Only little detergent to be dispensed for the main wash.

Starching

The laundry must not be treated with fabric softener.

- ☐ Insert the washing.
- ☐ Dose a quantity of starch for approx. 15 litres of water. Dissolve starch according to the manufacturer's instructions.
- ☐ Turn the programme selector to **Rinse**.
- ☐ Set the spin speed; **No Final Spin** is possible.
- ☐ Press the **Start** button.

As soon as the water runs in:

- ☐ Pull out the detergent drawer a little and
- ☐ Pour starch solution into dispenser **I**.
- ☐ Close the detergent drawer.

If the **No Final Spin** option has been selected, select the **Empty** programme.

Cleaning and Care

Clean housing, fascia and supply lines

Cleaning the drum

Descaling the washing machine

⚠ Risk of electric shock!

First, always disconnect the appliance from the power supply.

Never clean the washing machine with a water jet.

⚠ Risk of explosion!

Never clean the appliance with solvents.

As required:

- ☐ Use hot soapy water or a mild, non-abrasive cleaning agent.
- ☐ Wipe dry with a soft cloth.

If metal items (e.g. coins, paper clips, needles, nails) left in the drum have caused rust spots:

- ☐ Use chlorine-free cleaning agents; comply with the manufacturer's instructions. Never use steel wool.

Attention

Descaling agents contain acids which may corrode the components of the washing machine and discolour the washing.

Provided that you use the correct amount of detergent, it is not necessary to descale the washing machine.

If descaling is nevertheless required, please follow the instructions supplied by the manufacturer of the descaling agent.

Cleaning the detergent dispenser

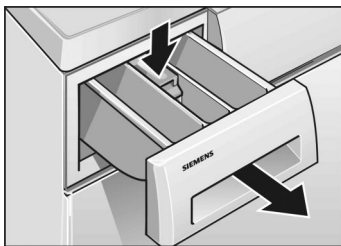

- ☐ Pull out the detergent drawer all the way,
- ☐ Press down the insert and
- ☐ remove the detergent drawer.

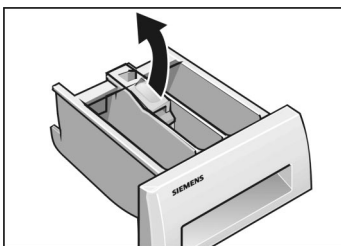

- ☐ Pull up the insert.
- ☐ Clean the detergent drawer under running water and dry.

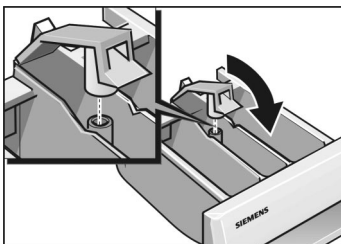

- ☐ Attach the insert and lock into position.
- ☐ Slide in the detergent drawer.

Cleaning the drain pump

Drain the water

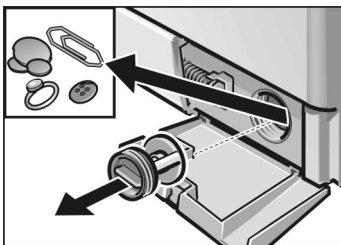
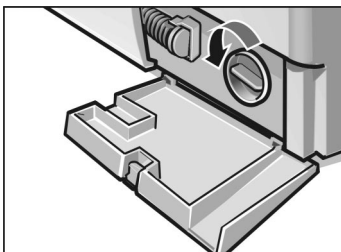
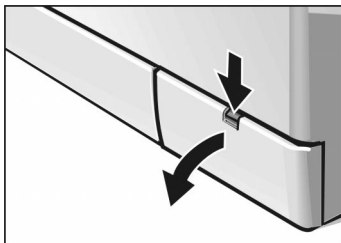

This is necessary if the washing solution has not been completely drained. The pump is blocked by either loose debris or fluff which accumulates if fluff-giving fabrics are washed.

(Up to 20 litres. Have a suitable container ready.)

⚠ Risk of scalding!

Allow the hot water to cool down beforehand. Keep children and pets away from the washing machine.

- ☐ Turn the programme selector to **Off**.
 - ☐ Open service flap and remove it.
 - ☐ Remove the drain hose from its holder and pull the hose out of the housing.
 - ☐ Pull down the closing cap **carefully** and allow the washing lye to flow into a suitable container.
 - ☐ Push up the closing cap and place the drain hose back in its holder.
 - ☐ Carefully remove the pump cap.
A little more residual water will flow out.
 - ☐ Remove foreign objects/fluff from inside and clean the interior. The pump impeller wheel must be able to rotate.
Clean any residual lye or fluff from the thread of the pump cap and pump housing.
 - ☐ Insert the pump cover and screw tight.
 - ☐ Insert and close the service flap.
- To prevent unused detergent from flowing into the drain during the next wash cycle:
- ☐ Pour 1 litre / 1 ¾ pt of water into chamber II.
 - ☐ Select the **Empty** programme.

Cleaning water inlet strainers

⚠ Risk of electric shock!

Do not immerse Aqua-Stop safety device in water (contains electrically operated valve).

This is necessary if very little or no water flows into the washing machine.

First, reduce the water pressure in the inlet hose:

- ☐ Turn off the tap.
- ☐ Turn the programme selector to any programme (except **Spin** and **Empty**).
- ☐ Press the **Start** button, and allow the programme to run for approx. 40 seconds.
- ☐ Turn the programme selector to **Off**.
- ☐ Disconnect the hose from the water tap.
- ☐ Clean the filter with a small brush or paint brush.
- ☐ Connect the hose.
- ☐ Turn the tap on.
- ☐ Check whether water is leaking out of the end of the hose connected to the tap.
If water is still discharged, check that the strainer is attached properly.

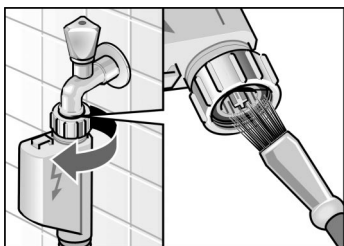

Help with minor problems

If repairs are needed, and assuming that you cannot eliminate the fault yourself with the aid the following table

- ☐ Turn the programme selector to **Off**.
- ☐ Disconnect the washing machine from the mains.
- ☐ Turn off the tap.
- ☐ Call customer service, see Page 28.

⚠ Risk of electric shock!
Repairs may be carried out by customer service or authorised technicians only.

Fault displays

Indicator light flashes and, depending on the model, a signal emitted	Possible cause	Remedial action
Wash	Door not closed properly.	Check whether laundry is trapped in door; Close the washing machine door.
Rinse	Tap not turned on.	Turn the tap on.
	Inlet hose kinked or pinched.	Eliminate cause.
	Filter blocked in water inlet hose.	Clean filter, see Page 22.
	Water pressure too low.	Eliminate cause.
Spin	Loose debris is blocking the pump.	Clean the pump, see Page 21.
	Drainage pipe and/or drainage hose blocked.	Clean drainage pipe and/or drainage hose.

Problems	Cause	Remedial action
Washing machine door cannot be opened.	There is still some water in the appliance, No Final Spin selected.	Select Empty or Spin .
	Safety function is active.	Wait for 2 minutes.
Detergent residue in the detergent drawer.	Damp or lumpy detergent.	Clean and dry the detergent dispenser; see Page 20.
		Use the dosing aid for liquid detergent.
	Difficult-to-dissolve detergent tablets used.	Before filling dispenser II , crush the tablets in the packet.
Odour in the appliance.	Washing mainly at low temperatures and/or with liquid detergents.	Start Cottons 90 °C programme without washing. Use a standard detergent.
Control lights do not come on.	A fuse has triggered.	Switch on/replace the fuse.
		If the fault occurs repeatedly, call Customer Service.
	Power failure.	An interrupted programme will be resumed when the power returns. If you wish to unload the laundry, proceed as in Cleaning the drain pump , page 21.
	Plug is loose or not plugged in.	
Programme does not start.	Loading door not closed properly.	Check whether laundry is trapped in door.
		Close the loading door (a click should be heard).
Programme does not start.	Start button not pressed.	Press the Start button.
Water does enter the machine or detergent is not washed away.	Tap not turned on.	Turn the tap on.
	Inlet hose kinked or pinched.	
	Filter blocked in water inlet hose.	Clean the strainer; see from Page 22.
Detergent in chamber I is not washed away.	A programme without Prewash was selected.	Select programme with Prewash.

Problems	Cause	Remedial action
Water not visible in the drum.	Not a fault. The water lies below the visible part of the drum.	
Washing solution is not completely drained.	Pumped blocked by foreign objects.	Clean the pump refer to page 21.
	Fluff-producing laundry was washed. The water drainage pipe or drain hose is blocked.	Clean drainage pipe and/or drainage hose.
Programme does not continue running and an indicator light is lit.	Water in the base pan; Appliance leaking.	Call Customer Service.
Water runs out from under the appliance.	Screw fitting of the inlet hose is leaking.	Tighten the screw-fitting.
	Drainage hose is leaking.	Replace the drain hose.
Foam comes out of the detergent drawer.	Too much detergent or detergent not suitable for use in washing machines used.	Mix 1 tablespoon of fabric softener with ½ litre pt of water and pour into chamber II of the detergent dispenser.
		Reduce detergent dosage for next wash cycle or use detergent which is suitable for use in washing machines.
Vibrations during wash and spin cycles	Transit bolts not removed.	Remove the transit bolts; see installation instructions.
	Appliance feet not secured.	Secure the appliance feet.
The washing has not been spun correctly.	Large laundry items have become entangled and are not evenly distributed in the drum. For safety reasons, the high-speed final spin cycle was automatically cancelled.	Do not put only large items in the drum.
Spin result unsatisfactory.	The Rinse or Spin programme selected maximum spin speed: see Page 13.	
Spin cycle actuated several times.	Not a fault. Unbalanced load detection system is attempting to compensate the imbalance by spinning the washing several times.	

Problems	Cause	Remedial action
The programme takes longer than usual.	Not a fault. Imbalance compensation system attempts to balance the laundry by repeated distribution.	Wash large and small items together in order to reduce the imbalance.
	The foam detection feature has activated an additional rinsing cycle to reduce the amount of foam.	Adjust the detergent dosage for the next wash cycle.
Washing result not satisfactory.	Soiling is greater than expected or recommended load has been exceeded.	Select suitable programme and press the Intensive Wash button or reduce load.
	Detergent was underdosed.	Dose detergent according to the manufacturer's instructions.
Detergent residue on the washing.	Some phosphate-free detergents contain water-insoluble residue which may appear as light stains on the washing.	Select Rinse immediately or brush out the washing after drying.
Grey residue on the washing.	Soiling caused by ointment, grease or oil.	Select maximum detergent dosage and maximum permitted temperature for the next wash cycle.
Signal is emitted	Signal for switching buttons on and off is switched on.	Switch off the signal: Press the Start button and set the programme selector to Cottons/Coloureds 30 °C . Hold down the Start button until the signal is emitted. Acoustic signal is switched off.
	Signal for programme status is switched on.	Switch off signal or change volume: Press the Intensive Wash button and hold down until the signal is emitted and the volume of the signal changes. Release the button when the required volume is reached. The selected setting is stored.

If the fault recurs, call Customer Service, see Page 28.

Consumption values

Normal programme	Additional option	Load	Consumption values **		
			Power	Water	Programme duration
Cottons/Coloureds 40 °C	Intensive Wash *	6 kg	0.65 kWh	60 l	2:10 h
Cottons/Coloureds 60 °C	—	5 kg	0.95 kWh	60 l	1:17 h
Cottons/Coloureds 60 °C Stains	Intensive Wash *	6 kg	1.02 kWh	49 l	2:15 h
Cottons 90 °C (the hot washing solution is mixed with approx. 7 litres of cold water before being drained)	Intensive Wash	6 kg	2.1 kWh	67 l	2:10 h
Easy-Care 40 °C	Intensive Wash *	3 kg	0.5 kWh	50 l	1:18 h
Easy-Care 40 °C (Also suitable as short programme)	—	3 kg	0.5 kWh	38 l	0:47 h
Delicates 30 °C	—	2 kg	0.3 kWh	42 l	0:35 h
Wool 30 °C	Intensive Wash *	2 kg	0.2 kWh	35 l	0:50 h

* Programme setting with **Intensive Wash** option for test in accordance or in conformity with EN 60 456 and IEC 60 456.

** Consumption values will differ from the indicated values depending on the water pressure, water hardness, water inlet temperature, ambient temperature, type and quantity of washing and degree of soiling, utilised detergent, fluctuations in the mains voltage and selected additional options.

Customer service

Each washing machine which leaves our factory is checked carefully to ensure that it functions properly and is in perfect condition. If you have any questions – especially with respect to installing and connecting your washing machine – please do not hesitate to contact our customer service department.

Before you call customer service, please check whether you can eliminate the fault yourself (see from Page 23).

A technician who is called out to give advice will charge you, even if the appliance is still under guarantee.

You can find your nearest customer service in the enclosed address list. Please provide customer service with the product number (E-Nr.) and the production number (FD) of the appliance.

Rating plate

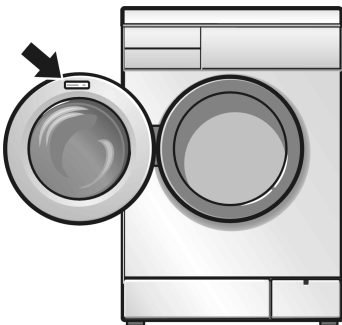

These numbers are shown on the rating plate which can be found on the frame of the open door and also on the identification plate, enclosed by a thick line, on the front of the machine behind the nameplate.

E-Nr. _____	FD _____
-------------	----------

Product number

Production number

Please note the two numbers in the space provided above.

In specifying the product number and production number of your appliance, you help us in our attempt to prevent unnecessary travelling and the associated extra costs.

Further information and a selection of our products can be found on our Internet page:
<http://www.siemens.de/hausgeraete>

Installing, connecting and transporting the appliance

Safety instructions

⚠ Risk of injury!

The washing machine is very heavy. Take care when lifting it.

Attention

Frozen hoses may tear/burst. Do not install the washing machine in an area where there is a risk of frost or outdoors.

The washing machine may be damaged. Do not lift the washing machine by its projecting parts (e.g. door).

In addition to the safety information listed here, the local water and electricity supplier may have special requirements.

If in doubt, have the appliance connected by a specialist.

Packaging and old appliances



Unpack the appliance and dispose of the packaging in an environmentally-responsible manner.

This appliance is labelled in accordance with European Directive 2002/96/EC concerning used electrical and electronic appliances (waste electrical and electronic equipment - WEEE).

The guideline determines the framework for the return and recycling of used appliances as applicable throughout the EU.

Standard accessories

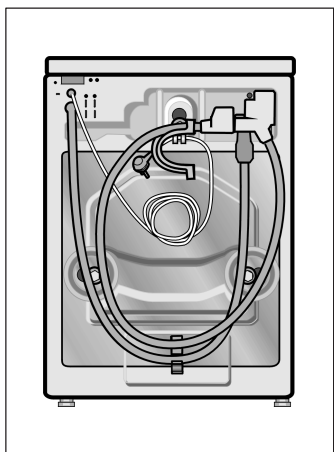

On the rear of the washing machine:

- Water drainage hose.
- Water-inlet hose.
- Elbow for attaching the drainage hose e.g. to the sink,
- Mains cable with plug.

Moisture in the drum is due to the final inspection which every washing machine undergoes before it leaves the factory.

Depending on the connection situation, the following part is also required:

- 1 hose clip Ø 24–40 mm (DIY store) is also required for connection to a siphon.

The bag contains:

- Spanner.
- Covers for holes left by removing the transport bolts.

Useful tools

The following tools are helpful:

- Box wrench A/F 13 for removing the transportation bolts,
- Spirit level for aligning the washing machine.

Dimensions

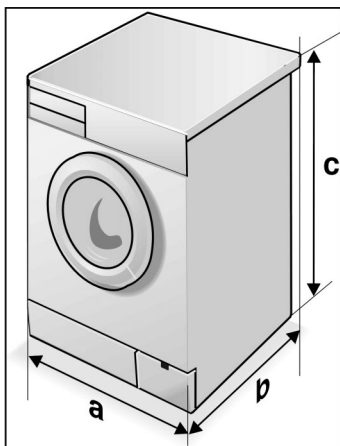

a = 600 mm

b = 590 mm

c = 852 mm

Weight 69–83 kg (depending on appliance)

Installation surface

Appliance stability is important so that the washing machine does not "wander" during the spin cycles.

The installation surface must be solid and level. Soft floor coverings, e.g. carpets or floor coverings with a foam backing are not suitable.

If the washing machine is to be installed on a wooden floor:

- ☐ If possible, install the washing machine in a corner.
- ☐ Screw a water-resistant wooden board (at least 30 mm thick) to the floor.
- ☐ Secure the washing machine feet with fixing brackets*.

If the washing machine is to be installed on a base:

- ☐ Secure the washing machine feet with fixing brackets*.

* Holding brackets (set) can be obtained from a specialist store or the Customer Service, order no. WX 9756.

Removing the transportation protection devices

Before removing the transportation protection devices

Removing the transportation protection devices

⚠ Caution

The transport bolts must always be removed before using the appliance for the first time.

- ☐ Take the hoses out of the holders.
- ☐ Detach the elbow.
- ☐ Release screws **1**, **2** and **3** using the A/F 13 wrench until they can be moved freely.

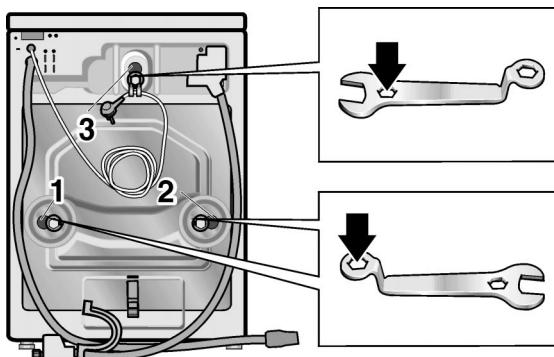

- ☐ Remove complete transportation protection devices **1** and **2** (bolt with washer and bush).
- ☐ Remove complete transportation protection device **3** (bolt with spring, washer and bush), holding the open washing machine door with one hand and pulling the drum slightly forwards.

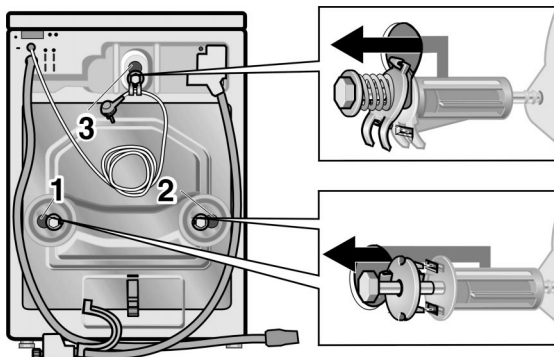

- ☐ Insert the covers.

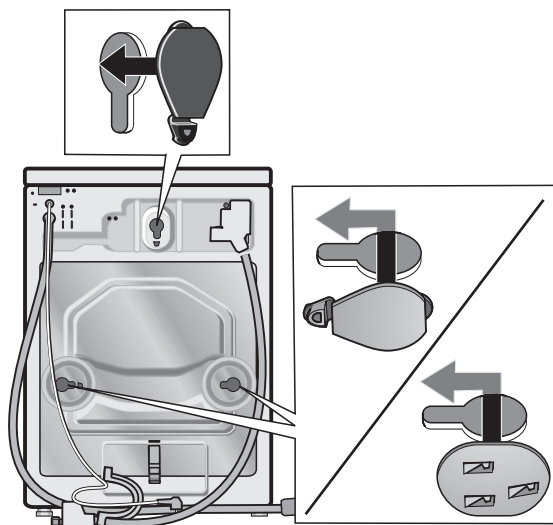

Storing the transportation protection devices

Always keep the transport bolts for subsequent transportation of the appliance (e.g. when moving house).

- ☐ Store transport bolts **1** and **2** (screw washer and bushing onto bolt).

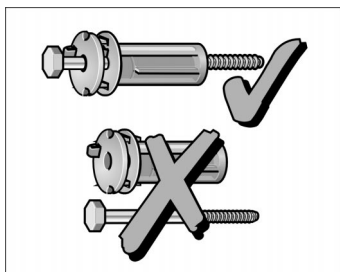

Hose and cable lengths

Connection on left side

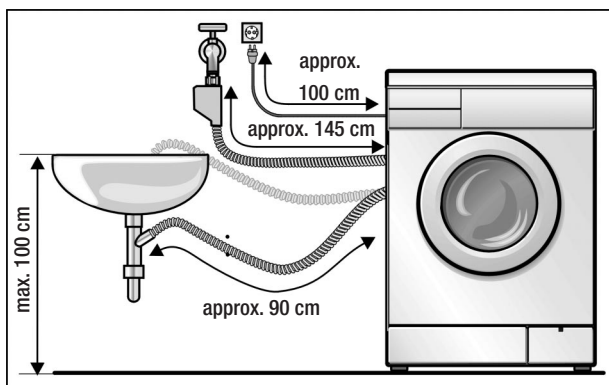

Connection on right side

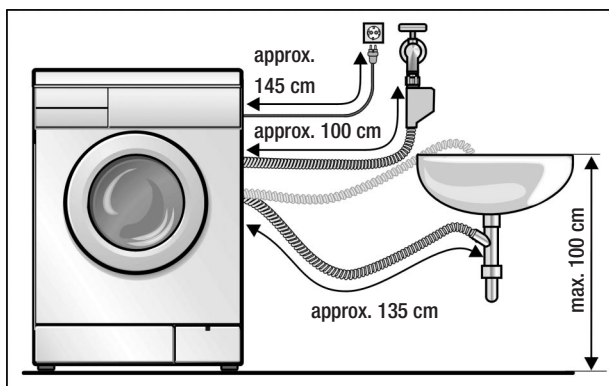

Aqua-Stop extension hose

Available in kit form from specialist outlets:

- Connecting kit with plastic hose (approx. 2.50 m), order no. WZ 10130.

Connecting the water

Water inlet hose

⚠ Risk of electric shock!

Do not immerse Aqua-Stop safety device in water (contains electrically operated valve).

To prevent leaks or water damage, it is essential to follow the instructions in this chapter!

Attention

Operate the washing machine with cold drinking water only. Do not connect to the mixer tap of an unpressurised hot-water apparatus.

If in doubt, have the appliance connected by a specialist.

The water inlet hose must not be

- kinked or crushed,
- modified or severed (strength is no longer guaranteed).

Check the mains water pressure:

- The water pressure should be between 1 and 10 bars (when the tap is turned on, at least 8 litres of water is discharged per minute).
- If the water pressure is higher, install a pressure reducing valve.

- ☐ Connect the water supply hose to the tap.

After connecting the water inlet hose:

- ☐ Turn on the tap fully.
- ☐ Check the connection points for leaks.

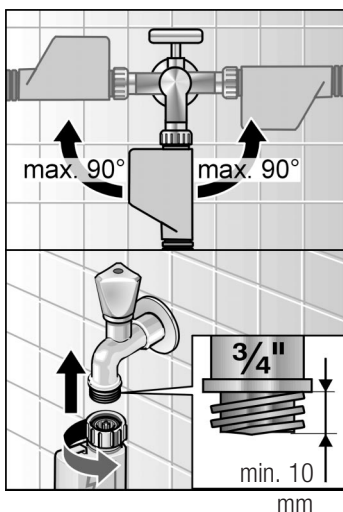

Water drainage hose

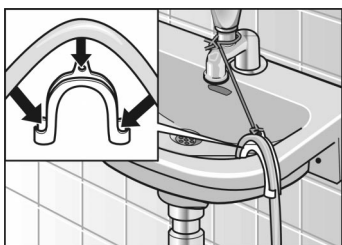
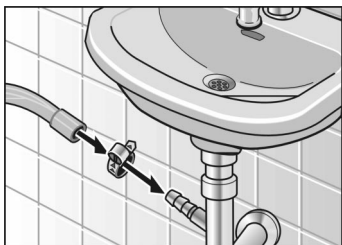

Attention

Do not bend or pull the water drainage hose.

Height difference between the placement area and drainage point: maximum 100 cm.

Drainage into a siphon:

- ☐ Secure connection point with 24–40 mm Ø hose clip (specialist outlet).

Drainage into a wash basin:

Attention

The plug must not block the drain of the wash basin.

- ☐ Secure the drainage hose to prevent it from slipping out of the sink.
- ☐ When the water is being pumped out of the washing machine, check that the water drains away quickly enough.

Aligning the washing machine

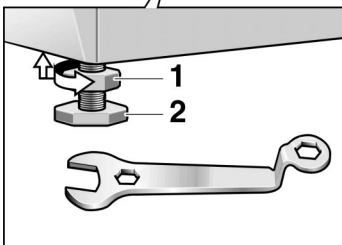
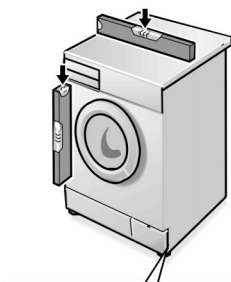

Level the washing machine with the assistance of the four adjustable feet and a spirit level:

- ☐ Loosen the lock nut **1** using the wrench.
- ☐ Adjust the height by rotating the foot **2**.
- ☐ Tighten the lock nut **1** against the housing. Simultaneously hold the foot in place and do not adjust the height.

All four feet must be firmly on the floor. The washing machine must not wobble.

The lock nuts of all four appliance feet must be screwed tightly against the housing!

Attention

Loud noise generation, vibrations and "wandering" may be due to incorrect alignment!

Connecting the power

Attention

Connect the washing machine only to an alternating current via a correctly installed earthed socket.

The mains voltage must correspond to the voltage specification on the washing machine (nameplate). Connection specifications as well as the required fuses are stipulated on the appliance nameplate.

Ensure that:

- The mains plug and socket are compatible.
- The cable cross-section is adequate.
- The earthing system has been installed correctly.

The mains cable may be changed (if required) by an electrician only.

Replacement mains cable available from customer service.

Do not use multiple plugs/sockets or extension cables.

In the event that an earth-leakage circuit breaker is to be used, only use types marked with the following symbol: .

Only this symbol can guarantee compliance with all current regulations.

Do not insert/pull out the mains plug with wet hands.

Do not pull out the mains plug by tugging the cable.

Transport, e.g. when moving

Before transporting the washing machine

- Turn off the tap,
- Reduce the water pressure in the water inlet hose (see Page 22),
- Drain any residual washing solution (refer to Page 21).
- Disconnect the washing machine from the power supply,
- remove the hoses,
- install the lower 2 transport bolts.

Having transported the appliance and ensured proper installation and connection, allow the **Empty** programme to run through before starting the first wash programme.

Preparing and inserting the transport bolts

- ☐ Remove the 2 lower covers.
- ☐ Prepare the transport bolts:
Loosen the screw in the sleeve until the end of the screw is level with the end of the sleeve.
- ☐ Through the open washing machine door have a second person pull the top of the drum forwards. Now insert transportation protection devices **1** and **2** and tighten the screws. The washer lugs must be located in the groove in the rear panel of the housing.

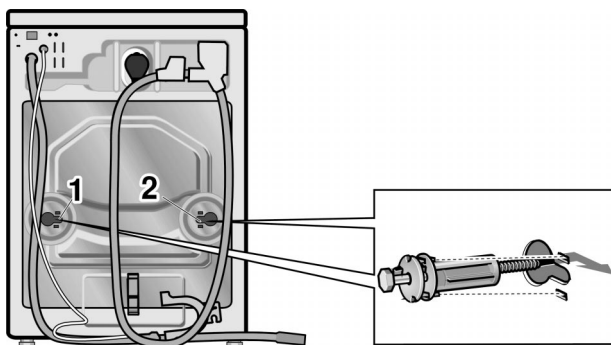

Aqua Stop warranty

In addition to warranty claims against the seller based on the sales contract and in addition to our appliance warranty we shall be liable for payment of damages under the following conditions:

1. If damage is caused by water due to a fault of our Aqua Stop system, we shall compensate the private user for the damage.
2. This liability guarantee is valid for the service life of the appliance.
3. A claim under the warranty can only be considered provided Aqua-Stop has been properly installed and connected to the appliance according to our instructions, including a properly installed Aqua-Stop extension (original accessory). Our warranty does not apply to defective supply lines or fittings up to the Aqua Stop connection on the tap.
4. If your washing machine features Aqua Stop, you do not need to keep your eye on the washing machine during operation or turn the tap off afterwards. You should only turn the tap off if you intend being away from home for a prolonged period, e.g. on holiday.

Index

A

- Adding detergent, 10
- Additional options, 5, 14
 - Extra Rinse, 5, 14
 - Intensive Wash, 5, 14
 - Prewash, 5, 14
- Aligning the washing machine, 36
- Aqua Stop, 39
- Aqua Stop extension hose, 34

B

- Basic programmes, 11

C

- Cancelling the programme, 16
- Changing the programme, 16
- Cleaning and Care, Detergent drawer, 20
- Cleaning and care, 19
 - Control panel, 19
 - Drain pump, 21
 - Drum, 19
 - Housing, 19
 - Strainer, 22
 - Supply lines, 19
- Closing cap, 21
- Connecting the power, 37
- Connecting the water, 35
- Consumption values, 27
- Control panel, 5
- Cottons/Coloureds, 11–13
 - Stains, 11
- Customer service, 28

D

- Degrees of dirt, 8
- Delicates, 12
- Descaling, 19
- Dimensions, 30
- Dosing detergent, 10

E

- Easy–Care, 11
- Empty, 12
- End of the programme, 5, 17

F

- Fault display, 23
- Functions, 11

H

- Holding bracket, 31
- Hose and-cable lengths, 34

I

- Indicator lights, 5
 - End of programme, 5
 - Ready, 5
 - Rinse, 5
 - Spin, 5
 - Wash, 5
- Insert transportation protection devices, 38
- Installation surface, 31
- Internet, 28

L

- Loading the washing, 7, 9

M

Mixed Fabrics, 12

P

Preparing the washing, 7

Problems, 23

Product number, 28

Production number, 28

Programme duration., 27

Programme options, 12

Programme selector, 5,
11

Programmes, 11

Pump cap, 21

R

Rating plate, 28

Remove the washing, 17

Removing stains, 8

Removing the transportation protection
devices, 32

Rinse, 12

S

Safety instructions, 29

Service flap, 21

Soaking, 18

Sorting the washing, 7

Spin, 12

Spin speed selector, 5,
13

Standard accessories,
30

Starching, 18

Start button, 5

Start programme, 15

Storing the transportation protection
devices, 33

T

Take out the drain hose.,
21

Tools, 30

Transporting the washing
machine, 38

W



















Wash, 15

without final spin, 13

Wool, 12

WXMLM168AGB/WXMLM166AGB/WXMLM148AGB
0105/9000 038 979

SIEMENS ELECTROGERÄTE GMBH

Programmes ¹⁾²⁾ Type of laundry	Amount of laundry	Degree of soiling	Required button, additional function
Cottons/Coloureds     			
Hard-wearing textiles, heat-resistant textiles e.g. cotton or linen			
30, 40 ³⁾ , 60 °C	6 kg	light to normal	Intensive Wash
60 °C Stains ³⁾		normally with stains	Intensive Wash
90 °C		normal	Intensive Wash
30, 40, 60 °C	up to 5 kg	light	–
30, 40, 60 °C		normal to heavy	Intensive Wash
60 °C Stains		normally to heavily with stains	Intensive Wash
Easy-Care   			
Easy-Care textiles e.g. cotton, linen, synthetic materials or blended fabrics (also suitable as a short programme)			
30, 40, 60 °C	up to 3 kg	light	–
30, 40 ³⁾ , 60 °C		normal to heavy	Intensive Wash
Mixed Fabrics  			
For cotton washing and easy-care textiles – different types of washing can be washed together			
30 °C	up to 3 kg	light	–
30 °C		normal to heavy	Intensive Wash
Delicate    			
Delicate, washable textiles, e.g. silk, satin, synthetic or blended fabrics without wool component (e.g. curtains)			
30 °C	up to 2 kg	light	–
30 °C		normal to heavy	Intensive Wash
Wool     			
hand and machine washable wool or woolrich textiles, e.g. cashmere, mohair or angora. Also suited for hand washable silk.			
cold, 30 °C	up to 2 kg	light	–
cold, 30 °C ³⁾		normal to heavy	Intensive Wash
Programme options		Rinse, Spin, Empty	

- 1) The following **additional options** can be selected in addition to the programmes:
Spin speed selector: **Spin speeds** or **No Final Spin** (without final spin),
Buttons: **Intensive Wash, Extra Rinse, Prewash.**
- 2) Pour detergent into dispenser **II** (on left) for programme without prewash;
distribute detergent between dispensers **I** and **II** for programmes with prewash.
- 3) Programme setting for test in accordance or in conformity with EN 60456 and IEC 60456.

Quick-reference instructions

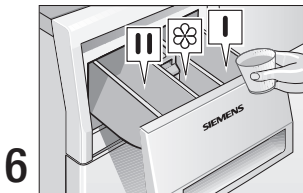
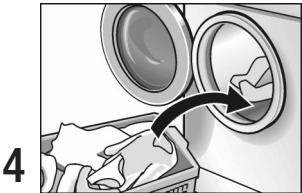
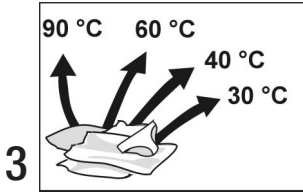
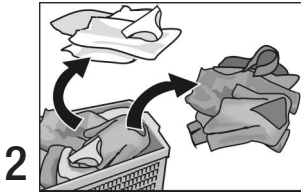
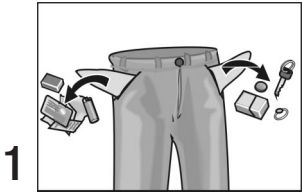

If required:

If required:

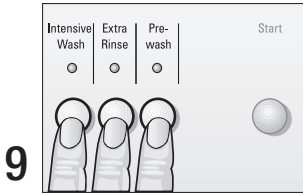
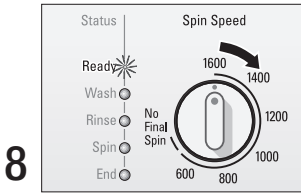
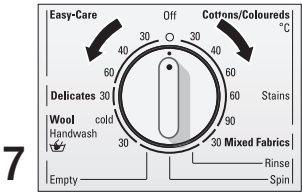

At the end of the programme:

