



立即注册您的新博世产品：  
[www.bosch-home.cn](http://www.bosch-home.cn)



**手持式搅拌机**  
MSMM7310CN  
MSMM8910CN



**BOSCH**

**zh** 使用说明书  
**en** Instruction manual

使用产品前请仔细阅读本使用说明书, 并请妥善保管

---

<b>zh</b>	简体中文	3
<b>en</b>	English	7

---



## 安全须知

在使用前, 请仔细阅读这些说明, 以便熟悉本电器的重要安全和操作说明。

若未遵守正确使用电器的说明, 制造商对造成的任何损害概不承担责任。本电器用于加工普通家庭用量或非商业应用中类似用量的食材。非商业应用包括诸如商场、办公室、农业和其他商业企业的员工厨房, 以及供公寓、小型旅馆和类似住所的客人使用。本电器用于加工满足家庭所需用量的食材。本电器仅适用于切碎或混合食材。不得将其用于加工其他物品或物质。请妥善保管使用说明书。若将本电器转让给第三方, 请务必随附上使用说明书。仅限在室温及海拔 2000 米以下的室内使用本机器。

### 一般安全说明

#### **⚠ 有电击危险!**

儿童不得使用本电器。必须将本电器及其电源线放在远离儿童的地方。可以让有身体、感官、精神障碍或缺乏使用经验和使用知识的人使用本电器, 不过前提是操作时必须有人在场监督并指导他们如何安全地使用本电器, 而且还要让他们了解操作时可能面临的危险。儿童不应玩耍本电器。电器必须按照铭牌上的技术规范进行连接和操作。仅供室内使用。若电源线和/或电器损坏, 请勿使用本电器。在更换附件或接近活动部件之前, 请关闭电器并断开电源连接。若无人照看时或者在装配、拆卸或清洁之前, 请始终记得断开电器的电源连接。请勿将电源线放在锐利边缘或热表面上。为防止受伤, 损坏的电源线必须交由制造商或其客服以及类似的合格人员进行更换。本电器只可交由我们的客服进行维修。

### 电器安全说明

#### **⚠ 有受伤危险!**

#### **⚠ 有电击危险!**

请勿以湿手来操作手持式搅拌机, 也不要使其空载运行。若将本电器浸入液体中, 请勿让液面超过搅拌脚与底座装置的连接点。切勿将底座装置浸入液体中, 不得放入洗碗机清洗。加工热液体时要小心。液体可能会在加工过程中飞溅出来。切勿将搅拌脚安放在热表面或用于高温食品。在用搅拌机加工之前, 至少要让食材冷却至 80 °C! 在烹饪锅内使用手持式搅拌机之前, 请将锅从电磁炉上移开。只能配合原装附件来使用手持式搅拌机。请勿在电器未完全停止前安装或拆卸工具。建议: 切勿让电器开启的时间超过加工食材所需的时间。搅拌杯不适用于微波炉。

#### **⚠ 锋利的刀片/旋转驱动装置容易引发受伤危险!**

切勿抓住搅拌脚上的刀片。切勿赤手清洁刀片。请使用刷子。

## 目录

安全须知 .....	3
概述 .....	4
操作 .....	5
清洁 .....	5
故障排除 .....	5
菜谱和提示 .....	6
环保型处理 .....	6
保修 .....	6

感谢您购买新的 Bosch 电器。您可以在我们的网页上找到更多关于产品的信息。

### 原产地:

斯洛文尼亚

### 总经销商:

博西家用电器(中国)有限公司  
南京市中山路129号中南国际大厦20、21楼

### 执行标准:

GB 4706.1-2005  
家用和类似用途电器的安全 第1部分:  
通用要求

GB 4706.30-2008  
家用和类似用途电器的安全 厨房机械的特殊要求

### 全国统一客户服务热线:

4008855888

### 客户服务电子邮箱:

careline.china@bshg.com

### 公司网站:

www.bosch-home.cn

### 技术规格:

电气连接 (电压 - 频率)	220-240 V~ 50/60 Hz
额定功率 MSMM7310CN MSMM8910CN	750 W 800 W
尺寸(高 x 宽 x 深)	402 x 63 x 63 毫米

这些操作说明涉及到各种型号。图示页上有不同型号的概述。→ 图 G

## 概述

请翻开图示页。

### → 图A:

- 底座装置**
- 电源线**
- 调速旋钮**  
工作速度可在最低 (●) 和最高 (12) 速度之间调节 (需配合按钮 4a)。
- 工作按钮**
  - 调速工作按钮**  
(需配合调速旋钮 3)
  - 点动脉冲按钮**  
只要按下了工作按钮 (a 或 b), 手持式搅拌机就会保持工作。点动脉冲用于多用途切碎附件 (若已随附)。
- 释放按钮**  
要卸下搅拌脚, 请同时按下两个释放按钮。
- 搅拌脚**  
连接搅拌脚并锁定到位。
- 搅拌机刀片**
- 搅拌杯**  
使用搅拌杯能够防止食材飞溅。
- 盖子**  
用盖子盖住搅拌杯以保存加工后的食材。

### 适用于部分型号:

- 带齿轮的打发桨**
- 带齿轮的蔬菜泥附件**
- 带盖子的多用途切碎附件 XL**
- 带盖子和碎冰刀片的多用途切碎附件 L**
- 带工具的多功能料理碗**
- 带工具和切丁器的多功能料理碗**

若手持式搅拌机未随附多用途切碎附件, 则可向客服订购 (订购号 753122)。配合多用途切碎附件 XL 可在全功率下用本电器制作蜜糖抹酱 (按照食谱)。您可以在多用途切碎附件的操作说明中找到食谱。用盖子盖住多用途切碎附件以保存加工后的食材。

## 操作

本电器适用于加工蛋黄酱、酱汁、混合饮品、婴儿食品、水果羹和蔬菜羹。适用于加工浓汤。

使用多用途切碎附件将原材料（洋葱、大蒜、香料）切碎/剁碎！

建议使用随附的搅拌杯。但是，也可使用其他合适的容器。

### 警告！

您所使用的容器底部不能带有任何凸起或凹陷。

- 首次使用本电器前，请清洁其所有部件。

### → 图 4:

- 彻底解开电源线。
- 将搅拌脚安装到底座装置上并锁定到位。
- 插上电源插头。
- 将食材放入搅拌杯或其他较高的容器中。

**信息：**若食材中加入部分液体，则本电器的使用效果更佳。

- 通过调速旋钮设定所需的速度。

### → 图 4-5

建议将低速档用于加工液体、热食品或者混合（如酸奶中的麦片）。建议将高速档用于加工固态些的食材。

- 紧握住手持式搅拌机和搅拌杯。
- 按所需的工作按钮，开启手持式搅拌机。

**信息：**在开启手持式搅拌机时，请稍稍呈一个角度将其握住，以防止其吸住搅拌杯底部。只要按下**工作按钮**，手持式搅拌机将保持开启。

**信息：**为防止食材飞溅，在搅拌脚浸入食材中之前，请勿按**工作按钮**。在从加工好的食材中提起手持式搅拌机之前，应始终记得将其关闭。

- 加工完后松开**工作按钮**。

## 使用电器后

- 拔下电源插头。
- 按释放按钮并从底座装置上卸下搅拌脚。

## 清洁

### 重要信息

本电器无需维护。彻底清洁可防止电器损坏并保持其功能正常。

### ⚠ 有电击危险！

切勿将底座装置浸入液体中，不得放入洗碗机清洗。在清洁本电器前，请拔下电源插头！请勿使用蒸汽清洗装置！

### 警告！

否则可能会损坏表面。请勿使用磨蚀性清洁剂。

**信息：**若加工如紫甘蓝或胡萝卜等食材，塑料部件会被染上颜色，用几滴食用油即可将其去除。

- 拔下电源插座！
- 用湿抹布擦拭底座装置，然后将其擦干。
- 搅拌杯和盖子可在洗碗机中清洗。
- 用洗碗机清洗搅拌脚，或者在流水下用刷子清洗。
- 垂直晾干搅拌脚（搅拌机刀片朝上），以便让残留的水流出。

**注：**带螺旋电源线的电器：切勿将电源线缠绕在电器上！

## 故障排除

### 故障

电器在使用时突然关闭。

### 补救措施

过载保护功能已被激活。

- 关闭电器并拔下电源插头。
- 让电器冷却大约 1 小时，以便停用过载保护设备。
- 重新开启电器。

若故障无法消除，请与客服联系。

---

## 菜谱和提示

### 蛋黄酱

- 1 个鸡蛋 (蛋黄和蛋白)
- 1 汤匙芥末
- 1 汤匙柠檬汁或醋
- 200-250 毫升油
- 盐和胡椒

食材必须温度相同!

- 将食材放入搅拌杯中。
- 将手持式搅拌机安放在搅拌杯底部, 然后开启 (点动脉冲) 本电器直到混合物乳白。
- 慢慢提起正在运行的搅拌机, 直到刚刚达到混合物上边缘, 然后再放低搅拌机, 如此重复直到蛋黄酱加工完成。

**提示:** 按照本食谱, 您也可以只用蛋黄来制作蛋黄酱。但使用的油量要减半。

### 蔬菜汤

- 300 克土豆
- 200 克胡萝卜
- 1 小根芹菜
- 2 个西红柿
- 1 个洋葱
- 50 克黄油
- 2 升水
- 盐和胡椒
- 西红柿去皮及去籽。
- 将洗净的蔬菜切碎并用黄油翻炒。
- 加入水和盐。
- 煮 20-25 分钟。
- 将锅从炉灶上移开。
- 用搅拌机在平底锅内将汤打成糊状。
- 用盐和胡椒调味。

### 法式薄饼面团

- 250 毫升牛奶
- 1 个鸡蛋
- 100 克面粉
- 25 克经融化和冷却的黄油
- 按照指明的顺序将所有食材放入搅拌杯中, 然后混合成均匀的面团。

### 混合牛奶饮料

- 1 杯牛奶
- 6 个大草莓或 10 颗覆盆子或 1 个香蕉 (切片)
- 将食材放入搅拌杯中并搅拌。
- 加糖调味。

**提示:** 要制作奶昔, 请加入一汤匙冰激凌或使用低温牛奶。

---

## 环保型处理



对本设备根据有关电气和电子设备报废的欧洲规定 2012/19/EU

(waste electrical and electronic equipment — WEEE) 进行标记。该规定管理在欧洲范围内对报废设备的回收和再生。

请咨询专业零售商, 了解可用的处置方式。

---

## 保修

该设备的保修条款将由售国国的销售代表来确定。您可向售出此设备的经销商详细了解这些条款。

当根据保修条款进行任何索赔时, 必须出具销售凭证或收据。

我们保留对保修条款作出修订的权利。

---

## For your safety

Before use, read these instructions carefully in order to become familiar with important safety and operating instructions for this appliance.

If the instructions for correct use of the appliance are not observed, the manufacturer's liability for any resulting damage will be excluded. This appliance is designed for processing normal household quantities in the home or similar quantities in non-industrial applications. Non-industrial applications include e.g. use in employee kitchens in shops, offices, agricultural and other commercial businesses, as well as use by guests in boarding houses, small hotels and similar dwellings. Use the appliance for processing normal quantities of food for domestic use. The appliance is only suitable for cutting or mixing food. It must not be used for processing other objects or substances. Please keep the operating instructions in a safe place. If passing on the appliance to a third party, always include the operating instructions. Only use the appliance indoors at room temperature and up to 2000 m above sea level.

### General safety instructions

#### **Danger of electric shock!**

The appliance must not be used by children. The appliance and its power cord must be kept away from children. Appliances can be used by persons with reduced physical, sensory or mental capabilities or lack of experience and knowledge if they have been given supervision or instruction concerning use of the appliance in a safe way and if they understand the hazards involved. Children shall not play with the appliance. Connect and operate the appliance only in accordance with the specifications on the rating plate. Only use indoors. Do not use the appliance if the power cord and/or appliance are damaged. Switch off the appliance and disconnect from supply before changing accessories or approaching parts that move in use. Always disconnect the appliance from the supply if it is left unattended and before assembling, disassembling or cleaning. Do not place the power cord over sharp edges or hot surfaces. To prevent injury, a damaged power cord must be replaced by the manufacturer or his customer service or a similarly qualified person. Only our customer service may repair the appliance.

## Safety instructions for this appliance

### **⚠ Risk of injury!**

### **⚠ Danger of electric shock!**

Do not use the hand blender with damp hands and do not operate it at no load. Do not immerse the appliance in liquid above the blender foot-base unit connection point. Never immerse the base unit in liquids and do not clean in the dishwasher. Caution when processing hot liquids. Liquids may splash during processing. Never place blender foot on hot surfaces or use in very hot food. Leave hot food to cool down to at least 80 °C before processing with the blender! Before using the hand blender in a cooking pot, take the pot off the hotplate. Operate the hand blender with original accessories only. Do not attach or remove tools until the appliance is at a standstill. Recommendation: Never switch on the appliance for longer as you need to processing the ingredients. The blender jug is not suitable for use in the microwave.

### **⚠ Risk of injury from sharp blades / rotating drive!**

Never grip the blade in the blender foot. Never clean the blades with bare hands. Use a brush.

---

## Contents

For your safety .....	7
Overview .....	9
Operation .....	9
Cleaning .....	10
Troubleshooting .....	10
Recipes and tips .....	10
Disposal .....	11
Guarantee .....	11

**Congratulations on the purchase of your new Bosch appliance. You can find further information about our products on our web page.**

### **Country of origin:**

Slovenia

### **Exclusive distributor:**

BSH Home Appliances (China) Co., Ltd.  
20/F,21/F, CN International Mansion,  
129 Zhongshan Road, Nanjing,  
Jiangsu Province, PRC.

### **Applicable standards:**

GB 4706.1-2005  
Safety of Household and Similar Electrical Appliances Part 1: General Requirements  
GB 4706.30-2008  
Safety of Household and Similar Electrical Appliances – Particular Requirements for Kitchen Machines

### **Careline:**

4008855888

### **Service E-mail:**

careline.china@bshg.com

### **Company website:**

www.bosch-home.cn

### **Technical specifications:**

Electrical connection (voltage – frequency)	220-240 V~ 50/60 Hz
Power rating MSMM7310CN MSMM8910CN	750 W 800 W
Dimensions (H x W x D)	402 x 63 x 63 mm



These operating instructions refer to various models. An overview of the different models can be found on the illustrated pages.

→ Fig. **Q**

---

## Overview

Please fold out the illustrated pages.

→ **Figure A:**

### 1 Base unit

### 2 Power cord

### 3 Speed control

Operating speed can be adjusted steplessly between the lowest (●) and highest (12) speed (only in conjunction with button 4a).

### 4 ON button

#### a Controllable speed

(with speed control 3)

#### b Turbo speed

The hand blender remains switched on as long as an **ON** button (a or b) is pressed. The turbo speed is used for the universal cutter (if included in delivery).

### 5 Release buttons

To remove the blender foot, simultaneously press both release buttons.

### 6 Blender foot

Attach the blender foot and lock into position.

### 7 Blender blade

### 8 Blender jug

Using the blender jug will prevent the ingredients from splashing.

### 9 Lid

Place the lid on the blender jug to keep in the processed food.

**For some models:**

### 10 Whisk with gear

### 11 Masher attachment with gear

### 12 Universal cutter XL with lid

### 13 Universal cutter L with lid and ice crush blade

### 14 Multifunction accessory with tools

### 15 Multifunction accessory with tools and dicer

If the universal cutter is not included with the hand blender, it can be ordered from customer service (order no. 753122). With the universal cutter use the appliance at full power to prepare honey spread (according to the recipe). You can find the recipe in the operating instructions of the universal cutter. Place the lid on the universal cutter to keep in the processed ingredients.

---

## Operation

The appliance is suitable for blending mayonnaise, sauces, mixed drinks, baby food, cooked fruit and vegetables. For puréeing soups.

Use the universal cutter for cutting/chopping raw food (onions, garlic, herbs)!

It is recommended to use the supplied blender jug. However, other suitable receptacles can also be used.

### Warning!

The bottom of the receptacle which you use must not have any bumps or recesses.

- Before using the appliance for the first time, clean all parts of it.

→ **Figure B:**

- Completely unwind the power cord.
- Place the blender foot on the base unit and lock into position.
- Insert the mains plug.
- Place food in the blender jug or another tall receptacle.

**Info:** The appliance works better if there is some liquid in the ingredients.

- Set the required speed with the speed control. → **Fig. B-5**

It is recommended to use a low speed setting for liquids, hot food and for mixing (e.g. muesli in yoghurt). The high speed settings are recommended for the processing of more solid foods.

- Firmly hold the hand blender and jug
- Switch on the hand blender by pressing the required **ON** button.

**Info:** When switching on the hand blender, hold it at a slight angle to prevent it from “sticking” to the bottom of the blender jug. The hand blender remains switched on as long as the **ON** button is pressed.

**Info:** To prevent the ingredients from splashing, do not press the **ON** button until the blender foot has been immersed in the ingredients. Always switch off the hand blender before taking it out of the processed food.

- Release the **ON** button after processing.

### After using the appliance

- Remove mains plug.
- Press the release buttons and remove the blender foot from the base unit.

---

## Cleaning

### Important information

The appliance requires no maintenance. Thorough cleaning protects the appliance from damage and keeps it functional.

#### **Danger of electric shock!**

Never immerse the base unit in liquids and do not clean in the dishwasher. Before cleaning the appliance, pull out the mains plug! Do not use a steam cleaner!

#### **Warning!**

Surfaces may be damaged. Do not use abrasive cleaning agents.

**Info:** If processing e.g. red cabbage or carrots, the plastic parts will become discoloured by a red film which can be removed with a few drops of cooking oil.

- Pull out the mains plug!
- Wipe the base unit with a damp cloth and then wipe dry.
- Blender jug and lid can be washed in the dishwasher.
- Clean the blender foot in the dishwasher or with a brush under running water.
- Dry the blender foot in an upright position (blender blade face up) so that any trapped water can run out.

**Note:** Appliances with spiral cable:  
Never wind the cable around the appliance!

---

## Troubleshooting

### Fault

Appliance switches off during use.

### Remedial action

The overload protection feature has been activated.

- Switch off the appliance and pull out the mains plug.
- Leave the appliance to cool down for approx. 1 hour in order to deactivate the overload protection device.
- Switch on appliance again.

If the fault cannot be eliminated, please contact customer service.

---

## Recipes and tips

### Mayonnaise

- 1 egg (egg yolk and egg white)
- 1 tbs. mustard
- 1 tbs. lemon juice or vinegar
- 200-250 ml oil
- Salt, pepper to taste

Ingredients must be at the same temperature!

- Put the ingredients in the jug.
- Place hand blender in the bottom of the jug and switch on (turbo speed) until the mixture emulsifies.
- Slowly raise the switched on blender as far as the upper edge of the mixture and lower again until the mayonnaise is ready.

**Tip:** According to this recipe you can also make mayonnaise with egg yolk only. However, use only half the amount of oil.

## Vegetable soup

- 300 g potatoes
- 200 g carrots
- 1 small stick of celery
- 2 tomatoes
- 1 onion
- 50 g butter
- 2 l water
- Salt, pepper to taste
- Skin and seed the tomatoes.
- Chop up cleaned and washed vegetables and sauté in the hot butter.
- Add water and salt.
- Leave to cook for a good 20-25 min.
- Take the pan off the cooker.
- Purée the soup in the pan with the blender.
- Season with salt and pepper.

## Crêpes dough

- 250 ml of milk
- 1 egg
- 100 g flour
- 25 g melted cooled butter
- Put all ingredients in the jug in the indicated sequence and blend to a smooth dough.

## Blended milk drinks

- 1 glass of milk
- 6 large strawberries or 10 raspberries or 1 banana (sliced)
- Put the ingredients in the jug and blend.
- Add sugar to taste.

**Tip:** For a milk shake add a scoop of ice cream or use very cold milk.

---

## Disposal



Dispose of packaging in an environmentally-friendly manner. This appliance is labelled in accordance with European Directive 2012/19/EU concerning used electrical and electronic appliances (waste electrical and electronic equipment – WEEE). The guideline determines the framework for the return and recycling of used appliances as applicable throughout the EU. Please ask your specialist retailer about current disposal facilities.

---

## Guarantee

The guarantee conditions for this appliance are as defined by our representative in the country in which it is sold. Details regarding these conditions can be obtained from the dealer from whom the appliance was purchased. The bill of sale or receipt must be produced when making any claim under the terms of this guarantee.

Changes reserved.

## Kundendienst – Customer Service

### DE Deutschland, Germany

BSH Hausgeräte Service GmbH  
Zentralwerkstatt für kleine  
Hausgeräte  
Trautskirchener Strasse 6-8  
90431 Nürnberg  
Online Auftragsstatus, Filterbeutel-  
Konfigurator und viele weitere  
Infos unter:  
[www.bosch-home.com](http://www.bosch-home.com)

Reparaturservice, Ersatzteile &  
Zubehör, Produkt-Informationen:  
Tel.: 0911 70 440 040  
mailto:cp-servicecenter@  
bshg.com  
Wir sind an 365 Tagen rund um die Uhr  
erreichbar.

### AE United Arab Emirates,

الإمارات العربية المتحدة

BSH Home Appliances FZE  
Round About 13,  
Plot Nr MO-0532A  
Jebel Ali Free Zone – Dubai  
Tel.: 04 881 4401  
mailto:service.uae@bshg.com  
[www.bosch-home.com/ae](http://www.bosch-home.com/ae)

### AL Republika e Shqiperise, Albania

AERTECH SH.P.K.  
Rruga Qemal Stafa  
Pallati i ri perball Prokuroris se  
Pergjithshme  
Hyrja C Kati 10  
Tirana  
Tel.: 066 206 47 94  
mailto:g.volina@aertech.al

### AT Österreich, Austria

BSH Hausgeräte  
Gesellschaft mbH  
Werkskundendienst  
für Hausgeräte  
Quellenstrasse 2  
1100 Wien  
Tel.: 0810 550 511\*  
Fax: 01 605 75 51 212  
mailto:vie-stoerungsannahme@  
bshg.com  
Hotline für Espresso-Geräte:  
Tel.: 0810 700 400\*  
[www.bosch-home.at](http://www.bosch-home.at)

\*innerhalb Österreichs zum Regionaltarif

### AU Australia

BSH Home Appliances Pty. Ltd.  
7-9 Arco Lane  
HEATHERTON, Victoria 3202  
Tel.: 1300 368 339  
mailto:bshau-as@bshg.com  
[www.bosch-home.com.au](http://www.bosch-home.com.au)

### BA Bosna i Hercegovina, Bosnia-Herzegovina

"HIGH" d.o.o.  
Gradačacka 29b  
71000 Sarajevo  
Info-Line: 061 100 905  
Fax: 033 213 513  
mailto:delicnanda@hotmail.com

### BE Belgique, België, Belgium

BSH Home Appliances S.A.  
Avenue du Laerbeek 74  
Laarbeeklaan 74  
1090 Bruxelles – Brussel  
Tel.: 070 222 141  
Fax: 024 757 291  
mailto:bru-repairs@bshg.com  
[www.bosch-home.be](http://www.bosch-home.be)

### BG Bulgaria

BSH Domakinski Uredi  
Bulgaria EOOD  
115K Tsarigradsko Chausse Blvd.  
European Trade Center Building,  
5th floor  
1784 Sofia  
Tel.: 02 892 90 47  
Fax: 02 878 79 72  
mailto:informacia.servis-bg@  
bshg.com  
[www.bosch.home.bg](http://www.bosch.home.bg)

### BH Bahrain, مملكة البحرين

Khalaifat Est.  
P.O. Box 5111  
Manama  
Tel.: 01 7400 553  
mailto:service@khalaifat.com

### BY Belarus, Беларусь

ООО "БСХ Бытовая техника"  
тел.: 495 737 2961  
mailto:mok-kdhl@bshg.com

### CH Schweiz, Suisse, Svizzera, Switzerland

BSH Hausgeräte AG  
Werkskundendienst für  
Hausgeräte  
Fahrweidstrasse 80  
8954 Geroldswil  
mailto:ch-info.hausgeraete@  
bshg.com  
Service Tel.: 0848 840 040  
Service Fax: 0848 840 041  
mailto:ch-reparatur@bshg.com  
Ersatzteile Tel.: 0848 880 080  
Ersatzteile Fax: 0848 880 081  
mailto:ch-ersatzteil@bshg.com  
[www.bosch-home.com](http://www.bosch-home.com)

### CY Cyprus, Κύπρος

BSH Ikiakes Syskeves-Service  
39, Arh. Makaanouri III Str.  
2407 Egomi/Nikosia (Lefkosia)  
Tel.: 7777 8007  
Fax: 022 658 128  
mailto:bsh.service.cyprus@  
cytanet.com.cy

### CZ Česká Republika, Czech Republic

BSH domácí spotřebiče s.r.o.  
Firemní servis domácích  
spotřebičů  
Pekařská 10b  
155 00 Praha 5  
Tel.: 0251 095 546  
Fax: 0251 095 549  
[www.bosch-home.com/cz](http://www.bosch-home.com/cz)

### DK Danmark, Denmark

BSH Hvidevarer A/S  
Telegrafvej 4  
2750 Ballerup  
Tel.: 44 89 89 85  
Fax: 44 89 89 86  
mailto:BSH-Service.dk@  
BSHG.com  
[www.bosch-home.dk](http://www.bosch-home.dk)

### EE Eesti, Estonia

SIMSON OÜ  
Raua 55  
10152 Tallinn  
Tel.: 0627 8730  
Fax: 0627 8733  
mailto:teenindus@simson.ee

### ES España, Spain

BSH Electrodomésticos  
España S.A.  
Servicio Oficial del Fabricante  
Parque Empresarial PLAZA,  
C/ Manfredonia, 6  
50197 Zaragoza  
Tel.: 902 245 255 o 976 305 713  
Fax: 976 578 425  
mailto:CAU-Bosch@bshg.com  
[www.bosch-home.es](http://www.bosch-home.es)

### FI Suomi, Finland

BSH Kodinkoneet Oy  
Itälähdenkatu 18 A, PL 123  
00201 Helsinki  
Tel.: 0207 510 700  
Fax: 0207 510 780  
mailto:Bosch-Service-  
FI@bshg.com  
[www.bosch-home.fi](http://www.bosch-home.fi)  
Lankapuhelimesta 8,28 snt/puhelu  
+ 7 snt/min (alv 24%)  
Matkapuhelimesta 8,28 snt/puhelu  
+ 17 snt/min (alv 24%)

**FR France**

BSH Electroménager S.A.S.  
50 rue Ardoin – BP 47  
93401 SAINT-OUEN cedex  
Service interventions à domicile:  
01 40 10 11 00

Service Consommateurs:  
0 892 698 010 (0,34 € TTC/mn)  
mailto:soa-bosch-conso@bshg.com  
Service Pièces Détachées et  
Accessoires:  
0 892 698 009 (0,34 € TTC/mn)  
www.bosch-home.fr

**GB Great Britain**

BSH Home Appliances Ltd.  
Grand Union House  
Old Wolverton Road  
Wolverton  
Milton Keynes MK12 5PT  
To arrange an engineer visit, to  
order spare parts and accessories  
or for product advice please visit  
www.bosch-home.co.uk  
or call  
Tel.: 0344 892 8979\*

\*Calls are charged at the basic rate, please  
check with your telephone service provider  
for exact charges

**GR Greece, Ελλάδα**

BSH Ikiakes Siskeves A.B.E.  
Central Branch Service  
17 km E.O. Athinon-Lamias &  
Potamou 20  
14564 Kifisia  
Πανελλήνιο τηλέφωνο: 181 82  
(Αστική χρέωση)  
www.bosch-home.gr

**HK Hong Kong, 香港**

BSH Home Appliances Limited  
Unit 1 & 2, 3rd Floor  
North Block, Skyway House  
3 Sham Mong Road  
Tai Kok Tsui, Kowloon  
Hong Kong  
Tel.: 2565 6151  
Fax: 2565 6681  
mailto:bosch.hk.service@bshg.com  
www.bosch-home.cn

**HR Hrvatska, Croatia**

BSH kućni uređaji d.o.o.  
Kneza Branimira 22  
10000 Zagreb  
Tel.: 01 640 36 09  
Fax: 01 640 36 03  
mailto:informacije.servis-hr@  
bshg.com  
www.bosch-home.com/hr

**HU Magyarország, Hungary**

BSH Háztartási Készülék  
Kereskedelmi Kft.  
Háztartási gépek márkaszervize  
Királyhágó tér 8-9  
1126 Budapest  
Hibabejelentés  
Tel.: +361 489 5461  
Fax: +361 201 8786  
mailto:hibabejelentes@bsh.hu  
Alkatrészrendelés  
Tel.: +361 489 5463  
Fax: +361 201 8786  
mailto:alkatrészrendeles@bsh.hu  
www.bosch-home.com/hu

**IE Republic of Ireland**

BSH Home Appliances Ltd.  
Unit F4, Ballymount Drive  
Ballymount Industrial Estate  
Walkinstown  
Dublin 12  
Service Requests,  
Spares and Accessories  
Tel.: 01450 2655\*  
Fax: 01450 2520  
www.bosch-home.co.uk  
\*0.03 € per minute at peak.  
Off peak 0.0088 € per minute

**IL Israel, ישראל**

C/S/B/ Home Appliance Ltd.  
1, Hamasger St.  
North Industrial Park  
Lod, 7129801  
Tel.: 08 9777 222  
Fax: 08 9777 245  
mailto:csb-serv@csb-ltd.co.il  
www.bosch-home.co.il

**IN India, Bhārat, भारत**

BSH Household Appliances  
Mfg. Pvt. Ltd.  
Arena House, 2nd Floor, Main Bldg,  
Plot No. 103, Road No. 12, MIDC,  
Andheri East  
Mumbai 400 093  
Toll Free 1800 266 1880  
www.bosch-home.com/in

**IS Iceland**

Smith & Norland hf.  
Noatuni 4  
105 Reykjavik  
Tel.: 0520 3000  
Fax: 0520 3101  
www.sminor.is  
**IT Italia, Italy**  
BSH Elettrodomestici S.p.A.  
Via. M. Nizzoli 1  
20147 Milano (MI)  
Numero verde 800 829 120  
mailto:info@bosch-elettrodomestici.it  
www.bosch-home.com/it

**KZ Kazakhstan, Қазақстан**

IP Turebekov Yerzhan  
Nurmanovich  
Jangeldina str. 15  
Shimkent 160018  
Tel.: 0252 31 00 06  
mailto:evrika\_kz@mail.ru

**LB Lebanon, لبنان**

Tehehi, Hana & Co.  
Boulevard Dora 4043 Beyrouth  
P.O. Box 90449  
Jdeideh 1202 2040  
Tel.: 01 255 211  
mailto:Info@Tehehi-Hana.com

**LT Lietuva, Lithuania**

Senuku prekybos centras UAB  
Jonavos g. 62  
44192 Kaunas  
Tel.: 0372 12146  
Fax: 0372 12165  
www.senukai.lt

**LU Luxembourg**

BSH électroménagers S.A.  
13-15 ZI Bredeweues  
1259 Senningerberg  
Tel.: 26349 300  
Fax: 26349 315  
mailto:lux-service.electromenager@  
bshg.com  
www.bosch-home.com/lu

**LV Latvija, Latvia**

General Serviss Limited  
Bullu street 70c  
1067 Riga  
Tel.: 07 42 41 37  
mailto:bt@olimpeks.lv  
Elkor Serviss  
Brivibas gatve 201  
1039 Riga  
Tel.: 067 0705 20; -36  
mailto:domoservice@elkor.lv  
www.servisacentrs.lv

**MD Moldova**

S.R.L. "Rialto-Studio"  
ул. Щуцева 98  
2012 Кишинев  
тел./факс: 022 23 81 80  
mailto:bosch-md@mail.ru

**ME Crna Gora, Montenegro**

Elektronika komerc  
Ul. Slobode 17  
84000 Bijelo Polje  
Tel./Fax: 050 432 575  
Mobil: 069 324 812  
mailto:ekobosch.servis@  
t-com.me

**MK Macedonia, Македонија**

GORENEC  
Jane Sandanski 69 lok.3  
1000 Skopje  
Tel.: 022 454 600  
Mobil: 070 697 463  
mailto:gore nec@yahoo.com

**MT Malta**

Oxford House Ltd.  
Notabile Road  
Mriehel BKR 14  
Tel.: 021 442 334  
Fax: 021 488 656  
www.oxfordhouse.com.mt

**MV Raajjeyge Jumhooriyyaa, Maldives**

Lintel Investments  
Ma. Maadheli, Majeedhee Magu  
Malé  
Tel.: 0331 0742  
mailto:mohamed.zuhuree@  
intel.com.mv

**NL Nederland, Netherlands**

BSH Huishoudapparaten B.V.  
Taurusavenue 36  
2132 LS Hoofddorp  
Storingsmelding:  
Tel.: 088 424 4010  
Fax: 088 424 4845  
mailto:bosch-contactcenter@  
bshg.com

Onderdelenverkoop:  
Tel.: 088 424 4010  
Fax: 088 424 4801  
mailto:bosch-onderdelen@bshg.com  
www.bosch-home.nl

**NO Norge, Norway**

BSH Husholdningsapparater A/S  
Grensevingen 9  
0661 Oslo  
Tel.: 22 66 06 00  
Fax: 22 66 05 50  
mailto:Bosch-Service-NO@  
bshg.com  
www.bosch-home.no

**NZ New Zealand**

BSH Home Appliances Ltd.  
Unit F 2, 4 Orbit Drive  
Mairangi Bay  
Auckland 0632  
Tel.: 09 477 0492  
Fax: 09 477 2647  
mailto:bshnz-cs@bshg.com  
www.bosch-home.co.nz

**PL Polska, Poland**

BSH Sprzęt Gospodarstwa  
Domowego sp. z o.o.  
Al. Jerozolimskie 183  
02-222 Warszawa  
Centrala Serwisu  
Tel.: 801 191 534  
Fax: 022 572 7709  
mailto:Serwis.Fabryczny@bshg.com  
www.bosch-home.pl

**PT Portugal**

BSHP Electrodomésticos Lda.  
Rua Alto do Montijo, n° 15  
2790-012 Carnaxide  
Tel.: 214 250 730  
Fax: 214 250 701  
mailto:bosch.electrodomesticos.pt@  
bshg.com  
www.bosch-home.pt

**RO România, Romania**

BSH Electrocasnice srl.  
Sos. Bucuresti-Ploiesti,  
nr. 19-21, sect.1  
13682 Bucuresti  
Tel.: 021 203 9748  
Fax: 021 203 9733  
mailto:service.romania@bshg.com  
www.bosch-home.ro

**RU Russia, Россия**

ООО "БСХ Бытовая техника"  
Сервис от производителя  
Малая Калужская 19/1  
119071 Москва  
тел.: 495 737 2961  
mailto:mok-kdhl@bshg.com  
www.bosch-home.com

**SA Kingdom Saudi Arabia,**

المملكة العربية السعودية  
Abdul Latif Jameel Electronics  
and Airconditioning Co. Ltd.  
BOSCH Service centre,  
Kilo 5 Old Makkah Road  
(Next to Toyota), Jamiah Dist.  
P.O.Box 7997  
Jeddah 21472  
Tel.: 800 244 0043  
mailto:kunnumalsp@alj.com  
www.aljelectronics.com.sa

**SE Sverige, Sweden**

BSH Hushållsapparater AB  
Landsvägen 32  
169 29 Solna  
Tel.: 0771 11 22 77 local rate  
mailto:Bosch-Service-SE@  
bshg.com  
www.bosch-home.se

**SG Singapore, 新加坡**

BSH Home Appliances Pte. Ltd.  
TECHPLACE I and  
Mo Kio Avenue 10  
Block 4012 #01-01  
569628 Singapore  
Tel.: 6751 5000  
Fax: 6751 5005  
mailto:boschsgp.service@bshg.com  
www.bosch-home.com.sg

**SI Slovenija, Slovenia**

BSH Hišni aparati d.o.o.  
Litostrjoka 48  
1000 Ljubljana  
Tel.: 01 583 07 01  
Fax: 01 583 08 89  
mailto:informacije.servis@  
bshg.com  
www.bosch-home.com/si

**SK Slovensko, Slovakia**

BSH domácí spotřebiče s.r.o.  
Organizačná zložka Bratislava  
Galvaniho 17/C  
821 04 Bratislava  
Tel.: 02 44 45 20 41  
mailto:opravy@bshg.com  
www.bosch-home.com/sk

**TR Türkiye, Turkey**

BSH Ev Aletleri Sanayi  
ve Ticaret A.S.  
Fatih Sultan Mehmet Mahallesi  
Balkan Caddesi No: 51  
34771 Ümraniye, İstanbul  
Tel.: 0 216 444 6333\*  
Fax: 0 216 528 9188  
mailto:careline.turkey@bshg.com  
www.bosch-home.com/tr  
\*Çağrı merkezini sabit hatlardan aramanın  
bedelli şehir içi ücretlendirme, Cep  
telefonlarından ise kullanılan tarifeye göre  
değişkenlik göstermektedir

**TW Taiwan, 台灣**

BSH Home Appliances Private Limited  
台北市內湖區洲子街80號11樓  
11F., No.80, Zhouzi St., Neihu Dist.  
Taipei City 11493  
Tel.: 0800 368 888  
Fax: 02 2627 9788  
mailto:bshztzn-service@bshg.com  
我們期盼您不斷的鼓勵與指導,  
任何諮詢或服務需求,  
歡迎洽詢客服專線  
www.bosch-home.com.tw

**UA Ukraine, Україна**

ТОВ "БСХ Побутова Техніка"  
тел.: 044 490 2095  
mailto:bsh-service.ua@bshg.com  
www.bosch-home.com.ua

**XK Kosovo**

NTP GAMA  
Rruga Mag Prishtine-Ferizaj  
70000 Ferizaj  
Tel.: 0290 321 434  
mailto:a\_service@  
gama-electronics.com

**XS Srbija, Serbia**

BSH Kućni aparati d.o.o.  
Milutina Milankovića 11<sup>a</sup>  
11070 Novi Beograd  
Tel.: 011 205 23 97  
Fax: 011 205 23 89  
mailto:informacije.servis-sr@  
bshg.com  
www.bosch-home.rs

**ZA South Africa**

BSH Home Appliances (Pty) Ltd.  
15th Road Randjespark  
Private Bag X36, Randjespark  
1685 Midrand – Johannesburg  
Tel.: 086 002 6724  
Fax: 086 617 1780  
mailto:applianceserviceza@  
bshg.com  
www.bosch-home.com/za



**Robert Bosch Hausgeräte GmbH**  
**Carl-Wery-Straße 34**  
**81739 München, GERMANY**  
**[www.bosch-home.com](http://www.bosch-home.com)**







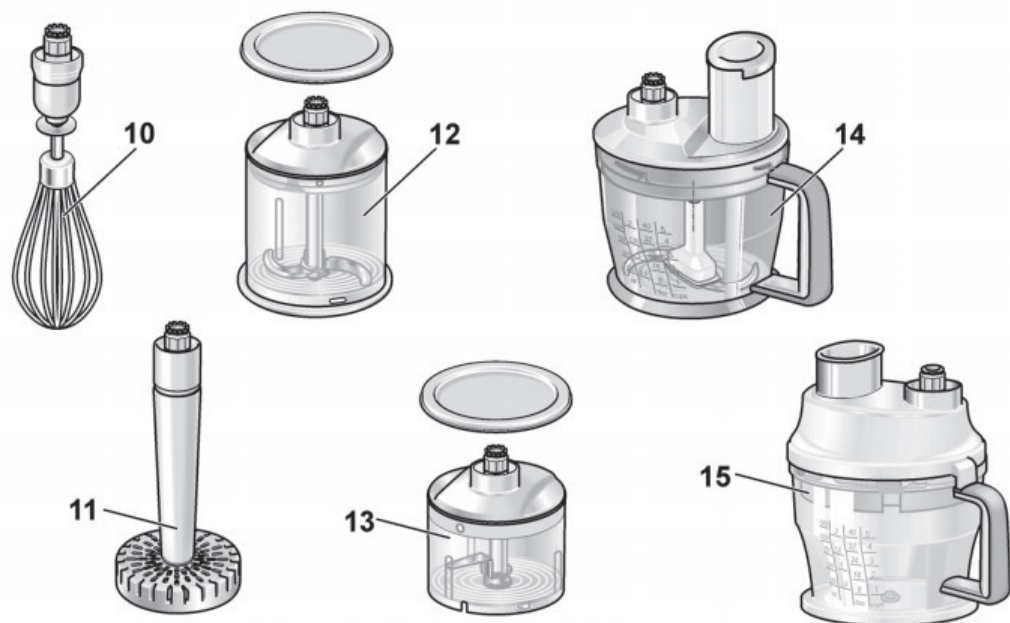
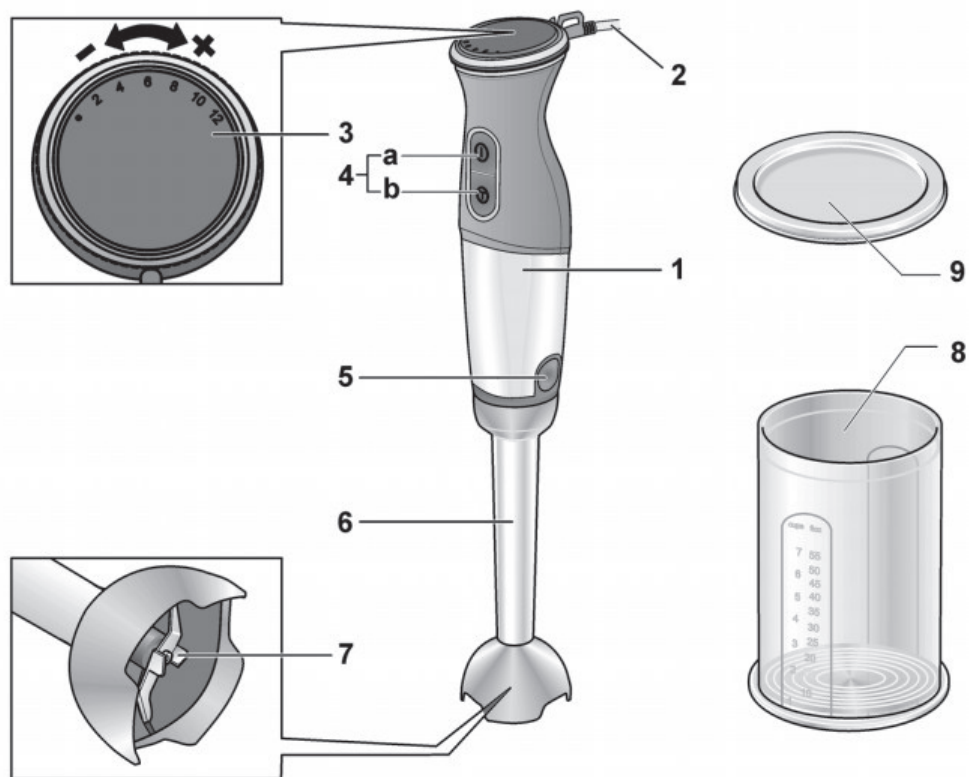

**8001020896**

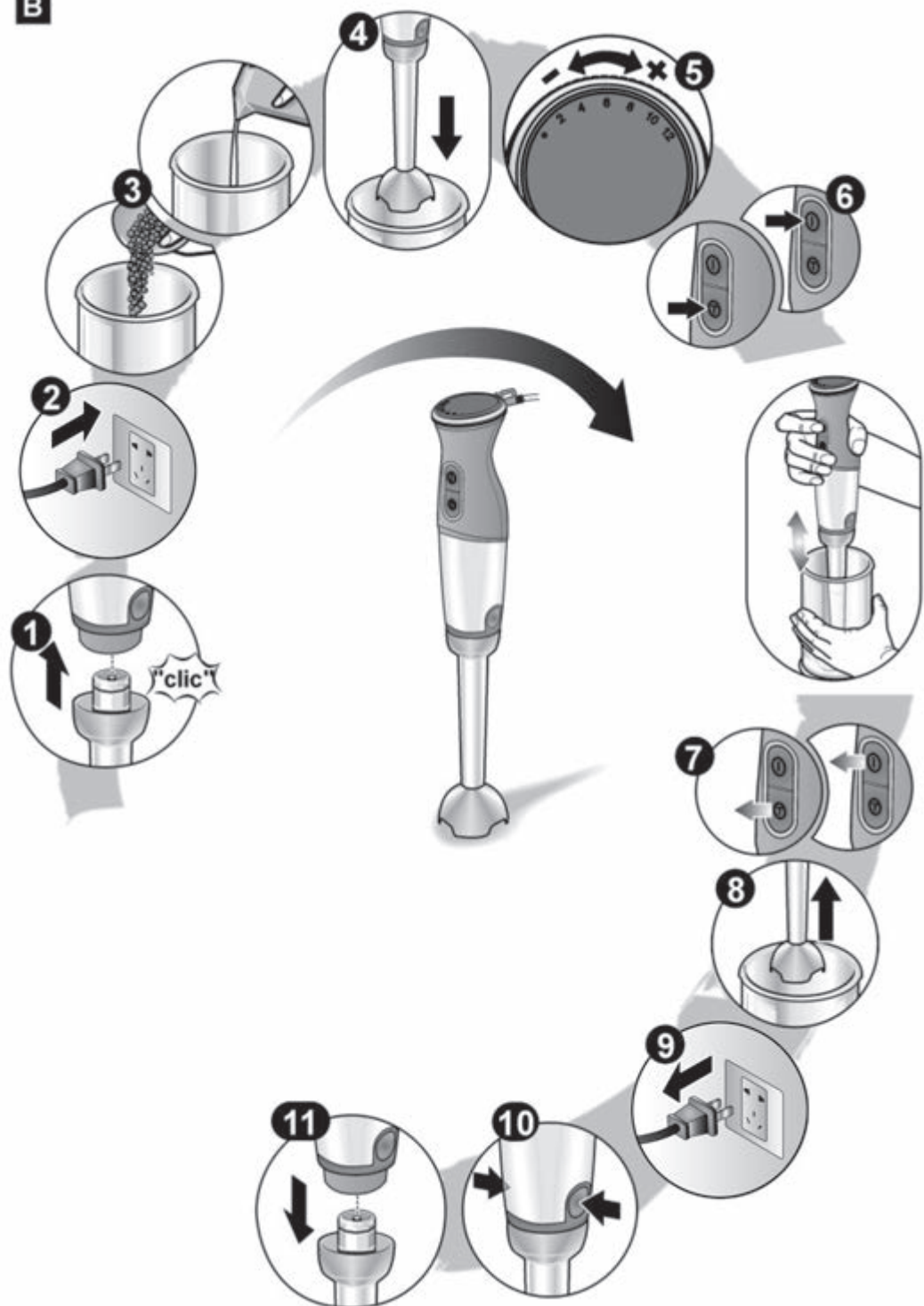



950817



**A**

**B**

<b>C</b>						
MSMM7310CN	X	X	X			
	X	X	X		X	

					
MSMM7310CN					
MSMM8910CN			X		