

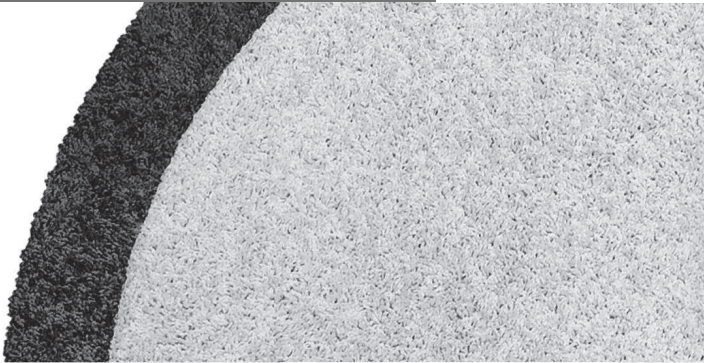

Register your new Bosch now:  
[www.bosch-home.com/welcome](http://www.bosch-home.com/welcome)



**BGS4...**  
Runn'n



**BOSCH**



## Table of content

<b>Safety information</b> .....	<b>5</b>
Intended use .....	5
Spare parts, accessories, dust bags .....	5
Safety information .....	6
Proper use .....	6
<b>Notes on the energy label</b> .....	<b>9</b>
<b>Your vacuum cleaner</b> .....	<b>10</b>
<b>Replacement parts and special accessories</b> .....	<b>12</b>
<b>Initial use</b> .....	<b>13</b>
Connecting the flexible hose .....	13
Putting the handle and the telescopic tube together .....	13
Inserting the telescopic tube into the floor nozzle .....	13
Adjusting the telescopic tube .....	14
Connecting the appliance .....	14
Switch on /off .....	14
Controlling the suction level .....	15
<b>Vacuuming</b> .....	<b>16</b>
Set the adjustable floor nozzle .....	16
Vacuuming with accessories .....	17
Parking aid .....	17
Vacuuming stairs .....	18
<b>After vacuuming</b> .....	<b>18</b>
Disconnecting the appliance .....	18
Sliding the telescopic tube .....	19
Storing and transporting .....	19
<b>Disassembly</b> .....	<b>20</b>
Removing the flexible hose .....	20
Removing the telescope tube .....	20

## Table of content

Removing the floor nozzle . . . . .	.20
<b>Cleaning and care . . . . .</b>	<b>.21</b>
Emptying the dust container . . . . .	.21
Removing the dust container . . . . .	.21
Maintaining the dust separation system . . . . .	.23
In normal operation . . . . .	.23
Cleaning the foam filter . . . . .	.23
In the event of a fault . . . . .	.25
Removing a blockage from the dust separation unit . . . . .	.25
<b>Exhaust filter care . . . . .</b>	<b>.26</b>
Cleaning a washable HEPA filter . . . . .	.26
Replacing the HEPA-filter . . . . .	.28
Cleaning the micro filter . . . . .	.29
<b>Cleaning instructions . . . . .</b>	<b>.31</b>
<b>Disposal . . . . .</b>	<b>.32</b>
<b>Customer service . . . . .</b>	<b>.33</b>
<b>Conditions of guarantee . . . . .</b>	<b>.34</b>

## Safety information

Please keep this instruction manual. When passing the vacuum cleaner on to a third party, please also pass on this instruction manual.

### **Intended use**

This vacuum cleaner is intended for domestic use and not for commercial use. Only use this vacuum cleaner in accordance with the instructions in this instruction manual.

**In order to prevent injuries and damage, the vacuum cleaner must not be used for:**

- Vacuum-cleaning persons or animals
- Vacuuming up:
  - hazardous, sharp-edged, hot or glowing substances.
  - damp or liquid substances.
  - highly flammable or explosive substances and gases.
  - ash, soot from tiled stoves and central heating systems.
  - toner dust from printers and copiers.

### **Spare parts, accessories, dust bags**

Our original spare parts, original (special) accessories and original dust bags are designed to work with the features and requirements of our vacuum cleaners. We therefore recommend that you only use our original spare parts, original (special) accessories and original dust bags. This will ensure that your vacuum cleaner has a long service life and that the quality of its cleaning performance will remain consistently high throughout.

### **! Please note**

Using unsuitable or inferior-quality spare parts, (special) accessories and dust bags can damage your vacuum cleaner. Damage caused by the use of such products is not covered by our guarantee.

### Safety information

This vacuum cleaner complies with the recognised rules of technology and the relevant safety regulations.

- The appliance may be used by children over the age of 8 years and by persons with reduced physical, sensory or mental capacity or by persons with a lack of experience or knowledge if they are supervised or have been instructed on the safe use of the appliance and they have understood the potential dangers of using the appliance.
- Children must never play with the appliance.
- Cleaning and user maintenance must never be carried out by children without supervision.
- Plastic bags and films must be kept out of the reach of children before disposal. => Risk of suffocation.

### Proper use

- Only connect and use the vacuum cleaner in accordance with the specifications on the rating plate.
- Never vacuum without the dust bag or dust container, motor protection or exhaust filter.  
=> This may damage the vacuum cleaner.
- Always keep the vacuum cleaner away from your head when using nozzles and tubes.  
=> This could cause injury!
- When vacuuming stairs, the appliance must always be positioned below the user.
- Do not use the power cord or the hose to carry or transport the vacuum cleaner.
- For safety reasons, if this appliance's mains power cable becomes damaged, it must be replaced by the manufacturer, their after-sales service department or a similarly qualified person.

## Safety information

- If using the appliance for longer than 30 minutes, pull out the power cord completely.
- When disconnecting the appliance from the mains, pull on the plug itself to remove it; do not pull on the power cord.
- Do not pull the power cord over sharp edges or allow it to become trapped.
- When the cable is being automatically rewound, ensure that the mains plug is not thrown towards persons, body parts, animals or objects.  
=> Use the mains plug to guide the power cord.
- Pull out the mains plug before carrying out any work on the vacuum cleaner.
- Do not operate the vacuum cleaner if it is damaged. Unplug the appliance from the mains if a fault is detected.
- For safety reasons, only authorised after-sales service personnel are permitted to carry out repairs and fit replacement parts to the vacuum cleaner.
- Protect the vacuum cleaner from the weather, moisture and sources of heat.
- Do not pour flammable substances or substances containing alcohol onto the filters (dust bag, motor protection filter, exhaust filter, etc.).
- The vacuum cleaner is not suitable for use on construction sites.  
=> Vacuuming up building rubble could damage the appliance.
- When not in use, switch off the appliance and pull out the mains plug.
- At the end of its life, the appliance should immediately be rendered unusable, then disposed of in an appropriate manner.

## Safety information

### **! Please note**

The mains socket must be protected by at least a 16 amp circuit breaker.

If a circuit breaker is tripped when you switch on the vacuum cleaner, this may be because other electrical appliances which have a high current draw are connected to the same power circuit.

To prevent the circuit breaker from tripping, select the lowest power setting before switching the appliance on, and increase the power only once it is running.



## Notes on the energy label

This vacuum cleaner is a general purpose vacuum cleaner. To achieve the declared energy efficiency and cleaning performance class on carpet, please use the interchangeable universal nozzle.

To achieve the declared energy efficiency and cleaning performance class on hard floor with nooks and crannies, please use the hard floor nozzle provided.

**These calculations are based on the delegated regulation (EU) no. 665/2013 established by the commission on 3rd May 2013 as a supplement to Directive 2010/30/EU.**

**All of the procedures in these instructions that are not described in more precise detail were listed based on DIN EN 60312-1:2014.**

# Your vacuum cleaner

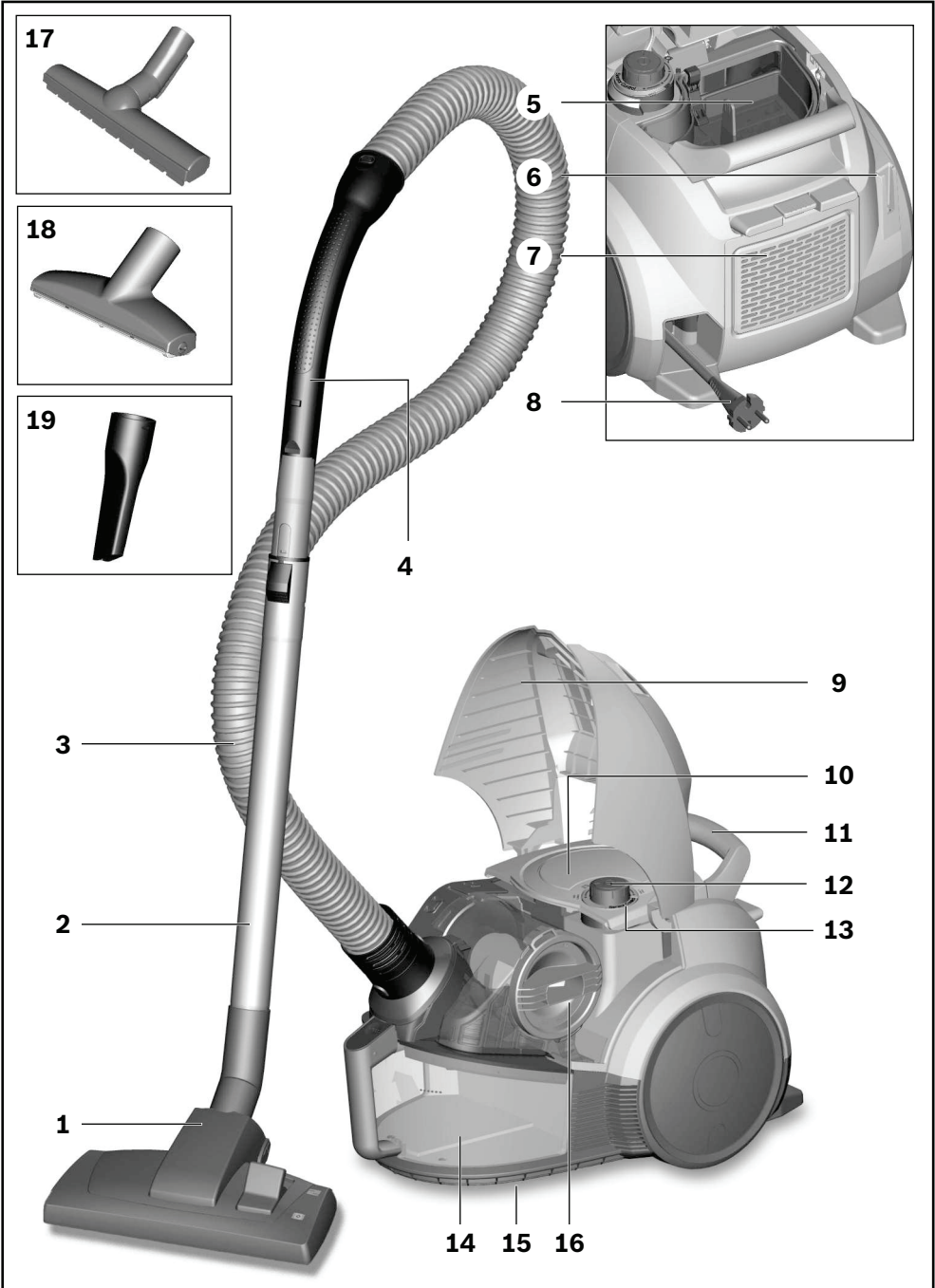

## Your vacuum cleaner

- ① Adjustable floor tool
- ② Telescopic tube with sliding switch but without accessory connection
- ③ Flexible hose
- ④ Handle
- ⑤ Foam filter
- ⑥ Parking aid on the back of the appliance
- ⑦ Exhaust filter lid
- ⑧ Power cord
- ⑨ Appliance lid
- ⑩ Foam filter lid
- ⑪ Carrying handle
- ⑫ On/Off button with electronic suction regulator
- ⑬ Filter control display (Sensor Control)
- ⑭ Dust container with carrying handle
- ⑮ Storage aid on the underside of the appliance
- ⑯ Fluff filter cover
- ⑰ Hard-floor tool
- ⑱ Professional upholstery nozzle
- ⑲ Crevice nozzle

## Replacement parts and special accessories

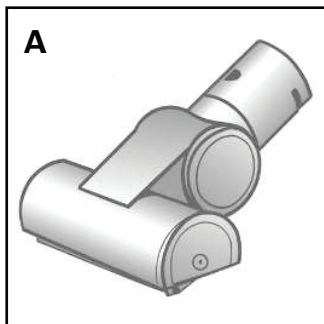

### **A TURBO-UNIVERSAL® brush for upholstery** BBZ42TB

All-in-one brushing and vacuuming of upholstered furniture, mattresses, car seats, etc. Especially suitable for picking up pet hair. The brush roller is driven by the suction air flow through the vacuum cleaner.

No separate electrical connection is needed.

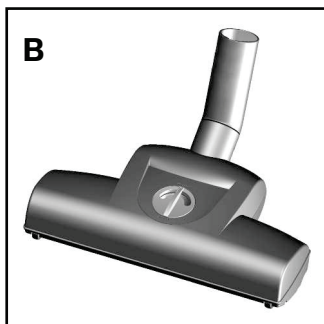

### **B TURBO-UNIVERSAL® brush for floors** BBZ102TBB

All-in-one brushing and vacuuming of rugs and carpets as well as all hard floor coverings.

Especially suitable for picking up pet hair. The brush roller is driven by the suction air flow of the vacuum cleaner. No separate electric connection is needed.

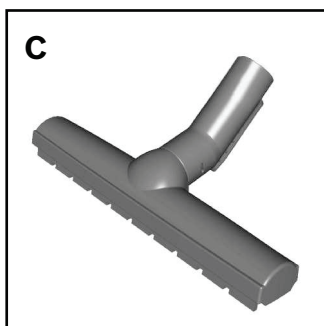

### **C Hard-floor nozzle** BBZ123HD

For vacuuming hard floors (parquet, tiles, terracotta, etc.)

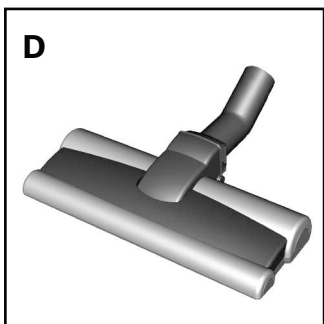

### **D Hard-floor nozzle** BBZ124HD

With 2 rotating brush rollers  
For caring for expensive hard floors and for the improved collection of coarse dirt.

## Initial use

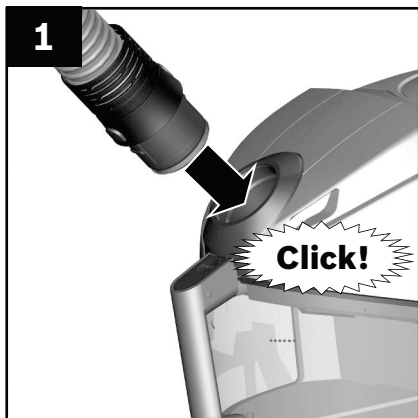

### Connecting the flexible hose

Figure 1

- Push the flexible hose adapter into the air intake opening on the appliance and lock it in place. You will hear an audible 'click'.

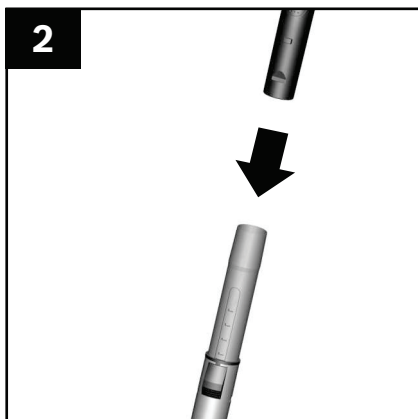

### Putting the handle and the telescopic tube together

Figure 2

- Push the handle into the telescopic tube.

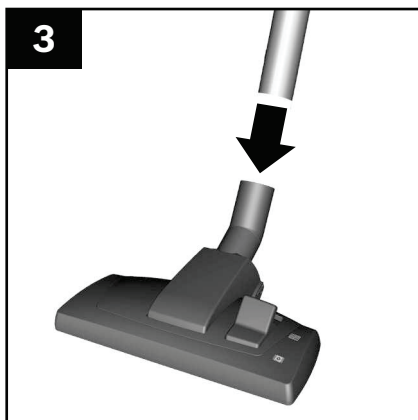

### Inserting the telescopic tube into the floor nozzle

Figure 3

- Push the telescopic tube into the connecting piece of the floor nozzle.

## Initial use

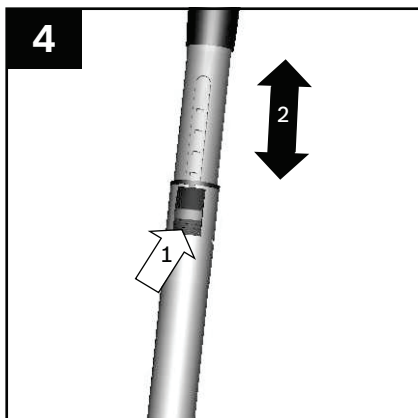

### Adjusting the telescopic tube

#### Figure

- Unlock the telescopic tube by moving the sliding switch in the direction of the arrow and adjust it to the desired length. The slide resistance on carpet is at its lowest when the telescopic tube has been completely pulled out.

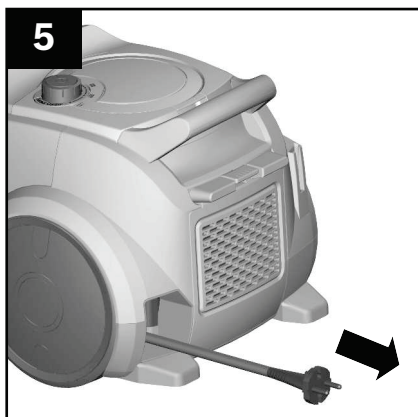

### Connecting the appliance

#### Figure 5

- Holding the power cord by the plug, pull out to the required length and insert the plug into the mains socket.

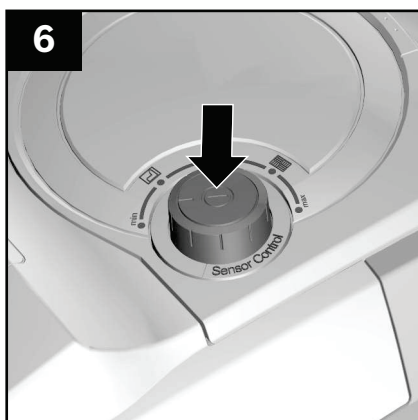

### Switch on /off

#### Figure 6

- To switch the vacuum cleaner on or off, press the ON/OFF button.

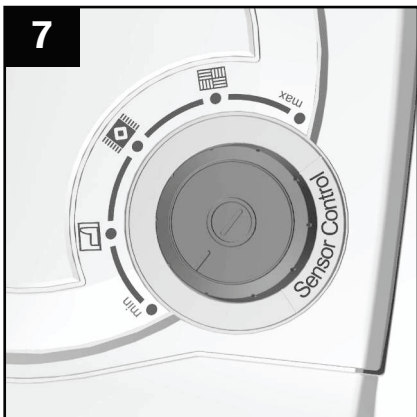

7



### Controlling the suction level

#### Figure 7

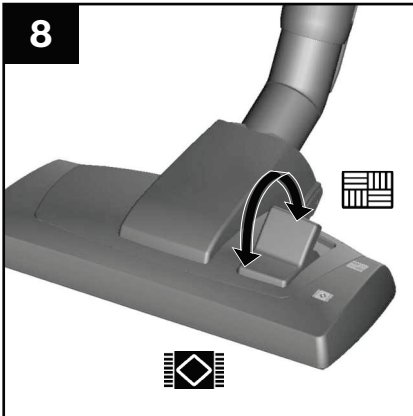

Turn the control knob to infinitely adjust the suction level to the level required.

- Low power range =>   
For vacuuming delicate materials, e.g. delicate upholstery, curtains, etc.
- Medium power range =>   
For daily vacuuming of lightly soiled floors.
- High power range =>   
For vacuuming durable floor coverings, hard floors and heavily soiled surfaces.



## Set the adjustable floor nozzle

**Figure 8**

- Rugs and carpets => 
- Hard floors/parquet => 

If you are vacuuming up large particles, make sure that you vacuum them up successively and carefully to ensure that the vacuum channel of the floor nozzle does not become blocked.

If necessary, you should raise the nozzle in order to better vacuum up the dirt particles.

### **!Caution**

Floor nozzles are subject to a certain amount of wear, depending on the type of hard floors you have (e.g. rough, rustic tiles). You must therefore check the underside of the floor nozzle at regular intervals. Worn undersides of floor nozzles may have sharp edges that can damage sensitive hard floors, such as parquet or linoleum. The manufacturer does not accept any responsibility for damage caused by worn floor nozzles.



9

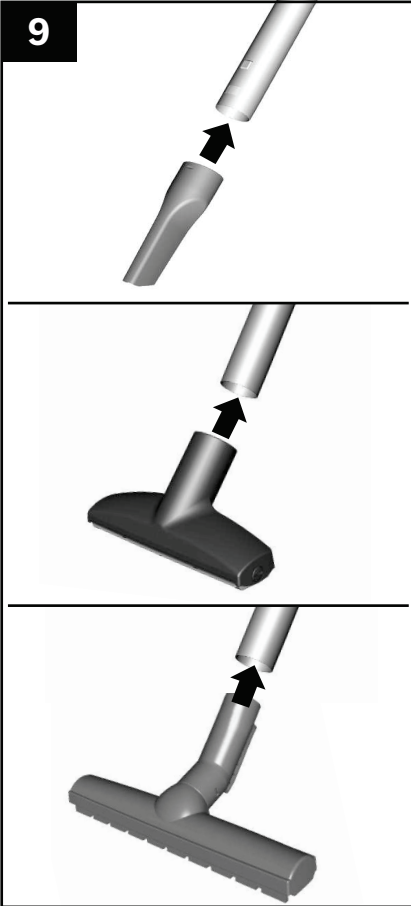

## Vacuuming with accessories

Attach the nozzles to the suction pipe or handle as required:

### Figure 9

- Crevice nozzle for vacuuming crevices and corners, etc.
- Upholstery nozzle for vacuuming upholstered furniture, curtains, etc.
- Floor tool for delicate hard floors, e.g. parquet

### Turbo Brush

If your appliance is equipped with a turbo brush, refer to the accompanying instruction manual for instructions on its use and maintenance.

10

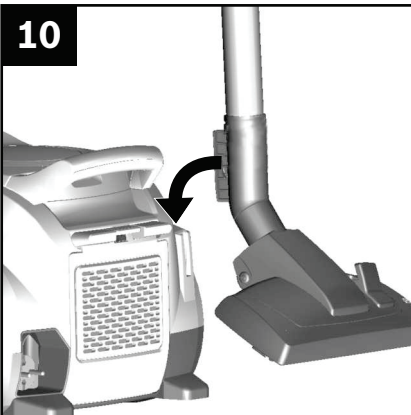

## Parking aid

### Figure 10

You can use the parking aid on the back of the vacuum cleaner if you want to stop vacuuming for a short time.

- After switching off the appliance, slide the hook on the floor nozzle into the parking aid.

## Vacuuming

11

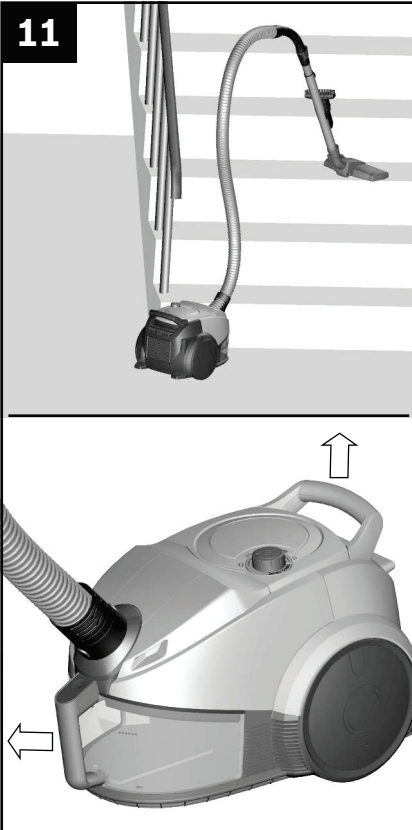

### Vacuuming stairs

#### Figure 11

When vacuuming stairs, the appliance must be positioned at the bottom of the stairs.

If it does not reach far enough, the appliance can also be carried using the carrying handle or the handle on the dust container.

## After vacuuming

12

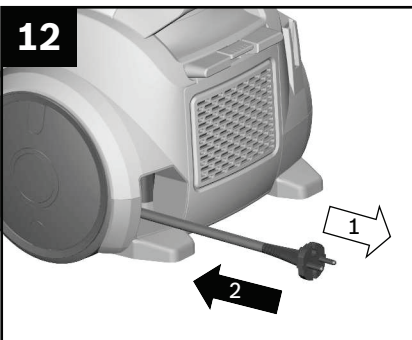

### Disconnecting the appliance

#### Figure 12

- Switch off the appliance.
- Remove the main plug.
- Briefly pull on the power cord and then let go. (The power cord retracts automatically).

13

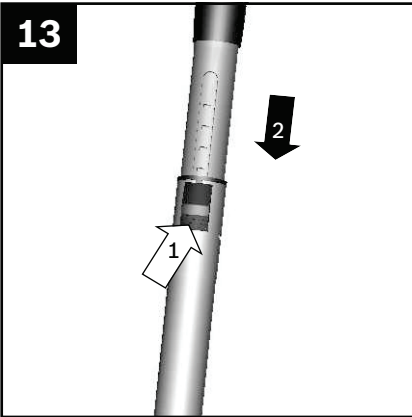

### Sliding the telescopic tube

#### Figure 13

- Unlock the telescopic tube by moving the sliding switch in the direction of the arrow and slide one tube into the other.

14

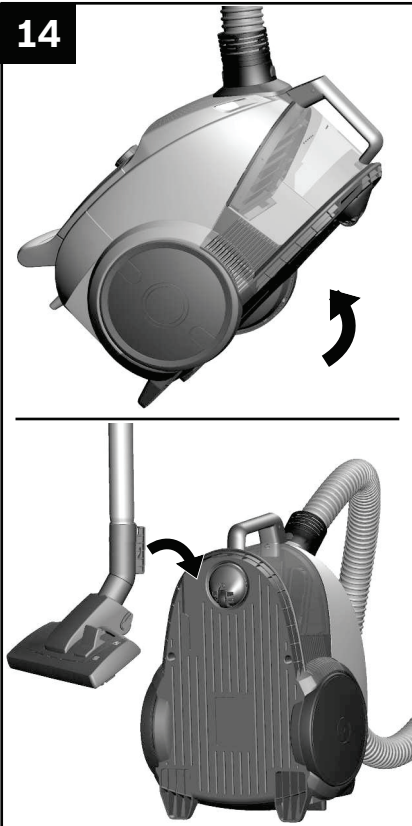

### Storing and transporting

#### Figure 14

To store the appliance, use the storage aid on the underside.

- Prop up the appliance with the hose or dust container handle.
- Slide the hook on the floor nozzle into the storage aid.

## Disassembly

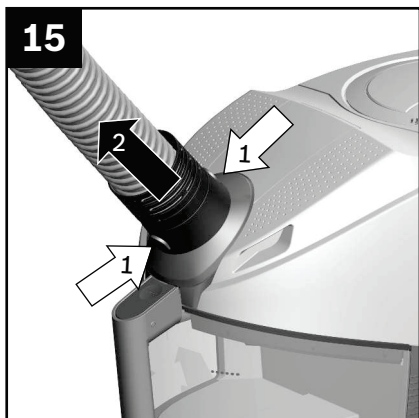

### Removing the flexible hose

**Figure 15**

- To remove the flexible hose, press the two catches together and pull out the hose from the appliance's suction opening.

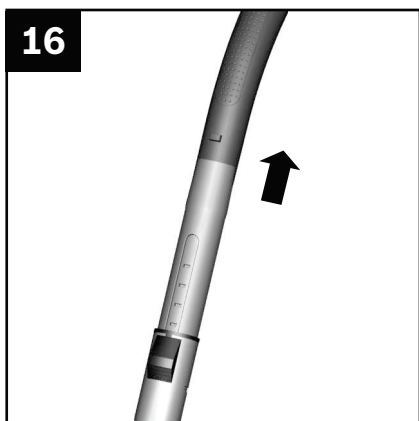

### Removing the telescopic tube

**Figure 16**

- To release the connection, turn the handle slightly and pull it out of the telescopic tool.

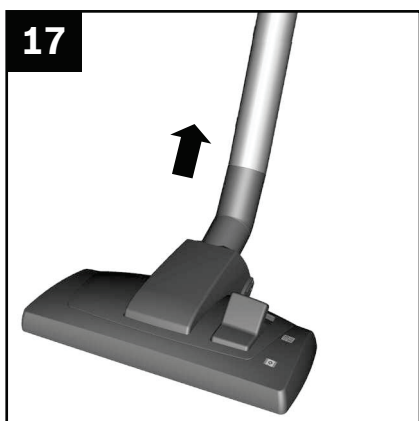

### Removing the floor nozzle

**Figure 17**

- To release the connection, turn the telescopic tube slightly and pull it out of the floor nozzle.

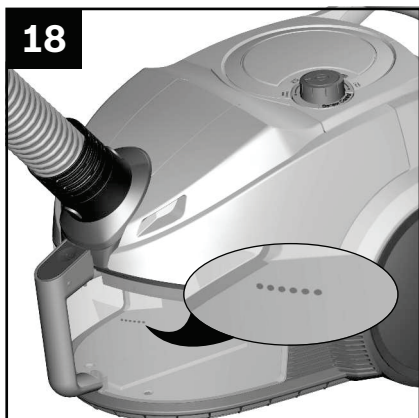

### Emptying the dust container

#### Figure 18

In order to achieve the best possible vacuuming results, the dust container should be emptied after every use or, at the latest, when dust in the dust container has reached the marking at any point.

#### ! Caution

The dust container can only be removed when the appliance is in a horizontal position. Therefore, place the appliance on the floor to unlock the release button.

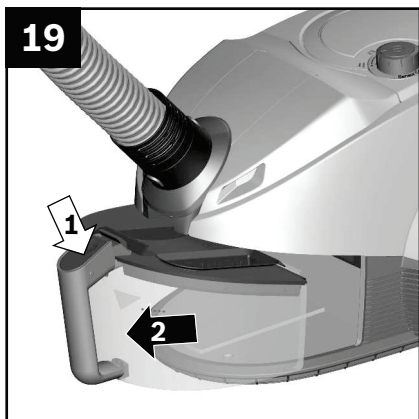

### Removing the dust container

#### Figure 19

- Press the release button and pull the dust container out of the appliance using the handle.

## Cleaning and care

19

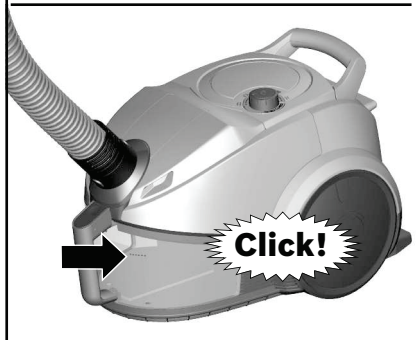
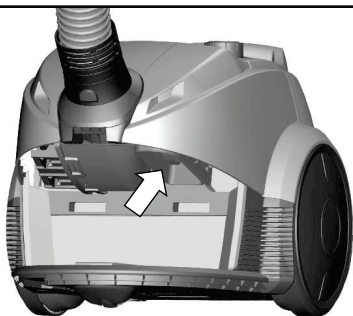
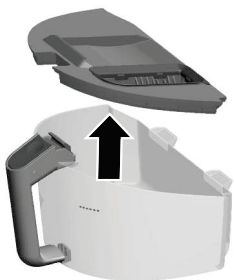

- Remove the lid from the dust container and empty the dust container.

- Put the lid back on the dust container.

- Remove any dirt which may have been lodged underneath the container ejector opening.

- Insert the dust container in the appliance, so that it 'clicks' audibly into place.

### Maintaining the dust separation system

Your appliance is equipped with a Sensor Control indicator. This function constantly monitors whether your vacuum cleaner is working at its optimum power level. **Fig. 20**

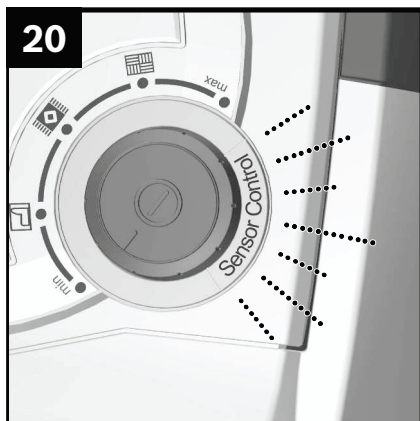

### In normal operation

#### Figure 20

The indicator (blue ring) flashes red when the foam filter needs to be cleaned. The appliance is automatically adjusted to the lowest power level.

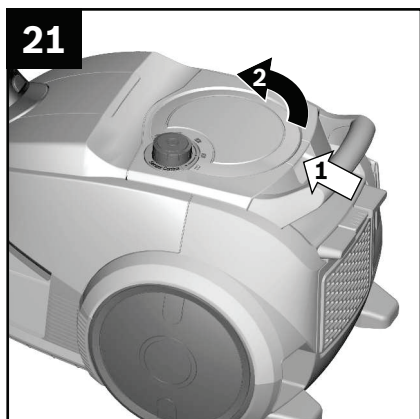

### Cleaning the foam filter

Switch off the appliance.

#### Figure 21

- Open the lid of the foam filter by pulling on the locking lever.

## Cleaning and care

21

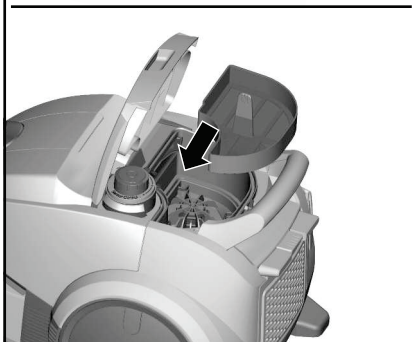
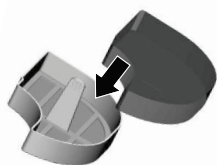
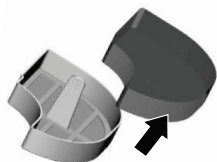
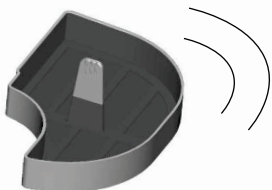
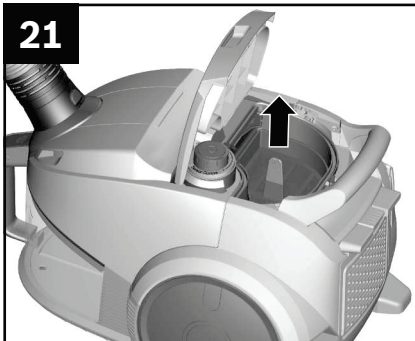

- Remove the filter cartridge with foam filter using the tab.

- Remove the foam filter from the filter cartridge and tap out both parts.

- If they are very dirty, the foam filter and filter cartridge should be cleaned under running water.

Alternatively, the unit can be cleaned in the washing machine at max. 30 °C using a gentle programme and the lowest spin speed.

**TIP** To protect other laundry items, put the filter unit into a laundry bag.

- Allow the foam filter and filter cartridge to dry completely (at least 24 hours) and then reinsert the foam filter into the filter cartridge.

- Insert the filter cartridge with foam filter back into the appliance. Close the lid of the foam filter.

### **!Caution**

The lid will only close if a filter has been inserted.



### In the event of a fault

The Sensor Control indicator also flashes after the foam filter has been cleaned:

#### Removing a blockage from the dust separation unit

**Figure 22**

- Switch off the appliance.
- Hold the appliance lid by the recessed handle and open it.

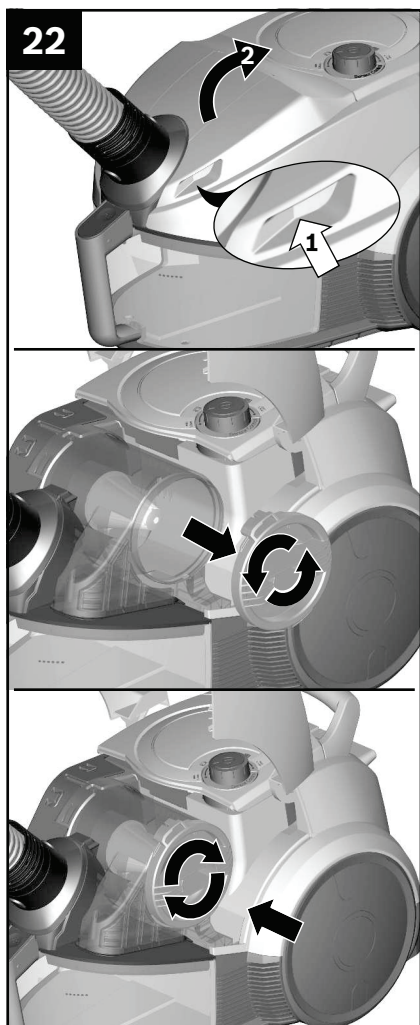

- Unlock the cover by turning it anti-clockwise, and remove it from the appliance.  
=> Remove the blockage from the collecting unit.

- Put the cover back on and lock it in place by turning it clockwise.  
=> Close the appliance lid.

If the Sensor Control indicator continues to flash red, check whether the nozzle, suction pipe or flexible hose are blocked. This can also trigger the Sensor Control indicator.

Depending on the model, your appliance is equipped with either a HEPA filter **Fig. 23** or a micro filter **Fig. 25**.

Depending on the model, your appliance has additional sound insulation behind the HEPA or micro filter. This does not have to be cleaned.

### **HEPA filter**

You can determine with which HEPA filter your appliance is equipped by looking at the imprint on the filter frame next to the reference number:

- **"washable"** – the filter can be washed.
- **No additional imprint** – the filter must be replaced.

### **Cleaning a washable HEPA filter**

The HEPA filter with the "washable" imprint is designed so that it does not need to be replaced, provided the appliance is used as intended in the household.

To ensure that the vacuum cleaner is working at its optimum power level, the exhaust filter should be rinsed out after one year. The filtering action of the filter remains intact, even if the filter surface becomes discoloured.

## Exhaust filter care

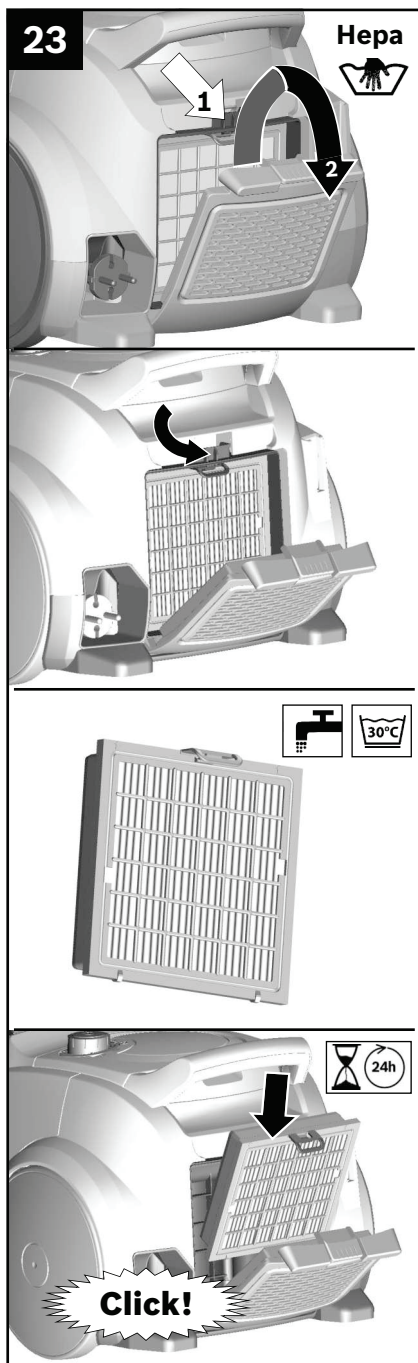

**Figure 23**

- Open the lid of the exhaust filter by pushing and pulling on the locking tab.
- Unlock the HEPA filter and remove it from the appliance.
- Tap out the filter unit and rinse it under running water. Alternatively, the unit can be cleaned in a washing machine at max. 30 °C using a gentle programme and the lowest spin speed.  
TIP: To protect other laundry items, put the filter unit into a laundry bag.
- Once the HEPA filter has dried completely (at least 24 hours), insert it back into the appliance and lock it in place.  
=> Close the exhaust filter lid. In doing so, push the lock bar upwards until it audibly clicks into place.

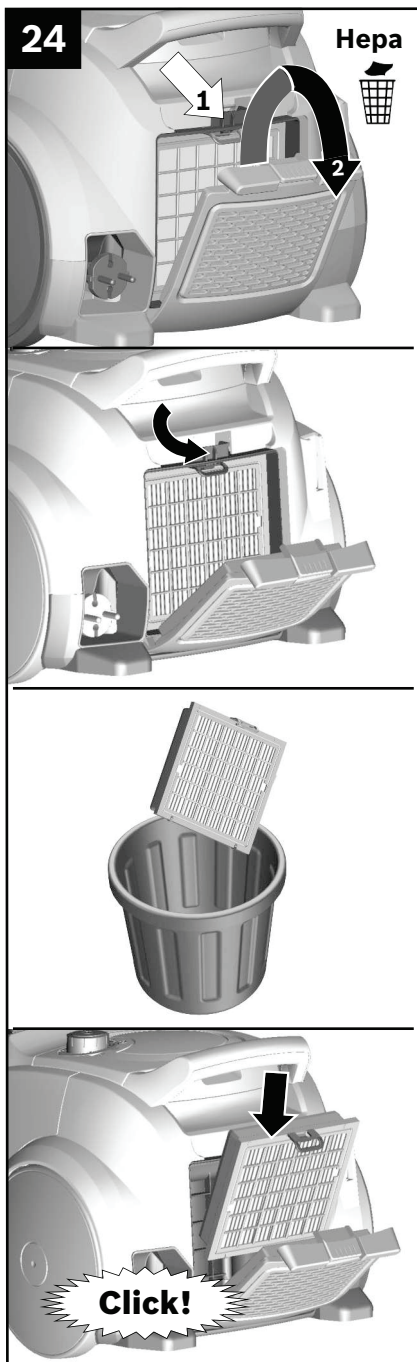

### Replacing the HEPA filter

(only for appliances without a washable HEPA filter)

To ensure that the vacuum cleaner can work at its optimum power level, the HEPA filter should be replaced after one year.

#### Figure 24

- Open the lid of the exhaust filter by pushing and pulling on the locking tab.
- Unlock the HEPA filter and remove it from the appliance.
- Dispose of the old HEPA filter with your household waste.
- Insert the new HEPA filter into the appliance and lock it in place.  
=> Close the exhaust filter lid. In doing so, push the lock bar upwards until it audibly clicks into place.

25



### Micro filter

#### Cleaning the micro filter

The micro filter is designed so that it does not need to be replaced, provided the appliance is used as intended in the household.

To ensure that the vacuum cleaner is working at its optimum power level, the exhaust filter should be rinsed out after one year. The filtering action of the filter remains intact, even if the filter surface becomes discoloured.

#### Figure 25

- Open the lid of the exhaust filter by pushing and pulling on the locking tab.
- Pull the locking tab to unlock the filter unit with foam filter and microfilter and remove it from the appliance.
- Remove the foam filter and microfilter from the filter frame.

## Exhaust filter care

25

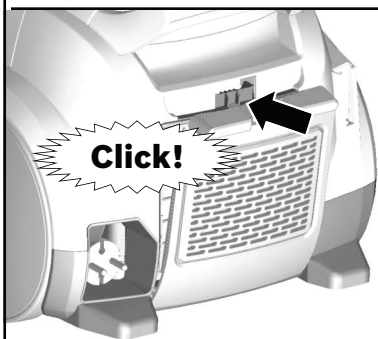
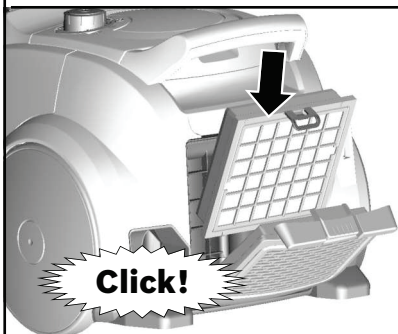
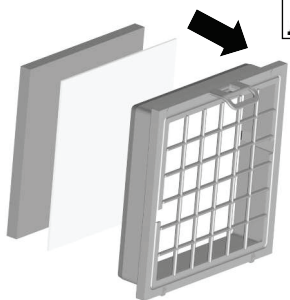
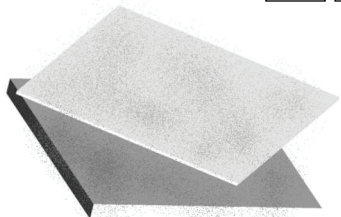

- Rinse the foam filter and micro filter under running water. Alternatively, they can be cleaned in the washing machine at max. 30 °C using a gentle programme and the lowest spin speed.

TIP: To protect other laundry items, put the unit into a laundry bag.

- Once the foam filter and microfilter have dried completely (at least 24 hours), insert them back into the filter frame.
- Insert the filter unit in the appliance and ensure that the locking tabs audibly click into place.
- Close the exhaust filter lid. In doing so, push the lock bar upwards until it audibly clicks into place.

## Cleaning instructions

Always switch off the vacuum cleaner and disconnect the power cord from the mains before cleaning the vacuum cleaner. The vacuum cleaner and plastic accessories can be cleaned with an ordinary plastic cleaner.



**Caution: do not use a scourer, glass-cleaning agent or multipurpose cleaning product. Never immerse the vacuum cleaner in water.**

Subject to technical modifications.

## Disposal

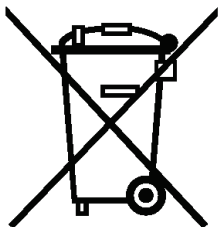

"This appliance is labelled in accordance with European Directive 2012/19/EU concerning used electrical and electronic appliances (waste electrical and electronic equipment - WEEE). The guideline determines the framework for the return and recycling of used appliances as applicable throughout the EU."

### Disposal information

#### ■ Packaging

The packaging is designed to protect the vacuum cleaner from being damaged during transportation. It is made of environmentally friendly materials and can therefore be recycled.

Dispose of packaging that is no longer required at an appropriate recycling point.

#### ■ Old appliances

Old appliances still contain many valuable materials. Therefore, please take appliances that have reached the end of their service to your retailer or recycling centre so that they can be recycled.

For current disposal methods, please enquire at a retailer or your local council.

#### ■ Disposal of filters and dust bags

Filters and dust bags are manufactured from environmentally friendly materials. Provided they do not contain substances that are not permitted in household waste, you can dispose of them with your normal household waste.



## Customer service

GB Great Britain  
BSH Home Appliances Ltd.  
Grand Union House  
Old Wolverton Road  
Wolverton  
Milton Keynes MK12 5PT

To arrange an engineer visit, to order spare parts and accessories  
or for product advice please visit:

[www.bosch-home.co.uk](http://www.bosch-home.co.uk)

or call

Tel.: 0844 892 8979\*

\*Calls are charged at the basic rate, please check with your telephone service  
provider for exact charges.

## Conditions of guarantee

For this appliance the guarantee conditions as set out by our representatives in the country of sale apply. Details regarding same may be obtained from the dealer from whom the appliance was purchased. For claims under guarantee the sales receipt must be produced.



**Robert Bosch Hausgeräte GmbH**

Carl-Wery-Str. 34

81739 München

Germany

**[www.bosch-home.com](http://www.bosch-home.com)**



8001011645