

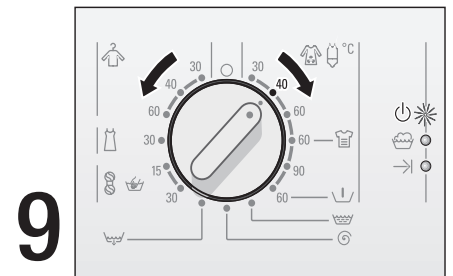

Quick-reference instructions

Please read and observe these operating and installation instructions carefully before using the washing machine for the first time.

SIEMENS

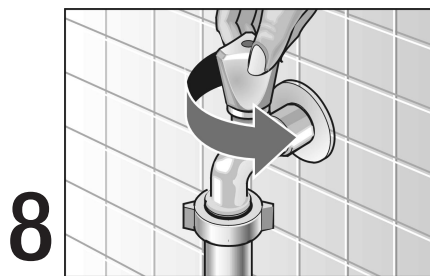
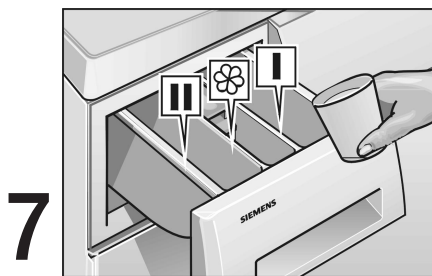
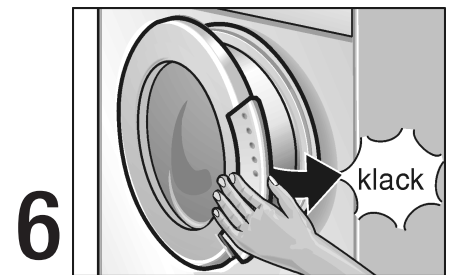
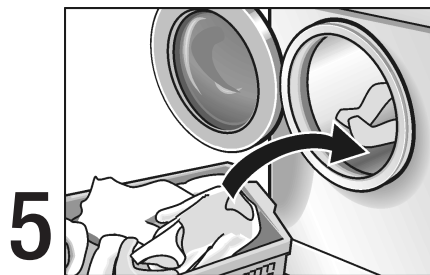
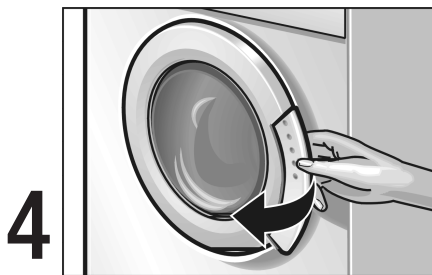
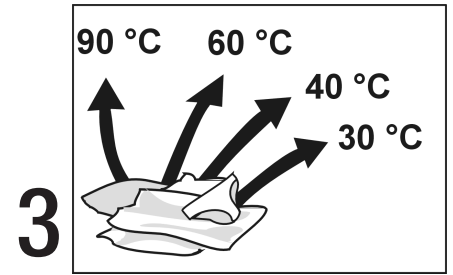
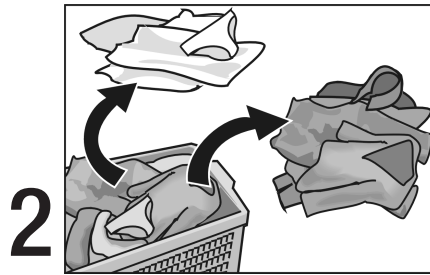
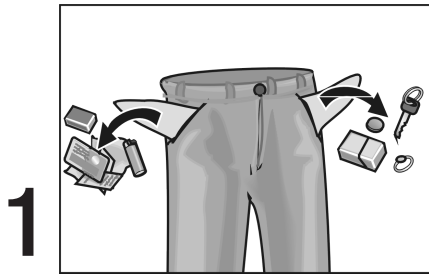

As required

As required

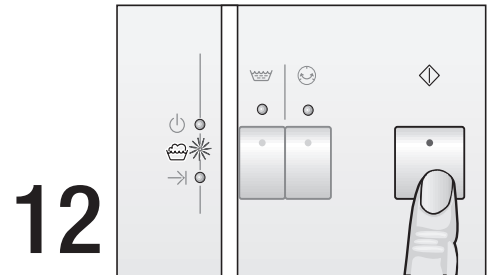
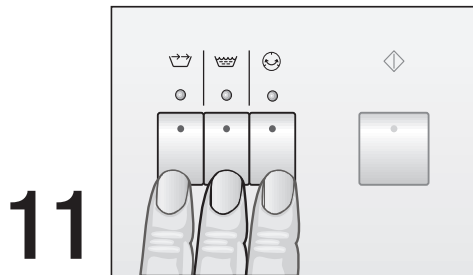
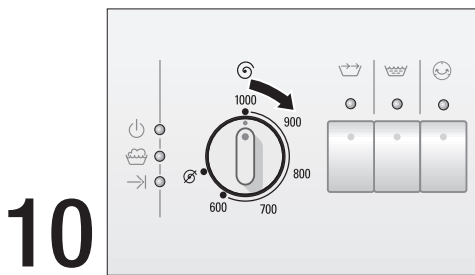

At the end of the programme

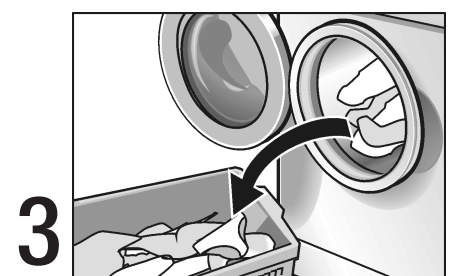
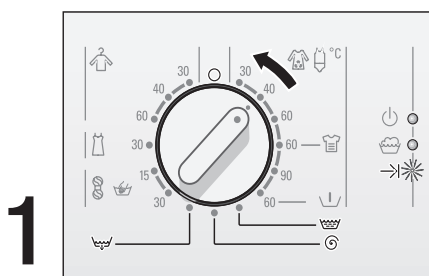

Programme Chart

Type of laundry	Amount of laundry, up to:	Programme	Degree of dirt / Advice	Additional functions	Programme duration in min. (approx.) *		
Hard-wearing fabrics made from cotton or linen, heat-resistant fabrics 	3,5 kg	 30, 40, 60 °C Cottons + Linens	Light to normal	None	120		
			Negligible to light	"	85		
			Additional rinsing cycle	"	130		
					Reduced spin speed	"	125
					The laundry is left in the final rinsing water	"	
					Stained	None	135
		 60 °C Intensive Stains	Intensive	None	140		
			 60 °C Cottons + Linens with Prewash	Intensive	None	120	
				90 °C Cottons + Linens			
Easy-care fabrics made from cotton, synthetics or blended fabrics 	2,0 kg	 30, 40, 60 °C Easy-care	Light to normal	None	75		
			Negligible to light	"	45		
			Additional rinsing cycle	"	85		
			Reduced spin speed	"	80		
			The laundry is left in the final rinsing water	"			
Sensitive, easy-care fabrics made from cotton, synthetics, silk or blended fabrics (e.g. net curtains) 	2,0 kg	 30 °C Delicates	Light to normal	None	45		
			Negligible to light	"	40		
			Additional rinsing cycle	"	55		
			Reduced spin speed	"	50		
			The laundry is left in the final rinsing water	"			
Washable fabrics made from wool or wool basis 	2,0 kg	 30 °C Woollens cold	Light to normal	None	45		
			Negligible to light	"	30		
			Additional rinsing cycle	"	55		
			Reduced spin speed	"	50		
			The laundry is left in the final rinsing water	"			

Programme options

Programme selector	Notes / Application	Programme duration in min. (approx.) *
Rinse	Separate rinsing cycle with subsequent spin cycle for easy-care fabrics. Rinsing of hand-washed laundry or for starching.	15
Spin	Separate spin cycle. Washing solution or rinsing water is drained prior to spinning. Spinning of hand-washed laundry.	10
Drain	Draining of the rinsing water after a programme with "". Gentle treatment of sensitive laundry.	2

* The programme duration may deviate from the specified values depending on the water pressure, hardness and input temperature, the room temperature, laundry type and amount, applied detergent, fluctuations in the mains voltage and the selected additional functions.

More detailed information can be found in the operating and installation instructions. Please read these carefully and observe the safety instructions.

0302 en 5550 006 721