

SIEMENS

Instruction Manual and Installation Instructions

en

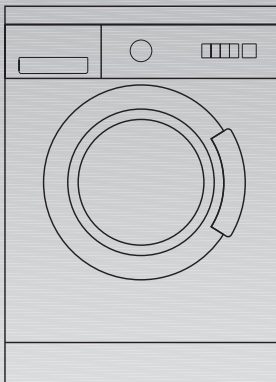

Washing Machine

Table of Contents

Operating Instructions

Information concerning waste disposal	5
Disposing of the packaging	5
Disposing of your old appliance	5
Protection of the environment / Hints and tips ..	6
General safety instructions	7
Introducing your washing machine	8
Control panel	9
Before using your washing machine for the first time	10
Preparing your washing machine	10
Preparing, sorting and loading the washing	11
Preparing the washing	11
Sorting the washing	12
Degrees of dirt	12
Loading the washing	15
Detergents and cleaning products	16
Dosing detergent	16
Adding detergent/cleaning product	17
Programmes and functions	18
Programme selector	18
Additional option – buttons	21
Wash	27
After washing	30
Removing the washing	30
Signal	31
Special applications	32
Soaking	32
Starching	32
Dyeing	33
Bleaching	33

Cleaning and Care	34
Clean housing, fascia and supply lines	34
Cleaning the drum	34
Cleaning the detergent dispenser	35
Cleaning the drain pump	36
Cleaning water inlet strainers	38
Descaling the washing machine	38
Help with minor problems	39
Fault displays	39
Consumption values	44
Customer service	45
Installing, connecting and transporting the appliance	46
Safety instructions	46
Standard accessories	47
Dimensions	48
Installation surface	48
Removing the transportation protection devices	49
Hose and cable lengths	52
Connecting the water	53
Aligning the washing machine	55
Connecting the power	56
Transport, e.g. when moving	57
Aqua Stop warranty	58
Index	59

Installation Instructions

Appendix

The new washing machine which you have just purchased is a modern, high-quality domestic appliance.

Your washing machine is distinguished by its economical consumption of energy, water and detergent.

Each washing machine which leaves our factory is checked carefully to ensure that it functions properly and is in perfect condition. If you have any questions – especially with respect to installing and connecting your washing machine – please do not hesitate to contact our customer service department.

Further information and a selection of our products can be found on our Internet page:
<http://www.siemens.de/hausgeraete>

Please read these operating and installation instructions and all other information enclosed with the washing machine and act accordingly.

These operating and installation instructions describe various models. Differences are indicated in the appropriate places.

Retain all documentation for subsequent use or for the next owner of the appliance.

Information concerning waste disposal

Disposing of the packaging

The shipping package has protected your new appliance on its way to your home. All utilised materials are ecologically harmless and recyclable. Please contribute to a better environment by disposing of packaging materials in an environmentally conscious manner.

Please ask your dealer or inquire at your local authority about current means of disposal.

⚠ Risk of choking!

Do not let children play with packaging and associated parts. Risk of choking on plastic film and collapsible cardboard boxes.

Disposing of your old appliance

Old appliances are not worthless rubbish! Environment-conscious recycling can reclaim valuable raw materials.

⚠ Danger of death!

Unplug mains plug on redundant appliances. Cut off mains cable and discard with mains plug.

Destroy the lock on the door. To prevent playing children from becoming trapped and endangered, ensure that the door locking mechanism is disabled.

Protection of the environment / Hints and tips

Your washing machine uses water, energy and detergent efficiently, thereby protecting the environment and reducing your household costs. See Page 44 for consumption values of your appliance.

Hints and tips

Using your washing machine in an efficient and environmentally friendly manner:

- Take advantage of recommended load quantity.

Cottons/coloureds	6.0 kg / 13.2 lb
Easy-care	3.0 kg / 6.6 lb
Delicates and Silk	2.0 kg / 4.4 lb
Woollens	2.0 kg / 4.4 lb

With smaller amounts of laundry, the load adjust reduces the water and energy consumption.

- Select the **Cottons/Coloureds 60 °C Stains** programme instead of **Cottons 90 °C**. The longer washing time in this 60 °C programme means that the cleaning effects are comparable with those of a 90 °C programme, although the power consumption is considerably lower.
- Do not use prewash for lightly to normally soiled washing.
- Add detergent according to the degree of soiling, amount of laundry and water hardness, and observe the detergent manufacturer's instructions.
- If washing is then to be dried in the tumble dryer, select spin speed in accordance with the instructions supplied by the dryer manufacturer.

General safety instructions

Your washing machine is intended for

- use in the household only,
- For washing machine-washable fabrics in washing lye.
- operation with cold drinking water and commercially available detergents and cleaning products which are suitable for use in washing machines.

Do not leave children unsupervised near the washing machine.

Keep pets away from the washing machine.

Do not insert/pull out the mains plug with wet hands.

Do not pull out the mains plug by tugging the cable.

Do not touch the loading door when washing at high temperatures.

Caution when draining hot water.

Do not climb onto the washing machine.

Do not lean on the open washing machine door.

Introducing your washing machine

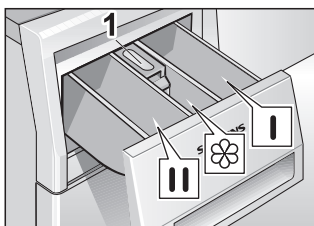

Adding detergent/ cleaning product

Dispenser I:

Detergent for prewash or starch.

Dispenser II:

Detergent for main wash,
soaking agent, water softener,
bleach or stain remover.

Dispenser :

Additives, e.g. fabric softener
or former.

(Fill at least to lower edge of
insert **1**).

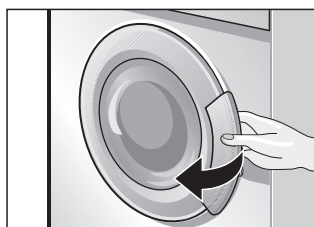
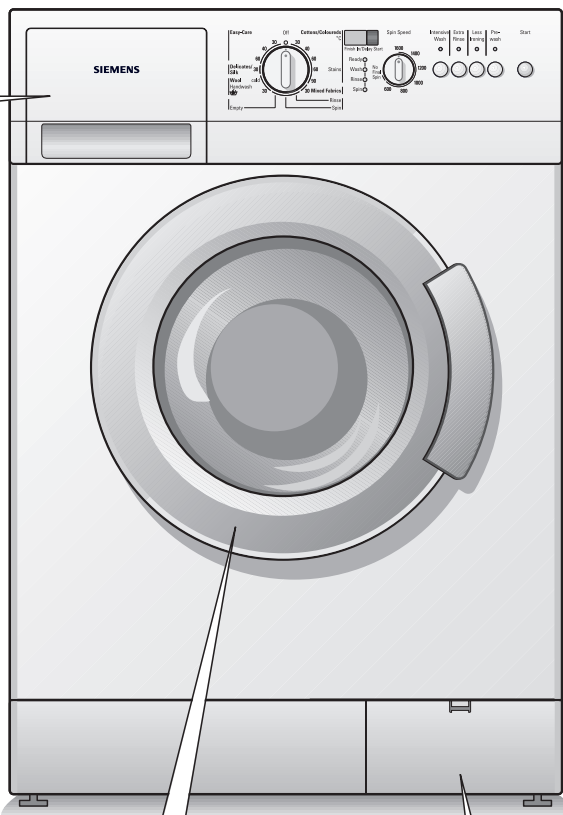

Opening ...

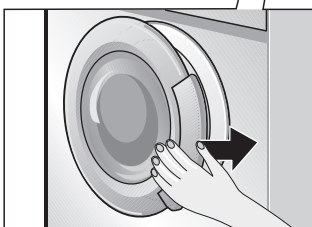

and closing the door

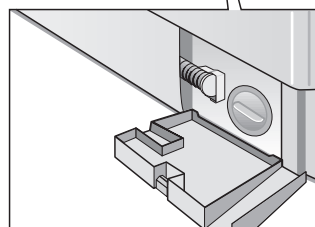

Service flap

Control panel

Delay Start button (if required)

The **time** can be delayed by hours up to a maximum of **19h**.

Finish In display,

if the programme is selected.

Delay Start display,

if the **Delay Start** is additionally selected.

The apostrophe ' between the number and **h** flashes until the **Delay Start** has elapsed. The selected programme then starts automatically and the **Finish In** is displayed.

Buttons for additional options

(in addition to the programme if required)

Intensive Wash: More intensive wash.

Extra Rinse: Additional rinsing cycle.

Less Ironing: Gentle spin.

Prewash: actuate Prewash.

Additional options can be combined before the programme is started.

The indicator lights of the buttons come on, if the additional options are active.

Switch off additional option: press button again. Indicator light goes out.

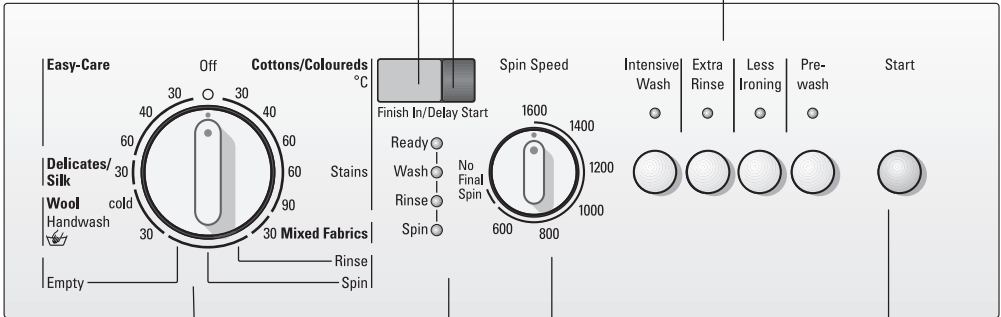

Programme selector

For switching the machine on and off and for selecting the programme. Can be rotated in either direction.

The programme selector does not rotate while the programme is running – the programme sequence is electronically controlled.

Indicator lights for the programme status

Ready illuminate, if the programme is selected.

Wash, Rinse, Spin illuminate when the **Start** button is pressed and the particular programme section is running.

Indicator lights flash: Operation error.

Spin speed selector

(if required)

For stepless setting of the spin speed; must click in place at

No Final Spin

Start button

For starting the wash cycle (programme must have been selected).

See chapter **Signal**, page 31, for **switching off acoustic signal or changing the volume**.

Before using your washing machine for the first time

Preparing your washing machine

Attention

The washing machine must have been installed and connected properly refer to Page 46.

- i** The washing machine was tested before leaving the factory. To remove any water left over from testing procedures, the first washing cycle should be carried out **without** laundry in the machine.
- Turn the tap on.
- Pull out the detergent drawer all the way.
- Pour approx. 1 litre / 1 ¼ pt of water into chamber **II** of the detergent dispenser.
- Half fill the measuring beaker with detergent and pour into chamber **II**.
- i** Do not use any special detergents for delicates or woollens (excessive foam).
- Close the detergent drawer.
- Close the washing machine door.
- Set the programme selector to **Cottons 90 °C**.
- Press the **Start** button.
The programme starts.

The programme has ended when a programme duration of **-0-** is displayed:

- Turn the programme selector to **Off**.

Preparing, sorting and loading the washing

Preparing the washing

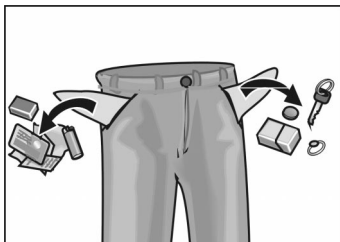

Attention

Loose debris (e.g. coins, paper clips, needles, nails) can damage items of clothing as well as parts of the washing machine (e.g. drum).

- Empty all pockets on items of clothing.
- Brush sand out of pockets and cuffs/turn-ups.
- Close zips, fasten pillow cases/cushion covers.
- Remove curtain runners or tie up in a net/bag.
- Wash in a net/cushion cover:
 - delicates, e.g. tights, curtains,
 - small laundry items, e.g. socks or handkerchiefs,
 - underwired bras (underwire may become detached during washing and cause damage).
- Trousers, knitwear and knitted textiles, e.g. jersey garments, T-shirts or sweatshirts should be turned inside out.

Sorting the washing

According to colour and degree of dirt

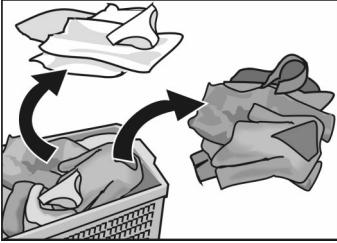

Attention

Washing may become discoloured. Do not wash new coloured washing with other washing.

White items may become grey. Wash white and coloured items separately.

Degrees of dirt

lightly soiled

No visible soiling or stains. Washing has probably absorbed body odour.

- Light-weight summer clothing and sportswear worn for several hours.
- T-shirts, shirts, blouses worn for up to one day.
- Bed linen, guest towels used for one day.

normally soiled

Visible soiling and/or a few light stains.

- T-shirts, shirts, blouses soaked in sweat or worn several times.
- Underpants, briefs worn for one day.
- Tea towels, hand towels, bed linen used for up to one week.
- Curtains (without nicotine soiling) used for up to six months.

very soiled

Visible soiling and/or stains.

- Kitchen towels used for up to one week.
- Fabric serviettes.
- Baby bibs.
- Children's outer clothing or football jerseys and shorts soiled with grass and/or earth.
- Work clothes, e.g. mechanic's overalls, baker's and butcher's clothing.

Typical stains

- Skin grease, cooking oil/fat, sauces, mineral oil, wax (containing fat/oil).
- Tea, coffee, red wine, fruit, vegetables (which can be bleached).
- Blood, egg, milk, starch (containing protein, carbohydrate).
- Soot, earth, sand (pigments), tennis clothing soiled with red clay.

Removing stains

Remove/pre-treat stains as soon as possible after they have occurred.

First dab with a soapy solution. Do not rub.

Then select the appropriate programme and wash the item.

Stubborn/dried in stains can sometimes only be removed by washing several times.

Sorting washing according to the instructions on the care labels

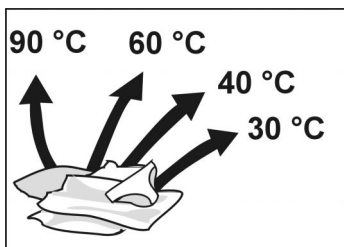

Only wash laundry that is labelled with the following care symbols:



hard-wearing textiles, heat-resistant textiles
e.g. made from cotton or linen,



for easy-care textiles
e.g. cotton, linen, synthetic materials or blended fabrics



for easy-care, washable textiles
e.g. silk, satin, synthetic materials or blended fabrics
(e.g. curtains)



for hand and machine washable wool or wool-rich textiles
e.g. cashmere, mohair or angora,
also suited for hand washable silk

Do not wash laundry items which bear the following care label in the washing machine:



= do not wash

Loading the washing

⚠ Risk of explosion!

Items of clothing that have been pretreated with solvent-based cleaning agents, e.g. stain remover and dry cleaning spirit, represent an explosion hazard once loaded into the washing machine. Before loading the laundry, rinse thoroughly by hand.

Attention

Foreign objects in the drum may damage the laundry. Before loading the laundry, check that there is no debris in the drum.



- ❑ Open the washing machine door.

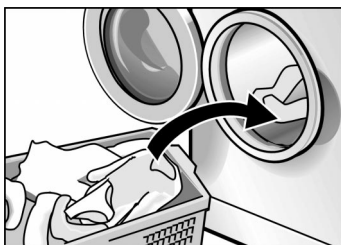

- ❑ Unfold the sorted items of clothing and place them loosely into the drum. Mix large and small items. Laundry items which vary in size are more evenly distributed during the spin cycle.

- i** Do not exceed recommended loads. Overloading will cause poor wash results and encourage creasing.

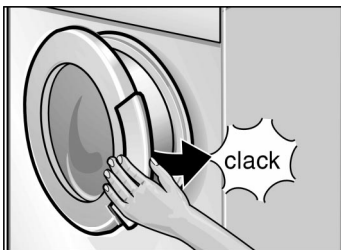

- ❑ Close the washing machine door. Take care not to trap any items of clothing between the loading door and rubber seal.

Detergents and cleaning products

Dosing detergent

⚠ Risk of poisoning!

Keep detergents and additives out of the reach of children.

Dose detergent according to

- the water hardness. You can find out the water hardness from your water utility company.
- the amount of laundry.
- the degree of soiling.
Information on soiling can be found on Page 12.
- the specifications of the detergent manufacturer.
The correct dosage reduces the impact on the environment and produces a good washing result.

Pour liquid detergent into the corresponding dispenser.

Too little detergent:

- The laundry is not washed clean and eventually becomes grey and hard.
- Greyish-brown dots (grease spots) may stain the laundry.
- The heating elements are calcifying.

Too much detergent:

- The environment is loaded.
- Excessive froth may be generated during the wash cycle causing a reduction in the washing mechanism. This may be the cause of poor washing and rinsing results.

Adding detergent/ cleaning product

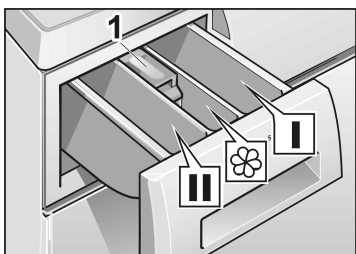

Dispenser I
Detergent for prewash or starch.

Dispenser II
Detergent for main wash, water softener, pre-soaking agent, bleach and stain removal product.

Dispenser ☼
Cleaning product, e.g. fabric softener or fabric conditioner (do not fill above the lower edge of the insert 1).

- i** Concentrated or viscous fabric softener or fabric conditioner must be diluted with a little water before it is poured into the dispenser (prevents the overflow from becoming blocked).
- Pull out the detergent drawer all the way.
- Pour in detergent and/or cleaning product.
- Close the detergent drawer.

Programmes and functions

Programme selector

Select the desired programme - see also the separate programme overview.

i Programmes wash lightly soiled textiles in the shortest possible time. For heavily soiled textiles reduce the load or press the **Intensive Wash** button!

Basic programmes

Cottons/Coloureds 30, 40, 60 °C

For hard-wearing textiles, e.g. made of cotton or linen.

Cottons/Coloureds 60 °C Stains

For stained, heavily soiled textiles, e.g. cotton or linen. Energy and water saving programme. The longer washing time in this 60 °C-programme means that the cleaning effects are comparable with those of a 90 °C-programme, although the power and water consumption is considerably lower.

Cottons 90 °C

Energy-intensive programme for heat-resistant textiles, e.g. made of cotton or linen.

To protect the waste-water pipes, the hot water is mixed with approx. 7 litres of cold water and cooled before being drained.

Easy-Care 30, 40, 60 °C

For easy-care textiles, e.g. made of cotton, linen, synthetic or blended fabrics.

i Also suitable as **short programme**.

Mixed Fabrics 30 °C

Time-optimised programme for lightly soiled cotton textiles and easy-care textiles. Different types of washing can be washed together.

Even suitable for washing new textiles before they are worn for the first time.

- i** Wash white and coloured items separately.
Do not wash new coloured washing with other washing.

Short washing time.

Delicates/Silk 30 °C

For delicate, washable textiles, e.g. silk, satin, synthetic materials or blended fabrics (e.g. curtains).

Delicates cycle at 30 °C for hand and machine washable silk.

- i** We do not recommend washing these textiles with other rougher textiles.

Wool Handwash cold, 30 °C

For hand and machine washable wool or wool-rich textiles, e.g. cashmere, mohair or angora.

Also suited for hand washable silk.

Programme options

Rinse

Rinse cycle with subsequent spin cycle for rinsing hand-washed items or for starching.

Press the **Extra Rinse** button for an additional rinse cycle.

Spin

Spin cycle after a programme with setting **No Final Spin** or for spinning hand-washed washing with selection of the required speed. Washing water or rinsing water is drained before the spin cycle.

Empty

Water is drained after a programme with the **No Final Spin** setting on display panel for gentle treatment of delicate laundry.

Spin speed selector

Basic setting

The spin speed selector is pointing up.

In the **Cottons/Coloureds** programme the fabrics will be spun at the maximum possible spin speed.

In the **Easy-Care, Mix, Delicates/Silk** and **Wool** programmes, a lower spin speed will automatically be used, irrespective of the position of the button – gentle treatment of delicate fabrics.

i Between the rinse cycles the washing is given an intermediate spin only (not for **Delicates/Silk**). This improves the rinsing results.

Maximum spin speeds

Revolutions per minute depending on model			Type of laundry / Programme options
1600	1400	1200	Cottons/Coloureds
800	800	800	Easy-Care
800	800	800	Mixed Fabrics
600	600	600	Delicates/Silk
800	800	800	Wool
1200	1200	800	Rinse
1200	1200	800	Spin

Additional option

No Final Spin  (without final spin)

For delicate textiles and net curtains.

All programmes can be run without final spin.

The laundry is left in the final rinsing water.

At the end of the programme "---" is indicated on the remaining time display and the **Spin** indicator light is lit.

Before the washing can be removed, the **Empty** or **Spin** programme must be run by setting the speed selector to the required speed.

Additional option – buttons

Intensive Wash

The washing time is extended so that highly soiled washing or 6 kg of cottons/coloureds are washed more intensively.

Press the button in addition to the programme for the following combinations of load and degree of soiling:

Amount of laundry	Programme and button Intensive Wash	Degree of soiling
6 kg	Cottons/Coloureds 30, 40, 60 °C	lightly to normally soiled
	Cottons/Coloureds 60 °C Stains	normally soiled with stains
	Cottons 90 °C	normally soiled
up to 5 kg	Cottons/Coloureds 30, 40, 60 °C	normally to heavily soiled
	Cottons/Coloureds 60 °C Stains	normally to heavily soiled with stains
up to 3 kg	Easy-Care 30, 40, 60 °C	normally to heavily soiled
	Mixed Fabrics 30 °C	
up to 2 kg	Delicates/Silk 30 °C	
	Wool cold 30 °C	

See the separate programme table for further information.

Extra Rinse

Additional rinsing of laundry.
Programme duration is extended accordingly.

Recommended application:
in areas with very soft water.

Less Ironing

Gentler reduced spin cycle with subsequent fluffing.
After the spin cycle, the laundry is loose in the drum –
creasing is reduced.

Prewash

For very dirty, hard-wearing laundry, e.g. cotton or
linen.

The washing temperature of the prewash is 30 °C.
Prewash cannot be selected for woollens programme.

i If the prewash is cancelled, the detergent solution
is pumped out and the programme continues with
the main wash cycle.

Finish In display

Example of **Easy-Care 40 °C** programme:

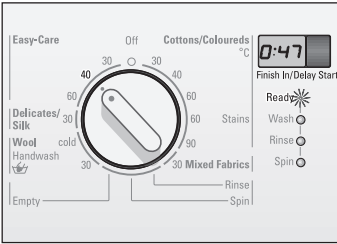

- ❑ Turn the programme selector to the desired programme.

The **Ready** indicator light comes on.

The expected **Finish In** (programme duration) is displayed, e.g. **0:47**.

- i** **Finish In** is displayed in hours and minutes, e.g.
0:47 – 47 minutes
1:17 – 1 hour and 17 minutes



- ❑ Press the **Start** button.

The programme starts.

The colon : between hours and minutes flashes and the programme duration counts down in minutes.

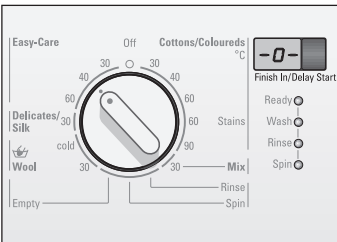

When the programme ends, the displays shows **-0-**.

- i** At the start of the programme, a projection of the remaining time occurs under the assumption of a full load and a water supply temperature of 15 °C. The actual load is calculated during the first 10 minutes.

The remaining time can become increased or reduced while the programme is running for the following reasons.

Reductions in time occur because of:

- small loads.
- reduced heating times, e.g. if the water is very hot.

Increases in time occur because of:

- Additional rinse cycle if excessive foam is in the laundry,
- Multiple spinning if the laundry is distributed poorly in the drum,
- Increased heating times, e.g. when the water is too cold,
- Water pressure too low,
- Selection of an additional option, e.g. **Extra Rinse** and/or **Intensive Wash** after the programme has started,
- Very absorbent washing extends the heating duration.

Delay Start display and button

Example of **Easy-Care 40 °C** programme:

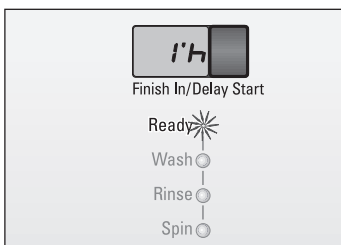
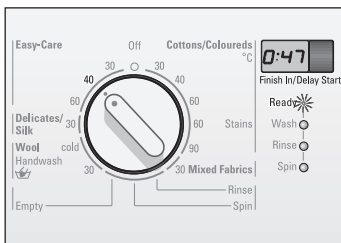

Example:

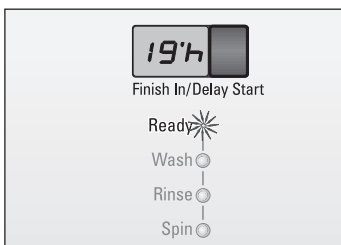

Before starting a programme, you can specify by how many hours the time delay should be delayed.

- Turn the programme selector to the desired programme.

The **Ready** indicator light comes on.

The expected remaining time will be displayed.

- Press the **Delay Start** button, **1'h** (h=hour) appears in the display.

- Press the **Delay Start** button until the desired number of hours is displayed.

- i** **Delay Start** can be set by hours. The time can be delayed up to a maximum of **19'h**. If a start time of **19'h** has been set, the remaining time mode is accessed by pressing the **Delay Start** button again.

- Press the **Start** button. The programme starts.

The time delay begins running immediately after the programme starts. This indicated by the flashing apostrophe ' between the number and **h**.

- i** The time delay is counted down by the hour. The programme is automatically started after the time delay has elapsed. The indicator light of the respective programme segment comes on. The remaining time appears in the display.
- i** Changes to the **Delay Start** or an immediate start are possible. To do this:
- Briefly set the programme selector to another programme.
 - When the programme selector has been reset to the original programme, individual or all other settings may have to be reselected. If required, reset the **Delay Start**.
 - Press the **Start** button. The programme starts.
- i** If the programme sequence is changed by rotating the programme selector or the programme is cancelled, the preselected start time is also cancelled. The remaining time of the newly selected programme appears in the display. The **Delay Start** must be reselected. See also chapter **Changing the programme**, page 28 and **Cancelling the programme**, page 29.
- i** Topping up laundry is possible at any time during the time delay. Close the washing machine door.

Wash

Example of **Easy-Care 40 °C** programme:

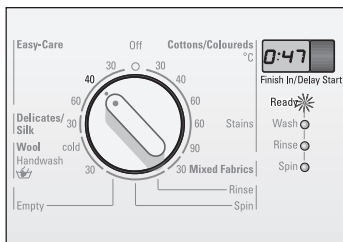

- Turn the programme selector to the desired programme (see also the separate programme overview).

The **Ready** indicator light comes on.
Finish In is displayed.

Example:

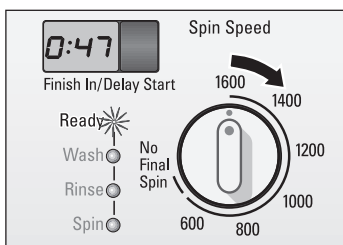

- If required, select spin speed or **No Final Spin** .

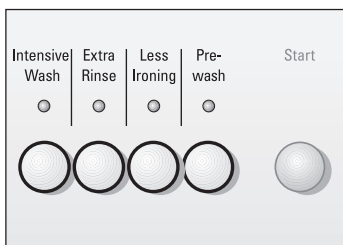

- If required, press the button(s) for additional option(s).

The indicator light of the selected button is on.

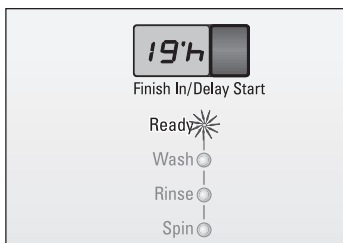

- If required, select **Delay Start**.

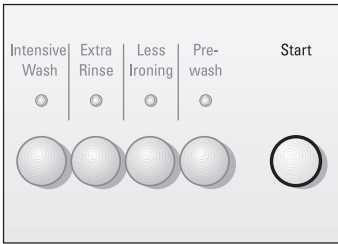

Changing the programme

- Press the **Start** button.
The programme starts.

If you have accidentally selected the wrong programme:

- Turn the programme selector to the desired programme.
If prewash is selected subsequently, set the programme selector to **Off** and reselect the programme.
- If required, change other settings.
- Press the **Start** button.
The programme starts.
- i** The newly selected programme starts at the programme section at which the previous programme was cancelled, however with the new settings.

Cancelling the programme

If you would like to terminate a programme and remove the washing:

- Turn the programme selector to **Empty**, **Spin** or **Rinse**.
If required, select spin speed (not **No Final Spin** .
- i** If a programme is interrupted at a high temperature, **Rinse** should be selected to cool down the washing.
- Press the **Start** button.
- Wait until programme ends.
- Turn the programme selector to **Off**.
- Open the washing machine door.
- Remove the washing.
- i** If a programme was interrupted at a high temperature, the washing machine door may remain locked until the appliance has cooled down.

After washing

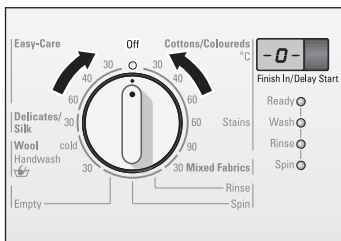

Setting selected without (without final spin)

-0- appears in the display.

- Turn the programme selector to **Off**.

or

 ”---” is displayed and the **Spin** indicator light is lit.

- Select an additional programme (**Empty** or **Spin**).
- Press the **Start** button.
- At the end of the programme option, turn the programme selector to **Off**.

Removing the washing

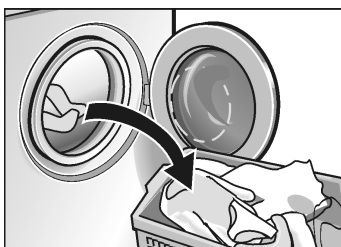

- Open the washing machine door.

If the loading door cannot be opened:
Wait 2 minutes (safety function is active)

or

there is still water in the washing machine if the **No Final Spin**  option was selected.

Select the **Empty** or **Spin** programme and press the **Start** button.

- Unload the laundry.

Attention

Remove any foreign objects (e.g. coins, paper clips) from the drum and rubber seal – **risk of rust!**

- Leave the washing machine door and detergent drawer open to allow the interior of the washing machine to dry.

Signal

Signal for switching buttons on and off

The acoustic signal indicates:

- that the additional functions (buttons) have been switched on or off,
- individual programme statuses (e.g. start of programme, end of programme), operating errors and faults.

☐ Press the **Start** button and set the programme selector to **Cottons/Coloureds 30 °C**. Hold down the **Start** button until the signal is emitted. The selected setting is saved.

i When the additional functions are switched on, a long signal is emitted; when the additional function is switched off, the signal is short. The volume of the signal cannot be changed.

Signal for programme status

The signal can be switched on and off and the volume set before the start or after the end of the programme.

☐ Press the **Intensive Wash** button and hold down until the signal is emitted and the volume of the signal changes.

☐ Release the button when the required volume is reached. The selected setting is stored.

Special applications

Soaking

- Load laundry of the same colour.
- Pour soaking agent into dispenser **II** according to the manufacturer's instructions.
- Set the programme selector to **Cottons/Coloureds 30 °C**.
- Press the **Start** button.
The programme starts.
- After approx. 10 minutes, turn the programme selector to **Off**. The laundry is left to lie in the water.
- Select a programme according to the required soaking time, the detergent solution is pumped out.
- i** Only little detergent to be dispensed for the main wash.

Starching

The laundry must not be treated with fabric softener.

- Insert the washing.
- Dose a quantity of starch for approx. 15 litres of water. Dissolve starch according to the manufacturer's instructions.
- Turn the programme selector to **Rinse**.
- Set the spin speed; **No Final Spin** is possible.
- Press the **Start** button.

As soon as the water runs in:

- Pull out the detergent drawer a little and
- Pour starch solution into dispenser I.
- Close the detergent drawer.

If the **No Final Spin** option has been selected, select the **Empty** programme.

Only use dyes that are environmentally compatible and suitable for use in washing machines.

Attention

Washing in subsequent wash cycles may become discoloured.

- Apply dyes according to the manufacturer's instructions.

After dyeing:

- Pour approx. ½ measuring beaker of detergent into dispenser II.
- Without any laundry in the drum, allow the **90 °C Cottons** programme to run through.
- Wipe out the rubber seal.

Attention

Bleaches may contain sulphur or chlorine which can corrode components of the washing machine. Do not bleach washing in the washing machine.

Dyeing

Bleaching

Cleaning and Care

⚠ Risk of electric shock!

First, always disconnect the appliance from the power supply.

Never clean the washing machine with a water jet.

⚠ Risk of explosion!

Never clean the appliance with solvents.

As required:

- Use hot soapy water or a mild, non-abrasive cleaning agent.
- Wipe dry with a soft cloth.

Clean housing, fascia and supply lines

Cleaning the drum

If metal items (e.g. coins, paper clips, needles, nails) left in the drum have caused rust spots:

- Use chlorine-free cleaning agents; comply with the manufacturer's instructions. Never use steel wool.

Cleaning the detergent dispenser

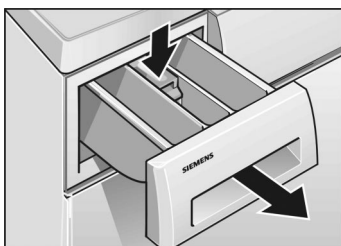

- Pull out the detergent drawer all the way,
- Press down the insert and
- remove the detergent drawer.

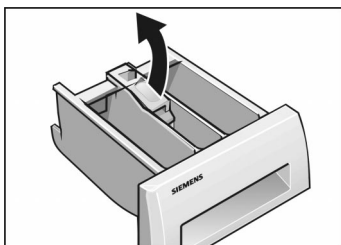

- Pull up the insert.
- Clean the detergent drawer under running water and dry.

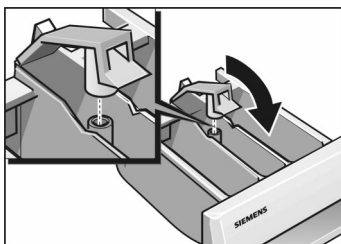

- Attach the insert and lock into position.
- Slide in the detergent drawer.

Cleaning the drain pump

Drain the water

This is necessary if the washing solution has not been completely drained. The pump is blocked by either loose debris or fluff which accumulates if fluff-giving fabrics are washed.

(Up to 20 litres. Have a suitable container ready.)

⚠ Risk of scalding!

Allow the hot water to cool down beforehand. Keep children and pets away from the washing machine.

Turn the programme selector to **Off**.

Open service flap.

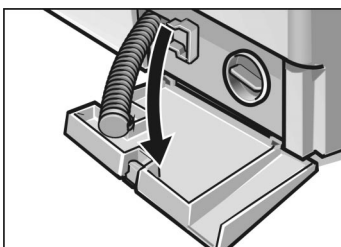
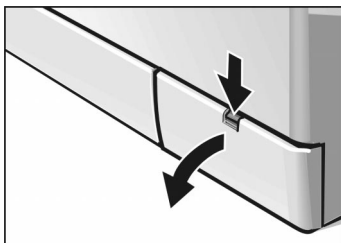

Remove the drain hose from its holder and pull the hose out of the housing.

Remove the service flap.



Pull down the closing cap and allow the washing lye to flow into a suitable container.

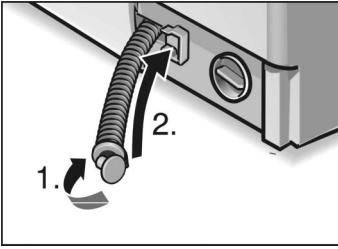

- ❑ Push up the closing cap (**1st**) and place the drain hose back in its holder (**2nd**).

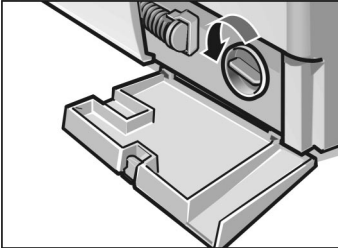

- ❑ Carefully remove the pump cap.
A little more residual water will flow out.
- ❑ Remove foreign objects/fluff from inside and clean the interior. The pump impeller wheel must be able to rotate.
Clean any residual lye or fluff from the thread of the pump cap and pump housing.

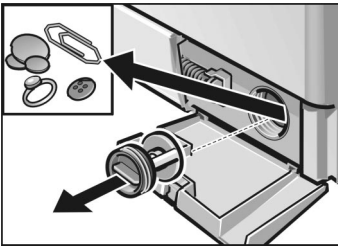

- ❑ Insert the pump cover and screw tight.
- ❑ Insert and close the service flap.

To prevent unused detergent from flowing into the drain during the next wash cycle:

- ❑ Pour 1 litre / 1 $\frac{3}{4}$ pt of water into chamber II.
- ❑ Select the **Empty** programme.

Cleaning water inlet strainers

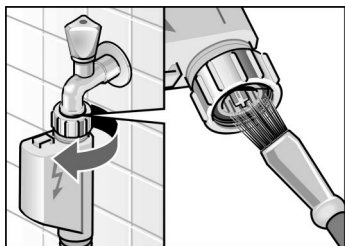

This is necessary if very little or no water flows into the washing machine.

First, reduce the water pressure in the inlet hose:

- Turn off the tap.
- Turn the programme selector to any programme (except **Spin** and **Empty**).
- Press the **Start** button, and allow the programme to run for approx. 40 seconds.
- Turn the programme selector to **Off**.
- Disconnect the hose from the water tap.
- Clean the filter with a small brush or paint brush.
- Connect the hose.
- Turn the tap on.
- Check whether water is leaking out of the end of the hose connected to the tap.
If water is still discharged, check that the strainer is attached properly.

Descaling the washing machine

Attention

Descaling agents contain acids which may corrode the components of the washing machine and discolour the washing.

Provided that you use the correct amount of detergent, it is not necessary to descale the washing machine.

If descaling is nevertheless required, please follow the instructions supplied by the manufacturer of the descaling agent.

Help with minor problems

If repairs are needed, and assuming that you cannot eliminate the fault yourself with the aid of the following table

- Turn the programme selector to **Off**.
- Disconnect the washing machine from the mains.
- Turn off the tap.
- Call customer service, see Page 45.

⚠ Risk of electric shock!

Repairs may be carried out by customer service or authorised technicians only.

Fault displays

Indicator light flashes and a signal sounds	Possible cause	Remedial action
Ready	Door not closed properly.	Check whether laundry is trapped in door; Close the washing machine door.
Wash	Tap not turned on.	Turn the tap on.
	Inlet hose kinked or pinched.	Eliminate cause.
	Filter blocked in water inlet hose.	Clean filter, see Page 38.
	Water pressure too low.	Eliminate cause.
Rinse	Loose debris is blocking the pump.	Clean the pump, see Page 36.
	Drainage pipe and/or drainage hose blocked.	Clean drainage pipe and/or drainage hose.

Problems	Cause	Remedial action
Washing machine door cannot be opened.	There is still some water in the appliance, No Final Spin  selected.	Select Empty or Spin .
	Safety function is active.	Wait for 2 minutes.
Detergent residue in the detergent drawer.	Damp or lumpy detergent.	Clean and dry the detergent dispenser; see Page 35.
	Difficult-to-dissolve detergent tablets used.	Use the dosing aid for liquid detergent. Before filling dispenser II , crush the tablets in the packet.
Odour in the appliance.	Washing mainly at low temperatures and/or with liquid detergents.	Start Cottons 90 °C programme without washing. Use a standard detergent.
Control lights do not come on.	A fuse has triggered.	Switch on/replace the fuse. If the fault occurs repeatedly, call Customer Service.
	Power failure.	An interrupted programme will be resumed when the power returns. If you wish to unload the laundry, proceed as in Cleaning the drain pump , page 36.
	Plug is loose or not plugged in.	
Programme does not start.	Loading door not closed properly.	Check whether laundry is trapped in door. Close the loading door (a click should be heard).
	Start button not pressed.	Press the Start button.
Water does enter the machine or detergent is not washed away.	Tap not turned on.	Turn the tap on.
	Inlet hose kinked or pinched.	
	Filter blocked in water inlet hose.	Clean the strainer; see from Page 38.
Detergent in chamber I is not washed away.	A programme without Prewash was selected.	Select programme with Prewash.

Problems	Cause	Remedial action
Water not visible in the drum.	Not a fault. The water lies below the visible part of the drum.	
Washing solution is not completely drained.	Pumped blocked by foreign objects.	Clean the pump refer to page 36.
	Fluff-producing laundry was washed. The water drainage pipe or drain hose is blocked.	Clean drainage pipe and/or drainage hose.
Programme does not continue running and an indicator light is lit	Water in the base pan; Appliance leaking.	Call Customer Service.
Water runs out from under the appliance.	Screw fitting of the inlet hose is leaking.	Tighten the screw-fitting.
	Drainage hose is leaking.	Replace the drain hose.
Foam comes out of the detergent drawer.	Too much detergent or detergent not suitable for use in washing machines used.	Mix 1 tablespoon of fabric softener with ½ litre pt of water and pour into chamber II of the detergent dispenser.
		Reduce detergent dosage for next wash cycle or use detergent which is suitable for use in washing machines.
The washing has not been spun correctly.	Large laundry items have become entangled and are not evenly distributed in the drum. For safety reasons, the high-speed final spin cycle was automatically cancelled.	Do not put only large items in the drum.
Spin result unsatisfactory.	Less Ironing button pressed – for reduced spin speed see page 22.	
	The Rinse or Spin programme selected maximum spin speed: see Page 20.	
Spin cycle actuated several times.	Not a fault. Unbalanced load detection system is attempting to compensate the imbalance by spinning the washing several times.	

Problems	Cause	Remedial action
The programme takes longer than usual.	Not a fault. Imbalance compensation system attempts to balance the laundry by repeated distribution.	Wash large and small items together in order to reduce the imbalance.
	The foam detection feature has activated an additional rinsing cycle to reduce the amount of foam.	Adjust the detergent dosage for the next wash cycle.
Washing result not satisfactory.	Soiling is greater than expected or recommended load has been exceeded.	Select suitable programme and press the Intensive Wash button or reduce load.
	Detergent was underdosed.	Dose detergent according to the manufacturer's instructions.
Detergent residue on the washing.	Some phosphate-free detergents contain water-insoluble residue which may appear as light stains on the washing.	Select Rinse immediately or brush out the washing after drying.
Grey residue on the washing.	Soiling caused by ointment, grease or oil.	Select maximum detergent dosage and maximum permitted temperature for the next wash cycle.
Changes in the Finish In while the programme is running	Not a fault. See also explanations under Finish In display , see from page 23.	
Reduction in the remaining time	Not a fault. For small amounts of laundry, a reduction in time of approx. 20 minutes can result, depending on washing programme.	

Problems	Cause	Remedial action
Increase in the remaining time	In the case of excessive foam, the foam detection system has activated an additional rinse cycle and an additional spin cycle to ensure the rinsing result.	Reduce the detergent dosage for the next wash cycle.
	For severe imbalances during spinning, an increase in time of approx. 10 minutes can occur because of repeated distribution of the laundry.	Wash large and small items together in order to reduce the imbalance.
	If very cold water must be heated up, an increase in time up to 20 minutes can result.	

If the fault recurs, call Customer Service, see Page 45.

Consumption values

Normal programme	Additional option	Load	Consumption values **		
			Power	Water	Programme duration
Cottons/Coloureds 40 °C	Intensive Wash *	6 kg	0.65 kWh	60 l	2:10 h
Cottons/Coloureds 60 °C	–	5 kg	0.95 kWh	60 l	1:17 h
Cottons/Coloureds 60 °C Stains	Intensive Wash *	6 kg	1.02 kWh	49 l	2:15 h
Cottons 90 °C (the hot washing solution is mixed with approx. 7 litres of cold water before being drained)	Intensive Wash	6 kg	2.1 kWh	67 l	2:10 h
Easy-Care 40 °C	Intensive Wash *	3 kg	0.5 kWh	50 l	1:18 h
Easy-Care 40 °C (Also suitable as short programme)	–	3 kg	0.5 kWh	38 l	0:47 h
Delicates/Silk 30 °C	–	2 kg	0.3 kWh	42 l	0:35 h
Wool 30 °C	Intensive Wash *	2 kg	0.2 kWh	35 l	0:50 h

* Programme setting with **Intensive Wash** option for test in accordance or in conformity with EN 60 456 and IEC 60 456.

** Consumption values will differ from the indicated values depending on the water pressure, water hardness, water inlet temperature, ambient temperature, type and quantity of washing and degree of soiling, utilised detergent, fluctuations in the mains voltage and selected additional options.

Customer service

Before you call customer service, please check whether you can eliminate the fault yourself (see from Page 39).

A technician who is called out to give advice will charge you, even if the appliance is still under guarantee.

You can find your nearest customer service in the enclosed address list. Please provide customer service with the product number (E-Nr.) and the production number (FD) of the appliance.

These numbers are shown on the rating plate which can be found on the frame of the open door and also on the identification plate, enclosed by a thick line, on the front of the machine behind the nameplate.

Rating plate

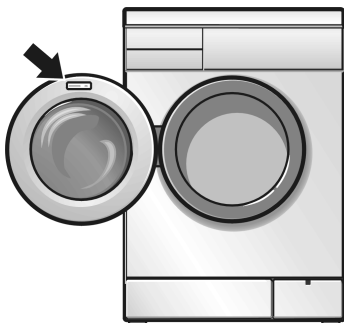

E-Nr. _____	FD _____
-------------	----------

Product number

Production number

Please note the two numbers in the space provided above.

In specifying the product number and production number of your appliance, you help us in our attempt to prevent unnecessary travelling and the associated extra costs.

Installing, connecting and transporting the appliance

Safety instructions

⚠ Risk of injury!

The washing machine is very heavy. Take care when lifting it.

Attention

Frozen hoses may tear/burst. Do not install the washing machine in an area where there is a risk of frost or outdoors.

The washing machine may be damaged. Do not lift the washing machine by its projecting parts (e.g. door).

In addition to the safety information listed here, the local water and electricity supplier may have special requirements.

If in doubt, have the appliance connected by a specialist.

Standard accessories

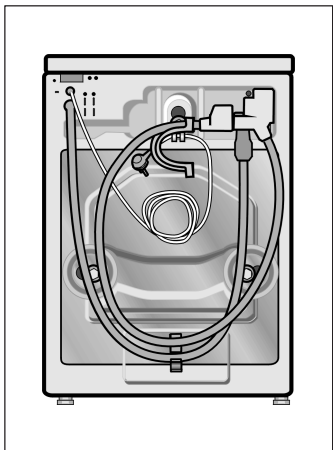

On the rear of the washing machine:

- Water drainage hose.
- Water-inlet hose.
- Elbow for attaching the drainage hose e.g. to the sink,
- Mains cable with plug.

Moisture in the drum is due to the final inspection which every washing machine undergoes before it leaves the factory.

Depending on the connection situation, the following part is also required:

- 1 hose clip Ø 24–40 mm (DIY store) is also required for connection to a siphon.

The bag contains:

- Spanner.
- Covers for holes left by removing the transport bolts.

Useful tools

The following tools are helpful:

- Box wrench A/F 13 for removing the transportation bolts,
- Spirit level for aligning the washing machine.

Dimensions

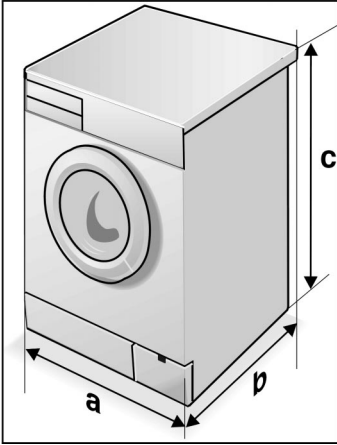

a = 600 mm

b = 590 mm

c = 852 mm

Weight 69–83 kg (depending on appliance)

Installation surface

Appliance stability is important so that the washing machine does not "wander" during the spin cycles.

The installation surface must be solid and level. Soft floor coverings, e.g. carpets or floor coverings with a foam backing are not suitable.

If the washing machine is to be installed on a wooden floor:

- If possible, install the washing machine in a corner.
- Screw a water-resistant wooden board (at least 30 mm thick) to the floor.
- Secure the washing machine feet with fixing brackets*.

If the washing machine is to be installed on a base:

- Secure the washing machine feet with fixing brackets*.

* Holding brackets (set) can be obtained from a specialist store or the Customer Service, order no. WX 9756.

Removing the transportation protection devices

Before removing the transportation protection devices

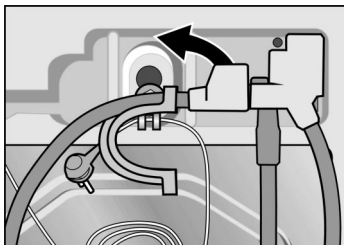

Removing the transportation protection devices

⚠ Caution

The transport bolts must always be removed before using the appliance for the first time.

- Take the hoses out of the holders.
- Detach the elbow.

- Release screws **1**, **2** and **3** using the A/F 13 wrench until they can be moved freely.

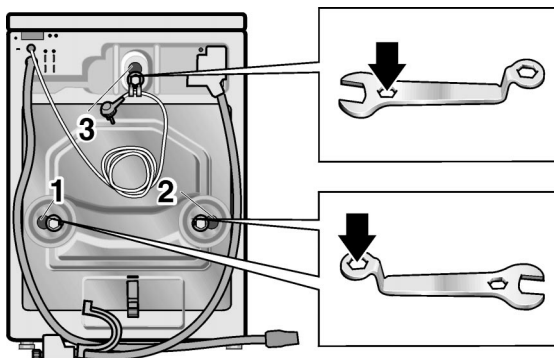

- Remove complete transportation protection devices **1** and **2** (bolt with washer and bush).

- ❑ Remove complete transportation protection device **3** (bolt with spring, washer and bush), holding the open washing machine door with one hand and pulling the drum slightly forwards.

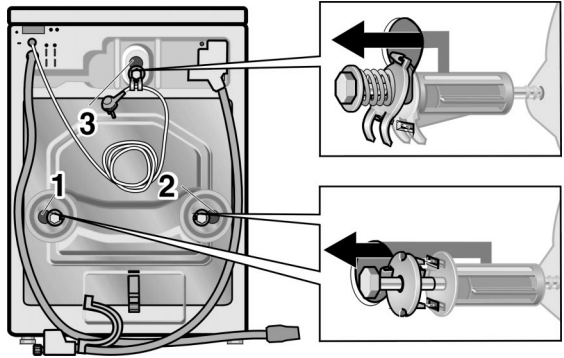

- ❑ Insert the covers.

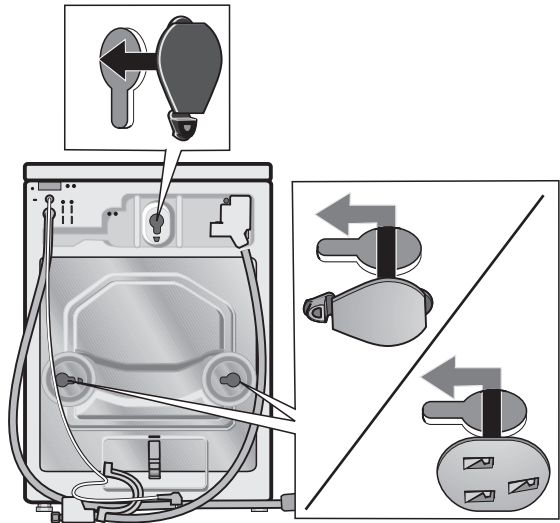

Storing the transportation protection devices

Always keep the transport bolts for subsequent transportation of the appliance (e.g. when moving house).

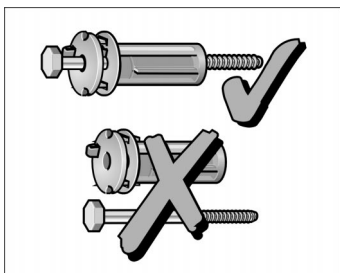

- Store transport bolts **1** and **2** (screw washer and bushing onto bolt).

Hose and cable lengths

Connection on left side

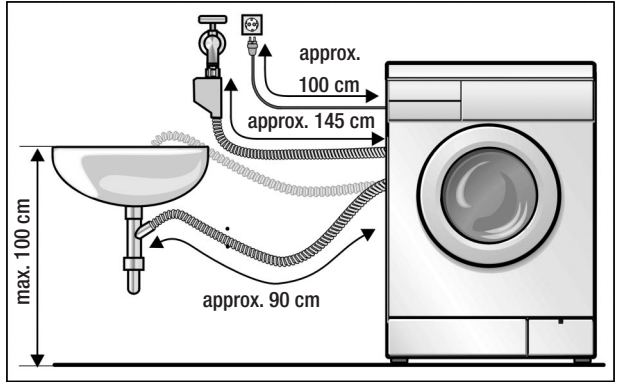

Connection on right side

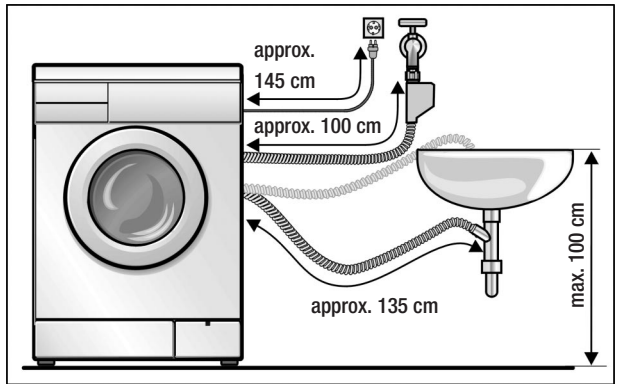

Aqua-Stop extension hose

Available in kit form from specialist outlets:

- Connecting kit with plastic hose (approx. 2.50 m), order no. WZ 10130.

Connecting the water

Water inlet hose

⚠ Risk of electric shock!

Do not immerse Aqua-Stop safety device in water (contains electrically operated valve).

To prevent leaks or water damage, it is essential to follow the instructions in this chapter!

Attention

Operate the washing machine with cold drinking water only. Do not connect to the mixer tap of an unpressurised hot-water apparatus.

If in doubt, have the appliance connected by a specialist.

The water inlet hose must not be

- kinked or crushed,
- modified or severed (strength is no longer guaranteed).

Check the mains water pressure:

- The water pressure should be between 1 and 10 bars (when the tap is turned on, at least 8 litres of water is discharged per minute).
- If the water pressure is higher, install a pressure reducing valve.

- Connect the water supply hose to the tap.

After connecting the water inlet hose:

- Turn on the tap fully.
- Check the connection points for leaks.

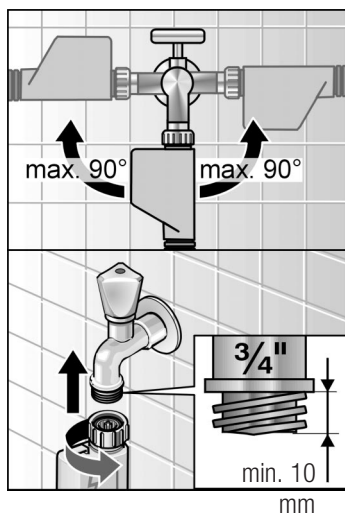

Water drainage hose

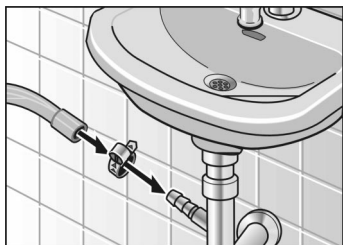

Attention

Do not bend or pull the water drainage hose.

Height difference between the placement area and drainage point: maximum 100 cm.

Drainage into a siphon:

- Secure connection point with 24–40 mm Ø hose clip (specialist outlet).

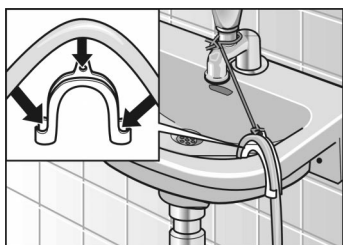

Drainage into a wash basin:

Attention

The plug must not block the drain of the wash basin.

- Secure the drainage hose to prevent it from slipping out of the sink.
- When the water is being pumped out of the washing machine, check that the water drains away quickly enough.

Aligning the washing machine

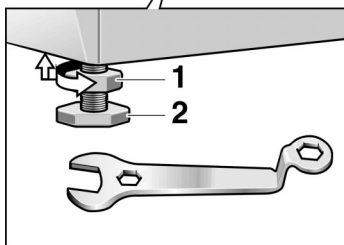

Level the washing machine with the assistance of the four adjustable feet and a spirit level:

- Loosen the lock nut **1** using the wrench.
- Adjust the height by rotating the foot **2**.
- Tighten the lock nut **1** against the housing. Simultaneously hold the foot in place and do not adjust the height.

All four feet must be firmly on the floor. The washing machine must not wobble.

The lock nuts of all four appliance feet must be screwed tightly against the housing!

Attention

Loud noise generation, vibrations and "wandering" may be due to incorrect alignment!

Connecting the power

Attention

Connect the washing machine only to an alternating current via a correctly installed earthed socket.

The mains voltage must correspond to the voltage specification on the washing machine (nameplate). Connection specifications as well as the required fuses are stipulated on the appliance nameplate.

Ensure that:

- The mains plug and socket are compatible.
- The cable cross-section is adequate.
- The earthing system has been installed correctly.

The mains cable may be changed (if required) by an electrician only.

Replacement mains cable available from customer service.

Do not use multiple plugs/sockets or extension cables.

In the event that an earth-leakage circuit breaker is to be used, only use types marked with the following symbol: .

Only this symbol can guarantee compliance with all current regulations.

Do not insert/pull out the mains plug with wet hands.

Do not pull out the mains plug by tugging the cable.

Transport, e.g. when moving

Before transporting the washing machine

- Turn off the tap,
- Reduce the water pressure in the water inlet hose (see Page 38),
- Drain any residual washing solution (refer to Page 36).
- Disconnect the washing machine from the power supply,
- remove the hoses,
- install the lower 2 transport bolts.

Having transported the appliance and ensured proper installation and connection, allow the **Empty** programme to run through before starting the first wash programme.

Preparing and inserting the transport bolts

- Remove the 2 lower covers.
- Prepare the transport bolts:
Loosen the screw in the sleeve until the end of the screw is level with the end of the sleeve.
- Through the open washing machine door have a second person pull the top of the drum forwards. Now insert transportation protection devices **1** and **2** and tighten the screws. The washer lugs must be located in the groove in the rear panel of the housing.

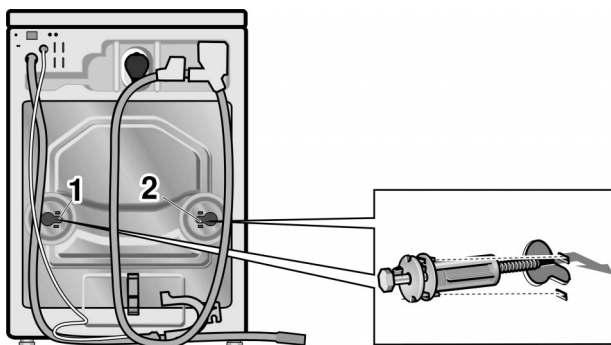

Aqua Stop warranty

In addition to warranty claims against the seller based on the sales contract and in addition to our appliance warranty we shall be liable for payment of damages under the following conditions:

- 1.** If damage is caused by water due to a fault of our Aqua Stop system, we shall compensate the private user for the damage.
- 2.** This liability guarantee is valid for the service life of the appliance.
- 3.** A claim under the warranty can only be considered provided Aqua-Stop has been properly installed and connected to the appliance according to our instructions, including a properly installed Aqua-Stop extension (original accessory). Our warranty does not apply to defective supply lines or fittings up to the Aqua Stop connection on the tap.
- 4.** If your washing machine features Aqua Stop, you do not need to keep your eye on the washing machine during operation or turn the tap off afterwards. You should only turn the tap off if you intend being away from home for a prolonged period, e.g. on holiday.

Index

A

- Additional options, 9, 21
 - Extra Rinse, 9, 22
 - Intensive Wash, 9, 21
 - Less Ironing, 9, 22
 - Prewash, 9, 22
- Aligning the washing machine, 55
- Aqua Stop, 58
- Aqua Stop extension hose, 52

B

- Basic programmes, 18
- Bleaching, 33

C

- Canceling the programme, 29
- Care labels, 14
- Changing the programme, 28
- Cleaning and care, 34
 - Control panel, 34
 - Detergent drawer, 35
 - Drain pump, 36
 - Drum, 34
 - Housing, 34
 - Strainer, 38
 - Supply lines, 34
- Closing cap, 36
- Connecting the power, 56

- Connecting the water, 53
- Consumption values, 44
- Control panel, 9
- Cottons/Coloureds, 18–20
 - Stains, 18
- Customer service, 45

D

- Degrees of dirt, 12
- Delay Start button, 9, 25
- Delay Start display, 9, 25
- Delicates, 19
- Descaling, 38
- Dimensions, 48
- Disposal, information, 5
- Dosing detergent, 16
- Dyeing, 33

E

- Easy-Care, 18
- Empty, 19
- End of the programme, 30

F

- Fault display, 39
- Finish In display, 9, 23
- Functions, 18

H

- Hints and tips, 6
- Holding bracket, 48
- Hose and-cable lengths, 52

I

- Indicator lights, 9
 - Ready, 9
 - Rinse, 9
 - Spin, 9
 - Wash, 9
- Insert transportation protection devices, 57
- Installation surface, 48
- Internet, 4

L

- Loading the detergent, 17
- Loading the washing, 11, 15

M

- Mixed Fabrics, 18

O

- Old appliance, 5

P

- Packaging, 5
- Preparing the washing, 11
- Problems, 39
- Product number, 45
- Production number, 45
- Programme duration, 23
- Programme duration., 44
- Programme options, 19
- Programme selector, 9, 18
- Programmes, 18
- Protection of the environment, 6
- Pump cap, 37

R

- Rating plate, 45
- Remove the washing, 30
- Removing stains, 13
- Removing the transportation protection devices, 49
- Rinse, 19

S

- Safety instructions, 7, 46
- Service flap, 36
- Signal, 31
- Silk, 19
- Soaking, 32
- Sorting the washing, 12
- Spin, 19
- Spin speed selector, 9, 20
- Standard accessories, 47
- Starching, 32
- Start button, 9
- Start programme, 27
- Storing the transportation protection devices, 51

T

- Take out the drain hose., 36
- Tools, 47
- Transporting the washing machine, 57

W

- Wash, 27
- Washing machine, 8
- Without final spin, 20
- Wool, 19

WXL166AGB/WXL146AGB/WXL127AGB
0104 en

SIEMENS ELECTROGERÄTE GMBH

5500 019 280