

T24ID100RP

24-INCH BUILT-IN FREEZER COLUMN WITH ICE & WATER DISPENSER

FREEDOM® COLLECTION, PANEL-READY, RIGHT-HAND DOOR SWING

Thermador★

IMAGES
COMING
SOON

 HomeConnect

Also Available In:
T24ID100LP – Left-Hand Door Swing

FEATURES & BENEFITS

- **Exceptional Interior Capacity** – Two new storage zones for increased capacity, adjustable glass shelving, and storage drawers for optimal organization.
- **In-Door Dispenser** – Enjoy refreshing, purified water and new bite-sized 1/4 Carat Diamond Ice. Features 3 customizable favorites for effortless dispensing.
- **Beauty Meets Visibility** – All-new larger sidewall LEDs, illuminate the interior beautifully, making contents easy to find from any angle.
- **Get Cooler Faster** – SuperFreeze® drops to -22°F, rapidly restoring softening ice creams, meats, and other goods to their optimal frozen state.
- **Free Flow® Cold Air System** – Ensures uniform airflow and optimal cooling across all compartments for unmatched performance and precision.

INNOVATION

New Interior Design & Compact Ice Maker	Yes
Wi-Fi-Enabled For Control with Home Connect® App	Yes
Bite Sized 1/4 Carat Diamond Ice	Yes
Full Stainless Steel Interior	Yes

PERFORMANCE

Quick Ice	Yes
Dedicated Evaporator & Compressor	Yes
Modes	
Demo, Quick Ice, SuperFreeze®	
Automatic Defrosting	Yes
External Water and Ice Dispenser	Yes
Water Filter (6 Months)	Yes

CAPACITY AND STORAGE

Total Capacity (cu. ft.)	N/A
Storage Drawers	3
Storage Shelves	2 Adjustable, 1 Fixed

GENERAL FEATURES

Touch Screen LED Panel	2
Water Filter Replacement Indicator	Yes
Ice On / Off	Yes
Quick Ice	Yes
LED Interior Lighting	Yes
Open Door Assist	Yes
Door Alarm	Yes
Childproof Lock	Yes
Cooling System	Free Flow® Cold Air System
Maximum Sound Level	39 dBA
SoftClose® Door	Yes
SoftClose® Drawers	Yes
Star-K Certified Sabbath Mode	TBD
ENERGY STAR® Certified	TBD
Annual Energy Consumption	TBD kWh / yr*

OPERATING TEMPERATURE

Freezer: -7°F (-22°C) to 6°F (-14°C)

SuperFreeze®: 22°F (-30°C) for Approximately 8 Hours

INSTALLATION FEATURES

Four Point Front Adjustable with 4 Wheels	Yes
Attachment Method to Cabinetry	
4 Fixation Brackets, Fixed at 4 Corners of Appliance, No Visible Screws	
Front Serviceable	Yes
Anti-tip Bracket Included	Yes
Side Trim Kit Included	Yes
Door Reversible	No
Door Hinge	Right

PRELIMINARY
PRELIMINARY
PRELIMINARY
PRELIMINARY

T24ID100RP
24-INCH BUILT-IN FREEZER COLUMN WITH
ICE & WATER DISPENSER
FREEDOM® COLLECTION, PANEL-READY, RIGHT-HAND DOOR SWING



TECHNICAL SPECS	
Required Power Supply	110-120 V, 60 Hz, Min. 10 Amp
Plug Type	3-Prong
Power Cord Length (Inches)	118"
DIMENSIONS AND WEIGHT	
Appliance Dimensions (HxWxD) (inches)	83 9/16" Min. – 85 1/2" Max. x 23 3/4" x 24"
Required Cutout Size (HxWxD) (Inches)	84" x 24" x 25"
Net Weight (Approx.) (lbs.)	TBD
Gross Weight (Approx.) (lbs.)	TBD

*Estimated annual energy consumption. Exact usage may vary.

WARRANTY	
Limited Warranty, Parts & Labor	2 Years
Limited Warranty, Sealed System and Compressor, Parts & Labor	6 Years
Limited Warranty, Sealed System and Compressor, Parts Only	12 Years
SUPPLEMENTAL MATERIAL	
CAD File	TBD
Installation Manual	TBD
Use & Care Guide	TBD
Warranty	TBD
Energy Guide	TBD
Home Connect® Quick Start Guide	TBD

ACCESSORIES (OPTIONAL)

COMING SOON

PRELIMINARY
PRELIMINARY
PRELIMINARY
PRELIMINARY
PRELIMINARY

T24ID100RP
24-INCH BUILT-IN FREEZER COLUMN WITH
ICE & WATER DISPENSER
FREEDOM® COLLECTION, PANEL-READY, RIGHT-HAND DOOR SWING



PRODUCT & CUTOUT DIMENSIONS



TOP VIEW CLEARANCES

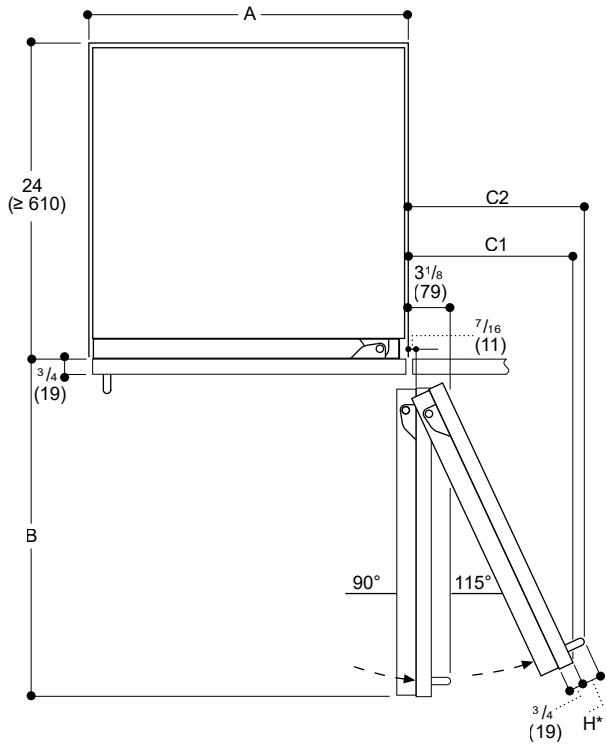

Niche width				
A	B	C1	C2-Masterpiece	C2-Professional
18 (457)	20 ¹¹ / ₁₆ (525)	9 ¹ / ₄ (235)	TBD	
24 (610)	26 ⁵ / ₈ (677)	11 ³ / ₄ (299)		
30 (762)	32 ¹¹ / ₁₆ (830)	14 ⁵ / ₁₆ (364)		
36 (914)	38 ¹ / ₁₆ (970)	16 ³ / ₁₆ (420)		

The drawing is based on a door panel thickness of 3/4" (19 mm)
as well as the *handle height (options below):
Thermador Masterpiece handle of 2 1/4" (56 mm)
Thermador Professional handle of 2 5/8" (67 mm)
Measurements in inches (mm)

PRELIMINARY
PRELIMINARY
PRELIMINARY
PRELIMINARY
PRELIMINARY

T24ID100RP
24-INCH BUILT-IN FREEZER COLUMN WITH
ICE & WATER DISPENSER
FREEDOM® COLLECTION, PANEL-READY, RIGHT-HAND DOOR SWING



PANEL DIMENSIONS



PANEL DIMENSIONS WITH HANDLE



These warranties give you specific legal rights and you may have other rights that vary from state to state. Limited warranty from date of delivery. For complete warranty details, refer to your Use & Care manual, or ask your dealer.

Specifications are for planning purposes only. Refer to installation instructions and consult your countertop supplier prior to making counter opening. Consult with a heating and ventilation engineer for your specific ventilation requirements. For the most detailed information, refer to installation instructions accompanying product or write to Thermador indicating the model number. Specifications are correct at time of printing. Thermador reserves the right to change product specifications or design without notice. Some models are certified for use in Canada. Thermador is not responsible for products that are transported from the U.S. for use in Canada.