

# Dishwasher



Scan code to find out more

## 60cm speedMatic Modular dishwasher SC76M542EU

<b>Capacity</b>	7 place settings	
<b>6 Programmes</b>	<ul style="list-style-type: none"> <li>Intensive Wash 70°C</li> <li>Auto Wash 45 - 65°C</li> <li>Eco Wash 50°C</li> </ul>	<ul style="list-style-type: none"> <li>Glass Wash 40°C</li> <li>Quick Wash 45°C</li> <li>Pre Rinse</li> </ul>
<b>Functions</b>	<ul style="list-style-type: none"> <li>varioSpeed Plus</li> <li>hygienePlus</li> </ul>	<ul style="list-style-type: none"> <li>intensiveZone</li> <li>extraDry</li> </ul>
<b>Technology</b>	<ul style="list-style-type: none"> <li>aquaSensor</li> <li>Heat exchanger</li> </ul>	<ul style="list-style-type: none"> <li>aquaStop anti-flood system</li> <li>iQdrive technology</li> </ul>
<b>Flexibility</b>	<ul style="list-style-type: none"> <li>Cutlery basket</li> <li>1-24 hours delay start timer</li> </ul>	
<b>Design</b>	<ul style="list-style-type: none"> <li>Stainless steel color panel</li> <li>LED front panel display with remaining time indicator</li> </ul>	
<b>Safety</b>	Control panel lock	
<b>Technical Information</b>	<ul style="list-style-type: none"> <li>Consumption rates (Eco Wash 50°C programme)                             <ul style="list-style-type: none"> <li>- Water 9L</li> <li>- Electricity 0.66kWh</li> </ul> </li> <li>Noise level 47dB</li> <li>Total connected load 2.4kW (13A)</li> </ul>	
<b>Appliance Dimensions (H x W x D)</b>	595 x 595 x 500mm	
<b>Country of Origin</b>	Spain	
<b>Expert Services</b>	<ul style="list-style-type: none"> <li>Product consultation with unlimited product hotline inquiry</li> <li>Kitchen planning consultation with pre-installation site measurement</li> <li>Professional installation</li> </ul>	
<b>Recommended Retail Price</b>	HK\$16,800	

† 99.999% reduction on Escherichia coli, Staphylococcus aureus in Eco 50°C program, HKTEC2000415202 (date 08/20) issued by SGS Hong Kong Limited.

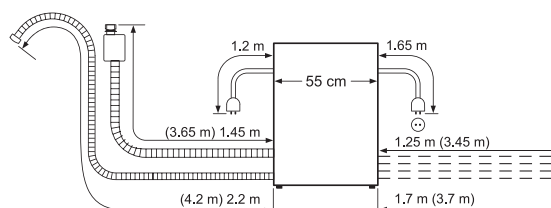
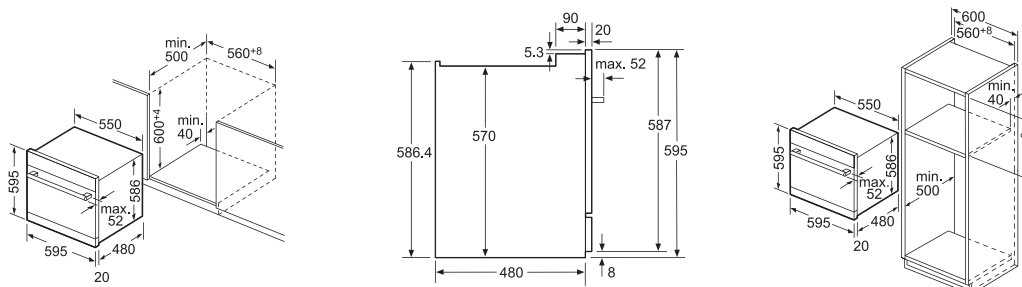

Nominal lengths:  
 AquaStop: 1.65 m  
 Drain hose: 2.15 m  
 Mains cable: 1.75 m  
 Extension:  
 AquaStop: 2.20 m  
 Drain hose: 2.00 m

\* Please ensure the plinth panel is removable.  
 Measurements in mm

**BSH Home Appliances Limited**

BSH Home Appliances Group is a Trademark Licensee of Siemens AG  
**Customer Contact Hotline:** 2565 6151 (Hong Kong) / 0800 030 (Macau local call only)  
 Website: www.siemens-home.bsh-group.com.hk

• Specification and technical information subject to change.  
 • Right of technical modification reserved, colours may vary slightly from illustrations.  
 © 2021 by BSH Home Appliances Limited. Reproduction, complete or in part, only with the express permission of BSH.