

The Siemens logo is displayed in a white rectangular box in the top left corner. It consists of the word "SIEMENS" in a bold, teal, sans-serif font.

SIEMENS



Kitchen design with no limits: Induction with integrated ventilation

5
YEAR
WARRANTY
CONDITIONS APPLY



Enjoy more freedom in kitchen planning with the inductionAir system. This space-saving concept combines two extraordinary appliances: a flexInduction cooktop and revolutionary integrated ventilation.

The future moving in.

Siemens Home Appliances

Flexibility and design that inspire.

Integrated design that maximises cooking space.

The modern design of the cooktop is paired with a fully integrated, flush air inlet, combining two high performance appliances into one sleek, integrated design piece. The streamlined inlet maximises surface space for your cookware, while flexInduction technology allows cooking zones to be combined to accommodate pans of any size, and even several pans placed anywhere on the surface at the same time.

Get there faster.

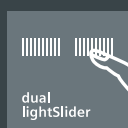

Quick and easy controls.

With a 30-centimetre wide display that maximises ease-of-use, the Dual lightSlider responds to the lightest touch, and gives you more information about your cooking zones for instant oversight.



Have your pan ready in no time.

The new power level for quickly and safely heating pans, panBoost applies extreme heat to your pan for 30 seconds and then automatically resets the cooking zone to Level 9.

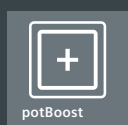

Boil water faster.

potBoost heats your pot of water by applying up to 50% higher heat for 10 minutes and then automatically resetting the cooking zone to Level 9.



Smart automation.



Always fresh with minimal noise.

No need to adjust or regulate the extraction power level. An intelligent sensor detects the level of steam and odours rising from the cooking and automatically adjusts the extraction power level, for more effective and efficient extraction.

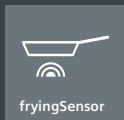

No more scorching.

For a controlled frying temperature, simply choose from a range of automatic programs according to the type of food being cooked, and Frying Sensor will apply the ideal setting. A signal tone will let you know when the ideal frying temperature has been reached.



Follow your cookware wherever it goes.

Any time you choose to re-arrange a piece of cookware, the induction surface detects this and reacts immediately. This means you can move your pots and pans around without losing any of the settings you've associated with each pan. The power at the pot's previous location is automatically switched off.

Convenience like never before.



A highly reliable extractor, minus the extra cleaning work.

The Siemens inductionAir cooktop is user-friendly both during and after cooking, with cleaning being simpler than ever. The flush extractor has a triple overflow protection to prevent liquids from entering the system. If something should tip over, everything is collected in a container below, which also incorporates the new grease filters. Now accessible from above, the entire unit fits easily into the top basket of a dishwasher. The cooktop is soon ready for use again.



Home Connect: stay connected to the future.

Control your WiFi enabled cooktop with the Home Connect App.

The Home Connect App gives you access to the inductionAir cooktop from anywhere. Send recommended settings for a recipe directly to the cooktop. Control the extraction level from the comfort of your sofa. Display the degree of filter saturation, or check that your cooktop is switched off while you're on the move.





An innovative space-saving concept. For an uncompromisingly individual kitchen.



Prestigious and functional in equal measure: the intelligent and compact concept of the inductionAir cooktop frees you from many restrictions when planning your kitchen. Because no external extractor hood is required, you can align your kitchen island to give an unobstructed view of the living area or set your own accents with atmospheric light. The system is just as suitable for space-saving kitchen units: it can even be placed under a sloping roof or directly against a window. The days when the floor plan dictated the kitchen design are over: you can now turn your own ideas into reality – with no compromises.



Kitchen planning.

Wall or island design?

The new inductionAir cooktop knows no limits. Whether it's functional, space-saving wall planning or an open-plan living concept with an island design, the possibilities are endless – the new inductionAir always fits in seamlessly.



Ducted or recirculated extraction?

The inductionAir cooktop is available in both ducted and recirculation extraction configurations.



In a **ducted extraction** configuration, a standard flat duct system discharges cooking steam and vapours through an opening in the wall in order to eliminate the cooking odours.



In a **recirculation configuration**, the cooking steam is additionally filtered through powerful and durable active carbon filters that eliminate odours and are comfortably and conveniently accessible from the top of the appliance. Because of their integration into the appliance itself, the recirculation filters don't need to be installed in less accessible areas like the flat duct system or behind the drawers in the base cabinet area – which further facilitates planning and expands the design options. Recirculation configurations are possible as ductless, partly ducted or fully ducted configurations in order to meet any design requirements or preferences.

Drawer and worktop depths.



Because of the flat duct elements being installed behind the furniture in all configurations, there are no restrictions on drawer depths.

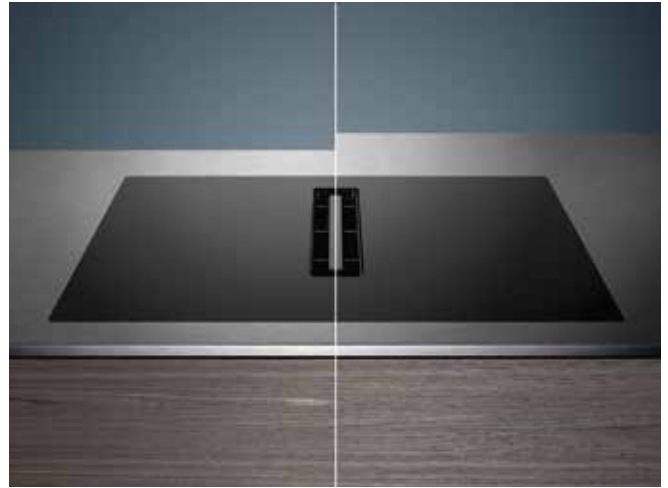

Planning and installation of ductless recirculation configurations is possible with a worktop depth from 600mm. Planning and installation of (partly) ducted recirculation or ducted extraction configurations is possible with a worktop depth from ≥ 700 mm. However by using the 90° flat duct vertical with medium radius, the cooktop can be installed even in a 650mm deep worktop.

Worktop thickness.



Installation of the inductionAir Plus requires an installation thickness ≥ 16 mm.

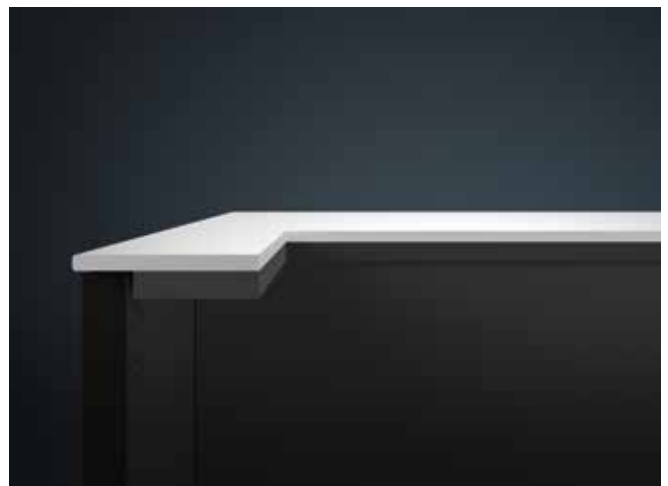

If the worktop is thinner than 16mm, the inductionAir Plus can still be easily installed. Simply ensure that an installation depth ≥ 16 mm is achieved in the installation area – for example, by doubling the material.

The thinner the installation thickness and worktop, the more important it is to ensure its load-bearing capacity and stability. The cooktops own weight combined with a full load of pots and their contents can weigh as much as 60kg. The worktop must be able to provide this level of stability. The worktop manufacturers structural integrity specifications should be taken into account.

Installation accessory options.

One of the following accessories must be used for installation of the EX875LX67E cooktop.

Ducted Extraction.

HZ9VEDU0*

Fully ducted

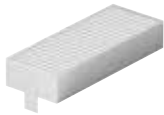

Installation kit for ducted extraction.

Your installer will be required to organise additional ducts.

It includes:

- 4 high-performance, low-noise acoustic filters for significantly lower noise and strongly improved psychoacoustics.
- A sealing gasket that can be attached onto a male flat duct before inserting the element into the appliance to ensure air tightness (The air outlet on the back-side of the appliance can be directly accessed with a male flat duct element (DN 150)).

Recirculation Extraction.

HZ9VRUD0

Ductless



Installation kit for recirculation extraction in an island bench or against an internal wall.

No additional duct elements required.

It includes:

- 4 high-performance cleanAir odour filters with optimised odour reduction performance for cooking applications with complex odour molecules (eg. fish). Large scale filter surfaces with high odour reduction capabilities and a lifetime of 360 hours of cooking (non-regenerative). Filters are additionally optimised for low-noise with optimised psychoacoustics.
- A telescopic slider element with integrated sealings and a self-gluing fixation frame to easily connect the appliance's air outlet with the cutout in the back panel of the furniture.

A return-flow aperture of $\geq 400\text{cm}^2$ is to be respected in the plinth area. This configuration requires a vertical aperture of min. 25mm behind the back panel of the furniture. Suggested for ideal ventilation performance is 50mm.

HZ9VRPD0*

Partially ducted



Installation kit for recirculation extraction against an external wall.

Your installer will be required to organise additional ducts if you are using this accessory.

It includes:

- 4 high-performance cleanAir odour filters with optimised odour reduction performance for cooking applications with complex odour molecules (eg. fish). Large scale filter surfaces with high odour reduction capabilities and a lifetime of 360 hours of cooking (non-regenerative). Filters are additionally optimised for low-noise with optimised psychoacoustics.
- A diffuser element that can be directly connected to the flat duct elements and that spreads the out-flowing air in the plinth area for partly ducted recirculation configurations. The diffuser can also be directly connected to the air outlet element with adhesive tape for fully ducted recirculation configurations.
- Adhesive tape to ensure a direct connection between the diffuser and the air outlet element such as lamella grids or outlet grids supplied by the kitchen furniture manufacturers.
- A sealing gasket that can be attached onto a male flat duct before inserting the element into the appliance to ensure air tightness (The air outlet on the back-side of the appliance can be directly accessed with a male flat duct element (DN 150)).

Fully ducted



The elements enable highly flexible and customized ducted planning – all further necessary flat ducting elements (DN 150) must be ordered additionally. A return-flow aperture of $\geq 400\text{cm}^2$ is to be respected in the plinth area.

*Flat duct elements are not included in the accessories pack and need to be ordered separately as a spare part based on the individual planning situation. Please contact 1300 167 425 for more information.

Ducting elements.

When installing the inductionAir cooktop in either a fully ducted configuration or a partly/fully ducted recirculation configuration, additional ducting elements are required. To guarantee compatibility between the ventilation outlet of the cooktop and the ducting elements, we recommend using the below Siemens ducting elements.

The following ducting elements and cleanAir replenishment filter are available for purchase via Siemens Spare Parts. For more information visit www.siemens-home.bsh-group.com.au/customer-service/support/spareparts-accessories, or call **1300 167 425** to place an order.



17004796

cleanAir recirculation replenishment filter

4 directly integrated, high-performance cleanAir odour filters (in recirculation configuration) for replenishment.



17005031 / 17005346

Straight tube 500mm / 1000mm

Straight flat-duct tube element (male).



17005352

90° flat duct vertical (Large Radius)

Connector flat / round with integrated 90° bow for appliances with vertical round air outlet (male).



17005036

90° flat duct vertical (Medium radius)

Vertical 90° bow with smaller radius for ducting (partly) within the furniture (from 65cm worktop depth) (male).



17005039

Connector sleeve (female)

Connector flat / round Ø 150mm. Round-flat adapter element (male).



17005353

Adapter round-flat

Connector flat / round with integrated 90° bow for appliances with vertical round air outlet (male part).



17005354

90° Adapter round-flat

Connector flat / round with integrated 90° bow for appliances with vertical round air outlet (male part).



17005351

90° flat duct bend horizontal

90° flat duct bend element (male) in horizontal configuration.

Configuration example* for partly ducted installation in a 70cm deep worktop:

Venting Cooktop



HZ9VRPD0 Installation kit for partly/fully ducted extraction



90° flat duct large (17005352)
+ connector sleeve (17005039)



straight tube 1000mm (17005346)
+ connector sleeve (17005039)



90° flat duct large (17005352)
+ connector sleeve (17005039)

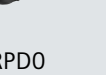

Diffuser from installation kit HZ9VRPD0

Male parts always need to be connected with a female sleeve.

*Please note that the above is just an example. Please discuss with your installer which elements you require in your individual installation situation.



Installation diagrams.

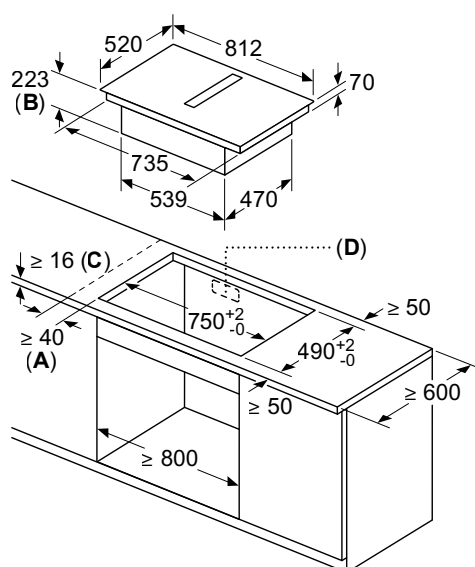

A – Minimum distance between cut-out and wall.

B – Immersion depth.

C – The worktop into which the appliance is installed should be able to withstand loads up to approximately 60kg – if necessary using suitable substructures.

D – A cut-out in the furniture's back panel is necessary for ductings. The exact size and position can be taken from specific drawings.

Dimensional drawings of the air outlet

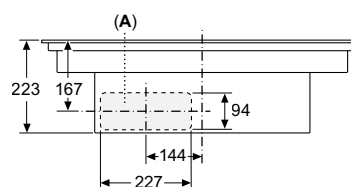

A – Connected directly at the rear.

Measurements in mm

inductionAir flexInduction® cooktop.

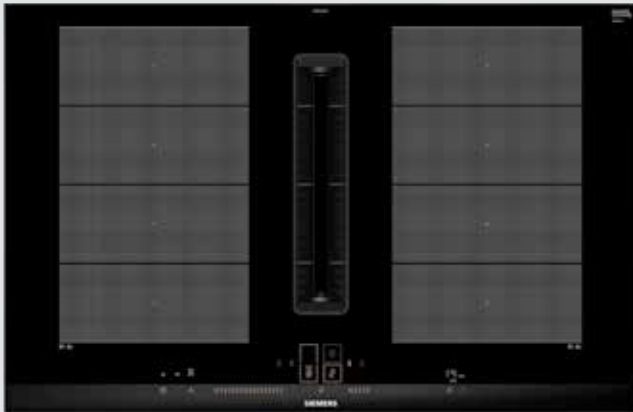

80cm inductionAir flexInduction® cooktop

Model	EX875LX67E
Features	4 cooking zones convertible to 2 x flexZones 17 power settings with powerBoost LED display with dual lightSlider controls Home Connect ready Child lock
Ventilation	622m³/h* maximum extraction rate 17 power levels + 2 intensive settings with auto-reset 42 / 69dB (min / max) iQdrive brushless motor
Design	Black ceramic glass with faceted front, stainless steel side profiles
Installation	Installation kit HZ9VEDU0, HZ9VRUD0 or HZ9VRPD0 required for installation (accessory sold separately)
Appliance dimensions (WxD)	812 x 520mm
Installation dimensions (HxWxD)	223 x 750 x 490mm

*Measured according to EN61591; suitable for ducted extraction or recirculation (accessory is respectively required).

Dimensional drawings for installations in ductless recirculation configurations.

Recommended for installation in an island bench or against an internal wall.

Side view

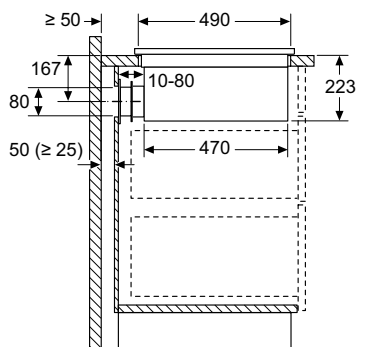

Position of cut out within the back panel of the furniture

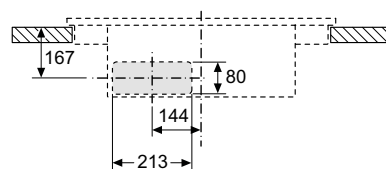

Dimensional drawings for installations in (partly) ducted recirculation and ducted extraction configurations.

Front view

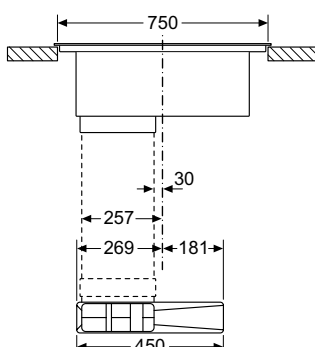

Side view

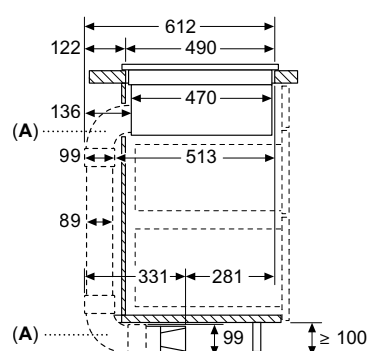

A: With 90° flat duct vertical (large radius).

Our services

Siemens Customer Care

1300 167 425

24 hour phone support

7:00am Monday to midnight Friday AEST

For product information and user guidance,
technical assistance, repair queries and servicing
appointments, warranty information
and dealer locations.

siemens-home.bsh-group.com.au

Product information and user guidance,
downloadable brochures and user manuals,
technical data and warranty information.

BSH Home Appliances Pty Ltd

BSH Group is a Trademark
Licensee of Siemens AG

1555 Centre Road
Clayton VIC 3168

Phone: 03 8551 1100

Fax: 03 8551 1182

siemens-home.bsh-group.com.au

Important Notes:

Certain appliances shown in this catalogue are not available in your country. Model numbers and specifications are for reference only and subject to change without prior notice. Please contact your local Siemens retailer for the latest information.

Siemens is continuously seeking to improve specification, design and production to its appliances and alterations may take place regularly.

All descriptions and installation diagrams are intended as a guide only. For additional technical information, full dimensional and installation details, please refer to the instruction manual supplied with the appliance.

The electrical and gas connection should only be made in accordance with the regulations of the national authorities.

Right of technical modification reserved, delivery subject to availability. Due to variation in photographic and printing processes, colours of actual products may vary slightly from illustrations. ®Registered trademark.

©2021 by BSH Home Appliances Pty Ltd. Reproduction, complete or in part, only with the express permission of the publisher.

BSH Home Appliances Pty. Ltd. ABN 22 109 198 405

While every care has been taken in the preparation of this publication, BSH Home Appliances Pty Ltd does not warrant the accuracy or completeness of the information in this publication and BSH Home Appliances Pty Ltd reserves the right to alter specifications without notice. To the extent permitted by law, BSH Home Appliances Pty Ltd excludes all liability, including negligence, for any loss incurred in reliance on the contents of this publication.