



SIEMENS



# Washing machine

WM16W640EU

[siemens-home.bsh-group.com/welcome](https://siemens-home.bsh-group.com/welcome)

**en** Instruction Manual and Installation Instructions

Register  
your  
product  
online

## Your new washing machine

You have chosen a Siemens washing machine.

Please take a few minutes to read and become familiar with the advantages of your washing machine.

To meet the high quality demands required by Siemens, every washing machine that leaves our factory is carefully checked to ensure that it functions correctly and is in perfect condition.

For more information on our products, accessories, replacement parts and services, see our website [www.siemens-home.bsh-group.com](http://www.siemens-home.bsh-group.com) or contact our after-sales service centres.

If the operating and installation instructions describe different models, any differences will be pointed out at the relevant points in the text.



Read these operating and installation instructions before switching on the washing machine.

### Display rules

#### **Warning!**

This combination of symbol and signal word indicates a possibly dangerous situation. Not heeding the warning can cause death or injuries.

#### **Caution!**

This signal word indicates a possibly dangerous situation. Not heeding the caution can cause property and/or environmental damage.

### Note/tip

Information about the optimum use of the appliance/any other useful information.

#### **1. 2. 3. / a) b) c)**

The steps are represented by numbers or letters.

■ / -

Lists are represented by a small box or a dash.

# Contents

	<b>Intended use</b> . . . . .	5
--	-------------------------------	---

	<b>Safety instructions</b> . . . . .	6
--	--------------------------------------	---

Electrical safety . . . . .	6
Risk of injury . . . . .	6
Safety for children . . . . .	7

	<b>Environmental protection</b> . . . . .	8
--	---	---

Packaging/used appliance . . . . .	8
Tips on economical use . . . . .	8

	<b>Main points in brief</b> . . . . .	9
--	---------------------------------------	---

	<b>Getting to know the appliance</b> . . . . .	10
--	--	----

Washing machine . . . . .	10
Control panel . . . . .	11
Display panel . . . . .	12

	<b>Laundry</b> . . . . .	14
--	--------------------------	----

Prepare the laundry . . . . .	14
Sorting laundry . . . . .	14

	<b>Detergent</b> . . . . .	15
--	----------------------------	----

Correct selection of detergent . . . . .	15
Saving energy and detergent . . . . .	15



	<b>Overview of programmes</b> . . . . .	16
---	---	----

Programmes on the programme selector . . . . .	16
Starching . . . . .	22
Dyeing/bleaching . . . . .	22
Soaking . . . . .	22

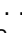
	<b>Programme default settings</b> . . . . .	22
--	---	----

Temperature . . . . .	22
Spin speed  . . . . .	22
Finish in  . . . . .	23
i-Dos settings . . . . .	23

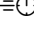
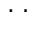
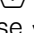
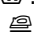
	<b>Additional programme settings</b> . . . . .	24
---	--	----

speedPerfect  . . . . .	24
ecoPerfect  . . . . .	24
Prewash  . . . . .	24
Extra Rinse  . . . . .	24
Less Ironing  . . . . .	24

	<b>Operating the appliance</b> . . . . .	24
---	--	----

Preparing the washing machine . . . . .	24
Switching on the appliance/ selecting a programme . . . . .	25
Placing laundry into the drum . . . . .	25
Measure and add detergent and care products . . . . .	25
Change the programme default settings . . . . .	26
Select additional programme settings . . . . .	26
Start the programme . . . . .	26
Child lock . . . . .	26
Adding laundry . . . . .	27
Changing the programme . . . . .	27
Cancel the programme . . . . .	27
Programme end during rinse hold. . . . .	27
Programme end . . . . .	27
Removing laundry/ switching off the appliance . . . . .	28

	<b>Intelligent dosing system</b> . . . . .	28
---	--	----

Intelligent dosing system in the detergent drawer . . . . .	28
Initial use/filling the dispensers . . . . .	29
Everyday use . . . . .	30
Basic settings . . . . .	30
Manual dosage . . . . .	31

	<b>Appliance settings</b> . . . . .	<b>32</b>		<b>Positioning and connecting</b> . .	<b>45</b>
	Activating the setting mode . . . . .	32		Included with the appliance . . . . .	45
	Changing the signal volume . . . . .	33		Safety instructions . . . . .	46
	Selecting/deselecting the appliance automatic switch-off. . . . .	33		Installation surface . . . . .	46
	Switching the drum-care information signal on/off . . . . .	33		Installation on a base or a wooden joist floor . . . . .	46
	Exiting setting mode . . . . .	33		Installation on a platform with drawer. . . . .	46
	<b>Sensors</b> . . . . .	<b>33</b>		Installing the appliance in a kitchenette. . . . .	47
	Automatic load sensing . . . . .	33		Removing the transport locks. . . . .	47
	Unbalanced load detection system . . . . .	33		Hose and cable lengths . . . . .	48
	AquaSensor . . . . .	33		Water inlet . . . . .	49
	<b>Cleaning and maintenance</b> . . . . .	<b>34</b>		Water outlet . . . . .	50
	Machine housing/control panel . . . . .	34		Levelling . . . . .	51
	Drum . . . . .	34		Electrical connection . . . . .	51
	Descaling. . . . .	34		Before washing for the first time. . . . .	52
	i-Dos detergent draw and its housing . . . . .	35		Transportation . . . . .	53
	The drain pump is blocked, emergency draining. . . . .	36		<b>Aqua-Stop warranty</b> . . . . .	<b>54</b>
	The drain hose at the siphon is blocked . . . . .	37			
	Filter in the water supply blocked . . . . .	37			
	<b>Faults and what to do about them.</b> . . . . .	<b>38</b>			
	Emergency release . . . . .	38			
	Information on the display panel . . . . .	39			
	Faults and what to do about them. . . . .	40			
	<b>After-sales service</b> . . . . .	<b>42</b>			
	<b>Consumption rates</b> . . . . .	<b>43</b>			
	Energy and water consumption, programme duration and residual moisture for the main washing programmes . . . . .	43			
	Efficiency test programmes for cotton fabrics . . . . .	44			
	<b>Technical data</b> . . . . .	<b>44</b>			



## Intended use

- For private domestic use only.
- The washing machine is suitable for washing machine-washable fabrics and hand-washable wool in detergent solution.
- To be operated with cold mains water and standard detergents and care products which are suitable for use in washing machines.
- When measuring out the amount of all detergents, additives, care products and cleaning agents, always follow the manufacturer's instructions.
- The washing machine may be used by children over the age of 8 years and by persons with reduced physical, sensory or mental capacity or by persons with a lack of experience or knowledge if they **are supervised** or have been **instructed** by a responsible person. Children must not carry out any cleaning or maintenance work without supervision.
- Keep children under the age of 3 years away from the washing machine.
- This appliance is intended for use up to a maximum height of 4000 metres above sea level.
- Keep pets away from the washing machine.

**Before operating the appliance:** Read the installation and operating instructions and all other information enclosed with the washing machine, and use the machine accordingly. Retain the documents for subsequent use or for subsequent owners.

## Safety instructions

### Electrical safety

#### **Warning** **Danger of death!**

There is a risk of electric shock if you touch live components.

- Never touch or hold the mains plug with wet hands.
- Only pull out the mains cable by the plug and never by the cable, as this could damage it.

### Risk of injury

#### **Warning** **Risk of injury!**

- When the washing machine is lifted by its protruding parts (e.g. the washing machine door), the components may break off and cause injuries.  
Do not lift the washing machine by protruding parts.
- If you climb on the washing machine, the worktop may break and cause injuries.  
Do not climb onto the washing machine.
- If you lean on the washing machine door when it is open, the washing machine may tip over and cause injuries.  
Do not lean on the washing machine door when it is open.

- Reaching into the drum when it is turning can cause injuries to hands.  
Do not reach into the drum when it is turning.  
Wait until the drum has stopped turning.

#### **Warning** **Risk of scalding!**

When you are washing at high temperatures, there is a risk of scalding if you come into contact with hot water e.g. if hot water is being drained into a wash basin.  
Do not reach into the hot detergent solution.

## Safety for children

### **Warning**

#### **Danger of death!**

If children play with the washing machine, they may get into life-threatening situations or injure themselves.

- Do not leave children unattended near the washing machine.
- Do not let children play with the washing machine.

### **Warning**

#### **Danger of death!**

Children may lock themselves in appliances, putting their lives at risk.

For appliances that have reached the end of their service life:

- Disconnect the mains plug.
- Cut through the mains cable and remove it, along with plug.
- Destroy the lock on the washing machine door.

### **Warning**

#### **Risk of suffocation!**

Children may become wrapped in packaging/film or packing parts if allowed to play with them, or they may pull them over their heads and suffocate. Keep packaging, film and packaging parts out of the reach of children.

### **Warning**

#### **Risk of poisoning!**

Detergents and care products may be poisonous if consumed.

Keep detergents and care products out of the reach of children.

### **Warning**

#### **Eye/skin irritation!**

Detergents and care products may cause irritation if they come into contact with the eyes or skin.

Keep detergents and care products out of the reach of children.

### **Warning**

#### **Risk of injury!**

When you wash at high temperatures, the glass in the washing machine door gets hot.

Do not let children touch the hot washing machine door.



## Environmental protection

### Packaging/used appliance



Dispose of packaging in an environmentally-responsible manner.

This appliance is labelled in accordance with European Directive 2012/19/EU concerning used electrical and electronic appliances (waste electrical and electronic equipment - WEEE).

The guideline determines the framework for the return and recycling of used appliances as applicable throughout the EU.

### Tips on economical use

- Always fill the appliance with the maximum amount of laundry for the relevant programme.  
Overview of programmes  
→ *Page 16*
  - Wash normally soiled laundry without a prewash.
  - Save energy and detergent when washing lightly and normally soiled laundry. → *Page 15*
  - Using the **intelligent dosing system** (i-Dos) to dose your detergent helps you to save detergent and use less water.
  - The selectable temperatures apply to the care labels on the textiles. The temperatures in the machine may deviate from this so that you get the optimum mix of energy-saving and washing results.
- **Information on energy and water consumption:** → *Page 12*  
The displays provide information about the relative level of energy and water consumption in the selected programmes.  
The more indicator lights light up, the higher the programme's consumption.  
This enables you to compare the consumption levels of the different programmes when choosing your programme settings and decide on an energy- and water-saving programme setting.
  - **Energy-saving mode:** The display panel lighting goes out after a few minutes and the ►|| button flashes. Press any button to activate the lighting.  
Energy-saving mode is not activated if a programme is running.
  - **Automatic switch off:** If the appliance is not operated for a prolonged period, it may automatically switch off before the programme starts and when the programme has ended to save energy. Press the main switch again to switch on the appliance.  
Switching the → *Page 32* function on/off
  - If the laundry is subsequently dried in a tumble dryer, select the spin speed according to the tumble dryer manufacturer's instructions.





## Main points in brief

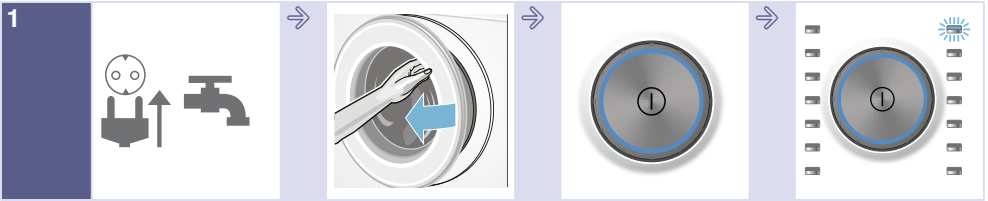

1  
Connect the mains plug. Turn on the tap.

Open the door.

To switch on, press the  button.

Select a programme, e.g. **Cottons**.



2  
Sort the laundry.

Observe the maximum load (depending on the model) on the display panel.

Load the laundry.

Close the door.



3  
If necessary, change the default programme settings and/or select additional settings.

Start the programme.

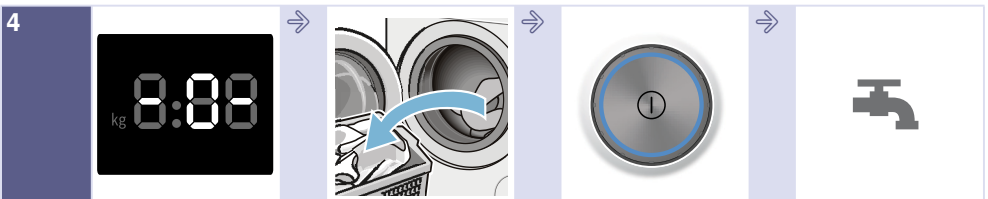

4  
End of the programme

Open the door and remove the laundry.

To switch off, press the  button.

Turn off the tap (for models without Aqua-Stop).

## Getting to know the appliance

### Washing machine

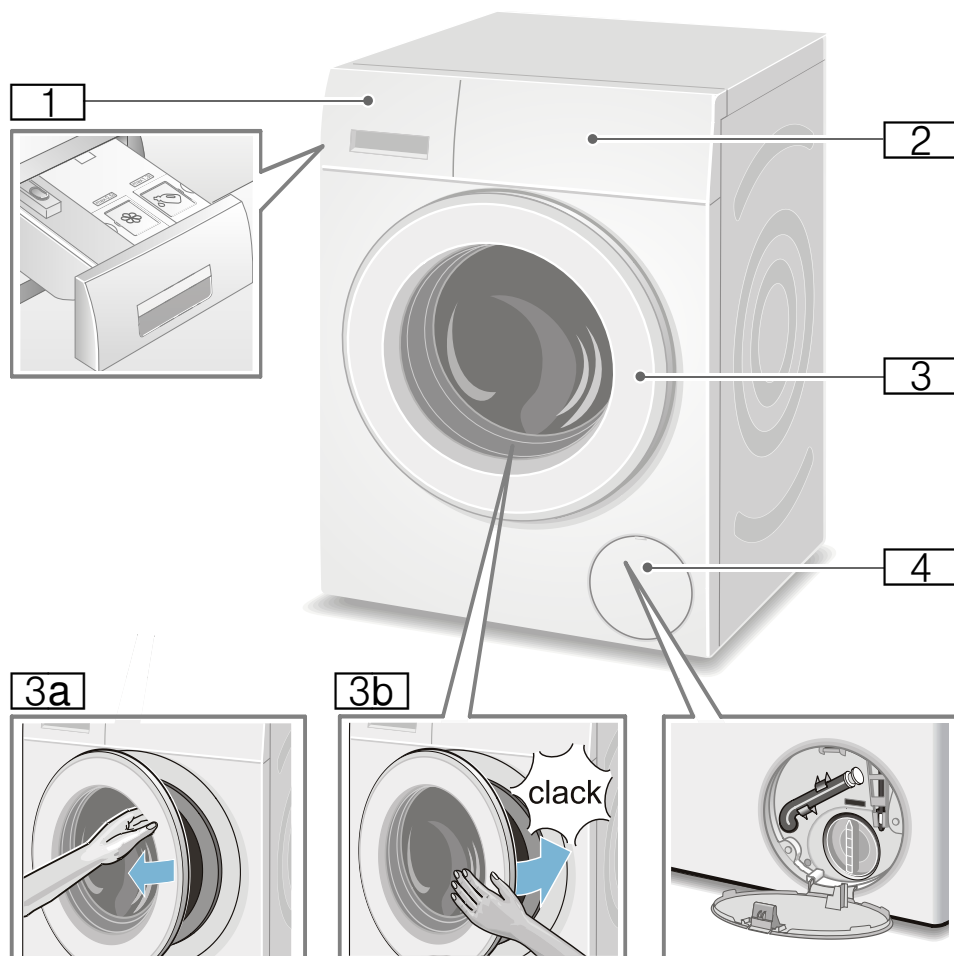

- 1** Detergent drawer → *Page 25*
- 2** Operating/display panel
- 3** Door with door handle
- 3a** Open the door
- 3b** Close the door
- 4** Service flap

## Control panel

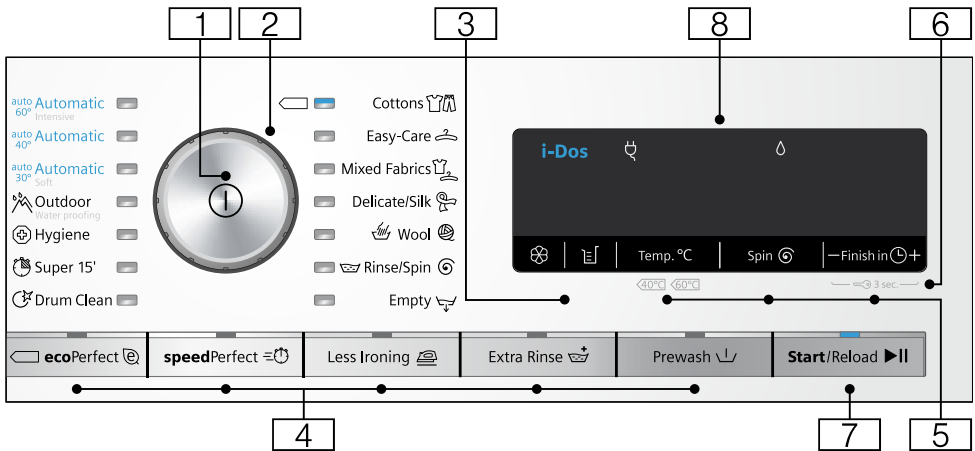

**Note:** All the buttons are sensitive (except for the main switch) and only need to be pressed lightly.

- 1 Main switch**  
for switching the washing machine on and off:  
Press the ① button.
- 2 Programme selector**  
for selecting a programme:  
Overview of programmes  
→ *Page 16*
- 3 i-Dos settings** → *Page 28*
- 4 Additional programme settings:**  
→ *Page 24*
  - speedPerfect ≡⏸,
  - ecoPerfect @,
  - Prewash ↓,
  - Extra Rinse ⚑,
  - Less Ironing 🧺
- 5 Changing the default programme settings:** → *Page 22*
  - Temperature (Temp. °C),
  - Spin speed Ⓞ,
  - Finish in ⌚ time

- 6 Child lock** (⏸ 3 sec.)  
to prevent the set functions from being changed accidentally:  
Press and hold the **Finish in** ⌚ + and - button at the same time for approx. 3 seconds to activate this function. → *Page 26*
- 7 ▶|| button for:**
  - Starting a programme
  - Interrupting a programme, e.g. to add items of laundry  
→ *Page 27*
  - Cancelling a programme  
→ *Page 27*
- 8 Display panel** for settings and information. → *Page 12*

## Display panel

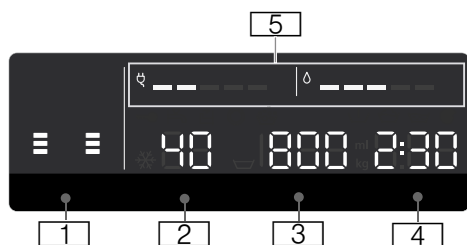

### Default programme settings:

#### 1 i-Dos settings

- **Detergent:**
  - for lightly soiled laundry,
  - for medium soiled laundry,
  - for heavily soiled laundry→ Page 23,
- **Fabric softener:**
  - for soft laundry,
  - for medium soft laundry,
  - for very soft laundry→ Page 23,
- automatic dosage deselected,
- flash; the fill level of the respective container has dropped below the minimum level, filling → Page 28

#### 2 Temperature in °C

\* - 90 (\* = cold)

#### 3 Spin speed in rpm,

- , 0 - 1600\*;  
\* Max. spin speed, depending on the selected programme and model,
- 0 = no spin cycle, draining only → Page 22,
- = Rinse Stop → Page 22

#### 4 Finish in time

e.g. 2:30;  
Programme duration depends on the programme selection in h:min (hours:minutes),

##### ■ Preselection of end time

1 - 24 h;  
Programme ends after... h  
(h = hours),

##### ■ Base dosing quantity

ml 10-200 → Page 30





##### ■ Load recommendation

e.g. kg 9\*;  
\* depending on the selected programme



#### 5 Information on energy and water consumption: → Page 8

- = = = = =  
Water consumption display,
- = = = = =  
Energy consumption display

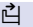

**Further information****Programme progress:**

	Prewash
	Washing
	Rinse
	Spin
- 0 -	Programme end
	Programme end during Rinse Stop
- P -	Pause, e.g. to reload laundry



**Detergent drawer:**

	Detergent drawer has been pulled out.
	When the programme has started: Detergent drawer not fully pushed in.

**Washing machine door:**

	The washing machine door can be opened.
	When the programme has started: The washing machine door is not closed properly.

**Tap:**

	Tap not turned on, no water pressure
	Water pressure too low (may increase the programme duration)

**Childproof lock:** → *Page 26*

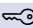
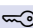
	Childproof lock activated
	Childproof lock activated, programme selector adjusted

**Foam detection:**

	→ <i>Page 26</i>
lights up	

**Fault display:**

E: --	→ <i>Page 39</i>
-------	------------------

**Signal setting:**

0 - 4	→ <i>Page 32</i>
-------	------------------

**Further information****Switching off the appliance automatically:**

On OFF → *Page 8*, → *Page 33*



## Laundry

### Prepare the laundry

#### Caution!

#### Damage to the appliance/fabrics

Foreign objects (e.g. coins, paperclips, needles, nails) may damage the laundry or components in the washing machine.

You should therefore note the following tips when preparing your laundry:

- Empty any pockets.

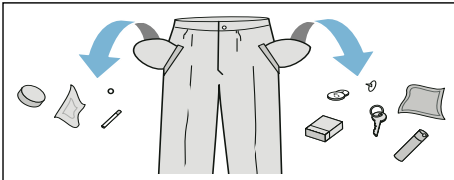

- Look out for metal items (paperclips, etc.) and remove them.
- Wash delicates in a laundry bag (tights, underwired bras, etc.).
- Close any zips; button up any cover buttons.
- Brush sand out of pockets and collars.
- Remove curtain fittings or place curtains in a laundry bag.

### Sorting laundry

Sort your laundry according to the care instructions and manufacturer's information on the care labels, depending on:

- Type of fabric/fibre
- Colour

**Note:** Laundry may discolour. Wash white and coloured items separately. Wash new coloured items separately the first time you wash them.





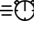

- Soiling  
Wash laundry with the same level of soiling together.

Some examples of soiling levels can be found on → Page 15

- **Light:** Do not prewash, select the **speedPerfect**  setting if necessary
- **Normal**
- **Heavy:** Load less laundry, select a programme with prewash
- **Stains:** Remove/pretreat stains while they are fresh. Firstly, dab with soapy water; do not rub. Then wash the items of laundry with the appropriate programme. Stubborn or dried-in stains can sometimes only be removed by washing several times.

- Symbols on the care labels

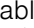
**Note:** The numbers in the symbols indicate the maximum washing temperature that may be used.

-  Suitable for normal washing process; e.g. Cottons programme
-  A gentle washing process is required; e.g. Easy-Care programme
-  An especially gentle washing process is required; e.g. Delicate/Silk programme
-  Suitable for washing by hand; e.g.  Woollens programme
-  Do not machine wash.

## Detergent

### Correct selection of detergent

The care label is crucial for selecting the correct detergent, temperature and treatment of the laundry. → See also [www.sartex.ch](http://www.sartex.ch)

If you visit [www.cleanright.eu](http://www.cleanright.eu), you will find further information on detergents, care products and cleaning agents for domestic use.

- **Standard detergent with optical brighteners**

Suitable for boil-washable white laundry made from linen or cotton  
Programme: Cottons/  
cold - max. 90 °C

- **Detergent for colours without bleach or optical brighteners**

Suitable for coloured laundry made from linen or cotton  
Programme: Cottons/  
cold - max. 60 °C

- **Detergent for colours/delicates without optical brighteners**

Suitable for coloured laundry made from easy-care fibres, synthetic fibres  
Programme: Easy-Care/  
cold - max. 60 °C

- **Detergent for delicates**

Suitable for delicate, fine fabrics, silk or viscose  
Programme: Delicate/Silk/  
cold - max. 40 °C

- **Detergent for woollens**

Suitable for wool  
Wool programme/  
cold - max. 40 °C

### Saving energy and detergent

For light and normal soiling, you can save energy (lower washing temperature) and detergent.

Saving	Soiling/note
Reduced temperature and detergent quantity as per the recommended dosage	<b>Light</b> No visible dirt or stains. Clothing has taken on some body odour, e.g.: <ul style="list-style-type: none"> <li>■ Light summer/sports clothing (worn for a few hours)</li> <li>■ T-shirts, shirts, blouses (worn for up to one day)</li> <li>■ Guest bed linen and hand towels (used for one day)</li> </ul>
 Temperature as per the care label and detergent quantity as per the recommended dosage for heavy soiling	<b>Normal</b> Visible dirt or a few light stains, e.g.: <ul style="list-style-type: none"> <li>■ T-shirts, shirts, blouses (sweat soaked, worn a few times)</li> <li>■ Towels, bedding (used for up to one week)</li> </ul>
	<b>Heavy</b> Dirt and/or stains clearly visible, e.g. tea towels, baby items, work clothing

**Note:** When measuring the amount of all detergents/additives/care products and cleaning agents, please always check the manufacturer's instructions and information. → *Page 25*







## Overview of programmes

### Programmes on the programme selector

Programme/type of laundry/information	Settings
<p><b>Programme name</b></p> <p>Brief explanation of the programme and for which fabrics it is suitable.</p>	<p>Max. load</p> <p>Temperature that can be selected (☼= cold)</p> <p>Spin speed Ⓢ** that can be selected; ▽ = Rinse Stop, 0 = no spin cycle, draining only</p> <p>Other programme settings that can be selected</p> <p>Automatic dosing can be selected for: Liquid detergent (☑)  Fabric softener (☼)  (De)selectable ✓, not selectable -</p>
<p><b>Cottons</b></p> <p>Hard-wearing fabrics, heat-resistant fabrics made of cotton or linen</p> <p><b>Notes</b></p> <ul style="list-style-type: none"> <li>In the <b>ecoPerfect</b> ☑ setting, the washing temperature is lower than the selected temperature. If you would like to set a particular washing temperature, use the programme without the <b>ecoPerfect</b> ☑ setting or, if necessary, set a higher temperature.</li> <li>The <b>speedPerfect</b> ≡Ⓢ setting is suitable as a short programme for lightly soiled laundry.</li> </ul>	<p>Max. 9 kg/5* kg</p> <p>☼ - 90 °C</p> <p>▽, 0 - 1600** rpm</p> <p>ecoPerfect ☑, speedPerfect ≡Ⓢ, Prewash ▽, Extra Rinse ☑+, Less Ironing ☑</p> <p>Detergent ✓, fabric softener ✓</p>
<p><b>Easy-Care</b></p> <p>Synthetic or blended fabrics</p>	<p>Max. 4 kg</p> <p>☼... 60 °C</p> <p>▽, 0 - 1200 rpm</p> <p>ecoPerfect ☑, speedPerfect ≡Ⓢ, Prewash ▽, Extra Rinse ☑+, Less Ironing ☑</p> <p>Detergent ✓, fabric softener ✓</p>
<p>* Reduced load for the <b>speedPerfect</b> ≡Ⓢ setting</p> <p>** Max. spin speed, depending on the model</p> <p>*** Programme depends on the model</p>	

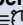
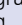
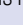
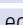

Programme/type of laundry/information	Settings
<p><b>Mixed Fabrics</b> Mixed load of cottons and synthetic fabrics</p>	<p>Max. 4 kg   - 40 °C   , 0 - 1600** rpm                      ecoPerfect , speedPerfect ,                      Prewash ,                      Extra Rinse ,                      Less Ironing </p> <p>Detergent ✓ , fabric softener ✓</p>
<p><b>Delicate / Silk</b> For delicate, washable fabrics, e.g. made of silk, satin, synthetic fibres or blends (e.g. silk blouses, silk scarves)  <b>Note:</b> . Use a detergent suitable for machine-washing delicates or silk.</p>	<p>Max. 2 kg   - 40 °C   , 0 - 800 rpm                      ecoPerfect , speedPerfect ,                      Prewash ,                      Extra Rinse ,                      Less Ironing </p> <p>Detergent ✓ , fabric softener ✓</p>
<p> <b>Wool</b> Hand- or machine-washable fabrics that are made of wool or contain wool; particularly gentle wash programme to prevent laundry from shrinking, with longer pauses in the programme (during which the items rest in the water)  <b>Notes</b>                      ■ Wool is of animal origin, e.g.: Angora, alpaca, llama, sheep.                      ■ Use a detergent that is suitable for machine-washing wool.</p>	<p>Max. 2 kg   - 40 °C   , 0 - 800 rpm                      -                      Detergent -, fabric softener ✓</p>
<p><b>Empty</b> for the rinsing water, e.g. after the  setting (Rinse Stop = no final spin cycle)</p>	<p>-                      -                      -                      -                      Detergent -, fabric softener -</p>
<p>* Reduced load for the <b>speedPerfect</b>  setting                      ** Max. spin speed, depending on the model                      *** Programme depends on the model</p>	

Programme/type of laundry/information	Settings
<b>Rinse / Spin</b> Extra rinse/spin with selectable speed <b>Note:</b> . The <b>Extra Rinse</b>  button is set by default for this programme. If you require a spin cycle only, press the button to deactivate the function.	- - ☹, 0 - 1600** rpm Less Ironing  Detergent -, fabric softener ✓
<b>*** Drum Clean</b> Programme for cleaning and caring for the drum and the outer tub, e.g. before running the first wash cycle, if washing frequently at a low temperature (40 °C or lower) or if an odour has developed after a prolonged period of non-use. The <b>Drum Clean</b> indicator light flashes when you use have not used a programme of 60 °C or higher for a long time.	0 kg 80, 90 °C 1200 rpm - Detergent -, fabric softener -
<b>Notes</b> <ul style="list-style-type: none"> <li>■ Run the programme without laundry.</li> <li>■ Use washing powder or a detergent containing bleach. To prevent foaming, only use half the amount of detergent recommended by the detergent manufacturer. Do not use detergent designed for woollens or delicates.</li> </ul>	
<b>*** Super 15' / 30'</b> Extra-short programme of approx. 15/30 minutes, suitable for small items of lightly soiled laundry <b>Note:</b> . The <b>Super 15'</b> programme is run for the <b>speedPerfect</b>  setting.	max. 2/3,5 kg ❄ - 40 °C ☹ - 1200** rpm ecoPerfect  , speedPerfect  Detergent ✓, fabric softener ✓
<b>*** Super 15'</b> Extra-short programme of approx. 15 minutes, suitable for small items of lightly soiled laundry	Max. 2 kg ❄ - 40 °C 0 - 1200 rpm - Detergent ✓, fabric softener ✓
<b>*** Down Wear</b> Machine-washable fabrics stuffed with down, such as pillows and duvets; also suitable for items stuffed with synthetic fibres <b>Note:</b> . Wash large items separately. Use a detergent designed for delicates and follow the instructions on the item's care label. Use detergent sparingly.	Max. 2 kg ❄ - 60 °C 0 - 1200** rpm ecoPerfect  , speedPerfect  , Extra Rinse  , Detergent -, fabric softener -
* Reduced load for the <b>speedPerfect</b>  setting ** Max. spin speed, depending on the model *** Programme depends on the model	

Programme/type of laundry/information	Settings
<p><b>*** Jeans / Dark wash</b></p> <p>Dark-coloured cottons and dark-coloured easy-care fabrics; turn items inside-out before washing.</p>	<p>Max. 3.5 kg</p> <p>✳ - 40 °C</p> <p>☒, 0 - 1200 rpm</p> <p>ecoPerfect @, speedPerfect ≡⌚,</p> <p>Prewash ↓, ↓,</p> <p>Extra Rinse ☕,</p> <p>Less Ironing ☞</p> <p>Detergent ✓, fabric softener ✓</p>
<p><b>*** Hygiene</b></p> <p>Hard-wearing fabrics made of cotton or linen</p> <p><b>Note:</b> . Particularly suited to washing items that need to be hygienically clean and especially kind to sensitive skin thanks to the longer wash cycle at a defined temperature, higher water level and longer spin cycle.</p>	<p>Max. 7 kg/5* kg</p> <p>✳ - 60 °C</p> <p>☒, 0 - 1600** rpm</p> <p>ecoPerfect @, speedPerfect ≡⌚,</p> <p>Prewash ↓, ↓,</p> <p>Extra Rinse ☕,</p> <p>Less Ironing ☞</p> <p>Detergent ✓, fabric softener ✓</p>
<p><b>*** Outdoor / Water proofing</b></p> <p>Wash cycle followed by waterproofing of membrane-coated weatherproof and outdoor clothing or water-resistant fabrics</p> <ol style="list-style-type: none"> <li>1. Select a programme.</li> <li>2. Add special detergent for outdoor clothing to compartment ☞☞.</li> <li>3. Press the ►   button. The programme stops before the last rinse cycle.</li> <li>4. Add a waterproofing agent (max. 170 ml) to compartment ☞☞.</li> <li>5. Press the ►   button. After-treat the laundry in accordance with the manufacturer's instructions.</li> </ol> <p><b>Notes</b></p> <ul style="list-style-type: none"> <li>■ Use a special detergent suitable for machine washing and dose in accordance with the manufacturer's instructions:</li> <li>■ Laundry must not be treated with fabric softener.</li> <li>■ Before washing, clean the detergent drawer thoroughly (all compartments) to remove fabric-softener residue.</li> </ul>	<p>Max. 1 kg</p> <p>✳ - 40 °C</p> <p>☒, 0 - 800 rpm</p> <p>ecoPerfect @, speedPerfect ≡⌚,</p> <p>Extra Rinse ☕</p> <p>Detergent -, fabric softener -</p>
<p>* Reduced load for the <b>speedPerfect</b> ≡⌚ setting</p> <p>** Max. spin speed, depending on the model</p> <p>*** Programme depends on the model</p>	

Programme/type of laundry/information	Settings
<p><b>*** Outdoor</b></p> <p>Membrane-coated weatherproof or outdoor clothing and water-resistant fabrics</p> <p><b>Notes</b></p> <ul style="list-style-type: none"> <li>■ Use special detergent suitable for machine washing; add the correct dosage to compartment   in accordance with the manufacturer's instructions.</li> <li>■ Laundry must not be treated with fabric softener.</li> <li>■ Before washing, clean the detergent drawer thoroughly (all compartments) to remove fabric-softener residue.</li> </ul>	<p>Max. 2 kg</p> <p> - 40 °C</p> <p> 0 - 800 rpm</p> <p>ecoPerfect , speedPerfect , Extra Rinse </p> <p>Detergent -, fabric softener -</p>
<p><b>*** Sportswear</b></p> <p>Sportswear and leisurewear made from microfibre fabrics</p> <p><b>Notes</b></p> <ul style="list-style-type: none"> <li>■ Laundry must not be treated with fabric softener.</li> <li>■ Before washing, clean the detergent drawer thoroughly (all compartments) to remove fabric-softener residue.</li> </ul>	<p>Max. 2 kg</p> <p> - 40 °C</p> <p> 0 - 800 rpm</p> <p>ecoPerfect , speedPerfect , Prewash , Extra Rinse , Less Ironing </p> <p>Detergent -, fabric softener -</p>
<p><b>*** Night Wash</b></p> <p>Especially quiet programme for washing during the night; suitable for cotton, linen, synthetic and blended fabrics.</p> <p><b>Notes</b></p> <ul style="list-style-type: none"> <li>■ Final buzzer deactivated.</li> <li>■ Reduced final spin speed set by default and shorter washing time</li> </ul>	<p>Max. 4 kg</p> <p> - 40 °C</p> <p> 0 - 1200 rpm</p> <p>ecoPerfect , speedPerfect , Prewash , Extra Rinse , Less Ironing </p> <p>Detergent ✓, fabric softener ✓</p>
<p><b>*** Duvet</b></p> <p>Machine-washable items stuffed with synthetic fibres, such as pillows, quilts and bedspreads; also suitable for items stuffed with down</p> <p><b>Note:</b> . Wash large items separately. Use a detergent designed for delicates and follow the instructions on the item's care label. Use detergent sparingly.</p>	<p>Max. 2.5 kg</p> <p> - 60 °C</p> <p> 0 - 1200 rpm</p> <p>ecoPerfect , speedPerfect , Extra Rinse </p> <p>Detergent -, fabric softener -</p>
<p>* Reduced load for the <b>speedPerfect</b>  setting</p> <p>** Max. spin speed, depending on the model</p> <p>*** Programme depends on the model</p>	

Programme/type of laundry/information	Settings
<p>*** <b>Automatic / auto 40 °C</b></p> <p>Hard-wearing fabrics;</p> <p>The degree of soiling and the type of fabric are automatically detected and the washing sequence and intelligent dosage are adjusted accordingly.</p>	<p>Max. 6 kg</p> <p>40 °C</p> <p>☒, 1400 rpm</p> <p>-</p> <p>Detergent ✓, fabric softener ✓</p>
<p>*** <b>Automatic Soft / auto 30°C</b></p> <p>Gentler treatment of the laundry;</p> <p>The degree of soiling and the type of fabric are automatically detected and the washing sequence and intelligent dosage are adjusted accordingly.</p>	<p>Max. 3.5 kg</p> <p>30 °C</p> <p>☒, 1000 rpm</p> <p>-</p> <p>Detergent ✓, fabric softener ✓</p>
<p>*** <b>Automatic Intensive / auto 60 °C</b></p> <p>More intensive treatment of the laundry;</p> <p>The degree of soiling and the type of fabric are automatically detected and the washing sequence and intelligent dosage are adjusted accordingly.</p>	<p>Max. 6 kg</p> <p>60 °C</p> <p>☒, 1400 rpm</p> <p>-</p> <p>Detergent ✓, fabric softener ✓</p>
<p><b>Shirt / Blouses</b></p> <p>Non-iron shirts or blouses made of cotton, linen, synthetic fibres or blended fabrics</p> <p><b>Notes</b></p> <ul style="list-style-type: none"> <li>Shirts/blouses are only given a short spin on the <b>Less Ironing</b> ☒ setting. Hang them up to dry while still dripping wet. -&gt; Self-smoothing effect</li> <li>Use the <b>Delicate / Silk</b> programme to wash shirts/blouses made of silk or delicate fabrics.</li> </ul>	<p>Max. 2 kg</p> <p>☒ - 60 °C</p> <p>☒, 0 - 800 rpm</p> <p>ecoPerfect ☒, speedPerfect ☒☒,</p> <p>Prewash ☒,</p> <p>Extra Rinse ☒,</p> <p>Less Ironing ☒</p> <p>Detergent ✓, fabric softener ✓</p>
<p>* Reduced load for the <b>speedPerfect</b> ☒☒ setting</p> <p>** Max. spin speed, depending on the model</p> <p>*** Programme depends on the model</p>	

## Starching

**Note:** Laundry should not be treated with fabric softener.

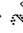

1. Switch on the appliance.
2. Select the **Rinse** programme.
3. Pour liquid starch into compartment   in accordance with the manufacturer's instructions (clean first if necessary).
4. Press the ►|| button.

## Dyeing/bleaching

Dye should only be used in normal household quantities. Salt may damage stainless steel. Always follow the dye manufacturer's instructions.

Do **not** use the washing machine to bleach clothes.

## Soaking

1. Switch on the appliance.
2. Select the **Cottons 30 °C** programme.
3. Use i-Dos to dose your detergent or add it to compartment   in accordance with the manufacturer's instructions.
4. Press the ►|| button. The programme starts.
5. After approx. 10 minutes, press the ►|| button to pause the programme.
6. Leave the laundry to soak for as long as required, then either press the ►|| button again to continue the programme or change the programme.

### Notes

- Load laundry of the same colour.
- No additional detergent is required; the soaking solution is used for washing.

## P+ Programme default settings

The default programme settings are displayed in the display panel after selecting the programme.

You can change the default settings.

An overview of all programme settings, which can be selected depending on the programme, can be found from → *Page 16*.

## Temperature

(Temp. °C)

Depending on what stage the programme is in, you can change the set temperature before and during the programme.

The maximum temperature that can be set depends on the programme that has been selected.

## Spin speed

Depending on what stage the programme is in, you can change the spin speed (in rpm; revolutions per minute) before and during the programme.

**Setting 0:** The rinsing water is drained but there is no final spin. The laundry stays wet inside the drum, e.g. for items that should not be spun.

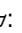
**Setting **: Rinse Stop = no final spin. The laundry stays in the water after the final rinse.

You can select "Rinse Stop" to prevent creasing if the laundry will not be taken out of the washing machine immediately after the programme has ended.

To continue/end the programme → *Page 27*

The maximum speed that can be set depends on the model and programme that has been selected.

## Finish in ⌚

**Before starting the programme**, you can preselect the programme end ("Ready in" time) in hourly increments (h = hour) up to a maximum of 24 hours.

To do this:

1. Select a programme.  
The programme duration is displayed for the selected programme, e.g. **2:30** (hours:minutes).
2. Press the **Finish in** ⌚ button repeatedly until the required number of hours is displayed.  
**Note:** The setting values are increased using the **Finish in** ⌚ + button, and decreased using the **Finish in** ⌚ - button.
3. Press the ►|| button.  
The programme starts.  
The selected number of hours (e.g. **8 h**) is shown in the display panel and counts down until the wash programme starts. The duration of the programme is then displayed.

**Note:** The length of the programme is automatically adjusted when the programme is running. Changes to the default programme settings or programme settings may also change the programme duration.

**After starting the programme** (if a Finish in ⌚ time has been selected and the wash programme has not yet started), you can change the preselected number of hours as follows:

1. Press the ►|| button.
2. Use the **Finish in** ⌚ - or + button to change the number of hours.
3. Press the ►|| button.

**After starting the programme**, you can add or remove laundry if necessary.

→ Page 27

## i-Dos settings

Your washing machine has an intelligent dosing system for liquid detergent and fabric softener.

The washing machine doses your detergent and fabric softener automatically in most programmes.

→ Page 16

The following have been preset at the factory:

- i-Dos ④: ④  
Detergent dosage for lightly soiled laundry
- i-Dos ⑥: ⑥  
Fabric softener dosage for a medium level of softness

### i-Dos ④ for detergent

#### Dosage strengths

- ④ High: heavy soiling and staining
- ④ Medium: average soiling
- ④ Low: light soiling
- ④ Automatic dosage deselected, manual dosage → Page 31

You can change the settings for automatic detergent dosage before the programme starts. You can find information on degrees of soiling on → Page 15

### i-Dos ⑥ for fabric softener

#### Dosage strengths

- ⑥ High: high level of softness
- ⑥ Medium: medium level of softness
- ⑥ Low: low level of softness
- ⑥ Automatic dosage deselected

Depending on what stage the programme is in, you can change the settings for automatic detergent dosage.

## P+ Additional programme settings

An overview of all additional settings, which can be selected depending on the programme, can be found from → *Page 16*.

### speedPerfect

Washing in a shorter time while achieving a washing result that is consistent with, but uses more energy than, the selected programme, without the speedPerfect  setting.

**Note:** Do not exceed the maximum load.  
Overview of programmes → *Page 16*



### ecoPerfect

Energy-optimised washing by reducing the temperature while achieving a washing result that is consistent with the selected programme, without the ecoPerfect  setting.

### Prewash

For heavily soiled laundry.

#### Notes

- If **intelligent dosage is selected**, the detergent will be dispensed automatically for the prewash and the main wash.
- Set the i-Dos dosage to **medium** to prevent overdosing.
- If **dosing manually**, allocate detergent to the prewash and the main wash. Place detergent for the prewash in the drum and add detergent for the main wash to compartment  .

### Extra Rinse

Additional rinse cycle for particularly sensitive skin and/or for areas with very soft water.

### Less Ironing

Reduces creasing thanks to a special spin sequence followed by fluffing and reduced spin speed.

**Note:** The washing's residual moisture is increased.

## Operating the appliance

### Preparing the washing machine

**Note:** The washing machine **must be correctly installed and connected**.  
From → *Page 45*.

1. Connect the mains plug.
2. Turn on the tap.
3. Open the door.
4. Check that the drum is completely drained. Drain if necessary.

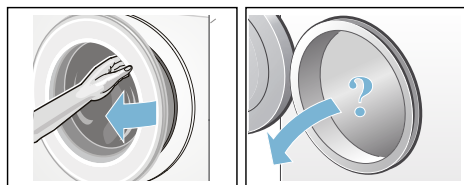



## Switching on the appliance/ selecting a programme

Press the **ⓘ** button. The appliance is switched on.

The **Cottons** programme set at the factory is then always displayed.

You can use this programme or select a different programme. The programme selector can be turned in either direction.

**Note:** If you have activated the childproof lock, you must deactivate it before you can set a programme.  
→ *Page 26*

The indicator light on the programme selector lights up and the **default programme settings** for the selected programme appear in the display panel.

- Temperature
- Spin speed
- The maximum load and the duration of the programme (alternately)
- The indicator light for the i-Dos settings, if intelligent dosage has been selected
- Information on water and energy consumption

In appliances with a **drum light**:

The drum is lit after switching on the appliance, after opening and closing the door and after starting the programme. The light switches off automatically.

## Placing laundry into the drum

### **⚠ Warning** **Danger of death!**

Items of laundry pretreated with cleaning agents that contain solvents, e.g. stain remover/cleaning solvent, may cause an explosion after being loaded into the washing machine. Hand-rinse these items of laundry thoroughly beforehand.

## Notes

- Mix items of laundry of varying sizes. Laundry items of different sizes distribute themselves better during the spin cycle. Individual laundry items may cause an unbalanced load.
  - Observe the maximum specified load. Overfilling adversely affects the washing result and promotes creasing.
1. Unfold presorted laundry items and place them in the drum.
  2. Make sure that no items of laundry are trapped between the door and the rubber seal, and close the door.

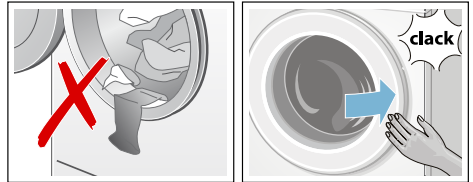

The **▶||** button indicator lamp flashes and the programme settings appear in the display panel.

## Measure and add detergent and care products

The washing machine doses your detergent and fabric softener automatically in most programmes.

The intelligent dosage has been preset at the factory for all programmes in which it can be used.

You can use these default settings or change them. → *Page 23*

In addition to intelligent dosage, cleaning aids (e.g. stain remover) can be added manually to compartment **↻ ↻**, if necessary. → *Page 31*

For programmes that cannot be used with intelligent dosage, or if you would prefer to dose manually (in which case set intelligent dosage to "off" **⏏**), add detergent to compartment **↻ ↻**.

→ *Page 31*

## Change the programme default settings

You can use the default settings for each washing cycle or change them.

To do this, repeatedly press the corresponding button until the required setting is displayed.

**Note:** Pressing and holding the buttons automatically runs through the setting values until the last one. Then press the button again and you will be able to change the setting values again.

The settings are activated without needing to be confirmed.

### Notes

- The i-Dos settings are saved until they are changed again, even if the washing machine is switched off.
- Other programme settings are not saved if the washing machine is switched off.

Default programme settings  
→ *Page 22*

## Select additional programme settings

By selecting additional settings, you can better adapt the washing process to your items of laundry.

The settings can be selected or deselected depending on the programme progress.

The button indicator lamps light up if a setting is activated.

The settings are not saved after switching off the washing machine.

Additional programme settings  
→ *Page 24*

## Start the programme

Press the ►|| button. The indicator lamp lights up and the programme starts.

The display panel shows the "Ready in" time while the programme is running or the programme length and the programme progress symbols when the washing programme has started.  
Display panel → *Page 12*

### Note: . Foam detection

If the 🧼 symbol also lights up in the display panel, the washing machine has detected too much foam during the wash programme and automatically activated additional rinse cycles to remove the foam.

Add less detergent to the next washing cycle with the same load.

If you want to lock the programme to prevent it from being inadvertently adjusted, you can select the childproof lock as follows.

## Child lock

(🔒 3 sec.)

You can lock the washing machine to prevent the functions you have set from being changed inadvertently. To do this, activate the childproof lock.

To **activate/deactivate**, press and hold the **Finish in** ⏪ - and + buttons at the same time for approx. three seconds. The 🔒 symbol is appears in the display panel.

- 🔒 lights up: The childproof lock is active.
- 🔒 flashes briefly: The childproof lock is active and the programme selector was turned or a button was pressed.

**Note:** The childproof lock remains active, even once the washing machine has been switched off. Before selecting the next programme, deactivate the childproof lock.

## Adding laundry

After starting the programme, you can add or remove laundry if necessary.

Press the ►|| button to do this.

The ►|| button indicator lamp flashes and the machine checks whether it is possible to add laundry.

If the following appears in the display panel:

- **Both** the - P - and © symbols light up, it is possible to add laundry.
- - P - lights up, it is not possible to add laundry.

**To continue the programme, press the ►|| button.** The programme continues automatically.

### Notes

- Do not leave the door open for too long when adding laundry as water from the laundry may leak out.
- For safety reasons, the door remains locked when the water level or temperature is high, or while the drum is turning, and it is not possible to add laundry during this time.
- The load display is not active during reloading.

## Changing the programme

If you have started the wrong programme by mistake, you can change the programme as follows:

1. Press the ►|| button.
2. Select another programme.
3. Press the ►|| button. The new programme starts from the beginning.

## Cancel the programme

For programmes at high temperatures:

1. Press the ►|| button.
2. To cool down laundry: Select **Rinse**.
3. Press the ►|| button.

For programmes at low temperatures:

1. Press the ►|| button.
2. Select **Spin** or **Empty**.
3. Press the ►|| button.

## Programme end during rinse hold

In the display panel, ☹ flashes, and the preset spin speed and remaining programme length are displayed for the selected programme.

Continue the programme by:

- Pressing the ►|| button or
- Changing the spin speed, or setting the programme selector to **Empty** and then pressing the ►|| button.

## Programme end

- 0 - and © appear in the display panel. The ►|| button indicator lamp is off.

## Removing laundry/switching off the appliance

1. Open the door and remove the laundry.
2. Press the **Ⓛ** button. The appliance is switched off.
3. Turn off the tap.

**Note:** Not required for Aqua-Stop models.

### Notes

- Do not leave any items of laundry in the drum. They may shrink in the next wash or discolour another item.
- Remove any foreign objects from the drum and the rubber seal – risk of rusting.
- Wipe the rubber seal dry.

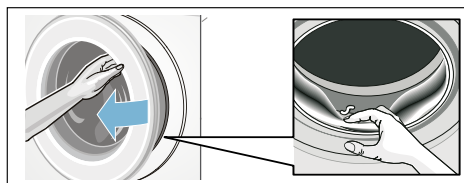



- Leave the door and detergent drawer open so that any residual water can evaporate. → *Page 34*
- Always wait until the programme ends, as the appliance could still be locked. Then switch the appliance on and wait for it to unlock.
- If the display panel goes off at the end of a programme, the energy-saving mode is active. Press any button to activate the panel.

## i-DOS Intelligent dosing system



### Intelligent dosing system in the detergent drawer

#### i-Dos Intelligent Dosing system

Your washing machine has an intelligent dosing system for liquid detergent and fabric softener.

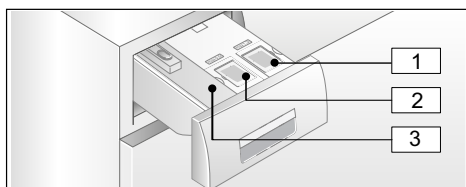
The i-Dos compartments  and  in the detergent drawer are used for this purpose.

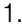

- 1 Dispenser  (1.3 l) for liquid detergent
- 2 Dispenser  (0.5 l) for fabric softener
- 3 Compartment   for manual dosing → *Page 31*

Depending on the selected programme and settings, the optimum quantity of detergent and/or fabric softener is dosed by the i-Dos dispensers.

## Initial use/filling the dispensers

Refer to the manufacturer's instructions when choosing your detergent and fabric softener. We recommend the use of standard, universal and colour liquid detergents for all machine-washable, coloured fabrics made of cotton or synthetic materials.

### Notes

- Only use easy-pour liquid products that the manufacturer recommends adding to the detergent drawer.
- Do not mix different liquid detergents. If changing your liquid detergent (type, manufacturer, etc.), empty the dispenser completely and clean it. → *Page 35*
- Do not use products containing solvents, caustic agents or volatile substances (e.g. bleach).
- Do not mix detergent and fabric softener.
- Do not use products that have expired or are highly congealed.
- To prevent drying out, do not leave the dispenser lids open for a long period of time.

### Filling the dispensers:

The lids of the dispensers in the detergent drawer are marked with the following symbols:

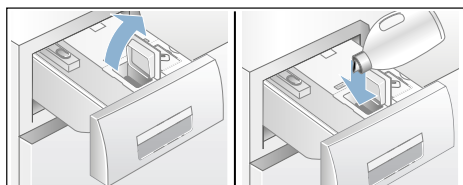

-  Standard/universal detergent
-  Fabric softener

1. Open the detergent drawer.
2. Open the dispenser lid(s).
3. Add detergent and/or fabric softener. Do not fill above the **max.** marking.



4. Close the lid(s).
5. Slowly push the detergent drawer in completely.

When the appliance is switched on, the fact that the detergent drawer is closed completely is indicated by the following:

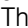
- If intelligent dosage i-Dos  or i-Dos  has been selected, the corresponding indicator lights up.
- If intelligent dosage has not been selected, the indicator flashes once and then goes out.
- The  symbol in the display panel goes out.

## Everyday use

### Indicator lights in the display panel:

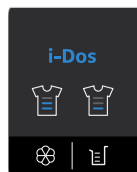



- The display **lights up** if intelligent dosage has been selected for the dispenser.
- The display **flashes** if the fill level of the selected intelligent dosing dispenser is below the minimum level.



### (De)selecting intelligent dosage and adjusting the dosage strength:

The intelligent dosages for detergent and fabric softener are set at the factory for programmes in which intelligent dosage can be used.

Overview of programmes → *Page 16*

The dosage strength has been preset to low (lightly soiled laundry) for detergent  and to medium (medium level of softness) for fabric softener . It can be changed for each programme. → *Page 23*

In addition to intelligent dosage, cleaning aids (e.g. stain remover) can be added manually to compartment , if necessary. → *Page 31*

**Note:** The selection (on/off) and the selected dosage strength for i-Dos  and i-Dos  are saved for each programme until they are changed again, even if the washing machine is switched off.

### Topping up the detergent/ fabric softener:

If the indicator light for the selected intelligent dosage flashes, this means that the amount of detergent or fabric softener in the dispenser is below the minimum fill level. The contents will last for another three washes or so.

The same detergent or fabric softener can be added at any time. If you change product/manufacturer, we recommend that you clean the dispensers first.

→ *Page 35*

If required, adjust the basic dosage.

## Basic settings

### The basic dosages are:

- **For detergents** – based on the manufacturer's recommendation for average soiling and the respective water hardness.
- **F or fabric softeners** – based on the manufacturer's recommendation for a medium level of softness.

Refer to the packaging label on your detergent/fabric softener or ask the manufacturer directly for this information.

To find out the hardness of your water supply, use a test strip or check with your water supplier.

### My water hardness:

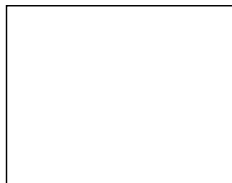

Below is an example of detergent dosages on a packaging label:

Degree of soiling → Water hardness ↓	light	normal	heavy	very heavy
soft/medium	55 ml	<b>75 ml</b>	120 ml	160 ml
hard/very hard	75 ml	<b>95 ml</b>	150 ml	180 ml

The default setting for the basic dosage is set specifically according to the area in which you live (e.g. 75 ml for detergent and 36 ml for fabric softener).

Set the basic detergent dosage according to the detergent's packaging label. Take your water hardness into consideration when doing so.

Select the basic fabric softener dosage according to how soft you would like your laundry to be.

Changing one basic dosage affects all three dosage quantities in the same way.

### Notes

- Reduce the basic dosage if using a very concentrated detergent.
- If large amounts of foam are repeatedly created during washing, please check your basic dosage and dosage quantity settings. Certain types of liquid detergent can also create excessive amounts of foam. If your basic dosage and dosage quantity settings are correct, we advise you to use a different detergent.



### Changing the basic dosages:

1. Press the corresponding i-Dos button (☐ or ☒) for approx. 3 seconds. The preset basic dosage will appear in the display panel.
2. Set the required basic dosage using the **Finish in** ⏪ - or + buttons.

3. The setting is activated without needing to be confirmed. You can now wait for a short while or press any button (except the i-Dos buttons) to revert to the original setting.

**Note:** The settings are saved until they are changed again, even if the machine is switched off.

## Manual dosage

For programmes that cannot be used with intelligent dosage, or if you would prefer to dose manually (in which case set intelligent dosage to "off" ☐), add detergent to compartment  .

Cleaning aids such as water softener, bleach and stain remover can be added to this compartment in addition to the intelligent dosage.

### **Warning** **Eye/skin irritation!**

Detergent and care products may spray out if the detergent drawer is opened while the machine is in operation. Open the drawer carefully.

Rinse eyes or skin thoroughly if they come into contact with detergent/care products.

If swallowed accidentally, seek medical advice.

### **Caution!** **Damage to the appliance**

Cleaning agents and agents for pretreating laundry (e.g. stain removers, prewash sprays, etc.) may cause damage if they come into contact with the surfaces of the washing machine.

Do not allow these agents to come into contact with the surfaces of the washing machine. If necessary, immediately wipe away spray residue and other residues/droplets with a damp cloth.

## Notes

- When dosing all detergents, cleaning aids and cleaning agents, always follow the manufacturer's instructions.
- If dosing detergent manually, do not add additional detergent to the intelligent dosage dispenser (set intelligent dosage to "off" 𠄎). This will prevent overdosing and foaming.
- Dilute viscous fabric softener and fabric conditioner with water to prevent blockages.

## Dosing and adding detergent:

1. Pull out the detergent drawer.

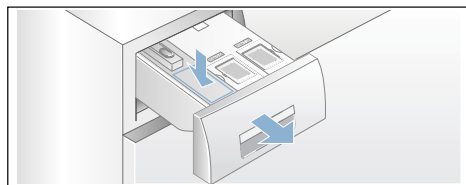

2. Add the correct dosage to compartment ↗ ↘ depending on:
  - Soiling
  - Water hardness (ask your water supply company)
  - The amount of laundry
  - The manufacturer's instructions
3. Close the detergent drawer.

## Appliance settings

You can change the following settings:

- The volume of the buttons and the information signals (e.g. at the end of the programme)
- Select/deselect the appliance's automatic switch-off function → *Page 8*
- Switch the drum-care information signal on/off (depending on the model).

You will need to activate the setting mode in order to change these settings.

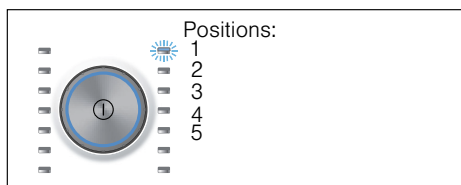

## Activating the setting mode

1. Press the ① button.  
The appliance is switched on and the **Cottons** programme is shown at position 1.
2. Press the **Temperature** button and, at the same time, turn the programme selector clockwise to position 2. Release the button.  
The setting mode is activated and the preset volume for the information signals appears in the display panel.

You can now change the settings:



## Changing the signal volume

Use the **Finish in**  + or - button to change the following settings at the corresponding programme selector positions:

- 2: The volume of the information signals and/or
- 3: The volume of the button signals.



0 = off,  
1 = quiet,  
2 = medium,  
3 = loud,  
4 = very loud

Exit setting mode or:

## Selecting/deselecting the appliance automatic switch-off

With the programme selector in position 4, press the **Finish in**  + or - button to turn the automatic switch-off function on or off.

Exit setting mode or:

## Switching the drum-care information signal on/off

depending on the model

With the programme selector in position 5, press the **Finish in**  + or - button to switch the **Drum Clean** information signal on or off.

## Exiting setting mode

To exit and save the settings, press the  button.

The appliance is switched off. The selected settings will take effect the next time the washing machine is switched on.

## Sensors

### Automatic load sensing

Depending on the type of fabric and load, the automatic load sensing function optimally adjusts the water consumption and programme duration in each programme.

### Unbalanced load detection system

The automatic unbalanced load detection system detects imbalances and ensures even distribution of the laundry by repeatedly starting and stopping drum spinning.

If the laundry is extremely unevenly distributed, the speed is reduced or the spin cycle is not performed for safety reasons.

**Note:** Place large and small items of laundry evenly in the drum.  
→ *Page 25*, → *Page 40*

### AquaSensor

Depending on the program and model During a rinse cycle, the Aqua sensor checks the turbidity of the rinsing water (turbidity is caused by dirt and detergent residue). The duration and the number of rinse cycles depend on the turbidity of the water.



## Cleaning and maintenance



### **Warning**

#### **Danger of death!**

There is a risk of electric shock if you touch live components. Switch off the appliance and pull out the mains plug.



### **Warning**

#### **Risk of poisoning!**

Toxic vapours can be produced by cleaning agents that contain solvents, e.g. cleaning solvent. Do not use cleaning agents that contain solvents.

### **Caution!**

#### **Damage to the appliance**

Cleaning agents that contain solvents, e.g. cleaning solvent, can damage surfaces and components in the machine. Do not use cleaning agents that contain solvents.

#### **Prevent detergent residue from building up and odours from forming by following these instructions:**

### **Notes**

- Ensure the room in which the washing machine is set up is well ventilated.
- Leave the door and detergent dispenser tray open slightly when the washing machine is not in use.
- Occasionally run a wash using the **Cottons 60 °C** programme and powder detergent.

## Machine housing/control panel

- Wipe the housing and the control panel with a soft, damp cloth.
- Remove the detergent residue immediately.
- Do not clean with a water jet.

## Drum

Use chlorine-free cleaning agents, do not use steel wool.

If there are odours in the washing machine, or to clean the drum, run the **Drum Clean 90 °C** programme without laundry. Add washing powder.

## Descaling

Descaling should not be necessary if the detergent is measured out correctly. However, if it is required, follow the manufacturer's instructions for the descaling agent. Suitable descalers can be obtained via our website or from customer services. → *Page 42*

## i-Dos detergent draw and its housing

### 1. Emptying the dispensers:

The dispensers have emptying outlets with removable sealing plugs at the front. To empty the dispensers, first remove the drawer handle as shown below:

a) Pull out the detergent drawer.

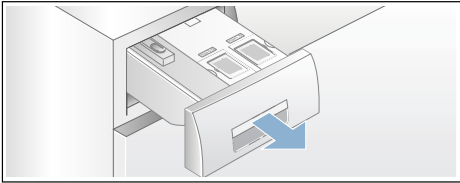

b) Pull the catch (A) on the back of the drawer handle (in the centre at the bottom) slightly towards you. This unlocks the drawer handle (B), which you can then pull off by lifting it upwards.

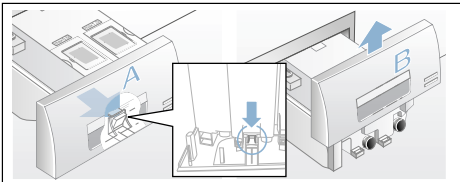

c) To empty the dispensers, carefully pull off each of the sealing plugs and empty the contents into a suitable container.

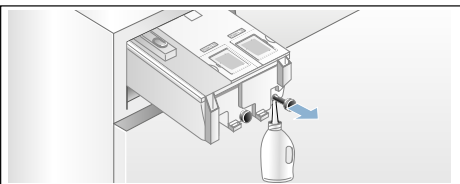

d) Then push the sealing plugs back in completely.

### 2. Cleaning the dispensers/detergent drawer:

The detergent drawer can be removed completely to allow you to clean the dispensers after you have emptied them.

a) Empty the dispensers before removing the drawer.

**Note:** Only put the drawer handle back on after you have finished cleaning.

b) Pull out the drawer.

c) Press the catch and remove the drawer completely.

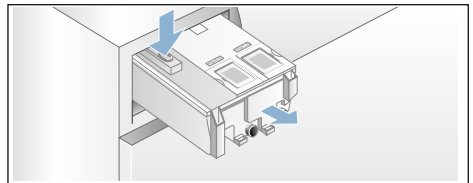

d) Carefully remove the drawer cover.

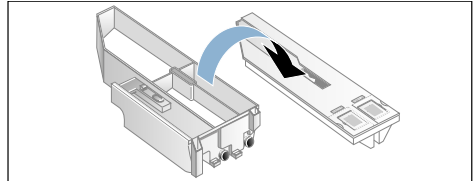

### Caution!

Risk of damage to the detergent drawer.

The detergent drawer contains electrical components. These may become damaged if they come into contact with water.

- Do not clean the cover in the dishwasher and do not immerse it in water.

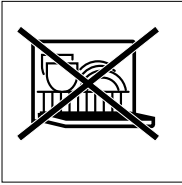

- Protect the rear drawer connector against water, detergent or fabric-softener residue; if necessary, clean the outer surfaces with a soft, damp cloth. Dry before putting back in.
- e) Clean the drawer and the cover with a soft, damp cloth or a hand shower. Also clean the inner surfaces with a soft, damp cloth.

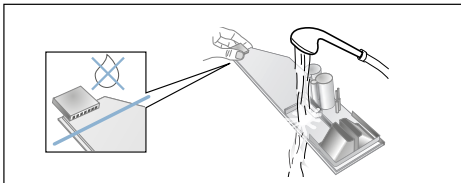

- f) Dry the drawer and the cover and put them back together.
- g) Push the drawer handle back in from above until you feel it click in place.
- h) Clean the inside of the detergent-drawer housing.
- i) Push the detergent drawer in completely.

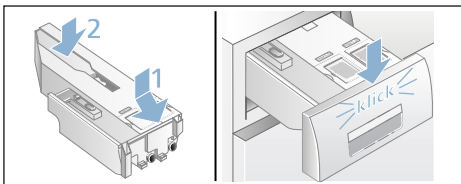

## The drain pump is blocked, emergency draining

### **Warning** **Risk of scalding!**

When you wash at high temperatures, the water gets very hot. If you come into contact with the hot water, you may be scalded.

Allow the water to cool down.

1. Turn off the water tap so that no more water can flow in and has to be drained via the drain pump.
2. Switch off the appliance. Pull out the mains plug.
3. Open and remove the service flap.

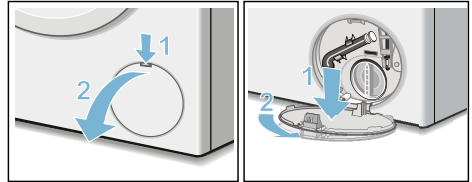

4. Take the drain hose out of the retainer. Remove the sealing cap and pour the water out into a suitable container. Replace the sealing cap and place the drain hose back in the retainer.

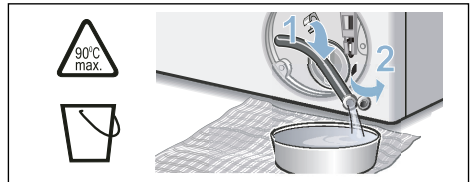

5. Carefully unscrew the pump cover; residual water may leak out. Clean the interior, pump-cover thread and pump housing. The impeller in the drain pump must be able to rotate. Refit the pump cover and screw it on tightly. The handle must be in a vertical position.

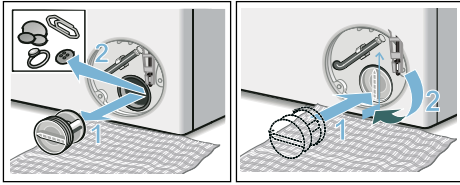

- Put the service flap back on, lock it into place and close it.

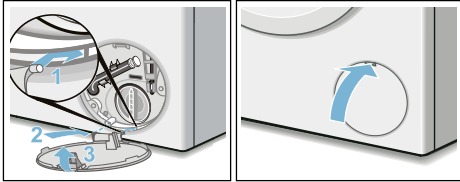

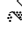
**Note:** To prevent unused detergent from flowing straight into the drain during the next wash, pour 1 litre of water into compartment  and start the **Empty** programme.

## The drain hose at the siphon is blocked

- Switch off the appliance. Pull out the mains plug.
- Loosen the hose clamp. Carefully remove the drain hose; residual water may leak out.
- Clean the drain hose and siphon connecting piece.

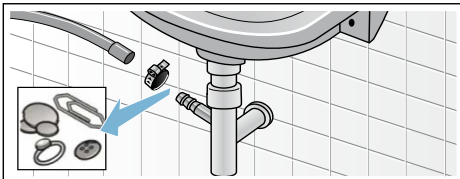

- Re-attach the drain hose and secure the connection point using the hose clamp.

## Filter in the water supply hose blocked

**First, reduce the water pressure in the supply hose:**

- Turn off the tap.
- Select any programme (except Rinse/Spin/Empty).
- Press the ► button. Allow the programme to run for approximately 40 seconds.
- Press the Ⓛ button. The appliance is switched off.
- Pull out the mains plug.

**Then clean the filter:**

- Disconnect the hose from the tap. Clean the filter with a small brush.

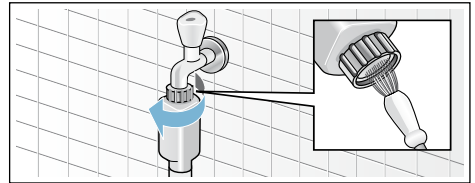

- For standard and Aqua-Secure models, clean the filter on the rear of the appliance: Remove the hose from the rear of the appliance. Use pliers to remove the filter and then clean it.

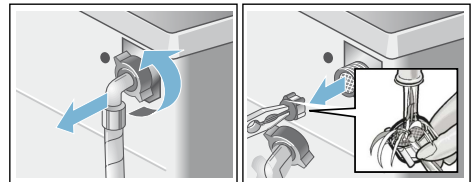

- Connect the hose and check for leaks.

## Faults and what to do about them.

### Emergency release

E.g. in the event of a power cut

The programme continues when the power supply is restored.

However, if the laundry has to be removed, the washing machine door can be opened as follows:

#### **Warning** **Risk of scalding!**

When you are washing at high temperatures, there is a risk of scalding if you come into contact with hot water and laundry.

If possible, leave it to cool down first.

#### **Warning** **Risk of injury!**

You may injure your hands if you reach into the drum while it is turning.

Do not reach into the drum when it is turning.

Wait until the drum has stopped turning.

#### **Caution!** **Water damage**





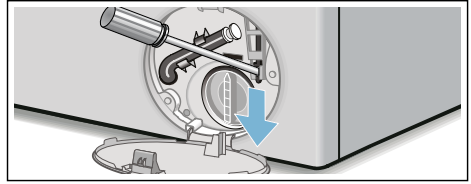

Any escaping water may cause water damage.

Do not open the door if water can be seen through the glass.

1. Switch off the appliance. Pull out the mains plug.
2. Drain the water. → *Page 36*
3. Pull the emergency release downwards with a tool and release. The door can then be opened.





## Information on the display panel

Display	Cause/Remedy
- P - and 	The door is unlocked. It is possible to add laundry.
- P -	<ul style="list-style-type: none"> <li>■ The temperature is too high. Wait until the temperature drops.</li> <li>■ The water level is too high. It is not possible to add laundry. Close the door immediately, if necessary. Press the ►   button to continue the programme.</li> </ul>
 flashes	<ul style="list-style-type: none"> <li>■ Laundry may be caught. Open and close the door again and press the ►   button.</li> <li>■ If necessary, push the door closed or remove some laundry and then push it closed again.</li> <li>■ If necessary, switch the appliance off and on again; set the programme and make your individual settings; start the programme.</li> </ul>
 flashes	The detergent drawer has not been pushed in completely. Push the detergent drawer in correctly.
 lights up	<ul style="list-style-type: none"> <li>■ Turn on the tap fully,</li> <li>■ Supply hose kinked/trapped,</li> <li>■ The water pressure is too low. Clean the filter. → <i>Page 37</i></li> </ul>
E:18	<ul style="list-style-type: none"> <li>■ The drain pump is blocked. Clean the drain pump. → <i>Page 36</i></li> <li>■ The drain hose/drain pipe is blocked. Clean the drain hose at the siphon. → <i>Page 37</i></li> </ul>
E:23	There is water in the base trough, the appliance is leaking. Turn off the tap. Call customer services. → <i>Page 42</i>
	The childproof lock is activated – deactivate it. → <i>Page 26</i>
 lights up	Too much foam has been detected and an additional wash cycle has been activated. Add less detergent to the next washing cycle with the same load.
The indicator light for the Drum Clean programme* flashes *depending on the model	<p>Run the <b>Drum Clean 90 °C</b> programme or a 60 °C programme to clean and care for the drum and the outer tub.</p> <p><b>Notes</b></p> <ul style="list-style-type: none"> <li>■ Run the programme without laundry.</li> <li>■ Use washing powder or a detergent containing bleach. To prevent foaming, only use half the amount of detergent recommended by the detergent manufacturer. Do not use detergent designed for woollens or delicates.</li> <li>■ Switching the information signal on/off → <i>Page 33</i></li> </ul>
Other displays	Switch off the appliance, wait for five seconds and then switch it on again. If the display appears again, call customer services. → <i>Page 42</i>

## Faults and what to do about them.

Faults	Cause/Remedy
Water is leaking out.	<ul style="list-style-type: none"> <li>■ Attach the drain hose correctly or replace it.</li> <li>■ Tighten the screw connection of the drain hose.</li> </ul>
The machine is not filling with water.	<ul style="list-style-type: none"> <li>■ Have you pressed the ►   button?</li> <li>■ Is the tap turned on?</li> </ul>
Detergent is not being dispensed.	<ul style="list-style-type: none"> <li>■ Could the filter be clogged? Clean the filter. → Page 37</li> <li>■ Is the supply hose kinked or trapped?</li> </ul>
The dispenser is empty and fill level indicator is not flashing.	<ul style="list-style-type: none"> <li>■ Is the drawer cover/connector dirty? Clean the detergent drawer. → Page 35</li> <li>■ Has the detergent drawer been pushed in correctly? → Page 29</li> </ul>
The wrong detergent/fabric softener has been poured into the dispenser(s).	<p>Dispenser(s):</p> <ol style="list-style-type: none"> <li>1. Empty and clean. → Page 35</li> <li>2. Refill. → Page 29</li> </ol>
Detergent/fabric softener has congealed in the dispensers.	Clean and refill the dispensers.
The door cannot be opened.	<ul style="list-style-type: none"> <li>■ The safety function is activated. Stop the programme? → Page 27</li> <li>■ Is the ☹ childproof lock activated? Deactivate it. → Page 26</li> <li>■ Is ☹ selected (Rinse Stop = no final spin)? → Page 27</li> <li>■ Can the door only be opened by the emergency release? → Page 38</li> </ul>
The programme will not start.	<ul style="list-style-type: none"> <li>■ Have you pressed the ►   button or selected <b>Finish in</b> ⊕ time?</li> <li>■ Is the door closed?</li> <li>■ Is the ☹ childproof lock activated? Deactivate it.</li> <li>■ If ☹ flashes, the detergent drawer has not been pushed in completely. Push the detergent drawer in correctly.</li> </ul>
The drum briefly jerks or judders after the programme has started.	Not a fault – the internal motor test may cause the drum to jerk or judder briefly when the wash programme starts.
The water is not draining.	<ul style="list-style-type: none"> <li>■ Is ☹ selected (Rinse Stop = no final spin)? → Page 27</li> <li>■ Clean the drain pump. → Page 36</li> <li>■ Clean the drain pipe and/or the drain hose.</li> </ul>
Water is not visible in the drum.	Not a fault – the water is below the visible area.
The spin result is not satisfactory. Laundry is wet/too damp.	<ul style="list-style-type: none"> <li>■ Not a fault – the unbalanced load detection system has interrupted the spin cycle because the laundry is unevenly distributed. Distribute small and large items of laundry evenly in the drum.</li> <li>■ Is <b>Less Ironing</b> ☹ selected (depending on the model)? → Page 24</li> <li>■ Is the selected speed too low?</li> </ul>
The spin cycle runs several times.	Not a fault – the unbalanced load detection system is adjusting an imbalance.

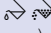

Faults	Cause/Remedy
The programme is taking longer than usual.	<ul style="list-style-type: none"> <li>■ Not a fault – the unbalanced load detection system is adjusting an imbalance by repeatedly distributing the laundry.</li> <li>■ Not a fault – the foam detection system is active – a rinse cycle has been switched on.</li> </ul>
The length of the programme changes during the wash cycle.	Not a fault – the programme sequence is optimised for the specific washing process. This may change the length of the programme shown in the display panel.
Residual water in the care-product compartment  .	■ Not a fault – the effect of the care product is not affected.
Odours in the washing machine.	Run the <b>Drum Clean</b> or <b>Cottons 90 °C</b> programme without laundry. Add washing powder or a detergent containing bleach. <b>Note:</b> . To prevent foaming, only use half the amount of detergent recommended by the detergent manufacturer. Do not use detergent designed for woollens or delicates.
The  symbol lights up in the display panel. Foam may also be leaking from the detergent drawer.	Have you used too much detergent? Mix one tablespoon of fabric softener with 1/2 litre of water and pour it into compartment  (not suitable for outdoor clothing, sportswear or items stuffed with down). Use less detergent in the next washing cycle.
Repeated, intensive foaming.	<ul style="list-style-type: none"> <li>■ Check your basic dosage and dosage strength settings.</li> <li>■ If required, use a different liquid detergent.</li> </ul>
Detergent/fabric softener drips off the seal and collects on the door or in the seal fold.	There is too much detergent/fabric softener in the dispensers. Do not fill above the <b>max.</b> mark in the dispensers.
Loud noises, vibrations and machine "movement" during the spin cycle.	<ul style="list-style-type: none"> <li>■ Is the appliance aligned? Align the appliance. → <i>Page 51</i></li> <li>■ Are the appliance's feet fixed? Secure the appliance's feet. → <i>Page 51</i></li> <li>■ Have the transport braces been removed? Remove the transport braces. → <i>Page 47</i></li> </ul>
The display panel/indicator lights do not work while the appliance is running.	<ul style="list-style-type: none"> <li>■ Has there been a power failure?</li> <li>■ Have the fuses blown? Reset/replace the fuses.</li> <li>■ If the fault occurs repeatedly, call customer services.</li> </ul>
There is detergent residue on the laundry.	<ul style="list-style-type: none"> <li>■ Some phosphate-free detergents contain water-insoluble residue.</li> <li>■ Select <b>Rinse</b> or brush the laundry after washing.</li> </ul>
- <b>P</b> - appears in the display panel when the cycle is paused.	<ul style="list-style-type: none"> <li>■ The water level is too high. It is not possible to add laundry. Close the door immediately, if necessary.</li> <li>■ Press the <b>▶  </b> button to continue the programme.</li> </ul>

Faults	Cause/Remedy
- P - and © appear in the display panel when the cycle is paused.	The door is unlocked. It is possible to add laundry.
If you cannot rectify a fault yourself (after switching the machine off and on again) or a repair is required: <ul style="list-style-type: none"><li>■ Switch off the appliance and pull out the mains plug.</li><li>■ Turn off the tap and call customer services.</li></ul>	

## After-sales service

If you cannot rectify a fault yourself, contact customer services. → Cover page

We will always find an appropriate solution in order to avoid unnecessary visits by engineers.

Please give customer services the product number (E no.) and the production number (FD) of the appliance.

E-Nr. _____ FD _____
----------------------

E no.      Product number  
FD        Production number

You can find this information  
\*depending on the model:

On the inside of the door\*/in the opened service flap\* and on the rear of the appliance.

### **Trust the expertise of the manufacturer.**

Contact us for assistance. By doing so, you will ensure that the repairs are carried out by trained service personnel using genuine spare parts.



## Consumption rates

### Energy and water consumption, programme duration and residual moisture for the main washing programmes

(approximate values)

Programme	Load	Energy consumption*	Water consumption*	Programme duration*
Cottons 20 °C	9 kg	0,25 kWh	90 l	2 ¾ h
Cottons 40 °C	9 kg	1,10 kWh	90 l	3 h
Cottons 60 °C	9 kg	1,16 kWh	90 l	2 ¾ h
Cottons 90 °C	9 kg	2,14 kWh	100 l	2 ¾ h
Easy-Care 40 °C	4 kg	0,71 kWh	64 l	2 h
Mixed Fabrics 40 °C	4 kg	0,60 kWh	45 l	1 ¼ h
Delicate / Silk 30 °C	2 kg	0,19 kWh	37 l	¾ h
Wool 30 °C	2 kg	0,19 kWh	41 l	¾ h





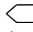

Programme	Approximate information on the residual moisture**			
	WM16... Max. 1600 rpm	WM14... Max. 1400 rpm	WM12... Max. 1200 rpm	WM10... Max. 1000 rpm
Cottons	44%	48%	53%	62%
Easy-Care	40%	40%	40%	40%
Delicate / Silk	30%	30%	30%	30%
Wool	45%	45%	45%	45%

\* Observed values may deviate from the indicated values due to influence of water pressure, hardness and inlet temperature, ambient temperature, type, amount and soiling of laundry, detergent used, fluctuations in power supply and selected additional functions.

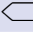
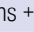
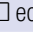
\*\* Information on residual moisture based on programme-dependent spin-speed limit and maximum loads.

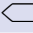
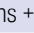
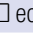
## Efficiency test programmes for cotton fabrics

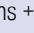
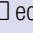
The following programmes (standard programmes, indicated by ) are suitable for cleaning normally soiled cotton fabrics and are the most efficient with respect to combined energy and water consumption.

Standard programmes for Cottons in accordance with the (EU) directive no. 1015/2010		
Programme + temperature + button	Load	Approximate programme duration
 Cottons +  +  ecoPerfect 	9 kg	4 ¾ h
 Cottons +  +  ecoPerfect 	4,5 kg	4 ½ h
 Cottons +  +  ecoPerfect 	4,5 kg	4 ½ h

Programme setting for testing and energy labelling in accordance with Directive 2010/30/EU with cold water (15 °C).  
The programme temperature information is based on the temperature stated on the care label for the fabrics. The actual washing temperature may deviate from the stated programme temperature for energy-saving reasons.

## Technical data

### Dimensions:

850 x 600 x 590 mm

(height x width x depth)

### Weight:

70 - 85 kg (depending on model)

### Mains connection:

Mains voltage 220 - 240 V, 50 Hz

Nominal current 10 A

Nominal power 1900 – 2300 W

### Water pressure:

100 - 1000 kPa (1 - 10 bar)

### Power consumption when switched off:

0,12 W

### Power consumption when left on:

0,43 W



## Positioning and connecting

### Included with the appliance

**Note:** Check the machine for transport damage. Never use a damaged machine. If you have any complaints, contact the dealer from whom you purchased the appliance or our customer services. → Page 42

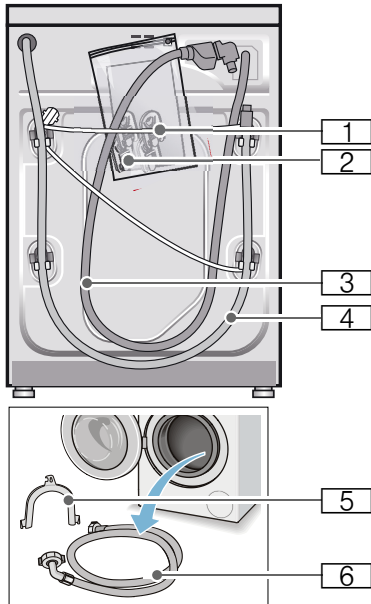

- 1 Mains cable
  - 2 Bag:
    - Installation and operating instructions
    - Customer services location directory\*
    - Warranty\*
    - Cover caps for openings after the transport braces have been removed
    - Adaptor with sealing washer from 21 mm = 1/2" to 26.4 mm = 3/4" \*
  - 3 Water supply hose on Aqua-Stop models
  - 4 Water drain hose
  - 5 Elbow for securing the water drain hose\*
  - 6 Water supply hose on standard/ Aqua-Secure models
- \* depending on the model

**In addition,** a hose clamp (24 - 40 mm diameter, available from specialist dealers) is required to connect the water drain hose to a siphon.

### Useful tools

- Spirit level for aligning
- Spanner with:
  - WAF13 for loosening the transport braces, and
  - WAF17 for aligning the appliance feet

## Safety instructions

### **Warning** **Risk of injury!**

- The washing machine is very heavy. Be careful when lifting/transporting the washing machine.
- When the washing machine is lifted by its protruding parts (e.g. the washing machine door), the components may break off and cause injuries. Do not lift the washing machine by protruding parts.
- If the hose and mains cables are not routed properly, there is a risk of tripping and injury. Lay hoses and cables in such a way that there is no risk of tripping.

### **Caution!**

#### **Damage to the appliance**

Frozen hoses may rip/burst. Do not install the washing machine in areas exposed to frost or outdoors.

### **Caution!**

#### **Water damage**

The connection points for the water supply hose and water drain hose are under high water pressure. To prevent leaks and water damage, you must follow the instructions in this section.

### **Notes**

- In addition to the safety information listed here, the local water and electricity supplier may have special requirements.
- If in doubt, have the appliance connected by a specialist.

## Installation surface

**Note:** The washing machine be stable so that it does not move around.

- The installation surface must be firm and level.
- Soft floors/floor coverings are not suitable.

## Installation on a base or a wooden joist floor

### **Caution!**

#### **Damage to the appliance**

The washing machine may "wander" and tip/topple from the base when spinning.

The feet of the appliance must be secured with holding brackets.

Order no. WMZ 2200, WX 9756, Z 7080X0

**Note:** On wooden joist floors, install the washing machine:

- In a corner, if possible,
- On a water-resistant wooden board (min. 30 mm thick) which is screwed tightly to the floor.

## Installation on a platform with drawer

Platform order no.: WMZ 20490, WZ 20490, WZ 20510, WZ 20520

## Installing the appliance in a kitchenette

### **⚠ Warning** **Danger of death!**

There is a risk of electric shock if you touch live components.  
Do not remove the appliance covering plate.

#### Notes

- Recess width of 60 cm required.
- Only install the washing machine underneath a continuous worktop that is securely connected to adjacent cabinets.

## Removing the transport locks

### **Caution!** **Damage to the appliance**

- The machine is secured for transportation using transport locks. If the transport locks are not removed, the drum, for example, may become damaged when the machine is operated. Before using the appliance for the first time, make sure that you completely remove all four transport locks. Keep the locks in a safe place.
- To prevent transport damage from occurring if the appliance is moved at a later date, you must refit the transport locks before transporting the appliance.

**Note:** Keep the screws and sleeves in a safe place.

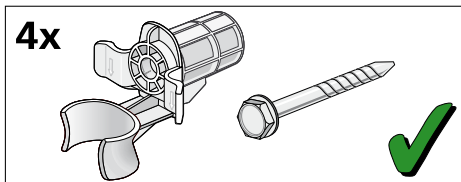

1. Take the hoses out of the holders.

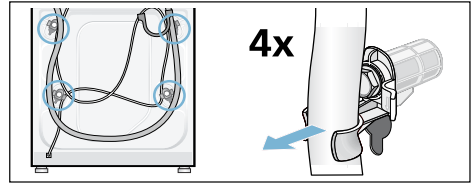

2. Unscrew and remove all four transportation securing bolts with a wrench (WAF 13). Remove the sleeves. Remove the mains cable from the holders.

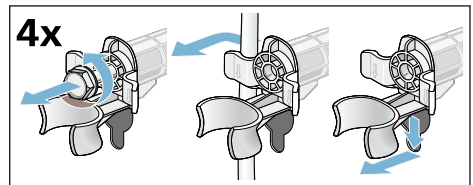

3. Insert the covers. Lock the covers firmly in place by applying pressure to the snap-in hooks.

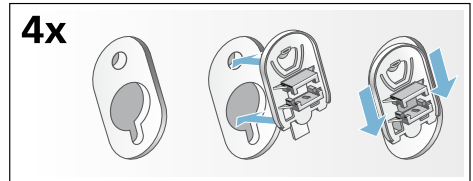

## Hose and cable lengths

### ■ Left-hand connection

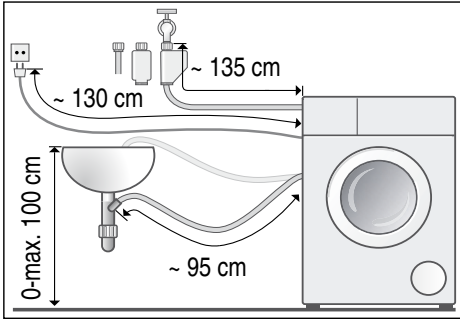

### ■ Right-hand connection

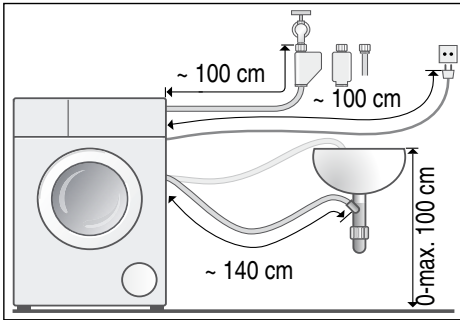

**Tip:** The following are available from specialist dealers/customer services:

- Extension for Aqua-Stop and cold water supply hose (approx. 2.50 m); order no. WM Z2380, WZ 10130, CZ 11350, Z 7070X0
- A longer supply hose (approx. 2.20 m) for standard models; individual component number for customer services: 00353925



## Water inlet

### **Warning** **Danger of death!**

There is a risk of electric shock if you touch live components. Do not immerse the Aqua-Stop safety valve in water (it contains an electric valve).

### Notes

- Only operate the washing machine using cold mains water.
  - Do not connect the machine to the mixer tap of an unpressurised hot-water boiler.
  - Do not use a used supply hose. Only use the supply hose supplied or one that was purchased from an authorised specialist retailer.
  - Do not kink or squash the water supply hose.
  - Do not alter (shorten, cut through) the water supply hose (otherwise its strength is no longer guaranteed).
  - Only tighten the screw connections by hand. If the screw connections are tightened too much with a tool (pliers), the thread may become damaged.
  - When connecting to a 21 mm = 1/2" tap, first fit an adapter\* with a sealing washer from 21 mm = 1/2" to 26.4 mm = 3/4".
- \*supplied depending on the model

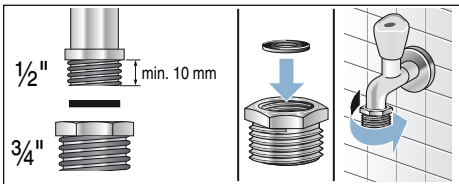

## Optimum water pressure in the supply network

**At least** 100 kPa (1 bar)

**Maximum** 1000 kPa (10 bar)

When the tap is open, the water flow rate is at least 8 l/min.

If the water pressure is higher than this, a pressure-reducing valve must be installed.

## Connection

Connect the water supply hose to the tap (26.4 mm = 3/4") and to the appliance (not necessary for Aqua-Stop models as this is permanently installed):

- Model: **Standard**

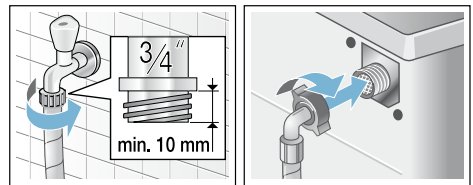

- Model: **Aqua-Secure**

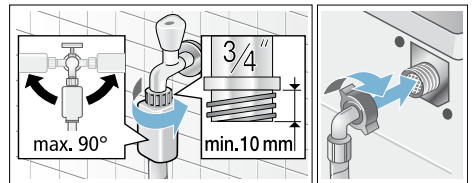

- Model: **Aqua-Stop**

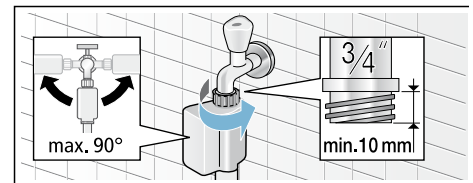

**Note:** Turn on the tap carefully, checking the leak tightness of the connection points. The screw connection is under mains water pressure.

## Water outlet

### **Warning** **Risk of scalding!**

When you are washing at high temperatures, there is a risk of scalding if you come into contact with hot water (e.g. when draining hot water into a washbasin).

Do not reach into the hot water.

### **Caution!** **Water damage**

If the drain hose slips out of the washbasin or the connection point during draining due to high water pressure, any escaping water may cause water damage.

Secure the drain hose so that it cannot slip out.

### **Caution!** **Damage to the appliance/fabrics**

If the end of the drain hose is immersed in the drained water, water may be sucked back into the appliance and may damage the appliance/fabrics. Make sure that:

- The plug does not block drainage from the washbasin.
- The end of the drain hose is not immersed in the drained water.
- The water drains away quickly enough.

**Note:** Do not kink the water drain hose or put strain on it lengthways.

## Connection

### ■ **Drainage into a washbasin**

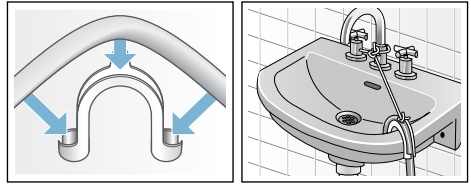

### ■ **Drainage into a siphon**

The connection point must be secured using a hose clamp with a diameter of 24 - 40 mm (available from specialist dealers).

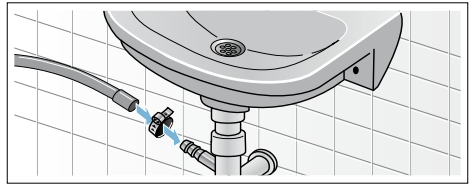

### ■ **Drainage into a plastic pipe with rubber bushing or into a drainage pit**

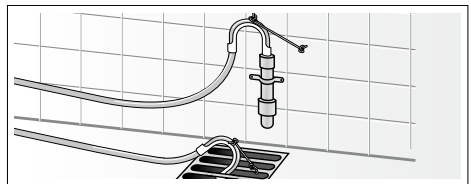

## Levelling

Align the appliance using a spirit level.

Incorrect alignment may result in loud noises, vibrations and machine "movement".

1. Loosen the lock nuts using a WAF17 spanner, by turning it in a clockwise direction.
2. Check the alignment of the washing machine with a spirit level, and adjust it if necessary. Change the height by turning the appliance feet. All four appliance feet must stand firmly on the ground.
3. The lock nuts on all four appliance feet must be screwed tightly against the housing using a suitable WAF17 spanner. In doing so, hold the foot tight and do not adjust its height.



## Electrical connection

### **Warning** **Danger of death!**

There is a risk of electric shock if you touch live components.

- Never touch or hold the mains plug with wet hands.
- Only pull out the mains cable by the plug and never by the cable, as this could damage it.
- Never unplug the mains plug during operation.

Observe the following information and ensure that:

### Notes

- The mains voltage and voltage indicated on the washing machine (rating plate) are the same. The connected load and fuse required are specified on the rating plate.
- The washing machine is only connected to an alternating current supply via a properly installed earthed socket.
- The mains plug fits the socket.
- The cable cross-section is adequate.
- The earthing system is properly installed.
- The mains cable is only replaced by a qualified electrician (if this is necessary). Replacement mains cables are available from customer services.
- No multiple plugs/couplings or extension cables are used.
- If an earth-leakage circuit breaker is used, only a type which displays the  symbol is used. Only this symbol guarantees compliance with the currently applicable regulations.
- The mains plug can be accessed at all times. If this is not possible, in order to comply with the relevant safety regulations, a switch (2-pole switch-off) must be built into the permanent installation in accordance with electrical installation regulations.
- The mains cable is not kinked, squashed, altered or cut through.
- The mains cable does not come into contact with heat sources.



## Before washing for the first time

The washing machine was thoroughly tested before leaving the factory. To remove any water that may be left over from the test, run the first wash cycle **without** any laundry.





### Notes

- The washing machine **must be correctly installed and connected.** (from → *Page 45*)
- Never use a damaged machine. Inform the after-sales service.

### Preparatory work:

1. Check the machine.
2. Fill the dispenser  and . → *Page 29*
3. Remove the protective film from the control panel.
4. Plug into the mains.
5. Turn on the tap.

### Run the programme without laundry:

1. Switch on the appliance.
2. Close the door (do not load any laundry).
3. Set the **Drum Clean 90 °C** programme.
4. Open the detergent drawer.
5. Pour approx. 1 litre of water into compartment  .
6. Pour standard washing powder into compartment  .
- Note:** To prevent foaming, only use half of the amount of detergent recommended by the detergent manufacturer. Do not use detergents that are intended for wool or delicates.
7. Close the detergent drawer.
8. Press the  button.
9. Switch off the appliance at the end of the programme.

**Your washing machine is now ready to use.**

## Transportation

E.g. when moving house

### Caution!

**Risk of damage to the appliance caused by detergent/fabric softener leaking from the dispensers.**

Leaking detergent/fabric softener can prevent the appliance from working correctly, e.g. due to damage to the electronics.

Empty the dispensers before transporting the appliance.

### Preparatory work:

1. Turn off the tap.
2. Reduce the water pressure in the supply hose: → *Page 37*; cleaning and maintenance – filter in the water supply clogged
3. Disconnect the washing machine from the mains.
4. Drain any residual water: → *Page 36*; cleaning and maintenance – drain pump blocked, emergency draining
5. Remove the hoses.
6. Empty the dispensers. → *Page 35*

### Fitting the transportation securing means:

1. Remove the covers and keep them in a safe place.  
If required, use a screwdriver.

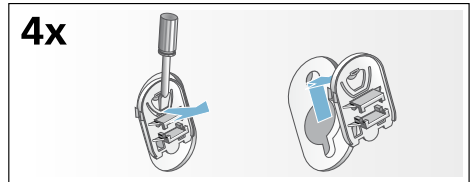

2. Insert all four sleeves.  
Clip the mains cable securely in the holders. Insert the transportation securing bolts and tighten them with a wrench (WAF 13).

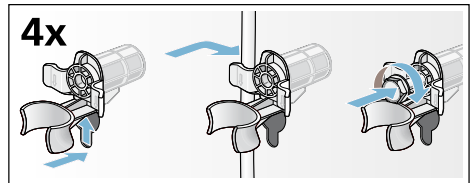

### Before switching on the appliance again:

#### Notes

- **Always** remove the transport braces.
- To prevent unused detergent from flowing straight into the drain during the next wash: Pour approx. 1 litre of water into compartment → → and start the **Empty** programme.



---

## Aqua-Stop warranty

### Only for appliances with Aqua-Stop

In addition to warranty claims against the vendor based on the purchase agreement and to our appliance warranty, we will provide compensation under the following conditions:

1. If water damage is caused due to a fault in our Aqua-Stop system, we will compensate domestic customers for the damage caused.
2. The liability guarantee is valid for the service life of the appliance.
3. It is a prerequisite of all warranty claims that the appliance with Aqua-Stop must have been installed and connected correctly in accordance with our instructions; this also includes a correctly fitted Aqua-Stop extension (genuine accessories). Our warranty does not cover defective feed lines or fittings leading to the Aqua-Stop connection at the tap.
4. Appliances with Aqua-Stop do not need to be supervised during operation, nor secured afterwards by turning off the tap.

The tap only needs to be turned off if you are away from home for a long period, e.g. for several weeks' holiday.



A series of horizontal lines for writing, starting with a solid line and followed by a series of dashed lines.

## **Repair order and advice in the event of faults**

GB 0344 892 8999 (Calls charged at local or mobile rate.)

IE 01450 2655 (0.03 € per minute at peak. Off peak 0.0088 € per minute.)

You can find the contact information for all countries in the attached after-sales service directory.

BSH Hausgeräte GmbH

Carl-Wery-Straße 34

81739 München

GERMANY

[siemens-home.bsh-group.com](http://siemens-home.bsh-group.com)

Manufactured by BSH Hausgeräte GmbH under Trademark License of Siemens AG



9001095376 (9802)