

The Siemens logo is displayed in a bold, teal, sans-serif font within a white rectangular box in the top left corner of the page. The background of the entire page is a photograph of a modern apartment interior. A large window on the left offers a panoramic view of a city at sunset, with a long, straight road leading into the distance. In the foreground, a small dog sits on a stack of books on a tiled floor. To the right, a built-in wardrobe is visible, containing folded white linens on a shelf, several shirts hanging on a rack, and a pair of white sneakers on a lower shelf.

SIEMENS

Washing machine

siemens-home.com/welcome

en Instruction Manual and Installation Instructions

Register
your
product
online

Your new washing machine

You have chosen a Siemens washing machine.

Please take a few minutes to read and become familiar with the advantages of your washing machine.

To meet the high quality demands required by Siemens, every washing machine that leaves our factory is carefully checked to ensure that it functions correctly and is in perfect condition.

For more information on our products, accessories, replacement parts and services, see our website www.siemens-home.com or contact our after-sales service centres.

If the operating and installation instructions describe different models, any differences will be pointed out at the relevant points in the text.



Read these operating and installation instructions before switching on the washing machine.

Display rules

Warning!

This combination of symbol and signal word indicates a possibly dangerous situation. Not heeding the warning can cause death or injuries.

Caution!

This signal word indicates a possibly dangerous situation. Not heeding the caution can cause property and/or environmental damage.



Information about the optimum use of the appliance/any other useful information.

1. 2. 3. / a) b) c)

The steps are represented by numbers or letters.

■ / -

Lists are represented by a small box or a dash.



Contents

Before washing

- Intended use 4
- Safety instructions 5
- Protection of the environment 7
- Getting to know your appliance 11

Operating the appliance

- Before each washing 12
- Washing 15
- After washing 16

Cleaning and maintenance

- Care and maintenance 17
- Faults, what to do? 20
- Customer service 24

Installing the appliance

- Standard accessories 25
- Installation 27
- Remove transportation protection devices 30
- Connecting the water 31
- Alignment 34
- Electrical connection 35
- Before the 1st washing 36
- Transportation, e.g. if moving house 37

Index

38



Intended use

- For use in the household only.
- The washing machine is suitable for washing machine-washable textiles and hand-washable wool in wash liquor.
- The washing machine is suitable to be operated with cold drinking water and commercially available detergents and care products which are suitable for use in washing machines.
- When dosing all detergents, cleaning aids, cleaning products and cleaning agents, always follow the manufacturer's instructions.
- The washing machine may be operated by children from 8 years of age, by persons who have limited physical, sensory or mental abilities and by persons who have inadequate experience or knowledge, provided they **are supervised** or **have been instructed** by a responsible person.
- Keep pets away from the washing machine!

Read and follow the operating and installation instructions and all other information enclosed with the washing machine.

Retain documents for subsequent use.



Safety instructions

⚠ Warning!

Risk of fatal injury from electrocution!

Your life is at risk if you touch live components.

- Only remove the mains plug by pulling on the plug body. Do not pull on the cable.
- Only plug in or disconnect the mains plug if your hands are dry.

⚠ Warning!

Risks to children!

- Do not leave children unattended near the washing machine.
- Children must not play with the washing machine.
- Children may lock themselves in appliances, putting their lives at risk.

For appliances that have reached the end of their service life:

- Disconnect the mains plug.
- Cut through the mains cable and remove complete with plug.
- Destroy the lock on the lid.
- Children must not perform cleaning or maintenance work unsupervised.
- Children may become wrapped in packaging/film or packing parts if allowed to play with them or pull them over their head and suffocate.
Keep packaging, film and packaging parts out of the reach of children.
- Detergents and care products may be poisonous if consumed, or may cause irritation if they come into contact with the eyes or skin.
Keep detergents and additives out of the reach of children.

⚠ Warning!

Risk of explosion!

Items of laundry pretreated with cleaning agents containing solvents, e.g. stain remover/cleaning solvent may cause an explosion after being loaded into the washing machine.

Thoroughly rinse out laundry items in advance by hand.

⚠ Caution!

Risk of scalding!

When you are washing at high temperatures, there is a risk of scalding if you come into contact with hot water (e.g. if hot water is being drained into a wash basin or if you have to empty the appliance in the event of a fault). Allow the water to cool down.

⚠ Caution!

Risk from damage to the appliance!

– **The lid may break!**

Do not climb onto the washing machine.

⚠ Caution!

Risk from contact with liquid detergents/care products!

Take care when opening the lid when the detergent dispenser is full.

In the event of contact with the eyes/skin, rinse thoroughly.

If swallowed accidentally, seek medical advice.



Protection of the environment

Packaging/Old appliance



Dispose of packaging in an environmentally friendly manner.

This appliance is labelled in accordance with European Directive 2012/19/EU concerning used electrical and electronic appliances (waste electrical and electronic equipment - WEEE).

The guideline determines the framework for the return and recycling of used appliances as applicable throughout the EU.

Saving tips

- Always fill the appliance with the maximum amount of laundry for the relevant programme.
- Wash normally soiled laundry without a prewash.
- **Automatic switch-off:** If the appliance is not operated for a relatively long period of time, it switches itself off automatically before the programme start and after the programme end in order to save energy. To switch the washing machine back on again, turn the programme selector to **Aus/O** (Off) and then back to the desired programme.
- If the laundry is subsequently dried in a tumble dryer, select the spin speed according to the tumble dryer manufacturer's instructions.

Information about the EU regulation

In accordance with regulation (EU) 1015/2010, further product information is provided below. The background to this is the energy-saving regulations that all appliances sold in the EU must comply with. A sample energy label is provided with explanations on a later page in these instructions. The energy label for your appliance can be found on the side or front of the appliance. The energy label contains an overview of the specific values of your appliance.

Product information

- Efficiency test programmes for cotton fabrics

Programmes that are suitable for cleaning normally soiled cotton fabrics and are the most efficient in terms of their combined energy and water consumption are contained in the attached programme table.

Programme setting for testing and energy labelling in accordance with Directive 2010/30/EU with cold water (15 °C). The programme temperature information is based on the temperature stated on the care label for the fabrics. The actual washing temperature may deviate from the stated programme temperature for energy-saving reasons.





■ Residual moisture in the laundry

The spin efficiency class of your appliance can be seen on the energy label. The percentage of residual moisture for the spin efficiency class in question can be seen in the following table.

Spin efficiency class	Residual moisture D in %
A (highest efficiency)	$D < 45$
B	$45 \leq D < 54$
C	$54 \leq D < 63$
D	$63 \leq D < 72$
E	$72 \leq D < 81$

Correct selection of detergent

The care label is crucial for the correct selection of detergent, temperature and treatment of the laundry. See also the website www.sartex.ch. On the www.cleanright.eu website, you will find further useful information about detergent, care products and cleaning agents for domestic use.

Laundry and fabric type	Washing temperature	Detergent
Boil-washable white laundry made from linen or cotton 	20 °C - max. 90 °C	Standard detergent with bleach and optical brighteners
Coloured laundry made from linen or cotton 	20 °C - max. 60 °C	Detergent for colours without bleach or optical brighteners
Coloured laundry made from easy-care fibres, synthetic fibres 	20 °C - max. 60 °C	Detergent for colours/delicates without optical brighteners
Delicate, fine fabrics, silk or viscose 	20 °C - max. 40 °C	Detergent for delicates
Wool 	20 °C - max. 40 °C	Detergent for woollens

Environmental protection and tips on economical use

In addition to the information in the instruction manual, you can lower your costs further and protect the environment by following the tips below. For light and normal soiling, it is possible to reduce the energy (lower washing temperature) and detergent.

Reduced temperature and detergent quantity as per the recommended dosage for light soiling	Leicht (Light)	No visible dirt or stains. Clothing has taken on some body odour, e.g. light summer/sports clothing (worn for a few hours), T-shirts, shirts, blouses (worn for up to 1 day), guest bed linen and hand towels (used for 1 day)
	Normal	Visible dirt or a few light stains, e.g. T-shirts, shirts, blouses (soaked in sweat, worn a few times), towels, bedding (used for up to 1 week)
Temperature as per care label and detergent as per recommended dosage for heavy soiling	Stark (Intense)	Dirt and/or stains clearly visible, e.g. tea towels, baby items, work clothing

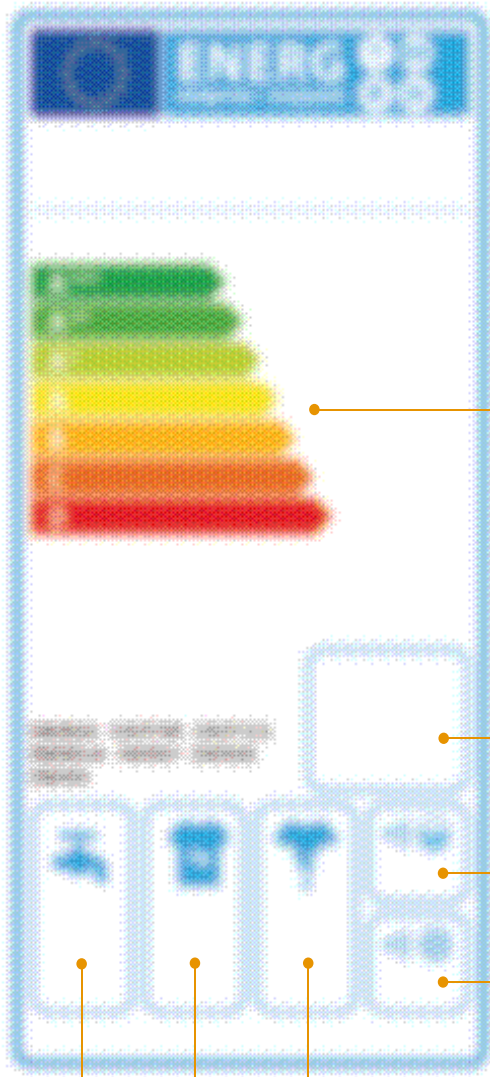

Energy efficiency classes

Annual energy consumption

Noise value during wash cycle

Noise value during spin cycle

Annual water consumption

Spin efficiency class

Load

Much more important information can be found in your operating and installation instructions.



Getting to know your appliance

Your appliance

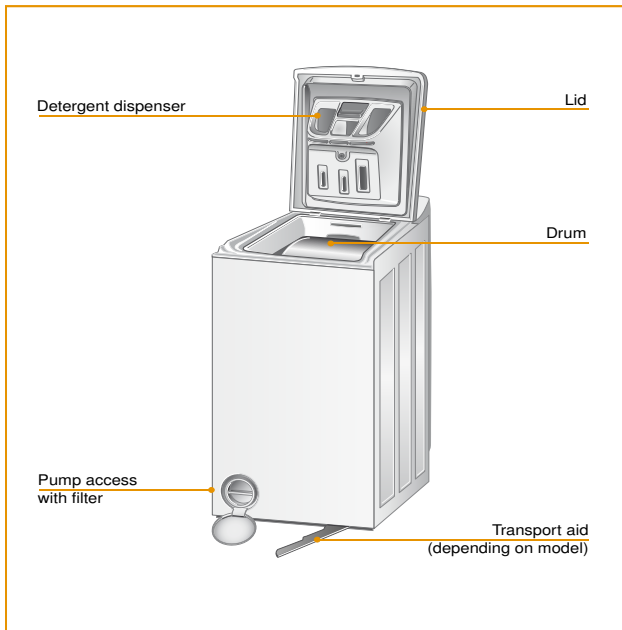

Detergent dispenser

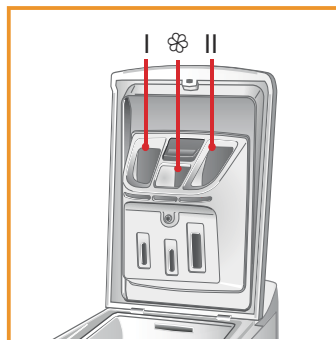

- Compartment I detergent for prewash
- Compartment ☼ fabric softener, starch, bleach
- Compartment II detergent for the main wash, water softener, stain remover

i Never exceed the "MAX" mark in each compartment.



Before each washing

- i** Make sure that
 - The washing machine has been **correctly installed** and **connected** . *From* → *Page 27*
 - A complete wash cycle **without** laundry has been run before the first use. → *Page 36*

1. Preparing the washing



Sorting the washing according to:

- Type of fabric/fibre.
- Colour.
- Soiling.
- Follow manufacturer's care information.
- Care label specifications:



Cottons 95 °C, 90 °C



Coloureds 60 °C, 40 °C, 30 °C



Easy-Care 60 °C, 40 °C, 30 °C



Delicates 40 °C, 30 °C



Hand and machine-washable silk and woollens cold, 40 °C, 30 °C



Do not wash laundry in the washing machine.

Protecting the washing and the machine:

- i** - When dosing all detergents, cleaning aids, cleaning products and cleaning agents, always follow the manufacturer's instructions.
- Keep detergents and agents for the pretreatment of washing (e.g. stain remover, prewash sprays, ...) away from the surfaces of the washing machine. Using a damp cloth, immediately remove any fine spray residue and other residue/droplets.



- Empty pockets.
- Remove metal parts (paper clips, etc.).
- Wash delicates in the net/bag (tights, underwired bras).
- Close zips, button up covers.
- Brush sand out of pockets and collars.
- Remove curtain fittings or include in the net/bag.
- Wash new items separately.

2. Preparing the appliance



Insert mains plug.

Turn on water tap.

3. Placing the laundry in the drum, selecting the programme



1. Open the machine lid by lifting it up.
2. Hold the rear drum flap, push the slide in the direction of the arrow with the other hand and push the front drum flap down gently until the locking mechanism releases.
3. Place the items of laundry in one at a time. Do not exceed the maximum load shown in the programme table.

- i** – Overfilling has a negative impact on the washing result and promotes creasing.
- Mix large and small items of laundry. Laundry items of different sizes distribute themselves better during the spin cycle.
 - Do not press laundry into the drum with the drum flaps.

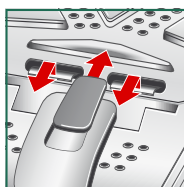

4. To close, place both drum flaps over the drum opening, with the rear one on top of the front one, then push them both down gently until the locking mechanism engages.

- i** – Make sure that the drum flaps lock correctly: the metal hook must engage fully; the slide must protrude slightly over the rear drum flap.
- Do not trap any laundry between the flap and the drum.

5. Select the programme.
Select the programme with additional functions according to the programme table. Set the temperature and spin speed.

4. Detergents and care products

1. The detergent that should be selected depends on:
 - Fabric type
 - Fabric colour
 - Washing temperature
 - Type and degree of soiling

- i** – Do not use liquid detergent if the "Startverzögerung" (Delay start) function is set.
- Do not use liquid detergent for the main wash if the "Vorwäsche" (Pre-wash) additional function has been selected.
- Only use detergent and care products for domestic washing machines.
- Dilute thick fabric softener and conditioner with a little water.

2. Measure accordingly:
 - Manufacturer's instructions
 - Type and degree of soiling
 - Water hardness (ask your water supply company)
 - Size of load (half load = 3/4 dosage, minimum load = 1/2 dosage)

- i** – Using too much detergent results in increased foaming and has an adverse effect on the cleaning action.
- Using too little detergent causes the laundry to turn grey and results in limescale build-up.
- Add highly concentrated powder and liquid detergents directly to the drum.

3. To add detergent and care products:
 - Do not fill the detergent or care product over the "**MAX**" mark.
 - For programmes without a pre-wash and with temperatures between cold and 40 °C, you should use liquid detergent. Likewise if "Startverzögerung" (Delay start) is not activated. This prevents detergent residues.

5. Starting the programme

- i** You can find information about the programmes in the separate programme table.
 - Select **Start**.



Washing

During the washing cycle

- **Childproof lock** (if present; depends on the model)
The childproof lock can be activated to prevent the functions that have been set on the washing machine from being changed inadvertently.
To activate/deactivate: press and hold the buttons with the key symbol at the same time for at least 3 seconds.
A key symbol appears in the display (if present).
- **Changing the programme**
If you have accidentally started the wrong programme.
 1. Select **Start**. The indicator lamp flashes.
 2. Select a different programme, option, temperature or spin speed.
 3. Select **Start**. The new programme starts in the same phase in which the previous programme was interrupted.
- **Cancelling the programme**
 1. Press and hold **Löschen (clear)** for approx. 3 seconds.
 2. **rES** appears in the display (if present).
 3. Any water present is drained.
 4. The lid can be opened.

Programme end

The "Deckel frei" (lid released) symbol lights up or appears in the display (if present).



After washing

1. Set the programme selector to "Aus" (off).

2. Open the machine, take out the laundry

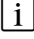
-  – Do not leave any items of laundry in the drum. They could shrink in the next wash or discolour another item.
- Leave the lid and drum open so that any remaining water can dry.
- Always wait for the end of the programme, otherwise the appliance will still be locked.



3. Turn off the tap.



Care and maintenance

Machine housing/control panel

- Remove detergent residues immediately.
- Wipe with a soft, damp cloth.
- Do not clean with a water jet.
- Do not use cleaning agents containing solvents, scouring powder, glass cleaner, multi-purpose cleaner or flammable liquids. These could damage the surfaces.

Drum

Use chlorine-free cleaning agent, do not use steel wool, do not use flammable liquids.

Descaling

Not required if detergent dosed correctly. However, if this does occur, follow the instructions of the descaling agent manufacturer. Suitable descalers can be purchased on our website or from customer service. → *Page 24*

Cleaning the detergent dispenser

Clean the detergent dispenser regularly (at least 3 or 4 times a year) to prevent detergent from accumulating.

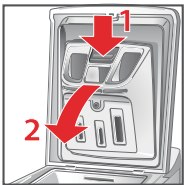

1. Press the push-button above the fabric softener compartment in the middle of the detergent dispenser downwards.
2. Pull out the detergent dispenser towards the front.



There may be water in the detergent dispenser. Hold the detergent dispenser upright.

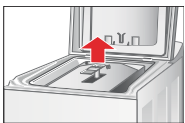

3. Rinse out the detergent dispenser under running water. The insert for the fabric softener compartment on the back of the detergent dispenser can be removed for cleaning purposes.
4. If applicable, refit the insert for the fabric softener compartment on the back of the detergent dispenser.

5. Insert the lower retaining brackets on the detergent dispenser into the corresponding openings in the lid and push the detergent dispenser towards the lid until it engages.

Filter in drain pump blocked

The washing machine is fitted with a self-cleaning pump. The filter catches objects such as buttons, coins, etc.

Check the filter regularly (at least two or three times a year). In particular:

- if the washing machine is not draining or spinning correctly.
- if the "Pumpe reinigen" (clean pump) display lights up.

⚠ Warning!

Risk of scalding!

When you wash at high temperatures, the water gets very hot. If you come into contact with the hot water, you may be scalded.

Allow the water to cool down.

- i** Turn off the tap so that no more water can flow in and has to be drained via the drain pump.

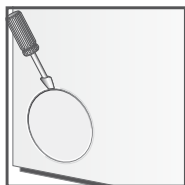

1. Switch off the appliance. Disconnect the mains plug.
2. Open the access to the pump, e.g. with a screwdriver.
3. Place a bowl underneath.
4. Slowly turn the filter anti-clockwise. Do not remove it yet!
5. Allow the water to drain out.

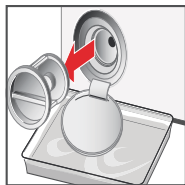

6. Unscrew the filter completely.
7. Clean the filter and filter compartment.
8. Make sure that the pump impeller (behind the filter in the housing) can move.
9. Refit the filter. Screw in tightly as far as it will go in a clockwise direction.
10. Pour 1 litre of water into the drum to ensure that no water escapes from the filter.
11. Close the access to the pump.
12. Connect the mains plug.

Drainage hose on the siphon blocked

1. Switch off the appliance. Pull out the mains plug!

Note: Residual water may run out!

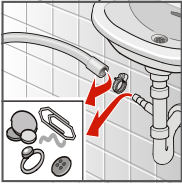

2. Loosen hose clip, carefully remove drainage hose.
3. Clean drainage hose and siphon spigot.
4. Re-attach drainage hose and secure connection point with hose clip.

Filter in the water supply blocked

Check and clean the filter regularly (at least two to three times a year).

1. Turn off the tap. Disconnect the mains plug.
2. Unscrew the hose from the tap.
3. Carefully clean the filter on the end of the hose with a small brush (e.g. toothbrush).



Do not immerse the hose in water.

4. Screw the hose back onto the tap. Do not use pliers.
5. Connect the mains plug.



Supply hose

– Regularly check for brittleness and cracks and replace if necessary.

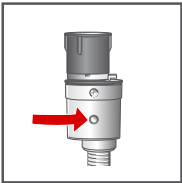

– The Aqua-Stop supply hose (fig. left) has a safety valve that protects against the uncontrolled supply of water. If the inspection window (see horizontal arrow) on this valve turns red, the safety mechanism has been triggered. The hose must be replaced → after-sales service

– Depending on the model, the water stop supply hose may have an unlocking device (see horizontal arrow), which must be pressed and held while the hose is being unscrewed from the tap.



– On supply hoses with a transparent covering, regularly check the colour of the covering. An intensification of the colour in places indicates that there is a leak. The hose must be replaced. → After-sales service



Faults, what to do?

Removing an object from between the drum and outer tub

If an object should fall between the drum and the tub, you can remove it as follows:

1. Switch off the appliance and disconnect the mains plug.
2. Remove the laundry from the drum.
3. Close the drum flaps and turn the drum through half a turn.

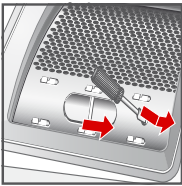

4. Use a screwdriver to press on the plastic end and, as you do so, push the plastic part from left to right; the part falls into the drum.

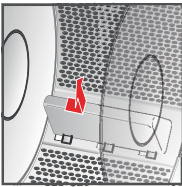

5. Turn the drum through half a turn; the object can now be removed through the opening that has been created in the drum.
6. Refit the plastic part inside the drum. Position the plastic tip over the opening on the right-hand side of the drum.
7. Push the plastic part from right to left until it engages.

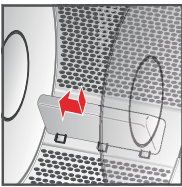

8. Close the drum flaps and turn the drum through half a turn. Check the position and fitting of the plastic part.
9. Connect the mains plug

Problem	Cause/Remedial action/Suggestions
The machine will not start; no displays light up	<ul style="list-style-type: none"> - Is the plug plugged in? - Is the socket faulty? Does it contain a fuse?
The appliance does not start when Start/Pause is pressed	<ul style="list-style-type: none"> - Is the lid closed properly? - Is the button lock activated? To unlock it, press and hold the two buttons with the key symbol at the same time for at least 3 seconds. The key symbol goes out in the display.
Washing machine stops during a programme, Start/Pause display flashes	<ul style="list-style-type: none"> - Is rinse hold activated? Press Start/Pause or start draining to end the programme. - The programme has been changed. Reselect the programme and start it. - Was the programme interrupted and the lid opened? Close the lid and restart the programme. - Are any fault displays lit up? - Check the water supply and hose.
Remains of detergent in the detergent dispenser after washing	<ul style="list-style-type: none"> - Is the detergent dispenser inserted correctly? - Is the filter in the supply hose blocked?
Intense noise, vibrations and "wandering" during spinning.	<ul style="list-style-type: none"> - Is the washing machine level? Has it been installed correctly? - Transportation safety device removed?
Spin result not satisfactory. Laundry wet/too damp.	<p data-bbox="313 805 1041 941">The appliance has an unbalanced load detection system. If it has been loaded with heavy individual items (e.g. a bathrobe), the spin speed is automatically reduced to protect the machine. If necessary, the spin cycle is stopped (see also the "Imbalance during spinning" section below).</p> <ul style="list-style-type: none"> - Add some light items of laundry and repeat the spin programme. - Excessive foaming can prevent spinning. Start "Spülen und Schleudern" (Rinse and spin). Avoid using excessive quantities of detergent. - Has a low spin speed been set?

Problem	Cause/Remedial action/Suggestions
Programme duration longer/shorter than originally displayed/specified.	Not a fault. The washing machine adapts the programme duration accordingly based on factors such as excessive foaming, load imbalance due to heavy items of laundry, longer heating time due to lower supply water temperature, etc.
"Unwucht beim Schleudern" (Imbalance during spinning) The spin indicator in the programme sequence display flashes or the spin speed flashes in the display once the programme has ended (depending on the model). The laundry is still very damp.	A laundry load imbalance during spinning has caused the spin cycle to be cancelled to protect the washing machine. The cause could be a small load that consists of just a few absorbent items (e.g. towels) or large/heavy items of laundry. <ul style="list-style-type: none"> – If possible, avoid washing small loads. – If possible, add a few more items of various sizes if you are washing a large or heavy item of laundry. If you want to spin the wet laundry: Add several items of laundry of various sizes and start the "Spülen & Schleudern" (Rinse & spin) programme.

Flashing fault display	Contents of display (if present)	Cause/remedial action
Wasserhahn zu (Tap closed)		No water supply, or water supply insufficient. <ul style="list-style-type: none"> – Tap off/not turned on fully, – Supply hose kinked/trapped – Water pressure too low. Clean the filter. – For models with an Aqua-Stop hose: if the colour in the inspection window of the safety valve is red, replace the hose.
Pumpe reinigen (Clean pump)		The water is not emptied. <ul style="list-style-type: none"> – Detergent solution pump blocked. Clean the filter. – Drain hose/waste pipe blocked. Clean the drain hose at the siphon. Once the fault has been rectified, start the Abpumpen (drain) programme or press and hold the Löschen (Clear) button for at least 3 seconds.
Service	bdd (models without display: all indicator lamps light up)	The washing machine stops in the middle of a programme. The drum flap is open/not closed properly: Press and hold the Löschen (Clear) button for at least 3 seconds until " Tür offen " (Door open) lights up. Turn the programme selector to "Aus" (Off), open the lid, close the drum flap. Restart the programme.

Flashing fault display	Contents of display (if present)	Cause/remedial action
Service	From F02 to F35	Fault in an electrical component. Start the "Abpumpen" (Drain) programme or press and hold the "Löschen/Abpumpen" (Clear/drain) button for at least 3 seconds.
	F06	Check whether the correct programme has been selected for the type of laundry, and whether the maximum load has been observed (see programme table). Press and hold "Löschen" (Clear) for at least 3 seconds; the programme is cancelled. Then select a suitable programme for the type of laundry.ⓘ
	FA	Fault in the Aqua-Stop device. Switch off the appliance, pull out the mains plug, turn off the tap. Carefully tip the appliance forwards. Allow the water to drain out of the appliance base. Then: <ul style="list-style-type: none"> – Connect the mains plug – Turn the tap on – Restart the programme
Service	Fod	Excessive foaming Programme interrupted because of excessive foaming <ul style="list-style-type: none"> – Start the Spülen und Schleudern (Rinse and spin) programme. – Restart the desired programme. Use less detergent

Should the malfunction persist: unplug the mains plug, turn off the tap and call the after-sales service.



Customer service

If you cannot remedy the fault yourself, *Faults and what to do about them* → Page 20, please contact our after-sales service. We will always find an appropriate solution and will avoid unnecessary visits by engineers.

Please give the after-sales service the product number (E no.) and the production number (FD) of the appliance.

E-Nr. _____ FD _____

Product number

Production number

You can find this information behind the pump access flap and on the rear of the appliance.

Trust the expertise of the manufacturer.

Contact us for assistance. You will thereby ensure that the repairs are performed by trained service personnel using genuine spare parts.



Standard accessories

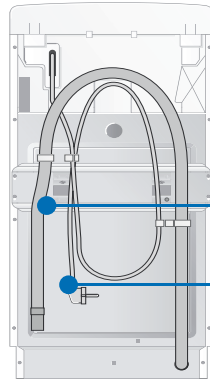

Water drain hose

Mains cable



Installation and operating instructions, programme table

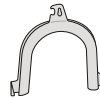

Angle for securing the water drain hose

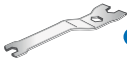

Spanner for adjusting the feet



Water supply hose (in the drum)

Also required for connection of the water drainage hose to a siphon:

1 hose clip Ø 24–40 mm (DIY store) is also required for connection to a siphon. *Connecting the water* → Page 33

Useful tools:

- Spirit level for levelling
- Flat-head screwdriver or hexagon socket wrench no. 8 for undoing the transport locks

Hose and cable lengths

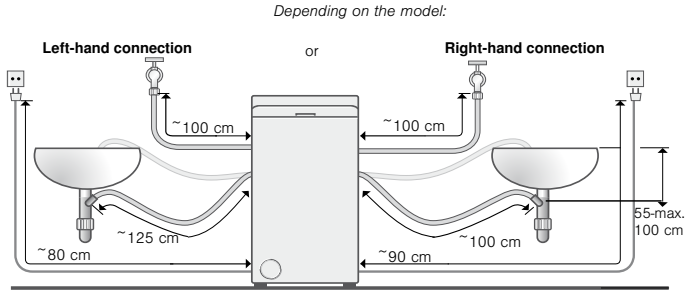

- i** Using the hose clips reduces the number of possible hose lengths

Available from specialist retailers/after-sales service:

- Extension for Aqua-Stop or cold-water supply hose (approx. 2.50 m).
Order no. WMZ2380, WZ10130, CZ11350, Z7070X0
- Longer supply hose (approx. 2.5 m) for standard model.

Technical data

Dimensions (width x depth x height)	40 x 65 x 90 cm
Weight	Approx. 58 kg
Mains connection	Nominal voltage 220-240 V, 50 Hz Nominal current 10 A Nominal output 2300 W
Water pressure	100-1000 kPa (1-10 bar)



Installation

- i** Humidity in the drum is caused by the final inspection.

Secure installation

⚠ Warning!

Risk of injury!

- The washing machine is heavy – caution: take care when lifting it.
- If the washing machine is raised by protruding components (e.g. washing machine door), the components may break off and cause injuries. Donot lift the washing machine by its projecting parts.

⚠ Caution!

Risk of stumbling!

If the hoses and power cord are installed improperly, there is a risk of tripping and injury.

Lay hoses and cables in such a way that there is no risk of stumbling.

⚠ Caution!

Washing machine may be damaged!

- Frozen hoses may tear/burst.
Do not install the washing machine in an area where there is a risk of frost or outdoors.
- If the washing machine is raised by protruding components (e.g. washing machine door), the components may break off and the washing machine may be damaged.
Donot lift the washing machine by its projecting parts.



- In addition to the safety information listed here, the local water and electricity supplier may have special requirements.
- If in doubt, have the appliance connected by a technician.

⚠ Warning!
Risk of injury!

- The washing machine is extremely heavy - take care when lifting it. Have it lifted by at least two people.
- When the washing machine is lifted, protruding parts (e.g. the lid) may break off and cause injuries. Do not lift the washing machine by protruding parts.

⚠ Caution!
Risk of tripping!

If the hose and mains lead are not routed properly, there is a risk of tripping and injury.

Lay hoses and cables in such a way that there is no risk of tripping.

⚠ Caution!
The washing machine could be damaged.

- Frozen hoses may rip/burst. Do not install the washing machine in areas exposed to frost or outdoors.
- If the washing machine is lifted by protruding parts (e.g. lid), the parts may break off and the washing machine could be damaged. Do not lift the washing machine by protruding parts.

- i** - In addition to the safety information listed here, the local water and electricity supplier may have special requirements.
- If in doubt, have the appliance connected by a specialist.

Installation area

- i** Stability is important to prevent the washing machine from wandering!
- The installation area must be firm and level.
 - Soft floors/floor coverings are not suitable.

Installation on a wooden floor or floating floor

Warning!

The washing machine could become damaged!

Secure the feet of the washing machine with holding brackets.

Holding brackets: order no. WMZ 2200, WX 9756, CZ 110600, Z 7080X0

-  – If possible, place the washing machine in a corner.
- Screw a water-resistant wooden board (min. 30 mm thick) to the floor.



Remove transportation protection devices

⚠ Caution!

The washing machine may become damaged.

If the transportation safety devices are not removed, the drum may become damaged, for example, when the washing machine is operated.

Before using the appliance for the first time, make sure that you completely remove the transportation safety device and keep it in a safe place.

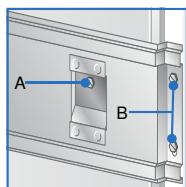

1. Remove the two "A" screws and the four "B" screws with a flat-head screwdriver or a hexagon socket wrench no.8.

2. Remove the transportation safety devices .

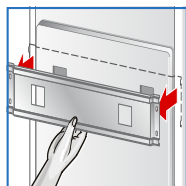

3. Refit the four outer screws "B". Tighten the screws.

4. Insert the cover caps supplied into the openings.

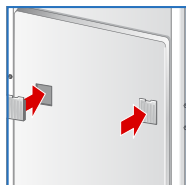

⚠ Caution!

Do not forget to refit the four outer screws "B". Tighten them firmly.

⚠ Caution!

The washing machine may become damaged.

To prevent transport damage from occurring if the appliance is moved at a later date, you must refit the transportation safety device before transporting the appliance.



Connecting the water

⚠ Caution!

Do not immerse the Aqua-Stop safety device in water.

- i** – To prevent leaks and water damage, you must follow the instructions in this section.
- Only operate the washing machine using cold drinking water.
- Do not connect to the mixer tap of an unpressurised hot-water boiler.
- Do not use a used inlet hose. Only use the inlet hose supplied or one that was purchased from an authorised specialist retailer.
- If in doubt, have the appliance connected by a specialist.

Water supply

- i** Do not bend, squash, modify or cut through the water supply hose (otherwise its strength is no longer guaranteed).

Optimum water pressure in the supply network: 100-1000 kPa (1-10 bar)

- When the tap is open, the water flow is at least 8 l/min.
- If the water pressure is higher than this, a pressure reducing valve must be installed.

1. Connect the water supply hose.

⚠ Caution!

The thread on the screw connection may be damaged

If the screw connections are tightened too much with a tool (pliers), the thread may be damaged.

Only tighten the screw connections by hand.

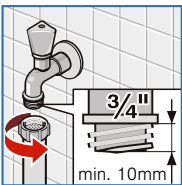

At the tap (3/4" = 26.4 mm):

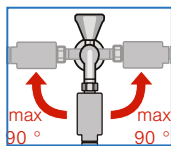

At the appliance:

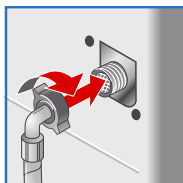

To unscrew the Aqua-Stop hose:

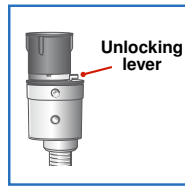

To unscrew the Aqua-Stop hose (if present), press and hold the unlocking lever (if present).

2. Open the water tap carefully, checking the leak tightness of the connection points.

i The screw connection is under mains water pressure.



Connect the water drain hose

- i**
- Do not kink the water drain hose or put strain on it lengthways.
 - Height difference between the installation surface and the drain: 55 - max. 100 cm

Outlet in a sink

⚠ Warning!

Possible water damage!

If the drain hose slips out of the wash basin during draining due to the high water pressure, any escaping water can cause water damage.

Secure the drain hose so that it cannot slip out.

⚠ Caution!

The appliance may become damaged.

If the end of the drain hose is immersed in the drained water, water may be sucked back into the appliance.

- The plug must not block drainage from the sink.
- Small hand wash basins are not suitable.
- During emptying, check whether the water is draining away quickly enough.
- The end of the outlet hose must not be immersed in the drained water.

Routing the drain hose:

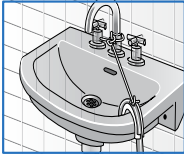
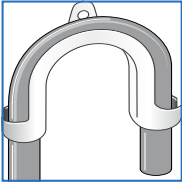

- i** The elbow must be secured right at the end of the drain hose.

Drainage into a siphon

⚠ Warning!
Water damage possible!

If the drainage hose slips off the siphon connection due to high water pressure when draining the washing machine, leaking water may cause damage. Connection point must be secured with hose clip, Ø 24–40 mm (specialist outlet).



Connecting

Outlet to a plastic pipe with rubber bushing

⚠ Warning!
Possible water damage!

If the drain hose slips out of the plastic pipe during draining due to the high water pressure, any escaping water may cause water damage. Secure the drain hose so that it cannot slip out.

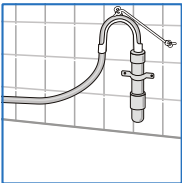

Connection



Alignment

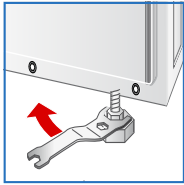

1. Undo the lock nut with a wrench in the direction of the arrow.
2. Check the alignment of the washing machine with a spirit level and adjust if necessary. Change the height by turning the appliance feet.

i All appliance feet must stand firmly on the ground.
The washing machine must not wobble.

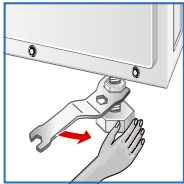

3. Tighten the lock nut against the housing.
In doing so, hold the foot tight and do not adjust its height.

i

- The lock nuts on all of the appliance feet must be screwed tightly against the housing.
- Intense noise, vibrations and "wandering" may be the result of incorrect levelling.



Electrical connection

Electrical safety

Warning!

Danger of death from electric shock!

Danger of death if live parts are touched.

- Never pull out the mains plug by tugging the power cord.
- Insert/pull out the mains plug with dry hands only.
- Never pull out the mains plug during operation.
- Connect the washing machine to an alternating current via a correctly installed earthed socket only.
- The mains voltage and voltage specifications on the washing machine (appliance rating plate) must match.
- Connected load as well as required fuse are indicated on the appliance rating plate.

Ensure that:

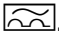
- Mains plug and socket match fit.
- Cable cross-section is adequate.
- Earthing system has been installed correctly.
- A damaged power cord may be replaced by an electrician only. A replacement mains cable can be obtained from customer service.
- Do not use multiple plugs/couplings or extension cables.
- If a residual-current-operated circuit breaker is used, use only a type which features this symbol:

Only this symbol guarantees compliance with currently valid regulations.
- The mains plug must be accessible at all times.



Before the 1st washing

The washing machine was thoroughly tested before leaving the factory. To remove any water that may be left over from the test, do **not** load any laundry the first time that you run a washing programme.

i The washing machine must be installed and connected correctly as described in the *Installation chapter* from → *Page 34 onwards*.

1. Check the machine.

i Never use a damaged machine. Inform the after-sales service. → *Page 24*

2. Remove the protective film from the display (if present).

3. Connect the mains plug.

4. Turn the tap on.

5. Open the lid; make sure that the drum flaps are closed correctly (do not load any laundry).

6. Select the **Baumwolle (cottons)** programme.

7. Set the temperature to **60 °C**.

8. Add 1/3 of the amount of standard detergent recommended by the manufacturer for light soiling to compartment **II**.

i To prevent foaming, only use approximately a third of the recommended amount of detergent. Do not use detergent for wool or delicates.

9. Close the lid.

10. **Select** start/pause.

11. At the end of the programme, turn the programme selector to "Aus" (off).

Your washing machine is now ready to use.



Transportation, e.g. if moving house

Preparatory work

1. Disconnect the mains plug.
2. Turn off the tap.
3. Remove the water supply and drain hose.
4. Wait until the water has cooled in order to prevent scalding.
Drain the remaining detergent solution. *Maintenance – detergent solution pump blocked* → Page 19
5. For easier transport, slightly pull out the handle at the bottom of the appliance on the front (depending on the model). If necessary, use foot to help pull out the handle fully.

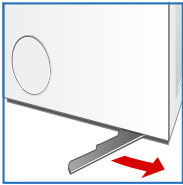

Fitting the transport lock

1. Refit the transport lock.
2. Transport the appliance in an upright position.

Before initial use:

-  – You **must** remove the transport lock. → Page 30
- Return the transport handle to its original position.
- To prevent unused detergent from flowing straight into the drain during the next wash: Pour 1 litre of water into the drum and start the **Abpumpen (drain)** or **Löschen/Abpumpen (clear/drain)** programme (depending on the model).

Index

- A** Alignment, 34
- C** Cancelling the programme, 15
Care, 17
Drum, 17
Machine housing/control panel, 17
Changing the programme, 15
- D** Descaling, 17
Detergent dispenser, 11
- E** Electrical connection, 35
- F** Faults, what to do?, 20
- G** Getting to know your appliance, 11
- H** Hose and cable lengths, 26
- I** Installation, 27
Intended use, 4
- M** Maintenance, 17
- O** Object between the drum and outer tub, 20
Old appliance, 7
- P** Packaging, 7
Programme end, 15
Protection of the environment, 7
- S** Safety instructions, 5
Saving tips, 7
Sorting
the washing, 12
Standard accessories, 25
Starting the

programme, 14

T	Technical data, 26	Transport locks
	Transport bolts , 30	Fitting, 37
W	Water connection	Water supply, 31
	Drain, 32	

Aqua-Stop warranty

For appliances with Aqua-Stop only

In addition to warranty claims against the seller based on the contract of sale and in addition to our appliance warranty we shall pay damages under the following conditions:

1. If water damage is caused by a fault in our water safety system, we shall make repairation for the damage with respect to private users.
2. The liability warranty applies to the service life of the appliance.
3. A claim can only be made under the warranty if the appliance and Aqua-Stop have been correctly installed and connected according to our instructions; this also includes a correctly installed Aqua-Stop extension (original accessory).
4. Our guarantee does not apply to defective cables/hoses or to fittings up to the connection on the tap.
5. Appliances which feature Aqua-Stop can be left unattended during operation and it is not necessary to turn off the tap afterwards.
6. The tap should only be turned off if you are away for a prolonged period, e.g. several weeks holiday.

To book an engineer visit and product advice

GB	0344 892 8999	Calls charged at local or mobile rate.
IE	01450 2655	0.03 € per minute at peak. Off peak 0.0088 € per minute.

Please find the contact data of all countries in the enclosed customer service list.

BSH Hausgeräte GmbH
Carl-Wery-Straße 34
81739 München
GERMANY
siemens-home.com

Manufactured by BSH Hausgeräte GmbH under Trademark License of Siemens AG



9000934734 (9501) W10857547