



Gas hob

ER326BB90X

[en] Instruction manual

中文說明書

型號

ER326BB90X 煤氣雙頭爐

請保留此說明書

SIEMENS

ER326BB90X

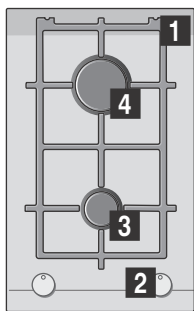

-
- 1** Pan supports
 - 2** Control knobs
 - 3** Front burner (up to 1.9 kW)
 - 4** Rear burner (up to 2.8 kW)
-

- 1** 平底鍋支架
- 2** 控制旋鈕
- 3** 前爐頭 (高至 1.9 kW)
- 4** 後爐頭 (高至 2.8 kW)

en Table of contents

Safety precautions	3	Maintenance	6
Your new appliance.....	5	Trouble shooting	7
Gas burners	5	Technical Assistance Service	7
Power levels	5	Warranty conditions.....	7
Switching on automatically	5	Used appliances and packaging.....	8
Safety system	5	Environmentally-friendly waste management.....	8
Switching off a burner.....	5	Specification	8
Warnings	5		
Cooking pans.....	6		
Suitable pans.....	6		
Precautions for use	6		
Cleaning and maintenance.....	6		
Cleaning	6		

Additional information on products, accessories, replacement parts and services can be found at www.siemens-home.com and in the online shop www.siemens-eshop.com

⚠ Safety precautions

Read these instructions carefully. You will only be able to use your appliance safely and effectively when you have read them. These operating and installation instructions should be retained, and passed onto the buyer if the appliance is sold.

Attention!

According to the Gas Safety Ordinance of Hong Kong, any gas installation works including the installation of appliances and connection tubing, must be undertaken by registered gas installers who are registered for that appropriate classes and be employed by registered gas contractors.

Use approved gas tubing bearing EMSD approval marking (such as: 機電工程署批准 EMSD APPROVAL GTXXXX) for connection to appliances, or other appropriate methods accepted by EMSD.

HK Town Gas connection

Governor Beckley model 2300 or Elitre EL - 125 should be installed. The working pressure is 10 mbar.

This appliance must not be converted to another type of gas.

Please do not use additional fitting, such as aluminium cover.

The manufacturer is exempt from all responsibility if the requirements of this manual are not complied with.

The images shown in these instructions are for guidance only.

Do not remove the appliance from its protective packaging until it is installed in the

unit. Do not switch on the appliance if it is damaged in any way. Contact our Technical Assistance Service.

This appliance is class 3 type, according to the EN 30-1-1 regulation for gas appliances: built-in appliance.

Before installing your new hob, ensure that it is being installed according to the assembly instructions.

This appliance cannot be installed on yachts or in caravans.

This appliance must only be used in well ventilated places.

This appliance is not intended for operation with an external clock timer or a remote control.

When installing built-in gas hob on top of stove cabinet, please check that there is provision for ventilation at the cabinet to ensure proper operation of the gas hob.

Do not store any flammable materials, sprays or pressurized containers inside the stove cabinet.

The top panel of this built-in hob is made of ceramic glass which is safer than normal glass for this application. However, the following safety precautions for using built-in hob with glass top panel should also be noted in order to prevent the glass top panel from breaking:

1. Clean the burner assembly frequently to maintain a clear gas passage on the flame distributor. Clean and tidy up the flame distributor after spillage of food and liquid once the burner assembly cooled down.
2. Turn off the gas appliance immediately if abnormal noise propagates from the gas appliance and contact gas supply company or gas hob importer for inspection.
3. Do not use oversized utensils for cooking.
4. Do not impact the glass surface with hard objects or place heavy objects on the glass surface.

This appliance has been designed for home use only, not for commercial or professional use. This appliance is only intended for cooking purposes, not as a heating system. The warranty will only be valid if the appliance is used for the purpose for which it was designed.

Never leave the appliance unattended during operation.

Do not use lids or protective barriers for children which are not recommended by the hob manufacturer. They may cause accidents such as those due to the overheating, ignition or detachment of fragments of materials.

This appliance may be used by children 8 years old and older and by persons with reduced physical, sensory or mental capacity or a lack of experience or knowledge if they are supervised or they have been instructed about the safe use of the appliance and have understood the associated dangers.

Never let children play with the appliance. Cleaning and user maintenance must not be carried out by unsupervised children.

Risk of deflagration!

Accumulation of unburned gas in an enclosed area carries a risk of deflagration. Do not subject the appliance to draughts. These might blow out the burners. Carefully read the instructions and warnings on the operation of gas burners.

Risk of poisoning!

The kitchen will become hot and humid and combustion products produced when this gas appliance is used. Make sure the kitchen is well ventilated, particularly when the hob is in operation: either keep the natural ventilation apertures open, or install a ventilation system (extractor hood). Intense prolonged use of the appliance may require additional or more effective ventilation: open a window or increase the power of the ventilation system.

Risk of burns!

The hotplates and their immediate vicinity get very hot. Never touch the hot surfaces. Keep children under 8 years old well away from this appliance.

Risk of fire!

- The hotplates get very hot. Do not rest inflammable objects on the hob. Do not store objects on the hob.
- Do not store or use corrosive chemicals, products which produce fumes, inflammable materials or non-food products below or near this domestic appliance.
- Fat or oil which is overheated can catch fire easily. Never leave fat or oil to heat up unattended. If oil or fats do catch fire, never use water to put the fire out. Put the fire out by covering the pan with a lid and switch off the hotplate.

Risk of injuries!

- Pans which are damaged, are not the right size, hang over the edge of the hob or are not positioned correctly can cause serious injuries. Follow the advice and warnings provided relating to the cooking pans.
- In the event of a malfunction, turn off the appliance's gas and electricity supply. For repairs, call our Technical Assistance Service.
- Do not tamper with the appliance's interior. If necessary, call our Technical Assistance Service.
- If one of the control knobs will not turn, do not force it. Call the Technical Assistance Service immediately so that they can repair or replace them.

Risk of electric shock!

- Do not clean the appliance using steam cleaners.
- Cracks or breaks in the glass may carry an electrocution risk. Disconnect the fuse from the fuse box. Notify the Technical Assistance Service.

Your new appliance

Page 2 shows an overall view of your new appliance as well as the burner power.

These appliances can be combined with conventional hobs of the same make, using the joint accessory. See the catalogue for details.

Gas burners

There are indications to show which burner each control knob operates.

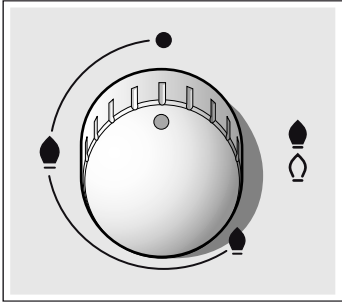

Power levels

The progressive control knobs can be used to control the power needed, from minimum to maximum power.

Off setting	●	Control knob off
High flame	🔥	Maximum capacity
Low flame	🔥	Minimum capacity

It is essential to ensure that all the burner parts and pan supports are correctly installed for the appliance to work correctly. Do not swap the burner caps around.

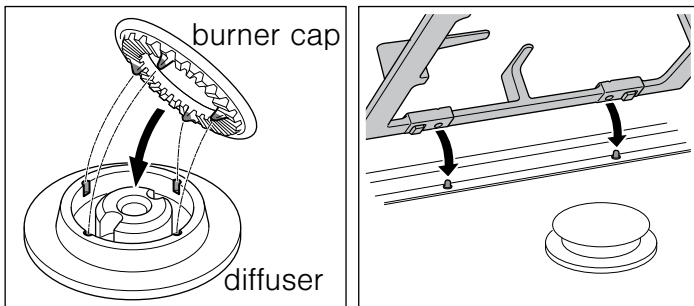

Switching on automatically

Your hob can be switched on automatically (ignition sparkers):

1. Press the chosen burner control knob and turn it anticlockwise to the maximum power setting.
While the control knob is still pressed down, sparks are produced on all burners. The flame ignites.
2. Release the control knob.
3. Turn the control knob to the required setting.

If it does not come on, turn the control knob to the off setting and repeat the steps above. This time, press and hold the control knob for longer.

⚠ Risk of deflagration!

If after 15 seconds the flame does not ignite, switch off the burner and open a nearby window or door. Wait at least one minute before trying to switch the burner back on.

Safety system

Your hob has a safety system (thermocouple) that prevents the flow of gas if the burners accidentally switch off.

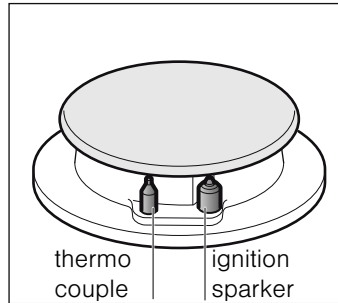

To ensure that this device is active:

1. Switch on the burner as usual.
2. Without releasing the control knob, press and hold it down firmly for 4 seconds after lighting the flame.

Switching off a burner

Turn the corresponding control knob clockwise to the Off setting.

Warnings

It is normal to hear a soft whistling noise while the burner is operating.

When first used, it is normal for the burner to give off odours. This does not pose any risk and does not indicate a malfunction. They will disappear in time.

An orange-coloured flame is normal. This is caused by the presence of dust in the atmosphere, spilt liquids, etc.

If the burner flames are accidentally blown out, switch off the burner operating control knob and do not try to relight it for at least 1 minute.

A few seconds after the burner is switched off, a sound (thud) will be produced. This is not a fault - this means that the safety device is no longer operating.

Keep the burner as clean as possible. If the ignition sparkers are dirty they will not light properly. Clean them periodically using a small non-wire brush. Bear in mind that the ignition sparkers must not suffer any serious impacts.

Cooking pans

Suitable pans

Burner	Minimum pan diameter	Maximum pan diameter
Rear burner	22 cm	26 cm
Front burner	14 cm	20 cm

Precautions for use

The following advice is intended to help you save energy and prevent pan damage:

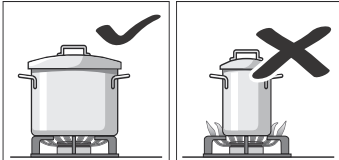

Use pans which are the right size for each burner.

Do not use small pans on large burners. The flame must not touch the sides of the pan.

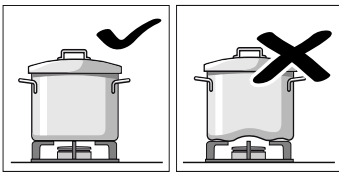

Do not use damaged pans, which do not sit evenly on the hob. Pans may tip over.

Only use pans with a thick, flat base.

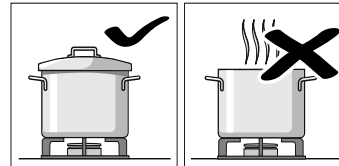

Do not cook without using a lid and make sure the lid is properly fitted. This wastes energy.

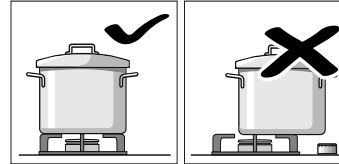

Always centre the pan over the burner, not to one side. Otherwise it could tip over.

Do not place large pans on the burners near the control knobs. These may be damaged by the very high temperatures.

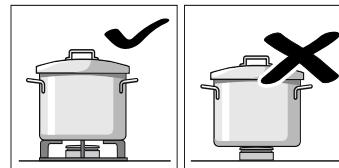

Place the pans on the pan supports, never directly on the burner.

Make sure that the pan supports and burner caps are correctly positioned before using the appliance.

Pans should be placed on the hob carefully.

Do not strike the hob and do not place excessive weight on it.

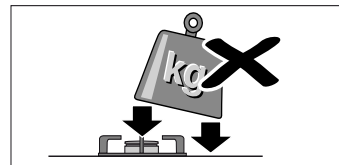

Cleaning and maintenance

Cleaning

Once the appliance is cool, use a sponge to clean it with soap and water.

After each use, clean the surface of the respective burner parts once they have cooled down. If any residue is left (baked-on food, drops of grease etc.), however little, it will become stuck to the surface and more difficult to remove later. The holes and grooves must be clean for the flame to ignite properly.

The movement of some pans may leave metal residue on the pan supports.

Clean the burners and pan supports using soapy water and scrub with a non-wire brush.

Alternatively, the pan supports can be put in the dishwasher. Use the dishwasher manufacturer's recommended detergent. If the pan supports are very dirty, they should be cleaned previously.

Do not put the burner caps in the dishwasher.

If the pan supports are fitted with rubber rests, ensure that these are also cleaned. The rests may come loose and the pan support may scratch the hob.

Always dry the burners and pan supports completely. Water droplets or damp patches on the hob at the start of cooking may damage the enamel.

After cleaning and drying the burners, make sure the burner caps are correctly positioned on the diffuser.

Caution!

- Do not use steam cleaners. This could damage the hob.
- Never use abrasive products, steel scourers, sharp implements, knives, etc. to remove bits of hardened food from the hob.
- Do not use knives, scrapers or similar implements to clean the point where the glass meets the burner trims, the metal frames or the glass/aluminium panels, if fitted.

Maintenance

Always clean off any liquid as soon as it is spilt. This will prevent food remains from sticking to the hob surface and you will save yourself any unnecessary effort.

Never slide pans across the glass surface, as you may scratch it. In addition, try not to drop heavy or sharp objects on the glass. Never strike any part of the hob.

Grains of sand that may come from cleaning fruits and vegetables will scratch the glass surface.

Melted sugar, or foods which contain a lot of sugar which may have spilt, should be cleaned off the hotplate immediately, using the glass scraper.

Trouble shooting

Sometimes certain faults detected can be easily resolved. Before calling the Technical Assistance Service, bear in mind the following advice:

Fault	Possible cause	Solution
The general electrical system is malfunctioning.	Defective fuse.	Contact the installation technician.
	The automatic safety switch or circuit breaker has tripped.	Check the main control panel to see if the automatic safety switch or circuit breaker has tripped.
The automatic switching on function does not work.	There may be food or cleaning products stuck between the ignition sparkers and the burners.	The space between the ignition sparker and the burner must be clean.
	The burners are wet.	Dry the burner caps carefully.
	The burner caps are not correctly positioned.	Check that the burner caps are correctly positioned.
	The appliance is not earthed, is poorly connected or the earthing is faulty.	Contact the installation technician.
The burner flame is not uniform.	The burner components are not correctly positioned.	Correctly place the parts on the appropriate burner.
	The grooves on the burner are dirty.	Clean the grooves on the burner.
The gas flow is not normal or there is no gas.	The gas supply is blocked by gas taps.	Open all gas taps.
The kitchen smells of gas.	A gas tap has been left on.	Turn off the taps.
	Incorrect connection of Town Gas.	Contact the installation technician.
	Possible gas leak.	Shut off the gas supply, ventilate the premises and immediately notify an authorised installation technician to check and certify the installation. Do not use the appliance until ensuring that there is no gas leak in the installation or appliance itself.
The burner immediately switches off after releasing the control knob.	The control knob was not held down for long enough.	Once the burner is on, hold the control knob down a few seconds longer.
	The grooves on the burner are dirty.	Clean the grooves on the burner.

Technical Assistance Service

When contacting our Technical Assistance Service, please provide the product number (E-Nr.) and production number (FD) of the appliance. This information is given on the specifications plate located on the lower section of the hob and on the label in the user manual.

Please find the contact data of all countries in the enclosed customer service list.

To book an engineer visit and product advice

2565 6151 Hong Kong

Trust the expertise of the manufacturer, and rest assured that the repair will be carried out by trained service technicians using original spare parts for your domestic appliance.

Warranty conditions

In the unlikely event that the appliance is damaged or does not meet your expectations in terms of quality, please inform us as soon as possible. For the warranty to be valid, the appliance must not have been tampered with, or used inappropriately.

The applicable warranty conditions are those set out by the company's representative office in the country of purchase. Detailed information is available from retail outlets. Proof of purchase must be presented to obtain the benefits of the warranty.

We reserve the right to introduce changes.

Used appliances and packaging

If the  symbol is shown on the specifications plate, bear in mind the following instructions:

Environmentally-friendly waste management

Unpack the appliance and dispose of the packaging by environmentally-friendly means.



This appliance is labelled in accordance with European Directive 2012/19/EU concerning used electrical and electronic appliances (waste electrical and electronic equipment - WEEE). The guideline determines the framework for the return and recycling of used appliances as applicable throughout the EU.

The packaging of your appliance has been manufactured using only the materials which are strictly necessary to guarantee efficient protection during transport. These materials are 100% recyclable, thus reducing the environmental impact. You can also contribute to caring for the environment by following the advice below:

- Dispose of the packaging in the appropriate recycling bin.
- Before you get rid of an old appliance, make sure you disable it. Contact your local authority to find out the address of your nearest recycling centre to dispose of your appliance.
- Do not pour used oil down the sink. Collect it in a sealed container and take it to an appropriate collection point or, failing that, place it in the rubbish bin (it will end up in a controlled dump; this is probably not the best option, but it will avoid contaminating ground water).

Specification

Product description:	2 burners town gas hob	
Top plate material	Schott Ceran glass	
Glass color	Black.	
Gas type	HK town gas	
Rated heat input	Front burner	1.9 kW
	Rear burner	2.8 kW
Working pressure	10 mbar	
External gas governor	Beckley 2300 or Elitre EL-125	
Dimension (W x D x H)	62 (exclude glass thickness, include gas connector) x 302 x 520 mm	
Cut-out dimension (W x D)	270 x 490-500 mm	
Net weight	6 kg	
Gross weight	7 kg	
Voltage	220-240 V	
Connected load	0.6 W (13 A plug)	

安全注意事項.....	9
閣下的新煮食爐.....	11
煤氣爐操作.....	11
火力等級.....	11
自動打火.....	11
安全系統.....	11
關掉爐頭.....	11
警告.....	11
烹飪鍋具建議.....	12
適用鍋具.....	12
注意事項.....	12
清潔及保養.....	12
清潔.....	12

保養.....	12
疑難排解.....	13
技術支援服務.....	13
保養條款.....	13
用過的煮食爐和包裝.....	13
環保廢棄管理.....	13
規格.....	14

如需產品、配件、替換零件以及服務項目等的其他資訊，請參觀：
www.siemens-home.com

⚠ 安全注意事項

請細閱本說明書。本使用說明書所載之資料對正確使用煮食爐尤其對閣下之安全非常重要。本操作及安裝說明書應予保存；如本煮食爐有轉售，請將本操作及安裝說明書轉給買家。

注意！根據香港氣體安全規例，任何氣體裝置工程，包括爐具和接駁喉管的安裝，必須由註冊氣體裝置技工執行，而該技工已於相關的氣體工程類別註冊及受聘於註冊氣體工程承辦商。

使用認可印有機電工程署批准標記（例如：機電工程署批准 EMSD APPROVAL GTXXXX）的氣體接駁喉管連接爐具，或使用機電工程署接納的其他恰當方法。

接駁煤氣時須加上穩壓器 Beckley（型號 2300）或 Elitre（型號 EL-125）。操作氣壓為 10 毫巴。

此煮食爐不得轉用其他氣體。

請勿使用蓋板，如鋁蓋。

若不遵守本說明書之要求，製造商免於承擔所有相關責任。

本說明書內之示圖僅供指引參考。

請勿於安裝前拆掉包裝紙，若本爐具受損切勿開爐。此時請聯繫我們的技術支援服務部。

根據氣體爐具 EN 30-1-1 規例，本電器為 3 類嵌入式爐具。

請確保本煮食爐按照安裝說明書安裝。

本煮食爐不可裝於遊艇上或活動房屋內。

本煮食爐必需安裝於備有良好通風系統之地方。

此煮食爐不能與計時器或遙控器使用。

當在灶櫃面安裝嵌入式氣體煮食爐時，灶櫃應設有通氣設施，以確保煮食爐在使用時操作正常。

不應將易燃物料、噴霧及壓縮容器放置在灶櫃內。

此煮食爐的面板是用陶瓷玻璃製造，較一般玻璃安全。唯使用玻璃面板煮食爐時還須注意以下事項，以避免玻璃面板爆裂：

1. 經常清潔爐頭組件以保持火蓋焰孔暢通，如滾瀉食物及汁液，應在爐頭組件冷卻後儘快作出妥善清理。
2. 如煮食爐出現不尋常聲音，應即停用並安排氣體供應公司或爐具進口商檢查。
3. 切勿使用過大的器皿煮食。
4. 切勿以硬物撞擊或將重物放置於玻璃面板。

本爐具僅為家居使用而設計，並不適合商業或專業用。本爐具僅供烹飪目的之用，並非取暖之用。保養服務僅在按設計目的使用爐具時方有效。

使用者在煮食時不應遠離煮食爐。

請勿使用煮食爐保護器具及兒童安全防護罩。這些可能會因過熱而造成意外事故，如：起火或材料碎裂。

8 歲以上兒童、身體、感官或心智能力欠佳者、或欠缺使用經驗與知識者，在使用本設備時，須由監督人士從旁監督或於了解其安全性並明瞭相關風險下使用。

不可讓兒童將此煮食爐當成玩具。

除非有人監督，否則兒童不可清潔本煮食爐及進行一般保養工作。

燃爆風險！

若未燃燒的煤氣在密閉區域中累積，容易造成燃爆風險。請勿把煮食爐放於當風處，此舉會使煮食爐熄掉。請仔細閱讀說明書的相關說明與警告。

中毒風險！

使用本煮食爐時，廚房會變得炎熱，潮濕並產生燃燒物。請確保廚房通風良好，尤其是在使用爐具時：要保持自然通風口暢開，或者安裝通風系統（抽油煙機）。若長時間密集使用爐具，可能需要額外或更有效的通風措施：打開窗戶或提高通風系統的強度。

灼傷風險！

煮食爐面板及周圍區域 會變得非常熱。切勿觸碰到高溫的表面。請讓 8 歲以下兒童保持在安全的距離。

火災風險！

- 煮食爐面板會變得非常熱。切勿將易燃物品放置於煮食爐上。切勿將物品放置於煮食爐上。
- 切勿於本煮食爐下面或附近放置或使用腐蝕性化學品、會產生煙霧的產品、易燃物或非食物類產品。
- 過熱油脂容易搶火。加熱油脂時切勿離開煮食爐。若油脂確實搶火，切勿用水滅火。請用蓋蓋住出事鍋具並關上煮食爐。

受傷風險！

- 將受損、尺寸不對的鍋具掛在煮食爐邊或無法正確放置在煮食爐上，可能會造成嚴重的人身傷害。請按說明書所提供的烹飪鍋具建議與警告使用。
- 若遇故障情況，請關閉煮食爐並聯絡技術支援服務。若其中某個控鈕不能轉動，不要勉強轉動它。請即時聯絡技術支援服務部進行修理或更換。
- 請勿更改煮食爐內部設定。如有需要，請致電本公司技術支援服務部。

觸電風險！

- 請勿用蒸汽清潔器清潔煮食爐！
- 玻璃裂縫或斷裂可能帶有觸電危險。請中斷煮食爐的電源並通知技術支援服務部。

閣下的新煮食爐

本說明書第 2 頁顯示煮食爐的整體外觀和爐頭功率。

使用接駁配件，能將此煮食爐與其他同類煮食爐並排一起使用，詳見產品目錄介紹。

煤氣爐操作

控鈕側會顯示控鈕所操作的爐頭。

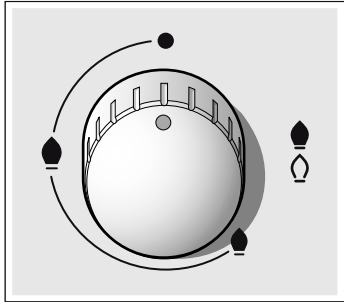

火力等級

可用漸進式控制旋鈕來控制所需火力，從最弱火至最強火。

關爐設定	●	熄火，關掉煮食爐
強火	●	最大火力
弱火	●	最少火力

必須確保所有爐頭部件及平底鍋支架安裝正確，以便爐頭正常運作。請勿隨意掉換兩個爐頭部件。

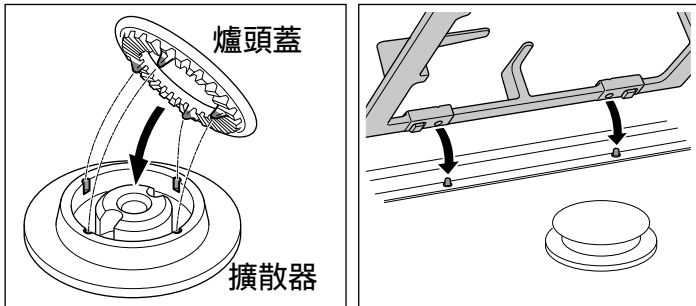

自動打火

您的煮食爐有自動打火功能（打火點燃）：

1. 按下選擇的爐頭控制旋鈕並按逆時針方向旋至最高火段設定。當控制鈕仍被按下時，所選擇的爐頭會產生火花，火焰點燃。
2. 鬆開按下的控制旋鈕。
3. 將控制旋鈕旋轉至所需的火段設定位置。

若此時熄火，將控制旋鈕旋轉至關爐設定並重複以上步驟。此時將控制鈕按下稍長時間。

⚠ 燃爆風險！

如已過 15 秒火焰仍點不著，關掉爐頭並打開附近的門窗。在您再度嘗試點火前，請等待至少一分鐘。

安全系統

閣下的煮食爐具有安全系統（熱電偶），此系統可在爐頭意外關停時防止燃料氣體流出。

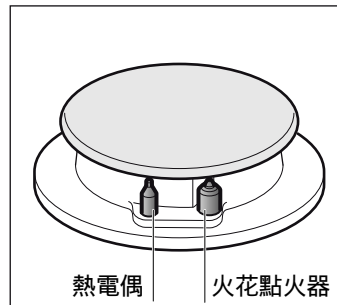

要確保此裝置啟動，

1. 照平常的方式點燃爐頭。
2. 在火焰點燃後不要放開控制旋鈕，用力壓住並停留 4 秒鐘。

關掉爐頭

將相關控制旋鈕按順時針方向旋至關爐設定。

警告

爐頭啟動時聽到噓噓聲乃屬正常。

爐頭首次使用時出現氣味道盡乃屬正常，此狀況並無任何風險，也不代表故障。氣味不久之後就會消失。

火焰呈橙色乃屬正常，此乃因空氣中有灰塵、噴濺液體等等所致。若爐頭火焰突然熄滅，請用控制旋鈕旋轉至關爐設定，請至少等待一分鐘再行點火。

關掉爐頭後數秒會發出聲音（"轟"一聲）；此非故障，而是安全裝置不再運作。

盡可能保持爐頭清潔。若火花點火器髒污，則不能正常打火。定期使用小型非金屬刷清理。切記火花點火器不能承受任何過份撞擊。

烹飪鍋具建議

適用鍋具

爐頭	平底鍋 最小直徑	平底鍋 最大直徑
後爐頭	22 cm	26 cm
前爐頭	14 cm	20 cm

注意事項

以下是幫您節省能源且避免鍋具損壞的使用建議：

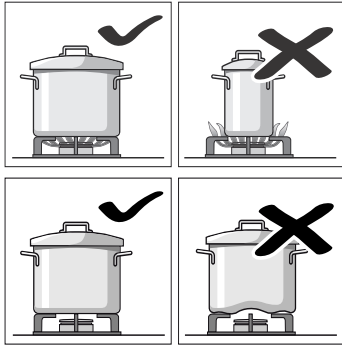

請配合每個爐頭，使用尺寸正確的鍋具。

請勿在大爐頭上使用小鍋具。火焰不可觸碰到鍋具的側邊。

請勿使用無法均衡坐落在爐台上的受損鍋具。鍋具可能會翻倒。

請僅使用厚平底的鍋具。

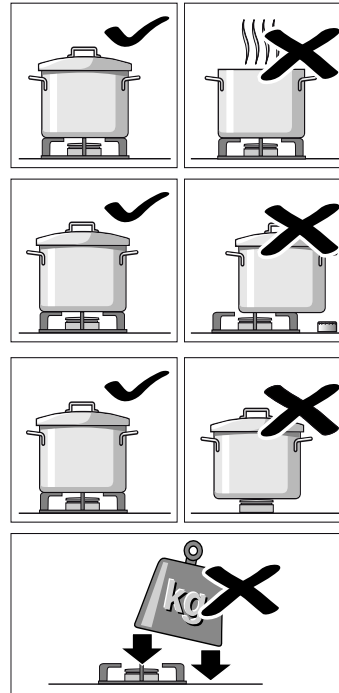

烹煮食物時請使用鍋蓋且確定鍋蓋確實蓋好。如此可節省能源。

請永遠將鍋子放在爐頭的中心處，不要倚向一邊。否則鍋子可能傾倒。

切勿將大鍋放在靠近控制旋鈕的爐頭上。旋鈕可能因非常高的溫度而受損。

請把鍋具放在平底鍋支架上，切勿直接放在爐頭上。

使用爐具前，請先確保平底鍋支架和爐頭配件放置在正確的位置上。

請小心將鍋具放在煮食爐上。

請勿重壓煮食爐，且勿將過重物品放在煮食爐上。

清潔及保養

清潔

待煮食爐冷卻後，請用海綿加肥皂與清水進行清潔。

每次使用後，待個別燃爐零件冷卻後，請清理其表面。若有任何殘留物（燒乾的食物、油滴等等），即使只有一點點，之後也會卡在表面上且更難清理。請定時清潔爐頭組件（如火蓋焰孔及爐頭的孔和坑）以確保正常點火。

移動某些鍋具可能會在平底鍋支架上留下金屬殘留物。

請用肥皂水和非金屬刷來清理爐頭和平底鍋支架。

另，平底鍋支架可放於洗碗碟機清洗。請使用製造商建議的洗碗碟機用清潔劑。如平底鍋支架太骯髒，請先清洗再放入洗碗碟機。

請勿把爐頭蓋放進洗碗碟機內。

若平底鍋支架是使用橡膠支托裝上去的，請同樣清理橡膠支托。支托可能會鬆弛而平底鍋支架可能會刮花煮食爐。

經常保持爐頭及平底鍋支架徹底乾爽。開始烹飪時若爐面上有水滴水漬，可能會令搪瓷受損。

清理並讓煮食爐乾燥後，請確定爐頭蓋正確安裝在火焰擴散器上。

注意！

- 勿使用蒸汽清潔機。此舉可能損及爐具。
- 請勿使用研磨產品，鋼硬毛刷或類似工具來清理煮食爐上已變硬的食物。
- 若您的煮食爐是配合玻璃或鋁面板進行安裝，請勿使用刀子、刮刀或類似工具來清理金屬連接點。

保養

如有任何液體噴濺，請儘快清理。此舉可預防食物黏在煮食爐表面上，並且可為您省下不必要的清理功夫。

請勿於煮食爐上拖行鍋具，此舉會刮花煮食爐。另，請防止重物或尖物跌在玻璃上。永遠不要敲打煮食爐的任何一部份。

來自清潔水果及蔬菜的沙粒會劃花玻璃的表面。

應使用玻璃刮具立即清除於熱爐面上濺出的熔糖或含有大量糖份的食物。

疑難排解

有時您所查覺的某些煮食爐問題是屬可輕鬆解決之範疇。在致電本公司客戶支援服務部前，請參考下列建議：

問題	可能原因	解決辦法
普通電力系統失效。	保險絲失效 自動安全開關跳制或保險絲燒斷。	聯絡氣體裝置技工。 檢查主控制板看自動安全開關有否跳制或燒斷保險絲。
自動開爐功能失靈。	火嘴和爐頭之間可能黏附食物或清潔產品。 爐頭潮濕。 未正確放妥爐頭蓋。 煮食爐未接地，接駁不當，或接地不良。	火嘴和爐頭之間的空隙必須清潔。 請小心弄乾爐頭蓋。 檢查爐頭蓋是否正確放妥。 聯絡氣體裝置技工。
爐頭火焰不均勻。	未正確放妥爐頭組件。 爐頭氣槽骯髒。	確保爐頭組件放置正確。 清潔爐頭氣槽。
煤氣出現不正常或沒有煤氣。	氣源關上。	打開所有氣源門閥。
廚房有氣體味。	某供氣開關打開了。 煤氣喉管接駁不良。 氣體可能外漏。	關上氣源門閥。 聯絡氣體裝置技工。 關掉氣體供應，讓場地通風並立即通知合格的氣體裝置技工檢查，確定安裝無虞。在確保安裝或煮食爐本身無氣體外漏風險前，請勿使用煮食爐。
放開控制旋鈕後，爐頭立即熄滅。	按壓控制旋鈕的時間不夠長。 爐頭氣槽骯髒。	點燃爐頭後，請按壓旋鈕數秒。 清潔爐頭氣槽。

技術支援服務

聯繫本公司客戶支援服務部時，請提供煮食爐的產品編號 (E-Nr.) 及生產編號 (FD)。您可在煮食爐下方區域的規格銘牌及說明書上的標籤找到此資料。

如需安排裝置技工及聯絡產品服務：

852-25656151 香港

請相信製造商的專業並請放心維修將由專業維修技術人員使用原廠配件進行。

保養條款

若煮食爐受損或不符合您對品質的期待，請儘速通知我們。為求保養有效，不得更改或不當使用煮食爐。保養服務以購買當地公司代表辦公室所提出之保養條款為準。詳情可向零售商查詢。您必須提出購買證明方能取得保養。

本公司保留進行變更的權利。

用過的煮食爐和包裝

如果規格銘牌上有  符號，請注意下列指示：

環保廢棄管理

以環保方式處理包裝。



此爐具根據歐盟關於使用過的爐具及電子產品的指令 2012/19/EU (棄置的爐具及電子產品 - WEEE) 貼有相關標籤。該指引訂明了在歐盟範圍內舊爐具退還及回收的方法。

本煮食爐包裝以嚴格遵循規定的材料製造而成，保證在運輸期間能有效保護本爐具。這些材料 100% 可回收，減少對環境的影響。您也可以遵守下列建議，為環保貢獻心力：

- 放置在適當的回收桶中。
- 丟棄舊煮食爐之前，請確定您已將它關閉。請聯絡政府機關，找到離您最近的回收中心地址以處置您的煮食爐。
- 請勿將使用過的油倒到水槽中。用密封的容器收集用過的油，並將容器帶往合適的回收處，若無法做到，請將容器放置在垃圾桶內 (最後會送往垃圾處理場處理，這或許不是最好的選擇，但可避免污染地下水)。

規格

產品描述	雙頭煤氣爐	
物料	Schott 陶瓷玻璃	
玻璃顏色	黑色	
操作氣體	香港煤氣	
額定熱負荷	前爐頭	1.9 千瓦
	後爐頭	2.8 千瓦
操作氣壓	10 毫巴	
外置氣體穩壓器	Beckley 2300 型號 或 Elitre EL-125 型號	
尺寸 (高 x 闊 x 深)	62 (不包括玻璃爐面) x 302 x 520 毫米	
開孔 (闊 x 深)	270 x 490-500 毫米	
淨重	6 公斤	
毛重	7 公斤	
電壓	220-240 伏	
總功率	0.6 瓦 (13 安培插頭)	

BSH Hausgeräte GmbH
Carl-Wery-Straße 34
81739 München
GERMANY

Manufactured by BSH Hausgeräte GmbH under Trademark License of Siemens AG
由 BSH 家用电器有限公司根据西门子股份公司的商标许可制造
由 BSH HOME APPLIANCES (中國) CO., LTD. 按 Siemens AG 商標使用授權製造



9000797087 (G) 960928