

Your new dryer

Congratulations - You have chosen a modern, high-quality Siemens domestic appliance. The condensation dryer is distinguished by its economical energy consumption. Every dryer which leaves our factory is carefully checked to ensure that it functions correctly and is in perfect condition. Should you have any questions, our after-sales service will be pleased to help.

Disposal in an environmentally-responsible manner
Dispose of packaging in an environmentally-responsible manner. This appliance is labelled in accordance with the European guideline 2002/96/EG on waste electrical and electronic equipment - WEEE. The guideline provides an EU-wide framework for the return and recycling of old appliances.

For further information about our products, accessories, spare parts and services, please visit: www.siemens-home.com

Contents

	Page
■ Preparation	2
■ Setting the programmes	2
■ Drying	3/4
■ Information on laundry	5
■ Care and cleaning	6
■ Programme overview	7
■ Installation	8
■ Frost protection/transport	8
■ Technical data	9
■ Optional accessories	9
■ What to do if... / After-sales service	10
■ Safety instructions	11

Intended use

- for domestic use only,
- only to be used for drying fabrics that have been washed with water.

Do not leave children unsupervised near the dryer. Keep pets away from the dryer.

Preparing for installation, see Page 8

Never start the dryer if it is damaged! Inform your after-sales service.

Make sure your hands are dry. Hold the plug only.

Inspecting the dryer

Remove all items from pockets. Check for cigarette lighters. The drum must be empty prior to loading.
See programme overview on page 7. See also separate instructions for "Woolens basket" (depending on model)

Connecting the mains plug

Sorting and loading laundry

Selecting and adjusting the programme

Select the drying programme ...

... and adapt to individual requirements

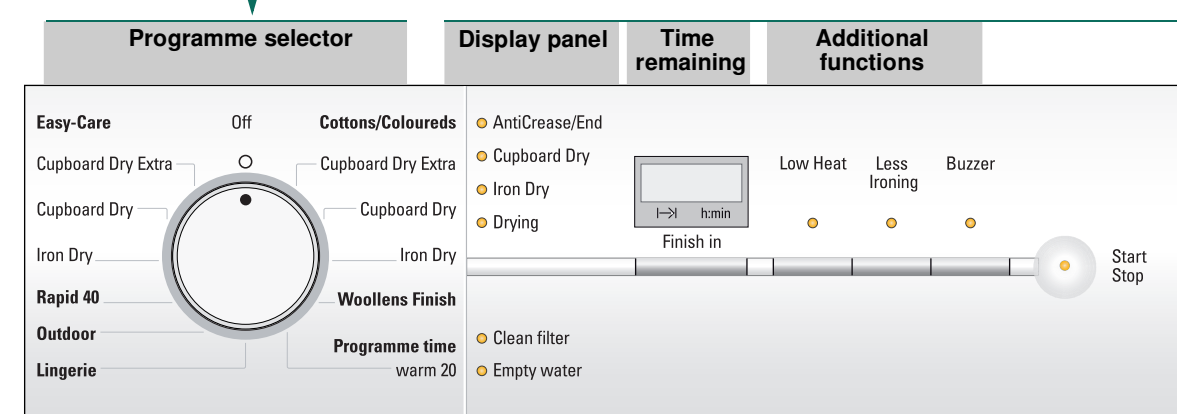

All buttons are sensitive and only need to be touched lightly.

Press the Start/Stop button

Only operate the dryer with the fluff filter inserted!



Drying

Emptying condensation

- Empty container **after** each drying operation!
1. Pull out condensation container keeping it horizontal.
 2. Pour out condensation.
 3. Always push container in fully until it clicks into place.
- If **Empty water** flashes in the display panel → *What to do if...*, Page 10.

Cleaning the fluff filter

- Clean the fluff filter **after** each drying operation.
1. Open the door, remove fluff from door/door area.
 2. Pull out and fold open the fluff filter.
 3. Remove the fluff (by wiping the filter with your hand). If the fluff filter is very dirty or blocked, rinse with warm water and dry thoroughly.
 4. Close and reinsert the fluff filter.

Switching off the dryer

Turn the programme selector to **Off**. Do not leave laundry in the dryer.

Removing the laundry

The automatic anti-crease function causes the drum to move at specific intervals, the washing remains loose and fluffy for an hour (two hours if the additional **Less Ironing** function is also selected-*depending on model*).

Programme end once lights up in the display.

Interrupt programme

The drying cycle can be interrupted for a brief period so that laundry may be added or removed. The programme selected must then be resumed and completed.

Never switch the dryer off before the drying process has ended. Drum and door may be hot!

1. Open door, the drying process is interrupted.
2. Load or remove laundry and close door.
3. If required, select a new programme and additional functions.
4. Press the **Start/Stop** button.

Information on laundry ...

Labelling of fabrics

- Follow the manufacturer's care information.**
- ☑ Drying at normal temperature.
 - ☑ Drying at low temperature → also select **Low Heat**.
 - ☒ Do not machine dry.

Observe safety instructions without fail → Page 11!
Do not tumble-dry the following fabrics for example:

- Impermeable fabrics (e.g. rubber-coated fabrics).
- Delicate materials (silk or curtains made from synthetic material) → they may crease
- Laundry contaminated with oil.

Drying tips

- To ensure a consistent result, sort the laundry by fabric type and drying programme.
- Always dry very small items (e.g. baby socks) together with large items of laundry (e.g. hand towel).
- Close zips, hooks and eyelets, and button up covers. Tie fabric belts, apron strings, etc. together
- Do not over-dry easy-care laundry → risk of creasing! Allow laundry to finish drying in the air.
- Do not dry woolens in the dryer, only use to freshen them up → *Page 7, Woolens Finish Programme (depending on model)*.
- Do not iron laundry immediately after drying, fold items up and leave for a while → the remaining moisture will then be distributed evenly.
- Machine-knitted fabrics (e.g. T-shirts or jerseys) often shrink the first time they are dried → do not use the **Cupboard Dry Extra** programme.
- Starched laundry is not always suitable for dryers → starch leaves behind a coating that adversely affects the drying operation.
- Use the correct dosage of fabric softener as per the manufacturer's instructions when washing the laundry to be dried.
- Use the timer programme for small loads → this improves the drying result.

Environmental protection/energy-saving tips

- Before drying, spin the laundry thoroughly in the washing machine → the higher the spin speed the shorter the drying time will be (consumes less energy), also spin easy-care laundry.
- Put in, but do not exceed, the maximum recommended quantity of laundry → programme overview → *Page 7*.
- Make sure the room is well ventilated during drying.
- Do not obstruct or seal up the air inlet.
- Keep the air cooler clean → *page 6 "Care and cleaning"*.

Care and cleaning

Only when switched off!

Dryer housing, control panel, air cooler, moisture sensors

- Wipe with a soft, damp cloth.
- Do not use harsh cleaning agents and solvents.
- Remove detergent and cleaning agent residue immediately.
- During drying, water may collect between the door and seal. This does not affect your dryer's functions in any way.

Clean the air cooler 5 - 6 times a year or if **Clean filter** flashes after cleaning the fluff filter

Air cooler

- Allow the dryer to cool.
- Residual water may leak out, so place an absorbent towel underneath the maintenance door.

1. Unlock the maintenance door.
2. Open the maintenance door fully.

3. Turn both locking levers towards each other.
4. Pull out the air cooler.

Do not damage the air cooler. Clean with warm water only. Do not use any hard or sharp-edged objects.

5. Clean the air cooler thoroughly, Allow to drip dry.

6. Clean the seals.

7. Re-insert the air cooler, with the handle facing down.

8. Turn back both locking levers.

9. Close the maintenance door until the lock clicks into place.

Moisture sensors

The dryer is fitted with stainless steel moisture sensors. The sensors measure the level of moisture in the laundry. After a long period of operation, a fine layer of limescale may form on the sensors.

1. Open the door and clean the moisture sensors with a damp sponge which has a rough surface.

Do not use steel wool or abrasive materials.

After drying: laundry is to be ...

Ironed	max. 8 kg	☑
lightly ironed dry		☑
not ironed		☑
passed through a mangle		☑
Cottons/Coloureds		
Iron Dry		☑
Cupboard Dry		☑
Cupboard Dry Extra		☑
Easy-Care		
Iron Dry		☑
Cupboard Dry		☑
Cupboard Dry Extra		☑
Outdoor		
max. 1.5 kg		☑
max. 1 kg		☑
max. 3 kg		☑
Woolens Finish		
max. 2 kg		☑
max. 3 kg		☑
Programme time warm 20		

☑ passed through a mangle

T-shirt	☑
Shirts	☑
Trousers	☑
Skirts/dresses	☑
Sportswear	☑
Work clothing	☑
Anoraks	☑
Towelling gowns	☑
Underwear	☑
Socks	☑
Bed linen	☑
Table linen	☑
Terry towels	☑
Tea towels/ Towels	☑

0111 / 9000617095

WT46E385GB

Siemens Electrogeräte GmbH
Carl-Wery-Str. 34
81739 München/Germany

For fabrics with membrane coating, water-repellent fabrics, functional clothing, fleece fabrics (dry jackets/trousers with removable internal lining separately).

For lingerie made of synthetic fibres, cotton or blended fabric.

For woollen fabrics suitable for machine-washing. Fabrics become fluffier but not dry.

Remove fabrics once the programme has ended and allow to dry.

For laundry made of synthetic fibres, cotton or blended fabrics (for example) that needs to be dried quickly. The values may differ from the those specified depending on the type of fabric, mixture of laundry to be dried, residual moisture in the fabric and loading capacity.

For pre-dried, multi-layered, sensitive fabrics made of acrylic fibres, or separate small items of laundry.

Also for subsequent drying.

7

Installation

- Delivery specification: dryer, instructions for installation and use, woollens basket (depending on model).
- Check dryer for transport damage.
- The dryer is very heavy. Do not attempt to lift it on your own.
- Be careful to avoid sharp edges.
- Do not lift the dryer by any of the protruding parts (e.g. the door) as they may break off.
- Do not set up in a room that is susceptible to frost.
- Freezing water may cause damage.
- If in doubt, have the appliance connected by an expert.

- 1. Setting up the dryer**
- The appliance plug must always be accessible.
 - Ensure that the appliance is installed on a clean, level and solid surface.
 - Keep the cooling grille at the front of the dryer unobstructed.
 - Keep the area around the dryer clean.
 - Make the dryer level using the threaded feet and a spirit level.
 - Do not remove the threaded feet under any circumstances.

Take all accessory parts out of the drum. The drum must be empty.

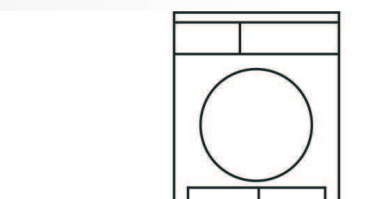

Do not set up the dryer behind a door or sliding door as this may obstruct or prevent the dryer door from opening. This will prevent a potentially fatal danger to children from locking themselves in.

- 2. Mains connection** see safety instructions → Page 11.
- Connect to an AC earthed socket. If in doubt have the socket checked by an expert.
 - The mains voltage and the voltage shown on the rating plate (→ Page 9) must correspond.
 - The connected load and necessary fuse protection are specified on the rating plate.

Frost protection/transport

- Preparation**
1. Empty the condensation container → page 4.
 2. Select any programme using the programme selector.
 3. Press the **Start/Stop** button → condensation is pumped into the container.
 4. Wait 5 min., and then empty the condensation container again.
 5. Turn the programme selector to **Off**.

Technical data

Dimensions (DxWxH)	60 x 60 x 85 cm (height adjustable)
Weight	approximately 45 kg
Max. capacity	8 kg
Condensation container	4.2 l
Connection voltage	
Connected load	
Fuse protection	see appliance rating plate
Ambient temperature	
Product number/ Production number	

You can find the rating plate on the back of the dryer.

- Consumption rates** These are guide values determined under standard conditions. Fluctuations up to 10% are possible.

	Spin speed in rpm (residual moisture)	Drying time in min.**	Energy consumption in kWh**
Cottons/Coloureds 8 kg		13 A	13 A
Cupboard Dry*	1400 (approx. 50 %)	105	3.74
	1000 (approx. 60 %)	122	4.49
	800 (approx. 70 %)	139	5.17
Iron Dry*	1400 (approx. 50 %)	83	2.24
	1000 (approx. 60 %)	100	3.44
	800 (approx. 70 %)	117	3.86
Easy-Care 3.5 kg			
Cupboard Dry*	1000	39	1.05
	800 (approx. 40 %)	42	1.35
	600 (approx. 50 %)	51	1.65

*Test program according to DIN EN 61121.
**The values may differ from the those specified depending on the type of fabric, mixture of laundry to be dried, residual moisture in the fabric and loading capacity.

- Drum interior light (depending on model) (bulb E14, 25 W)**
The drum is illuminated after the door is opened or closed, and also after the programme is started. It goes out automatically. Replacing the bulb → Page 10.

Optional accessories (order from the after-sales service using the order number)

- WZ 20460 Platform**
For better loading and unloading. The basket contained in the drawer can be used to carry the laundry.
- WZ 20310 Washer-dryer stack connection set**
The dryer can be placed on top of a suitable washing machine with the same width and depth to save space.
This connection set **must** always be used to secure the dryer to the washing machine.
- WZ 20290 Installation underneath the worktop**
Risk of electric shock!
Instead of the appliance covering plate, you must have a metal cover fitted by an expert.

What to do if ...

- The Start/Stop indicator lamp does not light up.**
Mains plug plugged in?
Programme selected?
- The Empty water and Start/Stop indicator lamp flash.**
Empty the condensation container.
If featured, check hose for condensation outlet.
- The Clean filter and Start/Stop indicator lamp flash.**
Clean the fluff filter and/or air cooler → Page 4/6.
- Dryer does not start.**
Start/Stop button selected?
Door closed?
Programme set?
Ambient temperature greater than 5 °C?
- Water is running out.**
Align dryer horizontally.
Clean air cooler seal.
- The door opens by itself.**
Push the door closed until you hear it engage.
- The required degree of dryness was not achieved or the drying time was too long.**
Clean the fluff filter and/or air cooler → Page 4/6.
Empty condensation container → Page 4.
Check water outlet (if featured).
Ambient temperature higher than 35 °C → airing.
Air inlet may be blocked → keep unobstructed.
Was an unsuitable programme selected? → Page 7.
Has the dryer been installed with sufficient space on all sides? Ensure that air can circulate.
Fine layer of scale on the moisture sensors → Clean the moisture sensors → page 6.
- Laundry damp.**
Use the next drying programme up or use the timer programme as a supplement → Page 7.
Warm laundry feels damper than it really is!
- The moisture content of the room has increased significantly.**
Make sure the room is sufficiently ventilated.
Air inlet blocked? → keep unobstructed.
Ensure that the air cooler has been inserted.
- Mains failure.**
Remove laundry from the dryer immediately and spread out. This allows the heat to dissipate.
- One or more indicator lights for programme status are flashing.**
Clean filter and air cooler → Page 4/6.
Check installation conditions → Page 8.
Switch off, leave to cool down, switch on again, restart programme.
- The interior light is not working (depending on model).**
Pull out the appliance plug, remove the cover cap in the interior above the door (use Torx 20 screw driver) and replace the bulb. Close the cover cap.
Never operate the dryer without a cover cap.

Safety instructions

- Emergency ONLY use the dryer...**
- Pull the appliance plug out of the socket immediately or disconnect the fuse.
- In rooms inside the house.
- To dry fabrics.
- The dryer must NEVER...**
- Be used for other purposes than those described above.
- Be modified in terms of its technology or attributes.
- Dangers**
- The dryer must not be used by children or persons who have not been instructed in its use.
- Do not leave children unsupervised near the dryer.
- Keep pets away from the dryer.
- Remove all objects from pockets.
- Make especially sure that cigarette lighters are removed as they constitute an **→ explosion hazard**.
- Do not lean or sit on the door **→ risk of tipping**.
- Installation**
- Secure loose cables **→ tripping hazard**.
- Do not operate the dryer if there is a risk of frost.
- Mains connection**
- Connect the dryer according to specifications to an AC earthed socket, as otherwise it cannot be guaranteed that the appliance is completely safe.
- The cable cross-section must be sufficient.
- Only use earth-leakage circuit breakers with the following symbol: 
- The appliance plug and socket must be compatible.
- Do not use multiple plugs/couplings and/or extension cables.
- Do not hold the appliance plug with wet hands **→ risk of electric shock**.
- Never pull the appliance plug out of the socket by its cable.
- Do not damage the mains lead **→ risk of electric shock**.
- Operation**
- Only load the drum with laundry.
- Check the contents before you switch the dryer on.
- Do not use the dryer if the laundry has been in contact with solvents, oil, wax, grease or paint (e.g. hair setting spray, nail polish remover, stain remover, cleaning solvent, etc.) **→ fire/explosion hazard**.
- Dust (e.g. coal dust, flour) poses a danger: do not use the dryer **→ explosion hazard**.
- Do not put laundry containing foamed material/rubber in the dryer **→ elastic material may be destroyed and the dryer may be damaged due to possible deformation of the foamed material**.
- Switch off the dryer once the programme has ended.
- Condensation is not drinking water and may be contaminated with fluff.
- Defect**
- Do not use the dryer if it is defective or if you suspect it is.
- Repairs must only be carried out by the after-sales service.
- Do not use the dryer if the mains cable is defective. To avoid danger, only have the defective mains cable replaced by the after-sales service.
- Always pull the mains plug out of the socket before changing the bulb for the interior light **→ risk of electric shock**.
- Spare parts**
- Only use genuine spare parts and accessories for safety reasons.
- Disposal**
- Dryer: pull out the appliance plug, **then** cut off the mains cable from the appliance.
- Dispose of at municipal waste disposal facility.
- Packaging: do not leave children alone with packing parts **→ risk of suffocation**.
- All materials are environmentally sound and can be reused. Dispose of in an environmentally-responsible manner.

Observe the safety instructions on page 11.

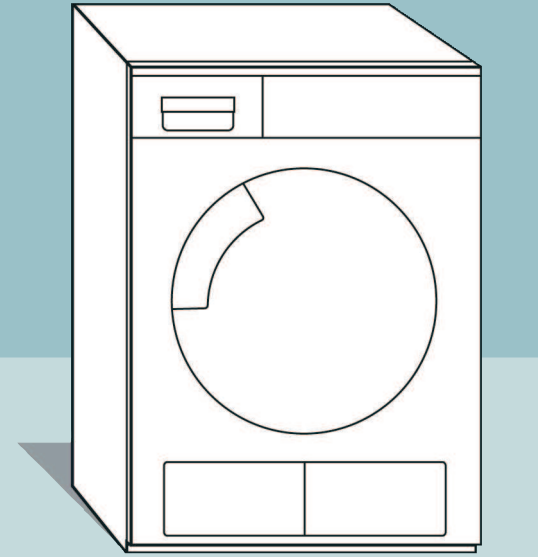

Tumble dryer

Instructions for installation and use

en

SIEMENS

Read these instructions before operating the dryer.

Your new dryer

Congratulations - You have chosen a modern, high-quality Siemens domestic appliance. The condensation dryer is distinguished by its economical energy consumption. Every dryer which leaves our factory is carefully checked to ensure that it functions correctly and is in perfect condition. Should you have any questions, our after-sales service will be pleased to help.

Disposal in an environmentally-responsible manner
Dispose of packaging in an environmentally-responsible manner. This appliance is labelled in accordance with the European guideline 2002/96/EG on waste electrical and electronic equipment - WEEE. The guideline provides an EU-wide framework for the return and recycling of old appliances.

For further information about our products, accessories, spare parts and services, please visit: www.siemens-home.com

Contents

	Page
Preparation	2
Setting the programmes	2
Drying	3/4
Information on laundry	5
Care and cleaning	6
Programme overview	7
Installation	8
Frost protection/transport	8
Technical data	9
Optional accessories	9
What to do if... / After-sales service	10
Safety instructions	11

Intended use

- for domestic use only,
- only to be used for drying fabrics that have been washed with water.

 Do not leave children unsupervised near the dryer. Keep pets away from the dryer.

Preparing for installation, see Page 8

 Never start the dryer if it is damaged! Inform your after-sales service.

 Make sure your hands are dry. Hold the plug only.





Sorting and loading

Remove all items from pockets. Check for cigarette lighters. The drum must be empty prior to loading. See programme overview on page 7. See also separate instructions for "Woollens" (depending on model)

Selecting and adjusting the programme

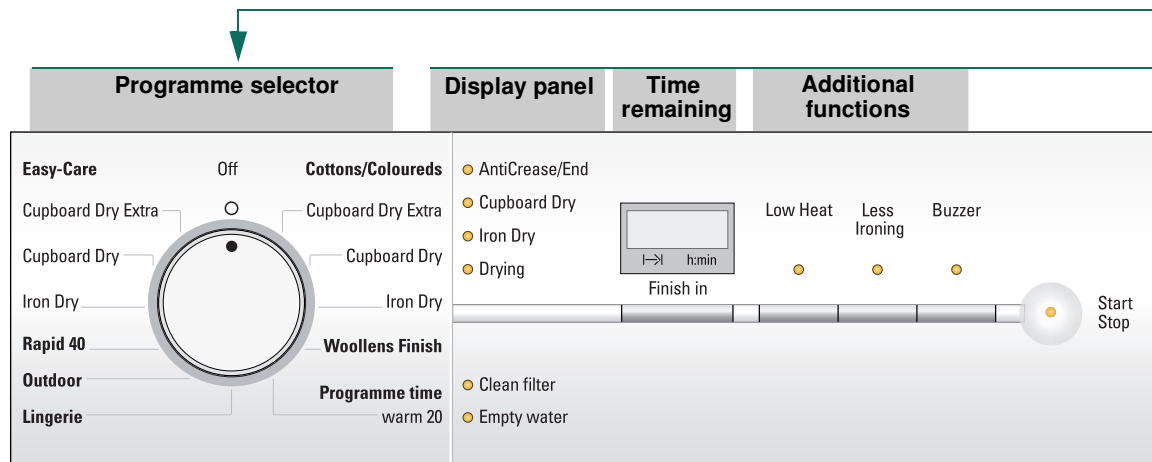
... and adapt to individual requirements



 All buttons are... need to be tou...

Press the...

 Only operate the fluff filter i...

Clean the fluff filter and/or air cooler → page 4/6. Empty the condensation container.

End of programme in 1*-24 hours (Press button several times if required) (*depending on the selected programme, e.g. duration 1:54h → 2h. Can always be selected to the next full hour.)

Service displays

Clean filter
Empty water

Finish in

Low Heat

Reduced temperature for delicate fabrics ☐ the longer drying time; e.g. for polyacrylics, polyam or acetate.

Less Ironing

Reduces creasing and extends the anti-creasing the program has ended.

Buzzer

Select On/Off for a acoustic signal at end of prog

Inspecting the dryer

Connecting the mains plug

Loading laundry

“Basket”

the programme

dry programme ...

individual requirements

sensitive and only touched lightly.

the Start/Stop button

the dryer with inserted!

it require a side, elastane

g phase once

programme.

Drying



1
2

3

Drying



Emptying condensation

Empty container **after** each drying operation!

1. Pull out condensation container keeping it horizontal.
2. Pour out condensation.
3. Always push container in fully until it clicks into place.

If **Empty water** flashes in the display panel → *What to do if...*, Page 10.

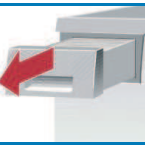

Cleaning the fluff filter

Clean the fluff filter **after** each drying operation.

1. Open the door, remove fluff from door/door area.
2. Pull out and fold open the fluff filter.
3. Remove the fluff (by wiping the filter with your hand). If the fluff filter is very dirty or blocked, rinse with warm water and dry thoroughly.
4. Close and reinsert the fluff filter.

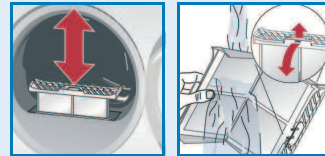

Switching off the dryer

Turn the programme selector to **Off**. Do not leave laundry in the dryer.



Removing the laundry

The automatic anti-crease function causes the drum to move at specific intervals, the washing remains loose and fluffy for an hour (two hours if the additional **Less Ironing** function is also selected-*depending on model*).

Programme end once lights up in the display.



Interrupt programme removing or adding laundry.



The drying cycle can be interrupted for a brief period so that laundry may be added or removed. The programme selected must then be resumed and completed.



Never switch the dryer off before the drying process has ended. Drum and door may be hot!

1. Open door, the drying process is interrupted.
2. Load or remove laundry and close door.
3. If required, select a new programme and additional functions.
4. Press the **Start/Stop** button.

Information on laundry ...



Labelling of fabrics

Follow the manufacturer's care information.

- Drying at normal temperature.
- Drying at low temperature → also select **Low Heat**.
- Do not machine dry.



Observe safety instructions without fail → Page 11!

Do not tumble-dry the following fabrics for example:

- Impermeable fabrics (e.g. rubber-coated fabrics).
- Delicate materials (silk or curtains made from synthetic material) → they may crease
- Laundry contaminated with oil.



Drying tips

- To ensure a consistent result, sort the laundry by fabric type and drying programme.
- Always dry very small items (e.g. baby socks) together with large items of laundry (e.g. hand towel).
- Close zips, hooks and eyelets, and button up covers.
Tie fabric belts, apron strings, etc. together
- Do not over-dry easy-care laundry → risk of creasing!
Allow laundry to finish drying in the air.
- Do not dry woollens in the dryer, only use to freshen them up → Page 7, **Woollens Finish Programme (depending on model)**.
- Do not iron laundry immediately after drying, fold items up and leave for a while → the remaining moisture will then be distributed evenly.
- Machine-knitted fabrics (e.g. T-shirts or jerseys) often shrink the first time they are dried → do not use the **Cupboard Dry Extra** programme.
- Starched laundry is not always suitable for dryers → starch leaves behind a coating that adversely affects the drying operation.
- Use the correct dosage of fabric softener as per the manufacturer's instructions when washing the laundry to be dried.
- Use the timer programme for small loads → this improves the drying result.

Environmental protection/energy-saving tips

- Before drying, spin the laundry thoroughly in the washing machine → the higher the spin speed the shorter the drying time will be (consumes less energy), also spin easy-care laundry.
- Put in, but do not exceed, the maximum recommended quantity of laundry → programme overview → Page 7.
- Make sure the room is well ventilated during drying.
- Do not obstruct or seal up the air inlet.
- Keep the air cooler clean → page 6 "Care and cleaning".

Care and cleaning



Only when switched off!



Dryer housing, control panel, air cooler, moisture sensors

- Wipe with a soft, damp cloth.
- Do not use harsh cleaning agents and solvents.
- Remove detergent and cleaning agent residue immediately.
- During drying, water may collect between the door and seal.
This does not affect your dryer's functions in any way.

Clean the air cooler 5 - 6 times a year
or if **Clean filter** flashes after cleaning the fluff filter.



Air cooler

- Allow the dryer to cool.
- Residual water may leak out, so place an absorbent towel underneath the maintenance door.

- Clean filter
- Empty water

1. Unlock the maintenance door.
2. Open the maintenance door fully.

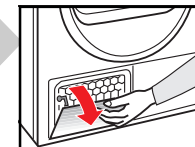

3. Turn both locking levers towards each other.
4. Pull out the air cooler.



Do not damage the air cooler.
Clean with warm water only. Do not use any hard or sharp-edged objects.

5. Clean the air cooler thoroughly,
Allow to drip dry.
6. Clean the seals.
7. Re-insert the air cooler,
with the handle facing down.
8. Turn back both locking levers.
9. Close the maintenance door until the lock clicks into place.



Moisture sensors

The dryer is fitted with stainless steel moisture sensors. The sensors measure the level of moisture in the laundry. After a long period of operation, a fine layer of limescale may form on the sensors.

1. Open the door and clean the moisture sensors with a damp sponge which has a rough surface.



Do not use steel wool or abrasive materials.



After drying: laundry is to be ...	T-shirt	Shirts	Trousers	Skirts/dresses	Sportswear	Work clothing	Anoraks	Towelng gowns	Underwear	Socks	Bed linen	Table linen	Terry towels	Tea towels/ towels
☞ ironed	✓													
☞ lightly ironed dry				✓										
☞ not ironed														
☞ passed through a mangle														
Cottons/Coloureds	max. 8 kg	For whites and coloureds/cotton or linen.												
Iron Dry	☞ ☞ ☞ ☞		✓											✓
Cupboard Dry	☞ ☞													✓
Cupboard Dry Extra	☞ ☞													✓
Easy-Care	max. 3.5 kg	For non-iron laundry made of synthetic fibres and blended fabric, cotton.												
Iron Dry	☞ ☞ ☞ ☞		✓											✓
Cupboard Dry	☞ ☞													✓
Cupboard Dry Extra	☞ ☞													✓
Outdoor	max. 1.5 kg	For fabrics with membrane coating, water-repellent fabrics, functional clothing, fleece fabrics (dry jackets/trousers with removable internal lining separately).												
Lingerie	max. 1 kg	For lingerie made of synthetic fibres, cotton or blended fabric.												
Woollens Finish	max. 3 kg	For woollen fabrics suitable for machine-washing. Fabrics become fluffier but not dry. Remove fabrics once the programme has ended and allow to dry.												
Rapid 40	max. 2 kg	For laundry made of synthetic fibres, cotton or blended fabrics (for example) that needs to be dried quickly. The values may differ from the those specified depending on the type of fabric, mixture of laundry to be dried, residual moisture in the fabric and loading capacity.												
Programme time warm 20	max. 3 kg	For pre-dried, multi-layered, sensitive fabrics made of acrylic fibres, or separate small items of laundry. Also for subsequent drying.												

0111 / 9000617095

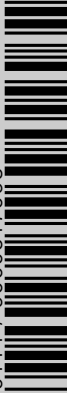

Siemens Electrogeräte GmbH
Carl-Wery-Str. 34
81739 München/Germany

WT46E385GB

Installation

- Delivery specification: dryer, instructions for installation and use, woollens basket (depending on model).
- Check dryer for transport damage.
- The dryer is very heavy. Do not attempt to lift it on your own.
- Be careful to avoid sharp edges.
- Do not lift the dryer by any of the protruding parts (e.g. the door) as they may break off.
- Do not set up in a room that is susceptible to frost. Freezing water may cause damage.
- If in doubt, have the appliance connected by an expert.

1. Setting up the dryer

- The appliance plug must always be accessible.
- Ensure that the appliance is installed on a clean, level and solid surface.
- Keep the cooling grille at the front of the dryer unobstructed.
- Keep the area around the dryer clean.
- Make the dryer level using the threaded feet and a spirit level. Do not remove the threaded feet under any circumstances.



Do not set up the dryer behind a door or sliding door as this may obstruct or prevent the dryer door from opening. This will prevent a potentially fatal danger to children from locking themselves in.



Take all accessory parts out of the drum. The drum must be empty.

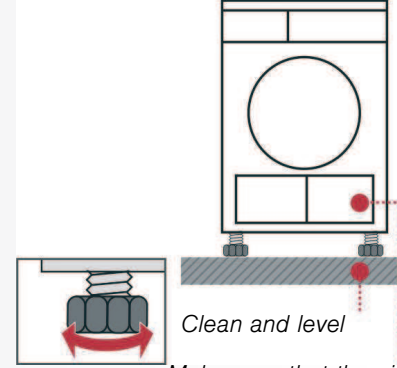

Clean and level

Make sure that the air inlet remains unobstructed

2. Mains connection see safety instructions → Page 11.

- Connect to an AC earthed socket. If in doubt have the socket checked by an expert.
- The mains voltage and the voltage shown on the rating plate (→ Page 9) must correspond.
- The connected load and necessary fuse protection are specified on the rating plate.

Frost protection/transport



Do not operate the dryer if there is a danger of frost.



Preparation

1. Empty the condensation container → page 4.
2. Select any programme using the programme selector.
3. Press the **Start/Stop** button → condensation is pumped into the container.
4. Wait 5 min., and then empty the condensation container again.
5. Turn the programme selector to **Off**.

Technical data

● Dimensions (DxWxH)	60 x 60 x 85 cm (height adjustable)
Weight	approximately 45 kg
Max. capacity	8 kg
Condensation container	4.2 l
Connection voltage	
Connected load	
Fuse protection	see appliance rating plate
Ambient temperature	
Product number/ Production number	

You can find the rating plate on the back of the dryer.

● Consumption rates	These are guide values determined under standard conditions. Fluctuations up to 10% are possible.		
	Spin speed in rpm (residual moisture)	Drying time in min.**	Energy consumption in kWh**
Cottons/Coloureds 8 kg		13 A	13 A
Cupboard Dry*	1400 (approx. 50 %)	105	3.74
	1000 (approx. 60 %)	122	4.49
	800 (approx. 70 %)	139	5.17
Iron Dry*	1400 (approx. 50 %)	83	2.24
	1000 (approx. 60 %)	100	3.44
	800 (approx. 70 %)	117	3.86
Easy-Care 3.5 kg	1000	39	1.05
Cupboard Dry*	800 (approx. 40 %)	42	1.35
	600 (approx. 50 %)	51	1.65

*Test program according to DIN EN 61121.

**The values may differ from the those specified depending on the type of fabric, mixture of laundry to be dried, residual moisture in the fabric and loading capacity.

- **Drum interior light** (depending on model) (bulb E14, 25 W)
The drum is illuminated after the door is opened or closed, and also after the programme is started. It goes out automatically. Replacing the bulb → Page 10.

Optional accessories (order from the after-sales service using the order number)

WZ 20460 **Platform**
For better loading and unloading. The basket contained in the drawer can be used to carry the laundry.

WZ 20310 **Washer-dryer stack connection set**
The dryer can be placed on top of a suitable washing machine with the same width and depth to save space.
This connection set **must** always be used to secure the dryer to the washing machine.

WZ 20290 **Installation underneath the worktop**
Risk of electric shock!
Instead of the appliance covering plate, you must have a metal cover fitted by an expert.

What to do if ...



If you cannot rectify a fault yourself, please contact our after-sales service. We will always find an appropriate solution and will avoid unnecessary visits by engineers. Trust the expertise of the manufacturer and rest assured that the repair will be carried out by trained service technicians using original spare parts. The contact details of your local after-sales service can be found in the enclosed **after-sales service** directory, or by calling one of these numbers:
– **GB** 0844 8928999 (Calls from a BT landline will be charged at up to 3 pence per minute. A call set-up fee of up to 6 pence may apply.)
– **IE** 01450 2655

When contacting the after-sales service, please quote the appliance's product number (E no.) and production number (FD) (see the inside of the door).
Set the programme selector to **Off** and remove the appliance plug from the socket.

- The **Start/Stop** indicator lamp does not light up. Mains plug plugged in? Programme selected?
- The **Empty water** and **Start/Stop** indicator lamp flash. Empty the condensation container. If featured, check hose for condensation outlet.
- The **Clean filter** and **Start/Stop** indicator lamp flash. Clean the fluff filter and/or air cooler → Page 4/6.
- Dryer does not start. **Start/Stop** button selected? Door closed? Programme set? Ambient temperature greater than 5 °C?
- Water is running out. Align dryer horizontally. Clean air cooler seal.
- The door opens by itself. Push the door closed until you hear it engage.
- The required degree of dryness was not achieved or the drying time was too long. Clean the fluff filter and/or air cooler → Page 4/6. Empty condensation container → Page 4. Check water outlet (if featured). Ambient temperature higher than 35 °C → airing. Air inlet may be blocked → keep unobstructed. Was an unsuitable programme selected? → Page 7. Has the dryer been installed with sufficient space on all sides? Ensure that air can circulate. Fine layer of scale on the moisture sensors → Clean the moisture sensors → page 6.
- Laundry damp. Use the next drying programme up or use the timer programme as a supplement → Page 7. Warm laundry feels damper than it really is!
- The moisture content of the room has increased significantly. Make sure the room is sufficiently ventilated. Air inlet blocked? → keep unobstructed. Ensure that the air cooler has been inserted.
- Mains failure. Remove laundry from the dryer immediately and spread out. This allows the heat to dissipate.
- One or more indicator lights for programme status are flashing. Clean filter and air cooler → Page 4/6. Check installation conditions → Page 8. Switch off, leave to cool down, switch on again, restart programme.
- The interior light is not working (depending on model). Pull out the appliance plug, remove the cover cap in the interior above the door (use Torx 20 screw driver) and replace the bulb. Close the cover cap. Never operate the dryer without a cover cap.

Safety instructions



- Emergency** – Pull the appliance plug out of the socket immediately or disconnect the fuse.
- ONLY use the dryer...** – In rooms inside the house.
– To dry fabrics.
- The dryer must NEVER...** – Be used for other purposes than those described above.
– Be modified in terms of its technology or attributes.
- Dangers** – The dryer must not be used by children or persons who have not been instructed in its use.
– Do not leave children unsupervised near the dryer.
– Keep pets away from the dryer.
– Remove all objects from pockets.
Make especially sure that cigarette lighters are removed as they constitute an → **explosion hazard.**
– Do not lean or sit on the door → **risk of tipping.**
- Installation** – Secure loose cables → **tripping hazard.**
– Do not operate the dryer if there is a risk of frost.
- Mains connection** – Connect the dryer according to specifications to an AC earthed socket, as otherwise it cannot be guaranteed that the appliance is completely safe.
– The cable cross-section must be sufficient.
– Only use earth-leakage circuit breakers with the following symbol: 
– The appliance plug and socket must be compatible.
– Do not use multiple plugs/couplings and/or extension cables.
– Do not hold the appliance plug with wet hands → **risk of electric shock.**
– Never pull the appliance plug out of the socket by its cable.
– Do not damage the mains lead → **risk of electric shock.**
- Operation** – Only load the drum with laundry.
Check the contents before you switch the dryer on.
– Do not use the dryer if the laundry has been in contact with solvents, oil, wax, grease or paint (e.g. hair setting spray, nail polish remover, stain remover, cleaning solvent, etc.) → **fire/explosion hazard.**
– Dust (e.g. coal dust, flour) poses a danger: do not use the dryer → **explosion hazard.**
– Do not put laundry containing foamed material/rubber in the dryer → elastic material may be destroyed and the dryer may be damaged due to possible deformation of the foamed material.
– Switch off the dryer once the programme has ended.
– Condensation is not drinking water and may be contaminated with fluff.
- Defect** – Do not use the dryer if it is defective or if you suspect it is.
Repairs must only be carried out by the after-sales service.
– Do not use the dryer if the mains cable is defective. To avoid danger, only have the defective mains cable replaced by the after-sales service.
– Always pull the mains plug out of the socket before changing the bulb for the interior light → **risk of electric shock.**
- Spare parts** – Only use genuine spare parts and accessories for safety reasons.
- Disposal** – Dryer: pull out the appliance plug, **then** cut off the mains cable from the appliance.
Dispose of at municipal waste disposal facility.
– Packaging: do not leave children alone with packing parts
→ **risk of suffocation.**
– All materials are environmentally sound and can be reused. Dispose of in an environmentally-responsible manner.



Observe the safety instructions on page 11.

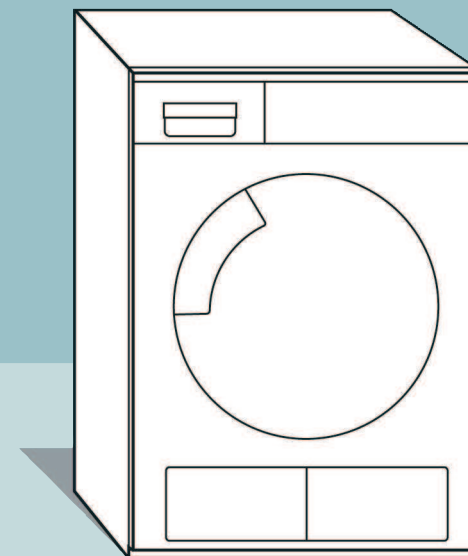

Tumble dryer

Instructions for installation and use

en

SIEMENS



Read these instructions before operating the dryer.