

Your washing machine

Congratulations – you have opted for a modern, high-quality domestic appliance manufactured by Siemens. This washing machine is distinguished by its economical water and energy consumption. Each machine that leaves our factory is inspected thoroughly to ensure that it functions properly and is in perfect condition.

For further information about products, accessories, spare parts and services visit our web site: www.siemens-home.com or contact our after-sales service centres.

Contents

Intended use	Page
Programmes	1
Setting and adjusting the programme	3
Washing	3/4
After washing	4
Individual settings	5/6
Overview of programmes	7
Safety instructions	8
Consumption values	8
Important information	9
Insert for liquid detergent	10
Care	10
Information on the display panel	10
Instructions for blockages	11
What to do if ...	12/13
Emergency release	13
After-sales service	13

Environmental protection/Conservation tips

- Always fill the washing machine with a maximum amount of laundry for the relevant programme.
- Wash normally soiled laundry without a prewash.
- Instead of **Cotton/Coloureds 90 °C**, select the **Cotton/Coloureds 60 °C** programme along with the **ecoPerfect** option. Comparable cleaning with significantly lower energy consumption.
- Measure the detergent according to the manufacturer's instructions and water hardness.
- If the laundry is then dried in the tumble dryer, select the appropriate spin speed according to the instructions of the dryer manufacturer.

Automatic stain removal
Automatic treatment of 16 different types of stain. No pretreatment of stains required – washing machine adjusts the washing process automatically → Page 6.

Intended use

- For domestic use only
- For machine-washable fabrics and hand-washable wool in detergent solution
- To be operated with cold mains water and commercially available detergents and care products which are suitable for use in washing machines.

- Do not leave children unattended near the washing machine
- The washing machine is not to be used by children or persons not familiar with the operating instructions
- Keep pets away from the washing machine.

Programmes

Detailed overview of programmes → page 7. Temperature and spin speed can be selected individually, depending on the selected programme and programme progress.

Cotton/Coloureds	Hard-wearing fabrics
Easy-Care	Easy-care fabrics
Mixed Fabrics	Different types of laundry
Delicates/Silk	Delicate washable fabrics
Wool	Hand/machine-washable wool
Rinse	Extra rinse with spin
Spin	Extra spin with selectable spin speed
Empty	To drain the rinsing water, select Rinse Hold (no Final spin)
Low spin	Extra spin with reduced spin speed
Rapid 15'	Super-short programme
Textile Guard	All-weather, sportswear and outdoor clothing → page 9.
Shirts/Blouses	Non-iron shirts
Lingerie	Lingerie programme
Curtains	Curtains programme
Easy-Care Dark	Dark-coloured fabrics

Preparation Before washing for the first time

- Correct installation according to the separate installation instructions.
- Check the machine: Never use a damaged machine. Inform the after-sales service.
- Connect the mains plug: Make sure your hands are dry. Take hold of the plug only.
- Turn the tap on

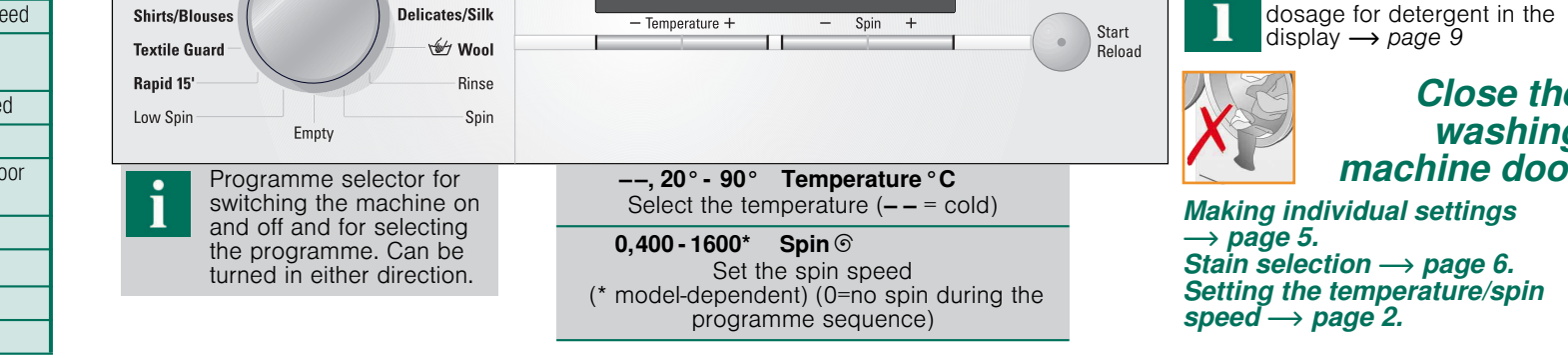
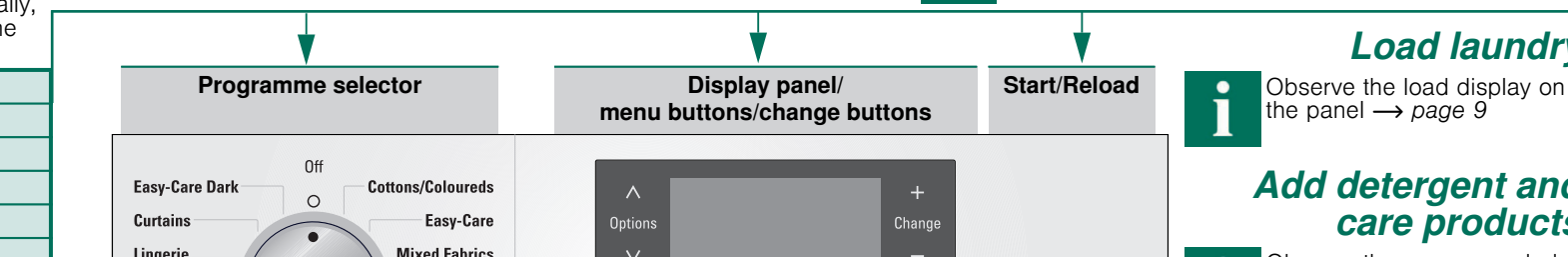
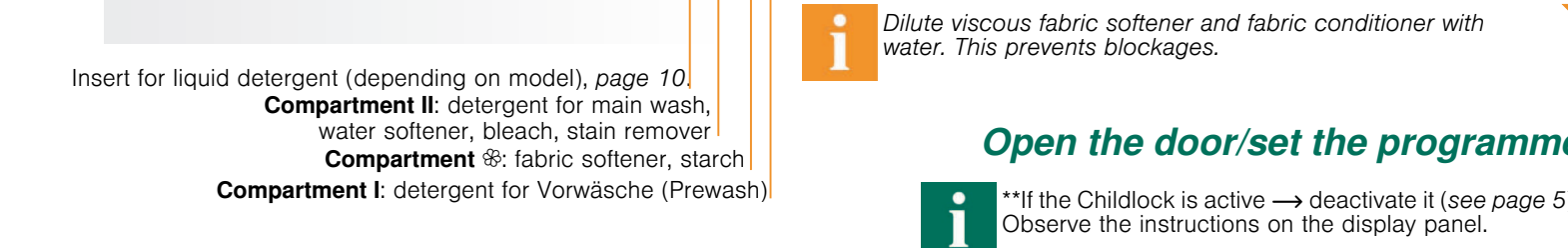
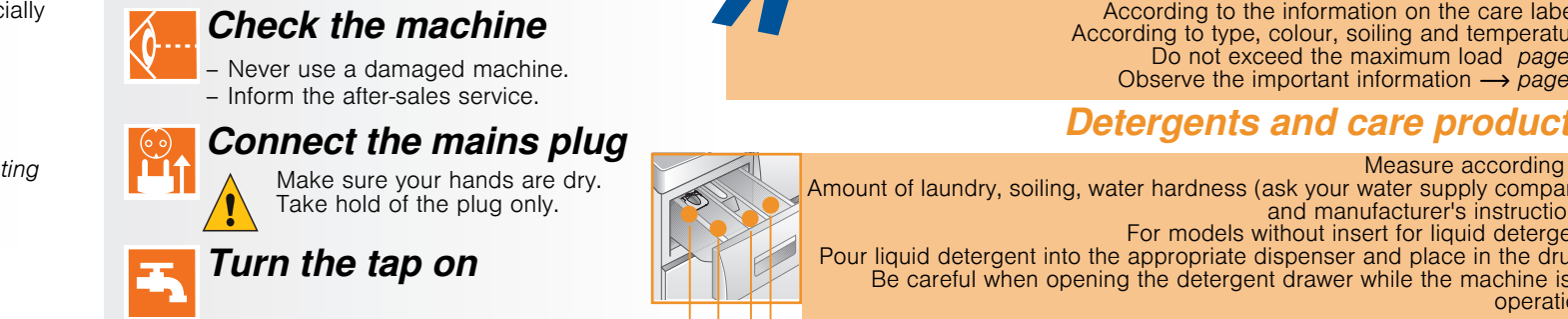

Washing

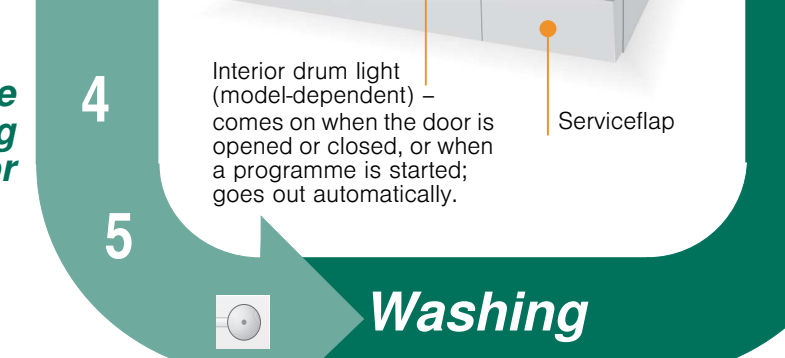
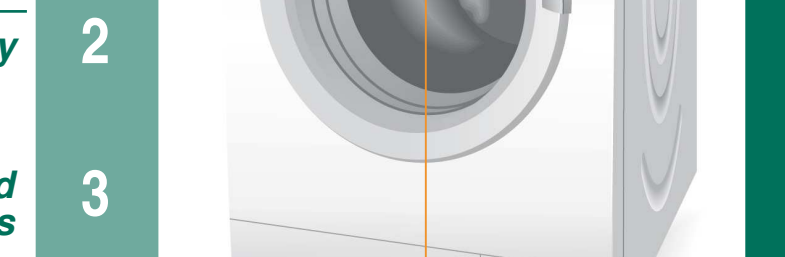
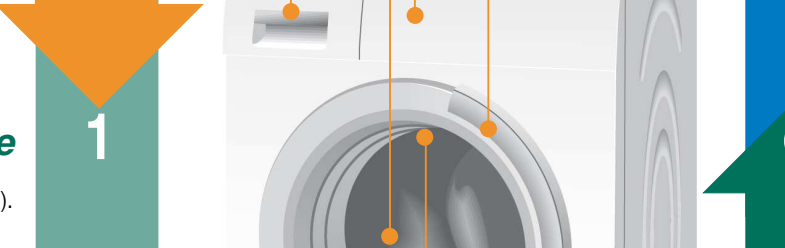
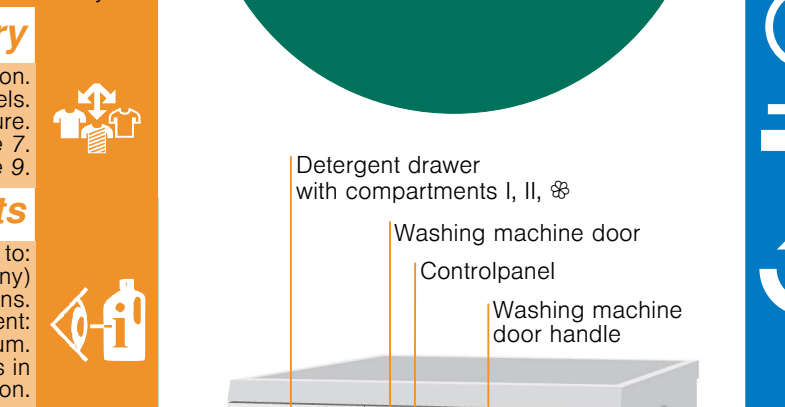

Switch off the appliance

Turn the programme selector to **Off**.

Turn the tap off

Not required for AquaStop models. Installation instructions, page 7.

Remove the washing

- Open the washing machine door and remove the washing.
- If **Rinse Hold** (without Final spin) is active: turn the programme selector to **Empty** or **Spin**. Select spin speed where necessary. Select **Start/Reload**.
 - Remove any foreign objects - risk of rusting.
 - Leave the washing machine door and detergent drawer open so that any residual water can evaporate.

Programme has ended when ...

... finished, remove washing appears on the display panel.

Cancelling the programme

- Programmes at high temperatures:
 - To cool the laundry down: Select **Rinse**.
 - Select **Start/Reload**.
- Programmes at low temperatures:
 - Select **Spin** or **Empty**.
 - Select **Start/Reload**.

Changing the programme, if ...

- ... you have selected the wrong programme by mistake:
 - Reselect the programme.
 - Select **Start/Reload**. The new programme starts from scratch.

Reloading laundry, if ...

- ... **Start/Reload** is selected and **Top-up** then appears on the display panel.
 - Do not leave the washing machine door open for too long as water from the washing could leak out.
 - Load display not active **when reloading**.

Individual settings

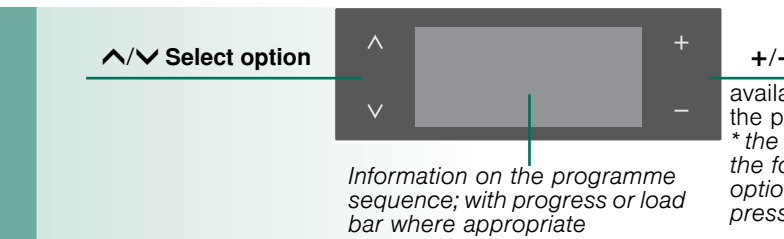

Options

see also the Overview of programmes

varioPerfect*
speedPerfect - Standard - ecoPerfect

End time*
When a programme is selected, the time until the programme will be finished is displayed. The programme end time can be adjusted in hours, up to a maximum of 24h. Press the **+/- Change** button repeatedly until the desired number of hours appears (h = hour). The time cannot be adjusted once the programme has started.

Prewash OFF - ON
For heavily soiled laundry. Prewash at max. 30 °C

Easy-iron OFF - ON
Special spin sequence with subsequent fluffing. Gentle Final spin at reduced speed - residual moisture in the laundry slightly increased.

Signal*
Select the volume of the information signals. OFF - quiet - medium - loud - very loud

Button signal*
Select the volume of the button signals. OFF - quiet - medium - loud - very loud

Language*
Select the language of the display texts.

Water Plus OFF - ON
Higher water level. Laundry washed with more care.

Rinse Hold OFF - ON
After the final rinse, the laundry remains in the water.

Extra rinse* max. +3 Rinses
Additional rinsing. Longer programme duration. Recommended use: for especially delicate skin and/or in areas with very soft water.

Select stain*
Automatic treatment of stubborn stains -> page 6.

Display symbols

Childlock/appliance lock
OFF - ON

You can lock the washing machine to prevent the functions you have set from being changed inadvertently. To activate/deactivate: press the **Options** button for 5 seconds. Note: the childlock can remain active until you wish to start the next programme, even after switching off the machine. Then deactivate the Childlock after the machine has been switched back on.

Foam detection
Too much foam in the washing machine. Foam detection system active - special programme sequence to reduce foam.

Select stain

The correct treatment for every stain

Do not allow stains to dry. Remove any solid residues first. Sort the items of laundry as usual and load the washing machine. Select a type of stain (cannot be combined).

There are a total of 16 different stains to choose from. The washing machine tailors the washing temperature, drum movement and soaking time to the type of stain. Hot or cold water, gentle or intensive washing control (thanks to the new drum structure) and a long or short soaking time ensure that the wash programme runs specifically according to the type of stain.

A stain type can be added to each programme via the menu buttons/change buttons. This results in optimum stain treatment without the use of additional special detergents.

Stains

Baby food	Cosmetics	Tea
Blood	Red wine	Tomato
Egg	Chocolate	Strawberry
Soil + sand	Sweat	Orange
Grass	Dirty socks	
Coffee	Grease + oil	

Stain treatment in detail - 2 examples

Egg
Soaked in lukewarm water, selected wash cycle with a higher water level and additional rinse cycles to remove particles

Blood
Blood is first "loosened" in cold water, then the selected wash programme starts.

For the other types of stain, we have formulated comparable solutions in our intensive studies.

Reload

If you want to add subsequent items of laundry after the programme has started, press the **Start/Reload** button. The machine checks whether reloading is possible. Note the information in the display panel.

For safety reasons, the washing machine door remains locked when the water level and/or temperature is high, or while the drum is rotating. To continue the programme, press the **Start/Reload** button

Overview of programmes

Programmes	°C	max.	Type of laundry	Options, notes
Cotton/Coloureds	90 °C	8 kg/ 5 kg*	Hard-wearing fabrics; heat-resistant fabrics made of cotton or linen	Prewash, Prewash, Rinse Hold, Extra rinse, Stains, EcoPerfect, Water Plus, speedPerfect, Standard, ecoPerfect
Easy-Care	60 °C		Easy-care fabrics made of cotton, linen, synthetic fibres or blended fabrics	speedPerfect, EcoPerfect, Standard, ecoPerfect
Mixed Fabrics	40 °C	3.5 kg	Fabrics made of cotton and easy-care fabrics	speedPerfect, EcoPerfect, Standard, ecoPerfect
Easy-Care Dark	40 °C		Dark-coloured fabrics made of cotton and dark easy-care fabrics	speedPerfect, EcoPerfect, Standard, ecoPerfect
Curtains	40 °C		Curtains weighing 3.5 kg, or light curtains measuring reduced rinse + spin and final spin	speedPerfect, EcoPerfect, Standard, ecoPerfect
Shirts/Blouses	60 °C		Non-iron shirts made of cotton, linen, synthetic fibres or blended fabrics	speedPerfect, EcoPerfect, Standard, ecoPerfect
Delicates/Silk	40 °C	2 kg	For delicate, washable fabrics, e.g. made of silk, satin, synthetic fibres or blended fabrics (e.g. curtains)	speedPerfect, EcoPerfect, Standard, ecoPerfect
Wool	40 °C		Hand or machine-washable fabrics made of wool or containing wool	speedPerfect, EcoPerfect, Standard, ecoPerfect
Rapid 15'	40 °C		Easy-care fabrics made of cotton, linen, synthetic fibres or blended fabrics	speedPerfect, EcoPerfect, Standard, ecoPerfect
Lingerie	40 °C	1 kg	Delicate (Lingerie)	speedPerfect, EcoPerfect, Standard, ecoPerfect
Textile Guard	40 °C		Washing with subsequent water proofing of all-weather, sportswear and outdoor clothing, and washing with a weatherproof membrane, waterproof fabrics	speedPerfect, EcoPerfect, Standard, ecoPerfect

Additional programmes
reduced load for speedPerfect option
For a short programme, Mix Fabrics 40 °C with max. spin speed is ideal.
Programmes with no prewash - place detergent into compartment II, programmes with prewash - divide detergent between compartments I and II.

Rinse, Spin, Empty, Low spin

Siemens Electrolux GmbH
Carl-Wery-Str. 34
81739 München / Deutschland

WT16S796GB
WT14S796GB

1206 / 900052311

Safety instructions

- Read the Instruction manual and Installation instructions and all other information enclosed with the washing machine and act accordingly.
- Retain the documents for subsequent use.

Risk of electric shock

- Never pull the cable to disconnect the mains plug.
- Only insert/pull out the mains plug with dry hands.

Danger to life

- For worn-out appliances:
- Disconnect the mains plug.
 - Sever the mains cable and discard along with the plug.
 - Destroy the lock on the washing machine door. This will prevent children from locking themselves in and putting their lives in danger.

Danger of suffocation

- Keep packaging, film and packaging parts out of the reach of children.

Risk of poisoning

Risk of explosion

- Items of laundry pretreated with cleaning agents containing solvents, e.g. stain remover/cleaning solvent may cause an explosion after being loaded into the washing machine. Rinse items of laundry thoroughly by hand before washing.

Risk of injury

- The washing machine door can become very hot.
- Be careful when draining hot detergent solution.
- Do not climb onto the washing machine.
- Do not lean on the open washing machine door.
- Do not reach into the drum if it is still rotating.

Important information

Before washing for the first time

- Do not load any laundry into the machine. Turn on the tap. Add the following to compartment **II**:
- approx. 1 litre water
 - detergent (dosage according to the manufacturer's instructions for light soiling and the appropriate degree of water hardness)
- Set the programme selector to **Easy-Care 60 °C** and select **Start/Reload**. At the end of the programme, turn the programme selector to **Off**.

Protecting the laundry and the machine

- Empty pockets.
- Look out for metal items (paperclips, etc.).
- Wash delicates in a laundry bag (tights, curtains, underwired bras).
- Fasten zips, do up any buttons.
- Brush sand out of pockets and collars.
- Remove curtain fittings or place in the laundry bag.

Loading the laundry

Insert large and small items of laundry. Ensure that items are not trapped between the door and rubber seal.

Laundry with varying degrees of soiling

- | light | Wash new items of clothing separately. |
|-------|---|
| | No prewash. The ecoPerfect function can also be selected if desired. |
| | Pretreat any stains as necessary. |
| heavy | Insert less laundry. Select Prewash with the programme. |

Soaking

Pour soaking agent/detergent into compartment **II** in accordance with the manufacturer's instructions. Turn the programme selector to **Cottons/Coloureds 30 °C** and press **Start/Reload**. After approx. 10 minutes, press **Start/Reload** to pause the programme. Once the required soaking time has elapsed, press **Start/Reload** again to continue the programme, or select a different programme.

Starching

Starching is possible in all wash programmes using liquid starch. Pour the starch into the fabric softener compartment according to the manufacturer's instructions (if necessary clean it first).

Dyeing/bleaching

Dye should only be used in normal household quantities. Salt may damage stainless steel. Always follow the dye manufacturer's instructions. **Do not** bleach laundry in the washing machine.

Load display

The loading sensor detects the load amount in the washing machine. The laundry is not weighed.

Recommended dosage

Depending on the programme selected and the load detected, a recommended detergent dosage is displayed in %. The % display corresponds to the detergent manufacturer's recommendation.

Load adjust

Independently of the load display, the "Load adjust" automatic load sensing function uses additional sensors to adapt the water and power consumption ideally to each programme, depending on the type of fabric and the load.

Outdoor+ Impregnation

Laundry must not be treated with fabric softener. Clean the detergent drawer thoroughly to remove fabric softener residue.

Special detergents and impregnating agents suitable for machine washing are available in sports shops. Dose according to manufacturing instructions:

1. Place the special detergent for outdoor clothing in compartment **II** and
2. pour impregnating agent (max. 170 ml) into the compartment.

Move the programme selector to **Textile Guard**. Select temperature. Press **Start/Reload**. Final treatment of laundry according to manufacturer's instructions.

Insert for liquid detergent

- Position the insert for dispensing liquid detergent:
- Remove the detergent drawer completely -> [page 10](#).
 - Slide the insert forwards.

Do not use the insert (slide upwards):

- for gel detergents and washing powder,
- for programmes with **Prewash** or the **End time** option.

Care

Machine housing, control panel

- Wipe with a soft, damp cloth.
- Do not use any abrasive cloths, scourers or cleaning agents (stainless steel cleaners).
- Remove detergent and cleaning agent residue immediately.
- Do not clean with a jet of water.

Cleaning the detergent drawer ...

... if it contains detergent or fabric softener residues.

1. Pull out, press insert down, remove drawer completely.
2. To remove the insert, push the insert up from below with your finger.
3. Clean the detergent dispenser tray and insert with water and a brush and dry it.
4. Attach the insert and engage (connect the cylinder to the guide pin).
5. Push in the detergent drawer.

Drum

Rust stains - use chlorine-free cleaning agent, not steel wool.

Descaling

No laundry in the machine.

This is not necessary if the detergent is dosed correctly. However, if it is necessary, follow the instructions of the descaler manufacturer. Suitable descaling products can be purchased from our website or after-sales service (→ [page 13](#)).

Information on the display panel

Door open?	Close the door properly; laundry may be trapped.
Tap closed?	Open the tap fully, supply hose kinked/trapped; clean the filter → page 11 , water pressure too low.
Pump blocked?	Detergent solution pump blocked; clean detergent solution pump → page 11 . Drainage hose/waste pipe blocked; clean the drain hose on the siphon → page 11 .
Pause No top-up; Water level too high or Temperature too high	Not possible to reload laundry. Press Start/Reload to continue the programme.
F: 23	Water in the base tub, appliance leaking. Call the after-sales service.
F: 34	Cannot lock washing machine door. Open the door and close it again so that you can hear it "click"; switch the appliance off and on again; set the programme and make individual settings; start the programme.
Other displays	Switch off the appliance, wait 5 seconds and switch on again. If the same display appears again, call the after-sales service → page 13 .

Information about blockages

Detergent solution pump

Turn the programme selector to **Off**, disconnect the mains plug.

1. Open and remove the service flap.
2. Remove the drainage hose from its holder. Remove the sealing cap and allow the solution to drain out. Put the sealing cap back in place.
3. Unscrew the pump cover carefully (residual water).
4. Clean the interior, pump cover thread and pump housing (the impeller in the detergent solution pump must rotate).
5. Put the pump cover back in place and screw it tight. The handle should stand vertically. Insert the drainage hose into its holder.
6. Refit the service flap and close it.

Drainage hose at the siphon

Turn the programme selector to **Off**, disconnect the mains plug.

1. Loosen the hose clamp, remove the drainage hose carefully (residual water).
2. Clean the drainage hose and siphon connecting piece.
3. Reattach the drainage hose and secure the connection with the hose clamp.

Filter in the water supply

Risk of electric shock
Do not immerse the AquaStop safety device in water (it contains an electric valve).

Reduce the water pressure in the supply hose:

1. Turn off the tap.
2. Select any programme (**apart from Spin/Empty**).
3. Press **Start/Reload**. Allow the programme to run for approx. 40 seconds.
4. Turn the programme selector to **Off**. Disconnect the mains plug. Clean the filter:
5. Disconnect the hose from the tap. Clean the filter using a small brush.
6. Connect the hose and check for leaks.

What to do if ...

- Water is leaking out.
 - Attach/replace the drainage hose correctly.
 - Tighten the screw connection of the supply hose.
- No water supply. Detergent not dispensed.
 - **Start/Reload** not selected?
 - Tap not turned on?
 - Filter may be blocked. Clean the filter → [page 11](#).
 - Supply hose kinked or trapped?
- Washing machine door cannot be opened.
 - Safety function active. Programme terminated? → [page 4](#).
 - **Rinse Hold** (no Final spin) selected? → [page 3, 4](#).
 - Can be opened by emergency release only? → [page 13](#).
- Programme does not start.
 - **Start/Reload** or **End time** selected?
 - Washing machine door closed?
 - Childlock active? Deactivate it → [page 5](#).
- Detergent solution does not drain.
 - **Rinse Hold** (no Final spin) selected? → [page 3, 4](#).
 - Clean the detergent solution pump → [page 11](#).
 - Clean the waste pipe and/or drainage hose.
- Water not visible in the drum.
 - Not a fault - water below the visible area.
- Unsatisfactory spin result. Laundry wet/too damp.
 - Not a fault - the unbalanced-load detection system has cancelled the spin cycle because of uneven distribution of the laundry. Distribute small and large items of laundry evenly inside the drum.
 - **Easy-iron** selected? → [page 5](#).
 - Selected speed too low? → [page 5](#).

- Drum spins gently several times.
 - Not a fault - unbalanced-load detection system is adjusting the imbalance.
- Residual water in the compartment for care products.
 - Not a fault - the action of the care product is not affected.
 - Clean the insert if necessary → [page 10](#).
- Odour formation in the washing machine.
 - Run the **Cottons/Coloureds 90 °C** programme with no load inserted. Use standard detergent.
- The status indicator lights. Appliance has detected a detergent overload.
 - Too much detergent used? Mix 1 tablespoon of fabric softener with ½ litre water and pour into compartment **II** (not with outdoor or down fabrics).
 - Reduce the detergent dosage for the next wash cycle.
- Loud spinning, vibrations and "walking" during the spin cycle.
 - Appliance feet fixed? Secure the appliance feet → [Installation instructions](#).
 - Transport braces removed? Remove the transport braces → [Installation instructions](#).
 - Power cut? Circuit breakers tripped? Reset/replace the circuit breakers.
 - If the fault occurs repeatedly, call the after-sales service.
- Display panel/indicator lamps do not function during operation.
 - Not a fault - unbalanced-load detection system is adjusting the imbalance by repeatedly redistributing the laundry.
 - Not a fault - foam detection system active - several rinse cycles are added.

What to do if ...

- There are detergent residues on the laundry.
 - Occasionally, phosphate-free detergents contain water-insoluble residues.
 - Use the **Rinse** cycle or brush out the laundry after washing.
 - in Reload mode, Start/Reload flashes very quickly and an audible signal sounds
 - Water level too high. Not possible to reload laundry. Close door immediately if open.
 - To continue the programme, press **Start/Reload**.
- If you cannot correct a fault yourself (switching on/off) or a repair is required:
- Turn the programme selector to **Off** and remove the mains plug from the socket.
 - Turn off the water supply and call the after-sales service → [page 13](#).

Emergency release

The programme continues when the power supply is restored. However, if the laundry has to be removed, the washing machine door can be opened as follows:

Risk of scalding.

The detergent solution and laundry may be hot. Allow them to cool down. Do not reach inside the drum if it is still turning. Do not open the door if you can see water through the glass.

1. Turn the programme selector to **Off** and disconnect the mains plug.
2. Drain the detergent solution → [page 11](#).
3. Pull the emergency release downwards with a tool and release. Washing machine door can then be opened.

After-sales service

- If you cannot rectify the fault yourself (Troubleshooting → [page 12, 13](#)), please contact our after-sales service. We will always find a suitable solution and will avoid a visit from a service technician wherever possible.
- You can find the contact details for your nearest after-sales service here or in the after-sales service directory (depending on model).

GB 0844 8928999 Calls from a BT landline will be charged at up to 3 pence per minute. A call set-up fee of up to 6 pence may apply.

IE 01450 2655

Please give the after-sales service the product number (E no.) and the production number (FD) of the appliance.

You will find this information: on the inside of the washing machine door*/ opened service flap* and rear of the appliance. *depending on the model

E-Nr. _____	FD _____
Product number	Production number

- **Rely on the professionalism of the manufacturer.** Please contact us. This will ensure that the repair is carried out by trained service technicians who arrive equipped with genuine spare parts for your appliance.

! Observe the safety instructions on page 8.



Washing machine

Instruction manual

Read these instructions and the separate Installation instructions before operating the washing machine.

en

SIEMENS

Your washing machine

Congratulations – you have opted for a modern, high-quality domestic appliance manufactured by Siemens. This washing machine is distinguished by its economical water and energy consumption.

Each machine that leaves our factory is inspected thoroughly to ensure that it functions properly and is in perfect condition.

For further information about products, accessories, spare parts and services visit our web site: www.siemens-home.com or contact our after-sales service centres.

Contents

	Page
Intended use	1
Programmes	1
Setting and adjusting the programme	3
Washing	3/4
After washing	4
Individual settings	5/6
Overview of programmes	7
Safety instructions	8
Consumption values	8
Important information	9
Insert for liquid detergent.....	10
Care	10
Information on the display panel	10
Instructions for blockages	11
What to do if	12/13
Emergency release	13
After-sales service	13



Environmental protection/Conservation tips

- Always fill the washing machine with a maximum amount of laundry for the relevant programme.
- Wash normally soiled laundry without a prewash.
- Instead of **Cotton/Coloureds 90 °C**, select the **Cotton/Coloureds 60 °C** programme along with the **ecoPerfect** option. Comparable cleaning with significantly lower energy consumption.
- Measure the detergent according to the manufacturer's instructions and water hardness.
- If the laundry is then dried in the tumble dryer, select the appropriate spin speed according to the instructions of the dryer manufacturer.

Automatic stain removal

Automatic treatment of 16 different types of stain. No pretreatment of stains required – washing machine adjusts the washing process automatically → Page 6.

Intended use

- For domestic use only
- For machine-washable fabrics and hand-washable wool in detergent solution
- To be operated with cold mains water and commercially available detergents and care products which are suitable for use in washing machines.



- Do not leave children unattended near the washing machine
- The washing machine is not to be used by children or persons not familiar with the operating instructions
- Keep pets away from the washing machine.

Programmes

Detailed overview of programmes → page 7. Temperature and spin speed can be selected individually, depending on the selected programme and programme progress.

Cotton/Coloureds	Hard-wearing fabrics
Easy-Care	Easy-care fabrics
Mixed Fabrics	Different types of laundry
Delicates/Silk	Delicate washable fabrics
Wool	Hand/machine-washable wool
Rinse	Extra rinse with spin
Spin	Extra spin with selectable spin speed
Empty	To drain the rinsing water, select Rinse Hold (no Final spin)
Low spin	Extra spin with reduced spin speed
Rapid 15'	Super-short programme
Textile Guard	All-weather, sportswear and outdoor clothing → page 9.
Shirts/Blouses	Non-iron shirts
Lingerie	Lingerie programme
Curtains	Curtains programme
Easy-Care Dark	Dark-coloured fabrics

Preparation Before washing for the first time

Wash once without any laundry →



Correct installation according to the separate installation instructions.



Check the machine

- Never use a damaged machine.
- Inform the after-sales service.



Connect the mains plug



Make sure your hands are dry. Take hold of the plug only.



Turn the tap on

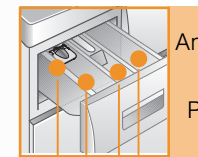

Insert for liquid detergent (depending on model), page 10.

Compartment II: detergent for main wash, water softener, bleach, stain remover

Compartment ⌘: fabric softener, starch

Compartment I: detergent for Vorwäsche (Prewash)

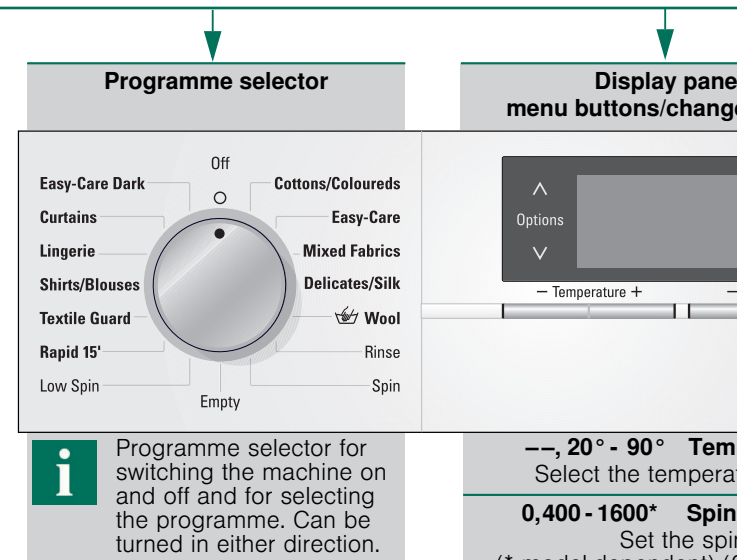

Programme selector for switching the machine on and off and for selecting the programme. Can be turned in either direction.



All buttons are sensitive to be touched lightly.

page 9. **Load indicator/ recommended dosage** To activate, first open the door, set the programme and then load the items of laundry.

Sorting the laundry

Please note the manufacturer's care information. According to the information on the care labels. According to type, colour, soiling and temperature. Do not exceed the maximum load *page 7*. Observe the important information → *page 9*.



Detergents and care products

Measure according to: amount of laundry, soiling, water hardness (ask your water supply company) and manufacturer's instructions. For models without insert for liquid detergent: Pour liquid detergent into the appropriate dispenser and place in the drum. Be careful when opening the detergent drawer while the machine is in operation.



i Dilute viscous fabric softener and fabric conditioner with water. This prevents blockages.

Open the door/set the programme

i **If the Childlock is active → deactivate it (see *page 5*). Observe the instructions on the display panel.

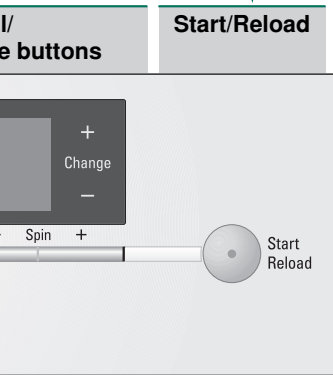

Load laundry

i Observe the load display on the panel → *page 9*

Add detergent and care products

i Observe the recommended dosage for detergent in the display → *page 9*



Close the washing machine door

Making individual settings → *page 5*.
Stain selection → *page 6*.
Setting the temperature/spin speed → *page 2*.

temperature °C
temperature (--- = cold)
Spin speed
no spin during the sequence
sensitive and need only
thly.

Washing

Detergent drawer with compartments I, II, ⌘
Washing machine door
Controlpanel
Washing machine door handle



Interior drum light (model-dependent) – comes on when the door is opened or closed, or when a programme is started; goes out automatically.
Serviceflap

Washing

Press Start/Reload

1
2
3
4
5



Switch off the appliance

Turn the programme selector to **Off**.

Turn the tap off

Not required for AquaStop models *Installation instructions, page 7*.

Remove the washing

Open the washing machine door and remove the washing.
If **Rinse Hold** (without Final spin) is active: turn the programme selector to **Empty** or **Spin**. Select spin speed where necessary. Select **Start/Reload**.

i – Remove any foreign objects - risk of rusting.
– Leave the washing machine door and detergent drawer open so that any residual water can evaporate.

Programme has ended when ...

... **finished, remove washing** appears on the display panel.

Cancelling the programme

Programmes at high temperatures:
– To cool the laundry down: Select **Rinse**.
– Select **Start/Reload**.
Programmes at low temperatures:
– Select **Spin** or **Empty**.
– Select **Start/Reload**.

Changing the programme, if ...

... you have selected the wrong programme by mistake:
– Reselect the programme.
– Select **Start/Reload**. The new programme starts from scratch.

Reloading laundry, if ... *page 6*

... **Start/Reload** is selected and **Top-up** then appears on the display panel.

i – Do not leave the washing machine door open for too long as water from the washing could leak out.
– Load display not active **when reloading**.
Select **Start/Reload**.

Individual settings

^/∨ Select option



+/- Change settings

Information on the programme sequence; with progress or load bar where appropriate

availability depends on the programme selected; * the display runs through the following setting options automatically if pressed and held

Options see also the Overview of programmes

varioPerfect*

- ⊞ speedPerfect - Standard -
- ⊞ ecoPerfect

speedPerfect: washes in a shorter time but with a washing outcome comparable to that of the standard programme. Maximum load → Overview of programmes, page 7.

ecoPerfect: saves energy but with a washing outcome comparable to that of the standard programme.

End time* When a programme is selected, the time until the programme will be finished is displayed. The programme end time can be adjusted in hours, up to a maximum of 24h. Press the **+/- Change** button repeatedly until the desired number of hours appears (h = hour). The time cannot be adjusted once the programme has started.

Prewash OFF - ON For heavily soiled laundry. Prewash at max. 30 °C

Easy-iron OFF - ON Special spin sequence with subsequent fluffing. Gentle Final spin at reduced speed - residual moisture in the laundry slightly increased.

Signal* Select the volume of the information signals. OFF - quiet - medium - loud - very loud

Button signal* Select the volume of the button signals. OFF - quiet - medium - loud - very loud

Language* Select the language of the display texts.

Water Plus OFF - ON Higher water level. Laundry washed with more care.

Rinse Hold OFF - ON After the final rinse, the laundry remains in the water.

Extra rinse* max. +3 Rinses Additional rinsing. Longer programme duration. Recommended use: for especially delicate skin and/or in areas with very soft water.

Select stain* Automatic treatment of stubborn stains -> page 6.

Display symbols

Childlock/appliance lock OFF - ON You can lock the washing machine to prevent the functions you have set from being changed inadvertently. To activate/deactivate: press the **∨ Options** button for 5 seconds. Note: the childlock can remain active until you wish to start the next programme, even after switching off the machine. Then deactivate the Childlock after the machine has been switched back on.

Foam detection Too much foam in the washing machine. Foam detection system active - special programme sequence to reduce foam.

Select stain



The correct treatment for every stain

Do not allow stains to dry. Remove any solid residues first. Sort the items of laundry as usual and load the washing machine. Select a type of stain (cannot be combined).

There are a total of 16 different stains to choose from. The washing machine tailors the washing temperature, drum movement and soaking time to the type of stain. Hot or cold water, gentle or intensive washing control (thanks to the new drum structure) and a long or short soaking time ensure that the wash programme runs specifically according to the type of stain.

A stain type can be added to each programme via the menu buttons/change buttons.

This results in optimum stain treatment without the use of additional special detergents.

Stains

Baby food	Cosmetics	Tea
Blood	Red wine	Tomato
Egg	Chocolate	Strawberry
Soil + sand	Sweat	Orange
Grass	Dirty socks	
Coffee	Grease + oil	

Stain treatment in detail - 2 examples

Egg	Soaked in lukewarm water, selected wash cycle with a higher water level and additional rinse cycles to remove particles
Blood	Blood is first "loosened" in cold water, then the selected wash programme starts.

For the other types of stain, we have formulated comparable solutions in our intensive studies.

Reload

If you want to add subsequent items of laundry after the programme has started, press the **Start/Reload** button. The machine checks whether reloading is possible. Note the information in the display panel.



For safety reasons, the washing machine door remains locked when the water level and/or temperature is high, or while the drum is rotating. To continue the programme, press the **Start/Reload** button

Overview of programmes → Check the consumption values table on page 8 and the instructions on page 9.

Programmes °C max. Type of laundry Options; notes

Programmes	°C	max.	Type of laundry	Options; notes
Cotton/Coloureds	-- ... 90 °C	8 kg/ 5 kg*	Hard-wearing fabrics, heat-resistant fabrics made of cotton or linen	speedPerfect *, ecoPerfect , Prewash , Easy-iron , Water Plus , Extra rinse , Stains , Rinse Hold
Easy-Care	-- ... 60 °C		Easy-care fabrics made of cotton, linen, synthetic fibres or blended fabrics	speedPerfect , ecoPerfect , Prewash , Easy-iron , Water Plus , Extra rinse , Stains , Rinse Hold
Mixed Fabrics	-- ... 40 °C	3.5 kg	Fabrics made of cotton and easy-care fabrics	speedPerfect , ecoPerfect , different types of laundry can be washed together
Easy-Care Dark	-- ... 40 °C		Dark-coloured fabrics made of cotton and dark easy-care fabrics	speedPerfect , ecoPerfect , reduced rinse + spin and final spin
Curtains	-- ... 40 °C		curtains weighing 3.5 kg, or light curtains measuring 25 - 30 m ²	speedPerfect , ecoPerfect , reduced rinse + spin and final spin
Shirts/ Blouses	-- ... 60 °C		Non-iron shirts made of cotton, linen, synthetic fibres or blended fabrics	speedPerfect , ecoPerfect , gentle spin only, hang up dripping wet
Delicates/Silk	-- ... 40 °C	2 kg	For delicate, washable fabrics, e.g. made of silk, satin, synthetic fibres or blended fabrics (e.g. curtains)	speedPerfect , ecoPerfect , gentle spin between the rinse cycles only
Wool	-- ... 40 °C		Hand or machine-washable fabrics made of wool or containing wool	Prewash ; particularly gentle wash programme to prevent shrinkage of laundry, longer breaks during the programme (fabrics rest in the detergent solution)
Rapid 15'	-- ... 40 °C		Easy-care fabrics made of cotton, linen, synthetic fibres or blended fabrics	Prewash ; short programme, approx. 15 minutes, suitable for lightly soiled washing
Lingerie	-- ... 40 °C		Dessous (Lingerie)	speedPerfect , ecoPerfect , Prewash , Water Plus , Rinse Hold
Textile Guard	-- ... 40 °C	1 kg	Washing with subsequent waterproofing of all-weather, sportswear and outdoor clothing, and clothing with a weatherproof membrane, waterproof fabrics	speedPerfect , ecoPerfect , Prewash , Water Plus ; further information on Impregnation → page 9, reduced Final spin at intervals

Additional programmes

* reduced load for **speedPerfect** option

For a short programme, Mix Fabrics 40°C with max. spin speed is ideal.

Programmes with no prewash - place detergent into compartment **II**, programmes with prewash - divide detergent between compartments **I** and **II**.

1209 / 9000522311



Siemens Electrogeräte GmbH
Carl-Wery-Str. 34
81739 München / Deutschland

WM16S796GB
WM14S796GB

Safety instructions

- Read the Instruction manual and Installation instructions and all other information enclosed with the washing machine and act accordingly.
- Retain the documents for subsequent use.

Risk of electric shock – Never pull the cable to disconnect the mains plug.
– Only insert/pull out the mains plug with dry hands.

Danger to life For worn-out appliances:
– Disconnect the mains plug.
– Sever the mains cable and discard along with the plug.
– Destroy the lock on the washing machine door. This will prevent children from locking themselves in and putting their lives in danger.



Danger of suffocation – Keep packaging, film and packaging parts out of the reach of children.

Risk of poisoning – Keep detergents and care products out of the reach of children.

Risk of explosion – Items of laundry pretreated with cleaning agents containing solvents, e.g. stain remover/cleaning solvent may cause an explosion after being loaded into the washing machine.
Rinse items of laundry thoroughly by hand before washing.

Risk of injury – The washing machine door can become very hot.
– Be careful when draining hot detergent solution.
– Do not climb onto the washing machine.
– Do not lean on the open washing machine door.
– Do not reach into the drum if it is still rotating.

Consumption values

Programme	Option	Load	Electricity consumption***	Water***	Programme duration***
Cotton/Coloureds 30 °C**		8 kg	0.33 kWh	57 l	2:06 h
Cotton/Coloureds 40 °C**		8 kg	0.95 kWh	57 l	2:16 h
Cotton/Coloureds 60 °C**		8 kg	1.45 kWh	57 l	2:26 h
Cotton/Coloureds 60 °C	 ecoPerfect*	8 kg	1.06 kWh	56 l	3:25 h
Cotton/Coloureds 90 °C		8 kg	2.32 kWh	68 l	2:16 h
Easy-Care 40 °C**		3.5 kg	0.54 kWh	41 l	1:35 h
Mix Fabrics 40 °C**		3.5 kg	0.46 kWh	37 l	0:53 h
Delicate/Silk – – (cold)		2 kg	0.04 kWh	35 l	0:41 h
Delicate/Silk 30 °C		2 kg	0.14 kWh	35 l	0:41 h
 Wool – – (cold)		2 kg	0.06 kWh	40 l	0:40 h
 Wool 30 °C		2 kg	0.16 kWh	40 l	0:40 h

* Programme setting for testing and energy labelling in accordance with EU directive 92/75/EEC.

** Programme setting for testing with the currently valid version of EN60456.

Note for comparative testing: to test using the test programmes, wash using the specified load amount and maximum spin speed.

Select the **Mix Fabrics 40 °C** programme and maximum spin speed as the **short programme** for coloureds.

*** The values deviate from the indicated values depending on water pressure, hardness, and inlet temperature, ambient temperature, type, amount and soiling of the laundry, detergent used, fluctuations in the power supply and selected additional functions.

Important information

Before washing for the first time

- Do not load any laundry into the machine. Turn on the tap. Add the following to compartment **II**:
- approx. 1 litre water
 - detergent (dosage according to the manufacturer's instructions for light soiling and the appropriate degree of water hardness)
- Set the programme selector to **Easy-Care 60 °C** and select **Start/Reload**. At the end of the programme, turn the programme selector to **Off**.



Protecting the laundry and the machine

- Empty pockets.
- Look out for metal items (paperclips, etc.).
- Wash delicates in a laundry bag (tights, curtains, underwired bras).
- Fasten zips, do up any buttons.
- Brush sand out of pockets and collars.
- Remove curtain fittings or place in the laundry bag.







Loading the laundry

Insert large and small items of laundry.
Ensure that items are not trapped between the door and rubber seal.



Laundry with varying degrees of soiling

- | | | |
|-------|---|---|
| light |  | Wash new items of clothing separately.
No prewash. The  speedPerfect function can also be selected if desired. |
| |  | Pretreat any stains as necessary. |
| heavy |  | Insert less laundry. Select Prewash with the programme. |



Soaking

Load laundry of the same colour.

Pour soaking agent/detergent into compartment **II** in accordance with the manufacturer's instructions. Turn the programme selector to **Cottons/Coloureds 30 °C** and press **Start/Reload**. After approx. 10 minutes, press **Start/Reload** to pause the programme. Once the required soaking time has elapsed, press **Start/Reload** again to continue the programme, or select a different programme.



Starching

Laundry must not be treated with fabric softener

Starching is possible in all wash programmes using liquid starch. Pour the starch into the  fabric softener compartment according to the manufacturer's instructions (if necessary clean it first).



Dyeing/bleaching

Dye should only be used in normal household quantities. Salt may damage stainless steel. Always follow the dye manufacturer's instructions. **Do not** bleach laundry in the washing machine.



Load display

The loading sensor detects the load amount in the washing machine.
The laundry is not weighed.



Recommended dosage

Depending on the programme selected and the load detected, a recommended detergent dosage is displayed in %. The % display corresponds to the detergent manufacturer's recommendation.



Load adjust

Independently of the load display, the "Load adjust" automatic load sensing function uses additional sensors to adapt the water and power consumption ideally to each programme, depending on the type of fabric and the load.



Outdoor+ Impregnation

*Laundry must not be treated with fabric softener.
Clean the detergent drawer thoroughly to remove fabric softener residue.*

Special detergents and impregnating agents suitable for machine washing are available in sports shops.
Dose according to manufacturing instructions:

1. Place the special detergent for outdoor clothing in compartment **II** and
2. pour impregnating agent (max. 170 ml) into the  compartment.

Move the programme selector to **Textile Guard**. Select temperature.

Press **Start/Reload**. Final treatment of laundry according to manufacturer's instructions.

Insert for liquid detergent model-dependent

Position the insert for dispensing liquid detergent:

- Remove the detergent drawer completely -> *page 10*.
- Slide the insert forwards.

Do not use the insert (slide upwards):

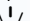
- for gel detergents and washing powder,
- for programmes with **Prewash**  or the **End time** option.

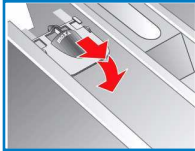

Care



- **Risk of electric shock.** *Disconnect the mains plug*
- **Risk of explosion.** *No solvents*

Machine housing, control panel

- Wipe with a soft, damp cloth.
- Do not use any abrasive cloths, scourers or cleaning agents (stainless steel cleaners).
- Remove detergent and cleaning agent residue immediately.
- Do not clean with a jet of water.

Cleaning the detergent drawer ...

... if it contains detergent or fabric softener residues.

1. Pull out, press insert down, remove drawer completely.
2. To remove the insert, push the insert up from below with your finger.
3. Clean the detergent dispenser tray and insert with water and a brush and dry it.
4. Attach the insert and engage (connect the cylinder to the guide pin).
5. Push in the detergent drawer.

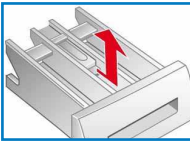
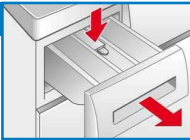

Leave the detergent drawer open so that any residual water can evaporate.

Drum

Rust stains - use chlorine-free cleaning agent, not steel wool.

Descaling

No laundry in the machine.

This is not necessary if the detergent is dosed correctly. However, if it is necessary, follow the instructions of the descaler manufacturer. Suitable descaling products can be purchased from our website or after-sales service (→ *page 13*).

Information on the display panel depending on model

Door open?	Close the door properly; laundry may be trapped.
Tap closed?	Open the tap fully, supply hose kinked/trapped; clean the filter → <i>page 11</i> , water pressure too low.
Pump blocked?	Detergent solution pump blocked; clean detergent solution pump → <i>page 11</i> . Drainage hose/waste pipe blocked; clean the drain hose on the siphon → <i>page 11</i> .
Pause No top-up; Water level too high or Temperature too high	Not possible to reload laundry. Press Start/Reload to continue the programme.
F: 23	Water in the base tub, appliance leaking. Call the after-sales service.
F: 34	Cannot lock washing machine door. Open the door and close it again so that you can hear it "click"; switch the appliance off and on again; set the programme and make individual settings; start the programme.
Other displays	Switch off the appliance, wait 5 seconds and switch on again. If the same display appears again, call the after-sales service → <i>page 13</i> .

Information about blockages



- **Risk of scalding.** *Allow the detergent solution to cool down*
- *Turn off the tap.*



Detergent solution pump

Turn the programme selector to **Off**, disconnect the mains plug.

1. Open and remove the service flap.
2. Remove the drainage hose from its holder. Remove the sealing cap and allow the solution to drain out. Put the sealing cap back in place.
3. Unscrew the pump cover carefully (residual water).
4. Clean the interior, pump cover thread and pump housing (the impeller in the detergent solution pump must rotate).

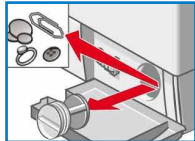
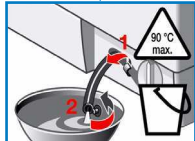
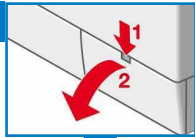

5. Put the pump cover back in place and screw it tight. The handle should stand vertically. Insert the drainage hose into its holder.
6. Refit the service flap and close it.

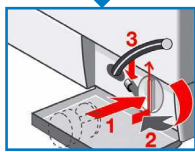

To prevent detergent from flowing down the drain unused during the next wash cycle: pour 1 litre of water into compartment **II** and start the **Empty** programme.



Drainage hose at the siphon

Turn the programme selector to **Off**, disconnect the mains plug.

1. Loosen the hose clamp, remove the drainage hose carefully (residual water).
2. Clean the drainage hose and siphon connecting piece.
3. Reattach the drainage hose and secure the connection with the hose clamp.

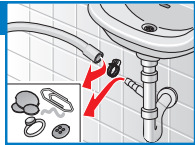

Filter in the water supply



Risk of electric shock

Do not immerse the AquaStop safety device in water (it contains an electric valve).

Reduce the water pressure in the supply hose:

1. Turn off the tap.
2. Select any programme (**apart from Spin/Empty**).
3. Press **Start/Reload**. Allow the programme to run for approx. 40 seconds.
4. Turn the programme selector to **Off**. Disconnect the mains plug. Clean the filter:
5. Disconnect the hose from the tap. Clean the filter using a small brush.



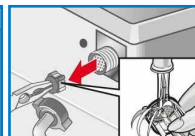
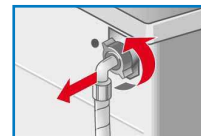

and/or on standard and Aqua-Secure models: Remove the hose from the rear, remove the filter using pliers and clean the filter.

6. Connect the hose and check for leaks.

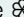

What to do if ...

- Water is leaking out.
 - Attach/replace the drainage hose correctly.
 - Tighten the screw connection of the supply hose.
- No water supply.
 - **Start/Reload** not selected?
- Detergent not dispensed.
 - Tap not turned on?
 - Filter may be blocked. Clean the filter → *page 11*.
 - Supply hose kinked or trapped?
- Washing machine door cannot be opened.
 - Safety function active. Programme terminated? → *page 4*.
 - **Rinse Hold** (no Final spin) selected? → *page 3, 4*.
 - Can be opened by emergency release only? → *page 13*.
- Programme does not start.
 - **Start/Reload** or **End time** selected?
 - Washing machine door closed?
 - Childlock active? Deactivate it → *page 5*.
- Detergent solution does not drain.
 - **Rinse Hold** (no Final spin) selected? → *page 3, 4*.
 - Clean the detergent solution pump → *page 11*.
 - Clean the waste pipe and/or drainage hose.
- Water not visible in the drum.
 - Not a fault - water below the visible area.
- Unsatisfactory spin result. Laundry wet/too damp.
 - Not a fault - the unbalanced-load detection system has cancelled the spin cycle because of uneven distribution of the laundry. Distribute small and large items of laundry evenly inside the drum.
 - **Easy-iron** selected? → *page 5*.
 - Selected speed too low? → *page 5*.
- Drum spins gently several times.
 - Not a fault - unbalanced-load detection system is adjusting the imbalance.
- Residual water in the  compartment for care products.
 - Not a fault - the action of the care product is not affected.
 - Clean the insert if necessary → *page 10*.
- Odour formation in the washing machine.
 - Run the **Cottons/Coloureds 90 °C** programme with no load inserted. Use standard detergent.
- The  status indicator lights. Appliance has detected a detergent overload.
 - Too much detergent used? Mix 1 tablespoon of fabric softener with ½ litre water and pour into compartment **II** (*not with outdoor or down fabrics*).
 - Reduce the detergent dosage for the next wash cycle.
- Loud spinning, vibrations and “walking” during the spin cycle.
 - Appliance feet fixed? Secure the appliance feet → *Installation instructions*.
 - Transport braces removed? Remove the transport braces → *Installation instructions*.
- Display panel/indicator lamps do not function during operation.
 - Power cut?
 - Circuit breakers tripped? Reset/replace the circuit breakers.
 - If the fault occurs repeatedly, call the after-sales service.
- Programme sequence longer than usual.
 - Not a fault - unbalanced-load detection system is adjusting the imbalance by repeatedly redistributing the laundry.
 - Not a fault - foam detection system active - several rinse cycles are added.

What to do if ...

- There are detergent residues on the laundry.
 - Occasionally, phosphate-free detergents contain water-insoluble residues.
 - Use the **Rinse**  cycle or brush out the laundry after washing.
 - in Reload mode, Start/Reload flashes very quickly and an audible signal sounds
 - Water level too high. Not possible to reload laundry.
 - Close door immediately if open.
 - To continue the programme, press **Start/Reload**.
- If you cannot correct a fault yourself (switching on/off) or a repair is required:
- Turn the programme selector to **Off** and remove the mains plug from the socket.
 - Turn off the water supply and call the after-sales service → *page 13*.

Emergency release e.g. in the event of a power cut



The programme continues when the power supply is restored. However, if the laundry has to be removed, the washing machine door can be opened as follows:



Risk of scalding.

The detergent solution and laundry may be hot. Allow them to cool down. Do not reach inside the drum if it is still turning. Do not open the door if you can see water through the glass.

1. Turn the programme selector to **Off** and disconnect the mains plug.
2. Drain the detergent solution → *page 11*.
3. Pull the emergency release downwards with a tool and release. Washing machine door can then be opened.

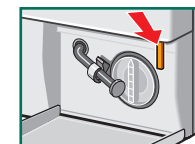

After-sales service

- If you cannot rectify the fault yourself (Troubleshooting → *page 12, 13*), please contact our after-sales service. We will always find a suitable solution and will avoid a visit from a service technician wherever possible.
- You can find the contact details for your nearest after-sales service here or in the after-sales service directory (depending on model).

GB 0844 8928999 Calls from a BT landline will be charged at up to 3 pence per minute. A call set-up fee of up to 6 pence may apply.

IE 01450 2655

- Please give the after-sales service the product number (E no.) and the production number (FD) of the appliance.

E-Nr. _____ FD _____

Product number Production number

*You will find this information:
on the inside of the washing machine door*/
opened service flap* and rear of the appliance.
depending on the model

- **Rely on the professionalism of the manufacturer.** Please contact us. This will ensure that the repair is carried out by trained service technicians who arrive equipped with genuine spare parts for your appliance.



Observe the safety instructions on page 8.

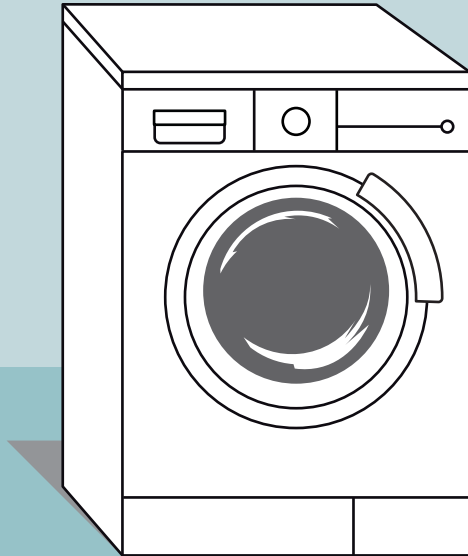

Washing machine

Instruction manual

en



Read these instructions and the separate installation instructions before operating the washing machine.

SIEMENS